

WOLTERS ENGINEERING

ENGINEERING, DRAFTING, CONSULTING

15211 97th Road N
West Palm Beach, FL 33412
Ph/Fx: (561) 225-1982

PRODUCT EVALUATION

PRODUCT: **1ST COAST 26 GA. GALVALUME PBR ROOF PANEL, 36" WIDE**
(FLPA# 36968.1)

MANUFACTURER: 1ST COAST METAL ROOFING SUPPLY
186 STATE ROAD 207
EAST PALATKA, FL 32131

To all concerned,

The 1st Coast 26 Ga. 36" Wide Galvalume PBR Roof Panel, manufactured by 1st Coast Metal Supply, is a non-structural galvalume coated Fluoropon painted steel roof panel (50 ksi min) that meets the requirements of Section 1507.4 of the 7th Edition (2020) Florida Building Code. The panel has been tested per TAS 100, TAS 125, and TAS 201 by Intertek, with results shown in test reports L4914.06-450-18, L4914.07-450-18, and L4914.08-450-18. It has also been tested per TAS 110 by PRI Construction Materials Technologies, with results shown in test reports VLS-004-02-01 and VLS-005-02-01.

Technical Documentation:

1. Drawing "1CPBR" dated 12/21/20, signed and sealed by Scott Wolters, PE.
2. Test Reports listed above by Intertek, signed and sealed by Vinu Abraham, PE.
3. Test Reports listed above by PRI Construction Materials Technologies, signed and sealed by Zachary R Priest, PE.
4. Supplemental Calculations to support "1CPBR", signed and sealed by Scott Wolters, PE.

I have reviewed this submittal per the requirements of FAC Product Approval Rule Chapter 61G20-3.005 (4). Based on the limitations listed below and those provided in the documents above, this product meets all the requirements of the 7th Edition (2020) Florida Building Code generally, and chapter 15 specifically, for use outside of the HVHZ.

Limitations: **This panel is approved for use outside of the HVHZ.**

<u>Overall Limitations:</u>	Maximum Panel Width:	36"
	Minimum Rib Height:	1 1/8"
	Min. Slope:	1/2"/12"
	Max. Purlin Spacing:	60" O.C.
	Min. Purlin Thickness:	16 Ga.

	Field Installation	Perimeter & Corner Installation
Max. Design Pressure:	-62.5 psf	-130 psf
Panel Fasteners:	#10x1 1/2" HiLo HWH Screws	#10x1 1/2" HiLo HWH Screws
Fastener Spacing (Across Panel)	12" Max. O.C. Beside Each Rib	5"-7"-5" Pattern Each Side of Ribs
Seam Fasteners and Sealant:	#10x3/4" HiLo HWH Screws 12" Max. O.C, with Butyl Tape	#10x3/4" HiLo HWH Screws 12" Max. O.C, with Butyl Tape.
Fasteners at Panel Butt-Joints	#10x1 1/2" HiLo HWH Screws 3" Max. O.C, with Butyl Tape	#10x1 1/2" HiLo HWH Screws 3" Max. O.C, with Butyl Tape
	(Panels are lapped 2")	(Panels are lapped 2")

Minimum Substrate: 16 Ga. Steel Purlins, spaced 60" max. O.C.

Other Limitations:

1. Roof slope must meet requirements of FBC Sections 1507.4.2.
2. Fire classification is not a part of this evaluation. Refer to a current Approved Roofing Materials Directory for fire ratings of this product.
3. Design of substrate is by others and is not a part of this evaluation.
4. Rational analysis, provided by a Florida licensed Architect/Engineer per FAS 61G20.3.005(e), may be used for project specific approval by the local authorities having jurisdiction.

Re-Roofing: The 36" Wide PBR Series 26 Ga. Galvalume Roof Panel may be installed over a single layer of existing asphalt shingles or existing PBR Panels, provided the existing roof meets the requirements of Section 1511 of the Florida Building Code.

Note: If installed over existing panels, the existing screws and any debris must be removed from The existing roof. Any corrosion in the existing roof must be treated per FBC 1521.8.

If you have any questions or need more information concerning this approval, please contact me.

Thank you,

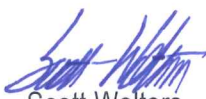
 Scott Wolters
 FL PE# 62354
 FEB 10 2021

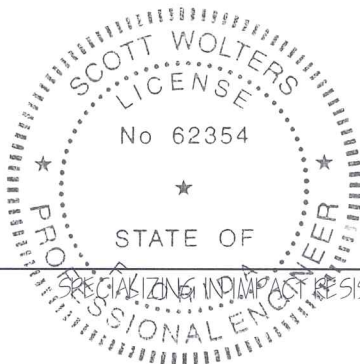

SPECIALIZING IN IMPACT RESISTANT CURTAINWALLS, STOREFRONTS, & WINDOWS

1ST COAST 26 Ga. STEEL PBR ROOF PANEL

36" RIBBED ROOF PANEL INSTALLED DIRECTLY OVER STEEL PURLINS
OR INSTALLED OVER EXISTING PBR PANEL OVER STEEL PURLINS

FIELD INSTALLATION

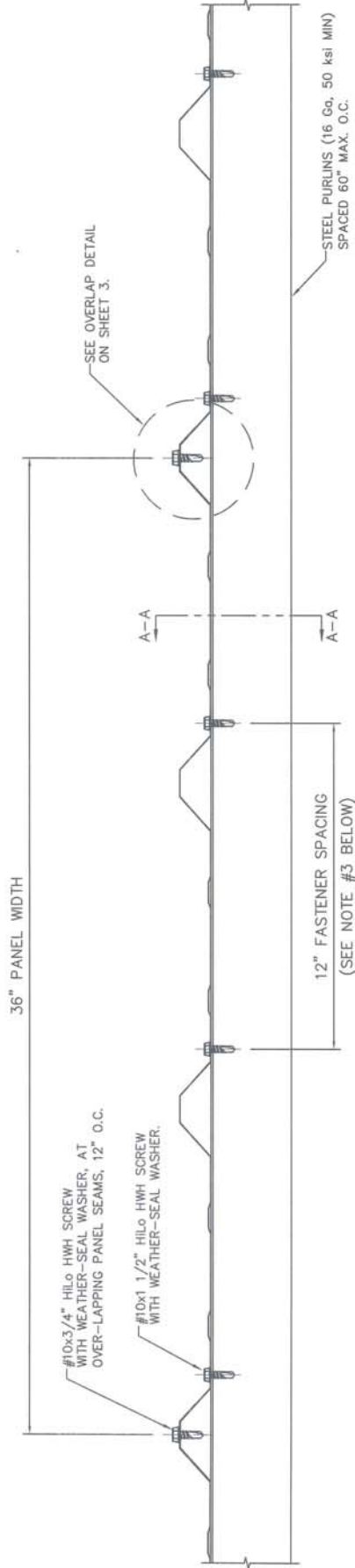

MAX UPLIFT PRESSURE	62.5 Psf
---------------------	----------

#10x3/4" HILO HWH SCREW
WITH WEATHER-SEAL WASHER AT
OVER-LAPPING PANEL SEAMS, 12" O.C.

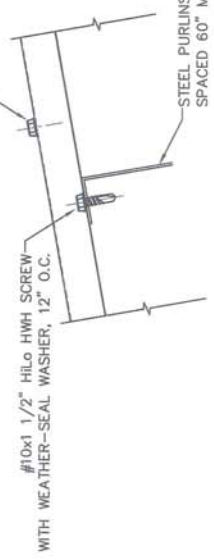

SECTION A-A

GENERAL NOTES:

- PBR PANEL MAY BE INSTALLED DIRECTLY TO STEEL PURLINS, OR INSTALLED OVER EXISTING PBR PANELS.
- IF INSTALLED OVER EXISTING PANELS, THE EXISTING SCREWS AND ANY DEBRIS MUST BE REMOVED FROM THE EXISTING ROOF. ANY CORROSION IN THE EXISTING ROOF MUST BE TREATED WITH A RUST INHIBITOR PER FBC 1521.8.
- AT PANEL BUTT JOINTS, PANELS ARE OVERLAPPED 2", SEALED WITH BUTYL TAPE, AND FASTENED WITH #10x1 1/2" HILO HWH SCREWS 3" O.C.
- ROOF SLOPE IS LIMITED PER THE REQUIREMENTS OF FBC SECTION 1507.4.2.
- FLASHING AND TRIM TO BE INSTALLED PER THE MANUFACTURER'S STANDARD INSTALLATION DETAILS, TO MEET THE REQUIREMENTS OF FBC SECTION 1503.

PRINTS ISSUED FOR	1ST SUBMITTAL
REV#	
DATE	12/21/20



SCOTT WOLTERS
FL PE # 62354
WOLTERS ENGINEERING
(COA# 27194)
15211 97TH ROAD N
WEST PALM BEACH, FL 33412
(561) 225-1982

1ST COAST METAL ROOFING SUPPLY
PH: (561) 629-7288
www.1stcoastmrs.com

186 STATE ROAD 207
EAST PALATKA, FL 32131

1ST COAST METAL ROOFING SUPPLY
DWG: 1CPBR
SHEET: 1/3

1ST COAST 26 Ga. STEEL PBR ROOF PANEL

36" RIBBED ROOF PANEL INSTALLED DIRECTLY OVER STEEL PURLINS OR INSTALLED OVER EXISTING PBR PANEL OVER STEEL PURLINS

PERIMETER & CORNER INSTALLATION

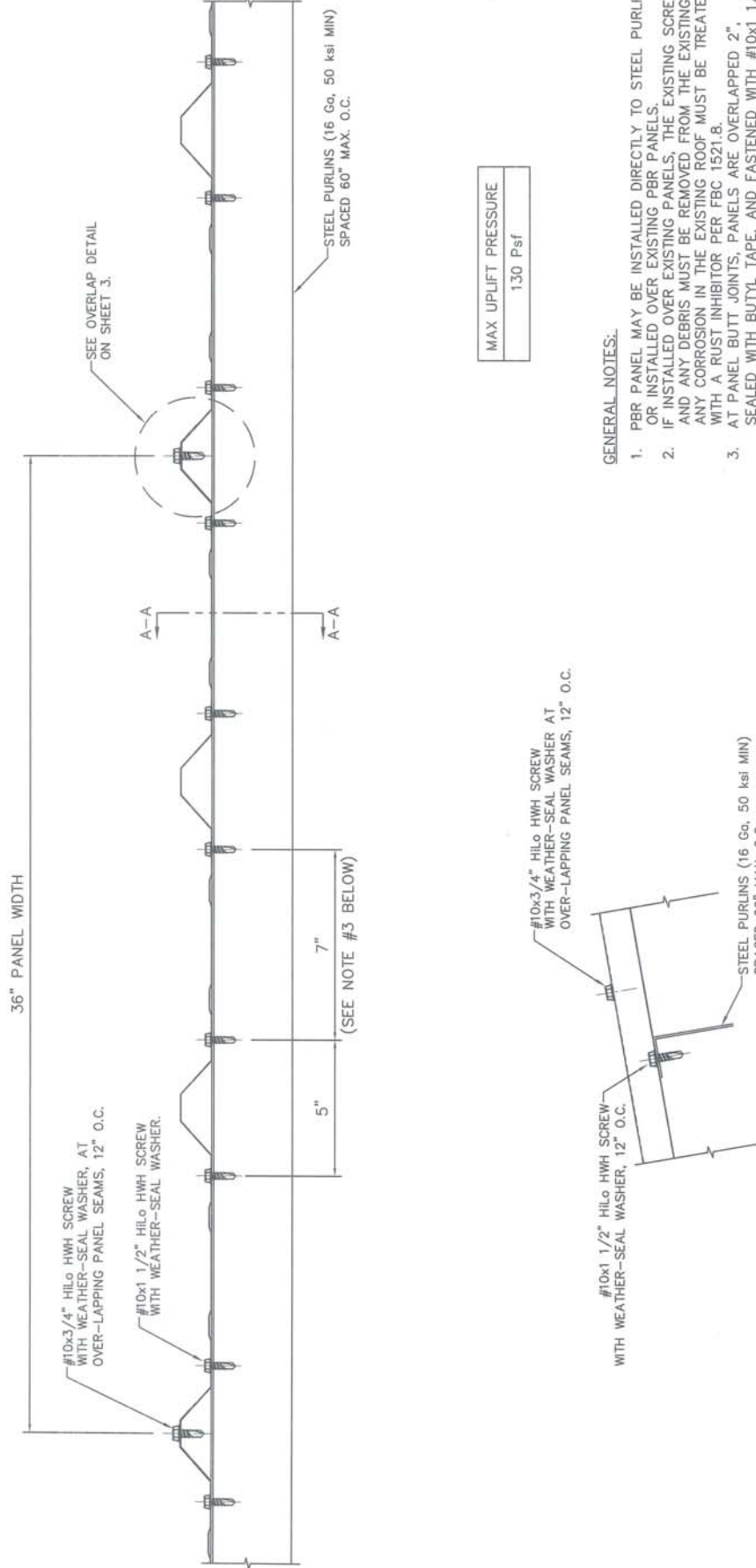

MAX UPLIFT PRESSURE
130 Psf

GENERAL NOTES:

1. PBR PANEL MAY BE INSTALLED DIRECTLY TO STEEL PURLINS, OR INSTALLED OVER EXISTING PBR PANELS.
2. IF INSTALLED OVER EXISTING PANELS, THE EXISTING SCREWS AND ANY DEBRIS MUST BE REMOVED FROM THE EXISTING ROOF. ANY CORROSION IN THE EXISTING ROOF MUST BE TREATED WITH A RUST INHIBITOR PER FBC 1521.8.
3. AT PANEL BUTT JOINTS, PANELS ARE OVERLAPPED 2", SEALED WITH BUTYL TAPE, AND FASTENED WITH #10x1 1/2" HILO HWH SCREWS 3" O.C.
4. ROOF SLOPE IS LIMITED PER THE REQUIREMENTS OF FBC SECTION 1507.4.2.
5. FLASHING AND TRIM TO BE INSTALLED PER THE MANUFACTURER'S STANDARD INSTALLATION DETAILS, TO MEET THE REQUIREMENTS OF FBC SECTION 1503.

SECTION A-A

PRINTS ISSUED FOR	REV.#	DATE
1ST SUBMITTAL		12/21/20



SCOTT WOLTERS
FL PE # 02334
WOLTERS ENGINEERING
(GOA# 27194)
15211 97TH ROAD N
WEST PALM BEACH, FL 33412
(561) 225-1982

PH: (561) 629-7288
WWW.1STCOASTMIS.COM

1ST COAST METAL ROOFING SUPPLY

186 STATE ROAD 207
EAST PALATKA, FL 32131

1ST COAST METAL ROOFING SUPPLY
DWG: 1CPBR
SUBJECT: 2/3

1ST COAST 26 Ga. STEEL PBR ROOF PANEL

36" RIBBED ROOF PANEL INSTALLED DIRECTLY OVER STEEL PURLINS
OR INSTALLED OVER EXISTING PBR PANEL OVER STEEL PURLINS

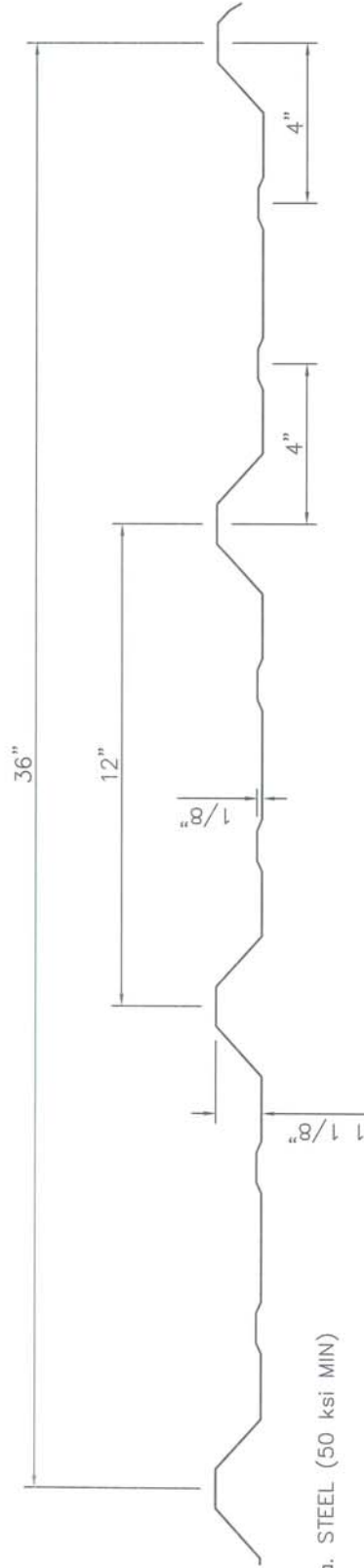

BUTYL TAPE AT
PANEL SEAMS.

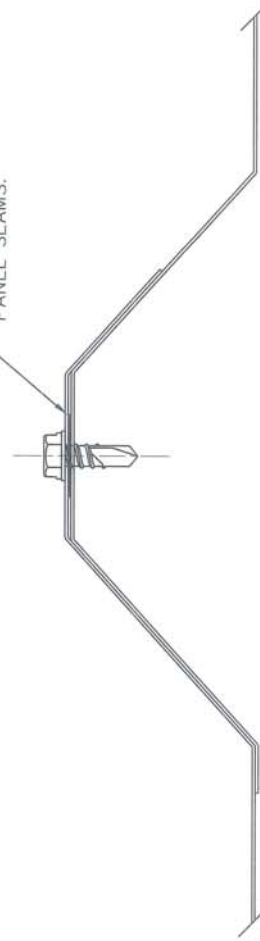

OVERLAP DETAIL
(1 RIB)

1ST COAST METAL ROOFING SUPPLY
186 STATE ROAD 207
EAST PALATKA, FL 32131
PH: (561) 629-7288
www.1stcoastmrs.com

SCOTT WOLTERS
FL PE# 82354
WOLTERS ENGINEERING
(561) 225-1982
WEST PALM BEACH, FL 33412
15211 97TH ROAD N
(COA# 22194)
DEC 21 2020

REV.#	DATE	PRINTS ISSUED FOR
12/21/20		1ST SUBMITTAL

1ST COAST METAL ROOFING SUPPLY
DWG: 1CPBR
SHEET: 3/3