

**Force Engineering & Testing**

19530 Ramblewood Drive  
Humble, Texas 77338  
Phone: (281) 540-6603 FAX: (281) 540-9966  
Website: [www.forceengineeringtesting.com](http://www.forceengineeringtesting.com)

**Product Evaluation Report**  
**GREEN SPAN PROFILES®**

**RidgeLine Standing Seam Roof Panel over open framing**

**Florida Product Approval # 21349.1 R4**

Florida Building Code 2023

Per Rule 61G20-3

Method: 1 -D

Category: Structural Components

Subcategory: Roof Deck

Compliance Method: 61G20-3.005(1)(d)

NON HVHZ

**Product Manufacturer:**

**Green Span Profiles®**

21200 FM 362

Waller, Texas 77484

**Engineer Evaluator:**

**Johnathan Green, P.E. #88223**

Florida Evaluation ANE ID: 12901

**Contents:**

**Evaluation Report: Page 1 - 4**

**Installation Detail: Page 5 - 8**

OCT 07 2023

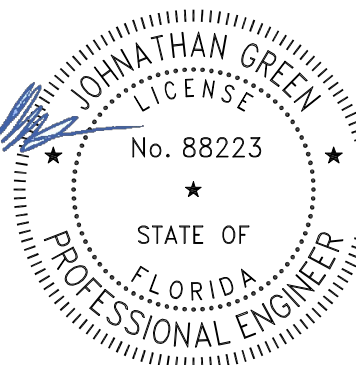

THIS DOCUMENT HAS BEEN DIGITALLY SIGNED AND SEALED BY JOHNATHAN GREEN ON THE DATE ADJACENT TO THE SEAL.

PRINTED COPIES OF THIS DOCUMENT ARE NOT CONSIDERED SIGNED AND SEALED AND THE SIGNATURE MUST BE VERIFIED ON ANY ELECTRONIC COPIES.



<b>Compliance Statement:</b>	The product as described in this report has demonstrated compliance with the Florida Building Code 2023, Sections 1504.3.2, 1504.7, 2603.3.
<b>Product Description:</b>	Insulated roof panel system with an interior steel facing and exterior steel standing seam facing bonded to an insulating polyisocyanurate foam core. A concealed clip in the interlocking side joint attaches the roof panels to supports. Structural Application.
<b>Panel:</b>	Profiles: RidgeLine Panel Thickness: 2 ½", 3", 4", 5", 6" Panel Coverage: 42" maximum Interior Side Joint: Green-Lock interlocking tongue and groove side joint Exterior Side Joint: 2" Tall, Tee shaped rib with seam cap, mechanically seamed
<b>Panel Interior Face:</b>	Material: Steel, ASTM A792 coated or ASTM A653 G90 Galvanized Yield Strength: Min. 50.0 ksi Thickness: 26 Ga., 24 Ga., 22 Ga. Texture: Embossed or Smooth Profile: MesaLine Panel material shall comply with Florida Building Code 2023, Section 1507.4.3.
<b>Panel Exterior Face:</b>	Material: Steel, ASTM A792 coated or ASTM A653 G90 Galvanized Yield Strength: Min. 50.0 ksi Thickness: 26 Ga., 24 Ga., 22 Ga. Texture: Smooth Profile: 2" tall standing seam Tee shaped rib with seam cap, mechanically seamed. Panel seam cap: 24 Ga. steel with factory applied hot melt adhesive sealant Panel material shall comply with Florida Building Code 2023 Section 1507.4.3.
<b>Panel Core:</b>	Polyisocyanurate insulating foam with a 2.5 pcf density (nominal).
<b>Panel Clip:</b>	Material: Galvanized Steel Thickness: 0.061", 16 Ga. Dimensions: 3.375" tall x 4" long with (5) pre punched holes Corrosion Resistance: Per Florida Building Code 2023, Section 1506.7.
<b>Panel Clip Fastener:</b>	(3) ¼ - 14 x 2 ¼" HWH SD Shoulder Fastener per clip. The fasteners shall be long enough to ensure a minimum penetration of 3 pitches of thread through steel girt. Corrosion Resistance: Per Florida Building Code 2023, Section 1507.4.4.
<b>Substrate Description:</b>	Min. 14 Ga. Steel Framing. Framing must be designed in accordance w/ Florida Building Code 2023.

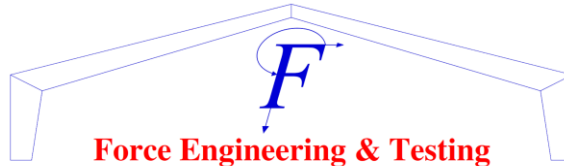

**Force Engineering & Testing**

19530 Ramblewood Drive  
Humble, Texas 77338

Phone: (281) 540-6603 FAX: (281) 540-9966  
Website: [www.forceengineeringtesting.com](http://www.forceengineeringtesting.com)

**Allowable Design Uplift Pressures:**

Table "A"

<b>Maximum Allowable Design Pressure (PSF):</b>	-78.1	-72.4	-66.7	-60.9	-55.2	-49.5
<b>Panel Clip Spacing (O.C.):</b>	2'-6"	3'-0"	3'-6"	4'-0"	4'-6"	5'-0"

\*Design Pressure includes a Safety Factor = 2.0.

\*Contact Manufacturer for additional Design Pressures/clip spacings

**Code Compliance:**

The product described herein has demonstrated compliance with The Florida Building Code 2023, Section 1504.3.2, 1504.7, 2603.3.

**Evaluation Report Scope:**

The product evaluation is limited to compliance with the structural wind load requirements of the Florida Building Code 2023, as relates to Rule 61G20-3.

**Performance Standards:**

The product described herein has demonstrated compliance with:

- ASTM E 1592-05 (2017) Test method for structural performance of sheet metal roof and siding systems by uniform static air pressure difference.
- FM 4471-92, Foot Traffic Resistance Test.
- ASTM E84-18b Standard Test Method for Surface Burning Characteristics of Building Materials.

**Reference Data:**

1. ASTM E 1592-05  
Force Engineering & Testing, Inc. (FBC Organization # TST-5328)  
Report No. 438-0191T-16
2. FM 4471-10, Foot Traffic Resistance Test  
Force Engineering & Testing, Inc. (FBC Organization # TST-5328)  
Report No. 438-0189T-16
3. ASTM E 84-11a  
FM Approvals  
Project ID: 3044381
4. Certificate of Independence  
By Johnathan Green, P.E. (No. 88223) @ Force Engineering & Testing  
(FBC Organization # ANE ID: 12901)

**Test Standard Equivalency:**

The ASTM E 1592-05 test standard is equivalent to the ASTM E 1592-05 (2017) test standard.

The FM 4471-10, Foot Traffic Resistance test standard is equivalent to the FM 4471-92, Foot Traffic Resistance test standard

The ASTM E84-11a test standard is equivalent to ASTM E84-18b.

**Quality Assurance Entity:**

The manufacturer has established compliance of roof panel products in accordance with the Florida Building Code and Rule 61G20-3.005 (3) for manufacturing under a quality assurance program audited by an approved quality assurance entity.

**Minimum Slope Range:**

Minimum Slope shall comply with Florida Building Code 2023, including Section 1507.4.2 and in accordance with Manufacturers recommendations.



- Installation:** Install per manufacturer's recommended details.
- Roof Panel Fire Classification:** Fire classification is not part of this evaluation.
- Shear Diaphragm:** Shear diaphragm values are outside the scope of this report.
- Design Procedure:** Based on the dimensions of the structure, appropriate wind loads are determined using Chapter 16 of the Florida Building Code 2023 for roof cladding wind loads. These component wind loads for roof cladding are compared to the allowable pressure listed above. The design professional shall select the appropriate erection details to reference in his drawings for proper fastener attachment to his structure and analyze the panel fasteners for pullout. Support framing must be in compliance with Florida Building Code 2023 Chapter 22 for steel, and Chapter 16 for structural loading.

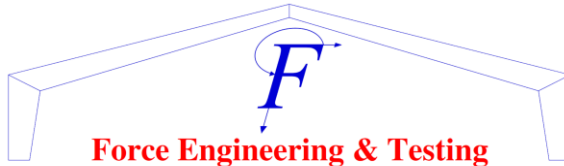

**Force Engineering & Testing**

19530 Ramblewood Drive  
Humble, Texas 77338

Phone: (281) 540-6603 FAX: (281) 540-9966  
Website: [www.forceengineeringtesting.com](http://www.forceengineeringtesting.com)

**NOTE: DO NOT OVER DRIVE FASTENERS.**

RL-SL-001

FASTENING SCHEDULE WILL VARY  
DEPENDING ON SPECIFIC APPLICATION

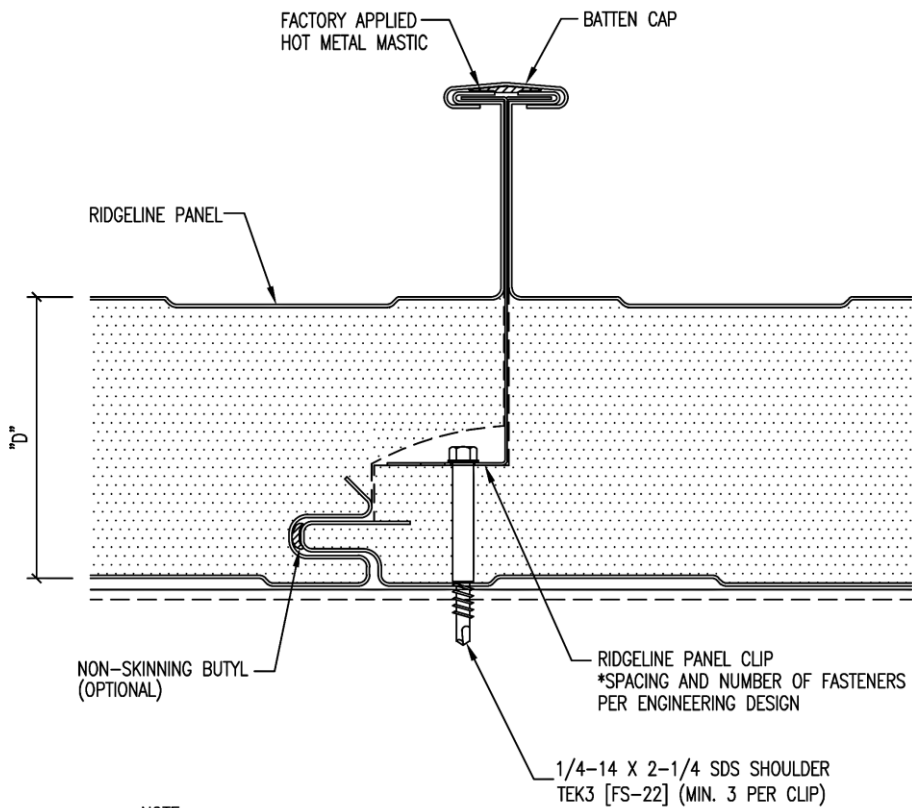

**NOTE:**

- "D" = ROOF PANEL THICKNESS (AVAILABLE THICKNESS = 2.5, 3, 4, 5 OR 6)



ROOF PANEL SIDE LAP		
APPLICATION: SSR	NOTES:	
SCALE: NTS	REVISION: 3	DATE: 6-3-16
DRAWN: JC	DATE: 10-20-13	
CHECK:	DATE:	
21200 FM362, WALLER, TEXAS 77484	281-807-7400	<a href="http://WWW.GREENSPANPROFILES.COM">WWW.GREENSPANPROFILES.COM</a>

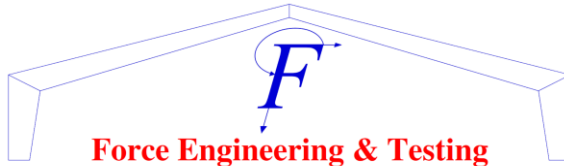

**Force Engineering & Testing**

19530 Ramblewood Drive  
Humble, Texas 77338

Phone: (281) 540-6603 FAX: (281) 540-9966  
Website: [www.forceengineeringtesting.com](http://www.forceengineeringtesting.com)

NOTE: DO NOT OVER DRIVE FASTENERS.

RL-CC-001

FASTENING SCHEDULE WILL VARY  
DEPENDING ON SPECIFIC APPLICATION

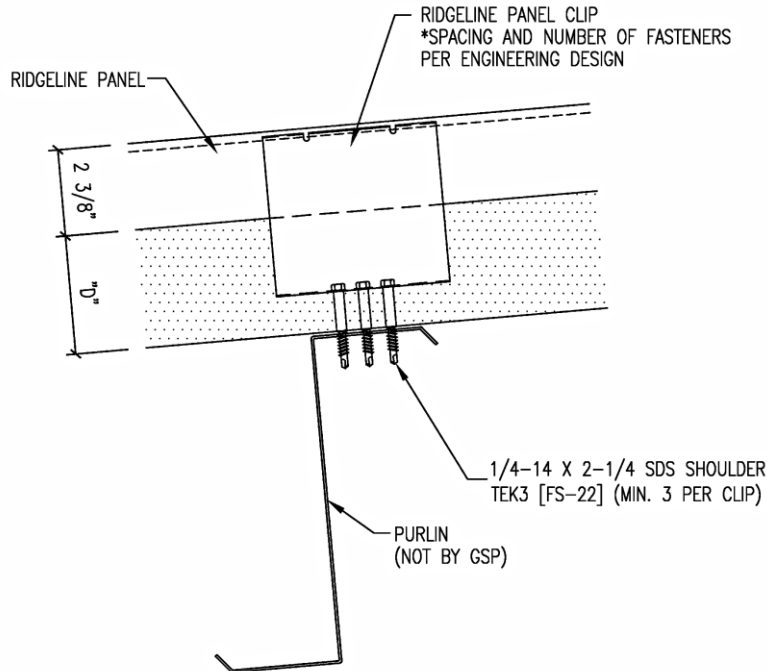

NOTE:

- "D" = ROOF PANEL THICKNESS (AVAILABLE THICKNESS = 2.5, 3, 4, 5, OR 6)



**GREEN SPAN  
PROFILES®**  
INSULATED PANEL TECHNOLOGIES

**ROOF PANEL CLIP CONNECTION**

APPLICATION: SSR	NOTES:	
SCALE: NTS	REVISION: 3	DATE: 6-3-16
DRAWN: JC	DATE: 10-20-13	
CHECK:	DATE:	
21200 FM362, WALLER, TEXAS 77484	281-807-7400	<a href="http://WWW.GREENSPANPROFILES.COM">WWW.GREENSPANPROFILES.COM</a>

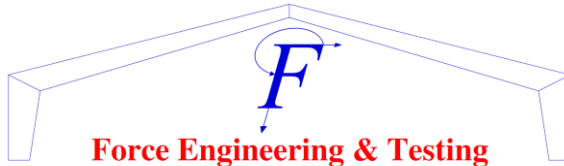

**Force Engineering & Testing**  
 19530 Ramblewood Drive  
 Humble, Texas 77338  
 Phone: (281) 540-6603 FAX: (281) 540-9966  
 Website: www.forceengineeringtesting.com

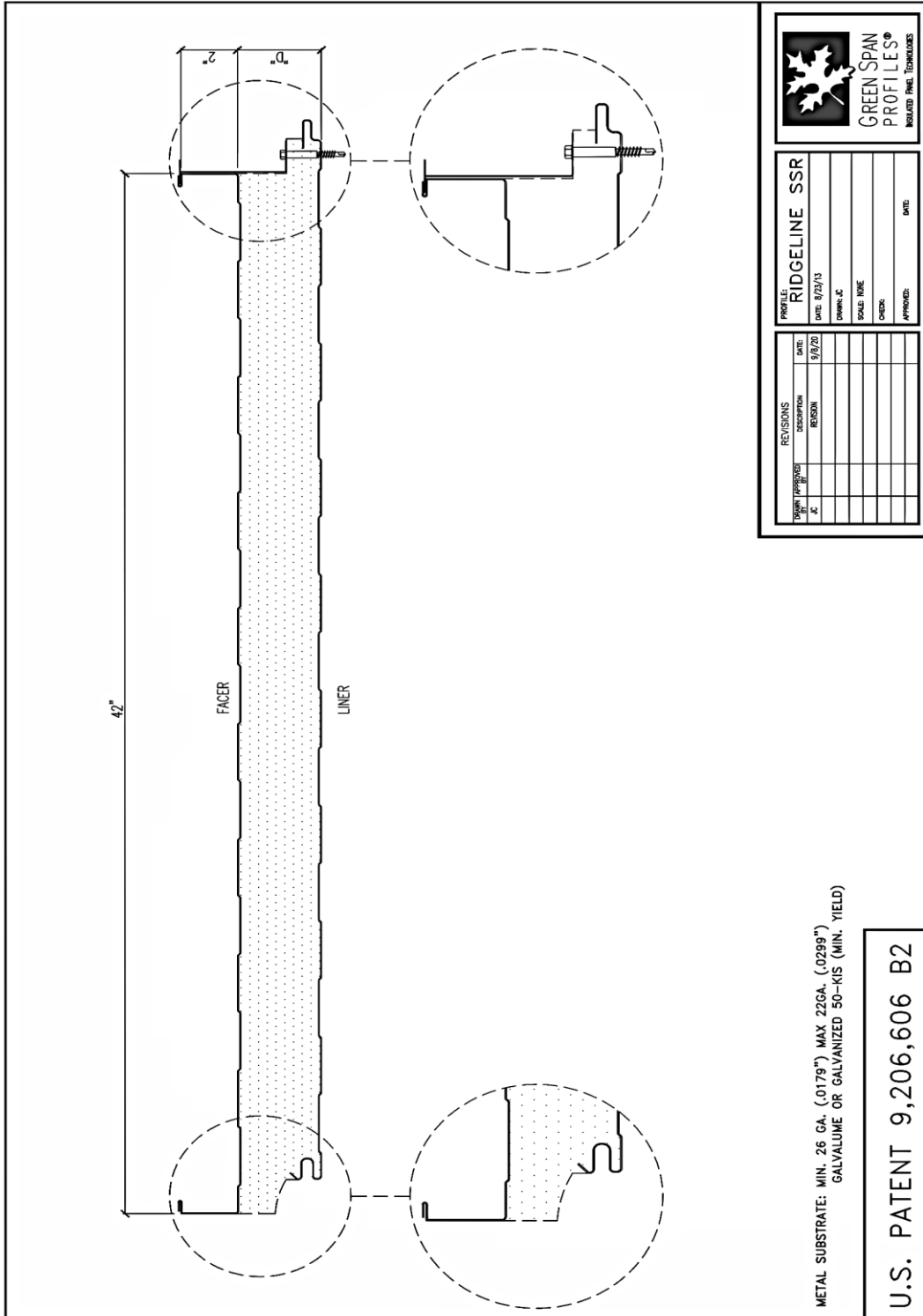

**PROFILE: RIDGELINE SSR**  
 DATE: 8/27/13  
 DRAWN BY: [blank]  
 SCALE: NONE  
 CHECKS: [blank]  
 APPROVED: [blank] DATE: [blank]

REVISIONS	DATE
DESIGN PREPARED BY: [blank]	8/9/13
DESCRIPTION: [blank]	
REVISION:	

METAL SUBSTRATE: MIN. 26 GA. (.0179") MAX 22GA. (.0299")  
 GALVALUME OR GALVANIZED 50-KIS (MIN. YIELD)

**U.S. PATENT 9,206,606 B2**

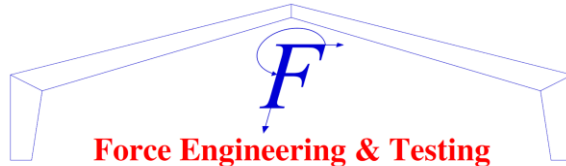

**Force Engineering & Testing**

19530 Ramblewood Drive  
Humble, Texas 77338

Phone: (281) 540-6603 FAX: (281) 540-9966  
Website: [www.forceengineeringtesting.com](http://www.forceengineeringtesting.com)

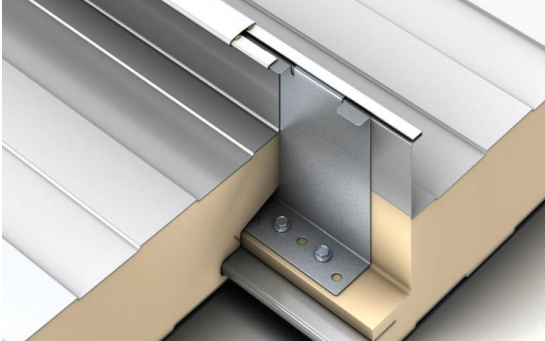

**RidgeLine Clip Attachment**

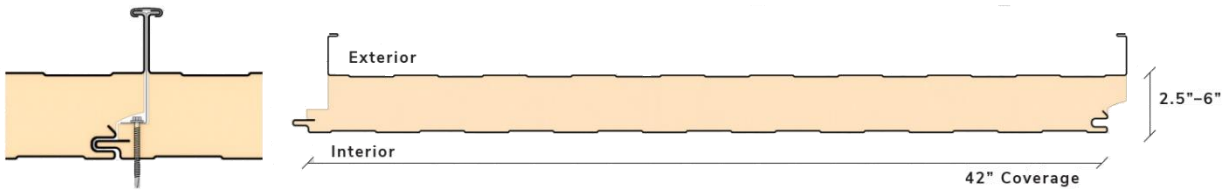

**RidgeLine Panel Profile**