

12/20/2020 10:44 PM

s:\projects\euro-wall systems\fbc-20-0927 - fbc submittal - multi slide door - 6 panels\dwgs\ews017.dwg

Euro-Wall Systems, LLC

MS-MULTISLIDE SYSTEM

(WZ3) (IMPACT)

GENERAL NOTES:

- THE PRODUCT SHOWN HEREIN IS DESIGNED AND MANUFACTURED TO COMPLY WITH THE CURRENT FLORIDA BUILDING CODE (FBC), **EXCLUDING** HVHZ AND HAS BEEN EVALUATED ACCORDING TO THE FOLLOWING:
 - TAS 201-94
 - TAS 202-94
 - TAS 203-94
- ADEQUACY OF THE EXISTING STRUCTURAL CONCRETE/MASONRY, 2X AND METAL STUD FRAMING AS A MAIN WIND FORCE RESISTING SYSTEM CAPABLE OF WITHSTANDING AND TRANSFERRING APPLIED PRODUCT LOADS TO THE FOUNDATION IS THE RESPONSIBILITY OF THE ENGINEER OR ARCHITECT OF RECORD FOR THE PROJECT OF INSTALLATION.
- 1X AND 2X BUCKS (WHEN USED) SHALL BE DESIGNED AND ANCHORED TO PROPERLY TRANSFER ALL LOADS TO THE STRUCTURE. BUCK DESIGN AND INSTALLATION IS THE RESPONSIBILITY OF THE ENGINEER OR ARCHITECT OF RECORD FOR THE PROJECT OF INSTALLATION.
- THE INSTALLATION DETAILS DESCRIBED HEREIN ARE GENERIC AND MAY NOT REFLECT ACTUAL CONDITIONS FOR A SPECIFIC SITE. IF SITE CONDITIONS CAUSE INSTALLATION TO DEVIATE FROM THE REQUIREMENTS DETAILED HEREIN, A LICENSED ENGINEER OR ARCHITECT SHALL PREPARE SITE SPECIFIC DOCUMENTS FOR USE WITH THIS DOCUMENT.
- APPROVED IMPACT PROTECTIVE SYSTEM **IS NOT REQUIRED** TO PROTECT THIS PRODUCT IN WIND ZONE 3 OR LESS.
- APPROVED IMPACT PROTECTIVE SYSTEM **IS REQUIRED** TO PROTECT THIS PRODUCT IN WIND ZONE 4.
- DOOR FRAME MATERIAL: *EXTRUDED ALUMINUM (6063-T5)*.
- GLASS MEETS THE REQUIREMENTS OF ASTM E1300 GLASS CHARTS. SEE SHEET 1 FOR GLAZING DETAILS.
- DISSIMILAR METALS INCLUDING FASTENERS THAT MAY COME INTO CONTACT WITH ALUMINUM COMPONENTS SHALL BE PROTECTED IN ACCORDANCE WITH THE FBC.

TABLE OF CONTENTS		
SHEET	REVISION	SHEET DESCRIPTION
1	-	GENERAL NOTES & GLAZING DETAILS
2	-	ELEVATIONS
3	-	ANCHOR LAYOUT
4	-	QUALIFIED CONFIGURATIONS
5	-	DESIGN PRESSURE TABLES
6	-	VERTICAL SECTIONS
7	-	HORIZONTAL SECTIONS
8	-	ANCHOR DETAILS
9	-	INSTALLATION NOTES & ANCHOR TABLE
10	-	BILL OF MATERIALS & COMPONENTS

DESIGN PRESSURE RATING		
MAX. UNIT DIMENSIONS	DESIGN PRESSURE	MISSILE IMPACT RATING
SEE SHEET 5	SEE SHEET 5	LMI & SMI

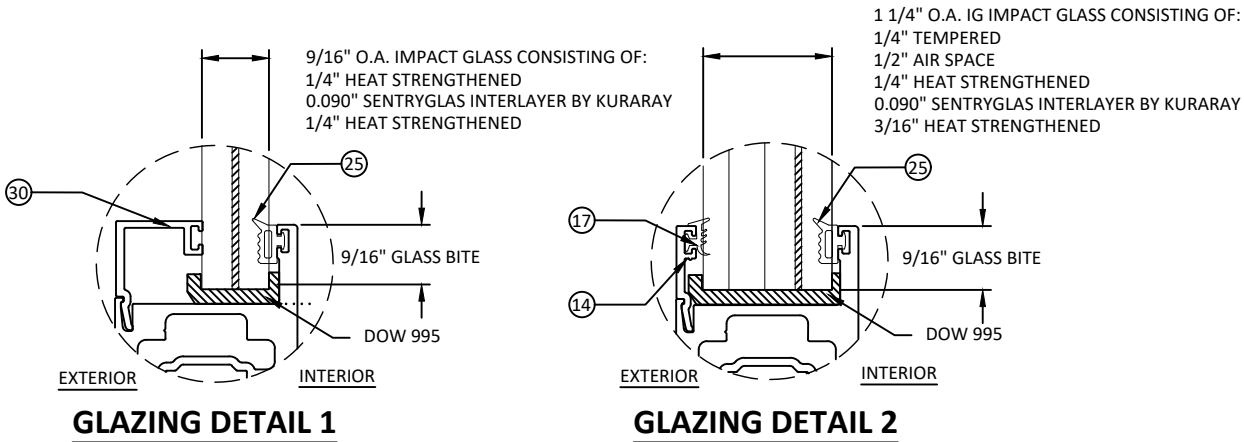

- NOTE:
- ALL GLAZING CONFIGURATIONS SHALL COMPLY WITH SAFETY GLAZING REQUIREMENTS OUTLINED IN CURRENT FBC AND ASTM E 1300 GLASS CHART REQUIREMENTS.
 - SETTING BLOCK SHOULD BE 70-90 DUROMETER AS PER CH 24 OF THE CURRENT FBC.
 - GLASS LITES THAT EXCEED 36" IN WIDTH SHALL USE SETTING BLOCKS AT $\frac{1}{4}$ SPAN FROM CORNERS.



EURO-WALL SYSTEMS, LLC
24100 TISEO BOULEVARD
PORT CHARLOTTE, FL 33980
PH: 888-989-3876

TITLE: MS MULTI-SLIDE SYSTEM (WZ3)(IMPACT)

GENERAL NOTES & GLAZING DETAILS

PREPARED BY:

BUILDING DROPS, INC.

398 E. DANIA BEACH BLVD., STE. 338
DANIA BEACH, FL 33004
PH: (954)399-8478
FAX: (954)744-4738
WEB: www.buildingdrops.com

REMARKS	BY	DATE

THE INSTALLATION DETAILS DESCRIBED HEREIN ARE GENERIC AND MAY NOT REFLECT ACTUAL CONDITIONS FOR A SPECIFIC SITE. IF SITE CONDITIONS CAUSE INSTALLATION TO DEVIATE FROM THE REQUIREMENTS DETAILED HEREIN, A LICENSED ENGINEER OR ARCHITECT SHALL PREPARE SITE SPECIFIC DOCUMENTS FOR USE WITH THIS DOCUMENT.

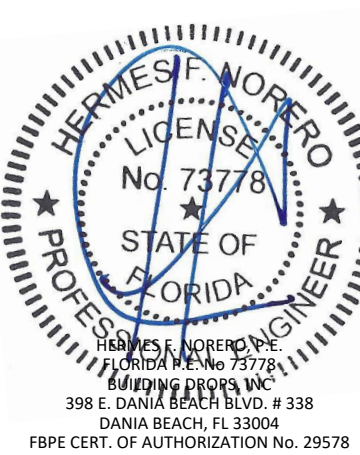

FL #:

FL34003

DATE:

11.19.20

DWG. BY:

YC

CHK. BY:

HFN

SCALE:

NTS

DWG. #:

EWS017

SHEET:

1

OF 9

12/20/2020 10:44 PM

s:\projects\euro-wall systems\fbc-20-0927 - fbc submittal - multi slide door - 6 panels\dwgs\ews017.dwg

***NOTE:**

- SEE SHEET 4 FOR QUALIFIED PANEL AND TRACKS.
- FRAME WIDTH = NUMBER OF PANELS X PANELS WIDTH
- MAX D.L.O WIDTH = PANEL WIDTH - 1.900"
- MAX D.L.O HEIGHT = PANEL HEIGHT - 6.100"

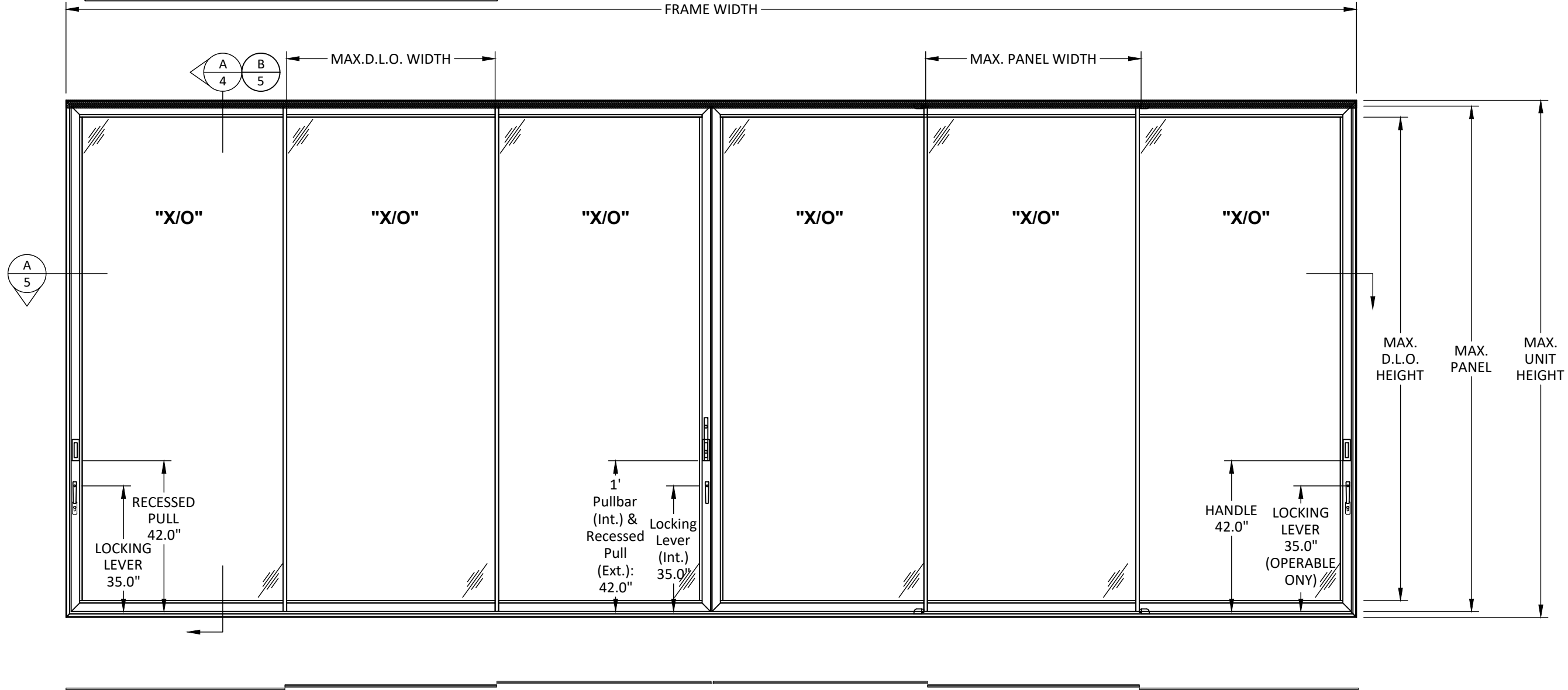

- APPROVED CONFIGURATIONS:
2 PANEL - OX, XO, XX
3 PANEL - OOX, XOO, XOX, XXO, OXX, XXX
4 PANEL - OXXO, OXXX, XXO, XXOO, XOOX, OOX, XXXX
5 PANEL - XXOO, OOOX, XXXX, OXXX, XXXXO
6 PANEL - OXXXXO, OXXXXP, XXXXXX, XXXOOO, OOOXXX, OOXOOO, XOOOOX, XXXXO, OXXXX,XXXXX
7 PANEL - XXXXXX, OXXXX, XXXXO, OXXXX
8 PANEL - OXXXXO, OXXXX, XXXXO, XXXXXX

- POCKETS ARE QUALIFY ON ANY CONFIGURATION.

- POCKETS ARE QUALIFY FOR INSTALLATION ON EITHER SIDE OF THE SYSTEM. POCKETS ARE QUALIFY TO BE USED ON BOTH SIDE AT THE SAME TIME.

TYPICAL ELEVATION

SLIDING GLASS DOOR

QUALIFIED 90 DEGREE CORNER UNIT

*CORNER UNITS ARE QUALIFIED FOR +/-55 PSF TO A MAXIMUM HEIGHT OF 120"

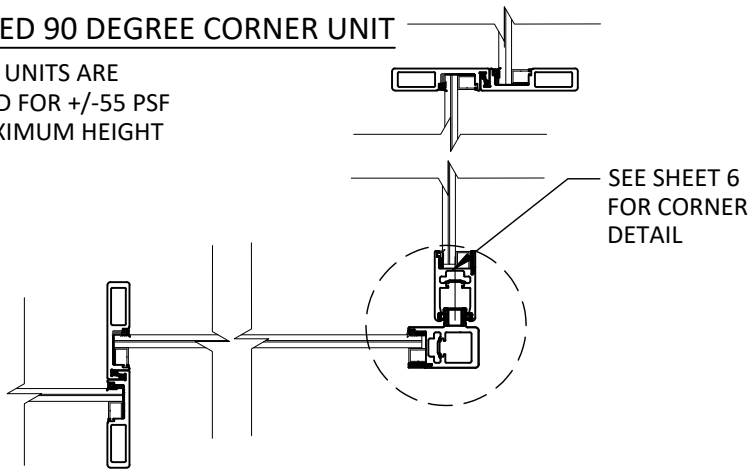

euro-wall
SUPERIOR BY DESIGN

EURO-WALL SYSTEMS, LLC
24100 TISEO BOULEVARD
PORT CHARLOTTE, FL 33980
PH: 888-989-3876

TITLE: MS MULTI-SLIDE SYSTEM
(WZ3)(IMPACT)

ELEVATION

PREPARED BY: BUILDING DROPS, INC.

398 E. DANIA BEACH BLVD, STE. 338
DANIA BEACH, FL 33004
PH: (954)399-8478
FAX: (954)744-4738
WEB: www.buildingdrops.com

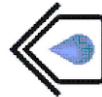

REMARKS	BY	DATE

THE INSTALLATION DETAILS DESCRIBED HEREIN ARE GENERIC AND MAY NOT REFLECT ACTUAL CONDITIONS FOR A SPECIFIC SITE. IF SITE CONDITIONS CAUSE INSTALLATION TO DEVIATE FROM THE REQUIREMENTS DETAILED HEREIN, A LICENSED ENGINEER OR ARCHITECT SHALL PREPARE SITE SPECIFIC DOCUMENTS FOR USE WITH THIS DOCUMENT.

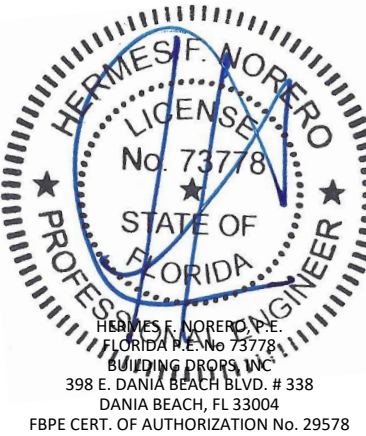

FL #:	FL34003	
DATE:	11.19.20	
DWG. BY:	YC	CHK. BY: HFN
SCALE:	NTS	
DWG. #:	EWS017	
SHEET:	2	

s:\projects\euro-wall systems\fb-20-0927 - fbc submittal - multi slide door - 6 panels\dwgs\ews017.dwg 12/20/2020 10:44 PM

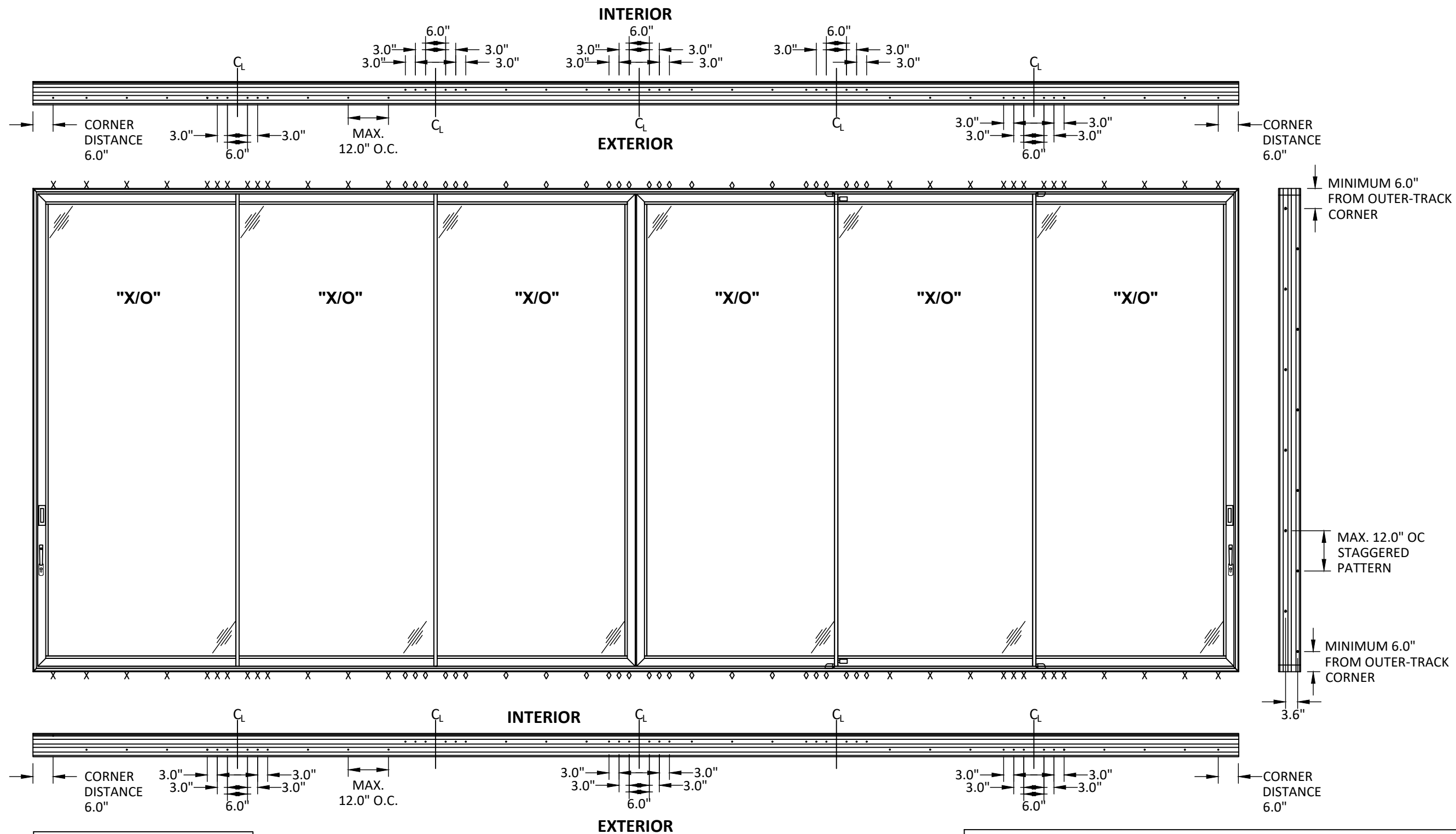

X =ANCHORS LOCATED ON THE
EXTERIOR TRACK
O =ANCHORS LOCATED ON THE
INTERIOR TRACK

TYPICAL ELEVATION
SLIDING GLASS DOOR

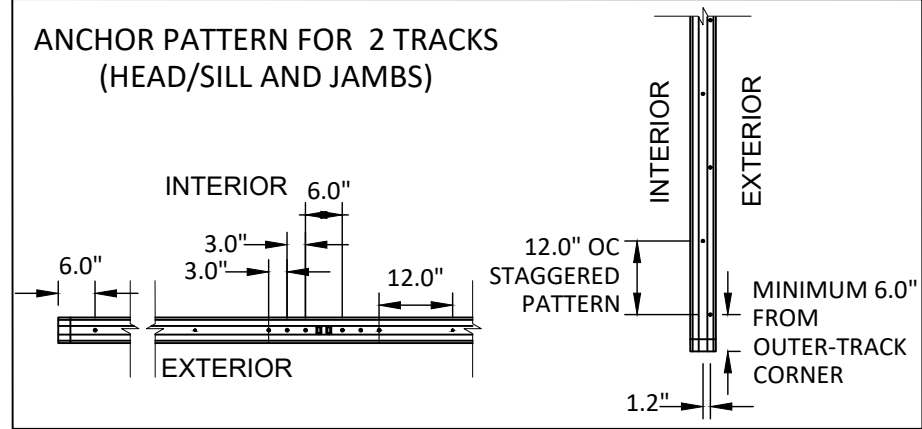

euro-wall
SUPERIOR BY DESIGN

EURO-WALL SYSTEMS, LLC
24100 TISEO BOULEVARD
PORT CHARLOTTE, FL 33980
PH: 888-989-3876

TITLE: MS MULTI-SLIDE SYSTEM
(WZ3)(IMPACT)

ANCHOR LAYOUT

PREPARED BY:

BUILDING DROPS, INC.

398 E. DANIA BEACH BLVD., STE. 338
DANIA BEACH, FL 33004
PH: (954)399-8478
FAX: (954)744-4738
WEB: www.buildingdrops.com



REMARKS	BY	DATE

THE INSTALLATION DETAILS DESCRIBED HEREIN ARE GENERIC AND MAY NOT REFLECT ACTUAL CONDITIONS FOR A SPECIFIC SITE. IF SITE CONDITIONS CAUSE INSTALLATION TO DEVIATE FROM THE REQUIREMENTS DETAILED HEREIN, A LICENSED ENGINEER OR ARCHITECT SHALL PREPARE SITE SPECIFIC DOCUMENTS FOR USE WITH THIS DOCUMENT.

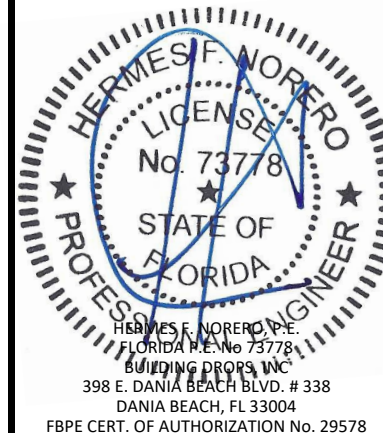

FL #:

FL34003

DATE: **11.19.20**

DWG. BY: **YC** CHK. BY: **HFN**

SCALE: **NTS**

DWG. #: **EWS017**

SHEET:

3

OF 9

12/20/2020 10:44 PM

s:\projects\euro-wall systems\fbc-20-0927 - fbc submittal - multi slide door - 6 panels\dwgs\ews017.dwg

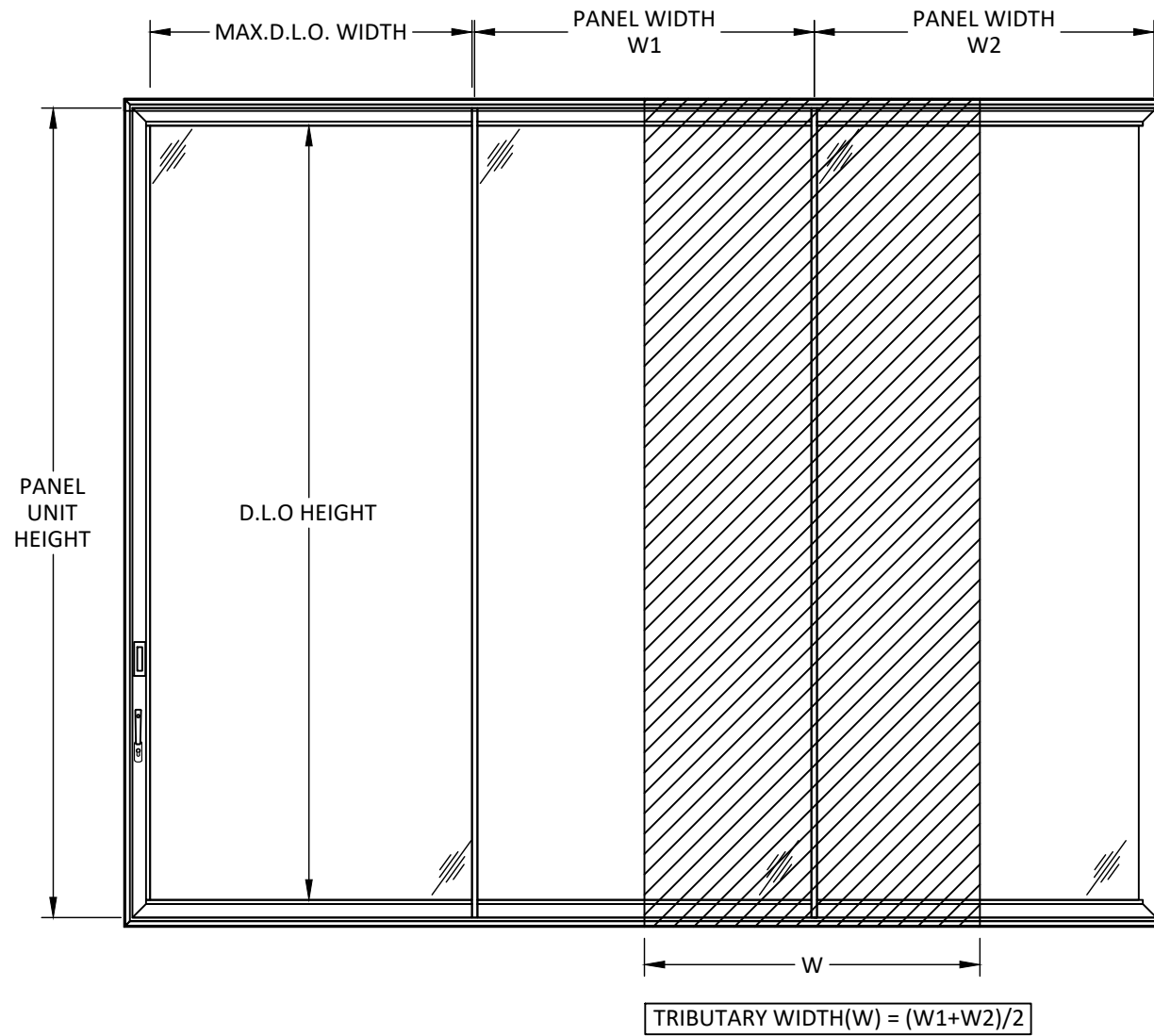

DESIGN PRESSURE TABLE (PSF)															
TRIBUTARY WIDTH (INCHES)															
PANEL HEIGHT (INCHES)		45	48	51	54	57	60	63	66	69	72	75	78	81	84
	90	120.0	120.0	120.0	120.0	120.0	120.0	120.0	120.0	120.0	120.0	120.0	120.0	120.0	119.0
	96	120.0	120.0	120.0	120.0	120.0	120.0	120.0	120.0	120.0	120.0	120.0	108.0	107.0	106.0
	102	120.0	120.0	120.0	120.0	120.0	120.0	120.0	120.0	120.0	101.0	99.0	98.0	97.0	95.0
	108	120.0	120.0	120.0	120.0	120.0	120.0	120.0	120.0	95.0	93.0	91.0	89.0		
	114	120.0	120.0	120.0	120.0	120.0	120.0	120.0	89.6	87.3	85.3	83.5			
	120	120.0	120.0	120.0	120.0	120.0	120.0	85.9	83.4	81.2	79.2				
	126	120.0	120.0	117.6	112.0	107.1	83.1	80.4	78.0						
	132	113.7	107.3	101.7	96.8	81.2	78.2	75.6							
	138	99.1	93.5	88.5	79.9	76.7	73.9								
	144	87.6	83.1	79.2	75.8	72.7	70.0								
	150	79.8	75.2	71.1	67.6	64.4									
	156	70.7	66.6	63.0	59.8										
	162	63.0	59.3	56.1											
	168	56.4	53.1	50.2											

TITLE: MS MULTI-SLIDE SYSTEM
(WZ3)(IMPACT)

DESIGN PRESSURE TABLES

PREPARED BY:

BUILDING DROPS, INC.
398 E. DANIA BEACH BLVD., STE. 338
DANIA BEACH, FL 33004
PH: (954)399-8478
FAX: (954)744-4738
WEB: www.buildingdrops.com



REMARKS	BY	DATE

THE INSTALLATION DETAILS DESCRIBED HEREIN ARE GENERIC AND MAY NOT REFLECT ACTUAL CONDITIONS FOR A SPECIFIC SITE. IF SITE CONDITIONS CAUSE INSTALLATION TO DEVIATE FROM THE REQUIREMENTS DETAILED HEREIN, A LICENSED ENGINEER OR ARCHITECT SHALL PREPARE SITE SPECIFIC DOCUMENTS FOR USE WITH THIS DOCUMENT.

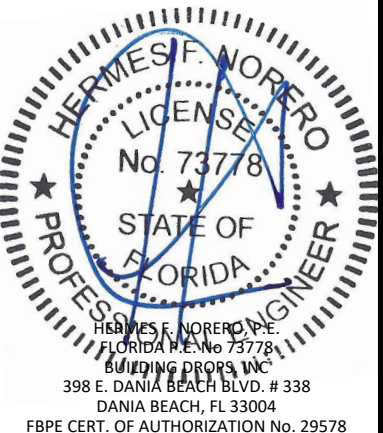

FL #: **FL34003**

DATE: **11.19.20**

DWG. BY: YC	CHK. BY: HFN
-----------------------	------------------------

SCALE: **NTS**

DWG. #: **EWS017**

SHEET:

12/20/2020 10:44 PM

s:\projects\euro-wall systems\fbc-20-0927 - fbc submittal - multi slide door - 6 panels\dwgs\ews017.dwg

*NOTE:
9/16" LAMINATED GLASS SHOWN
1-1/4" INSULATED GLASS ALSO QUALIFY

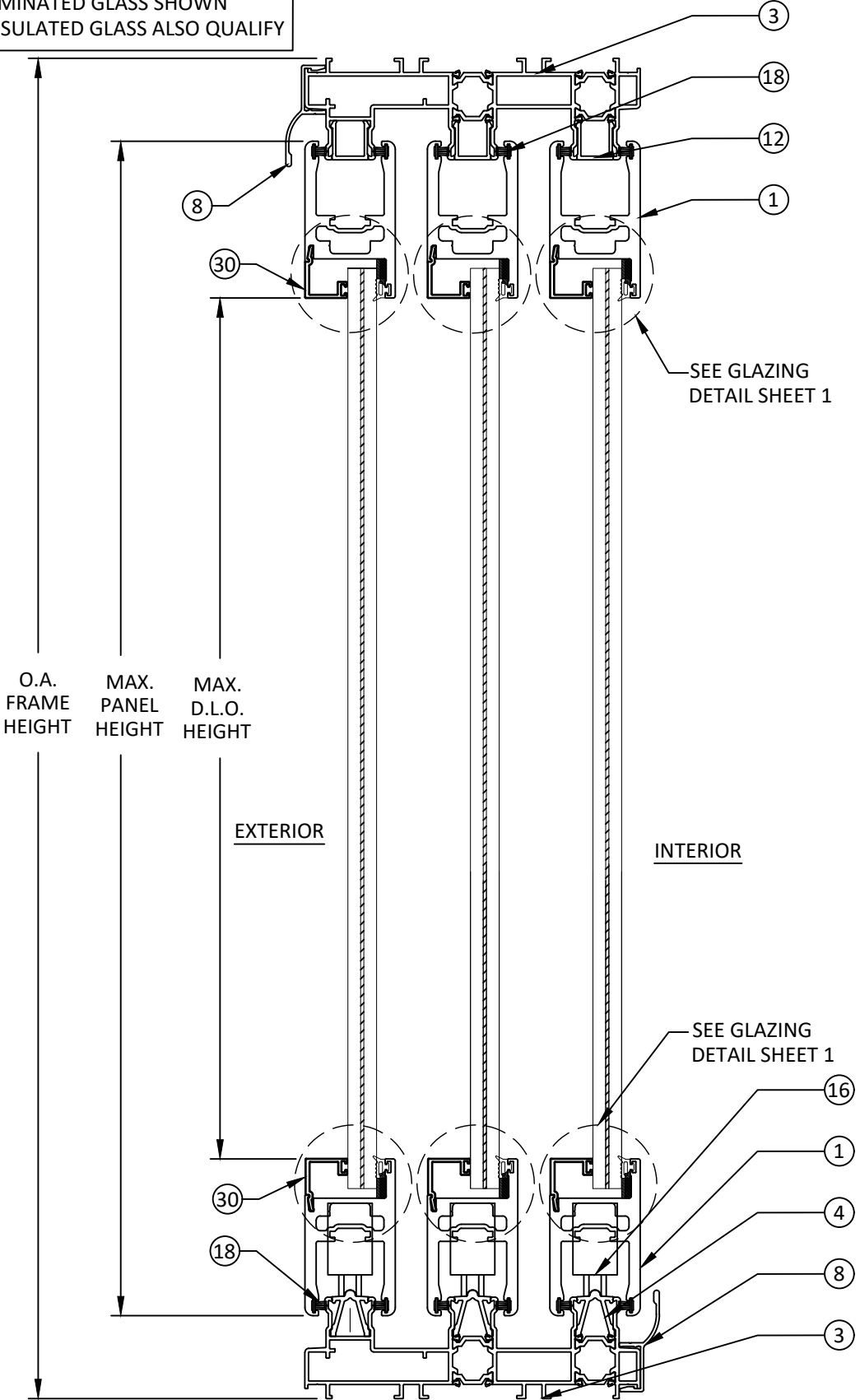

A
5

VERTICAL SECTION
SLIDING GLASS DOOR
3 TRACKS

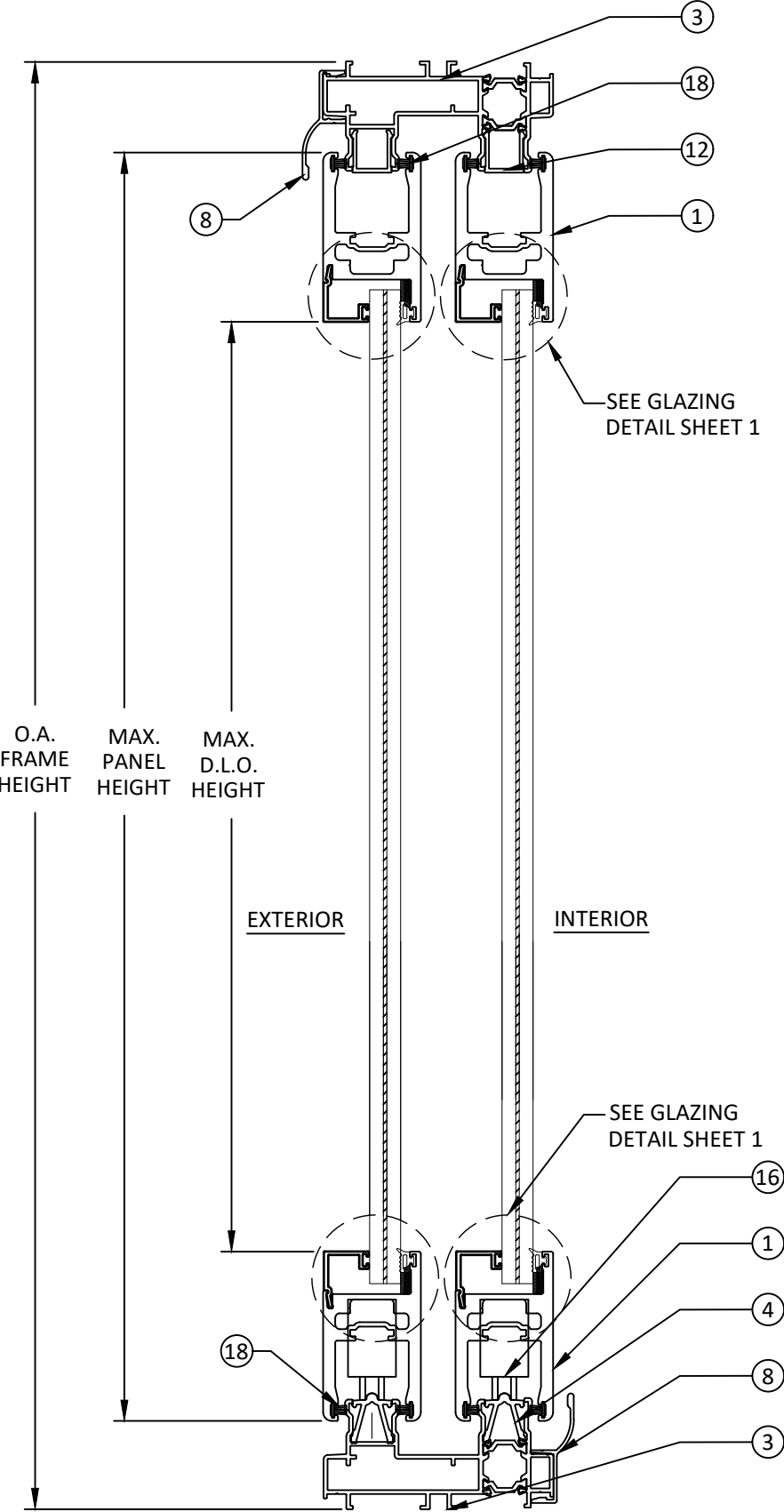

B
5

VERTICAL SECTION
SLIDING GLASS DOOR
2 TRACK

euro-wall
SUPERIOR BY DESIGN

EURO-WALL SYSTEMS, LLC
24100 TISEO BOULEVARD
PORT CHARLOTTE, FL 33980
PH: 888-989-3876

TITLE: MS MULTI-SLIDE SYSTEM
(WZ3)(IMPACT)

VERTICAL SECTIONS

PREPARED BY:
BUILDING DROPS, INC.
398 E. DANIA BEACH BLVD., STE. 338
DANIA BEACH, FL 33004
PH: (954)399-8478
FAX: (954)744-4738
WEB: www.buildingdrops.com



REMARKS	BY	DATE

THE INSTALLATION DETAILS DESCRIBED HEREIN ARE GENERIC AND MAY NOT REFLECT ACTUAL CONDITIONS FOR A SPECIFIC SITE. IF SITE CONDITIONS CAUSE INSTALLATION TO DEVIATE FROM THE REQUIREMENTS DETAILED HEREIN, A LICENSED ENGINEER OR ARCHITECT SHALL PREPARE SITE SPECIFIC DOCUMENTS FOR USE WITH THIS DOCUMENT.

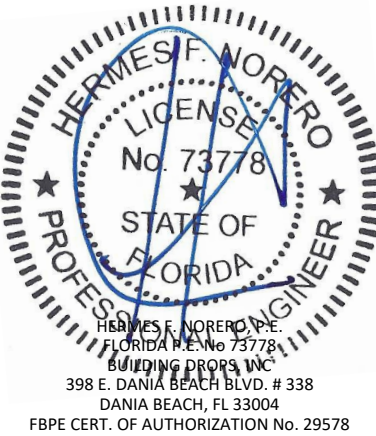

FL #:	FL34003
DATE:	11.19.20
DWG. BY:	YC
CHK. BY:	HFN
SCALE:	NTS
DWG. #:	EWS017
SHEET:	5

HORIZONTAL SECTIONS



REMARKS	BY	DATE

THE INSTALLATION DETAILS DESCRIBED HEREIN ARE GENERAL IN NATURE AND MAY NOT REFLECT ACTUAL CONDITIONS FOR A SPECIFIC SITE. IF SITE CONDITIONS CAUSE INSTALLATION TO DEVIATE FROM THE REQUIREMENTS DETAILED HEREIN, A LICENSED ENGINEER OR ARCHITECT SHALL PREPARE SITE SPECIFIC DOCUMENTS FOR USE WITH THIS DOCUMENT.

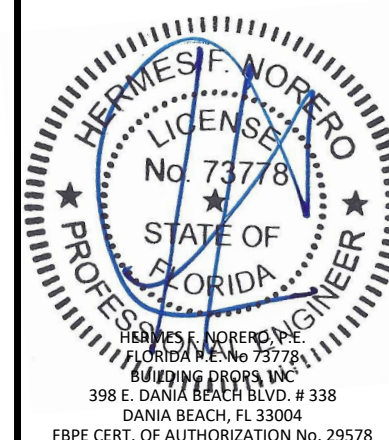

FL #:	
FL34003	
DATE: 11.19.20	
DWG. BY: YC	CHK. BY: HFN
SCALE: NTS	
DWG. #: EWS017	
SHEET:	

6

OF 9

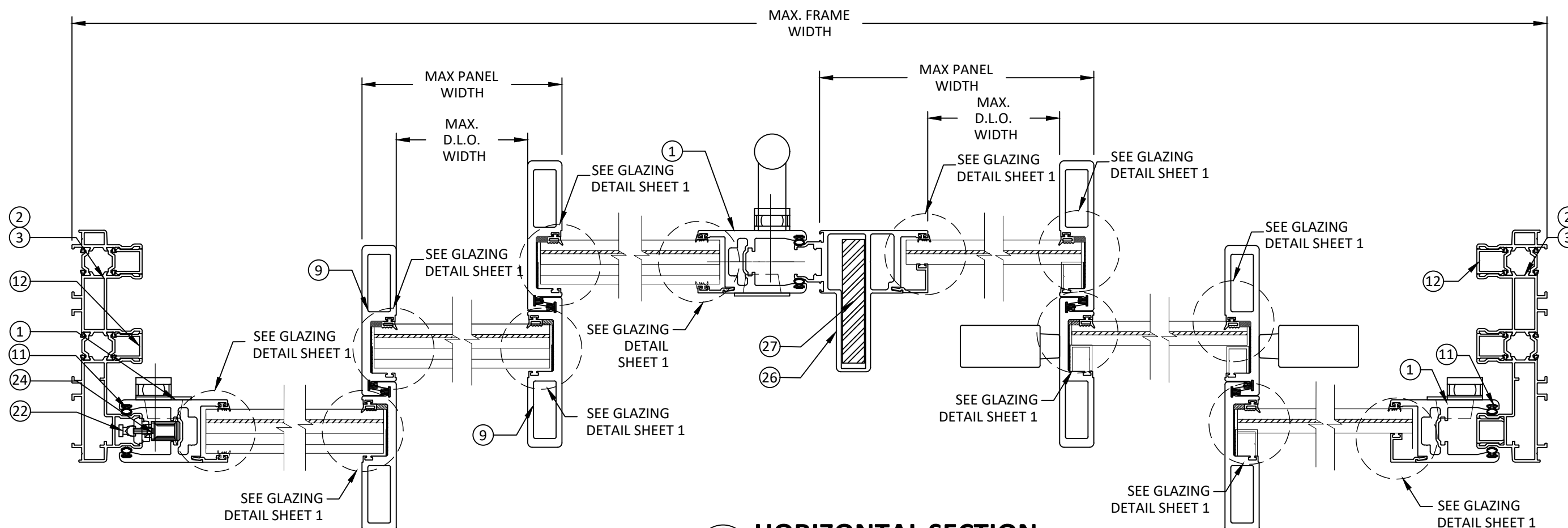

A HORIZONTAL SECTION

6 SLIDING GLASS DOOR

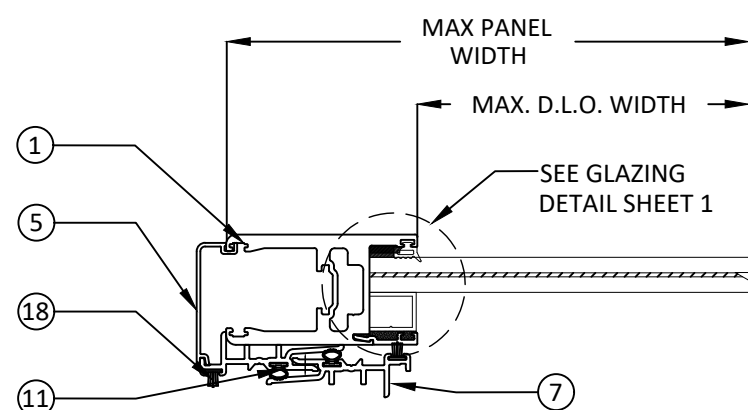

B HORIZONTAL SECTION

6 POCKET WALL

*NOTE:
9/16" LAMINATED GLASS SHOWN
1 1/4" INSULATED GLASS ALSO QUALIFY

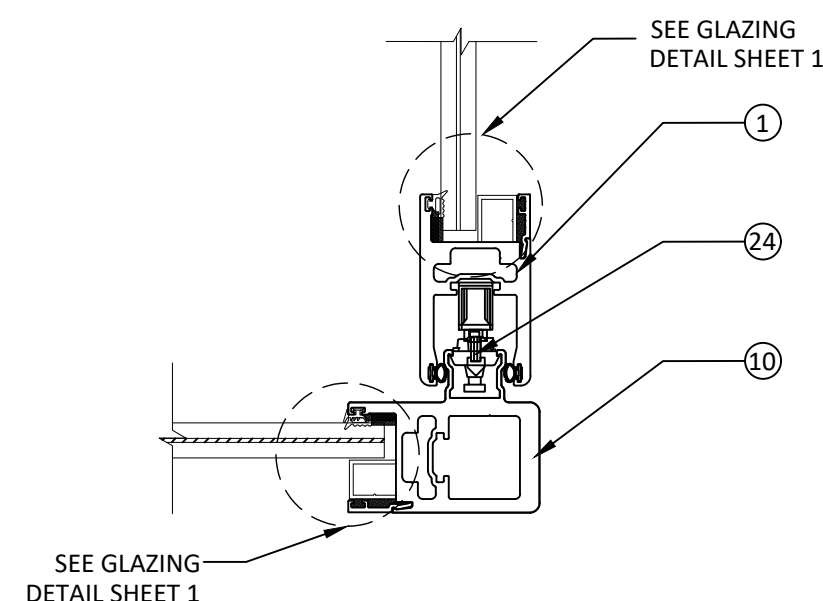

C HORIZONTAL SECTION

6 CORNER DETAIL

s:\projects\euro-wall systems\fbc-20-0927 - fbc submittal - multi slide door - 6 panels\dwgs\ews017.dwg
12/20/2020 10:44 PM

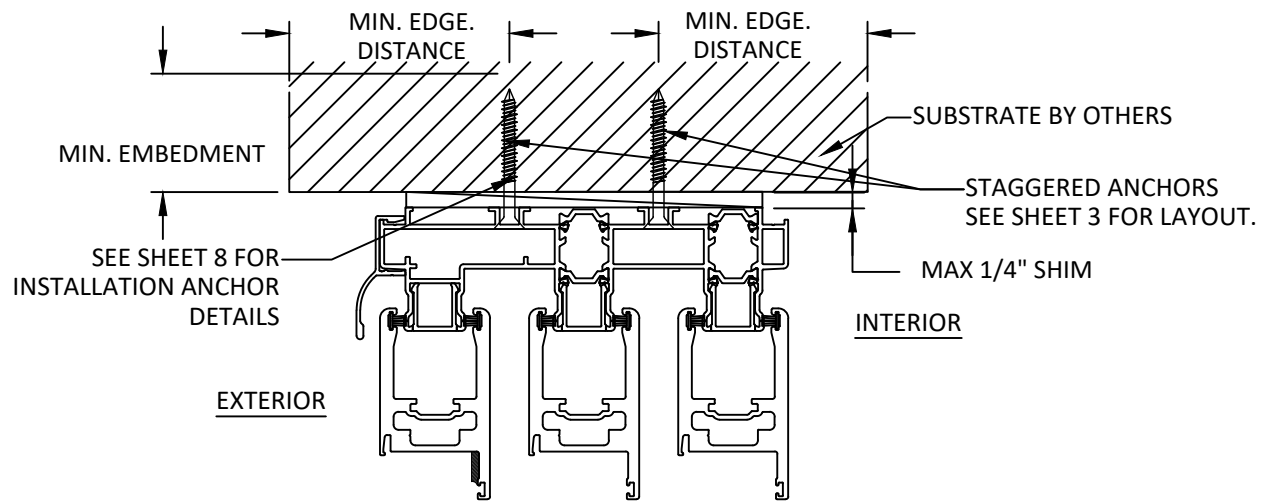

A
7 **ANCHOR DETAIL**
THROUGH FRAME INSTALLATION (HEAD)
3 TRACKS

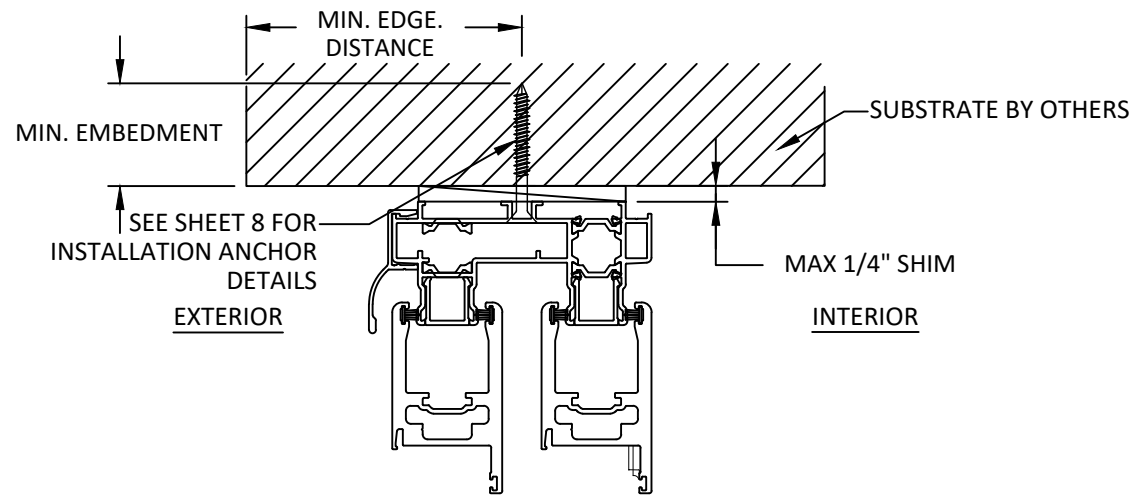

C
7 **ANCHOR DETAIL**
THROUGH FRAME INSTALLATION (HEAD)
2 TRACKS

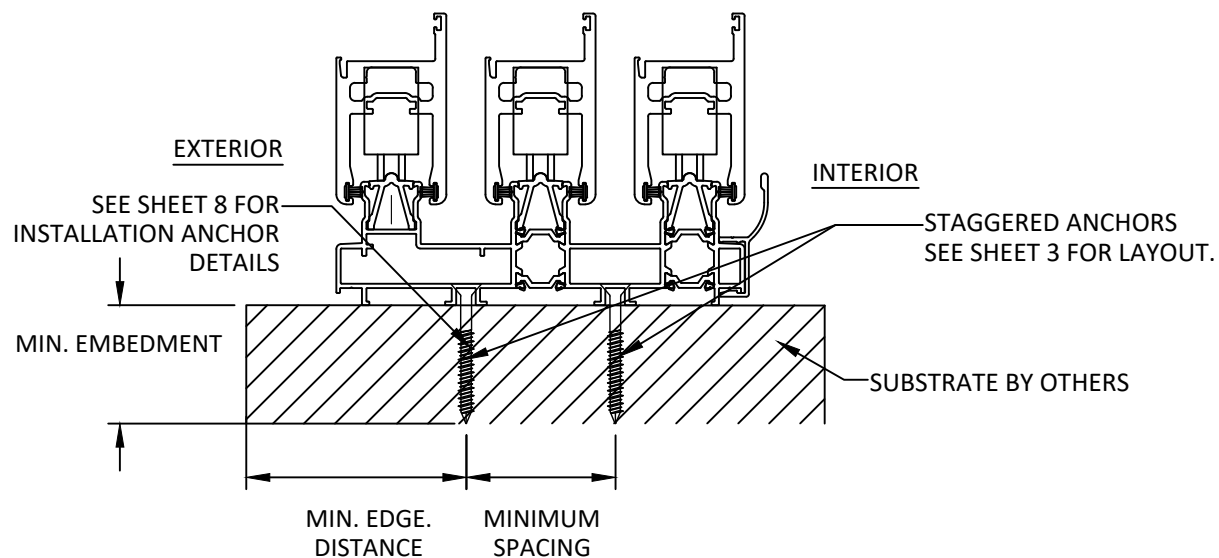

B
7 **ANCHOR DETAIL**
THROUGH FRAME INSTALLATION (SILL)
3 TRACKS

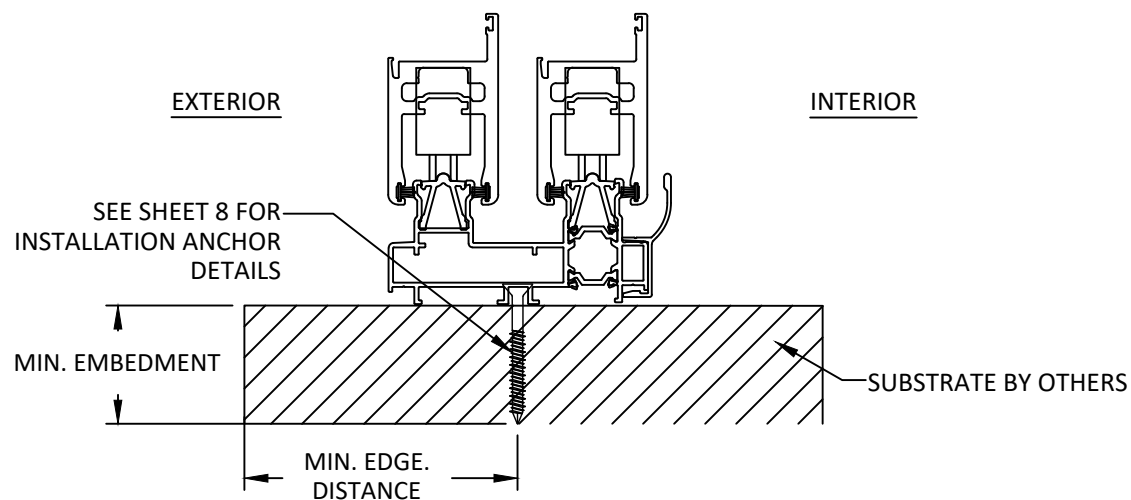

D
7 **ANCHOR DETAIL**
THROUGH FRAME INSTALLATION (HEAD)
2 TRACKS

TITLE: MS MULTI-SLIDE SYSTEM
(WZ3)(IMPACT)

ANCHOR SCHEDULE

PREPARED BY: BUILDING DROPS, INC.

398 E. DANIA BEACH BLVD., STE. 338
DANIA BEACH, FL 33004
PH: (954) 399-8478
FAX: (954) 744-4738
WEB: www.buildingdrops.com

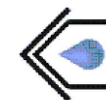

REMARKS	BY	DATE

THE INSTALLATION DETAILS DESCRIBED HEREIN ARE GENERIC AND MAY NOT REFLECT ACTUAL CONDITIONS FOR A SPECIFIC SITE. IF SITE CONDITIONS CAUSE INSTALLATION TO DEVIATE FROM THE REQUIREMENTS DETAILED HEREIN, A LICENSED ENGINEER OR ARCHITECT SHALL PREPARE SITE SPECIFIC DOCUMENTS FOR USE WITH THIS DOCUMENT.

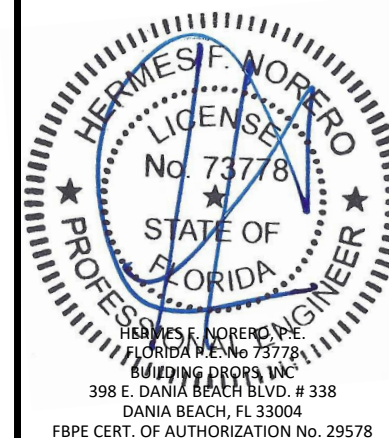

FL #:	FL34003	
DATE:	11.19.20	
DWG. BY:	YC	CHK. BY: HFN
SCALE:	NTS	
DWG. #:	EWS017	
SHEET:	7	

12/20/2020 10:44 PM

s:\projects\euro-wall systems\fbc-20-0927 - fbc submittal - multi slide door - 6 panels\dwgs\ews017.dwg

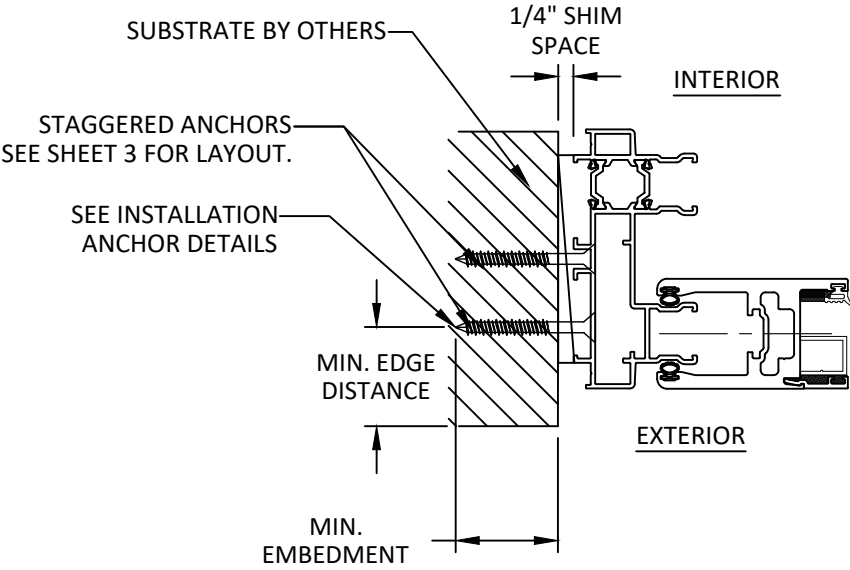

A
8 **ANCHOR DETAIL**
THROUGH FRAME (JAMB)
2 TRACK

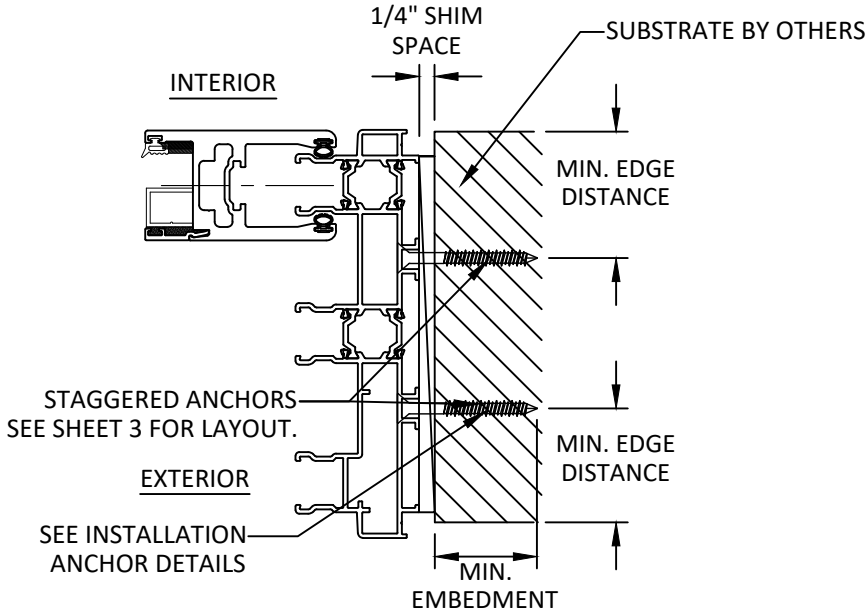

B
8 **ANCHOR DETAIL**
THROUGH FRAME (JAMB)
3 TRACK

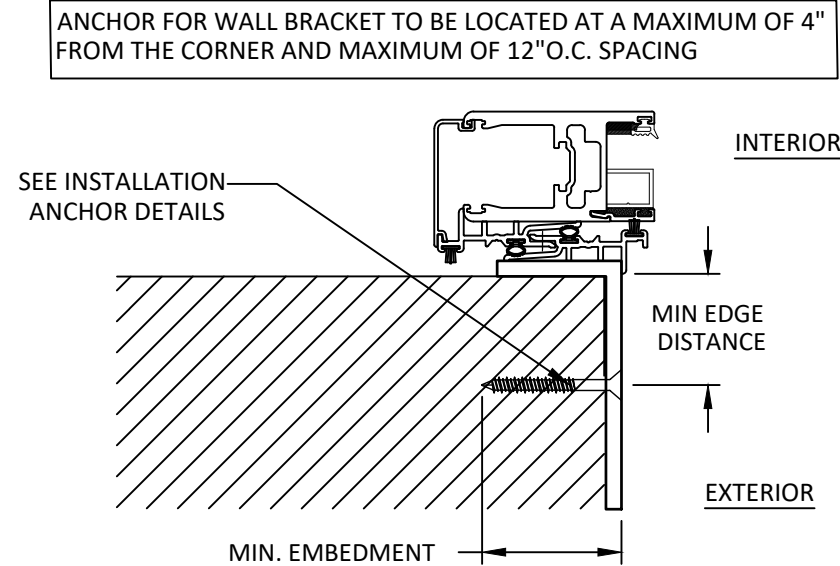

C
8 **ANCHOR DETAIL**
POCKET BRACKET INSTALLATION

INSTALLATION NOTES:

- ONE (1) INSTALLATION ANCHOR IS REQUIRED AT EACH ANCHOR LOCATION SHOWN UNLESS SPECIFIED IN THE ANCHOR SCHEDULE. TWO (2) INSTALLATION ANCHORS AT THE JAMBS.
- THE NUMBER OF INSTALLATION ANCHORS DEPICTED IS THE MINIMUM NUMBER OF ANCHORS TO BE USED FOR PRODUCT INSTALLATION OF THE MAXIMUM SIZE LISTED.
- INSTALL INDIVIDUAL INSTALLATION ANCHORS WITHIN A TOLERANCE OF $\pm 1/2$ INCH THE DEPICTED LOCATION & SPACING IN THE ANCHOR LAYOUT DETAILS (I.E., WITHOUT CONSIDERATION OF TOLERANCES). TOLERANCES ARE NOT CUMULATIVE FROM ONE INSTALLATION ANCHOR TO THE NEXT.
- SHIM AS REQUIRED AT EACH INSTALLATION ANCHOR WITH LOAD BEARING SHIM(S). MAXIMUM ALLOWABLE SHIM STACK TO BE 1/4 INCH. SHIM WHERE SPACE OF 1/16 INCH OR GREATER OCCURS. SHIM(S) SHALL BE CONSTRUCTED OF HIGH DENSITY PLASTIC OR BETTER.
- FOR MASONRY OR CONCRETE OPENINGS, 1X WOOD BUCK MAY BE USED (OPTIONAL AS LONG AS THE MINIMUM EMBEDMENT AND EDGE DISTANCE REQUIREMENTS ARE STILL MET WITHIN THE CORRESPONDING HOST SUBSTRATE.) SEE GENERAL NOTE #3 ON SHEET 1 FOR MORE INFORMATION.
- MINIMUM EMBEDMENT AND EDGE DISTANCE EXCLUDE WALL FINISHES, INCLUDING BUT NOT LIMITED TO STUCCO, FOAM, BRICK VENEER, AND SIDING.
- INSTALLATION ANCHORS AND ASSOCIATED HARDWARE MUST BE MADE OF CORROSION RESISTANT MATERIAL OR HAVE A CORROSION RESISTANT COATING.
- FOR HOLLOW BLOCK AND GROUT FILLED BLOCK, DO NOT INSTALL INSTALLATION ANCHORS INTO MORTAR JOINTS. EDGE DISTANCE IS MEASURED FROM FREE EDGE OF BLOCK OR EDGE OF MORTAR JOINT INTO FACE SHELL OF BLOCK.
- INSTALLATION ANCHORS SHALL BE INSTALLED IN ACCORDANCE WITH ANCHOR MANUFACTURER'S INSTALLATION INSTRUCTIONS, AND ANCHORS SHALL NOT BE USED IN SUBSTRATES WITH STRENGTHS LESS THAN THE MINIMUM STRENGTH SPECIFIED BY THE ANCHOR MANUFACTURER.

ANCHOR SCHEDULE				
METHOD	SUBSTRATE	ANCHOR SCHEDULE	MIN EMBEDMENT	MIN. EDGE DISTANCE
THROUGH FRAME	WOOD: MIN. SG = 0.55	#14 WOOD SCREW	1.5"	0.75"
	METAL: 18 GAUGE STEEL, MIN. Fy = 33KSI	#12 SELF DRILLING OR SELF TAPPING SCREW	3 THREADS MIN PENETRATION BEYOND METAL	0.50"
	METAL: 1/8" MIN. THICKENS ALUMINUM MIN. 6063-T5			
	CONCRETE: f'c=3000PSI	1/4" ITW TAPCON	1.25"	2.00"
	MASONRY: CMU per ASTM C90	1/4" ITW TAPCON	1.25"	2.00"

euro-wall
SUPERIOR BY DESIGN

EURO-WALL SYSTEMS, LLC
24100 TISEO BOULEVARD
PORT CHARLOTTE, FL 33980
PH: 888-989-3876

TITLE: MS MULTI-SLIDE SYSTEM
(WZ3)(IMPACT)

INSTALLATION NOTES & ANCHOR TABLE

PREPARED BY:

BUILDING DROPS, INC.

398 E. DANIA BEACH BLVD., STE. 338
DANIA BEACH, FL 33004
PH: (954)399-8478
FAX: (954)744-4738
WEB: www.buildingdrops.com



REMARKS	BY	DATE

THE INSTALLATION DETAILS DESCRIBED HEREIN ARE GENERIC AND MAY NOT REFLECT ACTUAL CONDITIONS FOR A SPECIFIC SITE. IF SITE CONDITIONS CAUSE INSTALLATION TO DEVIATE FROM THE REQUIREMENTS DETAILED HEREIN, A LICENSED ENGINEER OR ARCHITECT SHALL PREPARE SITE SPECIFIC DOCUMENTS FOR USE WITH THIS DOCUMENT.

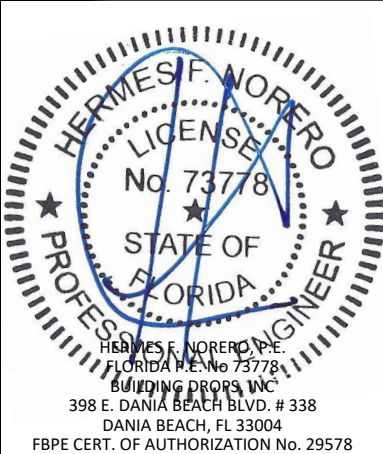

FL #: **FL34003**

DATE: **11.19.20**

DWG. BY:
YC

CHK. BY:
HFN

SCALE: **NTS**

DWG. #: **EWS017**

SHEET:

8

OF 9

12/20/2020 10:44 PM

s:\projects\euro-wall systems\fb-20-0927 - fbc submittal - multi slide door - 6 panels\dwgs\ews017.dwg

BILL OF MATERIALS			
NO	PART #	DESCRIPTION	MATERIAL
1	MS-SASH	SASH RAIL/STILE	6061-T5
2	MS-2 TRACK	2 TRACK JAMB/HEAD/SILL	6063-T5
3	MS-3 TRACK	3 TRACK JAMB/HEAD/SILL	6063-T5
4	MS-SB	SNAP TRACK	6063-T5
5	MS-SC	SASH END CAP	6063-T5
6	MS-DC	DRAIN COVER	POLYIMIDE
7	MS-ILP	POCKET INTERLOCK	6063-T5
8	MS-CON	CONDENSATION ACC	6063-T5
9	MS-SI	SASH/STILE INTERLOCK	6063-T5
10	CD-ASTRAGAL	CORNER DOOR ASTRAGAL SASH/STILE	6063-T6
11	MS-RWS	ROUND WEATHERSTRIP	POLYMER
12	MS-JHT	JAMB/ HEADER TRIM	6063-T5
13	MS-AST	ASTRAGAL	6063-T5
14	MS-GB	GLAZING BEAD	6063-T5
15	MS-RL1	ROLLER 1	KEVLAR/SS/STEEL
16	MS-RL2	ROLLER 2	KEVLAR/SS/STEEL
17	MS-GG	GLAZING GASKET	EPDM
18	MS-TWS	T-SLOT SWEEP	POLYMER
21	MS-REDUCER	REDUCER BAR	6063-T5
22	MS-PAWL-CAT	SMALL PAWL CATCHER	S/S STEEL
23	MS-LOCK	LOCKING LEVER (DEBAR)	
24	MS-PAWL	PAWL	S/S STEEL
25	CD AST BAR	9/16" GLAZING GASKET	EPDM
26	E0094-E	MS 1 PIECE ASTRAGAL	6063-T5
27	E0097-A	STEEL BAR .625"x 3.5"	STEEL
28	-	ASTRAGAL REINFORCEMENT	STEEL
29	-	LARGE PAWL CATCHER	STEEL
30	E0093-A	MS 9-16 BEAD	6063-T5

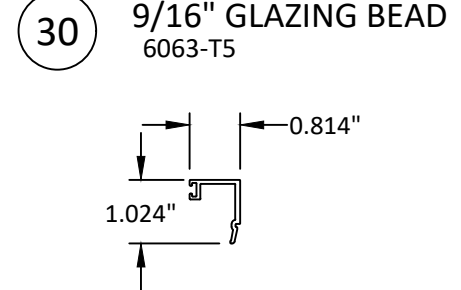
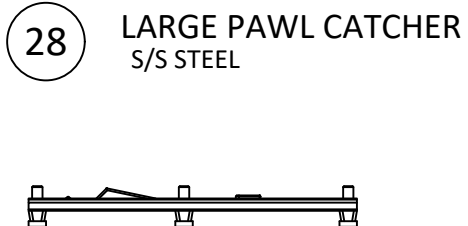
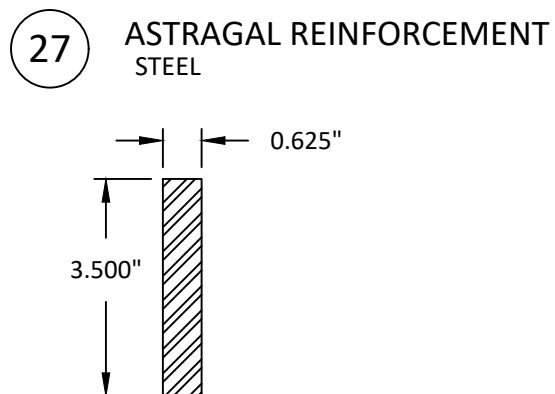
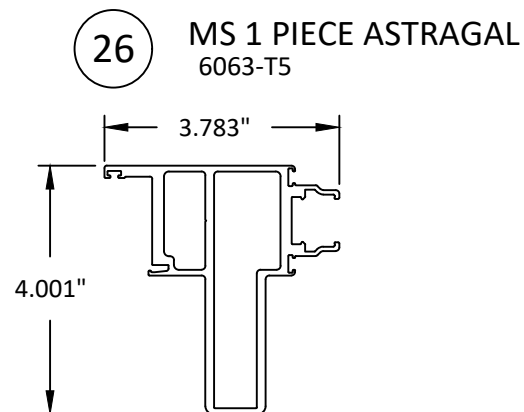
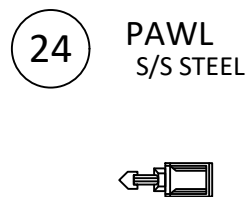
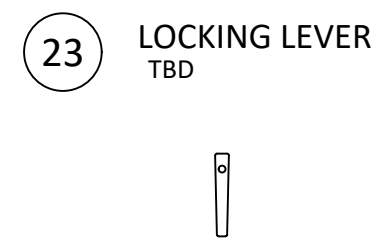
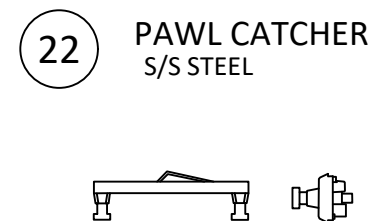
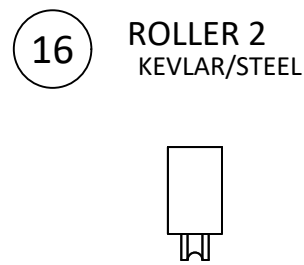
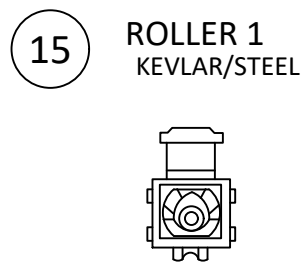
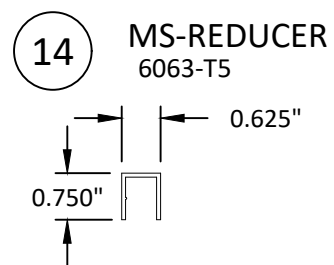
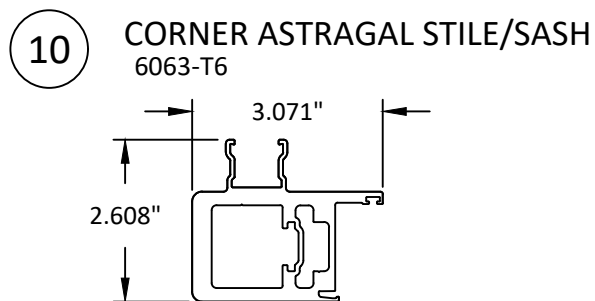
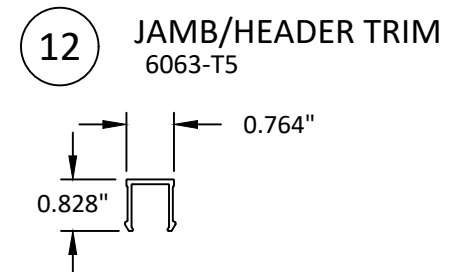
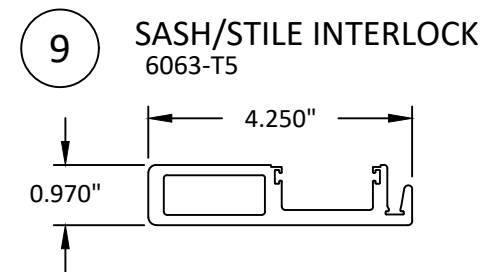
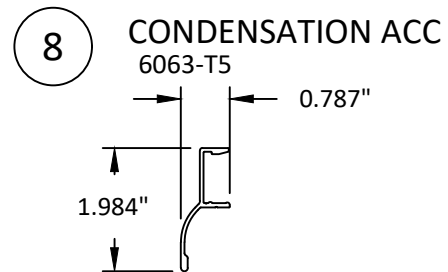
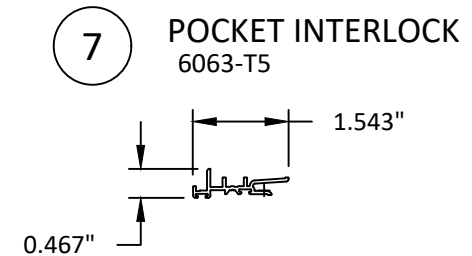
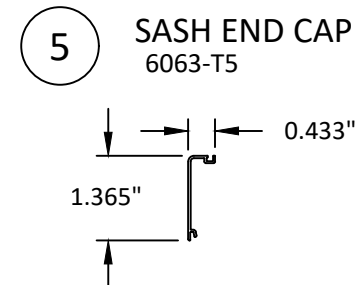
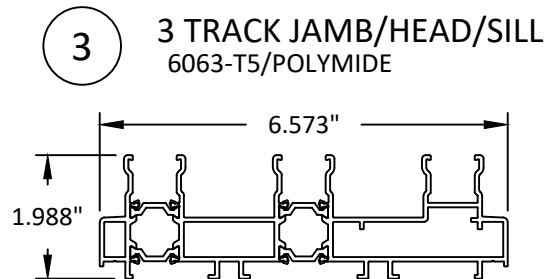
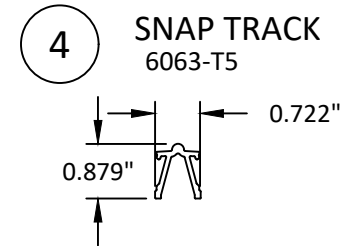
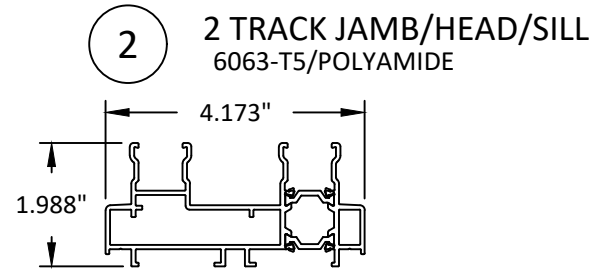
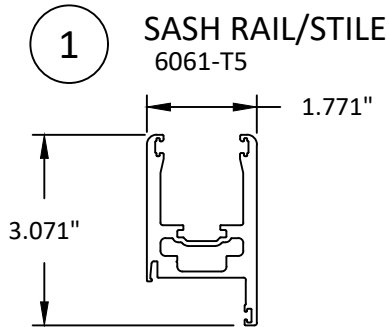

euro-wall
SUPERIOR BY DESIGN

EURO-WALL SYSTEMS, LLC
24100 TISEO BOULEVARD
PORT CHARLOTTE, FL 33980
PH: 888-989-3876

TITLE: MS MULTI-SLIDE SYSTEM
(WZ3)(IMPACT)

BILL OF MATERIALS & COMPONENTS

PREPARED BY:

BUILDING DROPS, INC.

398 E. DANIA BEACH BLVD., STE. 338
DANIA BEACH, FL 33004

PH: (954)399-8478
FAX: (954)744-4738

WEB: www.buildingdrops.com

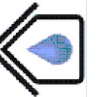

REMARKS	BY	DATE

THE INSTALLATION DETAILS DESCRIBED HEREIN ARE GENERIC AND MAY NOT REFLECT ACTUAL CONDITIONS FOR A SPECIFIC SITE. IF SITE CONDITIONS CAUSE INSTALLATION TO DEVIATE FROM THE REQUIREMENTS DETAILED HEREIN, A LICENSED ENGINEER OR ARCHITECT SHALL PREPARE SITE SPECIFIC DOCUMENTS FOR USE WITH THIS DOCUMENT.

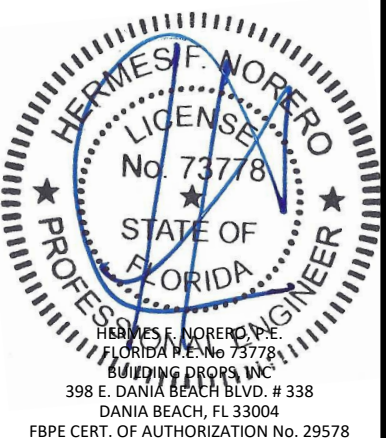

FL #:	FL34003
DATE:	11.19.20
DWG. BY:	YC
CHK. BY:	HFN
SCALE:	NTS
DWG. #:	EWS017
SHEET:	9