

# Oldcastle BuildingEnvelope®

## FG-5750T STORMMAX® STOREFRONT

### THERMAL IGU IMPACT STOREFRONT SYSTEM

#### LARGE AND SMALL MISSILE (WET AND DRY GLAZED)

#### FOR HIGH VELOCITY HURRICANE ZONES

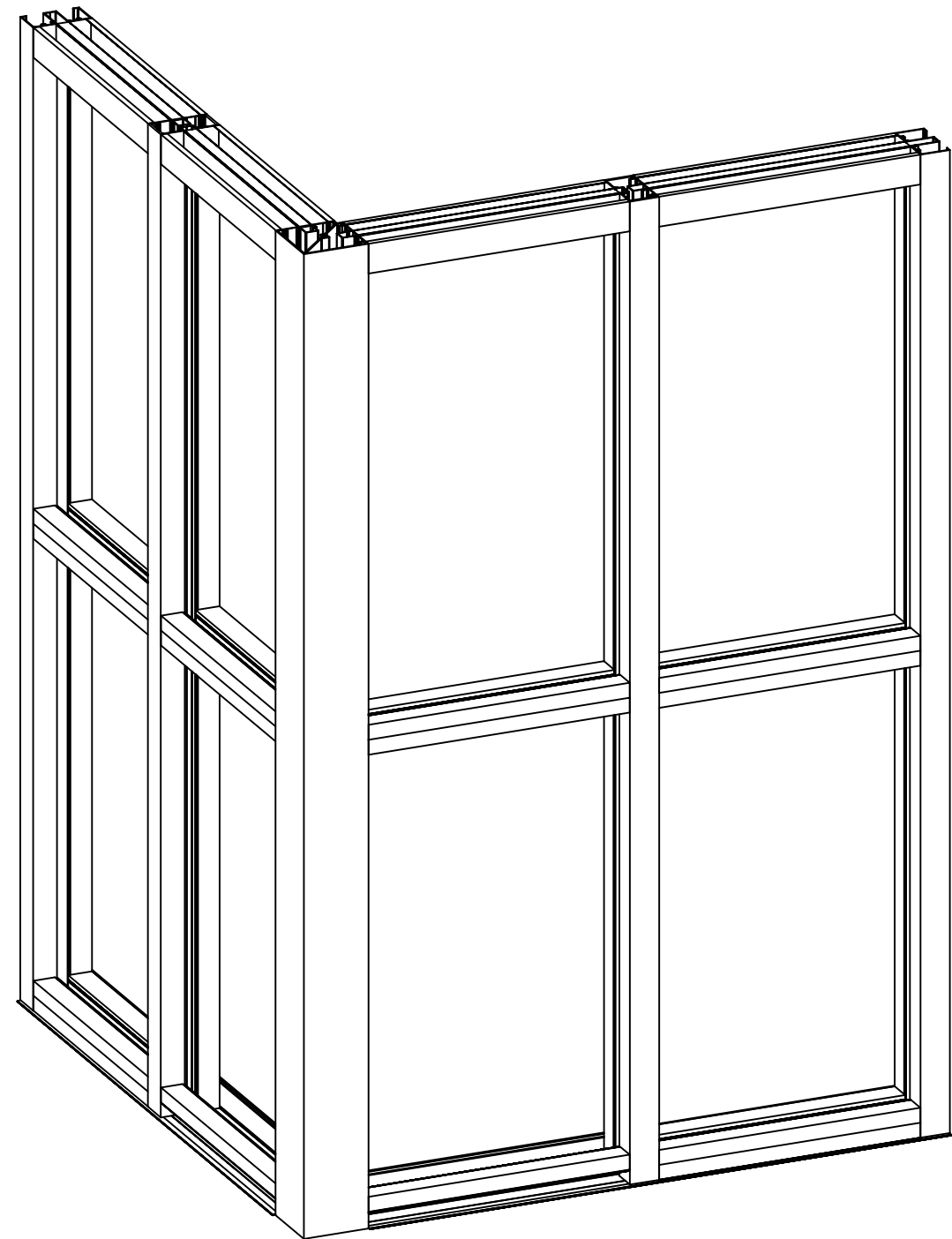

### GENERAL NOTES:

- THIS SYSTEM AND GLASS TYPES DESCRIBED HEREIN COMPLY AND HAVE BEEN DESIGNED AND TESTED IN ACCORDANCE WITH THE FLORIDA BUILDING CODE SEVENTH EDITION (2020) PER
  - ASTM E330-14, E331-00, E283-04
  - TAS 201 / 202 / 203
  - AAMA 501-5
  - ANSI Z97.1-2015 (400 ft-lb. IMPACT)
  - ALUMINUM DESIGN MANUAL 2015, ASCE 7-16
- SITE-SPECIFIC REQUIRED DESIGN PRESSURES SHALL BE CALCULATED BY A LICENSED PROFESSIONAL ENGINEER FOR USE WITH THIS DOCUMENT PER CURRENT ADOPTED EDITION OF ASCE 7 AND WITH LOCAL CODE REQUIREMENTS.
- FOR USE WITHIN AND OUTSIDE THE HIGH VELOCITY HURRICANE ZONE (HVHZ).
- DESIGN PRESSURES NOTED HEREIN ARE BASED ON MAXIMUM TESTED PRESSURES DIVIDED BY A 1.5 SAFETY FACTOR.
- NO 33-1/3% INCREASE IN ALLOWABLE STRESS HAS BEEN USED IN THE DESIGN OF THIS SYSTEM. WIND LOAD DURATION FACTOR Cd=1.6 HAS BEEN USED FOR WOOD ANCHOR DESIGN.
- THE ARCHITECT/ENGINEER OF RECORD FOR THE PROJECT SUPERSTRUCTURE WITH WHICH THIS DESIGN IS USED SHALL BE RESPONSIBLE FOR THE INTEGRITY OF ALL SUPPORTING SURFACES TO THIS DESIGN WHICH SHALL BE COORDINATED BY THE PERMITTING CONTRACTOR. WOOD BUCKS (BY OTHERS) SHALL BE ANCHORED PROPERLY TO TRANSFER LOADS TO THE EXISTING STRUCTURE.
- THE SYSTEM DETAILED HEREIN IS GENERIC AND DOES NOT PROVIDE INFORMATION FOR A SPECIFIC SITE. FOR SITE CONDITIONS DIFFERENT FROM THE CONDITIONS DETAILED HEREIN, A LICENSED ENGINEER OR REGISTERED ARCHITECT SHALL PREPARE SITE SPECIFIC DOCUMENTS FOR USE IN CONJUNCTION WITH THIS DOCUMENT.
- THE CONTRACTOR IS RESPONSIBLE TO INSULATE ALL MEMBERS FROM DISSIMILAR MATERIALS TO PREVENT ELECTROLYSIS.
- FASTENERS SHALL BE CADMIUM-PLATED OR OTHERWISE CORROSION-RESISTANT MATERIAL AND SHALL COMPLY WITH "SPECIFICATIONS FOR ALUMINUM STRUCTURES" SECTION J.3.7.2 BY THE ALUMINUM ASSOCIATION, INC., & ANY APPLICABLE FEDERAL, STATE, AND/OR LOCAL CODES
- ENGINEER SEAL AFFIXED HERE TO VALIDATES STRUCTURAL DESIGN AS SHOWN ONLY. USE OF THIS SPECIFICATION BY CONTRACTOR, et. al. INDEMNIFIES & SAVES HARMLESS THIS ENGINEER FOR ALL COST & DAMAGES INCLUDING LEGAL FEES & APPELLATE FEES RESULTING FROM MATERIAL FABRICATION, SYSTEM ERECTION, & CONSTRUCTION PRACTICES BEYOND THAT WHICH IS CALLED FOR BY LOCAL, STATE, & FEDERAL CODES & FROM DEVIATIONS OF THIS PLAN.
- EXCEPT AS EXPRESSLY PROVIDED HEREIN, NO ADDITIONAL CERTIFICATIONS OR AFFIRMATIONS ARE INTENDED.
- PRESSURE VALUES ON THIS APPROVAL ARE (ASD) ALLOWABLE DESIGN PRESSURES.
- ALTERATIONS, ADDITIONS, OR OTHER MARKINGS TO THIS DOCUMENT ARE NOT PERMITTED AND INVALIDATE THIS CERTIFICATION.
- SAFEGUARDS MUST BE OBSERVED (NOT IN THIS CERTIFICATION)
- PRODUCT SHALL BE PERMANENTLY LABELED WITH A MINIMUM OF ONE LABEL PER SYSTEM CONTAINING THE FOLLOWING:  
 Oldcastle BuildingEnvelope®  
 803 AIRPORT ROAD  
 TERRELL, TEXAS 75160  
 TAS 201/202/203

SHEET INDEX	
# SHEET	DESCRIPTION
01	COVER SHEET
02-03	ELEVATIONS
04-05	GLAZING DETAILS
06-11	GLASS LOADING TABLES
12	MULLION & JAMB LOADING DETERMINATION
13-16	MULLION LOADING CHARTS
17-26	FASTENER SCHEDULE AND ANCHOR CHARTS
27-33	STANDARD FRAMING DETAILS
34-36	PART DRAWINGS
37-38	BILL OF MATERIALS
38	TOTAL

### DESIGN PRESSURE

WATER INFILTRATION 15 PSF  
 AIR INFILTRATION 6.24 PSF  
 MAXIMUM DESIGN PRESSURE = +/- 75 PSF

ALL ALUMINUM EXTRUSIONS SHALL BE MADE FROM 6063-T6 ALLOY AND TEMPER.

THIS PRODUCT HAS BEEN DESIGNED, ENGINEERED AND TESTED TO COMPLY WITH CURRENT FLORIDA BUILDING CODE.

MATERIALS, INCLUDING BUT NOT LIMITED TO STEEL SCREWS, THAT COME IN CONTACT WITH OTHER DISSIMILAR MATERIALS SHALL MEET THE REQUIREMENTS OF CURRENT FLORIDA BUILDING CODE.

VISIT [ECALC.IO/2029229h](http://ECALC.IO/2029229h) **SCAN HERE:**

FOR HELPFUL RESOURCES, SITE SPECIFIC JOB ORDERING & MORE INFORMATION ABOUT THIS PRODUCT & RELATED SERVICES

FRANK BENNARDO, P.E.  
 PE# 0046549 CA.9885

FL#20665.3

**ENGINEERING EXPRESS®**

CORPORATE OFFICE:  
 160 SW 12th AVE, SUITE 106  
 DEERFIELD BEACH, FL 33442  
 (954) 354-0660 | (866) 396-9999  
 TEAM@ENGINEERINGEXPRESS.COM  
 ENGINEERINGEXPRESS.COM

**Oldcastle BuildingEnvelope®**

803 AIRPORT ROAD  
 TERRELL, TX 75160  
 Phn. (972) 551-6100

FG-5750T STORMMAX® THERMAL IGU IMPACT STOREFRONT SYSTEM  
 WET AND DRY GLAZED

REMARKS	DATE
INIT ISSUE	07/23/20
JEM	
AJP	

COPYRIGHT ENGINEERING EXPRESS®

20-29229h

SCALE: NTS UNLESS NOTED

01 OF 38

C:\Users\joem\appdata\local\temp\AcPublish\_3432\OBE - FG-5750T.dwg joem 02/16/2021 - 1:48pm

02/16/2021



FL#20665.3

**ENGINEERING EXPRESS®**  
CORPORATE OFFICE:  
160 SW 12th AVE, SUITE 106  
DEERFIELD BEACH, FL 33442  
(954) 354-0660 | (866) 396-9999  
TEAM@ENGINEERINGEXPRESS.COM  
ENGINEERINGEXPRESS.COM

**Oldcastle BuildingEnvelope®**  
803 AIRPORT ROAD  
TERRELL, TX 75160  
Phn. (972) 551-6100  
FG-5750T STORMMAX® THERMAL IGU IMPACT STOREFRONT SYSTEM  
WET AND DRY GLAZED

REMARKS	DATE
INIT ISSUE	07/23/20
DRWN	CHKD
JEM	AJP

COPYRIGHT ENGINEERING EXPRESS®

20-29229h

SCALE: NTS UNLESS NOTED

02 OF 38

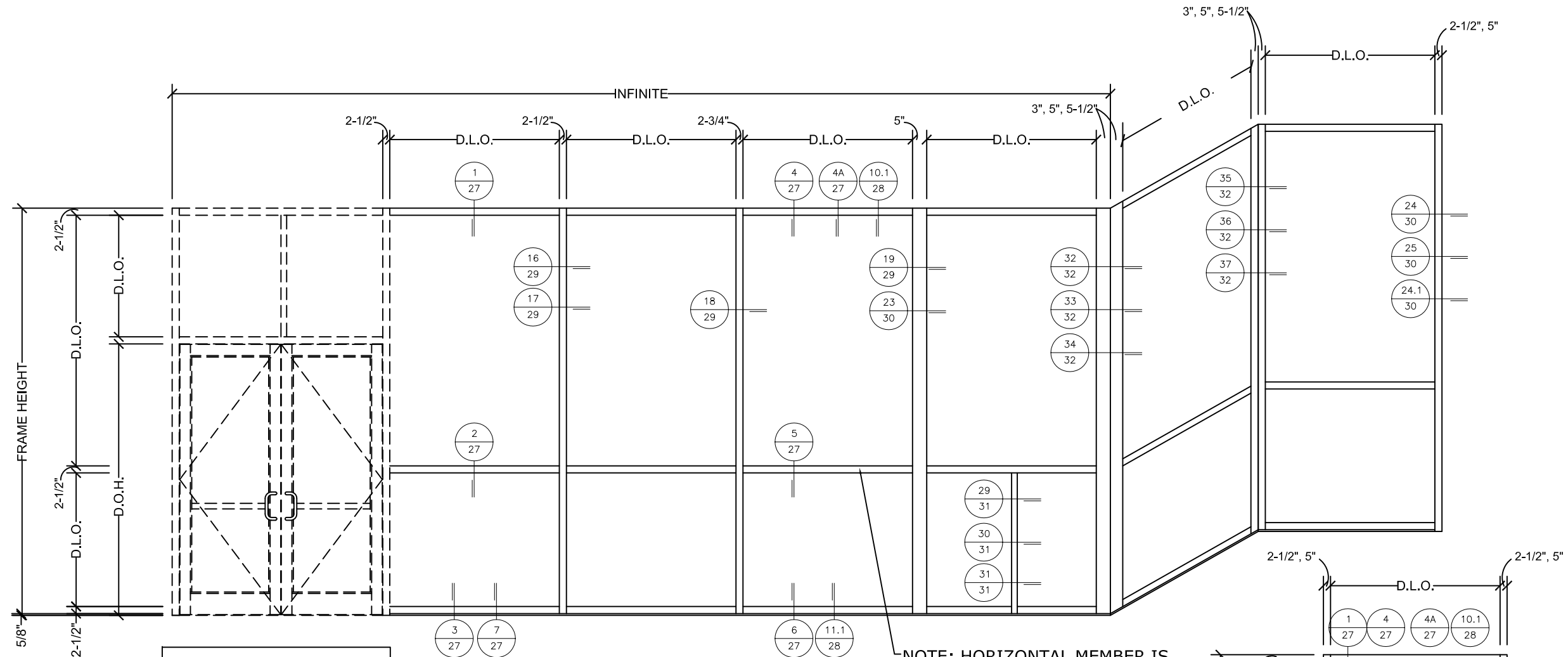

**OUTSIDE DRY AND WET GLAZED ELEVATIONS  
(DEPICTED WITH FGT-5712 SUB SILL)**

**INSTRUCTIONS TO DETERMINE DESIGN PRESSURE RATING**

STEP ①: USE THE GLASS LOADING TABLES TO DETERMINE THE ALLOWABLE PRESSURE OF THE GLASS.

STEP ②: USE THE MULLION LOADING TABLE TO DETERMINE THE ALLOWABLE PRESSURES FOR THE MULLIONS  
NOTE: TO DETERMINE THE LOADS OF THE MULLIONS, SEE DIAGRAM ON PAGE 12

STEP ③: THE MINIMUM VALUE BETWEEN STEP ① AND STEP ② WILL DETERMINE THE DESIGN LOAD PRESSURE FOR THE STOREFRONT SYSTEM.

STEP ④: LESSER OF SILL / HEAD ALLOWABLE PRESSURE (PAGES 27-28) AND FASTENER SCHEDULE (PAGES 17-26) MUST MEET OR EXCEED DESIGN LOAD PRESSURE FOR THE STOREFRONT SYSTEM.

NOTE: HORIZONTAL MEMBER IS LIMITED TO 57 1/2" MAX. IN LENGTH

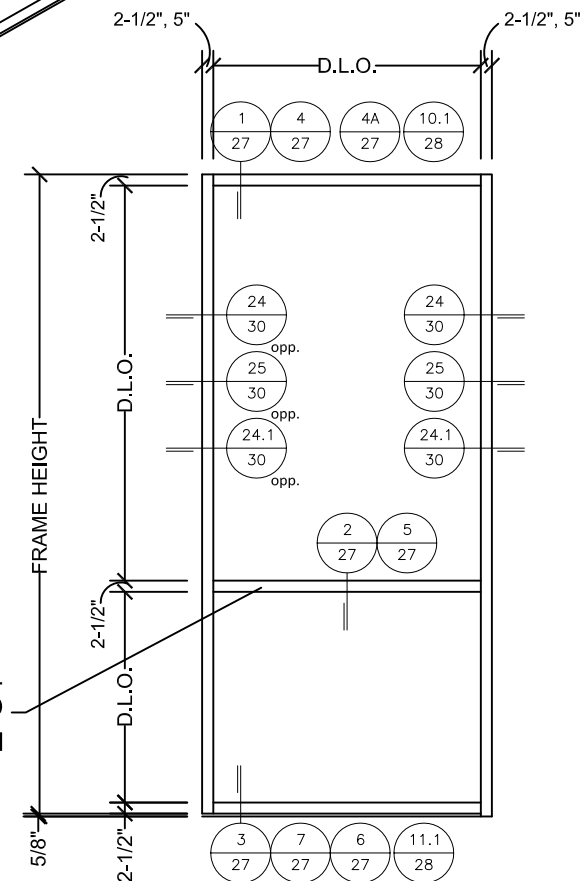

TYPICAL SINGLE PANEL OPENING

FRAME SIZE FOR SINGLE OPENINGS SHALL BE GOVERNED BY THE MAXIMUM ALLOWABLE D.L.O. DIMENSIONS DISPLAYED ON THE GLASS CHARTS

DOORS ARE SHOWN BY SEPARATE APPROVAL  
LESSER PRESSURE WILL PREVAIL ON COMBINED PRODUCTS  
MINIMUM SHIM SPACE REQUIRED 1/4", MAXIMUM SHIM SPACE 1/2"



FL#20665.3

**ENGINEERING EXPRESS®**  
CORPORATE OFFICE:  
160 SW 12th AVE, SUITE 106  
DEERFIELD BEACH, FL 33442  
(954) 354-0660 | (866) 396-9999  
TEAM@ENGINEERINGEXPRESS.COM  
ENGINEERINGEXPRESS.COM

**Oldcastle BuildingEnvelope®**  
803 AIRPORT ROAD  
TERRELL, TX 75160  
Phn. (972) 551-6100  
FG-5750T STORMMAX® THERMAL IGU IMPACT STOREFRONT SYSTEM  
WET AND DRY GLAZED

REMARKS	DRWN	CHKD	DATE
INIT ISSUE	JEM	AJP	07/23/20

COPYRIGHT ENGINEERING EXPRESS®

20-29229h

SCALE: NTS UNLESS NOTED

03 OF 38

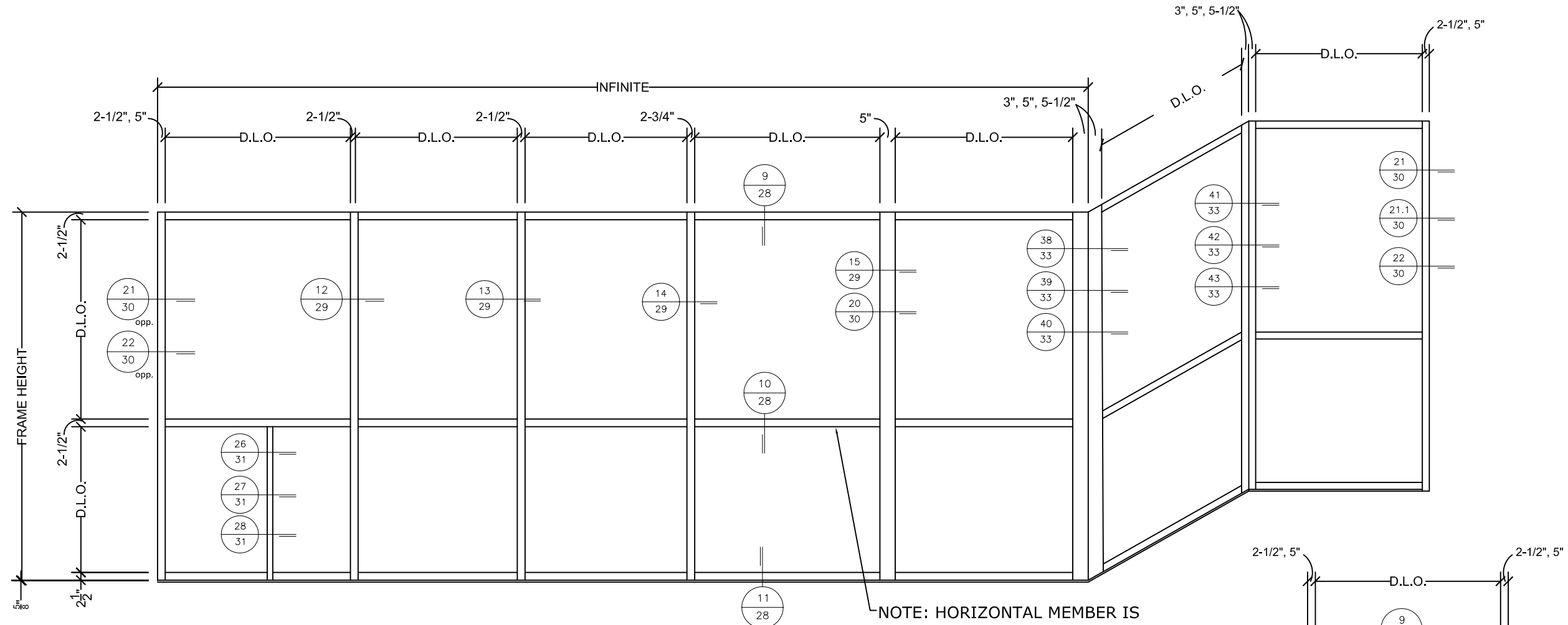

NOTE: HORIZONTAL MEMBER IS LIMITED TO 57 1/2" MAX. IN LENGTH

**INSIDE DRY GLAZED ELEVATIONS  
(DEPICTED WITH FGT-5712 SUB SILL)  
(LARGE & SMALL MISSILE IMPACT)**

**INSTRUCTIONS TO DETERMINE DESIGN PRESSURE RATING**

- STEP ①: USE THE GLASS LOADING TABLES TO DETERMINE THE ALLOWABLE PRESSURE OF THE GLASS.
- STEP ②: USE THE MULLION LOADING TABLE TO DETERMINE THE ALLOWABLE PRESSURES FOR THE MULLIONS  
NOTE: TO DETERMINE THE LOADS OF THE MULLIONS, SEE DIAGRAM ON PAGE 12
- STEP ③: THE MINIMUM VALUE BETWEEN STEP ① AND STEP ② WILL DETERMINE THE DESIGN LOAD PRESSURE FOR THE STOREFRONT SYSTEM.
- STEP ④: LESSER OF SILL / HEAD ALLOWABLE PRESSURE (PAGES 27-28) AND FASTENER SCHEDULE (PAGES 17-26) MUST MEET OR EXCEED DESIGN LOAD PRESSURE FOR THE STOREFRONT SYSTEM.

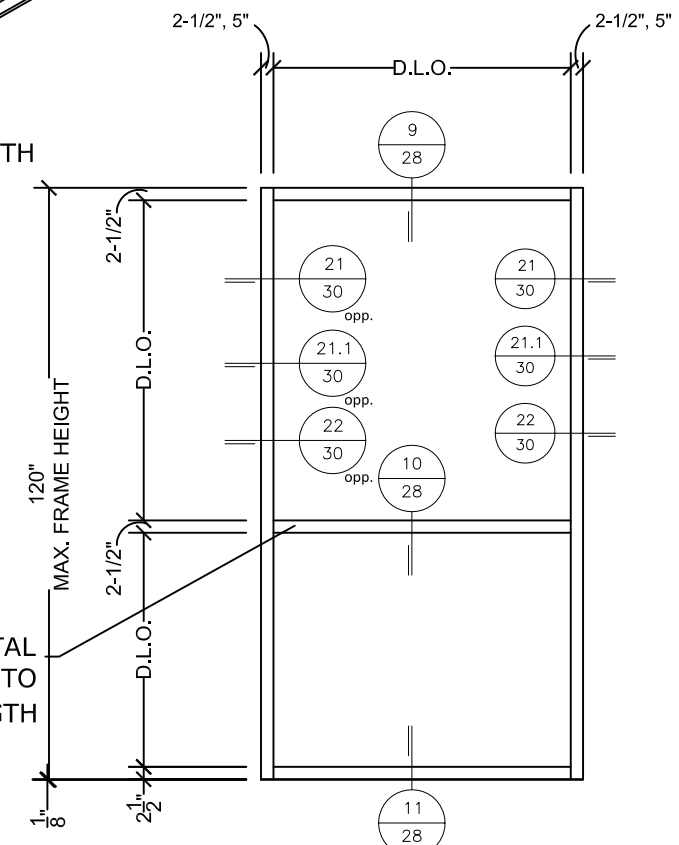

NOTE: HORIZONTAL MEMBER IS LIMITED TO 57 1/2" MAX. IN LENGTH

**TYPICAL SINGLE PANEL OPENING**

FRAME SIZE FOR SINGLE OPENINGS SHALL BE GOVERNED BY THE MAXIMUM ALLOWABLE D.L.O. DIMENSIONS DISPLAYED ON THE GLASS CHARTS

DOORS ARE SHOWN BY SEPARATE APPROVAL  
LESSER PRESSURE WILL PREVAIL ON COMBINED PRODUCTS  
MINIMUM SHIM SPACE REQUIRED 1/4", MAXIMUM SHIM SPACE 1/2"

C:\Users\joem\appdata\local\temp\AcPublish\_3432\OBE - FG-5750T.dwg joem 02/16/2021 - 1:48pm

# GLASS TYPES (L.M.I.) OUTSIDE GLAZED - MISSILE LEVEL "D"

FRANK BENNARDI, P.E.  
PE# 0046549 CA.9885



02/16/2021

FL#20665.3

**ENGINEERING EXPRESS®**  
CORPORATE OFFICE:  
160 SW 12th AVE, SUITE 106  
DEERFIELD BEACH, FL 33442  
(954) 354-0660 | (866) 396-9999  
TEAM@ENGINEERINGEXPRESS.COM  
ENGINEERINGEXPRESS.COM

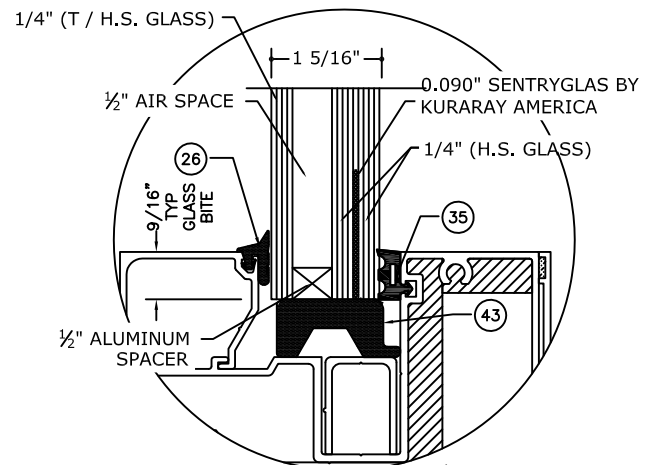

GLASS TYPE **G1**

GLAZING DETAIL (DRY GLAZED)

N.T.S.  
**GLASS RATING:**  
LARGE MISSILE LEVEL D  
1 5/16" GLASS

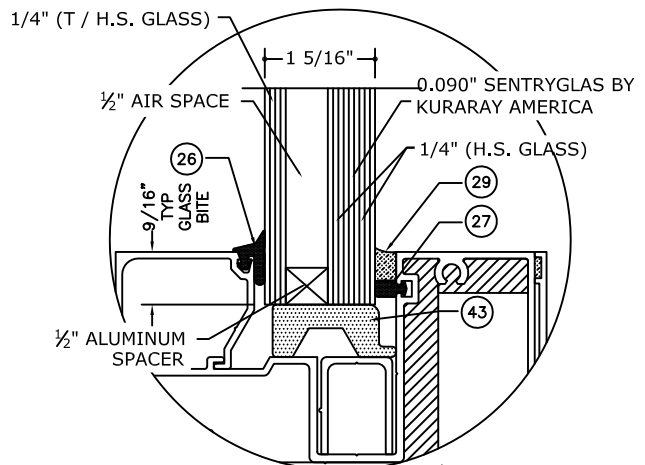

GLASS TYPE **G2**

GLAZING DETAIL (WET GLAZED)

N.T.S.  
**GLASS RATING:**  
LARGE MISSILE LEVEL D  
1 5/16" GLASS

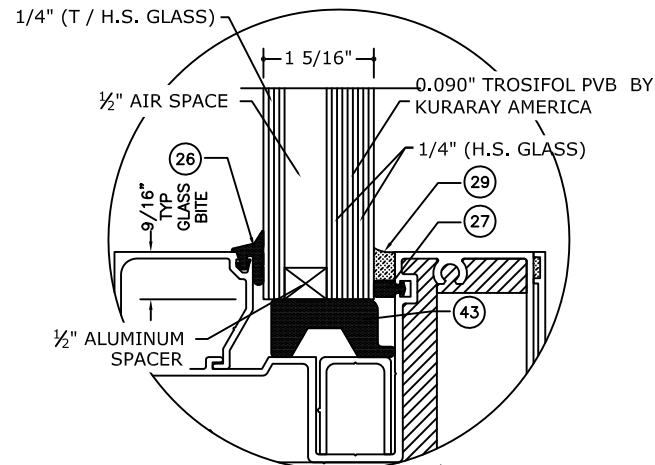

GLASS TYPE **G3**

GLAZING DETAIL (WET GLAZED)

N.T.S.  
**GLASS RATING:**  
LARGE MISSILE LEVEL D  
1 5/16" GLASS

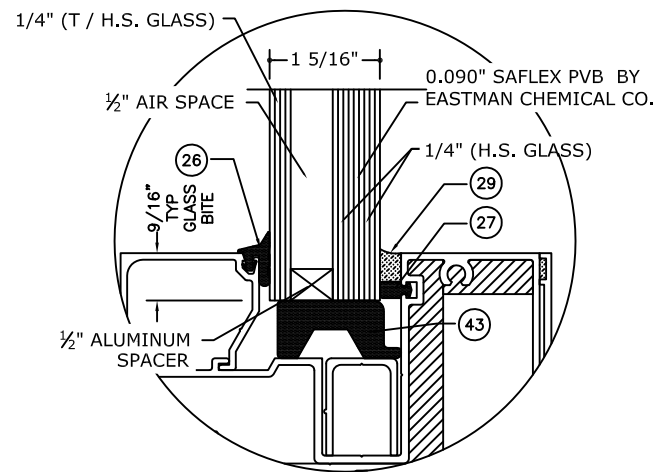

GLASS TYPE **G4**

GLAZING DETAIL (WET GLAZED)

N.T.S.  
**GLASS RATING:**  
LARGE MISSILE LEVEL D  
1 5/16" GLASS

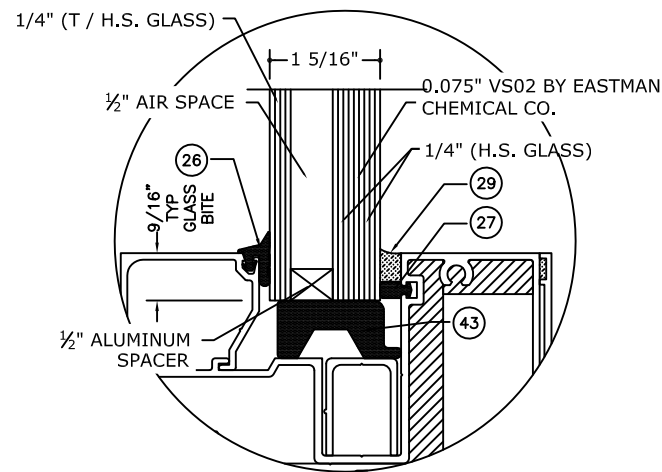

GLASS TYPE **G5**

GLAZING DETAIL (WET GLAZED)

N.T.S.  
**GLASS RATING:**  
LARGE MISSILE LEVEL D  
1 5/16" GLASS

**Oldcastle BuildingEnvelope®**  
803 AIRPORT ROAD  
TERRELL, TX 75160  
Phn. (972) 551-6100

FG-5750T STORMMAX® THERMAL IGU IMPACT STOREFRONT SYSTEM  
WET AND DRY GLAZED

REMARKS	DRWN	CHKD	DATE
INIT ISSUE	JEM	AJP	07/23/20

COPYRIGHT ENGINEERING EXPRESS®  
20-29229h  
SCALE: NTS UNLESS NOTED

04 OF 38

# GLASS TYPE (L.M.I. AND S.M.I.) - INSIDE GLAZED

FRANK BENNARDO, P.E.  
PE# 0046549 CA.9885



02/16/2021

FL#20665.3



ENGINEERING EXPRESS®  
CORPORATE OFFICE:  
160 SW 12th AVE, SUITE 106  
DEERFIELD BEACH, FL 33442  
(954) 354-0660 | (866) 396-9999  
TEAM@ENGINEERINGEXPRESS.COM  
ENGINEERINGEXPRESS.COM

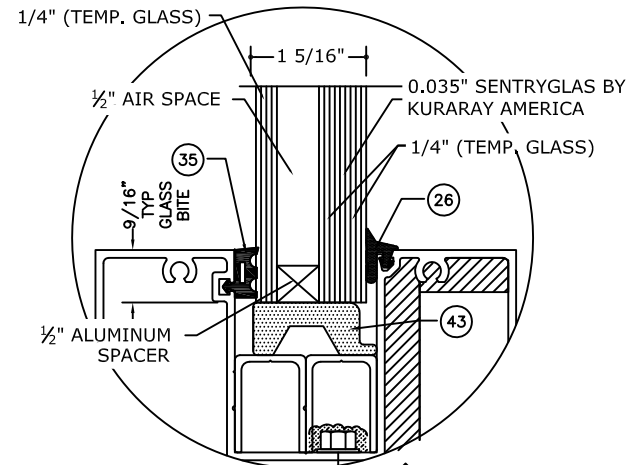

GLASS TYPE **G6**

GLAZING DETAIL (DRY GLAZED)

N.T.S.

**GLASS RATING:**

SMALL MISSILE  
1 5/16" GLASS

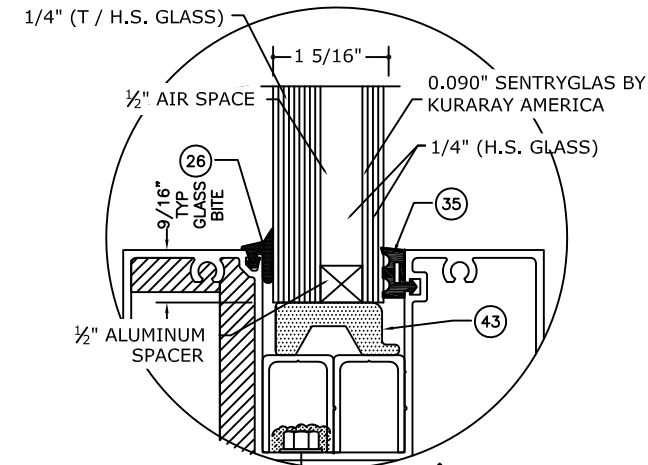

GLASS TYPE **G7**

GLAZING DETAIL (DRY GLAZED)

N.T.S.

**GLASS RATING:**

LARGE MISSILE LEVEL D  
1 5/16" GLASS

**Oldcastle BuildingEnvelope®**

803 AIRPORT ROAD  
TERRELL, TX 75160  
Phn. (972) 551-6100

FG-5750T STORMMAX® THERMAL IGU IMPACT STOREFRONT SYSTEM  
WET AND DRY GLAZED

REMARKS	DRWN	CHKD	DATE
INIT ISSUE	JEM	AJP	07/23/20

COPYRIGHT ENGINEERING EXPRESS®

20-29229h

SCALE: NTS UNLESS NOTED

05 OF 38



# GLASS LOADING TABLES (L.M.I.)

GLASS TYPES		G1		G2		G3		G4		G5	
		ALLOWABLE PRESSURE		ALLOWABLE PRESSURE		ALLOWABLE PRESSURE		ALLOWABLE PRESSURE		ALLOWABLE PRESSURE	
D.L.O. HEIGHT (in)	D.L.O. WIDTH (in)	(+) P.S.F	(-) P.S.F	(+) P.S.F	(-) P.S.F	(+) P.S.F	(-) P.S.F	(+) P.S.F	(-) P.S.F	(+) P.S.F	(-) P.S.F
66	24	75	75	75	75	55	55	70	80	90	90
	30	75	75	75	75	55	55	70	80	90	90
	36	75	75	75	75	55	55	70	80	90	90
	42	75	75	75	75	55	55	67	77	90	90
	46	75	75	75	75	55	55	61	70	90	90
	48	75	75	75	75	52	52	59	67	90	90
	54	75	75	75	75	46	46	52	60	90	90
	57 1/2	75	75	75	75	44	44	49	56	90	90
	60	67	67	67	67	-	-	47	54	86	86
	66	60	60	60	60	-	-	42	49	78	78
72	24	75	75	75	75	55	55	70	80	90	90
	30	75	75	75	75	55	55	70	80	90	90
	36	75	75	75	75	55	55	70	80	90	90
	42	75	75	75	75	55	55	67	77	90	90
	46	75	75	75	75	55	55	61	70	90	90
	48	75	75	75	75	52	52	59	67	90	90
	54	75	75	75	75	-	-	52	60	90	90
	57 1/2	75	75	75	75	-	-	49	56	90	90
	60	67	67	67	67	-	-	47	54	86	86
	66	60	60	60	60	-	-	-	-	78	78
78	24	75	75	75	75	55	55	70	80	90	90
	30	75	75	75	75	55	55	70	80	90	90
	36	75	75	75	75	55	55	70	80	90	90
	42	75	75	75	75	55	55	67	77	90	90
	46	75	75	75	75	55	55	61	70	90	90
	48	75	75	75	75	52	52	59	67	90	90
	54	75	75	75	75	-	-	52	60	90	90
	57 1/2	75	75	75	75	-	-	-	-	90	90
	60	67	67	67	67	-	-	-	-	86	86
	66	60	60	60	60	-	-	-	-	78	78
83	24	75	75	75	75	55	55	70	80	90	90
	30	75	75	75	75	55	55	70	80	90	90
	36	75	75	75	75	55	55	70	80	90	90
	42	75	75	75	75	55	55	67	77	90	90
	46	75	75	75	75	55	55	61	70	90	90
	48	75	75	75	75	-	-	59	67	90	90
	54	75	75	75	75	-	-	-	-	90	90
	57 1/2	75	75	75	75	-	-	-	-	90	90
	60	67	67	67	67	-	-	-	-	86	86
	66	60	60	60	60	-	-	-	-	78	78
72	-	-	-	-	-	-	-	-	71	71	
78	-	-	-	-	-	-	-	-	66	66	

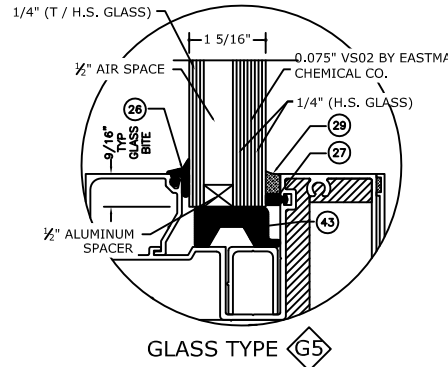
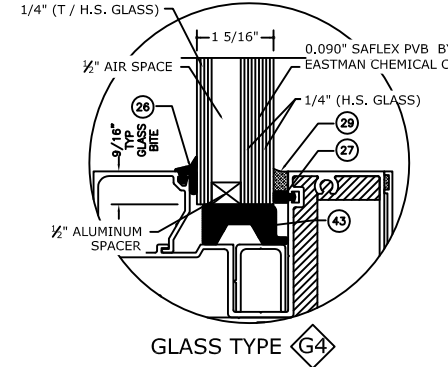
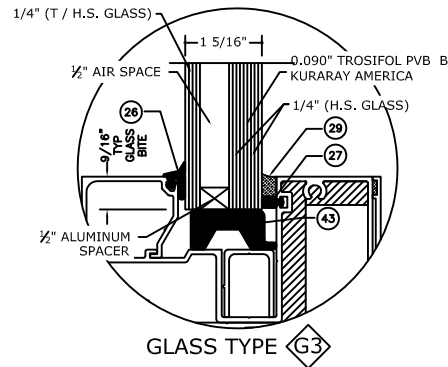
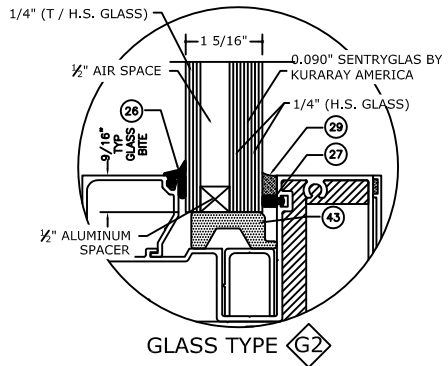
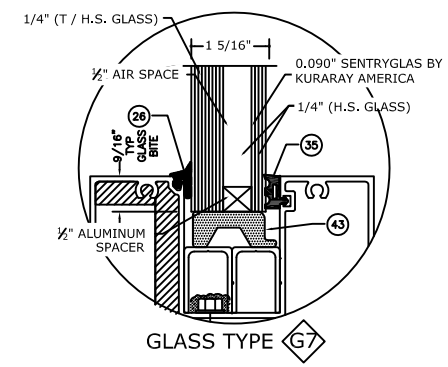
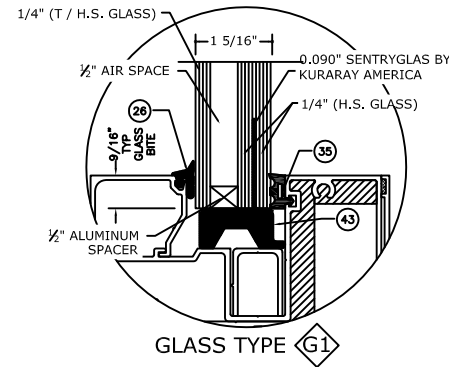

FRANK BENNARDO, P.E.  
PE# 0046549 CA.9885



02/16/2021

FL#20665.3

**ENGINEERING EXPRESS**  
CORPORATE OFFICE:  
160 SW 12th AVE, SUITE 106  
DEERFIELD BEACH, FL 33442  
(954) 354-0660 | (866) 396-9999  
TEAM@ENGINEERINGEXPRESS.COM  
ENGINEERINGEXPRESS.COM

**Oldcastle BuildingEnvelope**  
803 AIRPORT ROAD  
TERRELL, TX 75160  
Phn. (972) 551-6100  
FG-5750T STORMMAX<sup>®</sup> THERMAL IGU IMPACT STOREFRONT SYSTEM  
WET AND DRY GLAZED

DATE	07/23/20
DRWN	JEM
CHKD	AJP
INIT	
ISSUE	

COPYRIGHT ENGINEERING EXPRESS<sup>®</sup>

20-29229h

SCALE: NTS UNLESS NOTED

07

OF 38

C:\Users\joem\appdata\localtemp\AcPublish\_3432\OBE - FG-5750T.e.dwg 02/16/2021 - 1:49pm joem







# GLASS LOADING TABLES (S.M.I.)

GLASS TYPES		G6	
		ALLOWABLE PRESSURE	
D.L.O. HEIGHT (in)	D.L.O. WIDTH (in)	(+) P.S.F	(-) P.S.F
24	24	60	60
	30	60	60
	36	60	60
	42	60	60
	46	60	60
	48	60	60
	54	60	60
	57 1/2	60	60
	60	60	60
	66	60	60
	72	60	60
	78	60	60
30	24	60	60
	30	60	60
	36	60	60
	42	60	60
	46	60	60
	48	60	60
	54	60	60
	57 1/2	60	60
	60	60	60
	66	60	60
	72	60	60
	78	60	60
36	24	60	60
	30	60	60
	36	60	60
	42	60	60
	46	60	60
	48	60	60
	54	60	60
	57 1/2	60	60
	60	60	60
	66	60	60
	72	60	60
	78	60	60
40.5	24	60	60
	30	60	60
	36	60	60
	42	60	60
	46	60	60
	48	60	60
	54	60	60
	57 1/2	60	60
	60	60	60
	66	60	60
	72	60	60
	78	60	60

GLASS TYPES		G6	
		ALLOWABLE PRESSURE	
D.L.O. HEIGHT (in)	D.L.O. WIDTH (in)	(+) P.S.F	(-) P.S.F
42	24	60	60
	30	60	60
	36	60	60
	42	60	60
	46	60	60
	48	60	60
	54	60	60
	57 1/2	60	60
	60	60	60
	66	60	60
	72	60	60
	78	60	60
48	24	60	60
	30	60	60
	36	60	60
	42	60	60
	46	59	59
	48	57	57
	54	57	57
	57 1/2	57	57
	60	57	57
	66	57	57
	72	57	57
	78	57	57
54	24	60	60
	30	60	60
	36	60	60
	42	60	60
	46	59	59
	48	57	57
	54	51	51
	57 1/2	51	51
	60	51	51
	66	51	51
	72	51	51
	78	51	51
60	24	60	60
	30	60	60
	36	60	60
	42	60	60
	46	59	59
	48	57	57
	54	51	51
	57 1/2	47	47
	60	45	45
	66	45	45
	72	45	45
	78	-	-

GLASS TYPES		G6		
		ALLOWABLE PRESSURE		
D.L.O. HEIGHT (in)	D.L.O. WIDTH (in)	(+) P.S.F	(-) P.S.F	
66	24	60	60	
	30	60	60	
	36	60	60	
	42	60	60	
	46	59	59	
	48	57	57	
	54	51	51	
	57 1/2	47	47	
	60	45	45	
	66	41	41	
	72	24	60	60
		30	60	60
36		60	60	
42		60	60	
46		59	59	
48		57	57	
54		51	51	
57 1/2		47	47	
60		45	45	
78		24	60	60
		30	60	60
		36	60	60
	42	60	60	
	46	59	59	
	48	57	57	
	54	51	51	
	57 1/2	47	47	
	60	45	45	
	83	24	60	60
		30	60	60
		36	60	60
42		60	60	
46		59	59	
48		57	57	
54		51	51	

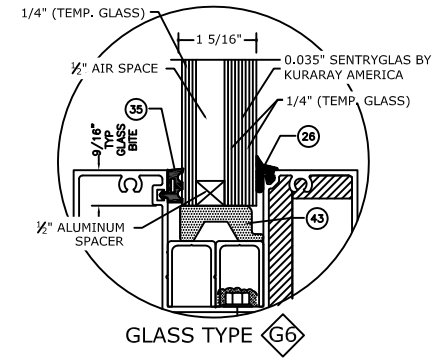

FRANK BENNARDO, P.E.  
PE# 0046549 CA.9885



02/16/2021

FL#20665.3

**ENGINEERING EXPRESS®**  
CORPORATE OFFICE:  
160 SW 12th AVE, SUITE 106  
DEERFIELD BEACH, FL 33442  
(954) 354-0660 | (866) 396-9999  
TEAM@ENGINEERINGEXPRESS.COM  
ENGINEERINGEXPRESS.COM

**Oldcastle BuildingEnvelope®**  
803 AIRPORT ROAD  
TERRELL, TX 75160  
Phn. (972) 551-6100  
FG-5750T STORMMAX® THERMAL IGU IMPACT STOREFRONT SYSTEM  
WET AND DRY GLAZED

REMARKS	DRWN	CHKD	DATE
INIT ISSUE	JEM	AJP	07/23/20

COPYRIGHT ENGINEERING EXPRESS®

20-29229h

SCALE: NTS UNLESS NOTED

10

# GLASS LOADING TABLES (S.M.I.)

GLASS TYPES		G6	
		ALLOWABLE PRESSURE	
D.L.O. HEIGHT (in)	D.L.O. WIDTH (in)	(+) P.S.F	(-) P.S.F
96	24	60	60
	30	60	60
	36	60	60
	42	60	60
	46	59	59
	48	57	57
101	24	60	60
	30	60	60
	36	60	60
	42	60	60
	46	60	60
108	24	60	60
	30	60	60
	36	60	60
	42	60	60
115	24	60	60
	30	60	60
	36	60	60

GLASS TYPES		G6	
		ALLOWABLE PRESSURE	
D.L.O. HEIGHT (in)	D.L.O. WIDTH (in)	(+) P.S.F	(-) P.S.F
120	24	60	60
	30	60	60
	36	60	60
126	24	60	60
	30	60	60
	36	60	60
132	24	60	60
	30	60	60
144	24	60	60
	30	60	60

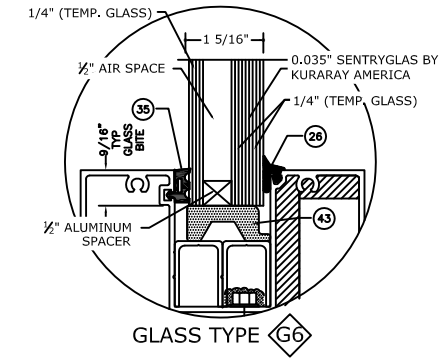

FRANK BENNARDO, P.E.  
PE# 0046549 CA.9885



02/16/2021

FL#20665.3

**ENGINEERING EXPRESS®**  
CORPORATE OFFICE:  
160 SW 12th AVE, SUITE 106  
DEERFIELD BEACH, FL 33442  
(954) 354-0660 | (866) 396-9999  
TEAM@ENGINEERINGEXPRESS.COM  
ENGINEERINGEXPRESS.COM

**Oldcastle BuildingEnvelope®**  
803 AIRPORT ROAD  
TERRELL, TX 75160  
Phn. (972) 551-6100

FG-5750T STORMMAX® THERMAL IGU IMPACT STOREFRONT SYSTEM  
WET AND DRY GLAZED

REMARKS	DRWN	CHKD	DATE
INIT ISSUE	JEM	AJP	07/23/20

COPYRIGHT ENGINEERING EXPRESS®  
20-29229h

SCALE: NTS UNLESS NOTED

## MULLION & JAMB LOAD DETERMINATION

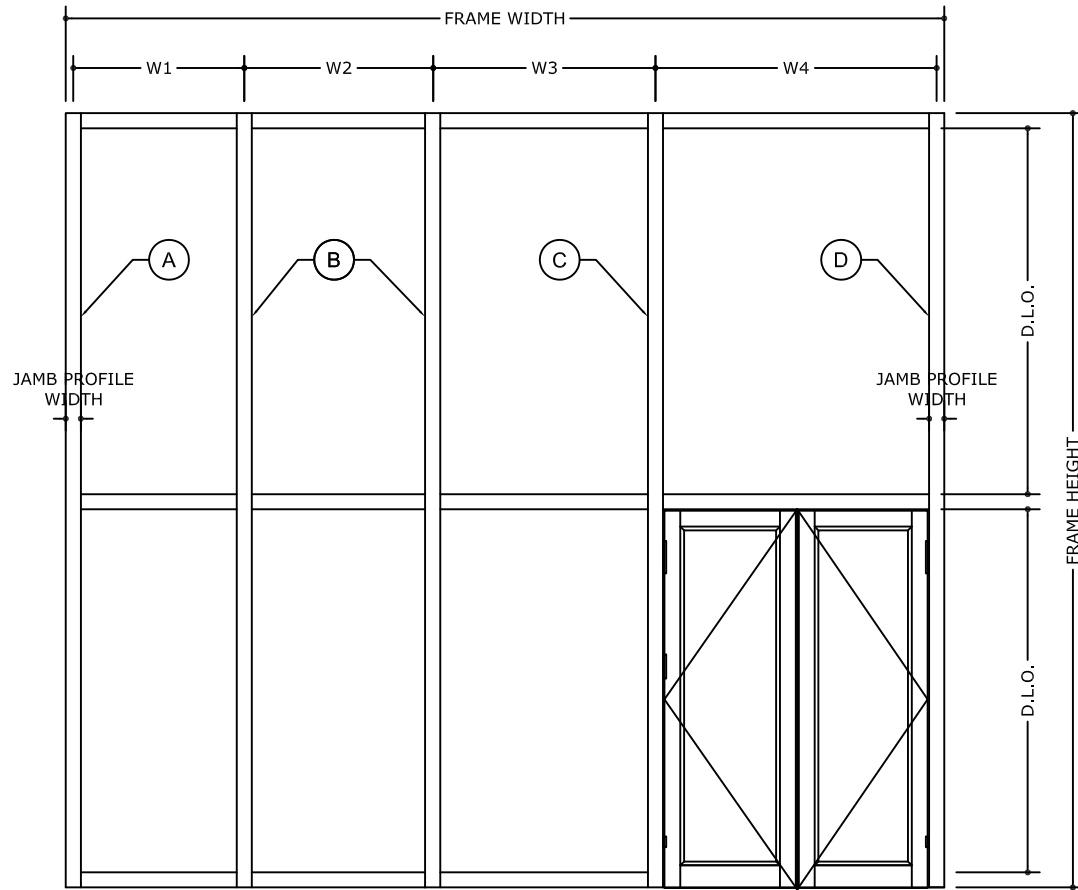

### LOAD DETERMINATION

TRIBUTARY WIDTH A =  $\frac{W1}{2} + 1/2"$  JAMB PROFILE WIDTH  
(FOR STANDARD JAMB MULLION)

TRIBUTARY WIDTH B = LARGER OF  $\frac{W1 + W2}{2}$  OR  $\frac{W2 + W3}{2}$   
(FOR STANDARD MULLION)

TRIBUTARY WIDTH C =  $\frac{W3 + W4}{2}$   
(FOR INTERMEDIATE DOOR MULLION)

TRIBUTARY WIDTH D =  $\frac{W4}{2} + 1/2"$  JAMB PROFILE WIDTH  
(FOR DOOR JAMB MULLION)

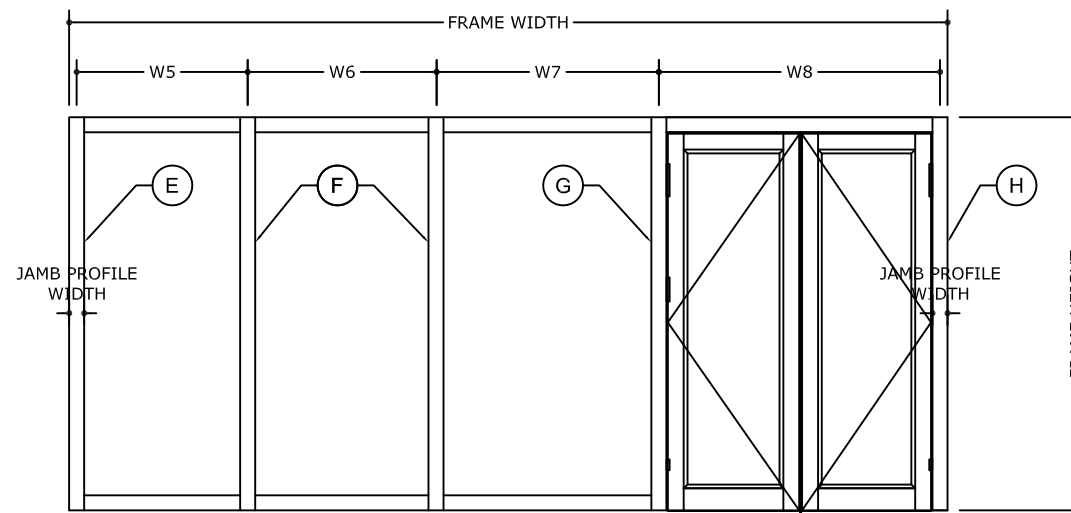

### LOAD DETERMINATION

TRIBUTARY WIDTH E =  $\frac{W5}{2} + 1/2"$  JAMB PROFILE WIDTH  
(FOR STANDARD JAMB MULLION)

TRIBUTARY WIDTH F = LARGER OF  $\frac{W5 + W6}{2}$  OR  $\frac{W6 + W7}{2}$   
(FOR STANDARD MULLION)

TRIBUTARY WIDTH G =  $\frac{W7 + W8}{2}$   
(FOR INTERMEDIATE DOOR MULLION)

TRIBUTARY WIDTH H =  $\frac{W8}{4} + 1/2"$  JAMB PROFILE WIDTH  
(FOR DOOR JAMB MULLION)

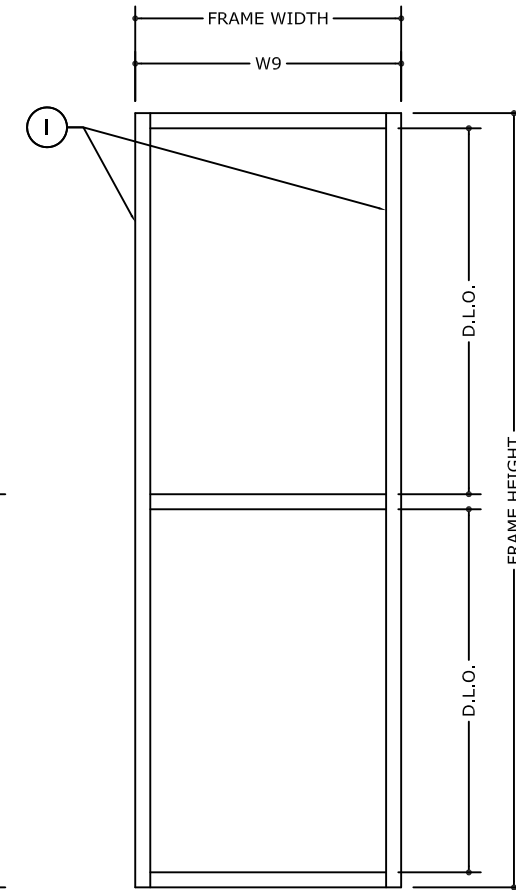

### LOAD DETERMINATION

TRIBUTARY WIDTH I =  $\frac{W9}{2}$   
(FOR STANDARD JAMB MULLION)

(A)	(E)	(I)	JAMB MULLION
(B)	(F)		STANDARD MULLION
(C)	(G)		DOOR JAMB INTERMEDIATE MULLION
(D)	(H)		DOOR JAMB MULLION

FRANK BENNARDO, P.E.  
PE# 0046549 CA.9885



02/16/2021

FL#20665.3

**ENGINEERING EXPRESS®**  
CORPORATE OFFICE:  
160 SW 12th AVE, SUITE 106  
DEERFIELD BEACH, FL 33442  
(954) 354-0660 | (866) 396-9999  
TEAM@ENGINEERINGEXPRESS.COM  
ENGINEERINGEXPRESS.COM

**Oldcastle BuildingEnvelope®**  
803 AIRPORT ROAD  
TERRELL, TX 75160  
Phn. (972) 551-6100

FG-5750T STORMMAX® THERMAL IGU IMPACT STOREFRONT SYSTEM  
WET AND DRY GLAZED

REMARKS	DRWN	CHKD	DATE
INIT ISSUE	JEM	AJP	07/23/20

COPYRIGHT ENGINEERING EXPRESS®

20-29229h

SCALE: NTS UNLESS NOTED

12 OF 38

C:\Users\joem\appdata\localtemp\AcPublish\_3432\OBE - FG-5750T.dwg joem 02/16/2021 - 1:49pm

# MULLION LOADING TABLES (P.S.F.)

SINGLE SPAN MULLION LOADING CHART		MULLION TYPE M1		MULLION TYPE M2		MULLION TYPE M3 - M4		MULLION TYPE M5		MULLION TYPE M6		MULLION TYPE M7	
FRAME HEIGHT (in)	FRAME WIDTH (in)	(+) P.S.F	(-) P.S.F	(+) P.S.F	(-) P.S.F	(+) P.S.F	(-) P.S.F	(+) P.S.F	(-) P.S.F	(+) P.S.F	(-) P.S.F	(+) P.S.F	(-) P.S.F
66	24	70	80	70	70	75	75	70	80	70	70	55	55
	30	70	80	70	70	75	75	70	80	70	70	55	55
	36	70	80	70	70	75	75	70	80	70	70	55	55
	42	70	80	70	70	75	75	70	80	70	70	55	55
	44.75	70	80	70	70	75	75	70	80	70	70	55	55
	48	70	80	70	70	75	75	70	80	70	70	55	55
	54	70	80	70	70	75	75	70	80	70	70	55	55
	60	70	80	70	70	75	75	70	80	70	70	55	55
	66	70	80	70	70	75	75	70	80	70	70	55	55
	72	70	80	70	70	75	75	70	80	70	70	55	55
72	24	70	80	70	70	75	75	70	80	70	70	55	55
	30	70	80	70	70	75	75	70	80	70	70	55	55
	36	70	80	70	70	75	75	70	80	70	70	55	55
	42	70	80	70	70	75	75	70	80	70	70	55	55
	44.75	70	80	70	70	75	75	70	80	70	70	55	55
	48	70	80	70	70	75	75	70	80	70	70	55	55
	54	70	80	70	70	75	75	70	80	70	70	55	55
	60	70	80	70	70	75	75	70	80	70	70	55	55
	66	70	80	70	70	75	75	70	80	70	70	55	55
	72	70	80	70	70	75	75	70	80	70	70	55	55
78	24	70	80	70	70	75	75	70	80	70	70	55	55
	30	70	80	70	70	75	75	70	80	70	70	55	55
	36	70	80	70	70	75	75	70	80	70	70	55	55
	42	70	80	70	70	75	75	70	80	70	70	55	55
	44.75	70	80	70	70	75	75	70	80	70	70	55	55
	48	70	80	70	70	75	75	70	80	70	70	55	55
	54	70	80	70	70	75	75	70	80	70	70	55	55
	60	70	80	70	70	75	75	70	80	70	70	55	55
	66	70	80	70	70	75	75	70	80	70	70	55	55
	72	70	80	-	-	75	75	70	80	70	70	55	55
84	24	70	80	70	70	75	75	70	80	70	70	55	55
	30	70	80	70	70	75	75	70	80	70	70	55	55
	36	70	80	70	70	75	75	70	80	70	70	55	55
	42	70	80	70	70	75	75	70	80	70	70	55	55
	44.75	70	80	70	70	75	75	70	80	70	70	55	55
	48	70	80	70	70	75	75	70	80	70	70	55	55
	54	70	80	70	70	75	75	70	80	70	70	55	55
	60	70	80	70	70	75	75	70	80	70	70	55	55
	66	70	80	-	-	75	75	70	80	70	70	55	55
	72	70	80	-	-	75	75	70	80	70	70	55	55
78	70	80	-	-	75	75	70	80	70	70	55	55	

SINGLE SPAN JAMB LOADING CHART		MULLION TYPE J1	
FRAME HEIGHT (in)	FRAME WIDTH (in)	(+) P.S.F	(-) P.S.F
36	24	90	90
	30	90	90
	36	90	90
	42	90	90
	44.75	90	90
	48	90	90
	54	90	90
	60	90	90
	66	90	90
	72	90	90
48	24	90	90
	30	90	90
	36	90	90
	42	90	90
	44.75	90	90
	48	90	90
50	24	90	90
	30	90	90
	36	90	90
	42	90	90
	44.75	90	90
	48	90	90
54	24	90	90
	30	90	90
	36	90	90
	42	90	90
	44.75	90	90
	48	90	90
60	24	90	90
	30	90	90
	36	90	90
	42	90	90
	44.75	90	90
	48	90	90
64	24	90	90
	30	90	90
	36	90	90
	42	90	90
	44.75	90	90
	48	90	90
66	24	90	90
	30	90	90
	36	86	86
	42	90	90
	44.75	90	90
	48	90	90
72	24	87	87
	30	87	87
	36	77	77
	42	90	90
	44.75	90	90
	48	90	90
78	24	90	90
	30	90	90
	36	90	90
	42	90	90
	44.75	90	90
	48	79	79

- APPLICABLE FOR UN-ANCHORED JAMB CONDITION ONLY
- JAMB TRIBUTARY SHALL BE DETERMINED PER SHEET 12 FOR SINGLE UNIT OR MULTI-UNITS STOREFRONT

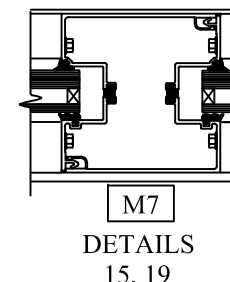
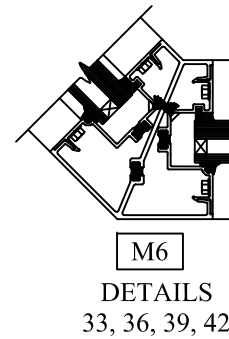
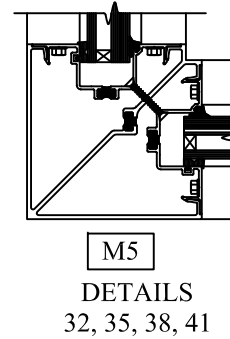
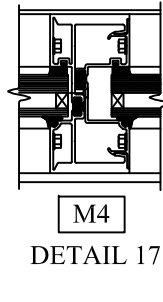
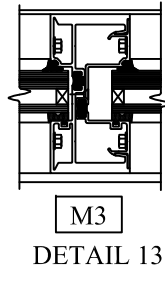
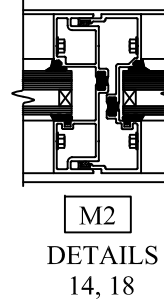
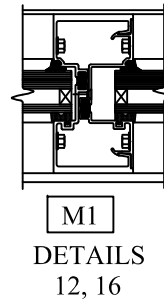
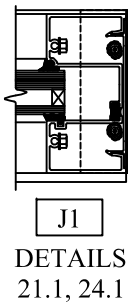

NOTE: FRAME WIDTHS = FRAME TRIBUTARY WIDTH

NOTE: SPANS NOT IN THIS TABLE CAN BE ADDED UNDER SITE SPECIFIC ENGINEERING AND SHALL BE APPROVED BY THE AUTHORITY HAVING JURISDICTION (AHJ)

FRANK BENNARDI, P.E.  
PE# 0046549 CA.9885



02/16/2021

FL#20665.3

**ENGINEERING EXPRESS**  
CORPORATE OFFICE:  
160 SW 12th AVE, SUITE 106  
DEERFIELD BEACH, FL 33442  
(954) 354-0660 | (866) 396-9999  
TEAM@ENGINEERINGEXPRESS.COM  
ENGINEERINGEXPRESS.COM

**Oldcastle BuildingEnvelope®**  
803 AIRPORT ROAD  
TERRELL, TX 75160  
Phn. (972) 551-6100

FG-5750T STORMMAX® THERMAL IGU IMPACT STOREFRONT SYSTEM  
WET AND DRY GLAZED

REMARKS	DATE
INIT ISSUE	07/23/20
DRWN	
CHKD	
JEM	
AJP	

COPYRIGHT ENGINEERING EXPRESS®  
20-29229h

SCALE: NTS UNLESS NOTED

# MULLION LOADING TABLES (P.S.F.)

SINGLE SPAN MULLION LOADING CHART		MULLION TYPE M1		MULLION TYPE M2		MULLION TYPE M3 - M4		MULLION TYPE M5		MULLION TYPE M6		MULLION TYPE M7	
FRAME HEIGHT (in)	FRAME WIDTH (in)	(+) P.S.F	(-) P.S.F	(+) P.S.F	(-) P.S.F	(+) P.S.F	(-) P.S.F	(+) P.S.F	(-) P.S.F	(+) P.S.F	(-) P.S.F	(+) P.S.F	(-) P.S.F
89	24	70	80	70	70	75	75	70	80	70	70	55	55
	30	70	80	70	70	75	75	70	80	70	70	55	55
	36	70	80	70	70	75	75	70	80	70	70	55	55
	42	70	80	70	70	75	75	70	80	70	70	55	55
	44.75	70	80	70	70	75	75	70	80	70	70	55	55
	48	70	80	70	70	75	75	70	80	70	70	55	55
	54	70	80	70	70	75	75	70	80	70	70	55	55
	60	70	80	-	-	75	75	70	80	70	70	55	55
	66	70	80	-	-	75	75	70	80	70	70	55	55
	72	70	80	-	-	75	75	70	80	70	70	55	55
78	70	80	-	-	75	75	-	-	-	-	-	-	
96	24	70	80	70	70	75	75	70	80	70	70	55	55
	30	70	80	70	70	75	75	70	80	70	70	55	55
	36	70	80	70	70	75	75	70	80	70	70	55	55
	42	70	80	70	70	75	75	70	80	70	70	55	55
	44.75	70	80	70	70	75	75	70	80	70	70	55	55
	48	70	80	70	70	75	75	70	80	70	70	55	55
	54	70	80	70	70	75	75	70	80	70	70	55	55
	60	70	80	-	-	75	75	70	80	70	70	55	55
	66	70	80	-	-	75	75	70	80	70	70	55	55
	72	69	78	-	-	75	75	70	80	-	-	55	55
78	-	-	-	-	75	75	-	-	-	-	-	-	
102	24	70	80	70	70	75	75	70	80	70	70	55	55
	30	70	80	70	70	75	75	70	80	70	70	55	55
	36	70	80	70	70	75	75	70	80	70	70	55	55
	42	70	80	70	70	75	75	70	80	70	70	55	55
	44.75	70	80	70	70	75	75	70	80	70	70	55	55
	48	70	80	70	70	75	75	70	80	70	70	55	55
	54	70	80	-	-	75	75	70	80	70	70	55	55
	60	68	78	-	-	75	75	70	80	70	70	55	55
	66	63	73	-	-	75	75	70	80	70	70	55	55
	72	-	-	-	-	75	75	-	-	-	-	-	-
108	24	70	80	70	70	75	75	70	80	70	70	55	55
	30	70	80	70	70	75	75	70	80	70	70	55	55
	36	70	80	70	70	75	75	70	80	70	70	55	55
	42	70	80	70	70	75	75	70	80	70	70	55	55
	44.75	70	80	70	70	75	75	70	80	70	70	55	55
	48	70	79	70	70	75	75	70	80	70	70	55	55
	54	65	72	70	70	75	75	70	80	70	70	55	55
	60	60	66	70	70	75	75	70	80	70	70	55	55
	66	56	62	-	-	75	75	-	-	-	-	-	-
	72	-	-	-	-	75	75	-	-	-	-	-	-

SINGLE SPAN JAMB LOADING CHART		MULLION TYPE J1	
FRAME HEIGHT (in)	FRAME WIDTH (in)	(+) P.S.F	(-) P.S.F
84	24	86	86
	30	90	90
89	24	81	81
96	24	74	74
102	24	69	69
108	24	65	65

NOTE: FRAME WIDTHS = FRAME TRIBUTARY WIDTH

NOTE: SPANS NOT IN THIS TABLE CAN BE ADDED UNDER SITE SPECIFIC ENGINEERING AND SHALL BE APPROVED BY THE AUTHORITY HAVING JURISDICTION (AHJ)

- APPLICABLE FOR UN-ANCHORED JAMB CONDITION ONLY
- JAMB TRIBUTARY SHALL BE DETERMINED PER SHEET 12 FOR SINGLE UNIT OR MULTI-UNITS STOREFRONT

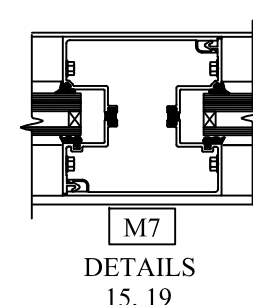
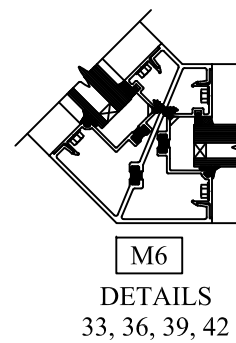
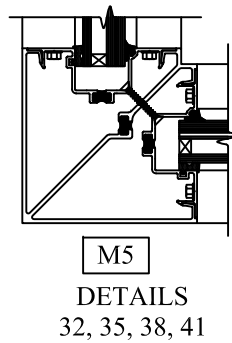
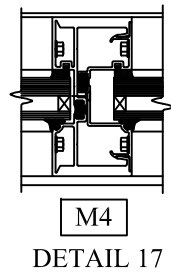
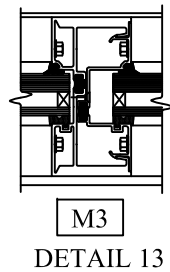
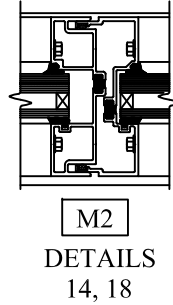
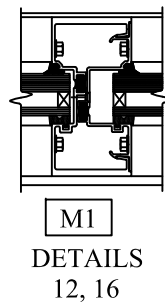
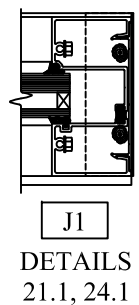

FRANK BENNARDO, P.E.  
PE# 0046549 CA.9885



02/16/2021

FL#20665.3

**ENGINEERING EXPRESS®**  
CORPORATE OFFICE:  
160 SW 12th AVE, SUITE 106  
DEERFIELD BEACH, FL 33442  
(954) 354-0660 | (866) 396-9999  
TEAM@ENGINEERINGEXPRESS.COM  
ENGINEERINGEXPRESS.COM

**Oldcastle BuildingEnvelope®**  
803 AIRPORT ROAD  
TERRELL, TX 75160  
Phn. (972) 551-6100  
FG-5750T STORMMAX® THERMAL IGU IMPACT STOREFRONT SYSTEM  
WET AND DRY GLAZED

DRWN	CHKD	DATE
JEM	AJP	07/23/20

20-29229h  
SCALE: NTS UNLESS NOTED

C:\Users\joem\appdata\local\temp\AcPublish\_3432\OBE - FG-5750Te.dwg  
02/16/2021 - 1:49pm joem

## MULLION LOADING TABLES (P.S.F.)

SINGLE SPAN MULLION LOADING CHART		MULLION TYPE		MULLION TYPE		MULLION TYPE		MULLION TYPE		MULLION TYPE		MULLION TYPE	
		<b>M1</b>		<b>M2</b>		<b>M3 - M4</b>		<b>M5</b>		<b>M6</b>		<b>M7</b>	
FRAME HEIGHT (in)	FRAME WIDTH (in)	(+) P.S.F	(-) P.S.F	(+) P.S.F	(-) P.S.F	(+) P.S.F	(-) P.S.F	(+) P.S.F	(-) P.S.F	(+) P.S.F	(-) P.S.F	(+) P.S.F	(-) P.S.F
109	24	70	80	70	70	75	75	70	80	70	70	55	55
	30	70	80	70	70	75	75	70	80	70	70	55	55
	36	70	80	70	70	75	75	70	80	70	70	55	55
	42	70	80	70	70	75	75	70	80	70	70	55	55
	44.75	70	80	70	70	75	75	70	80	70	70	55	55
	48	70	79	70	70	75	75	70	80	70	70	55	55
	54	65	72	70	70	75	75	70	80	70	70	55	55
	60	60	66	70	70	75	75	70	80	70	70	55	55
114	66	56	62	-	-	74	74	-	-	-	-	-	-
	24	70	80	-	-	75	75	70	80	-	-	55	55
	30	70	80	-	-	75	75	70	80	-	-	55	55
	36	70	80	-	-	75	75	70	80	-	-	55	55
	42	70	75	-	-	75	75	70	80	-	-	55	55
	44.75	68	71	-	-	75	75	70	80	-	-	55	55
	48	64	67	-	-	75	75	70	80	-	-	55	55
	54	58	61	-	-	75	75	70	80	-	-	55	55
120	60	53	56	-	-	73	73	70	80	-	-	55	55
	66	-	-	-	-	69	69	-	-	-	-	-	-
	24	70	80	-	-	75	75	70	80	-	-	55	55
	30	70	80	-	-	75	75	70	80	-	-	55	55
	36	70	74	-	-	75	75	70	80	-	-	55	55
	42	65	64	-	-	75	75	70	80	-	-	55	55
	44.75	61	60	-	-	75	75	70	80	-	-	55	55
	48	57	57	-	-	75	75	70	80	-	-	55	55
126	54	52	51	-	-	70	70	70	80	-	-	55	55
	60	47	47	-	-	68	68	-	-	-	-	-	-
	24	-	-	-	-	75	75	70	80	-	-	55	55
	30	-	-	-	-	75	75	70	80	-	-	55	55
	36	-	-	-	-	75	75	70	80	-	-	55	55
	42	-	-	-	-	75	75	70	80	-	-	55	55
	44.75	-	-	-	-	75	75	70	80	-	-	55	55
	48	-	-	-	-	68	68	70	80	-	-	55	55
54	-	-	-	-	62	62	70	78	-	-	55	55	

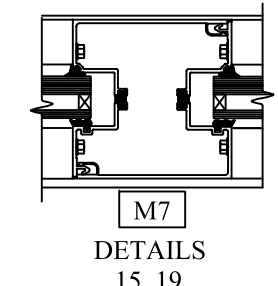
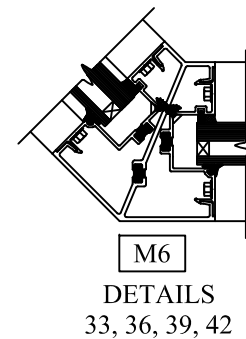
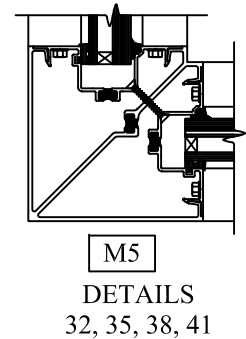
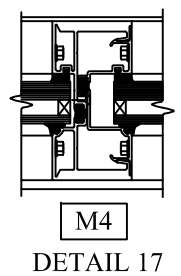
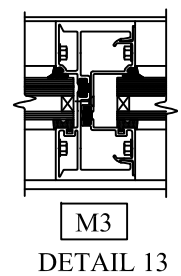
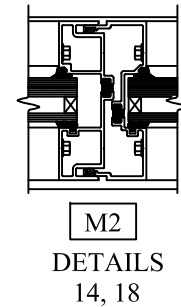
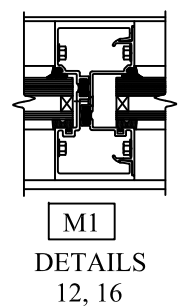

NOTE: FRAME WIDTHS = FRAME TRIBUTARY WIDTH

NOTE: SPANS NOT IN THIS TABLE CAN BE ADDED UNDER SITE SPECIFIC ENGINEERING AND SHALL BE APPROVED BY THE AUTHORITY HAVING JURISDICTION (AHJ)

FRANK BENNARDO, P.E.  
PE# 0046549 CA.9885

02/16/2021

FL#20665.3

**ENGINEERING EXPRESS®**

CORPORATE OFFICE:  
160 SW 12th AVE, SUITE 106  
DEERFIELD BEACH, FL 33442  
(954) 354-0660 | (866) 396-9999  
TEAM@ENGINEERINGEXPRESS.COM  
ENGINEERINGEXPRESS.COM

**Oldcastle BuildingEnvelope®**

803 AIRPORT ROAD  
TERRELL, TX 75160  
Phn. (972) 551-6100

FG-5750T STORMMAX® THERMAL IGU IMPACT STOREFRONT SYSTEM  
WET AND DRY GLAZED

REMARKS	DRWN	CHKD	DATE
INIT ISSUE	JEM	AJP	07/23/20

COPYRIGHT ENGINEERING EXPRESS®  
**20-29229h**

SCALE: NTS UNLESS NOTED

**15**

OF 38

C:\Users\joem\appdata\localtemp\AcPublish\_3432\OBE - FG-5750T.dwg  
joem  
02/16/2021 - 1:49pm

# MULLION LOADING TABLES (P.S.F.)

SINGLE SPAN MULLION LOADING CHART		MULLION TYPE <b>M3 - M4</b>		MULLION TYPE <b>M5</b>		MULLION TYPE <b>M7</b>	
FRAME HEIGHT (in)	FRAME WIDTH (in)	(+) P.S.F	(-) P.S.F	(+) P.S.F	(-) P.S.F	(+) P.S.F	(-) P.S.F
132	24	75	75	70	80	55	55
	30	75	75	70	80	55	55
	36	75	75	70	80	55	55
	42	75	75	70	80	55	55
	44.75	73	73	70	80	55	55
	48	69	69	70	75	55	55
138	24	75	75	70	80	55	55
	30	75	75	70	80	55	55
	36	75	75	70	80	55	55
	42	70	70	70	80	55	55
	44.75	66	66	70	74	55	55
	48	62	62	65	65	55	55
144	24	75	75	70	80	55	55
	30	75	75	70	80	55	55
	36	71	71	70	75	55	55
	42	62	62	65	65	55	55
	44.75	58	58	61	61	55	55
	48	54	54	57	57	55	55
146	24	75	75	-	-	-	-
	30	75	75	-	-	-	-
	36	68	68	-	-	-	-
	42	59	59	-	-	-	-
	44.75	56	56	-	-	-	-
	48	52	52	-	-	-	-

NOTE: FRAME WIDTHS = FRAME TRIBUTARY WIDTH

NOTE: SPANS NOT IN THIS TABLE CAN BE ADDED UNDER SITE SPECIFIC ENGINEERING AND SHALL BE APPROVED BY THE AUTHORITY HAVING JURISDICTION (AHJ)

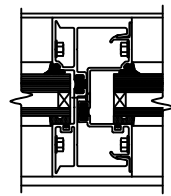

M3  
DETAIL 13

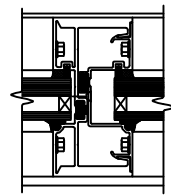

M4  
DETAIL 17

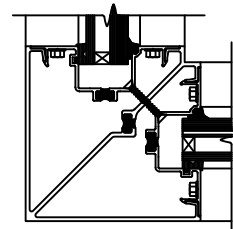

M5  
DETAILS  
32, 35, 38, 41

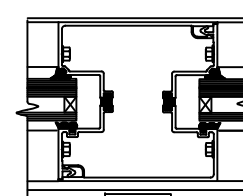

M7  
DETAILS  
15, 19

FRANK BENNARDO, P.E.  
PE# 0046549 CA.9885



02/16/2021

FL#20665.3

**ENGINEERING EXPRESS®**  
CORPORATE OFFICE:  
160 SW 12th AVE, SUITE 106  
DEERFIELD BEACH, FL 33442  
(954) 354-0660 | (866) 396-9999  
TEAM@ENGINEERINGEXPRESS.COM  
ENGINEERINGEXPRESS.COM

**Oldcastle BuildingEnvelope®**

803 AIRPORT ROAD  
TERRELL, TX 75160  
Phn. (972) 551-6100

FG-5750T STORMMAX® THERMAL IGU IMPACT STOREFRONT SYSTEM  
WET AND DRY GLAZED

REMARKS	DRWN	CHKD	DATE
INIT ISSUE	JEM	AJP	07/23/20

COPYRIGHT ENGINEERING EXPRESS®

20-29229h

SCALE: NTS UNLESS NOTED

16 OF 38

C:\Users\joem\appdata\localtemp\AcPublish\_3432\OBE - FG-5750Te.dwg  
joem  
02/16/2021 - 1:49pm



# FASTENER SCHEDULE

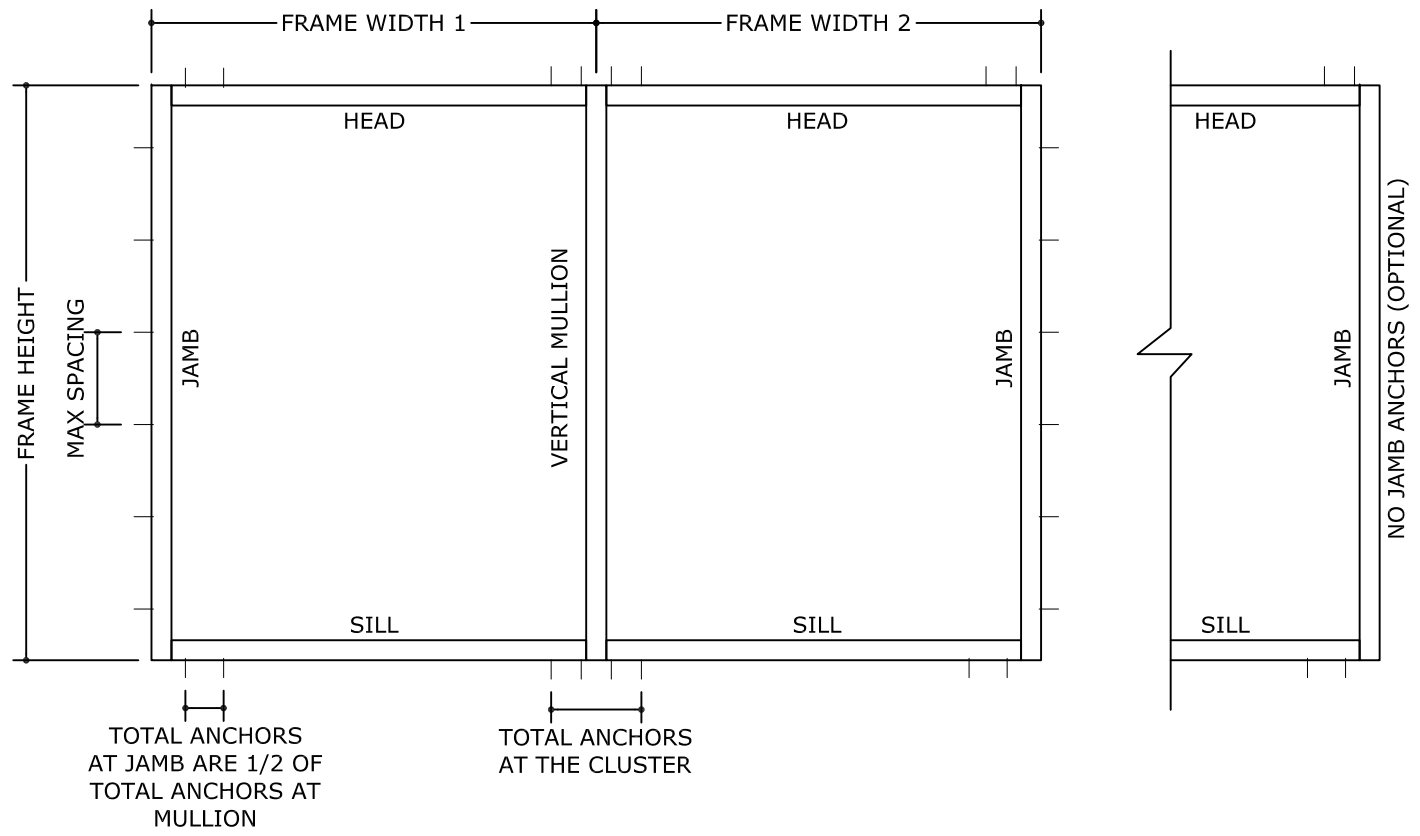

FASTENER SCHEDULE							
ANCHOR TYPE	ANCHOR DIAMETER	TYPE	MANUFACTURER	SUBSTRATE	MIN EMBEDMENT (IN)	MIN EDGE DISTANCE (IN)	SPACING (IN)
A	1/4"	ULTRACON ANCHOR	DEWALT	POURED CONCRETE 3000 PSI MIN	1-3/4	2-1/2	4" O.C.
B	1/4"-14	DRIL-FLEX HEX WASHER HEAD SELF DRILLING SCREW	DEWALT	16 GA MIN. STUD ASTM A-653 GRADE 33 STEEL	FULL	1-1/2	4" O.C.
				1/8" STEEL-A36			
C	1/4"	ULTRACON ANCHOR OR LAG SCREW	DEWALT	2X WOOD BUCK G=0.55	1-1/2	1-1/2	4" O.C.

FRANK BENNARDO, P.E.  
PE# 0046549 CA.9885

02/16/2021

FL#20665.3

**ENGINEERING EXPRESS®**  
CORPORATE OFFICE:  
160 SW 12th AVE, SUITE 106  
DEERFIELD BEACH, FL 33442  
(954) 354-0660 | (866) 396-9999  
TEAM@ENGINEERINGEXPRESS.COM  
ENGINEERINGEXPRESS.COM

**Oldcastle BuildingEnvelope®**  
803 AIRPORT ROAD  
TERRELL, TX 75160  
Phn. (972) 551-6100

FG-5750T STORMMAX® THERMAL IGU IMPACT STOREFRONT SYSTEM  
WET AND DRY GLAZED

REMARKS	DATE
INIT ISSUE	07/23/20
DRWN	CHKD
JEM	AJP

COPYRIGHT ENGINEERING EXPRESS®  
20-29229h

SCALE: NTS UNLESS NOTED

C:\Users\joem\appdata\local\temp\AcPublish\_3432\OBE - FG-5750Te.dwg joem 02/16/2021 - 1:49pm

# MAXIMUM ALLOWABLE STRESS DESIGN PRESSURE RATING FOR STANDARD MULLIONS WITH HEAD, SILL AND JAMB CONNECTIONS-ANCHOR TYPE A

FRAME HEIGHT (H)	TRIBUTARY (W)	TOTAL NUMBER OF ANCHORS AT THE CLUSTER-ANCHOR TYPE A							
		2		4		6		8	
		MAX PRESSURE (PSF)	JAMBS MAX ANCHOR SPACING (IN)	MAX PRESSURE (PSF)	JAMBS MAX ANCHOR SPACING (IN)	MAX PRESSURE (PSF)	JAMBS MAX ANCHOR SPACING (IN)	MAX PRESSURE (PSF)	JAMBS MAX ANCHOR SPACING (IN)
36	24	90	18"O.C.	90	18"O.C.	90	18"O.C.	90	18"O.C.
	36	90	18"O.C.	90	18"O.C.	90	18"O.C.	90	18"O.C.
	48	75	18"O.C.	90	18"O.C.	90	18"O.C.	90	18"O.C.
	60	60	18"O.C.	90	18"O.C.	90	18"O.C.	90	18"O.C.
	72	50	18"O.C.	90	18"O.C.	90	18"O.C.	90	18"O.C.
	78	46	18"O.C.	90	18"O.C.	90	18"O.C.	90	18"O.C.
48	24	90	24"O.C.	90	24"O.C.	90	24"O.C.	90	24"O.C.
	36	75	24"O.C.	90	24"O.C.	90	24"O.C.	90	24"O.C.
	48	56	24"O.C.	90	24"O.C.	90	24"O.C.	90	24"O.C.
	60	45	24"O.C.	90	24"O.C.	90	24"O.C.	90	24"O.C.
	72	37	24"O.C.	75	24"O.C.	90	16"O.C.	90	16"O.C.
	78	34	24"O.C.	69	24"O.C.	90	16"O.C.	90	16"O.C.
60	24	90	30"O.C.	90	30"O.C.	90	30"O.C.	90	30"O.C.
	36	60	30"O.C.	90	30"O.C.	90	30"O.C.	90	30"O.C.
	48	45	30"O.C.	90	30"O.C.	90	30"O.C.	90	30"O.C.
	60	36	30"O.C.	72	30"O.C.	90	20"O.C.	90	20"O.C.
	72	30	30"O.C.	60	30"O.C.	90	20"O.C.	90	20"O.C.
	78	27	30"O.C.	55	30"O.C.	83	20"O.C.	90	15"O.C.
72	24	75	36"O.C.	90	36"O.C.	90	36"O.C.	90	36"O.C.
	36	50	36"O.C.	90	36"O.C.	90	36"O.C.	90	36"O.C.
	48	37	36"O.C.	75	36"O.C.	90	24"O.C.	90	24"O.C.
	60	30	36"O.C.	60	36"O.C.	90	24"O.C.	90	24"O.C.
	72	25	36"O.C.	50	36"O.C.	75	24"O.C.	90	18"O.C.
	78	23	36"O.C.	46	36"O.C.	69	24"O.C.	90	18"O.C.

FRANK BENNARDO, P.E.  
PE# 0046549 CA.9885



02/16/2021

FL#20665.3

**ENGINEERING EXPRESS®**  
CORPORATE OFFICE:  
160 SW 12th AVE, SUITE 106  
DEERFIELD BEACH, FL 33442  
(954) 354-0660 | (866) 396-9999  
TEAM@ENGINEERINGEXPRESS.COM  
ENGINEERINGEXPRESS.COM

**Oldcastle BuildingEnvelope®**

803 AIRPORT ROAD  
TERRELL, TX 75160  
Phn. (972) 551-6100

FG-5750T STORMMAX® THERMAL IGU IMPACT STOREFRONT SYSTEM  
WET AND DRY GLAZED

REMARKS	DRWN	CHKD	DATE
INIT ISSUE	JEM	AJP	07/23/20

COPYRIGHT ENGINEERING EXPRESS®

20-29229h

SCALE: NTS UNLESS NOTED

18

OF 38

# MAXIMUM ALLOWABLE STRESS DESIGN PRESSURE RATING FOR STANDARD MULLIONS WITH HEAD, SILL AND JAMB CONNECTIONS-ANCHOR TYPE A

FRAME HEIGHT (H)	TRIBUTARY (W)	TOTAL NUMBER OF ANCHORS AT THE CLUSTER-ANCHOR TYPE A													
		2		4		6		8		10		12		16	
		MAX PRESSURE (PSF)	JAMBS MAX ANCHOR SPACING (IN)	MAX PRESSURE (PSF)	JAMBS MAX ANCHOR SPACING (IN)	MAX PRESSURE (PSF)	JAMBS MAX ANCHOR SPACING (IN)	MAX PRESSURE (PSF)	JAMBS MAX ANCHOR SPACING (IN)	MAX PRESSURE (PSF)	JAMBS MAX ANCHOR SPACING (IN)	MAX PRESSURE (PSF)	JAMBS MAX ANCHOR SPACING (IN)	MAX PRESSURE (PSF)	JAMBS MAX ANCHOR SPACING (IN)
84	24	64	42"O.C.	90	42"O.C.	90	42"O.C.	90	42"O.C.	90	42"O.C.	90	42"O.C.	90	42"O.C.
	36	42	42"O.C.	85	42"O.C.	90	28"O.C.	90	28"O.C.	90	28"O.C.	90	28"O.C.	90	28"O.C.
	48	32	42"O.C.	64	42"O.C.	90	28"O.C.	90	28"O.C.	90	28"O.C.	90	28"O.C.	90	28"O.C.
	60	25	42"O.C.	51	42"O.C.	77	28"O.C.	90	21"O.C.	90	21"O.C.	90	21"O.C.	90	21"O.C.
	72	21	42"O.C.	42	42"O.C.	64	28"O.C.	85	21"O.C.	90	17"O.C.	90	17"O.C.	90	17"O.C.
	78	19	42"O.C.	39	42"O.C.	59	28"O.C.	79	21"O.C.	90	17"O.C.	90	17"O.C.	90	17"O.C.
96	24	56	48"O.C.	90	48"O.C.	90	48"O.C.	90	48"O.C.	90	48"O.C.	90	48"O.C.	90	48"O.C.
	36	37	48"O.C.	75	48"O.C.	90	32"O.C.	90	32"O.C.	90	32"O.C.	90	32"O.C.	90	32"O.C.
	48	28	48"O.C.	56	48"O.C.	84	32"O.C.	90	24"O.C.	90	24"O.C.	90	24"O.C.	90	24"O.C.
	60	22	48"O.C.	45	48"O.C.	67	32"O.C.	90	24"O.C.	90	24"O.C.	90	24"O.C.	90	24"O.C.
	72	18	48"O.C.	37	48"O.C.	56	32"O.C.	75	24"O.C.	90	19"O.C.	90	19"O.C.	90	19"O.C.
	78	17	48"O.C.	34	48"O.C.	51	32"O.C.	69	24"O.C.	86	19"O.C.	90	16"O.C.	90	16"O.C.
108	24	50	54"O.C.	90	54"O.C.	90	54"O.C.	90	54"O.C.	90	54"O.C.	90	54"O.C.	90	54"O.C.
	36	33	54"O.C.	66	54"O.C.	90	36"O.C.	90	36"O.C.	90	36"O.C.	90	36"O.C.	90	36"O.C.
	48	25	54"O.C.	50	54"O.C.	75	36"O.C.	90	27"O.C.	90	27"O.C.	90	27"O.C.	90	27"O.C.
	60	20	54"O.C.	40	54"O.C.	60	36"O.C.	80	27"O.C.	90	22"O.C.	90	22"O.C.	90	22"O.C.
	72	16	54"O.C.	33	54"O.C.	50	36"O.C.	66	27"O.C.	83	22"O.C.	90	18"O.C.	90	18"O.C.
	78	15	54"O.C.	30	54"O.C.	46	36"O.C.	61	27"O.C.	76	22"O.C.	90	18"O.C.	90	18"O.C.
120	24	45	60"O.C.	90	60"O.C.	90	60"O.C.	90	60"O.C.	90	60"O.C.	90	60"O.C.	90	60"O.C.
	36	30	60"O.C.	60	60"O.C.	90	40"O.C.	90	40"O.C.	90	40"O.C.	90	40"O.C.	90	40"O.C.
	48	22	60"O.C.	45	60"O.C.	67	40"O.C.	90	30"O.C.	90	30"O.C.	90	30"O.C.	90	30"O.C.
	60	18	60"O.C.	36	60"O.C.	54	40"O.C.	72	30"O.C.	90	24"O.C.	90	24"O.C.	90	24"O.C.
	72	15	60"O.C.	30	60"O.C.	45	40"O.C.	60	30"O.C.	75	24"O.C.	90	20"O.C.	90	20"O.C.
	78	13	60"O.C.	27	60"O.C.	41	40"O.C.	55	30"O.C.	69	24"O.C.	83	20"O.C.	90	17"O.C.

FRANK BENNARDO, P.E.  
PE# 0046549 CA.9885



02/16/2021

FL#20665.3

**ENGINEERING EXPRESS®**  
CORPORATE OFFICE:  
160 SW 12th AVE, SUITE 106  
DEERFIELD BEACH, FL 33442  
(954) 354-0660 | (866) 396-9999  
TEAM@ENGINEERINGEXPRESS.COM  
ENGINEERINGEXPRESS.COM

**Oldcastle BuildingEnvelope®**  
803 AIRPORT ROAD  
TERRELL, TX 75160  
Phn. (972) 551-6100  
FG-5750T STORMMAX® THERMAL IGU IMPACT STOREFRONT SYSTEM  
WET AND DRY GLAZED

REMARKS	DRWN	CHKD	DATE
INIT ISSUE	JEM	AJP	07/23/20

20-29229h

SCALE: NTS UNLESS NOTED

C:\Users\joem\appdata\local\temp\AcPublish\_3432\OBE - FG-5750Te.dwg joem 02/16/2021 - 1:49pm

# MAXIMUM ALLOWABLE STRESS DESIGN PRESSURE RATING FOR STANDARD MULLIONS WITH HEAD, SILL AND JAMB CONNECTIONS-ANCHOR TYPE A

FRAME HEIGHT (H)	TRIBUTARY (W)	TOTAL NUMBER OF ANCHORS AT THE CLUSTER-ANCHOR TYPE A													
		2		4		6		8		10		12		16	
		MAX PRESSURE (PSF)	JAMBS MAX ANCHOR SPACING (IN)	MAX PRESSURE (PSF)	JAMBS MAX ANCHOR SPACING (IN)	MAX PRESSURE (PSF)	JAMBS MAX ANCHOR SPACING (IN)	MAX PRESSURE (PSF)	JAMBS MAX ANCHOR SPACING (IN)	MAX PRESSURE (PSF)	JAMBS MAX ANCHOR SPACING (IN)	MAX PRESSURE (PSF)	JAMBS MAX ANCHOR SPACING (IN)	MAX PRESSURE (PSF)	JAMBS MAX ANCHOR SPACING (IN)
132	24	40	66"O.C.	81	66"O.C.	90	44"O.C.	90	44"O.C.	90	44"O.C.	90	44"O.C.	90	44"O.C.
	36	27	66"O.C.	54	66"O.C.	81	44"O.C.	90	33"O.C.	90	33"O.C.	90	33"O.C.	90	33"O.C.
	48	20	66"O.C.	40	66"O.C.	61	44"O.C.	81	33"O.C.	90	26"O.C.	90	26"O.C.	90	26"O.C.
	60	16	66"O.C.	32	66"O.C.	49	44"O.C.	65	33"O.C.	81	26"O.C.	90	22"O.C.	90	22"O.C.
	72	13	66"O.C.	27	66"O.C.	40	44"O.C.	54	33"O.C.	68	26"O.C.	81	22"O.C.	90	19"O.C.
	78	12	66"O.C.	25	66"O.C.	37	44"O.C.	50	33"O.C.	62	26"O.C.	75	22"O.C.	90	17"O.C.
144	24	37	72"O.C.	75	72"O.C.	90	48"O.C.	90	48"O.C.	90	48"O.C.	90	48"O.C.	90	48"O.C.
	36	25	72"O.C.	50	72"O.C.	75	48"O.C.	90	36"O.C.	90	36"O.C.	90	36"O.C.	90	36"O.C.
	48	18	72"O.C.	37	72"O.C.	56	48"O.C.	75	36"O.C.	90	29"O.C.	90	29"O.C.	90	29"O.C.
	60	15	72"O.C.	30	72"O.C.	45	48"O.C.	60	36"O.C.	75	29"O.C.	90	24"O.C.	90	24"O.C.
	72	12	72"O.C.	25	72"O.C.	37	48"O.C.	50	36"O.C.	62	29"O.C.	75	24"O.C.	90	18"O.C.
	78	11	72"O.C.	23	72"O.C.	34	48"O.C.	46	36"O.C.	57	29"O.C.	69	24"O.C.	90	18"O.C.

FRANK BENNARDI, P.E.  
PE# 0046549 CA.9885



02/16/2021

FL#20665.3



**ENGINEERING EXPRESS®**  
CORPORATE OFFICE:  
160 SW 12th AVE, SUITE 106  
DEERFIELD BEACH, FL 33442  
(954) 354-0660 | (866) 396-9999  
TEAM@ENGINEERINGEXPRESS.COM  
ENGINEERINGEXPRESS.COM

**Oldcastle BuildingEnvelope®**

803 AIRPORT ROAD  
TERRELL, TX 75160  
Phn. (972) 551-6100

FG-5750T STORMMAX® THERMAL IGU IMPACT STOREFRONT SYSTEM  
WET AND DRY GLAZED

REMARKS	DRWN	CHKD	DATE
INIT ISSUE	JEM	AJP	07/23/20

COPYRIGHT ENGINEERING EXPRESS®

20-29229h

SCALE: NTS UNLESS NOTED

20

OF 38

# MAXIMUM ALLOWABLE STRESS DESIGN PRESSURE RATING FOR STANDARD MULLIONS WITH HEAD, SILL AND JAMB CONNECTIONS-ANCHOR TYPE B

FRAME HEIGHT (H)	TRIBUTARY (W)	TOTAL NUMBER OF ANCHORS AT THE CLUSTER-ANCHOR TYPE B			
		2		4	
		MAX PRESSURE (PSF)	JAMBS MAX ANCHOR SPACING (IN)	MAX PRESSURE (PSF)	JAMBS MAX ANCHOR SPACING (IN)
36	24	90	18"O.C.	90	18"O.C.
	36	90	18"O.C.	90	18"O.C.
	48	90	18"O.C.	90	18"O.C.
	60	90	18"O.C.	90	18"O.C.
	72	90	18"O.C.	90	18"O.C.
	78	90	18"O.C.	90	18"O.C.
48	24	90	24"O.C.	90	24"O.C.
	36	90	24"O.C.	90	24"O.C.
	48	90	24"O.C.	90	24"O.C.
	60	90	24"O.C.	90	24"O.C.
	72	83	24"O.C.	90	24"O.C.
	78	76	24"O.C.	90	24"O.C.
60	24	90	30"O.C.	90	30"O.C.
	36	90	30"O.C.	90	30"O.C.
	48	90	30"O.C.	90	30"O.C.
	60	80	30"O.C.	90	30"O.C.
	72	66	30"O.C.	90	30"O.C.
	78	61	30"O.C.	90	30"O.C.
72	24	90	36"O.C.	90	36"O.C.
	36	90	36"O.C.	90	36"O.C.
	48	83	36"O.C.	90	36"O.C.
	60	66	36"O.C.	90	36"O.C.
	72	55	36"O.C.	90	36"O.C.
	78	51	36"O.C.	90	36"O.C.

FRANK BENNARDO, P.E.  
PE# 0046549 CA.9885



02/16/2021

FL#20665.3

**ENGINEERING EXPRESS®**  
CORPORATE OFFICE:  
160 SW 12th AVE, SUITE 106  
DEERFIELD BEACH, FL 33442  
(954) 354-0660 | (866) 396-9999  
TEAM@ENGINEERINGEXPRESS.COM  
ENGINEERINGEXPRESS.COM

**Oldcastle BuildingEnvelope®**

803 AIRPORT ROAD  
TERRELL, TX 75160  
Phn. (972) 551-6100

FG-5750T STORMMAX® THERMAL IGU IMPACT STOREFRONT SYSTEM  
WET AND DRY GLAZED

REMARKS	DRWN	CHKD	DATE
INIT ISSUE	JEM	AJP	07/23/20

COPYRIGHT ENGINEERING EXPRESS®

20-29229h

SCALE: NTS UNLESS NOTED

# MAXIMUM ALLOWABLE STRESS DESIGN PRESSURE RATING FOR STANDARD MULLIONS WITH HEAD, SILL AND JAMB CONNECTIONS-ANCHOR TYPE B

FRAME HEIGHT (H)	TRIBUTARY (W)	TOTAL NUMBER OF ANCHORS AT THE CLUSTER-ANCHOR TYPE B					
		2		4		6	
		MAX PRESSURE (PSF)	JAMBS MAX ANCHOR SPACING (IN)	MAX PRESSURE (PSF)	JAMBS MAX ANCHOR SPACING (IN)	MAX PRESSURE (PSF)	JAMBS MAX ANCHOR SPACING (IN)
84	24	90	42"O.C.	90	42"O.C.	90	42"O.C.
	36	90	42"O.C.	90	42"O.C.	90	42"O.C.
	48	71	42"O.C.	90	42"O.C.	90	42"O.C.
	60	57	42"O.C.	90	42"O.C.	90	42"O.C.
	72	47	42"O.C.	90	42"O.C.	90	42"O.C.
	78	43	42"O.C.	87	42"O.C.	90	28"O.C.
96	24	90	48"O.C.	90	48"O.C.	90	48"O.C.
	36	83	48"O.C.	90	48"O.C.	90	48"O.C.
	48	62	48"O.C.	90	48"O.C.	90	48"O.C.
	60	50	48"O.C.	90	48"O.C.	90	48"O.C.
	72	41	48"O.C.	83	48"O.C.	90	32"O.C.
	78	38	48"O.C.	76	48"O.C.	90	32"O.C.
108	24	90	54"O.C.	90	54"O.C.	90	54"O.C.
	36	74	54"O.C.	90	54"O.C.	90	54"O.C.
	48	55	54"O.C.	90	54"O.C.	90	54"O.C.
	60	44	54"O.C.	88	54"O.C.	90	36"O.C.
	72	37	54"O.C.	74	54"O.C.	90	36"O.C.
	78	34	54"O.C.	68	54"O.C.	90	36"O.C.
120	24	90	60"O.C.	90	60"O.C.	90	60"O.C.
	36	66	60"O.C.	90	60"O.C.	90	60"O.C.
	48	50	60"O.C.	90	60"O.C.	90	60"O.C.
	60	40	60"O.C.	80	60"O.C.	90	40"O.C.
	72	33	60"O.C.	66	60"O.C.	90	40"O.C.
	78	30	60"O.C.	61	60"O.C.	90	40"O.C.

FRANK BENNARDO, P.E.  
PE# 0046549 CA.9885



02/16/2021

FL#20665.3

**ENGINEERING EXPRESS®**  
CORPORATE OFFICE:  
160 SW 12th AVE, SUITE 106  
DEERFIELD BEACH, FL 33442  
(954) 354-0660 | (866) 396-9999  
TEAM@ENGINEERINGEXPRESS.COM  
ENGINEERINGEXPRESS.COM

**Oldcastle BuildingEnvelope®**  
803 AIRPORT ROAD  
TERRELL, TX 75160  
Phn. (972) 551-6100

FG-5750T STORMMAX® THERMAL IGU IMPACT STOREFRONT SYSTEM  
WET AND DRY GLAZED

REMARKS	DRWN	CHKD	DATE
INIT ISSUE	JEM	AJP	07/23/20

COPYRIGHT ENGINEERING EXPRESS®

20-29229h

SCALE: NTS UNLESS NOTED

22

OF 38

C:\Users\joem\appdata\local\temp\AcPublish\_3432\OBE - FG-5750Te.dwg joem 02/16/2021 - 1:49pm

# MAXIMUM ALLOWABLE STRESS DESIGN PRESSURE RATING FOR STANDARD MULLIONS WITH HEAD, SILL AND JAMB CONNECTIONS-ANCHOR TYPE B

FRAME HEIGHT (H)	TRIBUTARY (W)	TOTAL NUMBER OF ANCHORS AT THE CLUSTER-ANCHOR TYPE B							
		2		4		6		8	
		MAX PRESSURE (PSF)	JAMBS MAX ANCHOR SPACING (IN)	MAX PRESSURE (PSF)	JAMBS MAX ANCHOR SPACING (IN)	MAX PRESSURE (PSF)	JAMBS MAX ANCHOR SPACING (IN)	MAX PRESSURE (PSF)	JAMBS MAX ANCHOR SPACING (IN)
132	24	90	66"O.C.	90	66"O.C.	90	66"O.C.	90	66"O.C.
	36	60	66"O.C.	90	66"O.C.	90	66"O.C.	90	66"O.C.
	48	45	66"O.C.	90	66"O.C.	90	66"O.C.	90	66"O.C.
	60	36	66"O.C.	72	66"O.C.	90	44"O.C.	90	44"O.C.
	72	30	66"O.C.	60	66"O.C.	90	44"O.C.	90	44"O.C.
	78	27	66"O.C.	55	66"O.C.	83	44"O.C.	90	33"O.C.
144	24	83	72"O.C.	90	72"O.C.	90	72"O.C.	90	72"O.C.
	36	55	72"O.C.	90	72"O.C.	90	72"O.C.	90	72"O.C.
	48	41	72"O.C.	83	72"O.C.	90	48"O.C.	90	48"O.C.
	60	33	72"O.C.	66	72"O.C.	90	48"O.C.	90	48"O.C.
	72	27	72"O.C.	55	72"O.C.	83	48"O.C.	90	36"O.C.
	78	25	72"O.C.	51	72"O.C.	76	48"O.C.	90	36"O.C.

FRANK BENNARDO, P.E.  
PE# 0046549 CA.9885



02/16/2021

FL#20665.3

**ENGINEERING EXPRESS®**  
CORPORATE OFFICE:  
160 SW 12th AVE, SUITE 106  
DEERFIELD BEACH, FL 33442  
(954) 354-0660 | (866) 396-9999  
TEAM@ENGINEERINGEXPRESS.COM  
ENGINEERINGEXPRESS.COM

**Oldcastle BuildingEnvelope®**

803 AIRPORT ROAD  
TERRELL, TX 75160  
Phn. (972) 551-6100

FG-5750T STORMMAX® THERMAL IGU IMPACT STOREFRONT SYSTEM  
WET AND DRY GLAZED

REMARKS	DRWN	CHKD	DATE
INIT ISSUE	JEM	AJP	07/23/20

COPYRIGHT ENGINEERING EXPRESS®

20-29229h

SCALE: NTS UNLESS NOTED

23

OF 38

# MAXIMUM ALLOWABLE STRESS DESIGN PRESSURE RATING FOR STANDARD MULLIONS WITH HEAD, SILL AND JAMB CONNECTIONS-ANCHOR TYPE C

FRAME HEIGHT (H)	TRIBUTARY (W)	TOTAL NUMBER OF ANCHORS AT THE CLUSTER-ANCHOR TYPE C											
		2		4		6		8		10		12	
		MAX PRESSURE (PSF)	JAMBS MAX ANCHOR SPACING (IN)	MAX PRESSURE (PSF)	JAMBS MAX ANCHOR SPACING (IN)	MAX PRESSURE (PSF)	JAMBS MAX ANCHOR SPACING (IN)	MAX PRESSURE (PSF)	JAMBS MAX ANCHOR SPACING (IN)	MAX PRESSURE (PSF)	JAMBS MAX ANCHOR SPACING (IN)	MAX PRESSURE (PSF)	JAMBS MAX ANCHOR SPACING (IN)
36	24	90	18"O.C.	90	18"O.C.	90	18"O.C.	90	18"O.C.	90	18"O.C.	90	18"O.C.
	36	75	18"O.C.	90	18"O.C.	90	18"O.C.	90	18"O.C.	90	18"O.C.	90	18"O.C.
	48	56	18"O.C.	90	18"O.C.	90	18"O.C.	90	18"O.C.	90	18"O.C.	90	18"O.C.
	60	45	18"O.C.	90	18"O.C.	90	18"O.C.	90	18"O.C.	90	18"O.C.	90	18"O.C.
	72	37	18"O.C.	75	18"O.C.	90	12"O.C.	90	12"O.C.	90	12"O.C.	90	12"O.C.
	78	34	18"O.C.	69	18"O.C.	90	12"O.C.	90	12"O.C.	90	12"O.C.	90	12"O.C.
48	24	85	24"O.C.	90	24"O.C.	90	24"O.C.	90	24"O.C.	90	24"O.C.	90	24"O.C.
	36	56	24"O.C.	90	24"O.C.	90	24"O.C.	90	24"O.C.	90	24"O.C.	90	24"O.C.
	48	42	24"O.C.	85	24"O.C.	90	16"O.C.	90	16"O.C.	90	16"O.C.	90	16"O.C.
	60	34	24"O.C.	68	24"O.C.	90	16"O.C.	90	16"O.C.	90	16"O.C.	90	16"O.C.
	72	28	24"O.C.	56	24"O.C.	85	16"O.C.	90	12"O.C.	90	12"O.C.	90	12"O.C.
	78	26	24"O.C.	52	24"O.C.	78	16"O.C.	90	12"O.C.	90	12"O.C.	90	12"O.C.
60	24	68	30"O.C.	90	30"O.C.	90	30"O.C.	90	30"O.C.	90	30"O.C.	90	30"O.C.
	36	45	30"O.C.	90	30"O.C.	90	30"O.C.	90	30"O.C.	90	30"O.C.	90	30"O.C.
	48	34	30"O.C.	68	30"O.C.	90	20"O.C.	90	20"O.C.	90	20"O.C.	90	20"O.C.
	60	27	30"O.C.	54	30"O.C.	81	20"O.C.	90	15"O.C.	90	15"O.C.	90	15"O.C.
	72	22	30"O.C.	45	30"O.C.	68	20"O.C.	90	15"O.C.	90	15"O.C.	90	15"O.C.
	78	20	30"O.C.	41	30"O.C.	62	20"O.C.	83	15"O.C.	90	12"O.C.	90	12"O.C.
72	24	56	36"O.C.	90	36"O.C.	90	36"O.C.	90	36"O.C.	90	36"O.C.	90	36"O.C.
	36	37	36"O.C.	75	36"O.C.	90	24"O.C.	90	24"O.C.	90	24"O.C.	90	24"O.C.
	48	28	36"O.C.	56	36"O.C.	85	24"O.C.	90	18"O.C.	90	18"O.C.	90	18"O.C.
	60	22	36"O.C.	45	36"O.C.	68	24"O.C.	90	18"O.C.	90	18"O.C.	90	18"O.C.
	72	18	36"O.C.	37	36"O.C.	56	24"O.C.	75	18"O.C.	90	14"O.C.	90	14"O.C.
	78	17	36"O.C.	34	36"O.C.	52	24"O.C.	69	18"O.C.	87	14"O.C.	90	12"O.C.

FRANK BENNARDO, P.E.  
PE# 0046549 CA.9885



02/16/2021

FL#20665.3

**ENGINEERING EXPRESS®**  
CORPORATE OFFICE:  
160 SW 12th AVE, SUITE 106  
DEERFIELD BEACH, FL 33442  
(954) 354-0660 | (866) 396-9999  
TEAM@ENGINEERINGEXPRESS.COM  
ENGINEERINGEXPRESS.COM

**Oldcastle BuildingEnvelope®**

803 AIRPORT ROAD  
TERRELL, TX 75160  
Phn. (972) 551-6100

FG-5750T STORMMAX® THERMAL IGU IMPACT STOREFRONT SYSTEM  
WET AND DRY GLAZED

REMARKS	DRWN	CHKD	DATE
INIT ISSUE	JEM	AJP	07/23/20

COPYRIGHT ENGINEERING EXPRESS®

20-29229h

SCALE: NTS UNLESS NOTED

24

OF 38



# MAXIMUM ALLOWABLE STRESS DESIGN PRESSURE RATING FOR STANDARD MULLIONS WITH HEAD, SILL AND JAMB CONNECTIONS-ANCHOR TYPE C

FRAME HEIGHT (H)	TRIBUTARY (W)	TOTAL NUMBER OF ANCHORS AT THE CLUSTER-ANCHOR TYPE C													
		2		4		6		8		10		12		16	
		MAX PRESSURE (PSF)	JAMBS MAX ANCHOR SPACING (IN)	MAX PRESSURE (PSF)	JAMBS MAX ANCHOR SPACING (IN)	MAX PRESSURE (PSF)	JAMBS MAX ANCHOR SPACING (IN)	MAX PRESSURE (PSF)	JAMBS MAX ANCHOR SPACING (IN)	MAX PRESSURE (PSF)	JAMBS MAX ANCHOR SPACING (IN)	MAX PRESSURE (PSF)	JAMBS MAX ANCHOR SPACING (IN)	MAX PRESSURE (PSF)	JAMBS MAX ANCHOR SPACING (IN)
84	24	48	42"O.C.	90	42"O.C.	90	42"O.C.	90	42"O.C.	90	42"O.C.	90	42"O.C.	90	42"O.C.
	36	32	42"O.C.	64	42"O.C.	90	28"O.C.	90	28"O.C.	90	28"O.C.	90	28"O.C.	90	28"O.C.
	48	24	42"O.C.	48	42"O.C.	72	28"O.C.	90	21"O.C.	90	21"O.C.	90	21"O.C.	90	21"O.C.
	60	19	42"O.C.	38	42"O.C.	58	28"O.C.	77	21"O.C.	90	17"O.C.	90	17"O.C.	90	17"O.C.
	72	16	42"O.C.	32	42"O.C.	48	28"O.C.	64	21"O.C.	80	17"O.C.	90	14"O.C.	90	14"O.C.
	78	14	42"O.C.	29	42"O.C.	44	28"O.C.	59	21"O.C.	74	17"O.C.	89	14"O.C.	90	12"O.C.
96	24	42	48"O.C.	85	48"O.C.	90	32"O.C.	90	32"O.C.	90	32"O.C.	90	32"O.C.	90	32"O.C.
	36	28	48"O.C.	56	48"O.C.	85	32"O.C.	90	24"O.C.	90	24"O.C.	90	24"O.C.	90	24"O.C.
	48	21	48"O.C.	42	48"O.C.	63	32"O.C.	85	24"O.C.	90	19"O.C.	90	19"O.C.	90	19"O.C.
	60	17	48"O.C.	34	48"O.C.	51	32"O.C.	68	24"O.C.	85	19"O.C.	90	16"O.C.	90	16"O.C.
	72	14	48"O.C.	28	48"O.C.	42	32"O.C.	56	24"O.C.	70	19"O.C.	85	16"O.C.	90	14"O.C.
	78	13	48"O.C.	26	48"O.C.	39	32"O.C.	52	24"O.C.	65	19"O.C.	78	16"O.C.	90	14"O.C.
108	24	37	54"O.C.	75	54"O.C.	90	36"O.C.	90	36"O.C.	90	36"O.C.	90	36"O.C.	90	36"O.C.
	36	25	54"O.C.	50	54"O.C.	75	36"O.C.	90	27"O.C.	90	27"O.C.	90	27"O.C.	90	27"O.C.
	48	18	54"O.C.	37	54"O.C.	56	36"O.C.	75	27"O.C.	90	22"O.C.	90	22"O.C.	90	22"O.C.
	60	15	54"O.C.	30	54"O.C.	45	36"O.C.	60	27"O.C.	75	22"O.C.	90	18"O.C.	90	18"O.C.
	72	12	54"O.C.	25	54"O.C.	37	36"O.C.	50	27"O.C.	62	22"O.C.	75	18"O.C.	90	14"O.C.
	78	11	54"O.C.	23	54"O.C.	34	36"O.C.	46	27"O.C.	58	22"O.C.	69	18"O.C.	90	14"O.C.
120	24	34	60"O.C.	68	60"O.C.	90	40"O.C.	90	40"O.C.	90	40"O.C.	90	40"O.C.	90	40"O.C.
	36	22	60"O.C.	45	60"O.C.	68	40"O.C.	90	30"O.C.	90	30"O.C.	90	30"O.C.	90	30"O.C.
	48	17	60"O.C.	34	60"O.C.	51	40"O.C.	68	30"O.C.	85	24"O.C.	90	20"O.C.	90	20"O.C.
	60	13	60"O.C.	27	60"O.C.	40	40"O.C.	54	30"O.C.	68	24"O.C.	81	20"O.C.	90	17"O.C.
	72	11	60"O.C.	22	60"O.C.	34	40"O.C.	45	30"O.C.	56	24"O.C.	68	20"O.C.	90	15"O.C.
	78	10	60"O.C.	20	60"O.C.	31	40"O.C.	41	30"O.C.	52	24"O.C.	62	20"O.C.	83	15"O.C.

FRANK BENNARDO, P.E.  
PE# 0046549 CA.9885



02/16/2021

FL#20665.3

**ENGINEERING EXPRESS®**  
CORPORATE OFFICE:  
160 SW 12th AVE, SUITE 106  
DEERFIELD BEACH, FL 33442  
(954) 354-0660 | (866) 396-9999  
TEAM@ENGINEERINGEXPRESS.COM  
ENGINEERINGEXPRESS.COM

**Oldcastle BuildingEnvelope®**

803 AIRPORT ROAD  
TERRELL, TX 75160  
Phn. (972) 551-6100

FG-5750T STORMMAX® THERMAL IGU IMPACT STOREFRONT SYSTEM  
WET AND DRY GLAZED

REMARKS	DRWN	CHKD	DATE
INIT ISSUE	JEM	AJP	07/23/20

COPYRIGHT ENGINEERING EXPRESS®

20-29229h

SCALE: NTS UNLESS NOTED

25

# MAXIMUM ALLOWABLE STRESS DESIGN PRESSURE RATING FOR STANDARD MULLIONS WITH HEAD, SILL AND JAMB CONNECTIONS-ANCHOR TYPE C

FRAME HEIGHT (H)	TRIBUTARY (W)	TOTAL NUMBER OF ANCHORS AT THE CLUSTER-ANCHOR TYPE C													
		2		4		6		8		10		12		16	
		MAX PRESSURE (PSF)	JAMBS MAX ANCHOR SPACING (IN)	MAX PRESSURE (PSF)	JAMBS MAX ANCHOR SPACING (IN)	MAX PRESSURE (PSF)	JAMBS MAX ANCHOR SPACING (IN)	MAX PRESSURE (PSF)	JAMBS MAX ANCHOR SPACING (IN)	MAX PRESSURE (PSF)	JAMBS MAX ANCHOR SPACING (IN)	MAX PRESSURE (PSF)	JAMBS MAX ANCHOR SPACING (IN)	MAX PRESSURE (PSF)	JAMBS MAX ANCHOR SPACING (IN)
132	24	30	66"O.C.	61	66"O.C.	90	44"O.C.	90	44"O.C.	90	44"O.C.	90	44"O.C.	90	44"O.C.
	36	20	66"O.C.	41	66"O.C.	61	44"O.C.	82	33"O.C.	90	26"O.C.	90	26"O.C.	90	26"O.C.
	48	15	66"O.C.	30	66"O.C.	46	44"O.C.	61	33"O.C.	77	26"O.C.	90	22"O.C.	90	22"O.C.
	60	12	66"O.C.	24	66"O.C.	37	44"O.C.	49	33"O.C.	61	26"O.C.	74	22"O.C.	90	17"O.C.
	72	10	66"O.C.	20	66"O.C.	30	44"O.C.	41	33"O.C.	51	26"O.C.	61	22"O.C.	82	17"O.C.
	78	9	66"O.C.	19	66"O.C.	28	44"O.C.	38	33"O.C.	47	26"O.C.	57	22"O.C.	76	17"O.C.
144	24	28	72"O.C.	56	72"O.C.	85	48"O.C.	90	36"O.C.	90	36"O.C.	90	36"O.C.	90	36"O.C.
	36	18	72"O.C.	37	72"O.C.	56	48"O.C.	75	36"O.C.	90	29"O.C.	90	29"O.C.	90	29"O.C.
	48	14	72"O.C.	28	72"O.C.	42	48"O.C.	56	36"O.C.	70	29"O.C.	85	24"O.C.	90	21"O.C.
	60	11	72"O.C.	22	72"O.C.	34	48"O.C.	45	36"O.C.	56	29"O.C.	68	24"O.C.	90	18"O.C.
	72	9	72"O.C.	18	72"O.C.	28	48"O.C.	37	36"O.C.	47	29"O.C.	56	24"O.C.	75	18"O.C.
	78	8	72"O.C.	17	72"O.C.	26	48"O.C.	34	36"O.C.	43	29"O.C.	52	24"O.C.	69	18"O.C.

FRANK BENNARDO, P.E.  
PE# 0046549 CA.9885



02/16/2021

FL#20665.3

**ENGINEERING EXPRESS®**  
CORPORATE OFFICE:  
160 SW 12th AVE, SUITE 106  
DEERFIELD BEACH, FL 33442  
(954) 354-0660 | (866) 396-9999  
TEAM@ENGINEERINGEXPRESS.COM  
ENGINEERINGEXPRESS.COM

**Oldcastle BuildingEnvelope®**

803 AIRPORT ROAD  
TERRELL, TX 75160  
Phn. (972) 551-6100

FG-5750T STORMMAX® THERMAL IGU IMPACT STOREFRONT SYSTEM  
WET AND DRY GLAZED

REMARKS	DRWN	CHKD	DATE
INIT ISSUE	JEM	AJP	07/23/20

COPYRIGHT ENGINEERING EXPRESS®

20-29229h

SCALE: NTS UNLESS NOTED

26

OF 38



FL#20665.3



CORPORATE OFFICE:  
160 SW 12th AVE, SUITE 106  
DEERFIELD BEACH, FL 33442  
(954) 354-0660 | (866) 396-9999  
TEAM@ENGINEERINGEXPRESS.COM  
ENGINEERINGEXPRESS.COM

**Oldcastle BuildingEnvelope®**  
803 AIRPORT ROAD  
TERRELL, TX 75160  
Phn. (972) 551-6100

FG-5750T STORMMAX® THERMAL IGU IMPACT STOREFRONT SYSTEM  
WET AND DRY GLAZED

REMARKS	DRWN	CHKD	DATE
INIT ISSUE	JEM	AJP	07/23/20

COPYRIGHT ENGINEERING EXPRESS®

20-29229h

SCALE: NTS UNLESS NOTED

27 OF 38

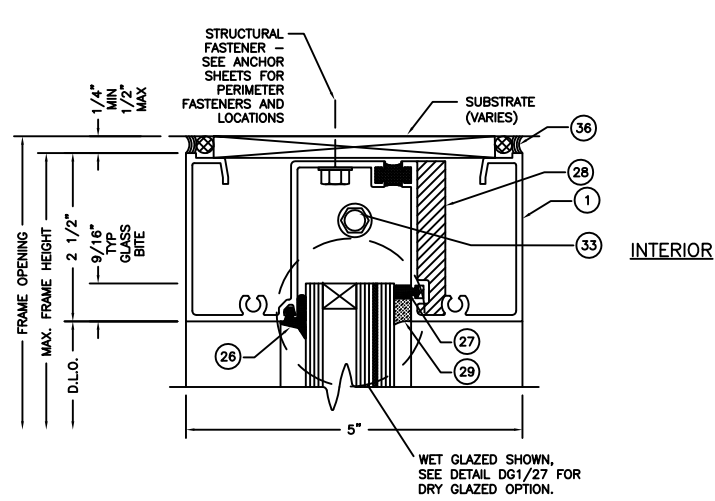

1 HEAD  
27 LIMITED TO +70 / -70 P.S.F

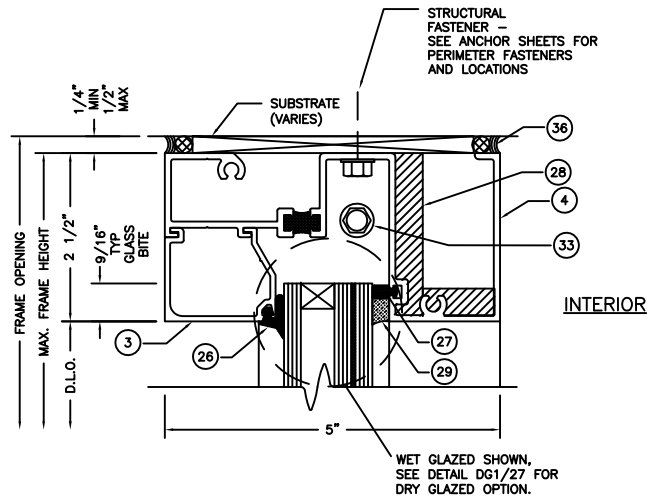

4 INVERTED HEAD  
27 LIMITED TO +70 / -70 P.S.F

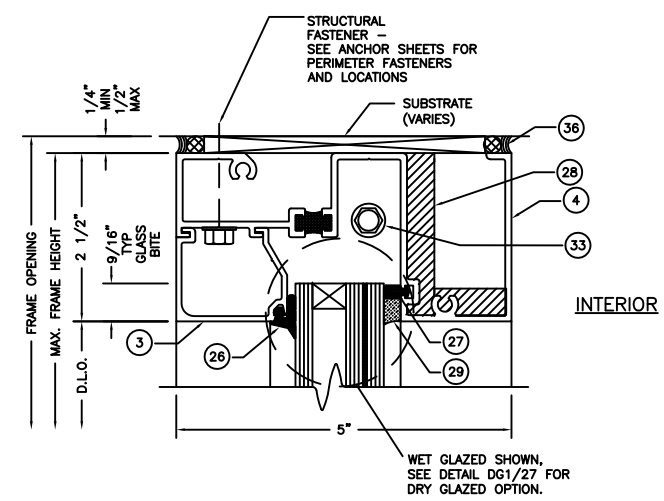

4A ALTERNATE INVERTED HEAD  
27 LIMITED TO +70 / -70 P.S.F

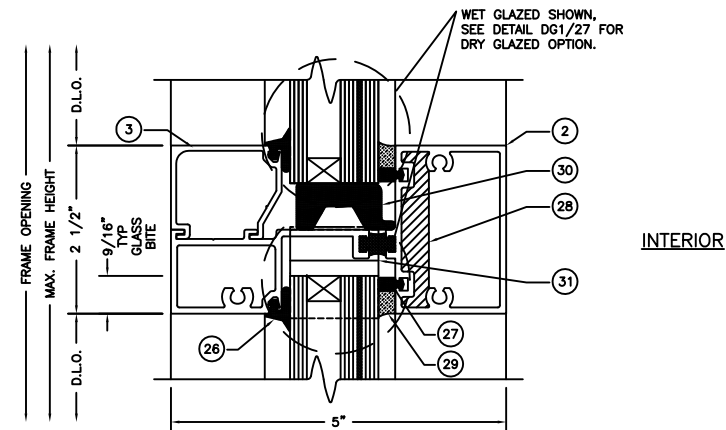

2 INTERMEDIATE HORIZONTAL  
27 LIMITED TO +70 / -70 P.S.F

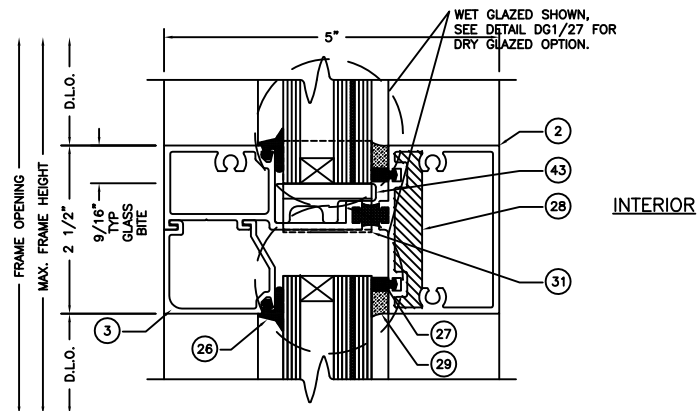

5 INVERTED INTERMEDIATE HORIZONTAL  
27 LIMITED TO +70 / -70 P.S.F

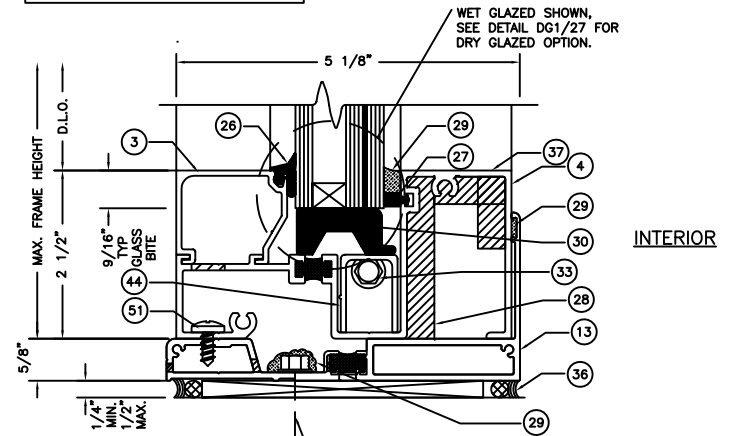

7 ALTERNATE SILL 1A  
27 LIMITED TO +70 / -70 P.S.F

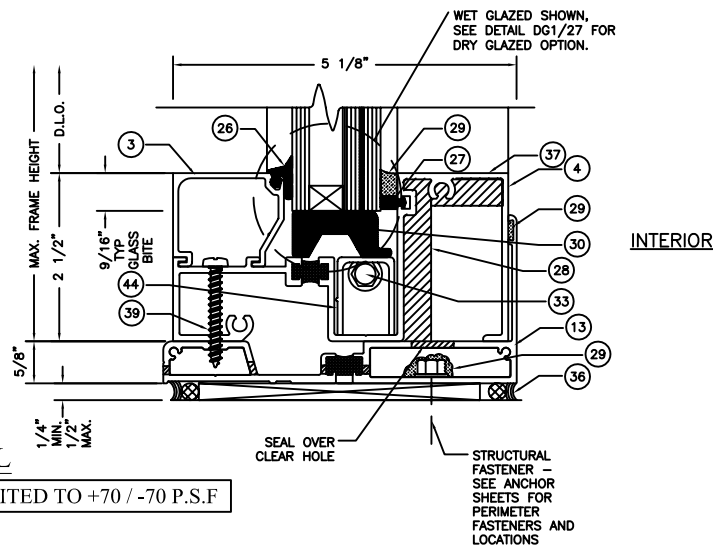

3 SILL  
27 LIMITED TO +70 / -70 P.S.F

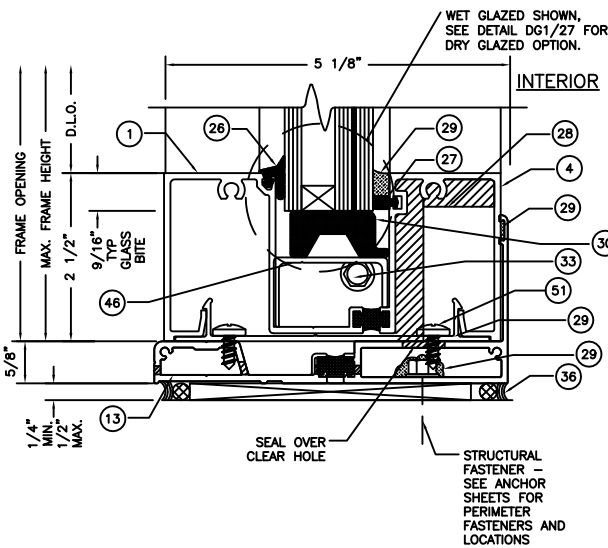

6 INVERTED SILL  
27 LIMITED TO +70 / -70 P.S.F

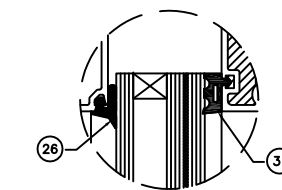

DG1 DRY GLAZED OPTION  
27

LOCATE REINFORCEMENT FASTENERS  
1" FROM EACH END.

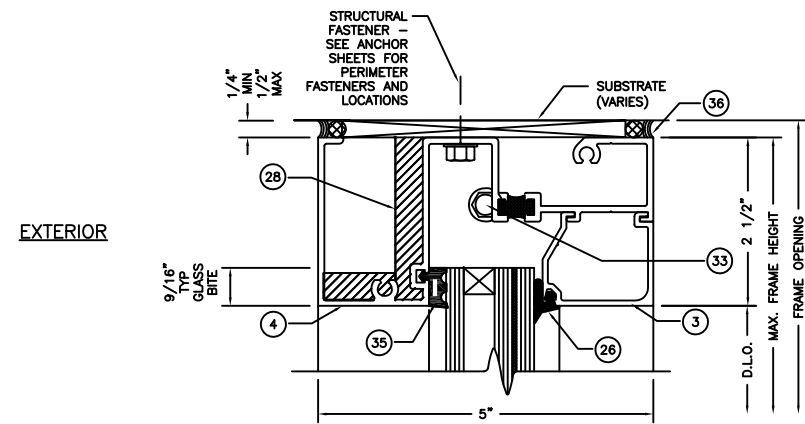

9  
28 **INSIDE GLAZED HEAD**  
LIMITED TO +70 / -70 P.S.F

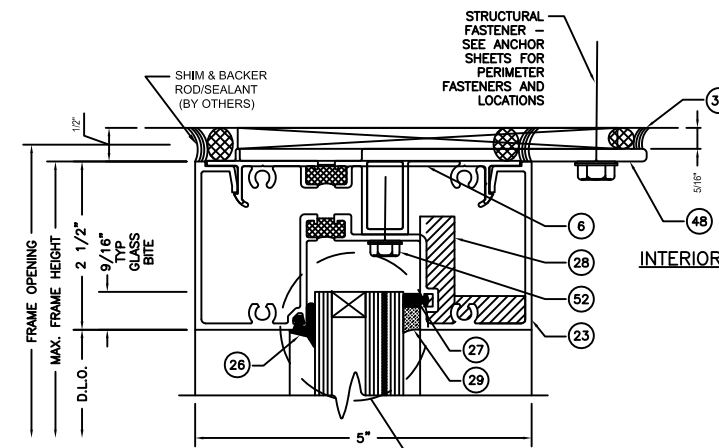

10.1  
28 **PRE-GLAZED HEAD**  
LIMITED TO +75 / -75 P.S.F

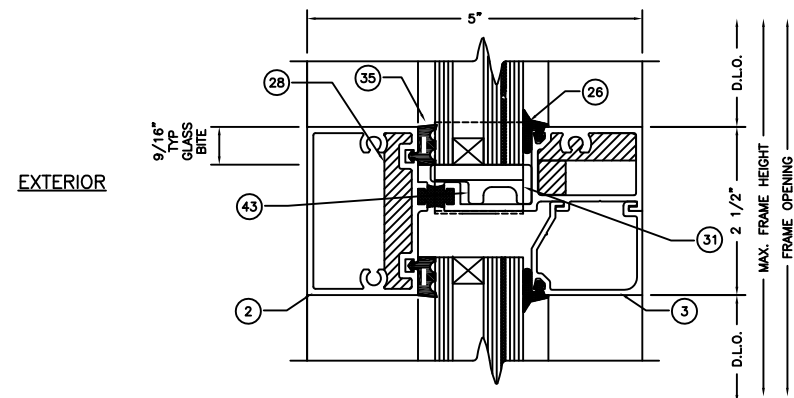

10  
28 **INSIDE GLAZED INTERMEDIATE HORIZONTAL**

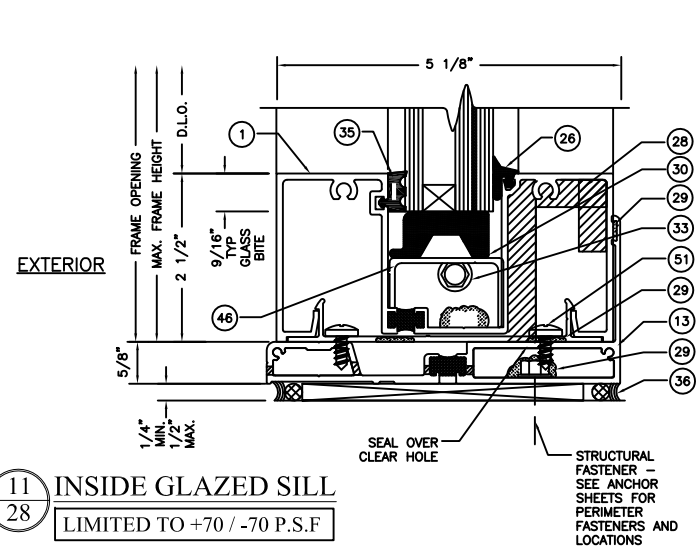

11  
28 **INSIDE GLAZED SILL**  
LIMITED TO +70 / -70 P.S.F

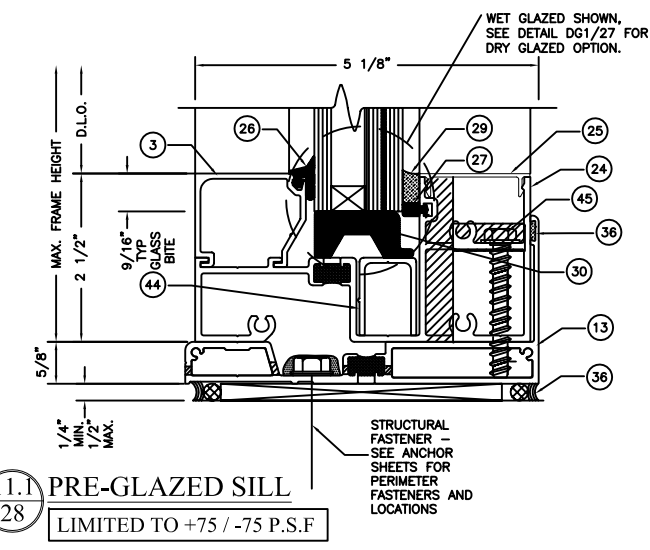

11.1  
28 **PRE-GLAZED SILL**  
LIMITED TO +75 / -75 P.S.F

LOCATE REINFORCEMENT FASTENERS  
1" FROM EACH END.



FL#20665.3

**ENGINEERING EXPRESS®**  
CORPORATE OFFICE:  
160 SW 12th AVE, SUITE 106  
DEERFIELD BEACH, FL 33442  
(954) 354-0660 | (866) 396-9999  
TEAM@ENGINEERINGEXPRESS.COM  
ENGINEERINGEXPRESS.COM

**Oldcastle BuildingEnvelope®**  
803 AIRPORT ROAD  
TERRELL, TX 75160  
Phn. (972) 551-6100  
FG-5750T STORMMAX® THERMAL IGU IMPACT STOREFRONT SYSTEM  
WET AND DRY GLAZED

REMARKS	DRWN	CHKD	DATE
INIT ISSUE	JEM	AJP	07/23/20

COPYRIGHT ENGINEERING EXPRESS®

20-29229h

SCALE: NTS UNLESS NOTED



FL#20665.3

**ENGINEERING EXPRESS®**  
CORPORATE OFFICE:  
160 SW 12th AVE, SUITE 106  
DEERFIELD BEACH, FL 33442  
(954) 354-0660 | (866) 396-9999  
TEAM@ENGINEERINGEXPRESS.COM  
ENGINEERINGEXPRESS.COM

**Oldcastle BuildingEnvelope®**  
803 AIRPORT ROAD  
TERRELL, TX 75160  
Phn. (972) 551-6100

FG-5750T STORMMAX® THERMAL IGU IMPACT STOREFRONT SYSTEM  
WET AND DRY GLAZED

REMARKS	DATE	DRWN	CHKD
INIT ISSUE	07/23/20	JEM	AJP

COPYRIGHT ENGINEERING EXPRESS®

20-29229h

SCALE: NTS UNLESS NOTED

29 OF 38

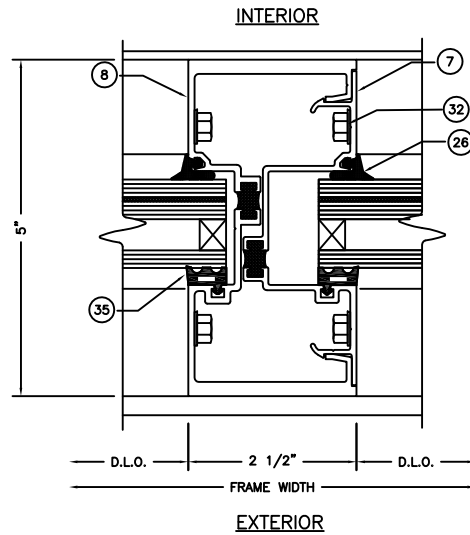

12  
29 INSIDE SET VERTICAL  
M1

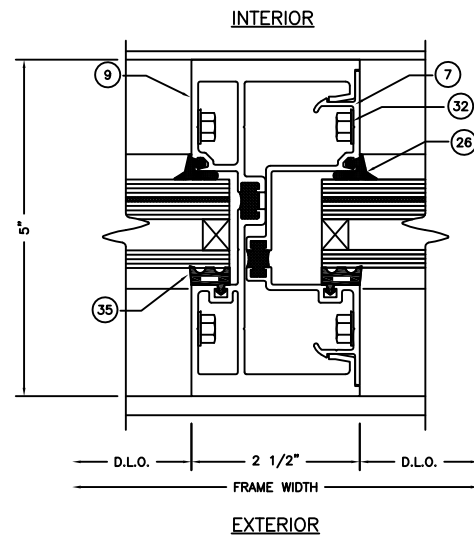

13  
29 INSIDE SET HEAVY VERTICAL  
M3

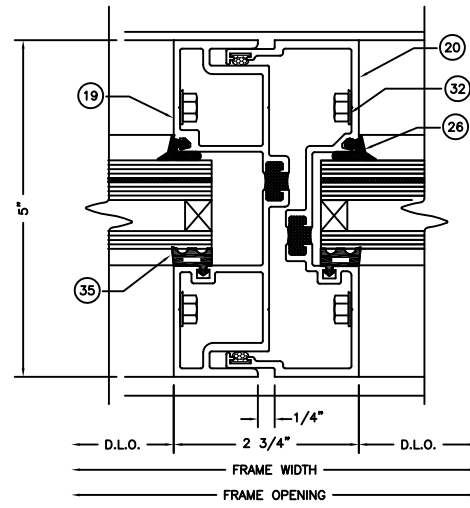

14  
29 INSIDE SET EXPANSION  
VERTICAL  
M2

NOTE: APPROVED FOR USE  
OUTSIDE HVHZ

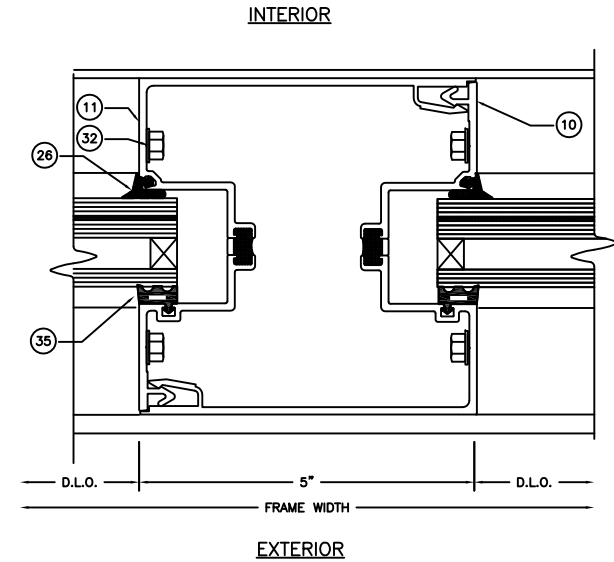

15  
29 INSIDE SET 5" VERTICAL MULLION  
M7

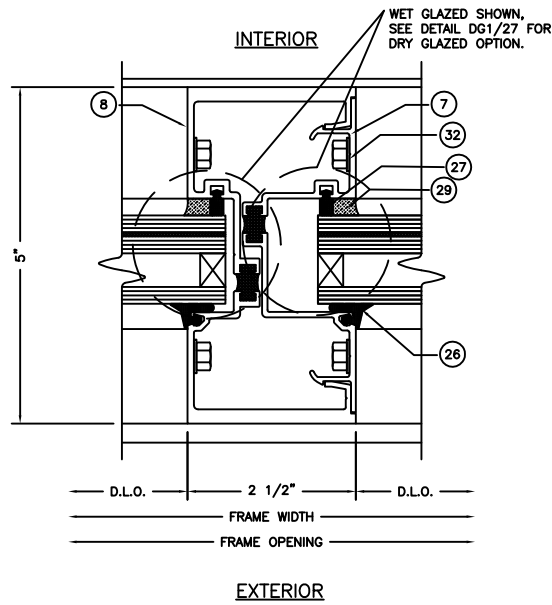

16  
29 STANDARD VERTICAL  
M1

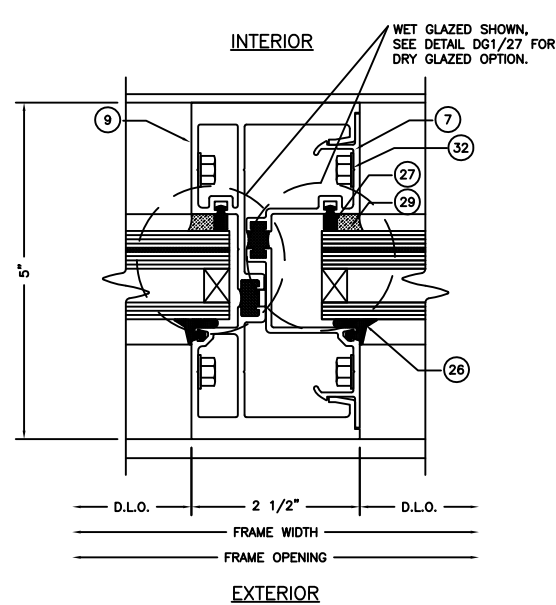

17  
29 HEAVY VERTICAL  
M4

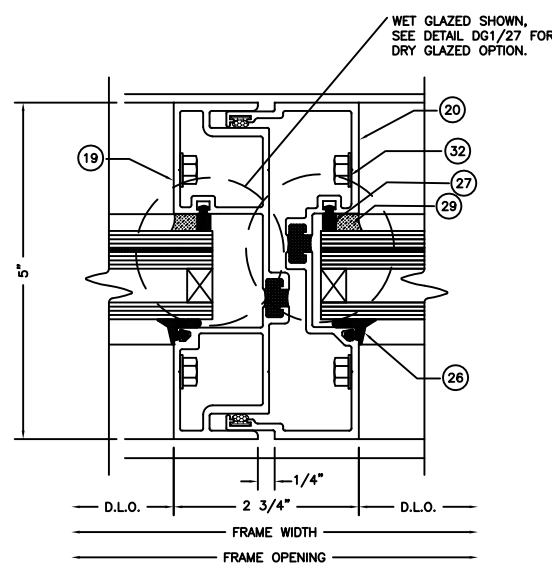

18  
29 EXPANSION VERTICAL  
M2

NOTE: APPROVED FOR USE  
OUTSIDE HVHZ

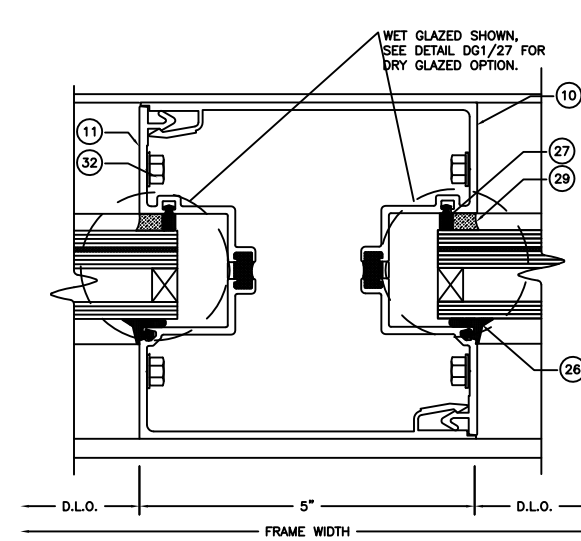

19  
29 5" VERTICAL MULLION  
M7



FL#20665.3

**ENGINEERING EXPRESS®**  
CORPORATE OFFICE:  
160 SW 12th AVE, SUITE 106  
DEERFIELD BEACH, FL 33442  
(954) 354-0660 | (866) 396-9999  
TEAM@ENGINEERINGEXPRESS.COM  
ENGINEERINGEXPRESS.COM

**Oldcastle BuildingEnvelope®**  
803 AIRPORT ROAD  
TERRELL, TX 75160  
Phn. (972) 551-6100  
FG-5750T STORMMAX® THERMAL IGU IMPACT STOREFRONT SYSTEM  
WET AND DRY GLAZED

REMARKS	DATE
INIT ISSUE	07/23/20
DRWN	
CHKD	
JEM	
AJP	

COPYRIGHT ENGINEERING EXPRESS®

20-29229h

SCALE: NTS UNLESS NOTED

30 OF 38

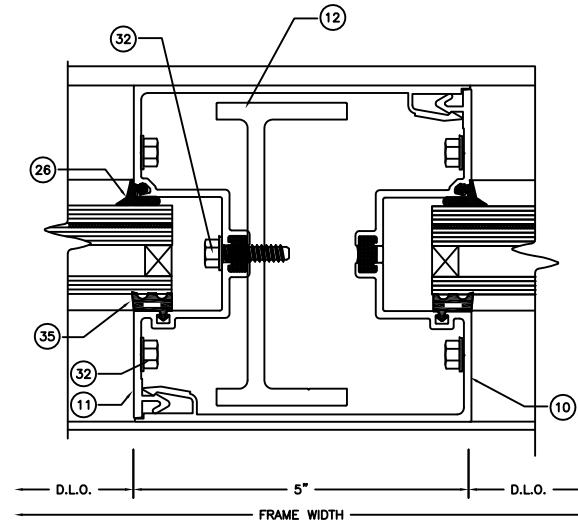

20  
30 **INSIDE SET 5" VERTICAL MULLION WITH FG-5720 REINFORCEMENT**

NOTE:  
MULLION CAN BE USED UNDER SITE SPECIFIC ENGINEERING AND SHALL BE APPROVED BY THE AUTHORITY HAVING JURISDICTION (AHJ).

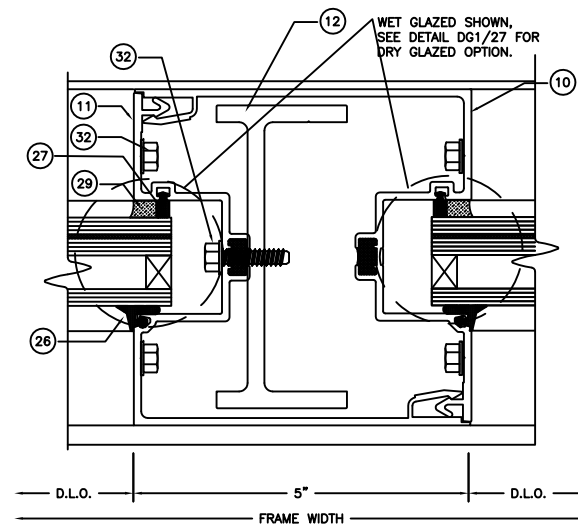

23  
30 **5" VERTICAL MULLION WITH FG-5720 REINFORCEMENT**

NOTE:  
MULLION CAN BE USED UNDER SITE SPECIFIC ENGINEERING AND SHALL BE APPROVED BY THE AUTHORITY HAVING JURISDICTION (AHJ).

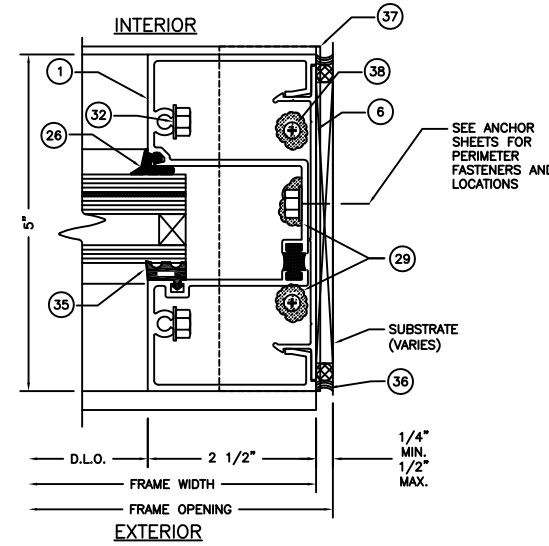

21  
30 **INSIDE SET JAMB VERTICAL**

21.1  
30 **INSIDE SET JAMB VERTICAL (NON ANCHORED)**

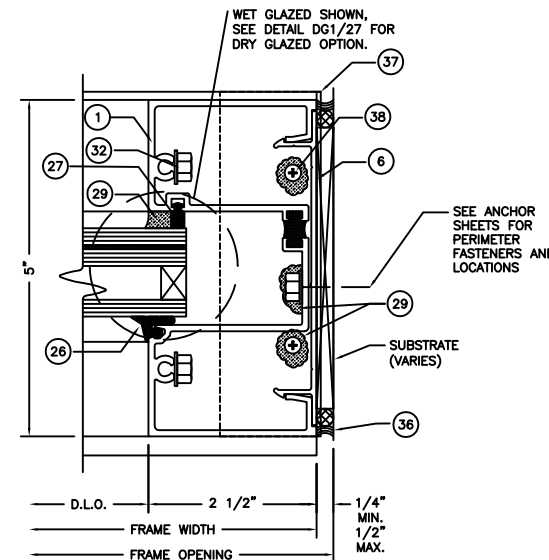

24  
30 **JAMB VERTICAL**

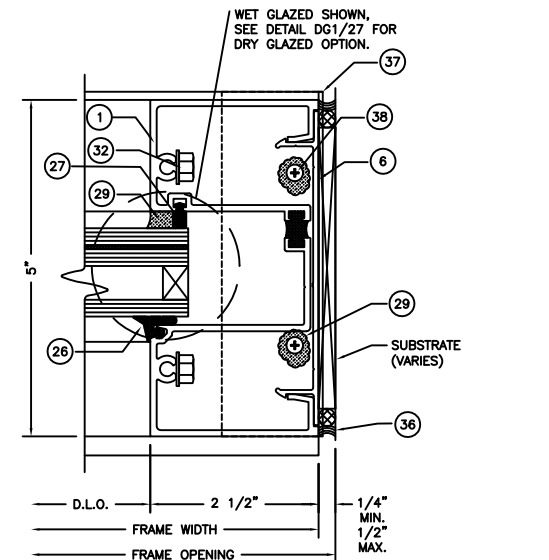

24.1  
30 **JAMB VERTICAL (NON ANCHORED)**

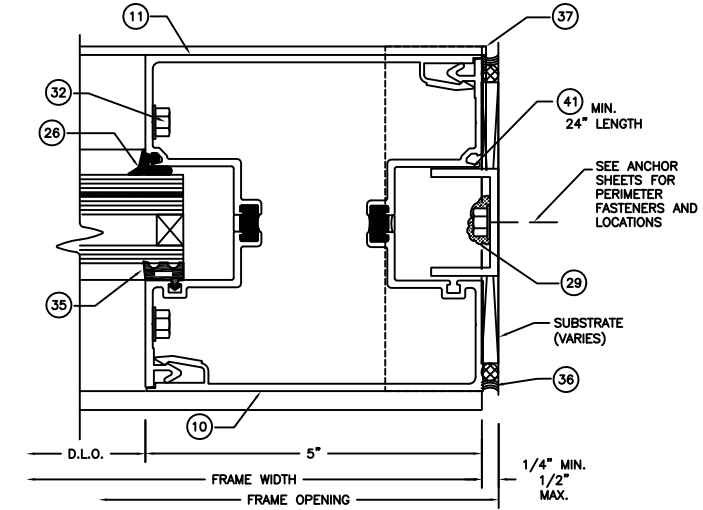

22  
30 **INSIDE SET 5" JAMB VERTICAL**

NOTE:  
MULLION CAN BE USED UNDER SITE SPECIFIC ENGINEERING AND SHALL BE APPROVED BY THE AUTHORITY HAVING JURISDICTION (AHJ).

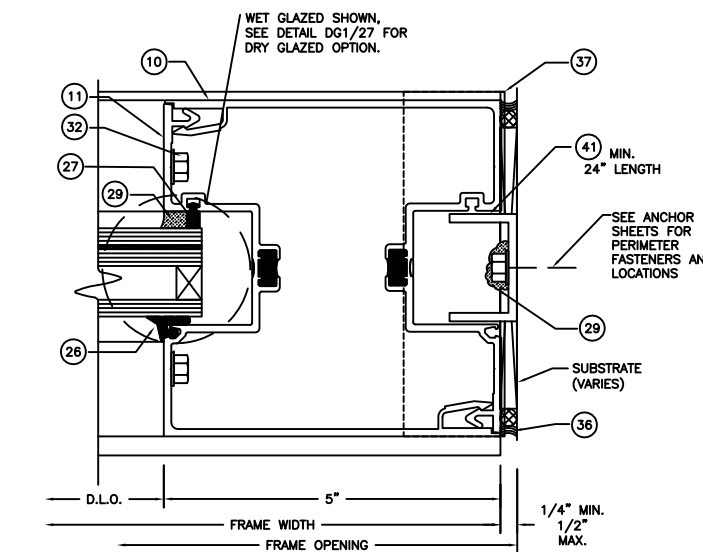

25  
30 **5" JAMB VERTICAL**

NOTE:  
MULLION CAN BE USED UNDER SITE SPECIFIC ENGINEERING AND SHALL BE APPROVED BY THE AUTHORITY HAVING JURISDICTION (AHJ).

LOCATE REINFORCEMENT FASTENERS  
1" FROM EACH END.

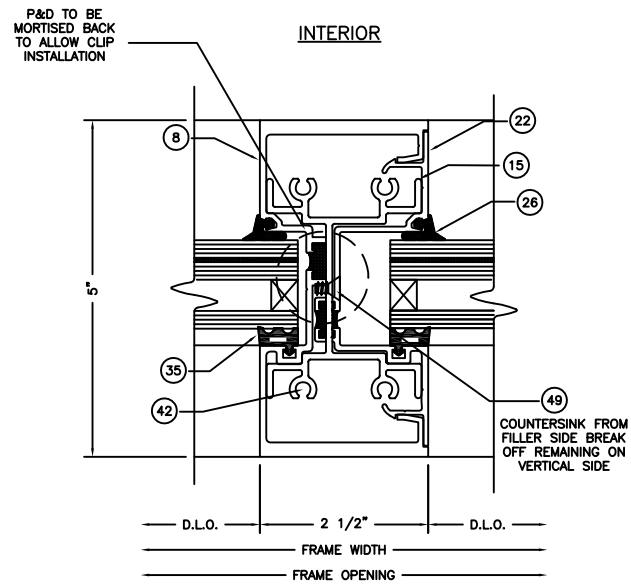

26  
31 INSIDE SET CRIPPLED VERTICAL

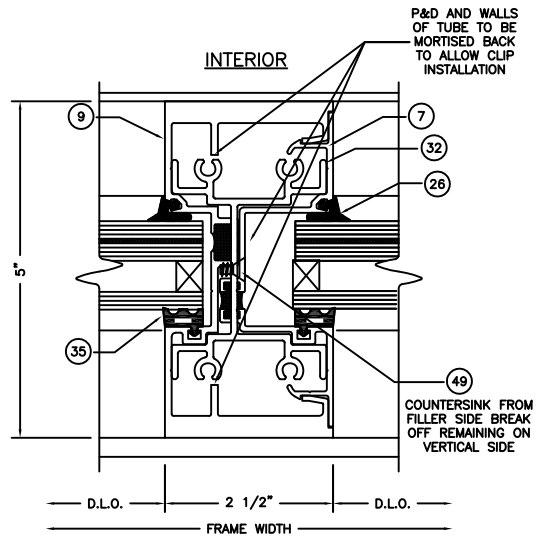

27  
31 INSIDE SET CRIPPLED HEAVY VERTICAL

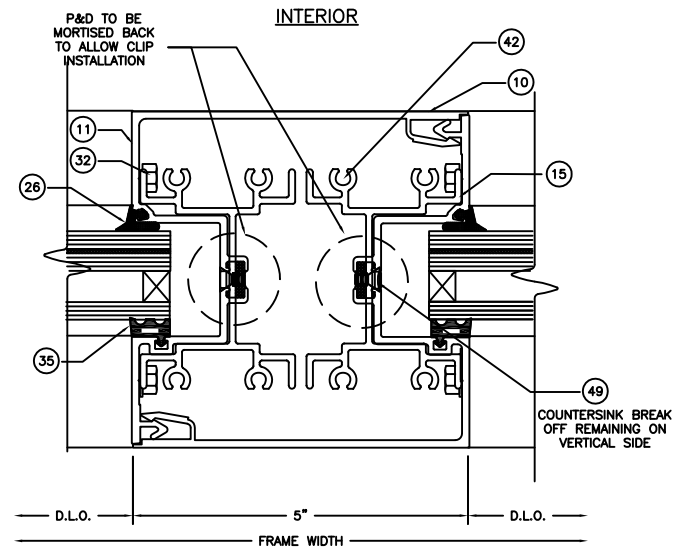

28  
31 INSIDE SET CRIPPLED 5" VERTICAL MULLION

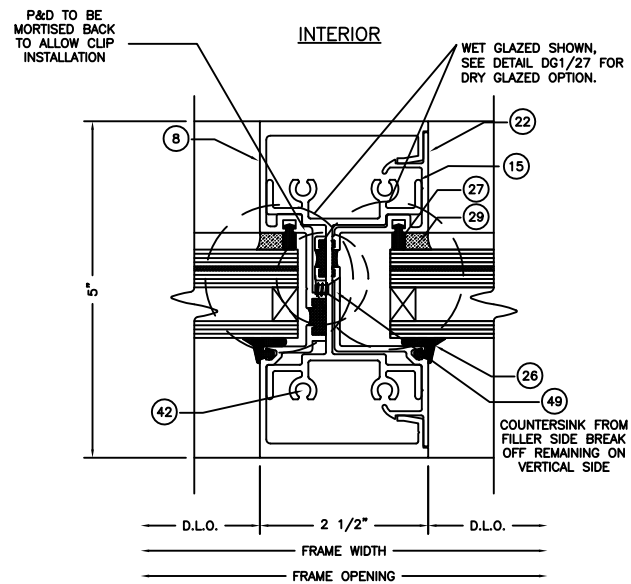

29  
31 CRIPPLED VERTICAL

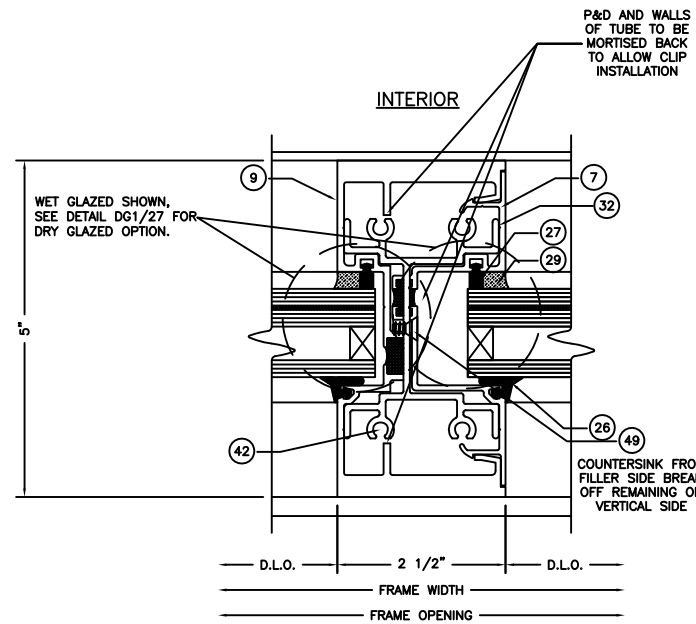

30  
31 CRIPPLED HEAVY VERTICAL

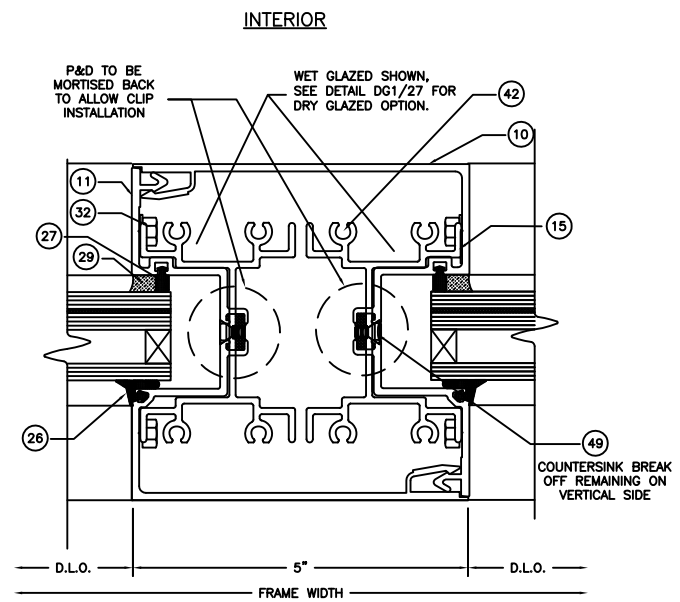

31  
31 CRIPPLED 5" VERTICAL MULLION

SHEAR BLOCKS USE FOUR  
(4) 42 FASTENERS EACH.

NOTE:  
CRIPPLED VERTICAL MULLIONS SHOWN  
HEREIN CAN BE USED UNDER SITE SPECIFIC  
ENGINEERING AND SHALL BE APPROVED BY  
THE AUTHORITY HAVING JURISDICTION (AHJ).



**ENGINEERING EXPRESS**  
CORPORATE OFFICE:  
160 SW 12th AVE, SUITE 106  
DEERFIELD BEACH, FL 33442  
(954) 354-0660 | (866) 396-9999  
TEAM@ENGINEERINGEXPRESS.COM  
ENGINEERINGEXPRESS.COM

**Oldcastle BuildingEnvelope**<sup>®</sup>  
803 AIRPORT ROAD  
TERRELL, TX 75160  
Phn. (972) 551-6100  
FG-5750T STORMMAX<sup>®</sup> THERMAL IGU IMPACT STOREFRONT SYSTEM  
WET AND DRY GLAZED

REMARKS	DATE	DRWN	CHKD
INIT ISSUE	07/23/20	JEM	AJP

COPYRIGHT ENGINEERING EXPRESS<sup>®</sup>

20-29229h

SCALE: NTS UNLESS NOTED



FL#20665.3

**ENGINEERING EXPRESS®**  
CORPORATE OFFICE:  
160 SW 12th AVE, SUITE 106  
DEERFIELD BEACH, FL 33442  
(954) 354-0660 | (866) 396-9999  
TEAM@ENGINEERINGEXPRESS.COM  
ENGINEERINGEXPRESS.COM

**Oldcastle BuildingEnvelope®**  
803 AIRPORT ROAD  
TERRELL, TX 75160  
Phn. (972) 551-6100  
FG-5750T STORMMAX® THERMAL IGU IMPACT STOREFRONT SYSTEM  
WET AND DRY GLAZED

REMARKS	DATE
INIT ISSUE	07/23/20
DRWN	
CHKD	
JEM	
AJP	

COPYRIGHT ENGINEERING EXPRESS®

20-29229h

SCALE: NTS UNLESS NOTED

32 OF 38

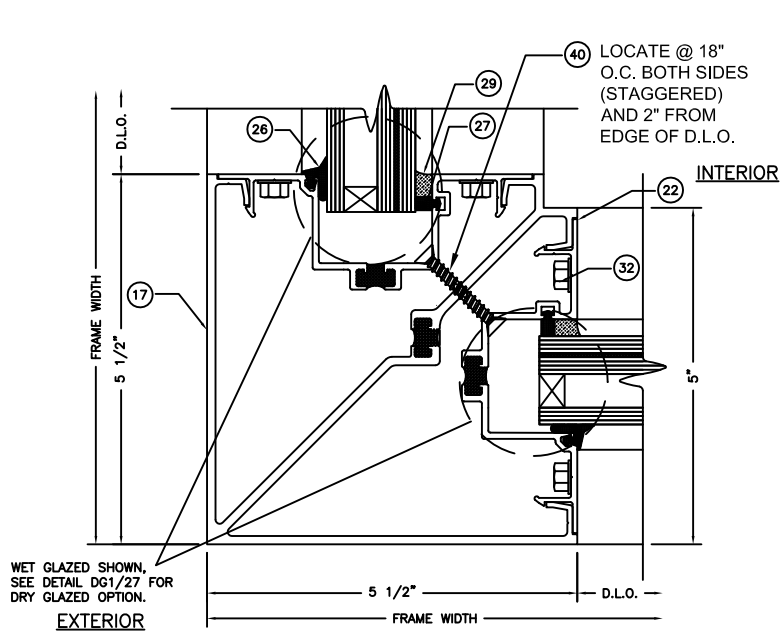

**32** 90° CORNER POST  
**32** M5  
NOTE: APPROVED FOR USE OUTSIDE HVHZ

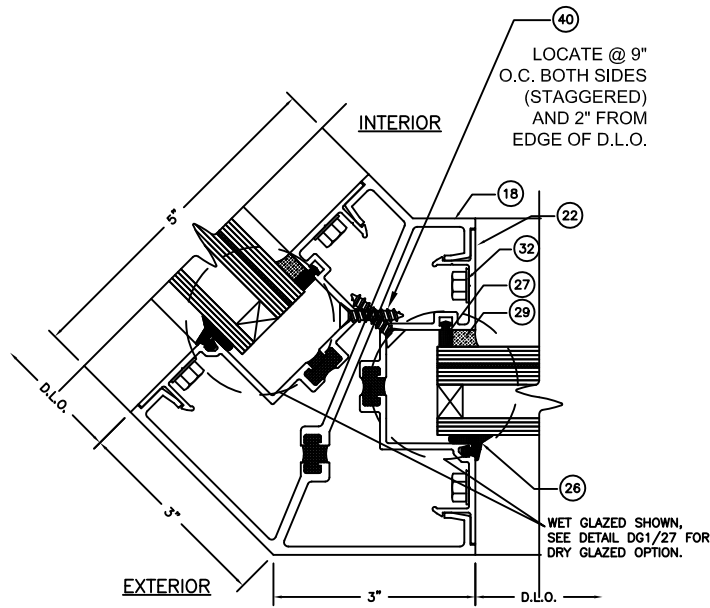

**33** 135° CORNER POST  
**32** M6  
NOTE: APPROVED FOR USE OUTSIDE HVHZ

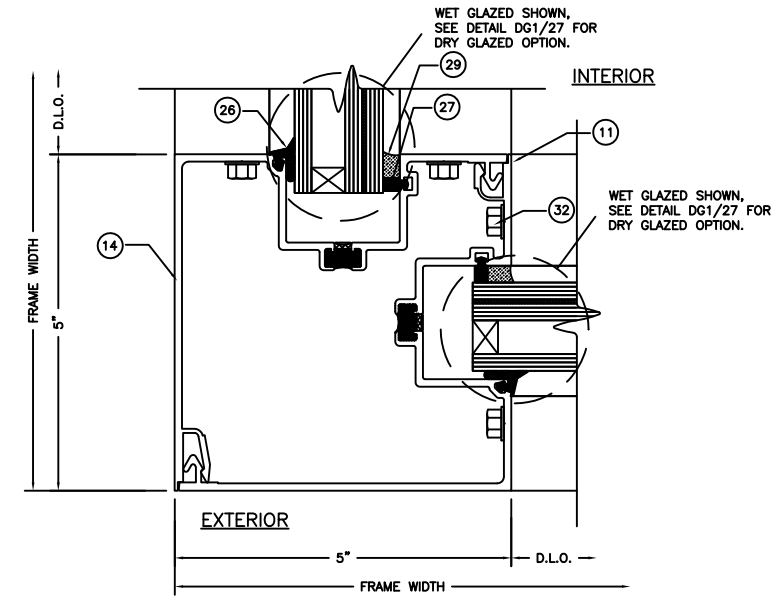

**34** 90° CORNER POST  
**32** NOTE: MULLION CAN BE USED UNDER SITE SPECIFIC ENGINEERING AND SHALL BE APPROVED BY THE AUTHORITY HAVING JURISDICTION (AHJ).

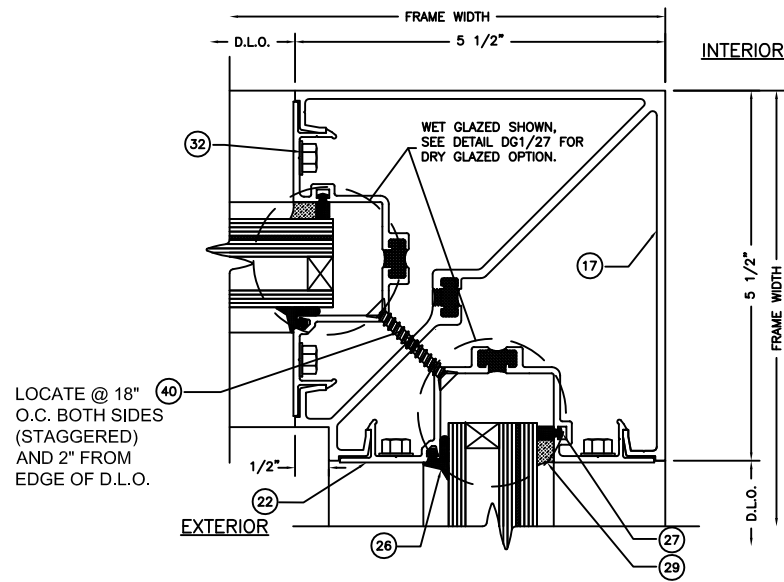

**35** 90° INSIDE CORNER POST  
**32** M5  
NOTE: APPROVED FOR USE OUTSIDE HVHZ

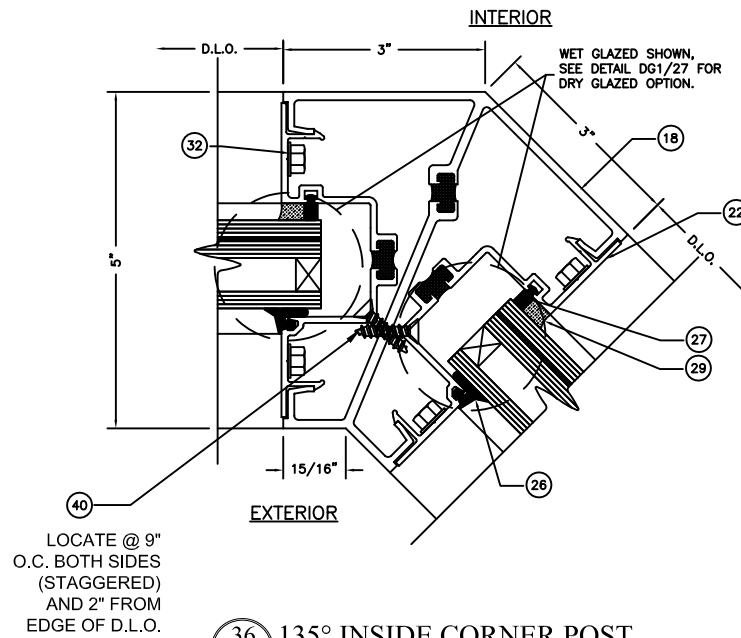

**36** 135° INSIDE CORNER POST  
**32** M6  
NOTE: APPROVED FOR USE OUTSIDE HVHZ

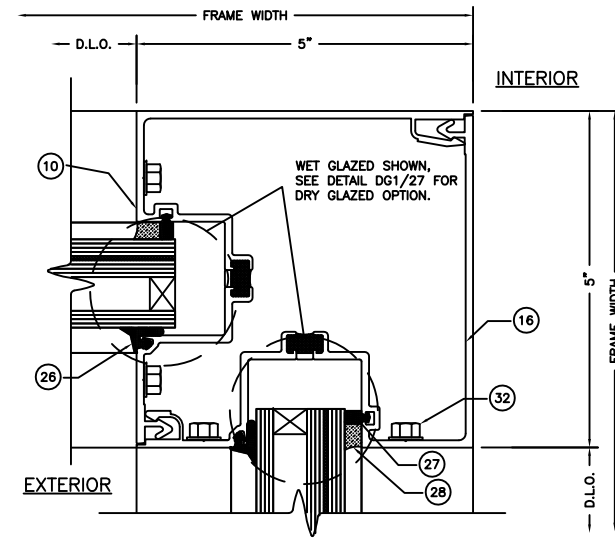

**37** INSIDE 90° CORNER ASSEMBLY  
**32** NOTE: MULLION CAN BE USED UNDER SITE SPECIFIC ENGINEERING AND SHALL BE APPROVED BY THE AUTHORITY HAVING JURISDICTION (AHJ).





FL#20665.3

**ENGINEERING EXPRESS**  
CORPORATE OFFICE:  
160 SW 12th AVE, SUITE 106  
DEERFIELD BEACH, FL 33442  
(954) 354-0660 | (866) 396-9999  
TEAM@ENGINEERINGEXPRESS.COM  
ENGINEERINGEXPRESS.COM

**Oldcastle BuildingEnvelope**<sup>®</sup>  
803 AIRPORT ROAD  
TERRELL, TX 75160  
Phn. (972) 551-6100

FG-5750T STORMMAX<sup>®</sup> THERMAL IGU IMPACT STOREFRONT SYSTEM  
WET AND DRY GLAZED

REMARKS	DRWN	CHKD	DATE
INIT ISSUE	JEM	AJP	07/23/20

COPYRIGHT ENGINEERING EXPRESS<sup>®</sup>

20-29229h

SCALE: NTS UNLESS NOTED

33 OF 38

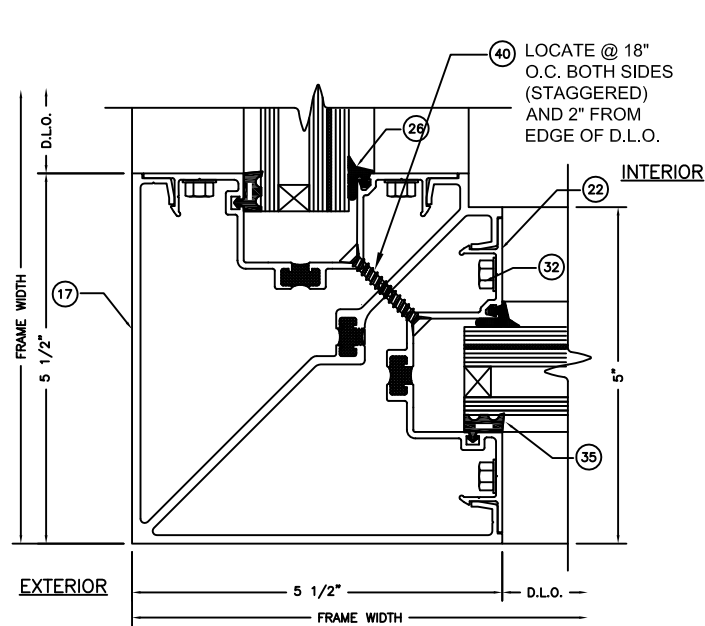

38 INSIDE SET 90° CORNER POST  
33 M5  
NOTE: APPROVED FOR USE  
OUTSIDE HVHZ

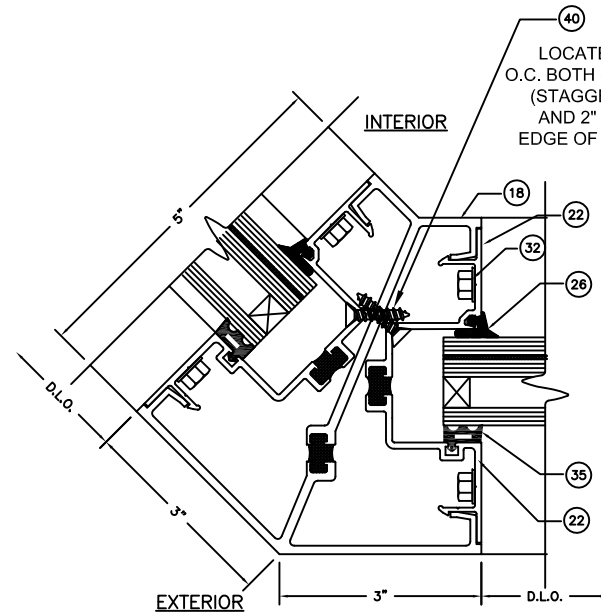

39 INSIDE SET 135° CORNER POST  
33 M6  
NOTE: APPROVED FOR USE  
OUTSIDE HVHZ

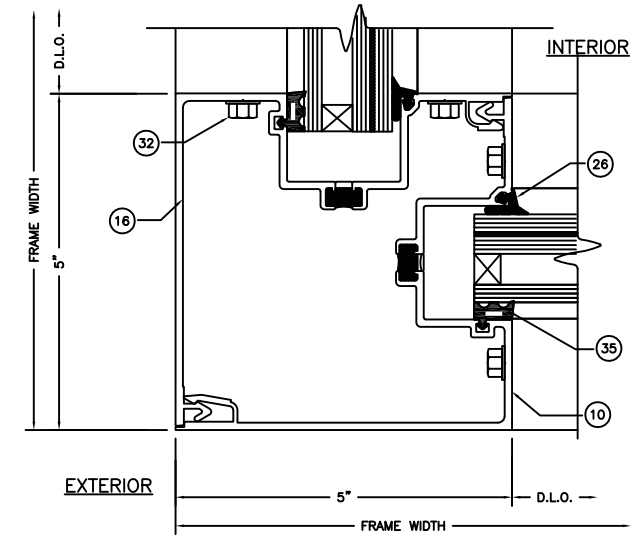

40 INSIDE SET 90° CORNER POST  
33  
NOTE:  
MULLION CAN BE USED UNDER SITE SPECIFIC  
ENGINEERING AND SHALL BE APPROVED BY  
THE AUTHORITY HAVING JURISDICTION (AHJ).

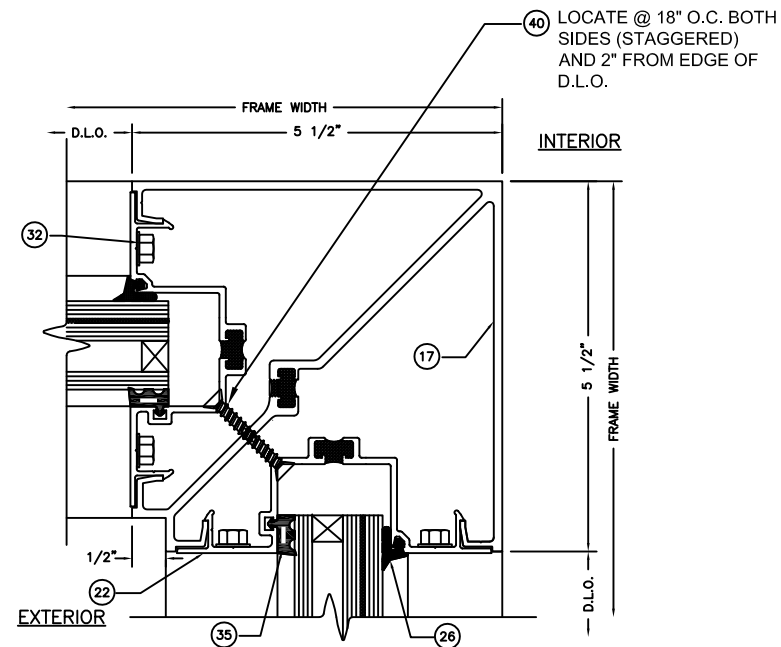

41 INSIDE SET 90° INSIDE CORNER POST  
33 M5  
NOTE: APPROVED FOR USE  
OUTSIDE HVHZ

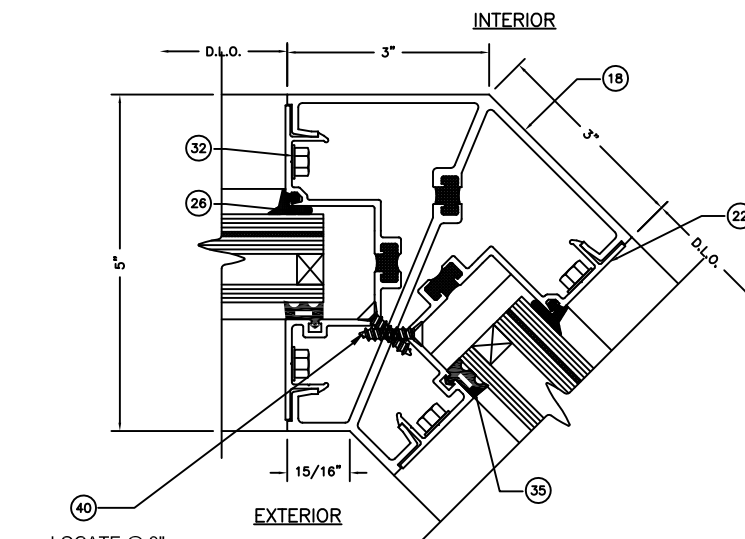

42 INSIDE SET 135° INSIDE CORNER POST  
33 M6  
NOTE: APPROVED FOR USE  
OUTSIDE HVHZ

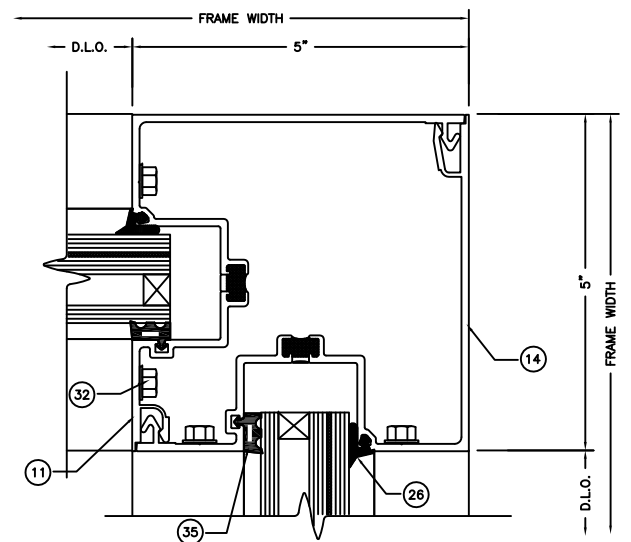

43 INSIDE SET INSIDE 90° CORNER ASSEMBLY  
33  
NOTE:  
MULLION CAN BE USED UNDER SITE SPECIFIC  
ENGINEERING AND SHALL BE APPROVED BY  
THE AUTHORITY HAVING JURISDICTION (AHJ).

C:\Users\joem\appdata\local\temp\AcPublish\_3432\OBE - FG-5750T.dwg  
joem  
02/16/2021 - 1:50pm

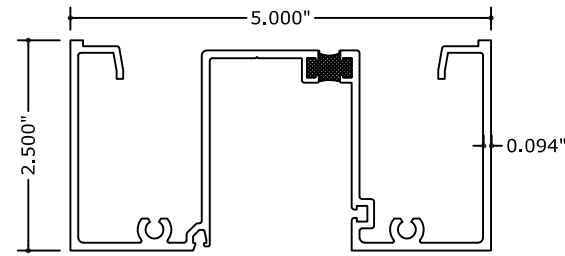

1 FGT-5770  
HEAD/SILL/JAMB

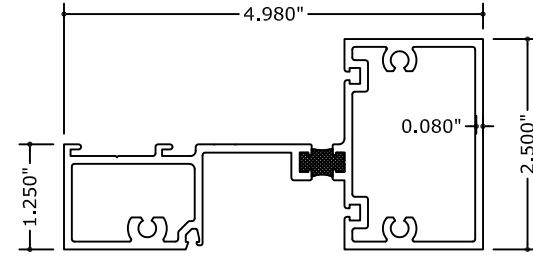

2 FGT-5772  
HORIZONTAL

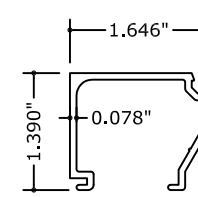

3 FG-5760  
GLASS STOP

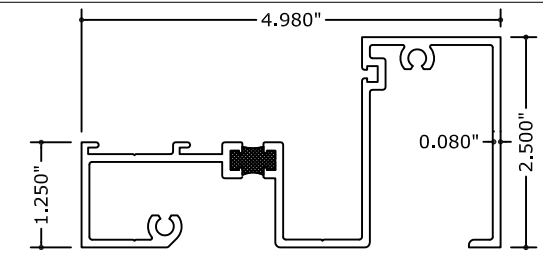

4 FGT-5771  
SILL/HEAD

NOT USED

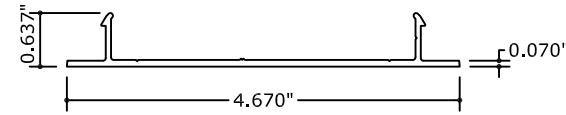

6 FG-5715  
FLAT FILLER

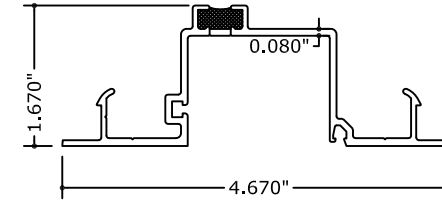

7 FGT-5780  
SNAP-IN FILLER

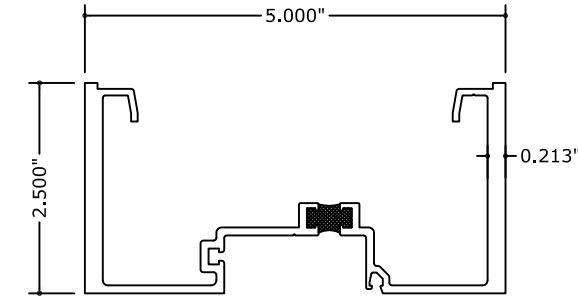

8 FGT-5773  
STANDARD VERTICAL

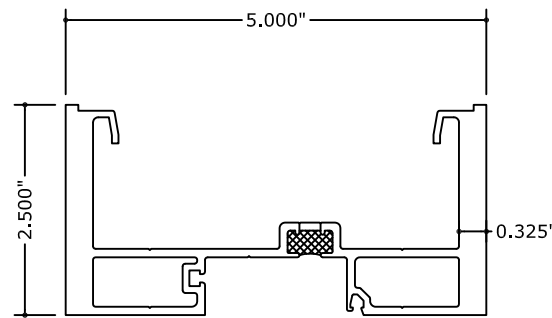

9 FGT-5774  
HEAVY VERTICAL MULLION

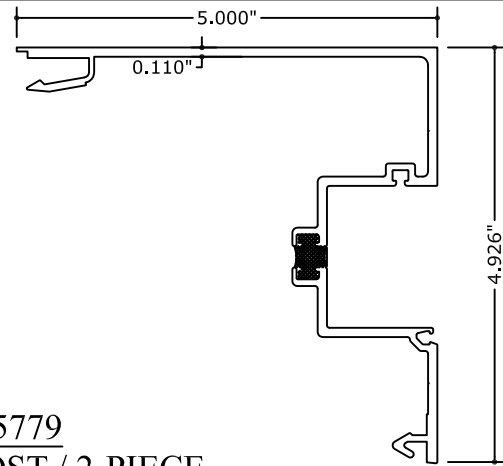

10 FGT-5779  
5" POST / 2-PIECE  
CORNER POST

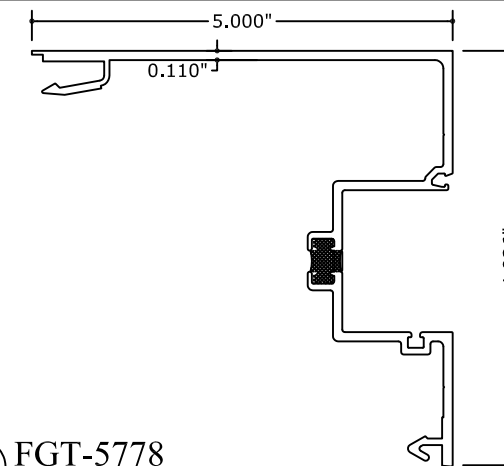

11 FGT-5778  
5" VERTICAL POST

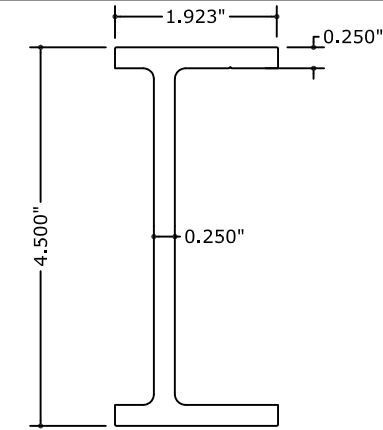

12 FG-5720  
ALUMINUM STIFFENER

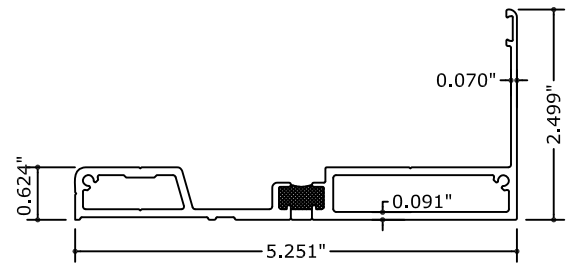

13 FGT-5712  
5/8" SUBSILL

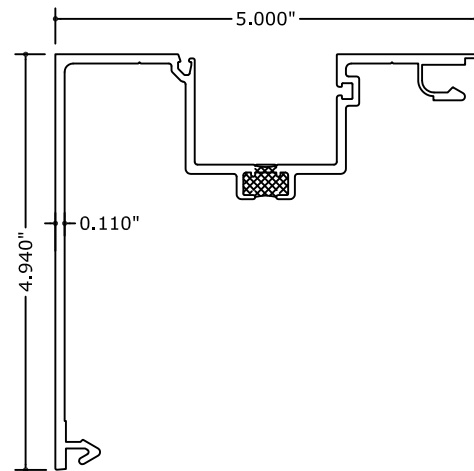

14 FGT-5784 5" POST /  
2-PIECE CORNER POST

NOT USED

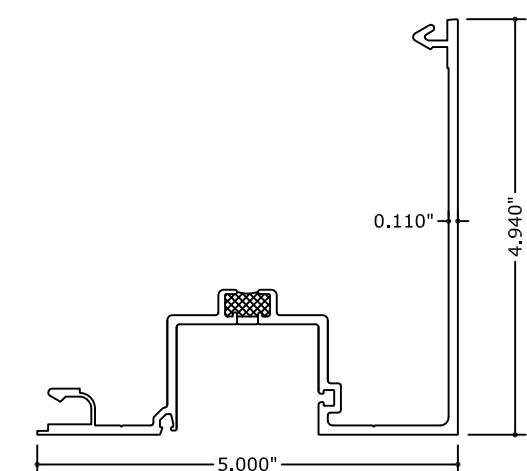

16 FGT-5785 5" POST /  
2-PIECE CORNER POST



**ENGINEERING EXPRESS**  
CORPORATE OFFICE:  
160 SW 12th AVE, SUITE 106  
DEERFIELD BEACH, FL 33442  
(954) 354-0660 | (866) 396-9999  
TEAM@ENGINEERINGEXPRESS.COM  
ENGINEERINGEXPRESS.COM

**Oldcastle BuildingEnvelope**<sup>®</sup>  
803 AIRPORT ROAD  
TERRELL, TX 75160  
Phn. (972) 551-6100  
FG-5750T STORMMAX<sup>®</sup> THERMAL IGU IMPACT STOREFRONT SYSTEM  
WET AND DRY GLAZED

REMARKS	DRWN	CHKD	DATE
INIT ISSUE	JEM	AJP	07/23/20

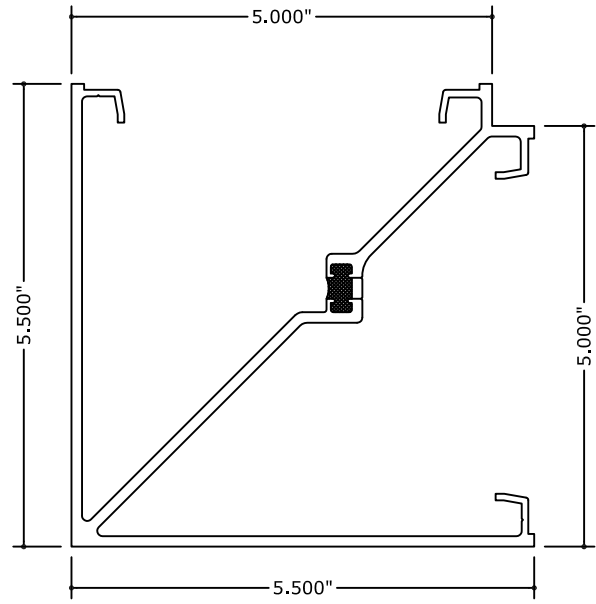

17 FGT-5706  
90 DEGREE CORNER POST

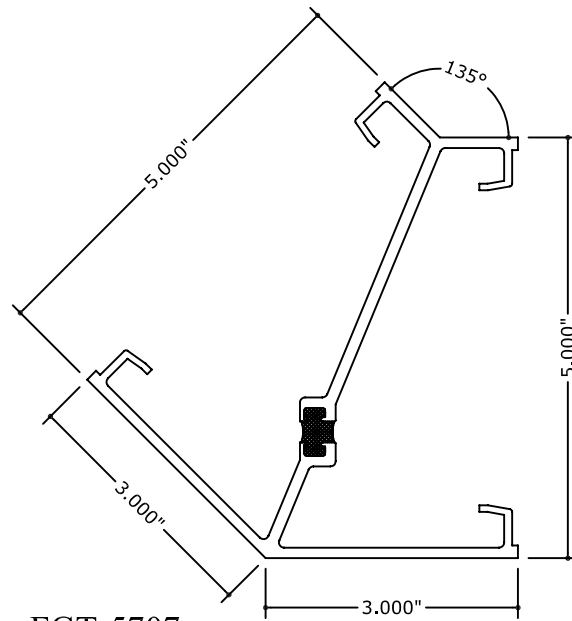

18 FGT-5707  
135 DEGREE CORNER POST

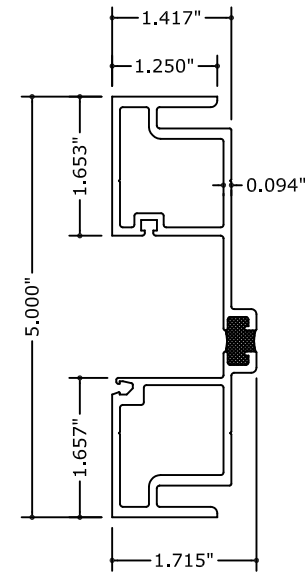

19 FGT-5782  
EXPANSION MULLION (FEMALE)

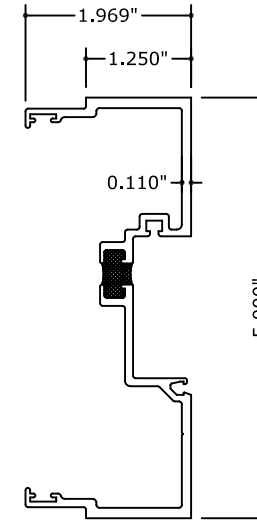

20 FGT-5783  
EXPANSION MULLION (MALE)

NOT USED

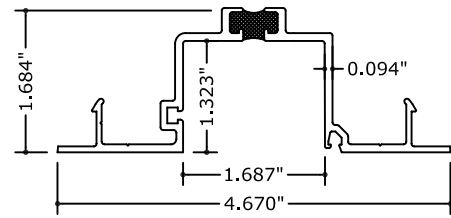

22 FGT-5781  
DEEP POCKET FILLER

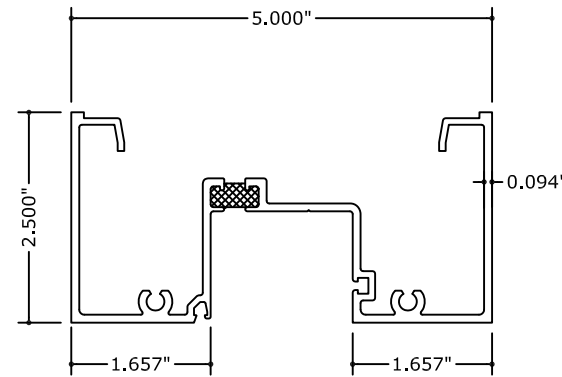

23 FGT-5786  
PRE-GLAZED HEAD

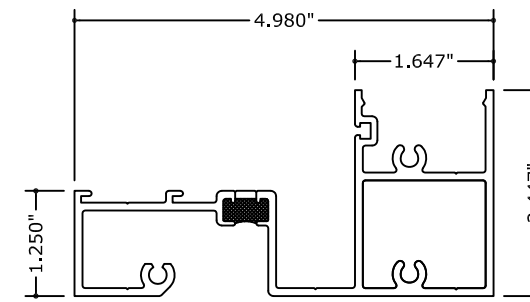

24 FGT-5787  
PRE-GLAZED SILL

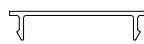

25 FG-5259  
PRE-GLAZED SILL FILLER



26 FG-5730  
EXTERIOR GLAZING GASKET

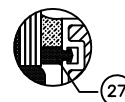

27 FG-5731  
SPACER GASKET

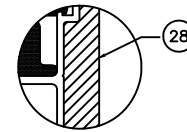

28 SM5601  
JOINT TAPE

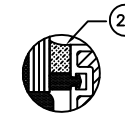

29 DOWSIL 995  
SEALANT

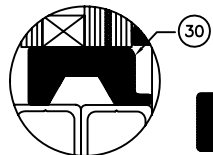

30 FG-5743  
SETTING BLOCK

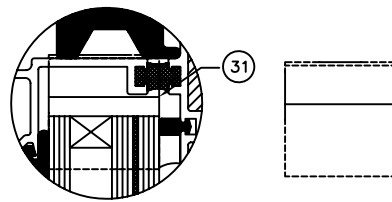

31 FG-5790-02  
WATER DIVERTER

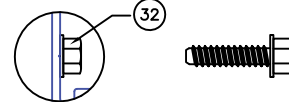

32 FS-8  
JOINT FASTENER

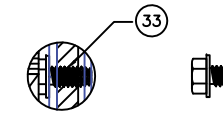

33 FS-354  
REINFORCEMENT FASTENER



**ENGINEERING EXPRESS®**  
CORPORATE OFFICE:  
160 SW 12th AVE, SUITE 106  
DEERFIELD BEACH, FL 33442  
(954) 354-0660 | (866) 396-9999  
TEAM@ENGINEERINGEXPRESS.COM  
ENGINEERINGEXPRESS.COM

**Oldcastle BuildingEnvelope®**

803 AIRPORT ROAD  
TERRELL, TX 75160  
Phn. (972) 551-6100

FG-5750T STORMMAX® THERMAL IGU IMPACT STOREFRONT SYSTEM  
WET AND DRY GLAZED

DRWN	CHKD	DATE
JEM	AJP	07/23/20

COPYRIGHT ENGINEERING EXPRESS®

20-29229h

SCALE: NTS UNLESS NOTED



FL#20665.3

**ENGINEERING EXPRESS®**  
CORPORATE OFFICE:  
160 SW 12th AVE, SUITE 106  
DEERFIELD BEACH, FL 33442  
(954) 354-0660 | (866) 396-9999  
TEAM@ENGINEERINGEXPRESS.COM  
ENGINEERINGEXPRESS.COM

**Oldcastle BuildingEnvelope®**

803 AIRPORT ROAD  
TERRELL, TX 75160  
Phn. (972) 551-6100

FG-5750T STORMMAX® THERMAL IGU IMPACT STOREFRONT SYSTEM  
WET AND DRY GLAZED

REMARKS	DRWN	CHKD	DATE
INIT ISSUE	JEM	AJP	07/23/20

COPYRIGHT ENGINEERING EXPRESS®

20-29229h

SCALE: NTS UNLESS NOTED

36 OF 38

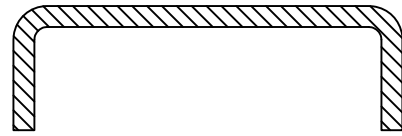

34 RS-30  
STEEL REINFORCEMENT

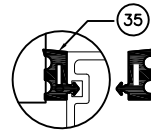

35 FG-5732  
DRY GLAZE GASKET

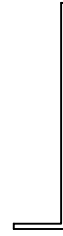

37 AN-101-01  
SILL END DAM

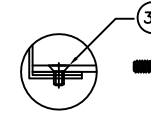

38 FS-23  
SILL END DAM  
FASTENER

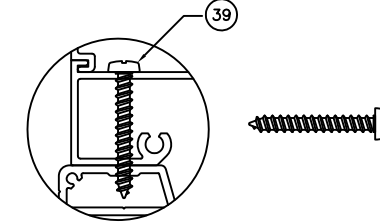

39 FS-229  
SILL-SUBSILL FASTENER

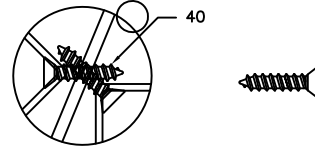

40 FS-58  
CORNER ASSEMBLY FASTENER



41 CH55  
U-CHANNEL



42 FS-96  
SHEAR BLOCK  
FASTENER

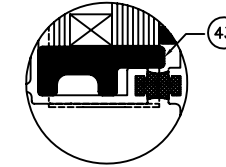

43 FG-5763  
SETTING BLOCK

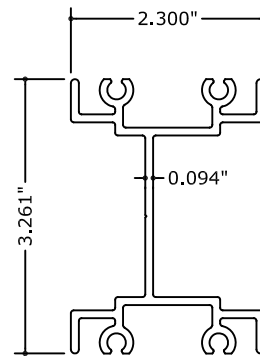

45 FG-5714-01  
SHEAR BLOCK

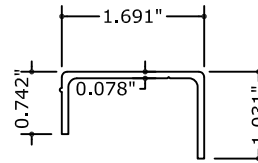

46 FG-5723-01  
SETTING CHAIR

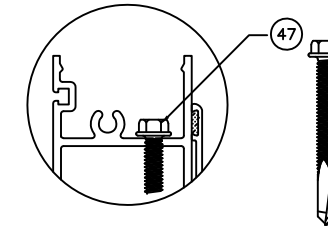

47 FS-128  
PRE-GLAZE SILL FASTENER

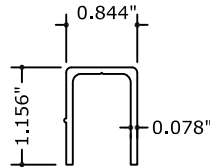

44 FG-5721-01  
SETTING CHAIR

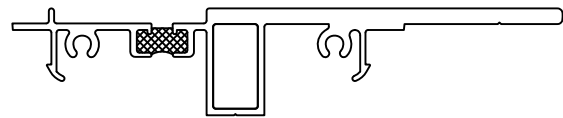

48 FGT-5788-01  
PRE-GLAZE HEAD  
ANCHOR

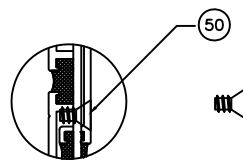

49 FS-56  
FG-5714 FASTENER

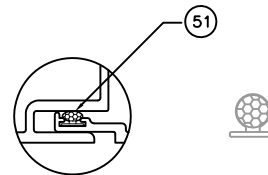

50 CW-998  
EXPANSION  
MULL GASKET

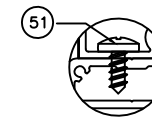

51 FS-27  
FASTENER

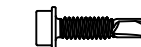

52 FS-336  
FASTENER



**BILL OF MATERIALS**

ITEM NO.	P/N	DESCRIPTION	DIMENSIONS	MATERIAL	MANUFACTURER	NOTES
ALUMINUM PARTS						
1	FGT-5770	HEAD/SILL/JAMB	2.500 x 5.000 x 0.094	6063-T6 ALUMINUM	OBE	
2	FGT-5772	HORIZONTAL MULLION	2.500 x 4.980 x 0.094	6063-T6 ALUMINUM	OBE	
3	FG-5760	GLASS STOP	1.250 x 1.650 x 0.078	6063-T6 ALUMINUM	OBE	
4	FGT-5771	HEAD/SILL	2.500 x 4.980 x 0.094	6063-T6 ALUMINUM	OBE	
5	NOT USED	NOT USED	NOT USED	NOT USED	NOT USED	
6	FG-5715	FLAT FILLER	0.636 x 4.670 x 0.080	6063-T6 ALUMINUM	OBE	RUNS FULL LENGTH
7	FGT-5780	SNAP-IN FILLER	0.681 x 4.670 x 0.080	6063-T6 ALUMINUM	OBE	
8	FGT-5773	VERTICAL MULLION	2.500 x 5.000 x 0.094	6063-T6 ALUMINUM	OBE	
9	FGT-5774	HEAVY MULLION	2.500 x 5.000 x 0.213	6063-T6 ALUMINUM	OBE	
10	FGT-5779	5" VERTICAL POST	5.000 x 4.941 x 0.110	6063-T6 ALUMINUM	OBE	
11	FGT-5778	5" VERTICAL POST	4.941 x 5.000 x 0.110	6063-T6 ALUMINUM	OBE	
12	FG-5720	ALUMINUM STIFFENER	4.500 x 1.9375 x 0.250	6063-T6 ALUMINUM	OBE	MAXIMUM LENGTH OF 144"
13	FGT-5712	5/8" SUBSILL	5.276 x 2.750 x 0.100	6063-T6 ALUMINUM	OBE	
14	FGT-5784	5" CORNER POST	5.000 x 4.940 x 0.110	6063-T6 ALUMINUM	OBE	
	NOT USED	NOT USED	NOT USED	NOT USED	NOT USED	
16	FGT-5785	5" CORNER POST	5.000 x 4.940 x 0.110	6063-T6 ALUMINUM	OBE	
17	FGT-5706	90° CORNER MULLION	5.500 X 5.500 X 0.125	6063-T6 ALUMINUM	OBE	
18	FGT-5707	135° CORNER MULLION	3.000 x 5.000 x 0.125	6063-T6 ALUMINUM	OBE	
19	FGT-5782	EXPANSION MULLION (FEMALE)	1.715 x 5.000 x 0.094	6063-T6 ALUMINUM	OBE	
20	FGT-5783	EXPANSION MULLION (MALE)	1.969 x 5.000 x 0.110	6063-T6 ALUMINUM	OBE	
	NOT USED	NOT USED	NOT USED	NOT USED	NOT USED	
22	FGT-5781	DEEP POCKET FILLER	0.681 x 4.670 x 0.080	6063-T6 ALUMINUM	OBE	
23	FGT-5786	PRE-GLAZE HEAD	2.500 X 5.000 X 0.094	6063-T6 ALUMINUM	OBE	
24	FGT-5787	PRE-GLAZE SILL	2.446 X 5.000 X 0.094	6063-T6 ALUMINUM	OBE	
25	FG-5259	PRE-GLAZE SILL FILLER	.344 X 1.638 X 0.050	6063-T5 ALUMINUM	OBE	

FL#20665.3

**ENGINEERING EXPRESS®**  
CORPORATE OFFICE:  
160 SW 12th AVE, SUITE 106  
DEERFIELD BEACH, FL 33442  
(954) 354-0660 | (866) 396-9999  
TEAM@ENGINEERINGEXPRESS.COM  
ENGINEERINGEXPRESS.COM

**Oldcastle BuildingEnvelope®**

803 AIRPORT ROAD  
TERRELL, TX 75160  
Phn. (972) 551-6100  
FG-5750T STORMMAX® THERMAL IGU IMPACT STOREFRONT SYSTEM  
WET AND DRY GLAZED

REMARKS	DRWN	CHKD	DATE
INIT ISSUE	JEM	AJP	07/23/20

COPYRIGHT ENGINEERING EXPRESS®

20-29229h

SCALE: NTS UNLESS NOTED

37 OF 38



**BILL OF MATERIALS**

ITEM NO.	P/N	DESCRIPTION	DIMENSIONS	MATERIAL	MANUFACTURER	NOTES
ACCESSORY PARTS						
26	FG-5730	EXTERIOR GLAZING GASKET	0.120 SPACE	EPDM	VARIES	
27	FG-5731	SPACER GASKET	0.250 SPACE	EPDM	VARIES	
28	SM5601	JOINT SEALANT TAPE	0.500 x 0.125 x VARIES	POLYISOBUTYLENE	SCHNEE-MOOREHEAD	
29	DOWSIL 995	STRUCTURAL SEALANT	--	SILICONE	DOW CHEMICAL COMPANY	FOR WET GLAZING AND FRAME ASSEMBLY
30	FG-5743	SETTING BLOCK	1.468 x 0.688 x 4.000	EPDM	VARIES	2 PER LITE
31	FG-5790-02	WATER DIVERTER	1.358 x 1.312 x 0.050	INJECTION MOLDED PLASTIC	OBE	AT EACH END OF INTERMEDIATE HORIZONTALS
32	FS-8	FASTENER	#14 x 1" HHSTS	STEEL (DACROMET)	VARIES	(4) FASTENERS PER SIDE (2" FROM MULLION & 2" ON CENTER, 4 PER SIDE).
33	FS-354	FASTENER	#1/4-20 x 3/8" HEXHEAD TYPE F	STEEL (GEOMET)	VARIES	REINFORCEMENT SCREW, 1" FROM EACH END
34	RS-30	STEEL REINFORCEMENT	4.562 x 1.250 x 0.250	STEEL	VARIES	ASTM A-36
35	FG-5732	DRY GLAZE GASKET	0.250 SPACE	EPDM	VARIES	
36	DOWSIL 795	PERIMETER SEALANT	--	SILICONE	DOW CHEMICAL COMPANY	
37	AN-101-01	SILL FLASHING END DAM	2.688 x 0.625 x 0.063 x 5.125	6063-T6 ALUMINUM	OBE	
38	FS-23	FASTENER	#6 x 3/8" PPH	STEEL (ZINC PLATED)	VARIES	ATTACH END DAM TO SUBSILL
39	FS-229	FASTENER (SILL-TO-SUBSILL)	#14 x 1-1/2" PPH	STEEL (GEOMET)	VARIES	(4) FASTENERS PER SIDE (2" FROM MULLION & 2" ON CENTER, 4 PER SIDE).
40	FS-58	FASTENER	#10 x 1" PHILLIPS FLAT HEAD	STAINLESS STEEL	VARIES	USED AT CORNERS
41	CH55	U-CHANNEL	1.000 x 1.593 x 0.125"	6063-T6 ALUMINUM	OBE	
42	FS-96	FASTENER	#12 x 2-1/2" PPH SMS A pt	STEEL (GEOMET)	VARIES	SHEAR BLOCK SCREW
43	FG-5763	SETTING BLOCK	0.579 x 0.250 x 1.500	EPDM	VARIES	
44	FG-5721-01	SETTING CHAIR	1.156 x 0.844 x 0.078	6063-T6 ALUMINUM	OBE	2 PER LITE, 4" LONG
45	FG-5714-01	SHEAR BLOCK	2.300 x 3.261 x 0.094	6063-T6 ALUMINUM	OBE	2" IN LENGTH
46	FG-5723-01	SETTING CHAIR	1.031 x 1.691 x 0.078	6063-T6 ALUMINUM	OBE	2 PER LITE, 4" LONG
47	FS-128	FASTENER	5/16"x24x 2" HEX WASHER HEAD	STEEL (DACROMET)	VARIES	(2) FASTENERS PER SIDE (1 1/2" AND 4 1/2" ON EACH SIDE OF MULLION)
48	FGT-5788-01	PRE-GLAZE HEAD ANCHOR	1.679 x 0.588 x 4.000	6063-T6 ALUMINUM	OBE	
49	FS-56	FASTENER	#10 X 1/2" UCPFH SMS	STAINLESS STEEL	VARIES	
50	CW-998	BULB GASKET		FOAM-TITE BULB	AMESBURY	
51	FS-27	FASTENER (SILL-TO-SUBSILL)	#12 x 1/2" PPH SMS A pt	STEEL (DRACOMET)	VARIES	LOCATE (2) SPACED @ 1-1/2" OFF EACH SIDE OF VERTICAL
52	FS-336	FASTENER	1/4-20 x 1-1/8" HWH KWIFLEX		HILTI	(2) FASTENERS PER SIDE (1 1/2" AND 4 1/2" ON EACH SIDE OF MULLION)

FL#20665.3

**ENGINEERING EXPRESS®**  
CORPORATE OFFICE:  
160 SW 12th AVE, SUITE 106  
DEERFIELD BEACH, FL 33442  
(954) 354-0660 | (866) 396-9999  
TEAM@ENGINEERINGEXPRESS.COM  
ENGINEERINGEXPRESS.COM

**Oldcastle BuildingEnvelope®**  
803 AIRPORT ROAD  
TERRELL, TX 75160  
Phn. (972) 551-6100  
FG-5750T STORMMAX® THERMAL IGU IMPACT STOREFRONT SYSTEM  
WET AND DRY GLAZED

DATE	07/23/20				
DRWN	JEM	AJP			
CHKD					
REMARKS					
INIT					
ISSUE					

COPYRIGHT ENGINEERING EXPRESS®

20-29229h

SCALE: NTS UNLESS NOTED

38 OF 38