

INSTALLATION INSTRUCTIONS

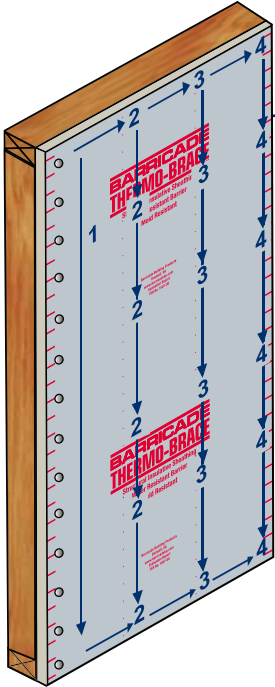

STEP 1

DO NOT fasten the four corners first.

1. Starting at the top left of the panel, begin fastening from top to bottom, referring to the fastener schedule on the front side of the panel for proper fastener spacing.

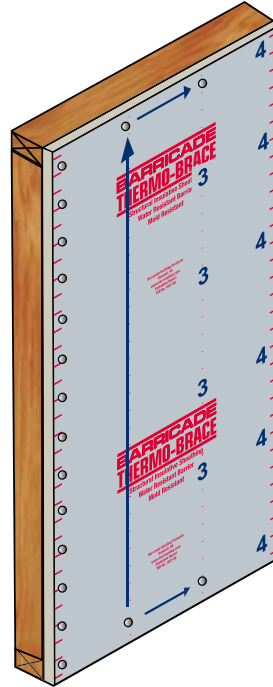

STEPS 2 & 3

2. Moving across the panel, attach fasteners at the top and bottom of the panel until you reach the next stud (it is important when using staples to fasten them in a parallel direction to the stud).

3. Fasten panel in numerical order repeating the procedure described in steps 1 and 2.

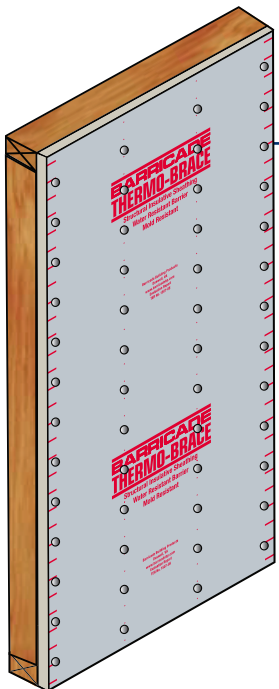

STEP 4

4. Continue until the Thermo-Brace panel is properly secured to the frame.

For use as a water-resistive barrier (WRB) noted in IRC section R703.2 and IBC Section 1404.2, use Barricade® Seam Tape® on joints and seams.



STEP 5

5. In order to prevent gaps or rippling, it is important to move cross from one side of the panel to the other when installing.

DO NOT fasten each of the four corners first.