



1 COCHRANE AVE. PENNSBORO, WV 26415 PH.  
800-426-2249

# STORMBREAKER PLUS 300VL IMPACT RESISTANT VINYL PICTURE (FIXED) WINDOW

## GENERAL NOTES:

1. THIS PRODUCT HAS BEEN DESIGNED AND TESTED TO COMPLY WITH THE 5TH EDITION (2014) FLORIDA BUILDING CODES, INCLUDING THE HIGH VELOCITY HURRICANE ZONE.
2. BASED ON LABORATORY TESTING, THIS PRODUCT IS COMPLIANT WITH TAS 201/202/203 FOR LARGE MISSILE IMPACT PERFORMANCE. SHUTTERS ARE NOT REQUIRED.
3. GLAZING AS INDICATED HEREIN COMPLIES WITH ASTM E 1300-04
4. HIGH QUALITY SILICONE CAULK SHALL BE USED AROUND ENTIRE WINDOW PERIMETER, INSIDE AND OUT, BY INSTALLER.
5. WOOD BUCKS (BY OTHERS) MUST SUSTAIN ALL IMPOSED LOADS. THE CONTRACTOR IS RESPONSIBLE FOR MAINTAINING WINDOW OPENING AND ALL WOOD FRAMING AROUND WINDOW. WOOD BUCKS, BY OTHERS, MUST BE PROPERLY ANCHORED TO TRANSFER LOADS TO THE STRUCTURE AS APPROVED BY THE AUTHORITY HAVING JURISDICTION.
6. SEALING AND FLASHING STRATEGIES FOR OVERALL WATER INFILTRATION RESISTANCE OF INSTALLED PRODUCT ARE THE RESPONSIBILITY OF OTHERS.
7. ALL FASTENERS PENETRATING INTO PRESSURE TREATED WOOD SHALL BE CAPABLE OF PREVENTING CORROSION DUE TO REACTION WITH PRESSURE TREATMENT CHEMICALS. ANY DISSIMILAR MATERIALS THAT COME INTO CONTACT SHALL BE PROTECTED TO PREVENT GALVANIC REACTIONS IN ACCORDANCE WITH CODE REQUIREMENTS.
8. A WINDLOAD DURATION FACTOR  $C_d = 1.6$  WAS USED FOR THE ANALYSIS OF WOOD SCREWS ONLY.

ALL MODELS ARE VIEWED FROM THE EXTERIOR

REV. #	REVISIONS:	REVISED BY:	DATE:
1	UPDATED FOR 5TH ED. (2014) FBC	LAT	4/27/2015
.	.	.	.
.	.	.	.
.	.	.	.

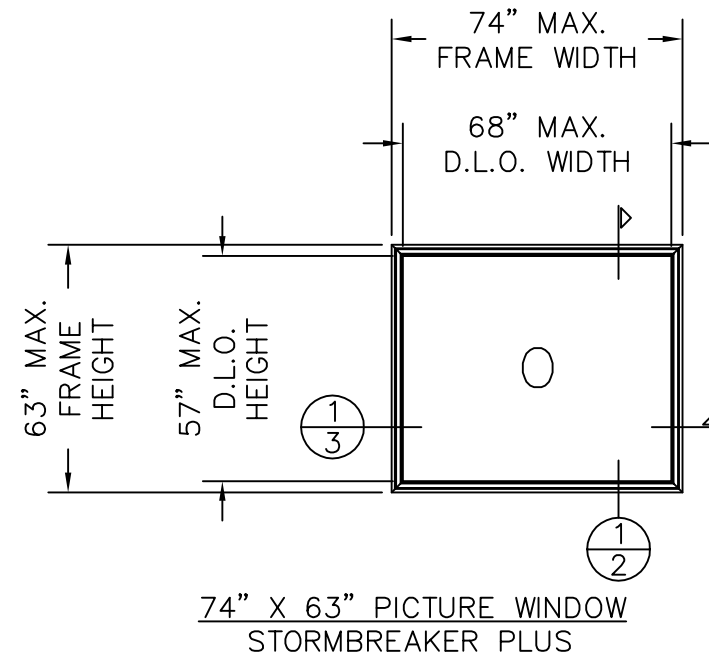

DESIGN PRESSURE RATING	IMPACT RATING:
+65.0 PSF    -65.0 PSF	SMALL & LARGE MISSILE IMPACT

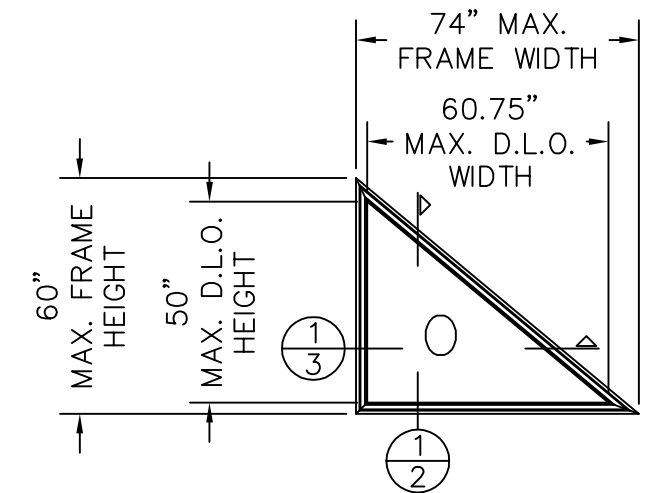

DESIGN PRESSURE RATING	IMPACT RATING:
+65.0 PSF    -65.0 PSF	SMALL & LARGE MISSILE IMPACT

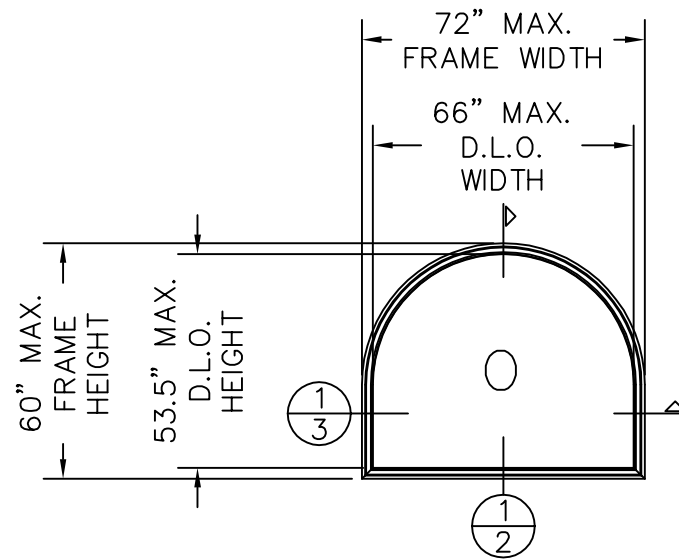

DESIGN PRESSURE RATING	IMPACT RATING:
+65.0 PSF    -65.0 PSF	SMALL & LARGE MISSILE IMPACT

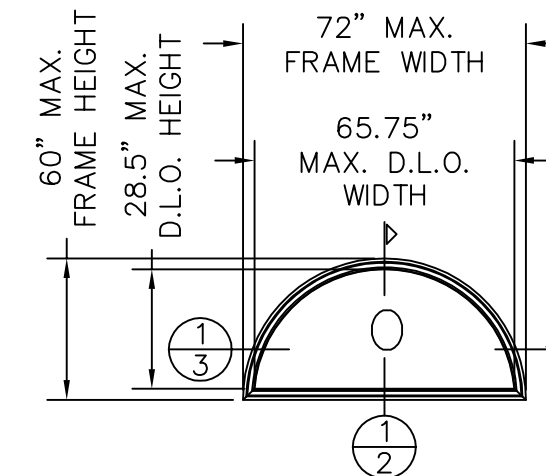

DESIGN PRESSURE RATING	IMPACT RATING:
+65.0 PSF    -65.0 PSF	SMALL & LARGE MISSILE IMPACT

TABLE OF CONTENTS	
SHEET #	DESCRIPTION
1	GEN. NOTES, TYPICAL ELEVATIONS, TABLE OF CONTENTS
2	VERTICAL CROSS SECTIONS
3	HORIZONTAL CROSS SECTIONS
4	ANCHORING LOCATIONS
5	GLAZING DETAILS, COMPONENTS & BILL OF MATERIALS

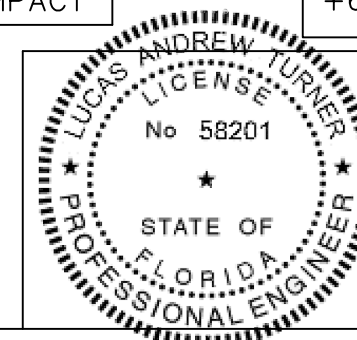

22  
4/27/2015  
LUCAS A. TURNER, FL P.E. #58201  
TURNER ENGINEERING & CONSULTING, INC., FBPE COA #29779  
1239 JABARA AVE., NORTH PORT, FL  
PH. 941-380-1574, FAX 941-584-8591

**SIMONTON WINDOWS**  
1 Cochrane Avenue  
Pennsboro, WV 26415

SIZE: DRAWING NO.: REV.:  
B DA0013 1  
DRAWN BY: DATE:  
T.D.D. 05-16-13  
CHECKED BY: DATE:  
APPR'VD BY: DATE:

SCALE: FIT SHEET: 1 of 5  
SERIES: STORMBREAKER PLUS 300VL PICTURE (FIXED) WINDOW  
TITLE: GENERAL NOTES & TYPICAL ELEVATIONS

REV. #	REVISIONS:	REVISED BY:	DATE:
1	UPDATED FOR 5TH ED. (2014) FBC	LAT	4/27/2015

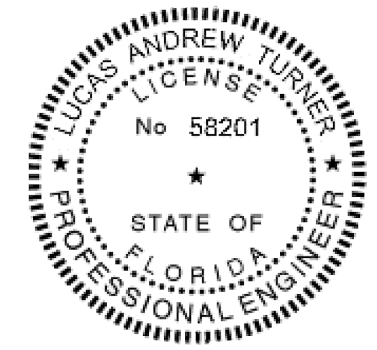
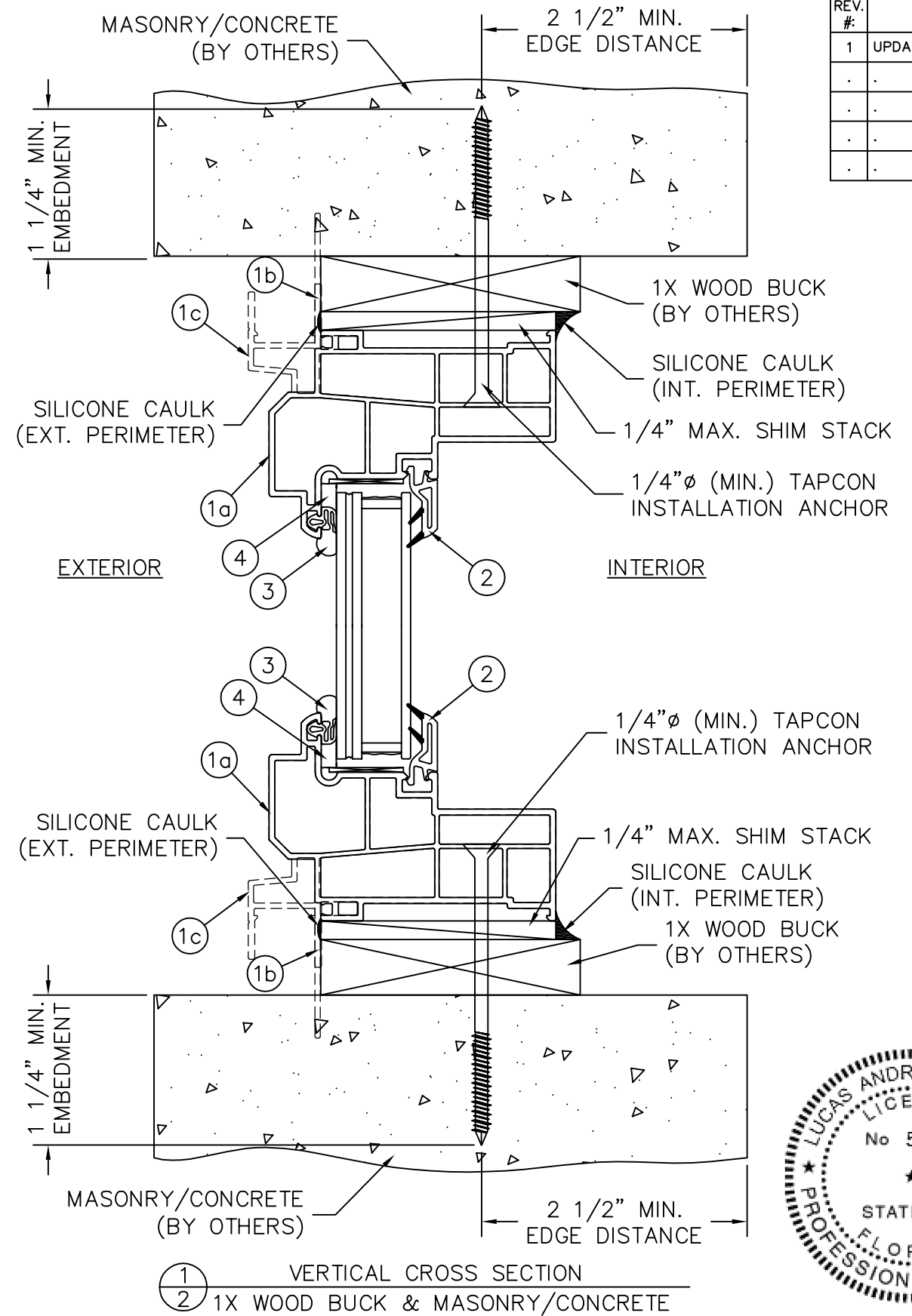
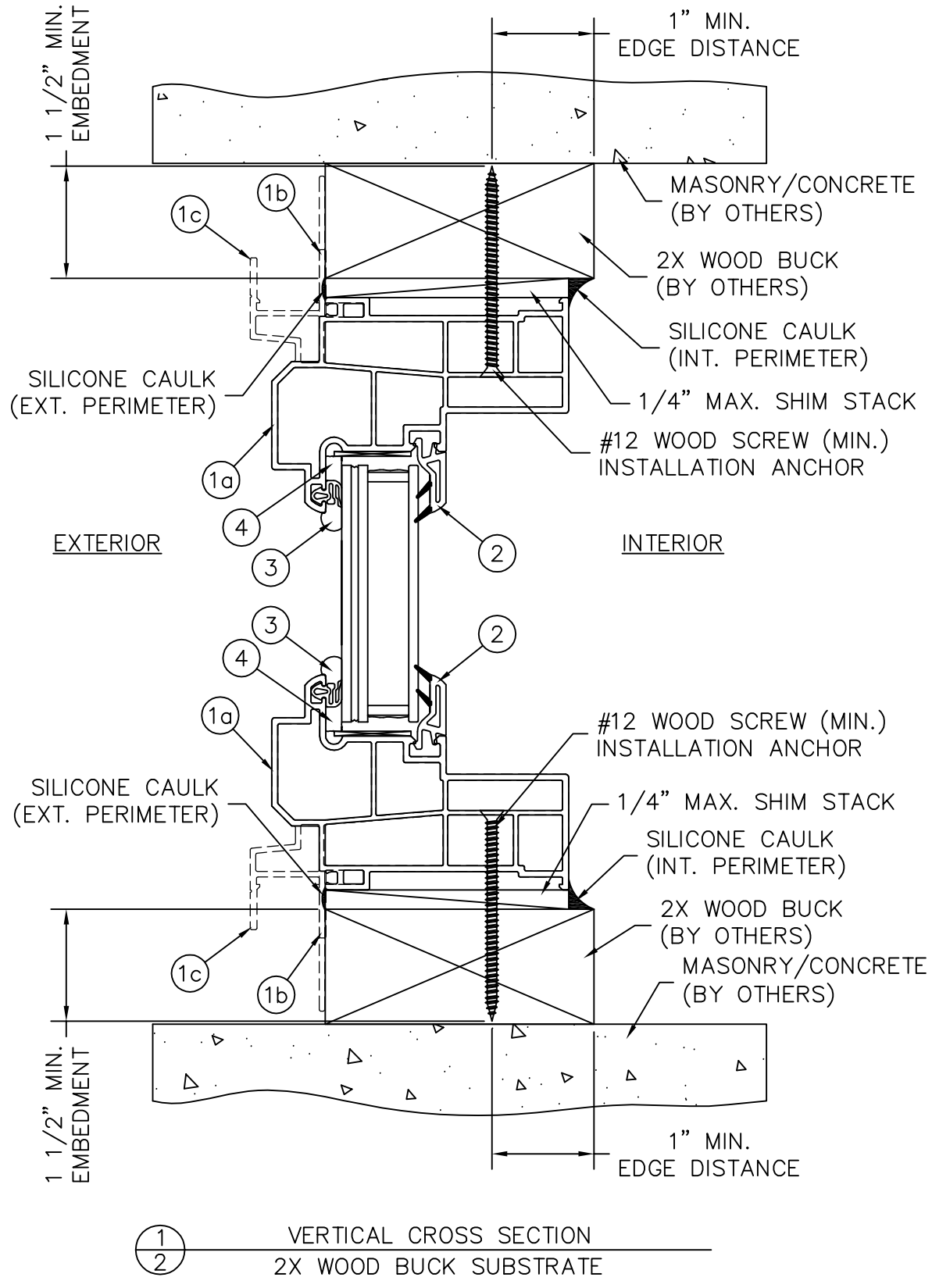

**NOTES:**

- SHIMS SHALL BE A "RIGID/STIFF" MATERIAL, PLASTIC OR METAL. SHIMS MUST BE USED WHEN GAP OF GREATER THAN 1/16" BETWEEN FRAME AND OPENING IS PRESENT AT THE ANCHOR LOCATION. MAX. SHIM STACK = 1/4".
- ONLY MIAMI-DADE COUNTY APPROVED CORROSION RESISTANT FASTENERS AND ELCO ULTRACON FASTENERS SHALL BE USED. WINDOW INSTALLERS SHALL FOLLOW ALL MANUFACTURER'S INSTRUCTIONS.
- WOOD SHALL BE SPRUCE-PINE-FIR MIN. WITH G=0.42 MIN. MASONRY SHALL BE 2 KSI MIN. CONCRETE OR ASTM C90 CMU (117 PCF MIN.)

<p>22</p> <p>4/27/2015</p> <p>LUCAS A. TURNER, FL P.E. #58201</p> <p>TURNER ENGINEERING &amp; CONSULTING, INC., FBPE COA #29779</p> <p>1239 JABARA AVE., NORTH PORT, FL</p> <p>PH. 941-380-1574, FAX 941-584-8591</p>	<p><b>SIMONTON</b> WINDOWS</p> <p>1 Cochrane Avenue Pennsboro, WV 26415</p>	<p>SIZE: DRAWING NO.: B DA0013</p> <p>REV.: 1</p>
	<p>SCALE: FIT</p> <p>SHEET: 2 of 5</p> <p>SERIES: STORMBREAKER PLUS 300VL PICTURE (FIXED) WINDOW</p> <p>TITLE: VERTICAL CROSS SECTIONS</p>	<p>DRAWN BY: T.D.D.</p> <p>CHECKED BY: DATE: 05/16/13</p> <p>APPR'VD BY: DATE:</p>

REV. #	REVISIONS:	REVISED BY:	DATE:
1	UPDATED FOR 5TH ED. (2014) FBC	LAT	4/27/2015
.	.	.	.
.	.	.	.
.	.	.	.
.	.	.	.

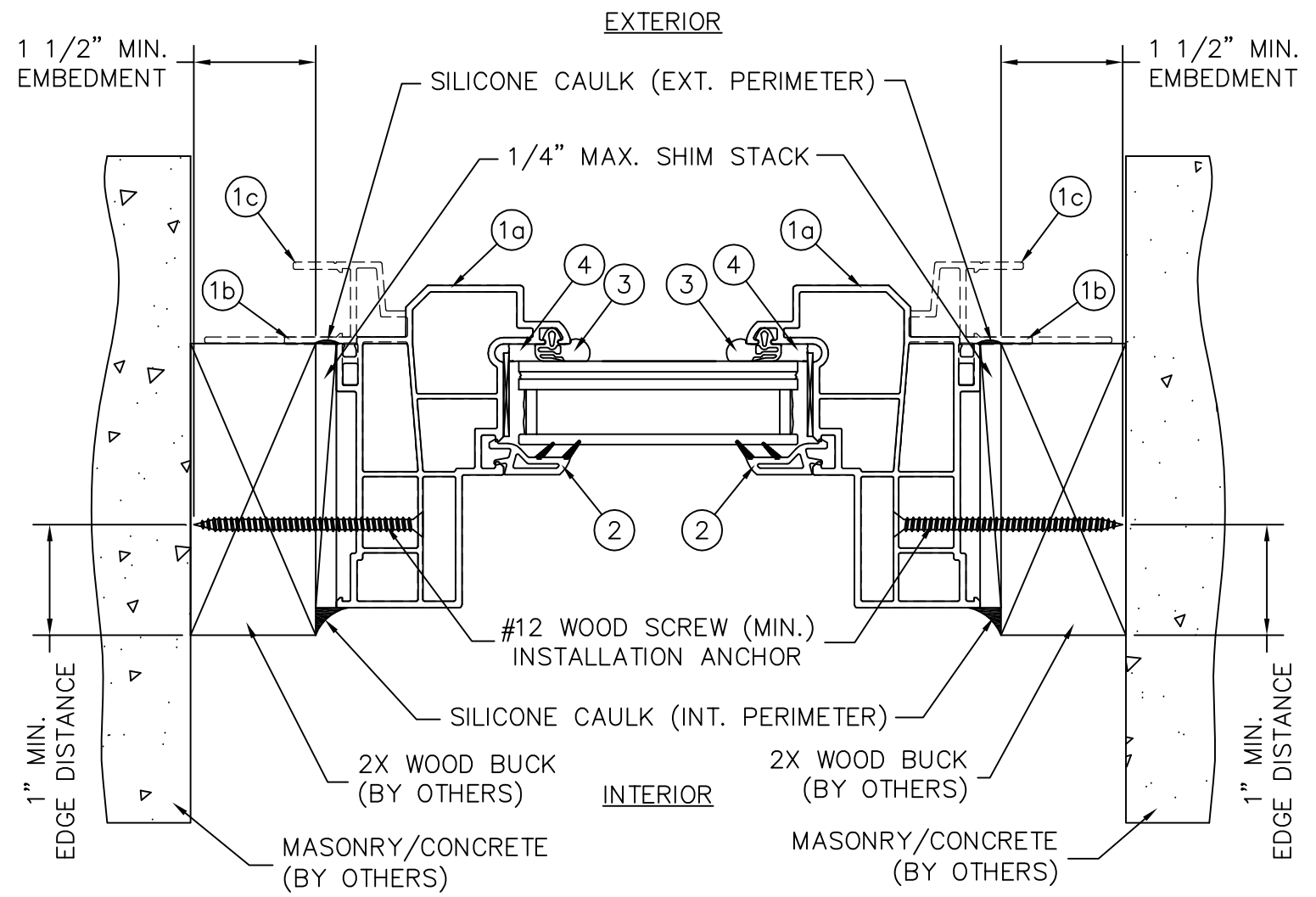

1 HORIZONTAL CROSS SECTION  
3 2X SUB BUCK STANDARD PICTURE WINDOW

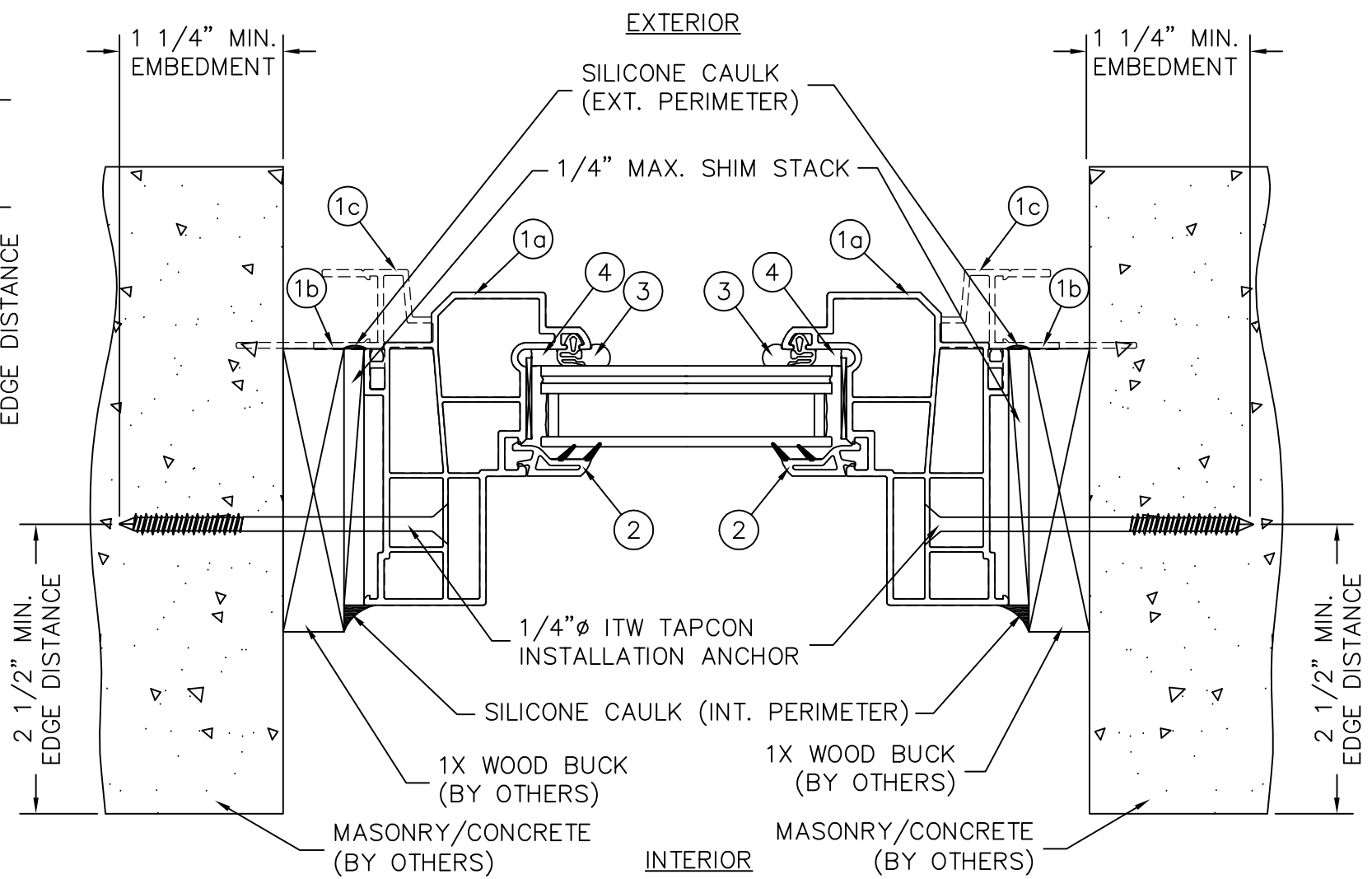

1 HORIZONTAL CROSS SECTION  
3 1X SUB BUCK STANDARD PICTURE WINDOW

**NOTES:**  
 1. SHIMS SHALL BE A "RIGID/STIFF" MATERIAL, PLASTIC OR METAL. SHIMS MUST BE USED WHEN GAP OF GREATER THAN 1/16" BETWEEN FRAME AND OPENING IS PRESENT AT THE ANCHOR LOCATION. MAX. SHIM STACK = 1/4".  
 2. ONLY MIAMI-DADE COUNTY APPROVED CORROSION RESISTANT FASTENERS AND ELCO ULTRACON FASTENERS SHALL BE USED. WINDOW INSTALLERS SHALL FOLLOW ALL MANUFACTURER'S INSTRUCTIONS.  
 3. WOOD SHALL BE SPRUCE-PINE-FIR MIN. WITH G=0.42 MIN. MASONRY SHALL BE 2 KSI MIN. CONCRETE OR ASTM C90 CMU (117 PCF MIN.)

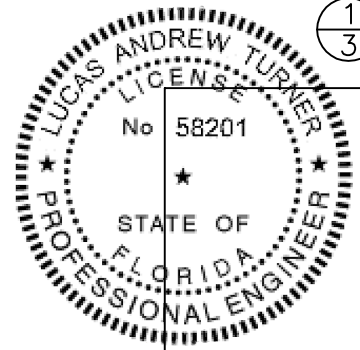

*LT*  
 4/27/2015  
 LUCAS A. TURNER, FL P.E. #58201  
 TURNER ENGINEERING &  
 CONSULTING, INC., FBPE COA #29779  
 1239 JABARA AVE., NORTH PORT, FL  
 PH. 941-380-1574, FAX 941-584-8591

**SIMONTON**  
 WINDOWS  
 1 Cochrane Avenue  
 Pennsboro, WV 26415

SIZE: DRAWING NO.: REV.:  
 B DA0013 1  
 DRAWN BY: DATE:  
 T.D.D. 05/16/13  
 CHECKED BY: DATE:  
 APPR'VD BY: DATE:

SCALE: FIT SHEET: 3 of 5  
 SERIES: STORMBREAKER PLUS 300VL PICTURE (FIXED) WINDOW  
 TITLE: HORIZONTAL CROSS SECTIONS

REV. #	REVISIONS:	REVISED BY:	DATE:
1	UPDATED FOR 5TH ED. (2014) FBC	LAT	4/27/2015
.	.	.	.
.	.	.	.
.	.	.	.
.	.	.	.

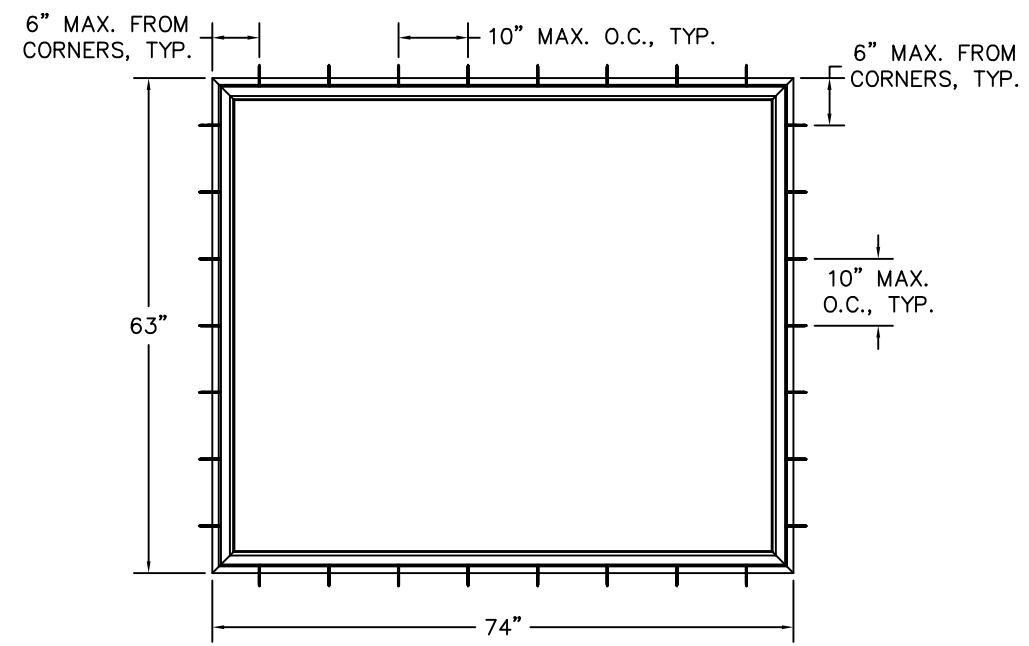

74" X 63" PICTURE WINDOW ANCHORING LOCATIONS

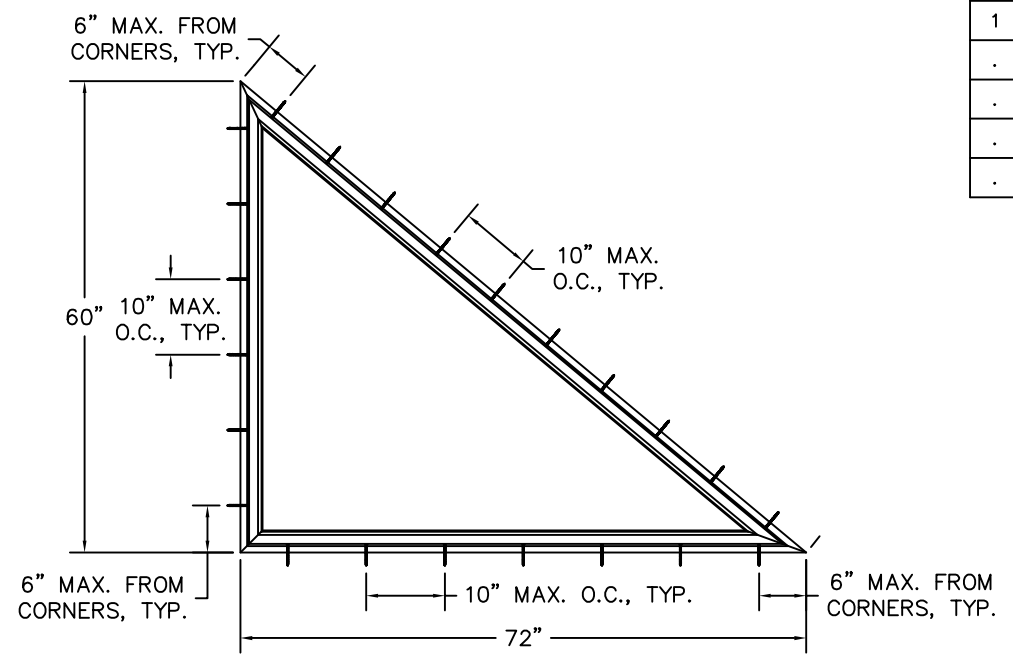

72" X 60" UNEQUAL LEG TRIANGLE ANCHORING LOCATIONS

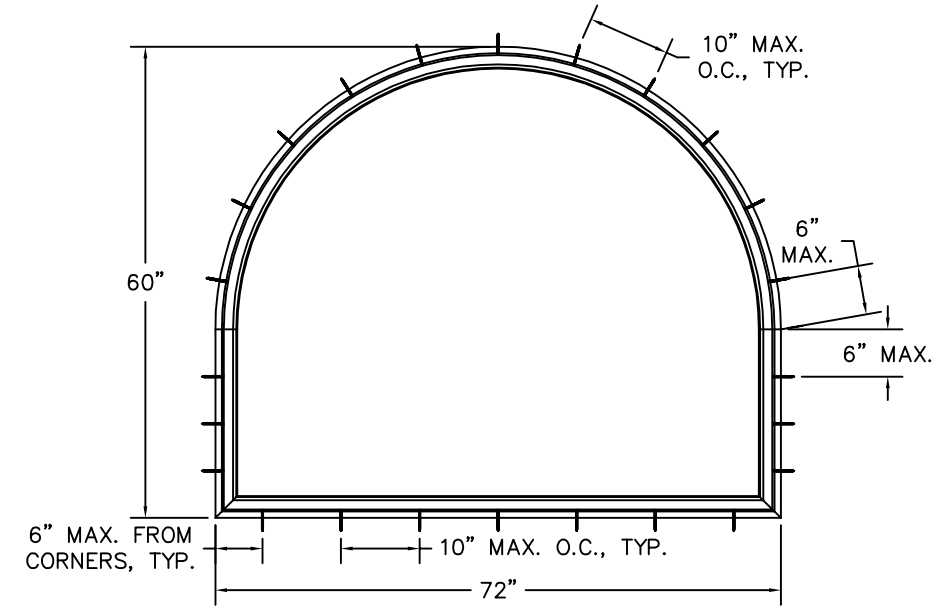

72" X 60" HALF ROUND W/ EQUAL LEGS ANCHORING LOCATIONS

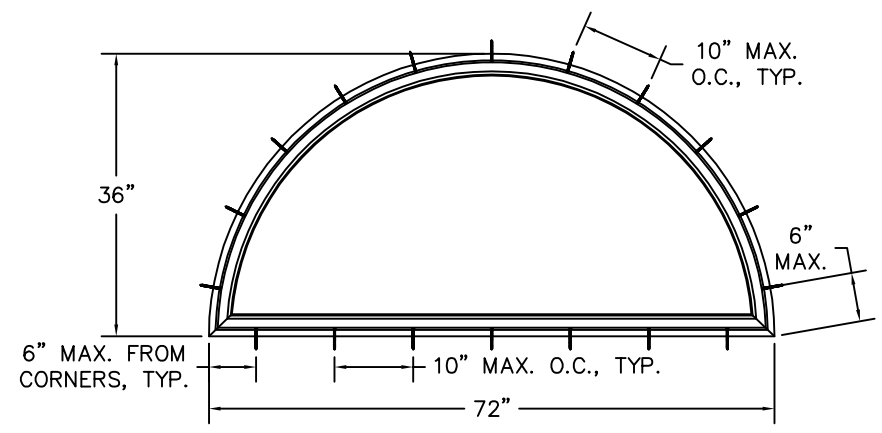

72" X 36" HALF ROUND ANCHORING LOCATIONS

- NOTES:
1. WHEN ANCHORING PICTURE WINDOWS TO A 2X BUCK, USE #12 (MIN.) WOOD SCREWS OF SUFFICIENT LENGTH TO ACHIEVE A MINIMUM 1 1/2" EMBEDMENT INTO THE WOOD BUCK.
  2. WHEN ANCHORING THE WINDOW INTO A 1X WOOD BUCK, USE 1/4"Ø (MIN.) ITW TAPCON ANCHORS OF SUFFICIENT LENGTH TO ACHIEVE A MINIMUM 1 1/4" EMBEDMENT INTO THE MASONRY/CONCRETE.
  3. SEE SHEETS 2 AND 3 FOR ADDITIONAL ANCHORAGE INFORMATION.
  3. THE 74" X 63" RECTANGULAR FIXED WINDOW WIDTH AND LENGTH DIMENSIONS CAN BE ORIENTED EITHER HORIZONTALLY OR VERTICALLY AND QUALIFY FOR THE DESIGN PRESSURE = ±65 PSF. SMALLER SIZE RECTANGULAR WINDOWS WILL ALSO QUALIFY FOR THE DESIGN PRESSURE ±65 PSF.

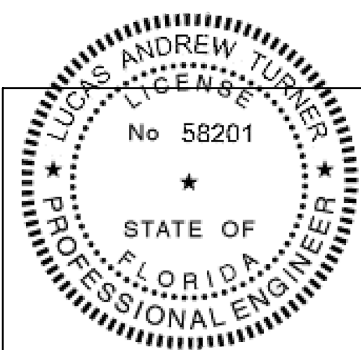

*LT*  
4/27/2015  
LUCAS A. TURNER, FL P.E. #58201  
TURNER ENGINEERING & CONSULTING, INC., FBPE COA #29779  
1239 JABARA AVE., NORTH PORT, FL  
PH. 941-380-1574, FAX 941-584-8591

 1 Cochrane Avenue Pennsboro, WV 26415	SIZE: B DRAWING NO.: DA0013 DRAWN BY: T.D.D. CHECKED BY:	REV.: 1 DATE: 05/16/13 DATE:
	SCALE: FIT SHEET: 4 of 5	APPRVD BY: DATE:
SERIES: STORMBREAKER PLUS 300VL PICTURE (FIXED) WINDOW TITLE: ANCHORING LOCATIONS		



BILL OF MATERIALS		
ITEM #	DESCRIPTION	MANUFACTURER
1a	PW0902S VINYL WINDOW FRAME	SIMEX, INC.
1b	PW1101S VINYL FRAME WITH FLANGE	SIMEX, INC.
1c	PW1201S VINYL FRAME WITH NAILING FIN/J-CHANNEL	SIMEX, INC.
2	BV34 VINYL GLAZING BEAD FOR 1" I.G.U.	VPI
3	EPDM DRY GLAZE GASKET	LAUREN
4	896-HIS GLAZING COMPOUND	PECORA

REV. #	REVISIONS:	REVISED BY:	DATE:
1	UPDATED FOR 5TH ED. (2014) FBC	LAT	4/27/2015
.	.	.	.
.	.	.	.
.	.	.	.
.	.	.	.

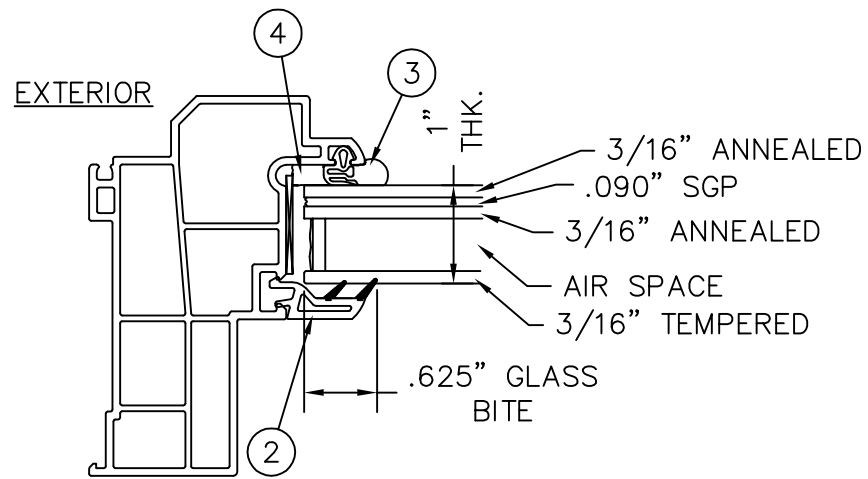

INTERIOR  
GLAZING DETAIL  
 RESISTANT GLASS GLAZING DETAIL  
 74" X 63" PICTURE WINDOW

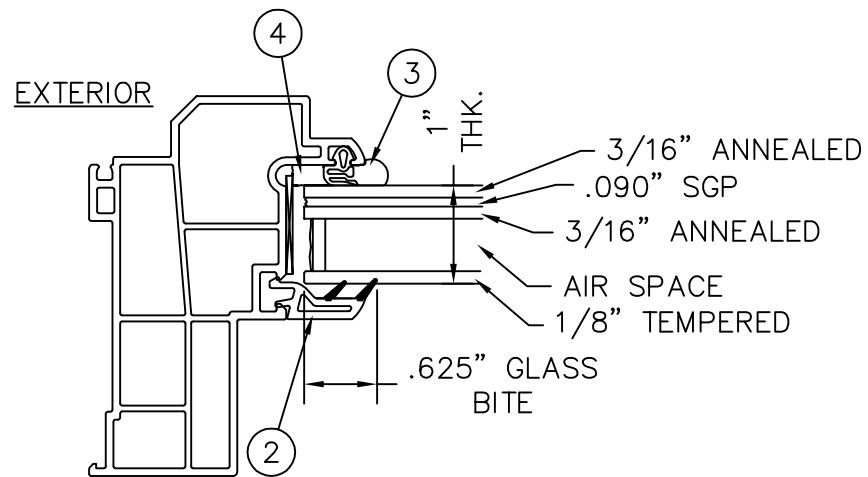

INTERIOR  
GLAZING DETAIL  
 TRIANGLE, HALF ROUND WITH LEG  
 AND HALF ROUND

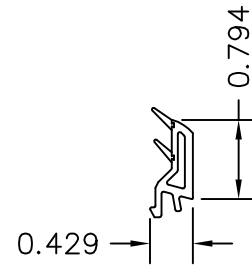

② BV34 GLAZING BEAD  
 0.059" MIN. WALL &  
 0.079" MAX. WALL

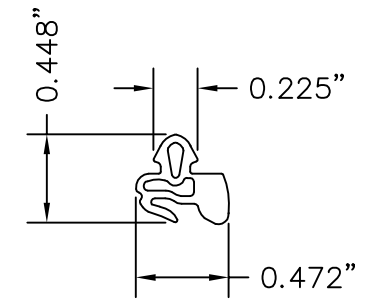

③ GLAZING GASKET

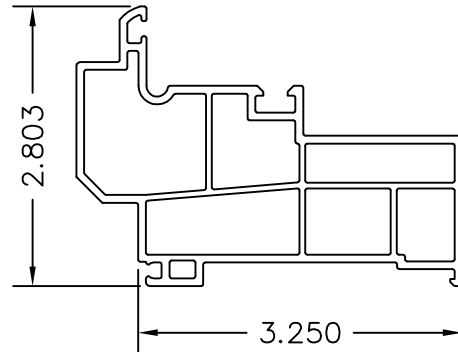

①a PW0902S FIXED WINDOW FRAME  
 VINYL 0.060" MIN. WALL &  
 0.079" MAX. WALL

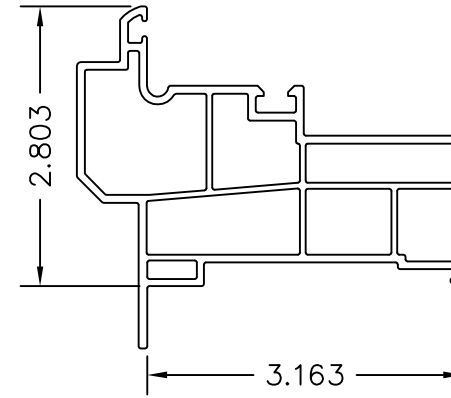

①b PW1101S FRAME WITH FLANGE  
 VINYL 0.060" MIN. WALL &  
 0.079" MAX. WALL

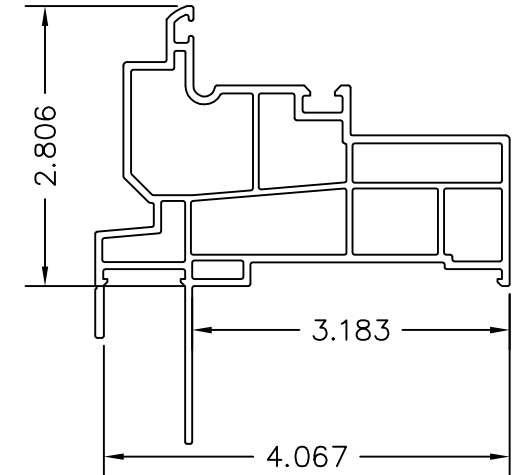

①c PW1201S FRAME WITH NAILING  
 FIN & J-CHANNEL  
 VINYL 0.060" MIN. WALL &  
 0.079" MAX. WALL

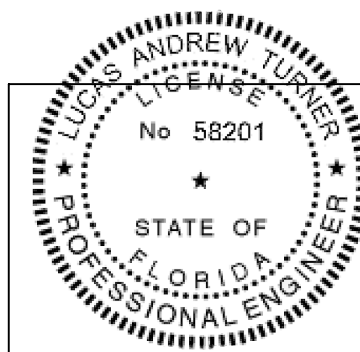

*LT*  
 4/27/2015  
 LUCAS A. TURNER, FL P.E. #58201  
 TURNER ENGINEERING &  
 CONSULTING, INC., FBPE COA #29779  
 1239 JABARA AVE., NORTH PORT, FL  
 PH. 941-380-1574, FAX 941-584-8591

 1 Cochrane Avenue Pennsboro, WV 26415	SIZE: B	DRAWING NO.: DA0013	REV.: 1
	SCALE: FIT	SHEET: 5 of 5	APPR'VD BY: DATE:
SERIES: STORMBREAKER PLUS 300VL PICTURE (FIXED) WINDOW TITLE: GLAZING DETAILS, COMPONENTS & BILL OF MATERIALS		DRAWN BY: T.D.D. CHECKED BY: DATE: 05/16/13	DATE: 05/16/13