

dormakaba USA, Inc.

PHI SERIES ARM-A-DOR™ PANIC EXIT HARDWARE DEVICE - LMI (COMPONENT APPROVAL)

ARM-A-DOR™ DEVICE DESIGN PRESSURE		
CONFIGURATION	MAX. PANEL SIZE	MAX. DP
SINGLE	48" X 86"	+/- 85 PSF

TABLE OF CONTENTS		
SHEET	REVISION	SHEET DESCRIPTION
1	-	GENERAL NOTES, ELEVATION, AND SECTION VIEW
2	-	EXPLODED ISOMETRIC VIEW
3	-	BILL OF MATERIALS, ORTHO & ISO VIEWS

GENERAL NOTES:

1. THIS PRODUCT HAS BEEN DESIGNED AND MANUFACTURED TO COMPLY WITH THE 6TH EDITION FLORIDA BUILDING CODE (FBC) INCLUDING PROVISIONS SET FORTH FOR HIGH-VELOCITY HURRICANE ZONES (HVHZ) AND HAVE BEEN TESTED AND EVALUATED IN ACCORDANCE WITH TAS 201, 202, & 203.
2. THE COMPONENT DESCRIBED HEREIN SHALL BE USED WITH DOOR PANEL FACE SHEETS TO BE MIN. 16 GA. (0.041" MIN.) STEEL, AND FRAME TO BE MIN. 16 GA. (0.053" MIN.) WITH MIN. Fy = 35,400 PSI STEEL. STEEL LOCK REINFORCEMENT AT LOCK STILE SHALL BE A MINIMUM OF 14 GA. (0.080" MIN.) 18" LONG STEEL LOCK REINFORCEMENT AT HINGE STILE SHALL BE A MINIMUM OF 14 GA. (0.080" MIN.) 12" LONG COLD ROLLED STEEL HINGE REINFORCEMENTS SHALL BE A MINIMUM OF 7 GA. (0.171" MIN.).

2.1. MAX. SINGLE DOOR PANEL DIMENSIONS: 48" (W) X 86" (H) X 1-3/4" THICK

2.1.1. DEVICE SHALL BE INSTALLED INTO SINGLE COMMERCIAL CORE FILLED STEEL DOORS UNDER SEPARATE APPROVAL.

2.1.2. CORE OF DOORS SHALL BE APPROVED AS PART OF SEPARATE DOOR APPROVAL.

2.1.3. DOOR SHALL BE REINFORCED WITH DOUBLE HAT 20 GA. VERTICAL STEEL STIFFENERS SPACED AT 6".
3. HARDWARE SHALL BE INSTALLED AS PER MANUFACTURER'S INSTALLATION INSTRUCTIONS.
4. ALL FASTENERS AND ASSOCIATED HARDWARE MUST BE MADE OF CORROSION RESISTANT MATERIAL OR HAVE A CORROSION RESISTANT COATING.
5. STRIKES, HINGES, AND ALL APPLICABLE REINFORCEMENTS MINIMUM AS REQUIRED ON DETAIL DRAWING IN THIS APPROVAL.
6. STEEL COMPONENTS SHALL BE COATED OR COMPLY WITH CORROSION RESISTANCE PROTECTION IN CONFORMANCE WITH THE MATERIAL PROTECTION PROVISIONS OF CHAPTER 22 OF THE FBC.

LIMITATIONS OF USE:

1. THIS HARDWARE COMPONENT APPROVAL IS TO BE USED AS AN EQUIVALENT ALTERNATIVE OF TESTED COMPONENTS FOR SINGLE OUTSWING DOORS HAVING A SEPARATE CURRENT NOA OR FLORIDA PRODUCT APPROVAL. THE LOWER DESIGN PRESSURE OF DOOR OR THE COMPONENT APPROVAL HEREIN SHALL CONTROL.
2. ELECTRICAL/ELECTRONIC FUNCTION AND INSTALLATION OTHER THAN SELF CONTAINED ELECTRONIC DEVICES ARE NOT PART OF THIS APPROVAL AND MUST BE REVIEWED BY AUTHORITY HAVING JURISDICTION(AHJ) IN THE AREA.
3. DOOR LEAF SHALL BE NO WIDER THAN 48" OR HIGHER THAN 86" FOR SINGLE DOORS APPLICATIONS.
4. COMPLIANCE WITH BUILDING EGRESS REQUIREMENTS TO BE REVIEWED BY BUILDING OFFICIAL.

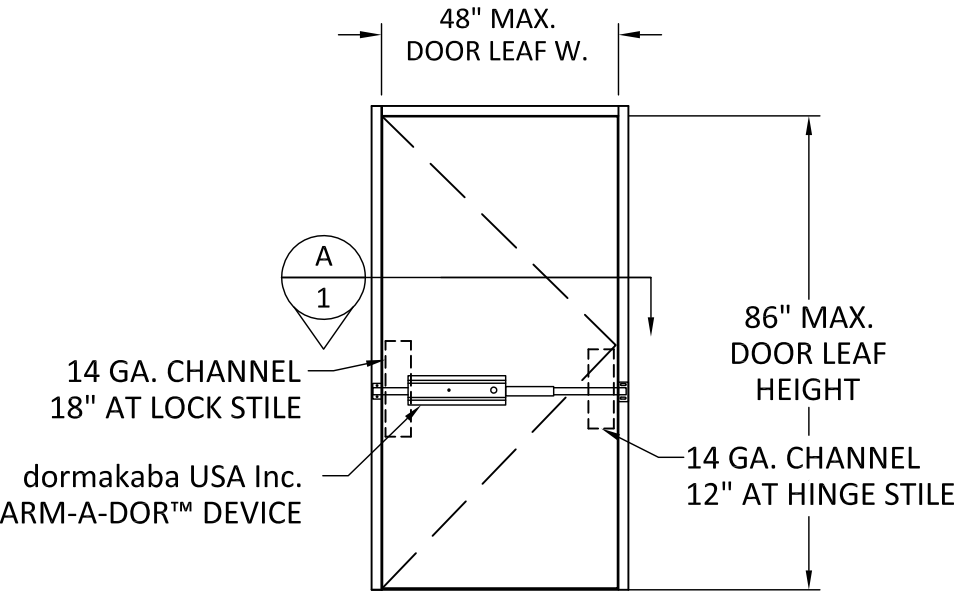
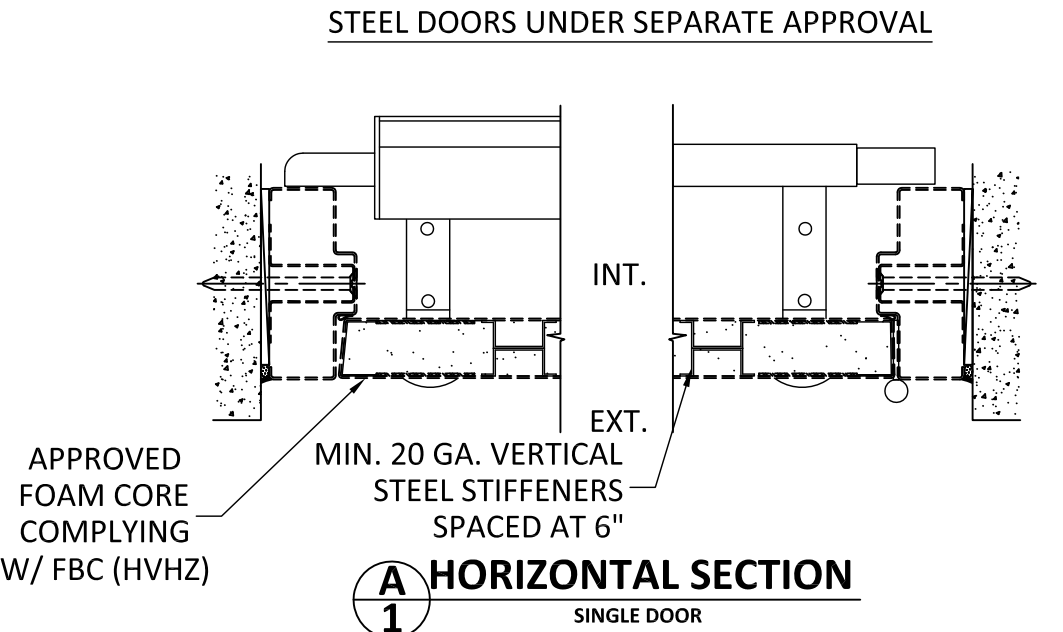

OUTSWING SINGLE STEEL DOOR  
DOORS UNDER SEPARATE APPROVAL



dormakaba USA Inc.  
6161 E. 75TH STREET  
INDIANAPOLIS, IN 46250  
PH: (317) 806-3288

ARM-A-DOR  
PANIC EXIT HARDWARE DEVICE  
GENERAL NOTES, ELEVATION,  
AND SECTION VIEW

PREPARED BY:  
**BUILDING DROPS, INC.**  
398 E. DANIA BEACH BLVD., STE. 338  
DANIA BEACH, FL 33004  
PH: (954)399-8478  
FAX: (954)744-4738  
WEB: www.buildingdrops.com



REMARKS	BY	DATE

THE INSTALLATION DETAILS DESCRIBED HEREIN ARE GENERIC AND MAY NOT REFLECT ACTUAL CONDITIONS FOR A SPECIFIC SITE. IF SITE CONDITIONS CAUSE INSTALLATION TO DEVIATE FROM THE REQUIREMENTS DETAILED HEREIN, A LICENSED ENGINEER OR ARCHITECT SHALL PREPARE SITE SPECIFIC DOCUMENTS FOR USE WITH THIS DOCUMENT.



FL16202

DATE: 02.13.18

DWG. BY:  
SM

CHK. BY:  
HFN

SCALE: NTS

DWG. #: DOR008

SHEET:

1

OF 3

s:\projects\dormakaba\loc-18-1134- 1120096 and 116202 (revision and name change)\dwg\116202 dor008 arm-a-dor.dwg 2/15/2019 1:20 PM

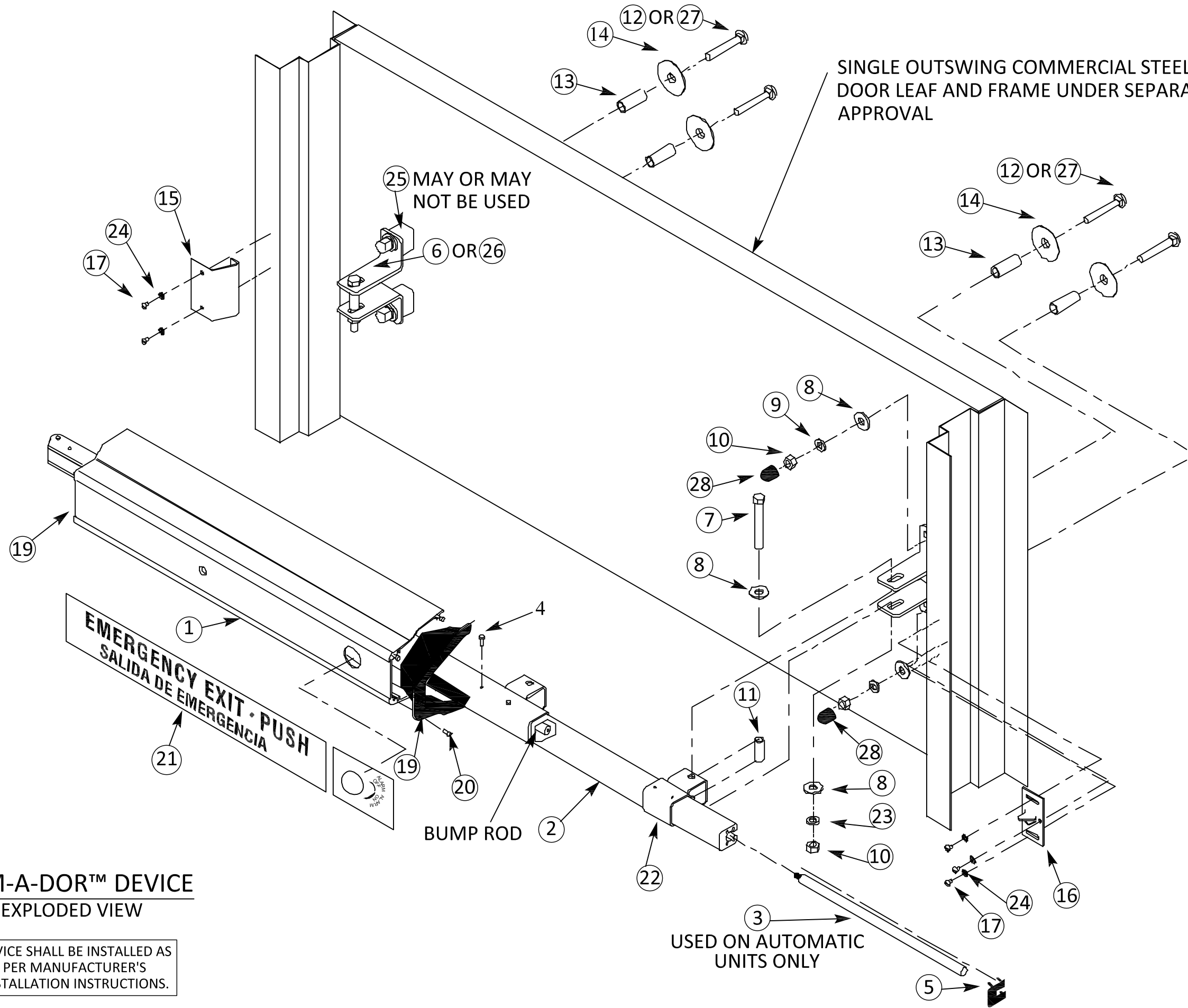

**ARM-A-DOR™ DEVICE**  
**EXPLODED VIEW**

DEVICE SHALL BE INSTALLED AS  
PER MANUFACTURER'S  
INSTALLATION INSTRUCTIONS.



dormakaba USA Inc.  
6161 E. 75TH STREET  
INDIANAPOLIS, IN 46250  
PH: (317) 806-3288

ARM-A-DOR  
PANIC EXIT HARDWARE DEVICE

EXPLODED ISOMETRIC VIEW

PREPARED BY:

**BUILDING DROPS, INC.**  
398 E. DANIA BEACH BLVD., STE. 338  
DANIA BEACH, FL 33004  
PH: (954)399-8478  
FAX: (954)744-4738  
WEB: www.buildingdrops.com



REMARKS	BY	DATE

THE INSTALLATION DETAILS DESCRIBED HEREIN ARE GENERIC  
AND MAY NOT REFLECT ACTUAL CONDITIONS FOR A SPECIFIC  
SITE. IF SITE CONDITIONS CAUSE INSTALLATION TO DEVIATE  
FROM THE REQUIREMENTS DETAILED HEREIN, A LICENSED  
ENGINEER OR ARCHITECT SHALL PREPARE SITE SPECIFIC  
DOCUMENTS FOR USE WITH THIS DOCUMENT.

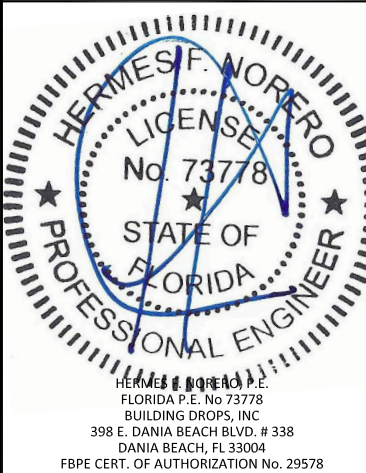

**FL16202**

DATE: **02.13.18**

DWG. BY:  
**SM**

CHK. BY:  
**HFN**

SCALE: **NTS**

DWG. #: **DOR008**

SHEET:

**2**

OF 3

2/15/2019 1:20 PM

s:\projects\dormakaba\loc-18-1134- 020006 and fl16202 (revision and name change)\dwg\fl16202 dor008 arm-a-dor.dwg

ARM-A-DOR™ DEVICE BILL OF MATERIALS		
ITEM	QTY	DESCRIPTION
1	1	LOCK ASSEMBLY
2	1	TAILPIECE
3	1	EXTENSION ROD (AUTO UNITS ONLY)
4	8	THREAD CUTTING SCREW (#6-3/8" LG)
5	1	END CAP (FOR TAILPIECE)
6	4	LONG DOOR BRACKET (3-1/2" X 2")
7	2	HEX HEAD BOLT (3/8" X 2-1/2")
8	8	FLAT WASHER (3/8")
9	4	STAR LOCK WASHER (3/8")
10	6	HEX NUT (3/8"-16)
11	2	SUPPORT SLEEVE (1-1/4" LG)
12	4	CARRIAGE BOLT (3/8" X 2-1/2" LG)
13	4	SUPPORT TUBE (1-5/8" LG)
14	4	BOLT WASHER
15	1	STRIKE PLATE
16	1	RELEASE BRACKET (AUTO UNITS ONLY)
17	5	SELF TAPPING SCREW (#10 X 3/4" LG)
18	1	DRILL TEMPLATE
19	2	END CAP (FOR PUSH BAR)
20	8	MACHINE SCREW (#6 X 3/4" LG)
21	1	EMERGENCY LABEL
22	1	EXTENSION COLLAR
23	2	SPLIT LOCK WASHER (3/8")
24	6	STAR LOCK WASHER (#10)
25	4	DOOR BRACKET SPACER
26	4	SHORT DOOR BRACKET (1-1/2" X 2")
27	4	CARRIAGE BOLT (3/8" X 3-1/2" LG)
28	4	CAP (GRAY)
NA	2	9-VOLT ALKALINE BATTERY

MODEL NUMBER	DESCRIPTION
A101-001	AUTOMATIC LOCK ASSEMBLY
A102-001	MANUAL LOCK ASSEMBLY
A101-002	AUTOMATIC LOCK ASSEMBLY WITH ALARM
A102-002	MANUAL LOCK ASSEMBLY WITH ALARM

TAILPIECE, EXTENSION ROD, TAILPIECE COLLAR, AND TAILPIECE PROTRUSION REQUIREMENTS			
DOOR WIDTH	TAILPIECE LENGTH	EXTENSION ROD LENGTH	TAILPIECE COLLAR
36"	8"	Not used	NO
37"	9"	1"	NO
38"	10"	2"	NO
39"	11"	3"	NO
40"	12"	4"	YES
41"	13"	5"	YES
42"	14"	6"	YES
43"	15"	7"	YES
44"	16"	8"	YES
45"	17"	9"	YES
46"	18"	10"	YES
47"	19"	11"	YES
48"	AS SHIPPED	AS SHIPPED	YES

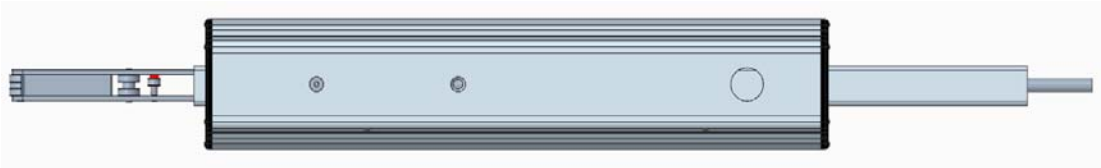

ARM-A-DOR™ DEVICE  
FRONT VIEW

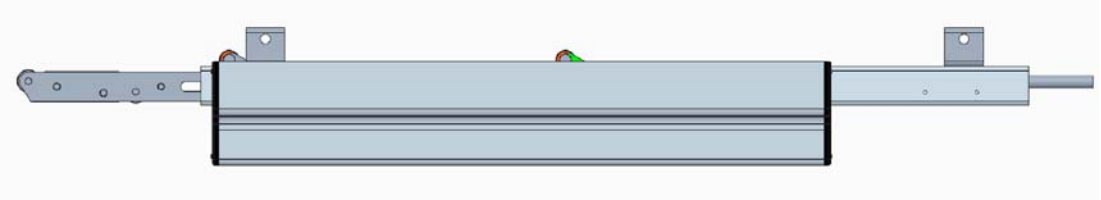

ARM-A-DOR™ DEVICE  
TOP VIEW

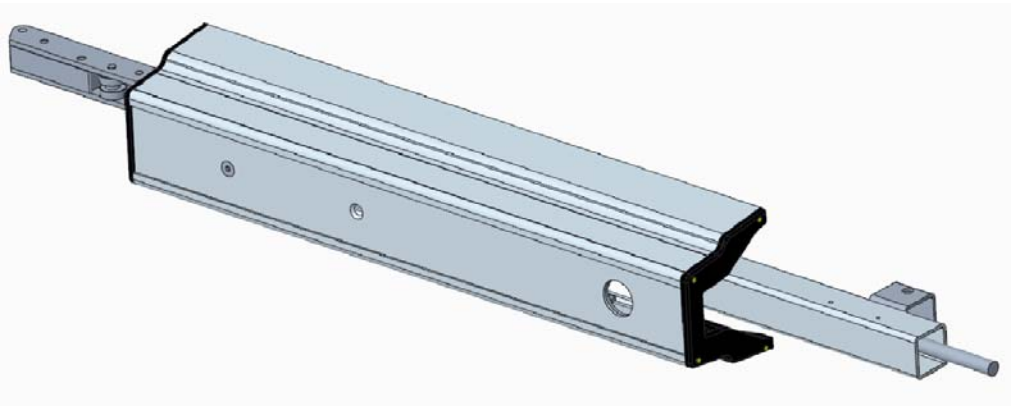

ARM-A-DOR™ DEVICE  
ASSEMBLED ISOMETRIC VIEW



dormakaba USA Inc.  
6161 E. 75TH STREET  
INDIANAPOLIS, IN 46250  
PH: (317) 806-3288

TITLE:

ARM-A-DOR  
PANIC EXIT HARDWARE DEVICE

B.O.M. AND ORTHO & ISO VIEW

PREPARED BY:

BUILDING DROPS, INC.

398 E. DANIA BEACH BLVD., STE. 338  
DANIA BEACH, FL 33004  
PH: (954)399-8478  
FAX: (954)744-4738  
WEB: www.buildingdrops.com

REMARKS	BY	DATE

THE INSTALLATION DETAILS DESCRIBED HEREIN ARE GENERIC AND MAY NOT REFLECT ACTUAL CONDITIONS FOR A SPECIFIC SITE. IF SITE CONDITIONS CAUSE INSTALLATION TO DEVIATE FROM THE REQUIREMENTS DETAILED HEREIN, A LICENSED ENGINEER OR ARCHITECT SHALL PREPARE SITE SPECIFIC DOCUMENTS FOR USE WITH THIS DOCUMENT.

HERMES F. NORENO, P.E.

FLORIDA P.E. No 73778

BUILDING DROPS, INC

398 E. DANIA BEACH BLVD. # 338

DANIA BEACH, FL 33004

FBPE CERT. OF AUTHORIZATION No. 29578

FL16202

DATE: 02.13.18

DWG. BY:  
SM

CHK. BY:  
HFN

SCALE: NTS

DWG. #: DOR008

SHEET:

3