

REVISIONS			
REV	DESCRIPTION	DATE	APPROVED
A	REVISED PER NEW REQUIREMENTS	01/09/18	R.L.

NOTES:

1. THE PRODUCT SHOWN HEREIN IS DESIGNED AND MANUFACTURED TO COMPLY WITH REQUIREMENTS OF THE FLORIDA BUILDING CODE INCLUDING THE HVHZ.
2. WOOD FRAMING AND MASONRY OPENING TO BE DESIGNED AND ANCHORED TO PROPERLY TRANSFER ALL LOADS TO STRUCTURE. FRAMING AND MASONRY OPENING IS THE RESPONSIBILITY OF THE ARCHITECT OR ENGINEER OF RECORD.
3. 1X BUCK OVER MASONRY/CONCRETE IS OPTIONAL. WHERE 1X BUCK IS NOT USED DISSIMILAR MATERIALS MUST BE SEPARATED WITH APPROVED COATING OR MEMBRANE. SELECTION OF COATING OR MEMBRANE IS THE RESPONSIBILITY OF THE ARCHITECT OR ENGINEER OF RECORD.
4. ALLOWABLE STRESS INCREASE OF 1/3 WAS NOT USED IN THE DESIGN OF THE PRODUCT SHOWN HEREIN. WIND LOAD DURATION FACTOR Cd=1.6 WAS USED FOR WOOD ANCHOR CALCULATIONS.
5. FRAME MATERIAL: EXTRUDED ALUMINUM 6063-T6.
6. UNITS MUST BE GLAZED PER ASTM E1300-04/09 SEE SHEET 2 FOR DETAILS.
7. APPROVED IMPACT PROTECTIVE SYSTEM IS NOT REQUIRED FOR THIS PRODUCT IN WIND BORNE DEBRIS REGIONS.
8. SHIM AS REQUIRED AT EACH INSTALLATION ANCHOR WITH LOAD BEARING SHIM. SHIM WHERE SPACE OF 1/16" OR GREATER OCCURS. MAXIMUM ALLOWABLE SHIM STACK TO BE 1/4".
9. FOR ANCHORING INTO WOOD FRAMING OR 2X BUCK USE #10 WOOD SCREWS WITH SUFFICIENT LENGTH TO ACHIEVE A 1 1/4" MINIMUM EMBEDMENT INTO SUBSTRATE. LOCATE ANCHORS AS SHOWN IN ELEVATIONS AND INSTALLATION DETAILS.
10. FOR ANCHORING INTO MASONRY/CONCRETE USE 1/4" TAPCONS WITH SUFFICIENT LENGTH TO ACHIEVE A 1 1/4" MINIMUM EMBEDMENT INTO SUBSTRATE WITH 2" MINIMUM EDGE DISTANCE. LOCATE ANCHORS AS SHOWN IN ELEVATIONS AND INSTALLATION DETAILS.
11. FOR ANCHORING TROUGH FRAME INTO METAL STRUCTURE USE #10 SMS OR SELF DRILLING SCREWS WITH SUFFICIENT LENGTH TO ACHIEVE 3 THREADS MINIMUM BEYOND STRUCTURE INTERIOR WALL. LOCATE ANCHORS AS SHOWN IN ELEVATIONS AND INSTALLATION DETAILS.

12. ALL FASTENERS TO BE CORROSION RESISTANT.
13. INSTALLATION ANCHORS SHALL BE INSTALLED IN ACCORDANCE WITH ANCHOR MANUFACTURER'S INSTALLATION INSTRUCTIONS AND ANCHORS SHALL NOT BE USED IN SUBSTRATES WITH STRENGTHS LESS THAN THE MINIMUM STRENGTH SPECIFIED BELOW:
 - A. WOOD – MINIMUM SPECIFIC GRAVITY OF G=0.42
 - B. CONCRETE – MINIMUM COMPRESSIVE STRENGTH OF 3,192 PSI.
 - C. MASONRY – STRENGTH CONFORMANCE TO ASTM C-90, GRADE N, TYPE 1 (OR GREATER).
 - D. METAL STRUCTURE: STEEL 18GA, 33KSI OR ALUMINUM 6063-T5 .048" THICK MINIMUM
14. APPROVED CONFIGURATIONS: OXXO, OXX, XXO, XX, OX, XO
15. UNITS MUST BE INSTALLED WITH 2 1/4" SILL RISER.

TABLE OF CONTENTS	
SHEET NO.	DESCRIPTION
1	NOTES
2	ELEVATION
3 – 11	INSTALLATION DETAILS



EASTERN ARCHITECTURAL SYSTEMS
A DIVISION OF
EASTERN METAL SUPPLY

16341 DOMESTIC AVE
FORT MYERS, FL 33912
800-432-2204

SERIES FWI 6000 ALUMINUM IMPACT RATED
SLIDING GLASS DOOR
NOTES

DRAWN:
N.G.

DWG NO.
08-02676

REV
A

SCALE NTS

DATE 03/30/15

SHEET 1 OF 11

L. ROBERTO LOMAS P.E.
1432 WOODFORD RD LEWISVILLE, NC 27023
434-688-0609 rllomas@lrlomaspe.com

SIGNED: 01/09/2018

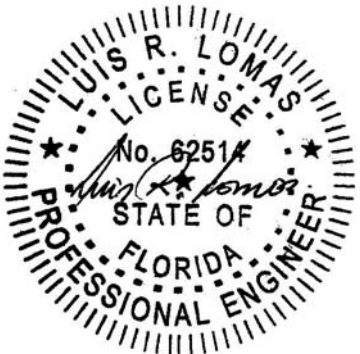

Luis R. Lomas P.E.
FL No.: 62514

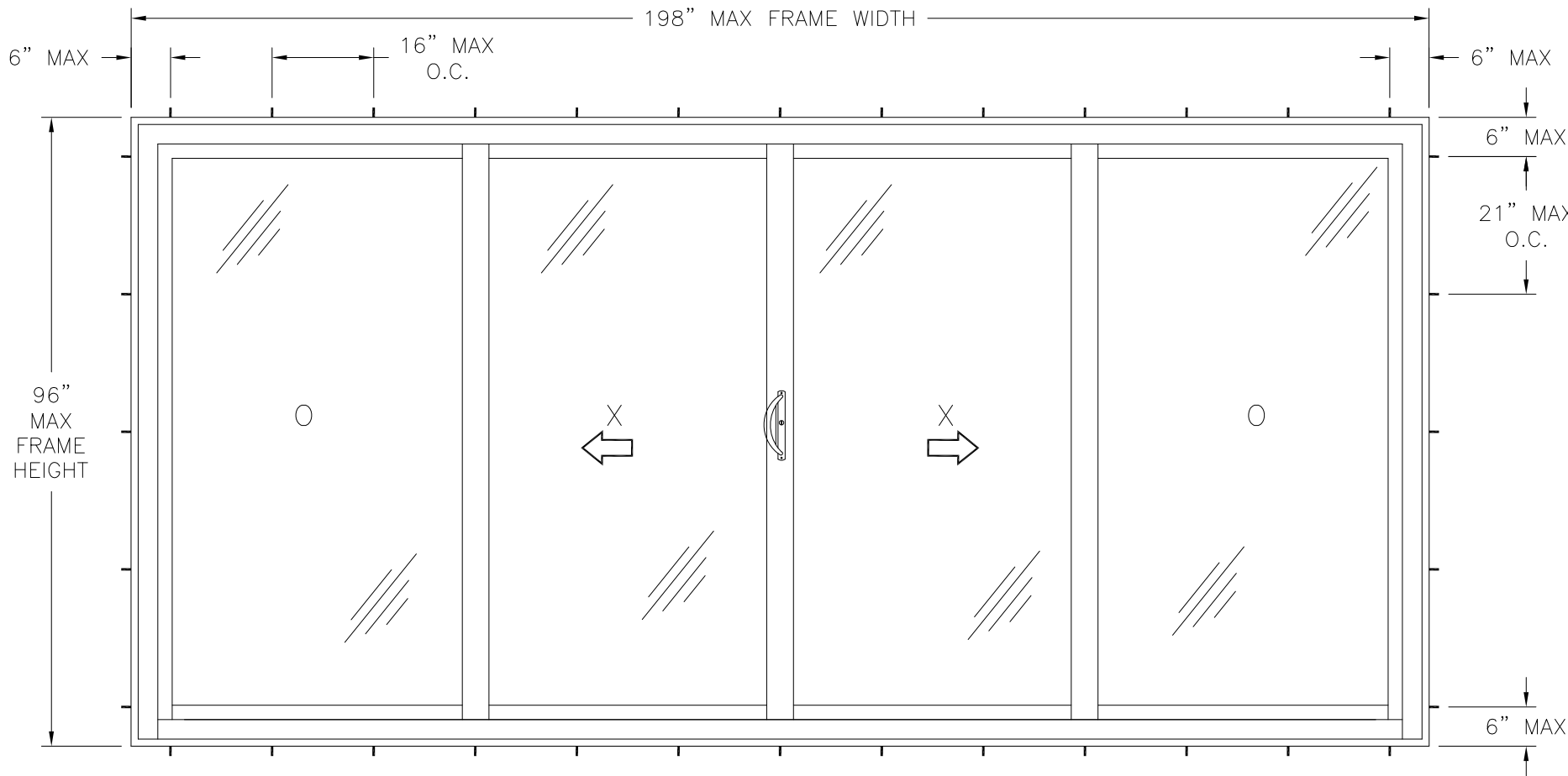

SERIES FWI 6000 ALUMINUM IMPACT RATED SLIDING GLASS DOOR
EXTERIOR VIEW

UNITS UP TO 4 PANELS IN UNLIMITED CONFIGURATIONS ARE APPROVED, SEE NOTE 14
SHEET 1, AS LONG AS INDIVIDUAL PANEL AREA DOES NOT EXCEED 33.64 FT²

DESIGN PRESSURE RATING	IMPACT RATING
±80.0PSF	LARGE AND SMALL MISSILE IMPACT

MISSILE LEVEL D, WIND ZONE 4

REVISIONS			
REV	DESCRIPTION	DATE	APPROVED
A	REVISED PER NEW REQUIREMENTS	01/09/18	R.L.

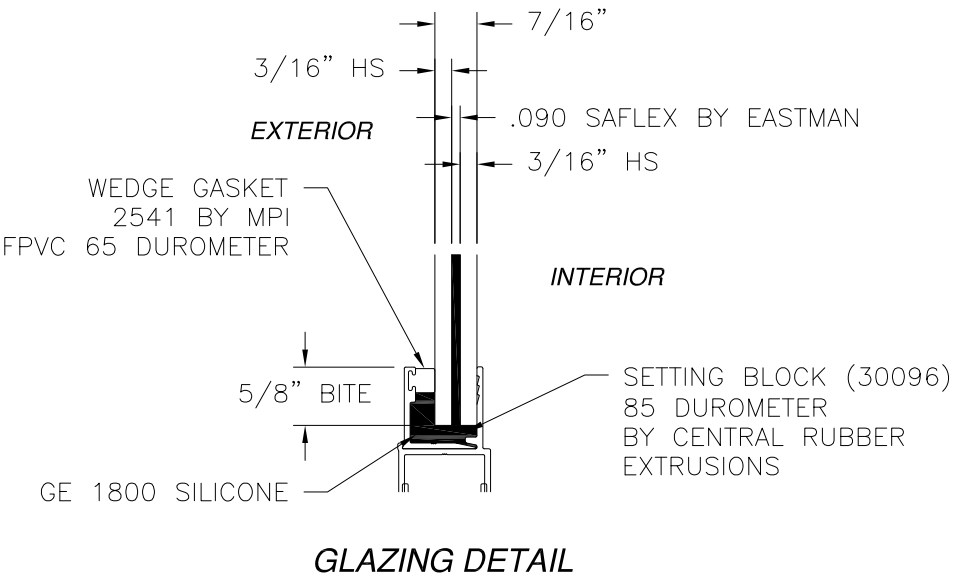

- NOTES:
- (8) 1 3/4" WEEP NOTCH FOUR AT EACH END OF FRAME SILL
 - PANEL SIZE: 51" X 95"
 4. D.L.O.: 44 3/4" X 90 3/4"

HARDWARE SCHEDULE	
A.	(1) FLUSH MOUNT STEEL THREE PLY HOOK LOCK AT 41" FROM BOTTOM MOVING PANEL LOCK STILE
B.	(1) STEEL KEEPER AT 39 1/2" FROM BOTTOM FEMALE ASTRAGAL STILE
C.	(2) ADJUSTABLE TANDEM ALUMINUM WHEELS IN ALUMINUM HOUSING AT EACH PANEL BOTTOM RAIL



EASTERN ARCHITECTURAL SYSTEMS
A DIVISION OF
EASTERN METAL SUPPLY

16341 DOMESTIC AVE
FORT MYERS, FL 33912
800-432-2204

SERIES FWI 6000 ALUMINUM IMPACT RATED
SLIDING GLASS DOOR
ELEVATION

DRAWN: N.G.	DWG NO. 08-02676	REV A
SCALE NTS	DATE 03/30/15	SHEET 2 OF 11

L. ROBERTO LOMAS P.E.
1432 WOODFORD RD LEWISVILLE, NC 27023
434-688-0609 rllomas@lrlomaspe.com

SIGNED: 01/09/2018



Luis R. Lomas P.E.
FL No.: 62514

REVISIONS			
REV	DESCRIPTION	DATE	APPROVED
A	REVISED PER NEW REQUIREMENTS	01/09/18	R.L.

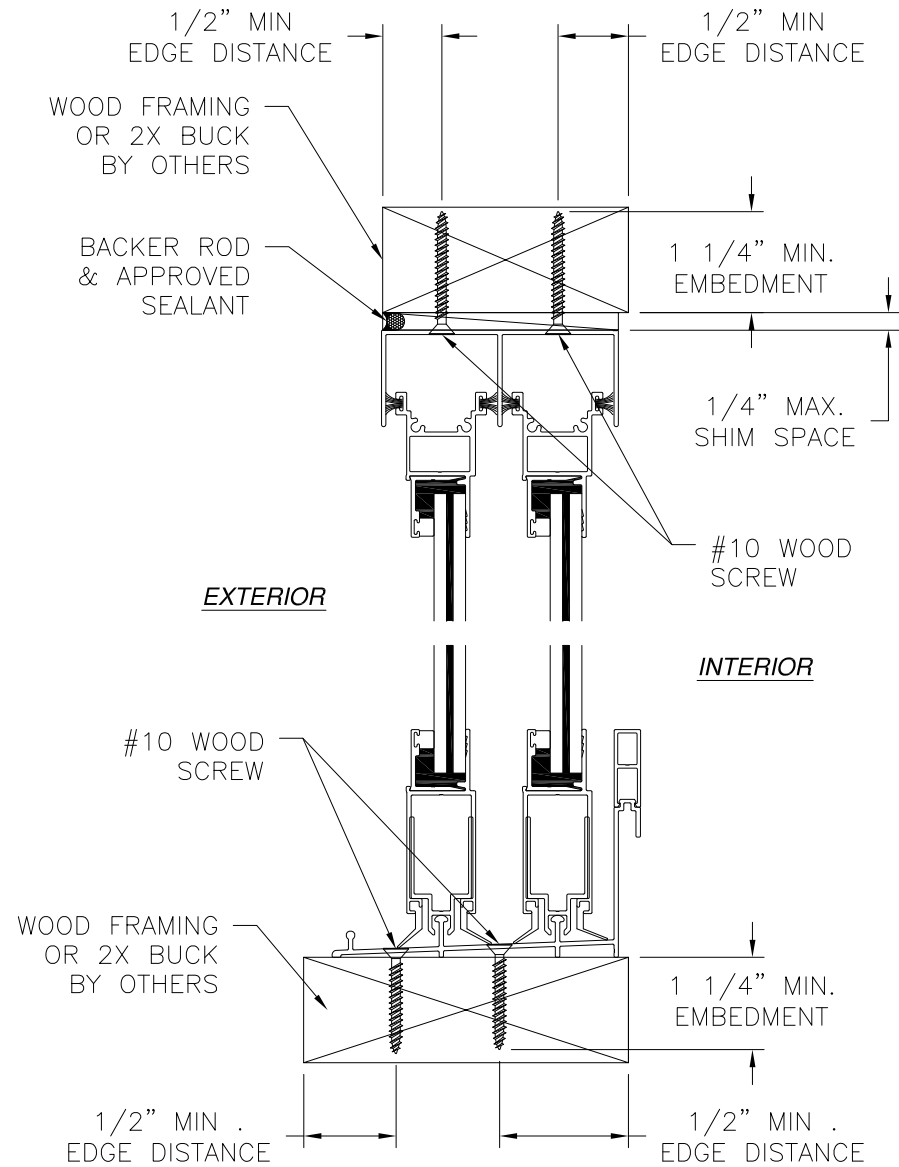

VERTICAL CROSS SECTION
WOOD FRAMING OR 2X BUCK INSTALLATION

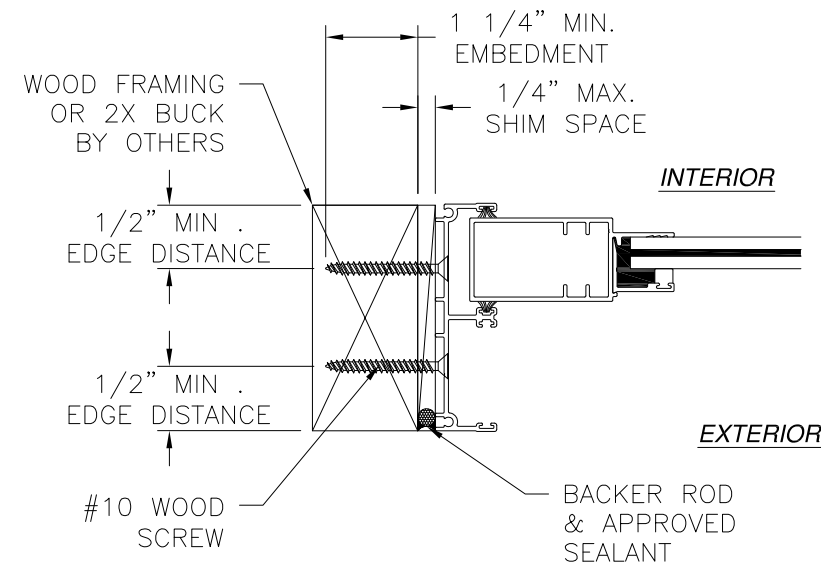

JAMB INSTALLATION DETAIL
WOOD FRAMING OR 2X BUCK INSTALLATION

NOTES:
1. INTERIOR AND EXTERIOR FINISHES, BY OTHERS,
NOT SHOWN FOR CLARITY.
2. PERIMETER AND JOINT SEALANT BY OTHERS TO BE
DESIGNED IN ACCORDANCE WITH ASTM E2112

SIGNED: 01/09/2018

		EASTERN ARCHITECTURAL SYSTEMS A DIVISION OF EASTERN METAL SUPPLY 16341 DOMESTIC AVE FORT MYERS, FL 33912 800-432-2204	
SERIES FWI 6000 ALUMINUM IMPACT RATED SLIDING GLASS DOOR 2 TRACK INSTALLATION DETAILS			
DRAWN: N.G.		DWG NO. 08-02676	
SCALE NTS		DATE 03/30/15	
SHEET 3 OF 11		REV A	
L. ROBERTO LOMAS P.E. 1432 WOODFORD RD LEWISVILLE, NC 27023 434-688-0609 rllomas@lrlomaspe.com			



Luis R. Lomas P.E.
FL No.: 62514

REVISIONS			
REV	DESCRIPTION	DATE	APPROVED
A	REVISED PER NEW REQUIREMENTS	01/09/18	R.L.

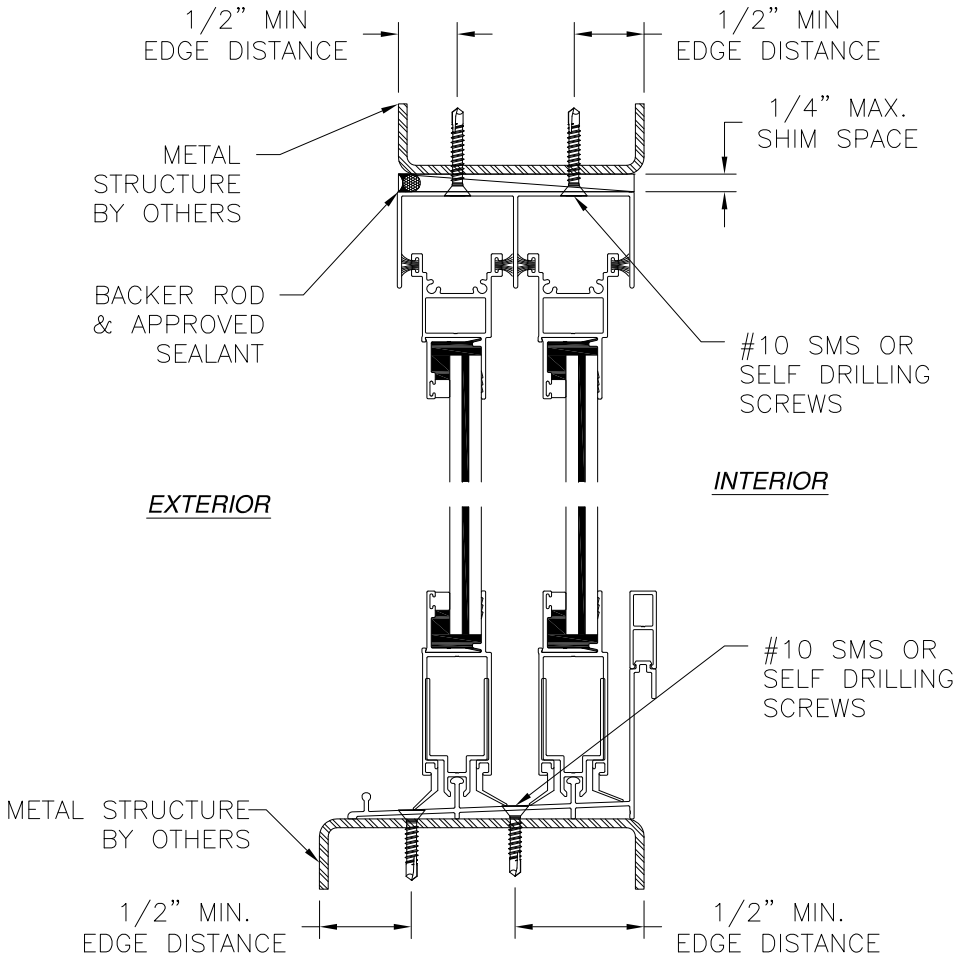

VERTICAL CROSS SECTION
METAL STRUCTURE INSTALLATION

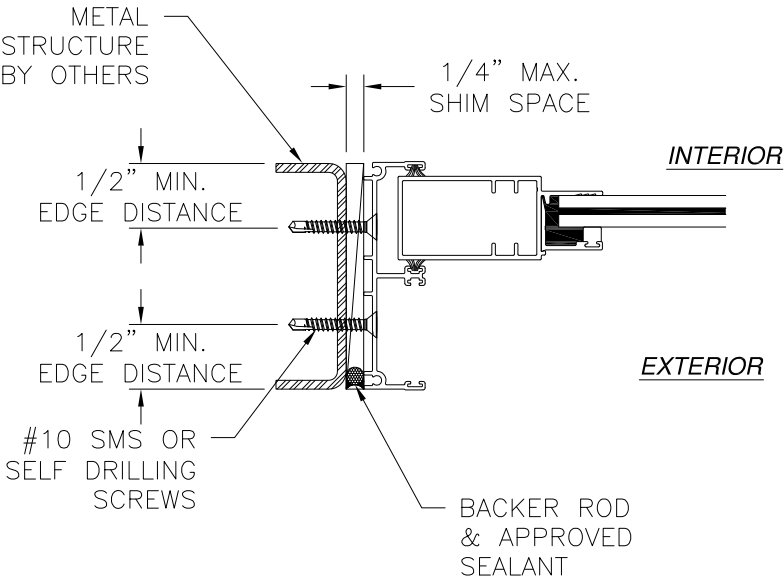

JAMB INSTALLATION DETAIL
METAL STRUCTURE INSTALLATION

NOTES:
 1. INTERIOR AND EXTERIOR FINISHES, BY OTHERS, NOT SHOWN FOR CLARITY.
 2. PERIMETER AND JOINT SEALANT BY OTHERS TO BE DESIGNED IN ACCORDANCE WITH ASTM E2112

SIGNED: 01/09/2018



EASTERN ARCHITECTURAL SYSTEMS
A DIVISION OF
EASTERN METAL SUPPLY

16341 DOMESTIC AVE
FORT MYERS, FL 33912
800-432-2204

SERIES FWI 6000 ALUMINUM IMPACT RATED
SLIDING GLASS DOOR
2 TRACK INSTALLATION DETAILS

DRAWN: N.G.	DWG NO. 08-02676	REV A
SCALE NTS	DATE 03/30/15	SHEET 4 OF 11

L. ROBERTO LOMAS P.E.
1432 WOODFORD RD LEWISVILLE, NC 27023
434-688-0609 rllomas@lrlomaspe.com



Luis R. Lomas P.E.
FL No.: 62514

REVISIONS			
REV	DESCRIPTION	DATE	APPROVED
A	REVISED PER NEW REQUIREMENTS	01/09/18	R.L.

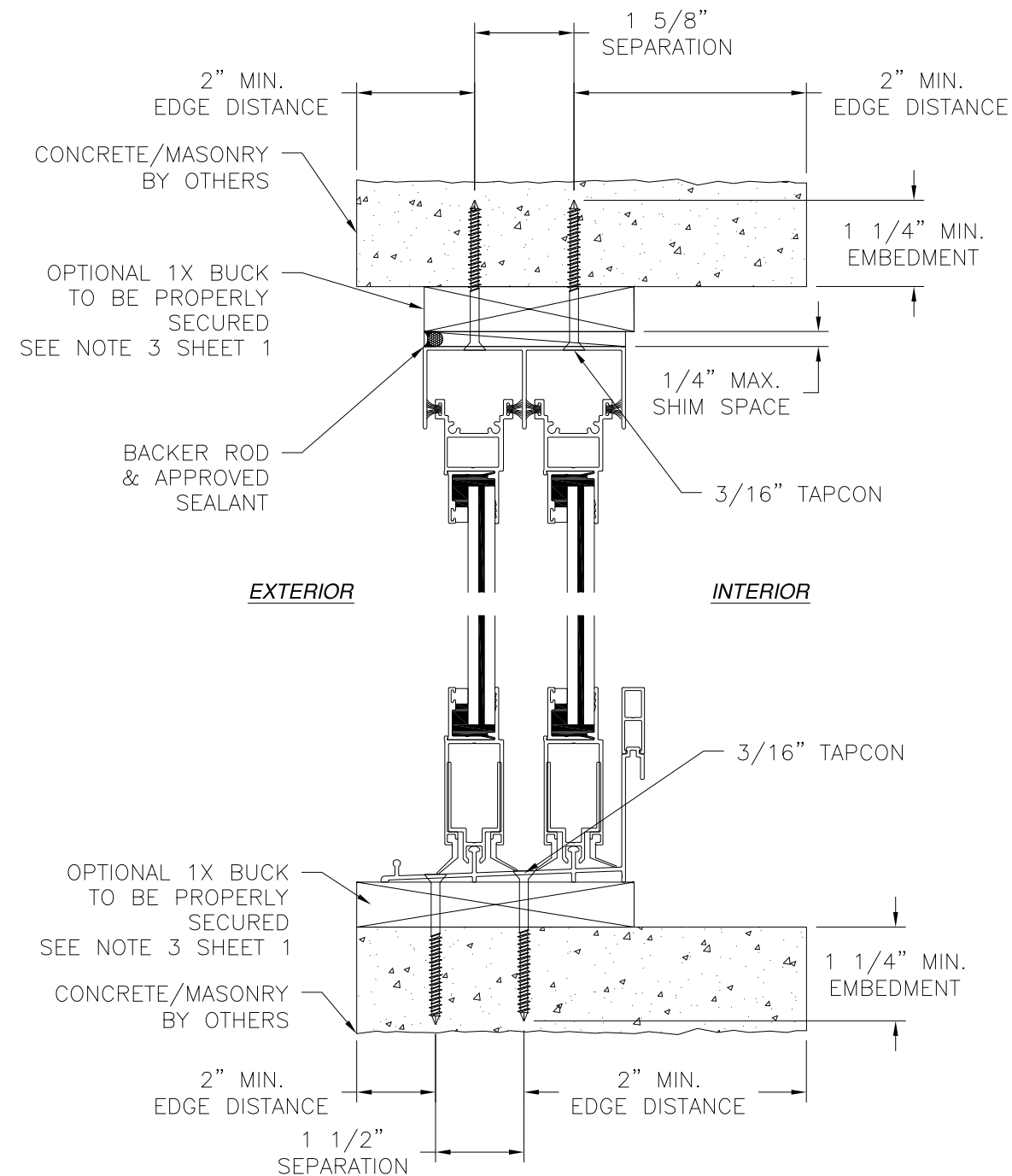

VERTICAL CROSS SECTION
CONCRETE/MASONRY INSTALLATION

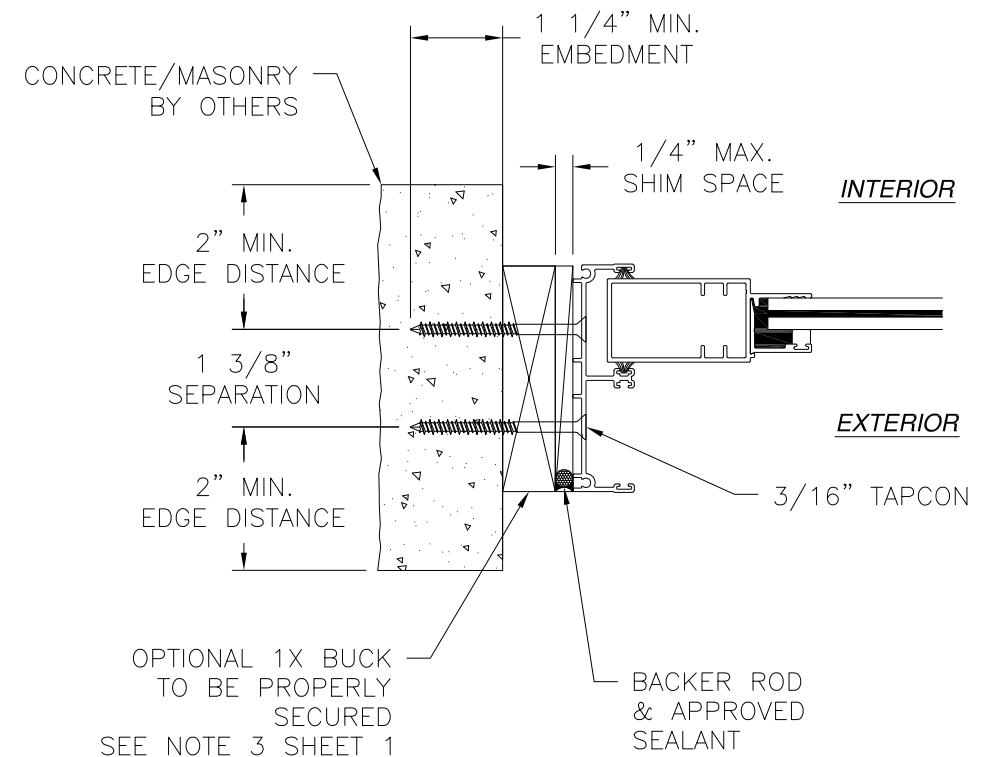

JAMB INSTALLATION DETAIL
CONCRETE/MASONRY INSTALLATION

NOTES:
1. INTERIOR AND EXTERIOR FINISHES, BY OTHERS,
NOT SHOWN FOR CLARITY.

SIGNED: 01/09/2018



Eastern
ARCHITECTURAL SYSTEMS
ALUMINUM AND VINYL
IMPACT WINDOWS AND DOORS

OTHERS TO BE
BY OTHERS TO BE
A DIVISION OF
TAMMERN METAL SUPPLY
16341 DOMESTIC AVE
FORT MYERS, FL 33912
800-432-2204

SERIES FWI 6000 ALUMINUM IMPACT RATED
SLIDING GLASS DOOR
2 TRACK INSTALLATION DETAILS

DRAWN: N.G.	DWG NO. 08-02676	REV A
SCALE NTS	DATE 03/30/15	SHEET 3 OF 11

L. ROBERTO LOMAS P.E.
1432 WOODFORD RD LEWISVILLE, NC 27023
434-688-0609 rllomas@lrlomaspe.com

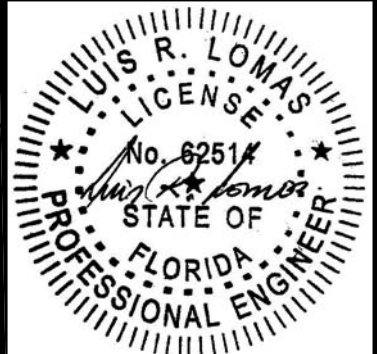

Luis R. Lomas P.E.
FL No.: 62514

REVISIONS			
REV	DESCRIPTION	DATE	APPROVED
A	REVISED PER NEW REQUIREMENTS	01/09/18	R.L.

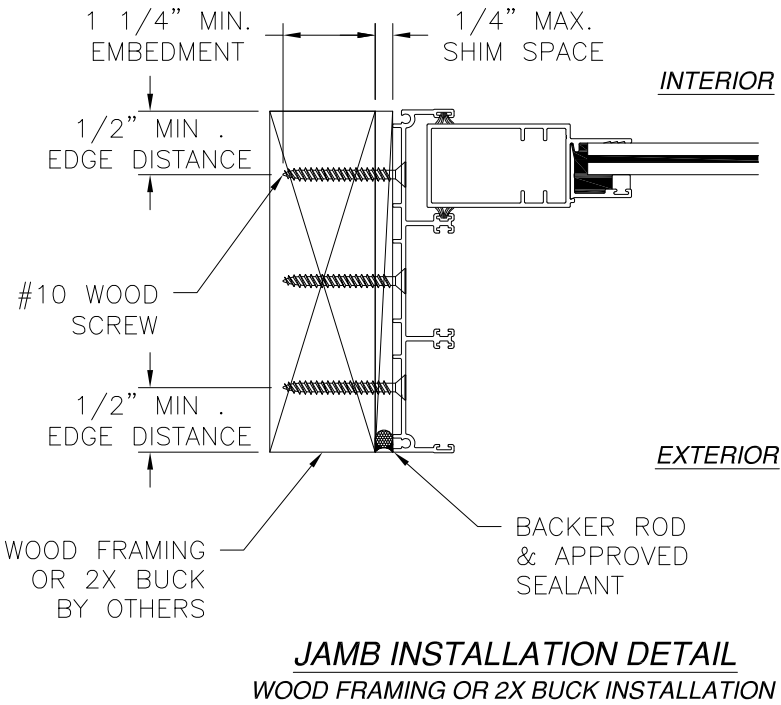
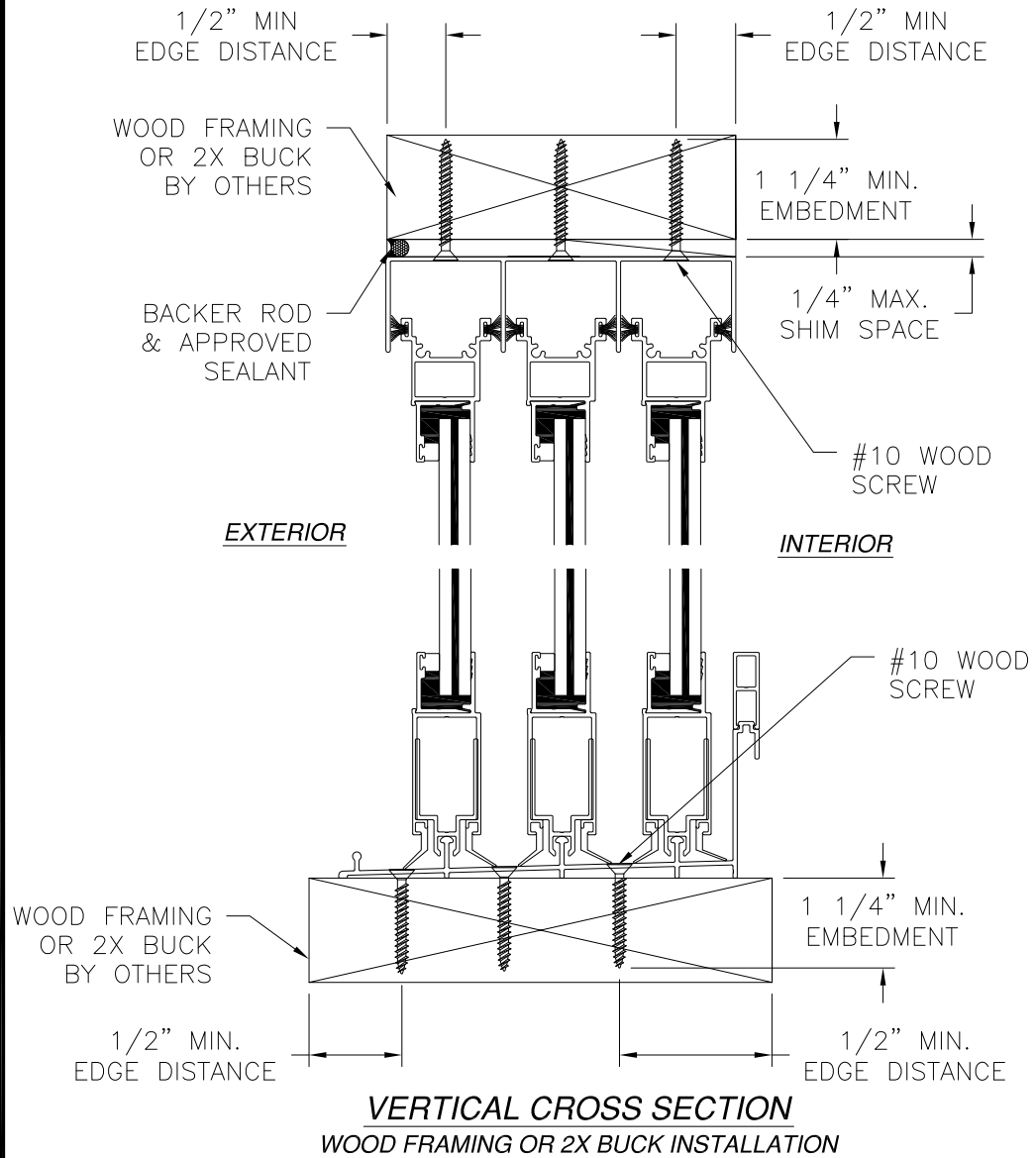

NOTES:
 1. INTERIOR AND EXTERIOR FINISHES, BY OTHERS, NOT SHOWN FOR CLARITY.
 2. PERIMETER AND JOINT SEALANT BY OTHERS TO BE DESIGNED IN ACCORDANCE WITH ASTM E2112

SIGNED: 01/09/2018



EASTERN ARCHITECTURAL SYSTEMS
 A DIVISION OF
 EASTERN METAL SUPPLY
 16341 DOMESTIC AVE
 FORT MYERS, FL 33912
 800-432-2204

SERIES FWI 6000 ALUMINUM IMPACT RATED
 SLIDING GLASS DOOR
 3 TRACK INSTALLATION DETAILS

DRAWN: N.G.	DWG NO. 08-02676	REV A
SCALE NTS	DATE 03/30/15	SHEET 6 OF 11

L. ROBERTO LOMAS P.E.
 1432 WOODFORD RD LEWISVILLE, NC 27023
 434-688-0609 rllomas@lrlomaspe.com

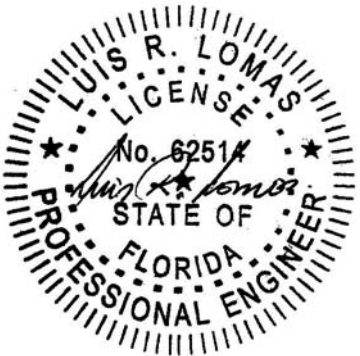

Luis R. Lomas P.E.
 FL No.: 62514

REVISIONS			
REV	DESCRIPTION	DATE	APPROVED
A	REVISED PER NEW REQUIREMENTS	01/09/18	R.L.

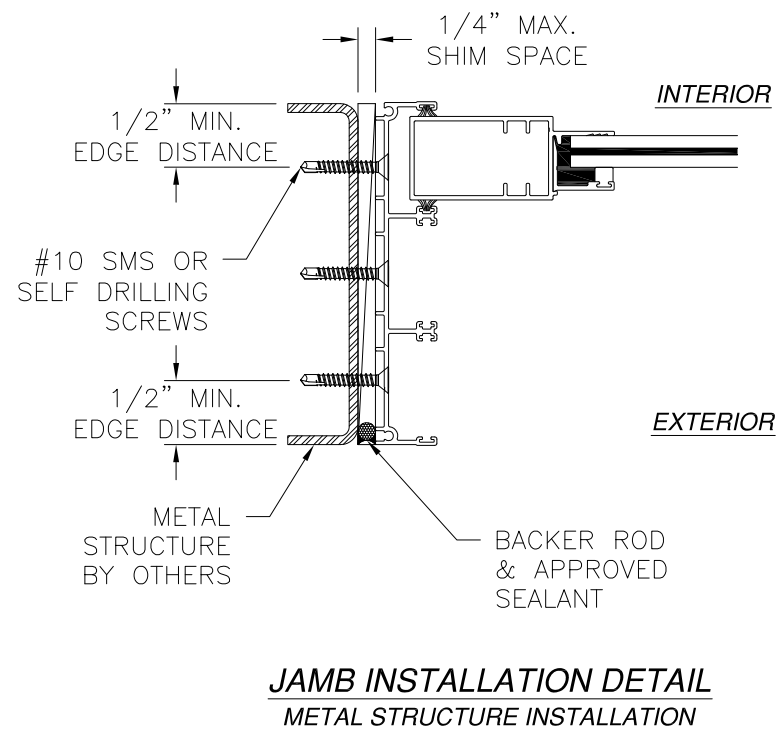
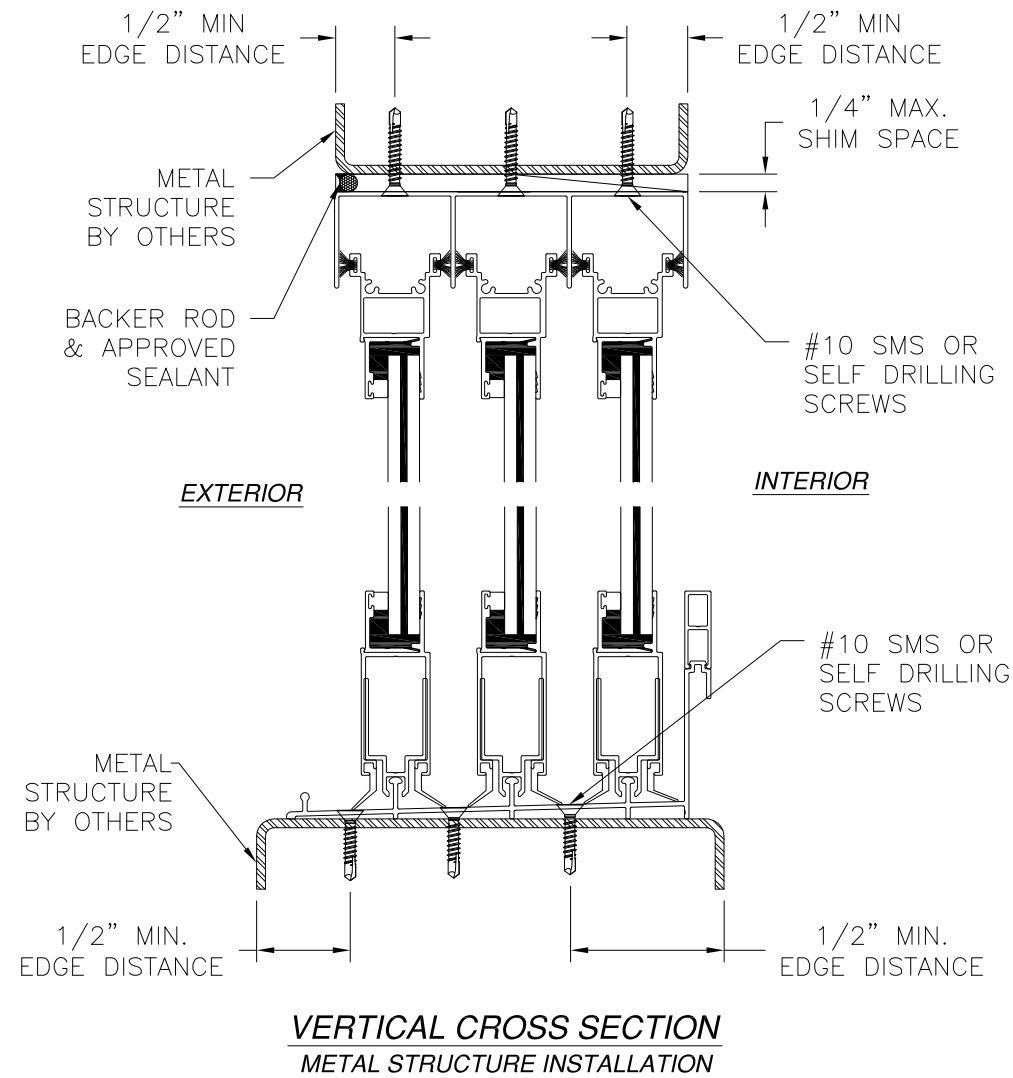

NOTES:
1. INTERIOR AND EXTERIOR FINISHES, BY OTHERS, NOT SHOWN FOR CLARITY.
2. PERIMETER AND JOINT SEALANT BY OTHERS TO BE DESIGNED IN ACCORDANCE WITH ASTM E2112



EASTERN ARCHITECTURAL SYSTEMS
A DIVISION OF
EASTERN METAL SUPPLY

16341 DOMESTIC AVE
FORT MYERS, FL 33912
800-432-2204

SERIES FWI 6000 ALUMINUM IMPACT RATED
SLIDING GLASS DOOR
3 TRACK INSTALLATION DETAILS

DRAWN: N.G.	DWG NO. 08-02676	REV A
SCALE NTS	DATE 03/30/15	SHEET 7 OF 11

L. ROBERTO LOMAS P.E.
1432 WOODFORD RD LEWISVILLE, NC 27023
434-688-0609 rllomas@lrlomaspe.com

SIGNED: 01/09/2018

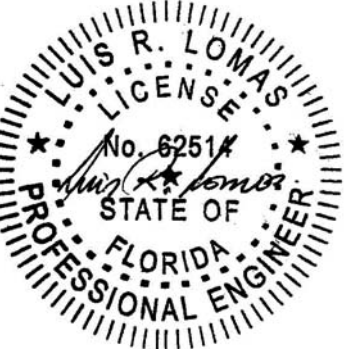

Luis R. Lomas P.E.
FL No.: 62514

REVISIONS			
REV	DESCRIPTION	DATE	APPROVED
A	REVISED PER NEW REQUIREMENTS	01/09/18	R.L.

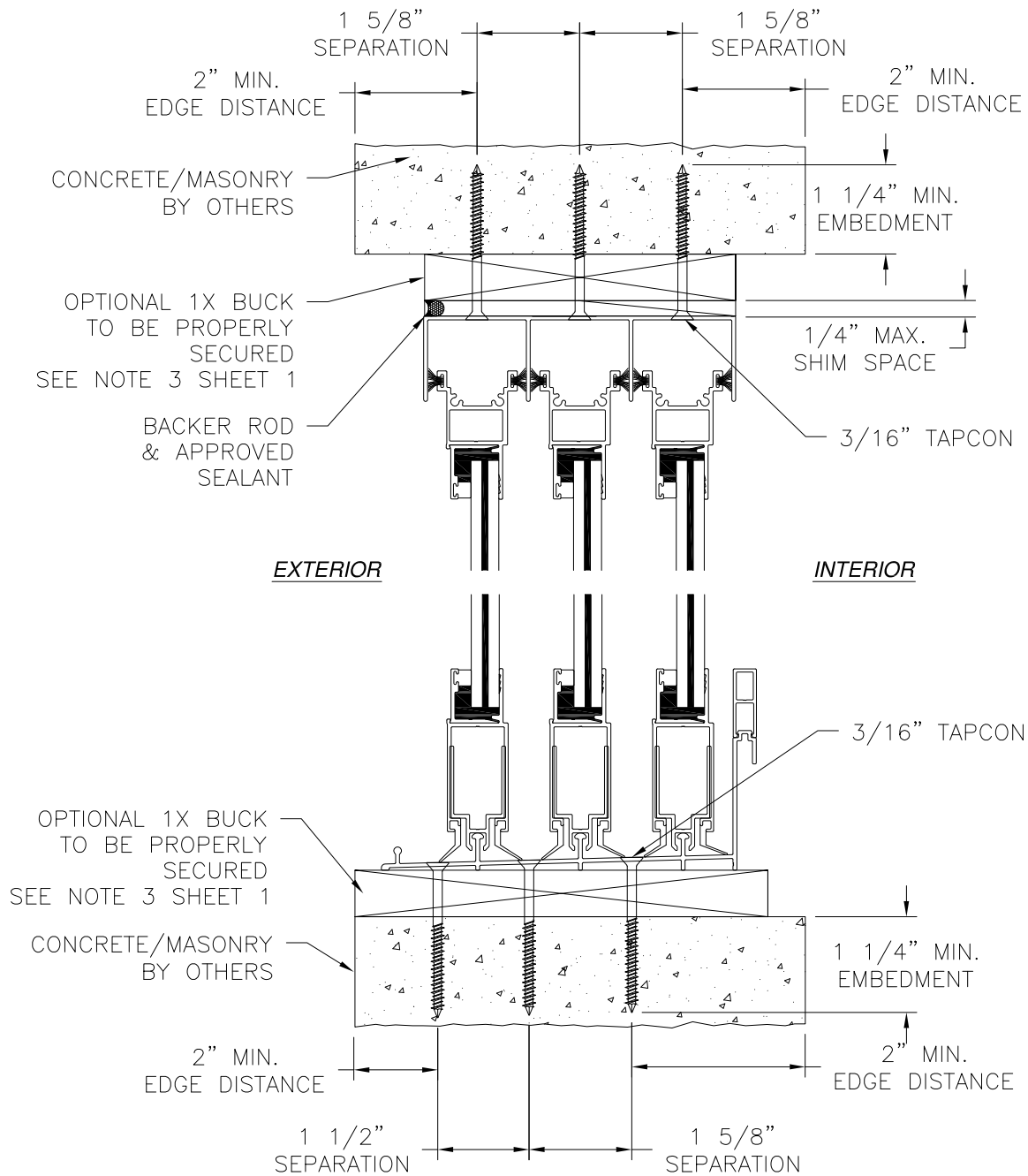

VERTICAL CROSS SECTION
CONCRETE/MASONRY INSTALLATION

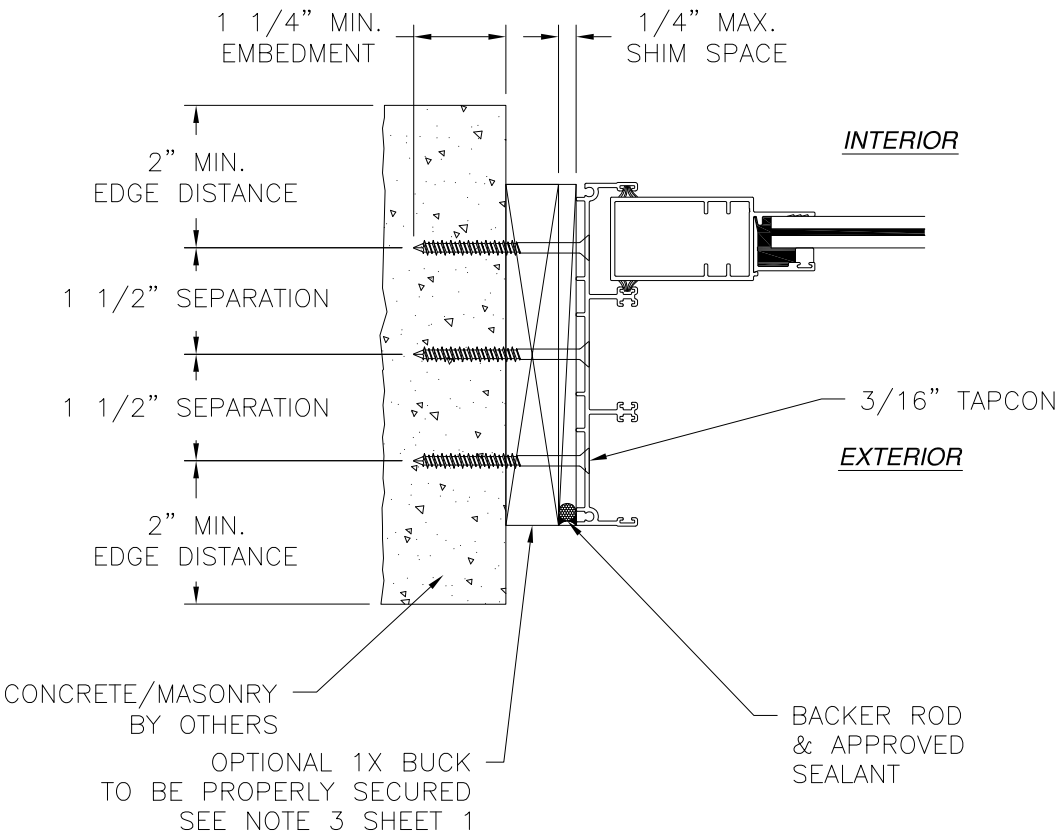

JAMB INSTALLATION DETAIL
CONCRETE/MASONRY INSTALLATION

NOTES:
1. INTERIOR AND EXTERIOR FINISHES, BY OTHERS,
NOT SHOWN FOR CLARITY.
2. PERIMETER AND JOINT SEALANT BY OTHERS TO BE
DESIGNED IN ACCORDANCE WITH ASTM E2112



EASTERN ARCHITECTURAL SYSTEMS

A DIVISION OF

EASTERN METAL SUPPLY

16341 DOMESTIC AVE

FORT MYERS, FL 33912

800-432-2204

SERIES FWI 6000 ALUMINUM IMPACT RATED
SLIDING GLASS DOOR
3 TRACK INSTALLATION DETAILS

DRAWN: N.G.

DWG NO. 08-02676

REV A

SCALE NTS

DATE 03/30/15

SHEET 8 OF 11

L. ROBERTO LOMAS P.E.

1432 WOODFORD RD LEWISVILLE, NC 27023

434-688-0609 rllomas@lrlomaspe.com

SIGNED: 01/09/2018



Luis R. Lomas P.E.
FL No.: 62514

REVISIONS			
REV	DESCRIPTION	DATE	APPROVED
A	REVISED PER NEW REQUIREMENTS	01/09/18	R.L.

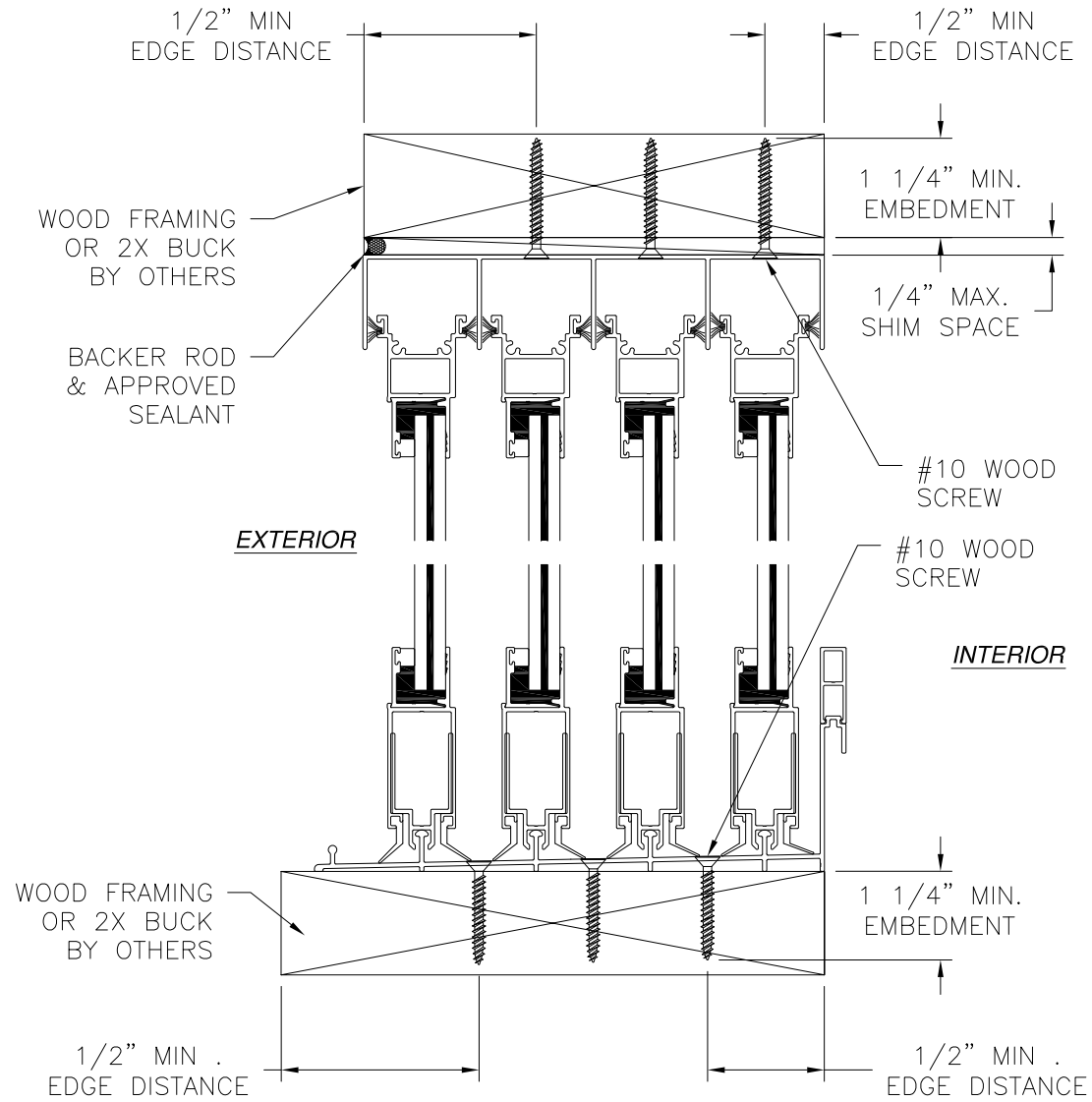

VERTICAL CROSS SECTION
WOOD FRAMING OR 2X BUCK INSTALLATION

NOTES:
1. INTERIOR AND EXTERIOR FINISHES, BY OTHERS,
NOT SHOWN FOR CLARITY.
2. PERIMETER AND JOINT SEALANT BY OTHERS TO BE
DESIGNED IN ACCORDANCE WITH ASTM E2112

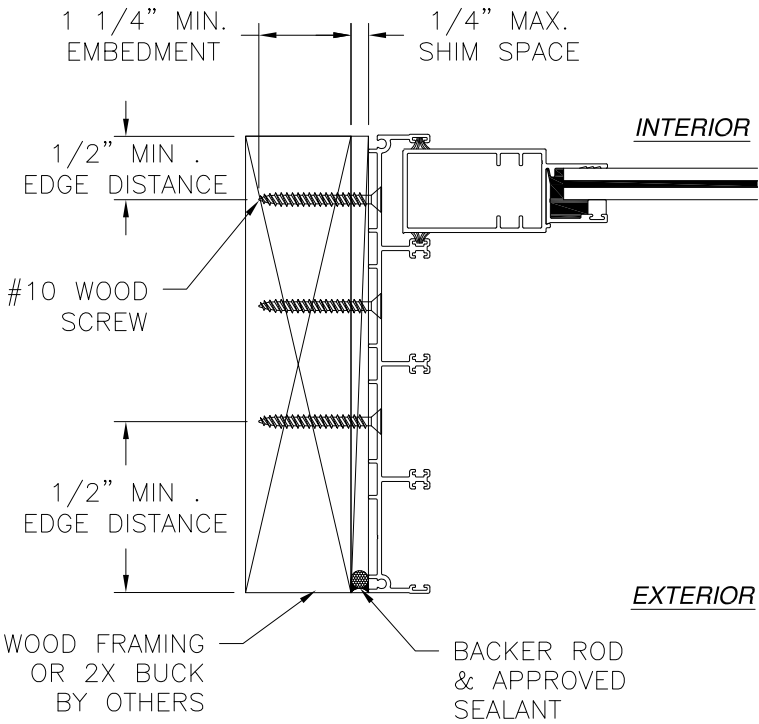

JAMB INSTALLATION DETAIL
WOOD FRAMING OR 2X BUCK INSTALLATION



EASTERN ARCHITECTURAL SYSTEMS
A DIVISION OF
EASTERN METAL SUPPLY

16341 DOMESTIC AVE
FORT MYERS, FL 33912
800-432-2204

SERIES FWI 6000 ALUMINUM IMPACT RATED
SLIDING GLASS DOOR
4 TRACK INSTALLATION DETAILS

DRAWN: N.G.	DWG NO. 08-02676	REV A
SCALE NTS	DATE 03/30/15	SHEET 9 OF 11

L. ROBERTO LOMAS P.E.
1432 WOODFORD RD LEWISVILLE, NC 27023
434-688-0609 rllomas@lrlomaspe.com

SIGNED: 01/09/2018



Luis R. Lomas P.E.
FL No.: 62514

REVISIONS			
REV	DESCRIPTION	DATE	APPROVED
A	REVISED PER NEW REQUIREMENTS	01/09/18	R.L.

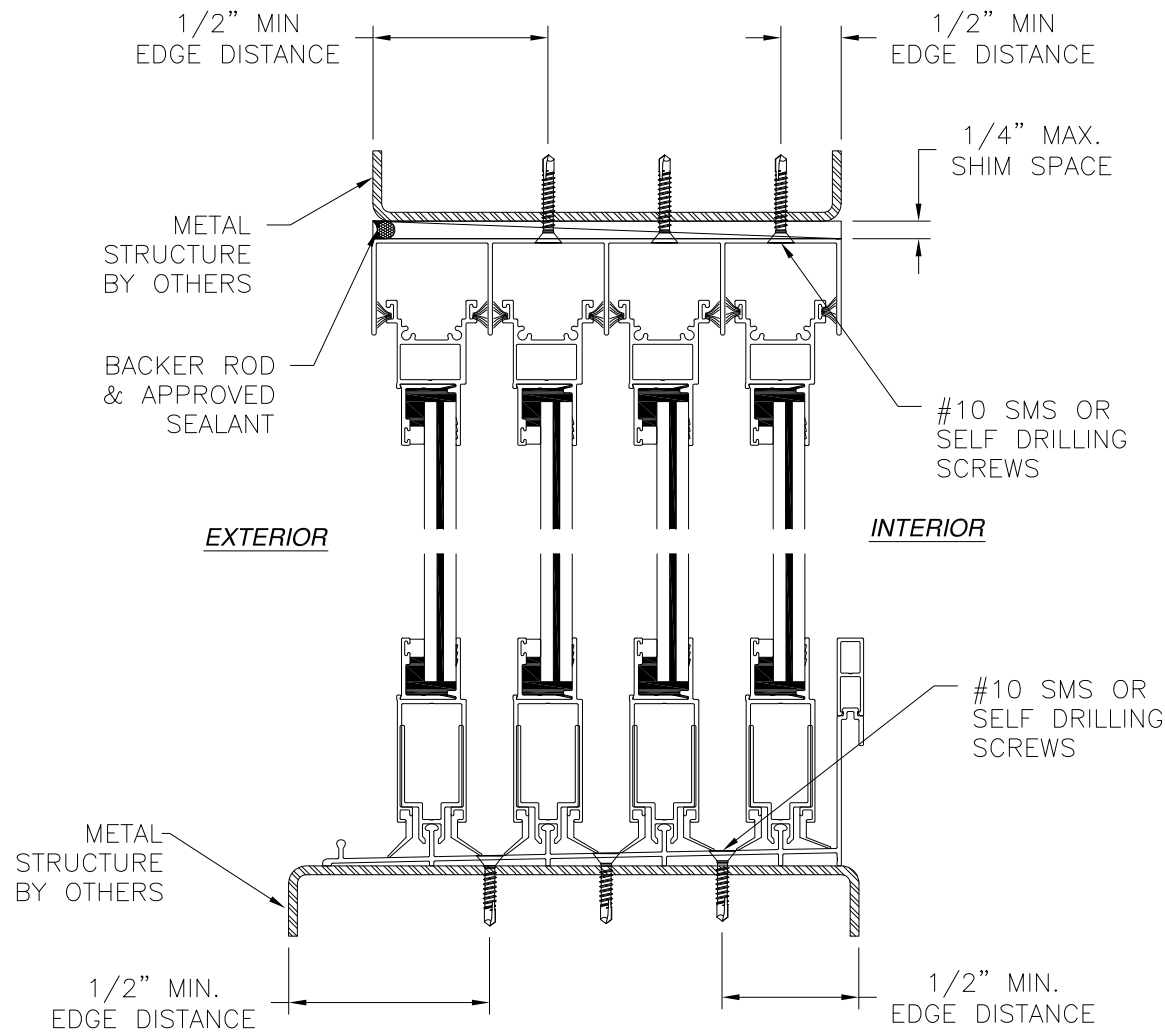

VERTICAL CROSS SECTION
METAL STRUCTURE INSTALLATION

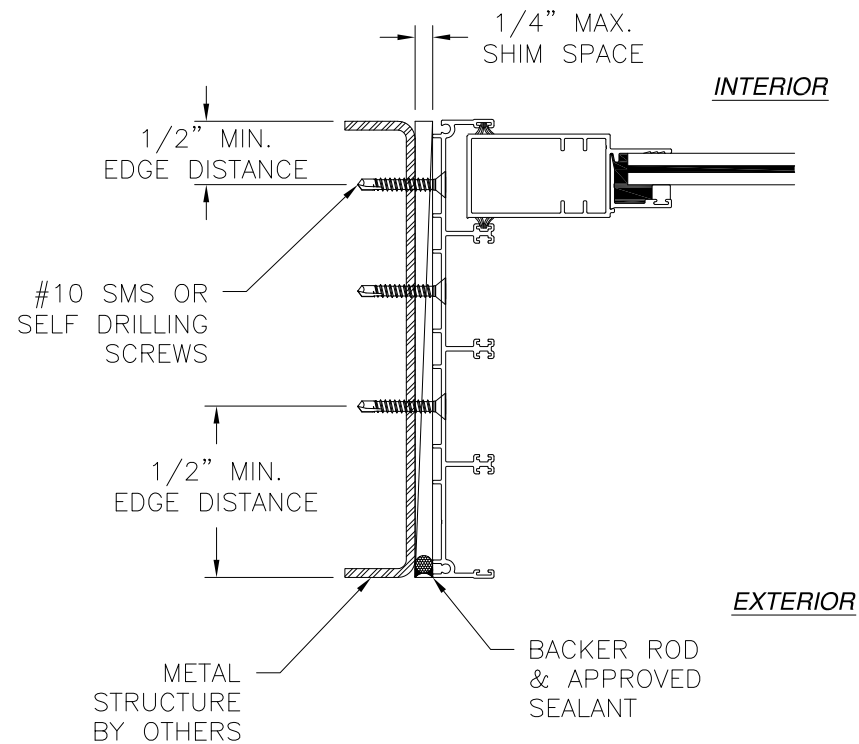

JAMB INSTALLATION DETAIL
METAL STRUCTURE INSTALLATION

- NOTES:
1. INTERIOR AND EXTERIOR FINISHES, BY OTHERS, NOT SHOWN FOR CLARITY.
 2. PERIMETER AND JOINT SEALANT BY OTHERS TO BE DESIGNED IN ACCORDANCE WITH ASTM E2112

SIGNED: 01/09/2018

 Eastern ARCHITECTURAL SYSTEMS ALUMINUM AND VINYL IMPACT WINDOWS AND DOORS		EASTERN ARCHITECTURAL SYSTEMS A DIVISION OF EASTERN METAL SUPPLY 16341 DOMESTIC AVE FORT MYERS, FL 33912 800-432-2204	
SERIES FWI 6000 ALUMINUM IMPACT RATED SLIDING GLASS DOOR 4 TRACK INSTALLATION DETAILS			
DRAWN: N.G.		DWG NO. 08-02676	
SCALE NTS		DATE 03/30/15	
		SHEET 10 OF 11	
L. ROBERTO LOMAS P.E. 1432 WOODFORD RD LEWISVILLE, NC 27023 434-688-0609 rllomas@lrlomaspe.com			



Luis R. Lomas P.E.
FL No.: 62514

REVISIONS			
REV	DESCRIPTION	DATE	APPROVED
A	REVISED PER NEW REQUIREMENTS	01/09/18	R.L.

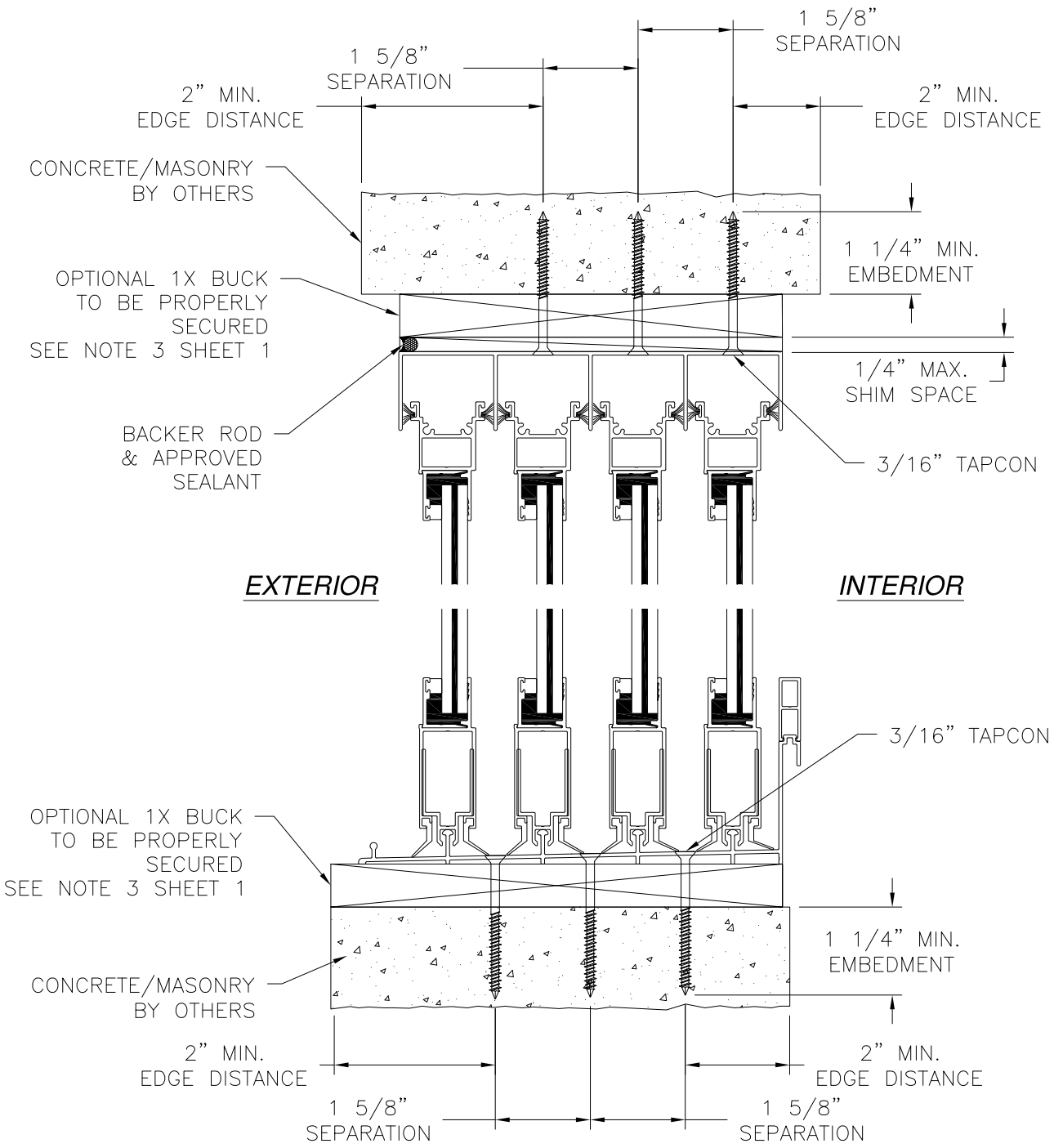

NOTES:
 1. INTERIOR AND EXTERIOR FINISHES, BY OTHERS, NOT SHOWN FOR CLARITY.
 2. PERIMETER AND JOINT SEALANT BY OTHERS TO BE DESIGNED IN ACCORDANCE WITH ASTM E2112

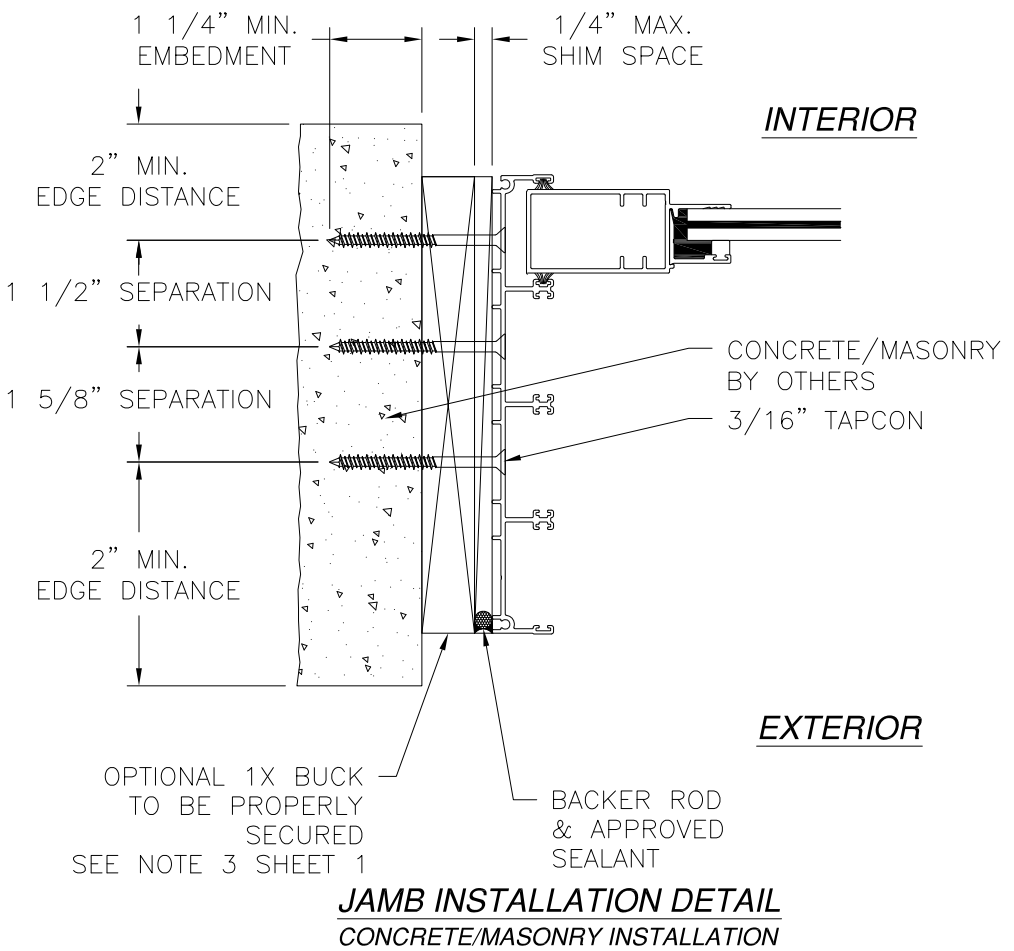



EASTERN ARCHITECTURAL SYSTEMS
 A DIVISION OF
 EASTERN METAL SUPPLY
 16341 DOMESTIC AVE
 FORT MYERS, FL 33912
 800-432-2204

SERIES FWI 6000 ALUMINUM IMPACT RATED
 SLIDING GLASS DOOR
 4 TRACK INSTALLATION DETAILS

DRAWN: N.G.	DWG NO. 08-02676	REV A
SCALE NTS	DATE 03/30/15	SHEET 11 OF 11

L. ROBERTO LOMAS P.E.
 1432 WOODFORD RD LEWISVILLE, NC 27023
 434-688-0609 rllomas@lrlomaspe.com

SIGNED: 01/09/2018

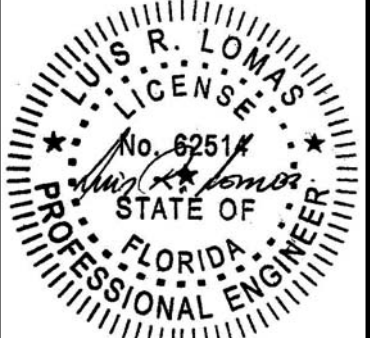

Luis R. Lomas P.E.
FL No.: 62514