

REVISIONS

| | |
|--|--|
| | |
| | |
| | |
| | |
| | |
| | |
| | |
| | |
| | |
| | |

DATE ■ 10/31/2017
DRAWN ■ BDH
CHECKED ■ BDH
JOB NO. ■

HANDICAP STALLS AND ACCESS AISLES SHALL BE LEVEL W/ SURFACE SLOPES NOT TO EXCEED 1:50 (2%) IN ALL DIRECTIONS.

ACCESSIBLE ROUTES FROM THE END OF THE H/C ACCESS AISLES TO THE INSIDE ENTRY SHALL NOT EXCEED 1:20 (5%) SLOPES UNLESS OTHERWISE NOTED W/ NO ABRUPT CHANGES IN ELEVATION. SLOPES OF 1:12 SHALL NOT HAVE A VERTICAL RISE GREATER THAN 6" WITHOUT PRIOR APPROVAL.

EACH ACCESSIBLE SPACE MUST BE PROMINENTLY OUTLINED W/ BLUE PAINT & MUST BE REPAINTED AS NECESSARY TO BE CLEARLY DISTINGUISHABLE AS A PARKING SPACE DESIGNATED FOR PERSONS WHO HAVE DISABILITIES & MUST BE POSTED W/ A PERMANENT ABOVE-GRADE SIGN BEARING THE INTERNATL. SYMBOL OF ACCESSIBILITY MEETING THE REQUIREMENTS OF COLOR AND DESIGN APPROVED BY FDOT INDEX & THE CAPTION "PARKING BY DISABLED PERMIT ONLY". SUCH SIGN MUST INDICATE THE PENALTY FOR ILLEGAL USE OF THE SPACE.

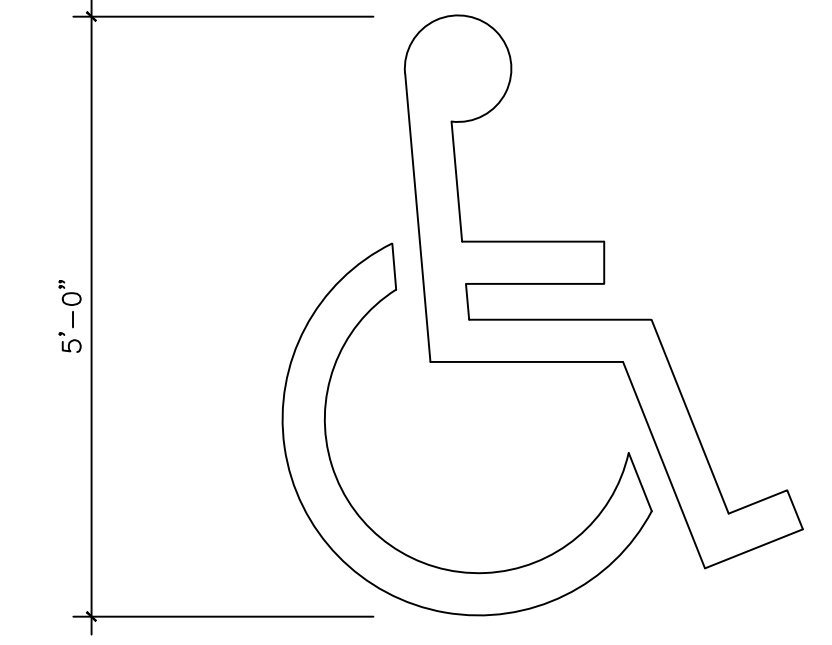

EACH ACCESSIBLE SPACE MUST BE PROMINENTLY OUTLINED W/ BLUE PAINT & BEAR A WHITE HANDICAP SYMBOL COMPLIANT WITH FDOT INDEX 17346.

5 H/C PARKING SYMBOL
NOT TO SCALE

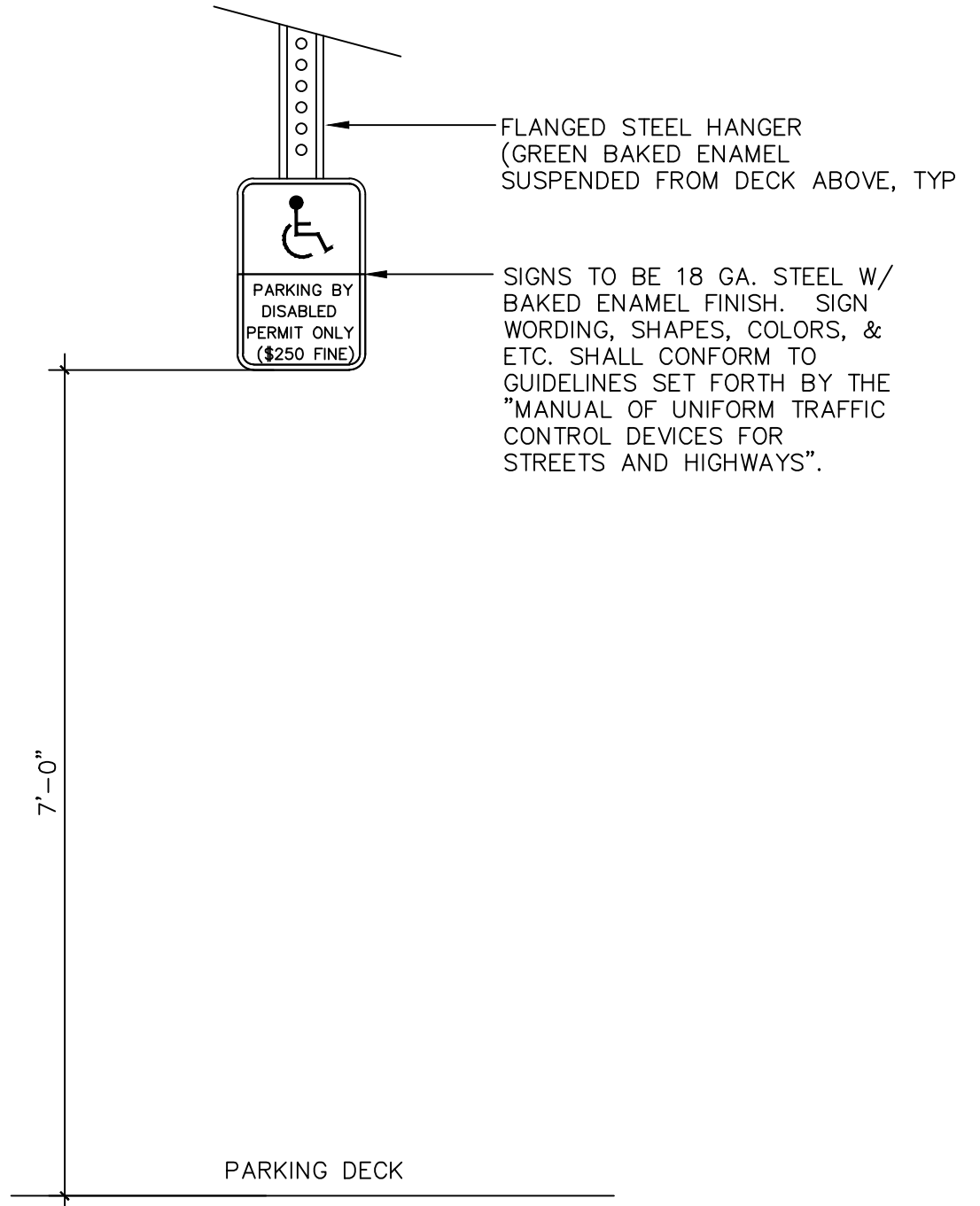

4 H/C SIGN MOUNTING HEIGHT
NOT TO SCALE

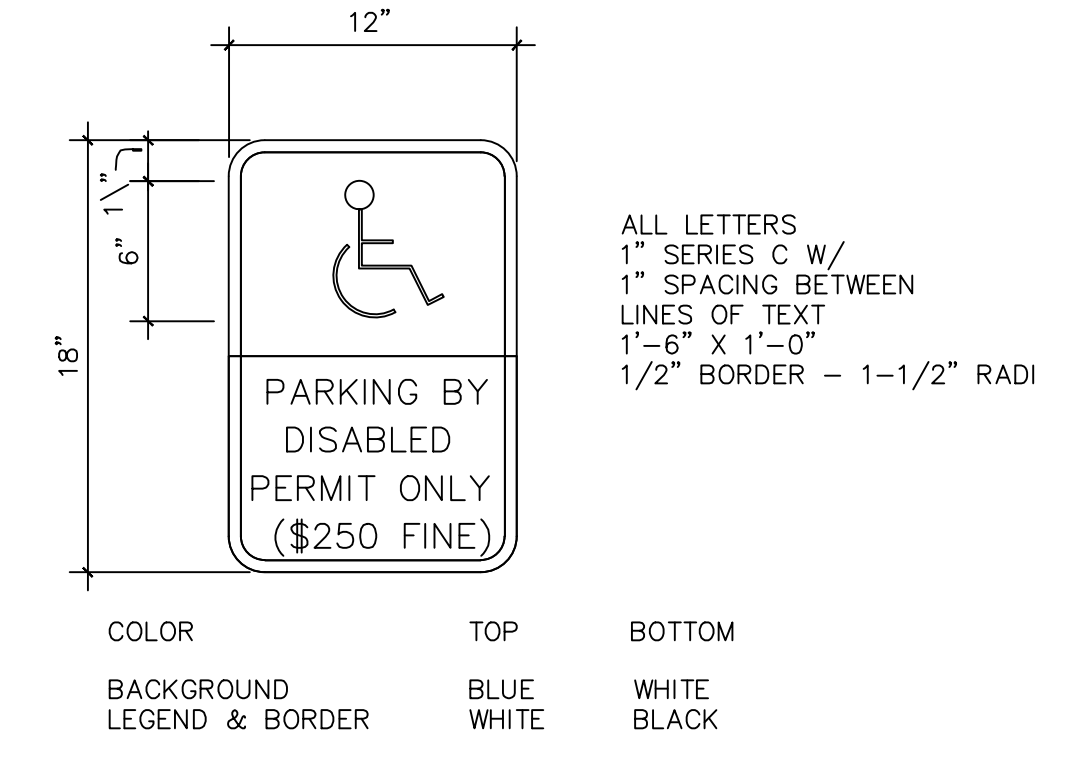

3 H/C PARKING SIGN
NOT TO SCALE

ALL LETTERS 1" SERIES C W/ 1" SPACING BETWEEN LINES OF TEXT
1"-6" X 1"-0"
1/2" BORDER - 1-1/2" RADI

COLOR TOP BOTTOM
BACKGROUND BLUE WHITE
LEGEND & BORDER WHITE BLACK

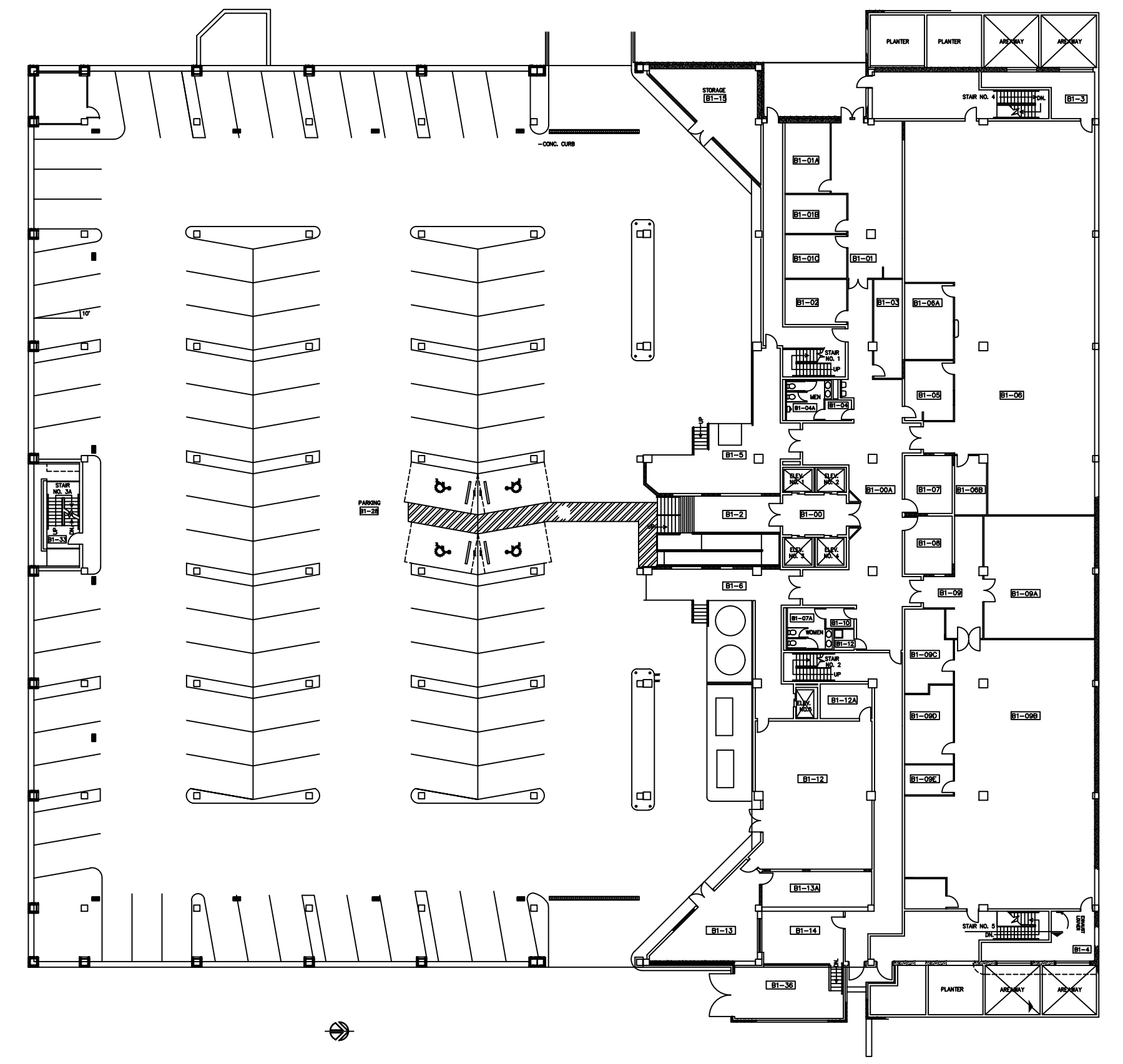

1 PARKING DECK LEVEL 1
SCALE 1/32"=1'-0"

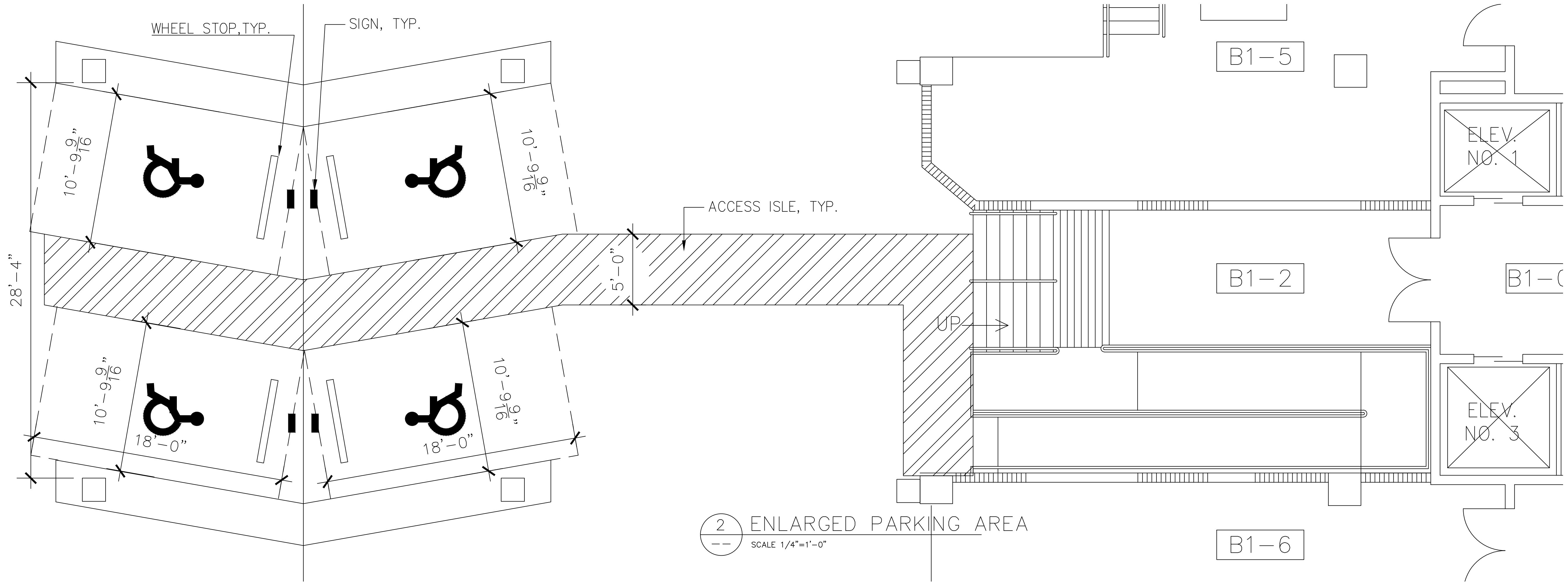

2 ENLARGED PARKING AREA
SCALE 1/4"=1'-0"