

COBB THEATRE 14 AT DAYTONA "LIVE"

Issue: Vertical accessibility to all rows of seats in a 14 screen movie theater complex.

Analysis: The applicant is requesting a waiver from providing vertical accessibility to all rows of seats in a new, \$7 million 14 screen movie theater complex. This project was previously reviewed and approved by the Commission in January, 2008; however, some relatively minor changes in seating configuration have been made since that time. The theaters range from 118 to 304 seats each and the appropriate number of wheelchair locations with adjacent companion seating have been provided. Estimates were provided indicating it would cost an additional \$560,000 to make all rows of seats accessible.

Project Progress:

The project is under design.

Items to be Waived:

Vertical accessibility to all rows of seats, as required by Section 553.509, Florida Statutes.

553.509 Vertical accessibility. Nothing in Sections 553.501-553.513 or the guidelines shall be construed to relieve the owner of any building, structure or facility governed by those sections from the duty to provide vertical accessibility to all levels above and below the occupiable grade level regardless of whether the guidelines require an elevator to be installed in such building, structure or facility, except for:

- (1) Elevator pits, elevator penthouses, mechanical rooms, piping or equipment catwalks and automobile lubrication and maintenance pits and platforms;
- (2) Unoccupiable spaces, such as rooms, enclosed spaces and storage spaces that are not designed for human occupancy, for public accommodations or for work areas; and
- (3) Occupiable spaces and rooms that are not open to the public and that house no more than five persons, including, but not limited to equipment control rooms and projection booths.

Waiver Criteria: There is no specific guidance for a waiver of this requirement in the code. The Commission's current rule, authorized in Section 553.512, Florida Statutes, provides criteria for granting waivers and allows consideration of unnecessary or extreme hardship to the applicant if the specific requirements were imposed.

This application is available in alternate formats upon request.

**REQUEST FOR WAIVER FROM ACCESSIBILITY REQUIREMENTS
OF CHAPTER 553, PART V, FLORIDA STATUTES**

Your application will be reviewed by the Accessibility Advisory Council and its recommendations will be presented to the Florida Building Commission. You will have the opportunity to answer questions and/or make a short presentation, not to exceed 15 minutes, at each meeting. The Commission will consider all information presented and the Council's recommendation before voting on the waiver request.

1. Name and address of project for which the waiver is requested.

Name: Cobb Theatre 14 @ Daytona 'LIVE'

Address: West International Speedway Blvd

Daytona, Florida 32120

2. Name of Applicant. If other than the owner, please indicate relationship of applicant to owner and written authorization by owner in space provided:

Applicant's Name: Joseph L. Sweeney

Applicant's Address: 530 Beacon Parkway West Suite 900 Birmingham, AL 35209

Applicant's Telephone: (205) 443-3720 FAX: (205) 443-3790

Applicant's E-mail Address: jsweeney@ctsmarchitects.com

Relationship to Owner: Architect for Theatres

Owner's Name: Cobb Theatres LLC

Owner's Address: 2100 A South Bridge Parkway Suite 640; Birmingham, AL 35209

Owner's Telephone: (205) 802-7766 FAX (205) 802-7771

Owner's E-mail Address: _____

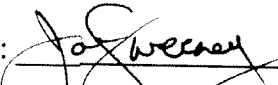
Signature of Owner:  as Agent and Architect for Cobb Theatres, LLC

Contact Person: Joe Sweeney or Lawrence L. Corley

Contact Person's Telephone: (205) 443-3720 E-mail Address: jsweeney@ctsmarchitects.com
lcorley@ctsmarchitects.com

This application is available in alternate formats upon request.
Form No. 2001-01

3. Please check one of the following:

New construction.

Addition to a building or facility.

Alteration to an existing building or facility.

Historical preservation (addition).

Historical preservation (alteration).

4. Type of facility. Please describe the building (square footage, number of floors). Define the use of the building (i.e., restaurant, office, retail, recreation, hotel/motel, etc.)

Multi-Screen Movie Theatre One Story 65,000 +/- square feet

Group "A" Assembly

5. Project Construction Cost (Provide cost for new construction, the addition or the alteration):

\$ 7 million

6. Project Status: Please check the phase of construction that best describes your project at the time of this application. Describe status.

Under Design Under Construction*

In Plan Review Completed*

* Briefly explain why the request has now been referred to the Commission.

N/A

7. **Requirements requested to be waived.** Please reference the applicable section of Florida law. Only Florida-specific accessibility requirements may be waived.

Issue

1: See Attachment 'A'

Issue

2: _____

Issue

3: _____

8. **Reason(s) for Waiver Request:** The Florida Building Commission may grant waivers of Florida-specific accessibility requirements upon a determination of unnecessary, unreasonable or extreme hardship. Please describe how this project meets the following hardship criteria. Explain all that would apply for consideration of granting the waiver.

The hardship is caused by a condition or set of conditions affecting the owner which does not affect owners in general.

Substantial financial costs will be incurred by the owner if the waiver is denied.
See Attachment "A"

The owner has made a **diligent investigation** into the costs of compliance with the code, but cannot find an efficient mode of compliance. Provide detailed cost estimates and, where appropriate, photographs. Cost estimates must include bids and quotes.

9. Provide documented cost estimates for each portion of the waiver request and identify any additional supporting data, which may affect the cost estimates. For example, for vertical accessibility, the lowest documented cost of an elevator, ramp, lift or other method of providing vertical accessibility should be provided, documented by quotations or bids from at least two vendors or contractors.

a. The following is the estimated cost impact for this theatre to comply with Section 553.509 of the Florida Statutes:

b. 14 lifts required (14 x \$40,000 each = \$560,000) See Attachment "B"

c. Also because 15% and 30% of seats (depending on house size) must be removed to accommodate the lifts. In addition, the seating platforms will be required to be wider to accommodate the wheelchairs at each tier of seating, further reducing the seat count by an estimated 15% to 30% per house

10. **Licensed Design Professional:** Where a licensed design professional has designed the project, his or her comments **MUST** be included and certified by signature and affixing of his or her professional seal. The comments must include the reason(s) why the waiver is necessary.

See Section 7

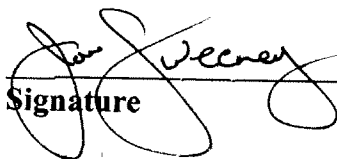
Signature

Joseph L. Sweeney
Printed Name

Phone number (205) 443-3720

(SEAL)

CERTIFICATION OF APPLICANT:

I hereby swear or affirm that the applicable documents in support of this Request for Waiver are attached for review by the Florida Building Commission and that all statements made in this application are to the best of my knowledge true and correct.

Dated this 10 day of July, 2008

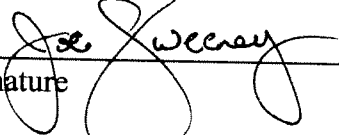
Signature _____

Joseph L. Sweeney
Printed Name

By signing this application, the applicant represents that the information in it is true, accurate and complete. If the applicant misrepresents or omits any material information, the Commission may revoke any order and will notify the building official of the permitting jurisdiction. Providing false information to the Commission is punishable as a misdemeanor under Section 775.083, Florida Statutes.

REVIEW AND RECOMMENDATION BY LOCAL BUILDING DEPARTMENT.

Please state why the issue is being referred to the Florida Building Commission as well as a recommendation for disposition. The Building Official or his or her designee should review the application and indicate that to the best of his or her knowledge, all information stipulated herein is true and accurate. Further, if this project is complete, explain why it is being referred to the Commission. The Building Official or his or her designee should sign a copy of the plans accompanying this application as certification that such plans are the same as those submitted for building department review. Please reference the applicable section of the Accessibility Code.

- a. _____
- b. _____
- c. _____

Has there been any permitted construction activity on this building during the past three years? If so, what was the cost of construction?

Yes No Cost of Construction _____

Comments/Recommendation _____

Jurisdiction _____

Building Official or Designee _____
Signature

Printed Name

Certification Number

Telephone/FAX

Address: _____

Attachment 'A'

The Florida State Statutes Section 553.509 VERTICAL ACCESSIBILITY states that "Nothing in Sections 553.501 – 553.513 or the guidelines shall be construed to relieve the owner of any building, structure or facility governed by those sections for the duty to provide vertical accessibility to all levels above and below the habitable grade level, regardless of whether the guidelines require an elevator to be installed in such building, structure or facility." The stadium seating concept is one relatively new to the movie theater industry therefore it is commonly believed that this type of building construction was not anticipated during the drafting of legislation for vertical accessibility nor that it was meant to mean that every level or platform of stadium seating be made accessible. The design industry has relied on Section 4.33.3 Placement of Wheelchair Locations for direction during the design process. This section states:

"Wheelchair areas shall be an integral part of any fixed seating plan and shall be provided so as to provide people with physical disabilities a choice of admission prices and lines of sight comparable to those for members of the general public. They shall adjoin an accessible route that also serves as a means of egress in case of emergency. At least one companion fixed seat shall be provided next to each wheelchair seating area. When the seating capacity exceeds 300, wheelchair spaces shall be provided in more than one location. Readily removable seats may be installed in wheelchair spaces when the spaces are not required to accommodate wheelchair users. EXCEPTION: Accessible viewing positions may be clustered for bleachers, balconies and other areas having sight lines that require slopes of greater than 5 percent. Equivalent accessible viewing positions may be located on levels having accessible egress."

It is the design industries desire and duty to incorporate the findings and wishes of the Council and Board with sound and practical construction methods. However, it is impossible to provide vertical accessibility to each level of stadium seating due 1) to the high cost and 2) to the requirements of the ADA Section 4.33.3 which states "they (stadium seating) shall adjoin an accessible route that also serves as a means of egress in case of emergency." It is impractical to achieve this in a stadium seating movie theatre and accommodate the needs of all patrons. We have therefore established the goal of locating accessible seating to within 0% to 20% of the center of each house achieving a disbursed pattern and providing for companion seating as well as achieving comparable sight lines. Having complied with the remaining requirements of Section 4.33.3 it is our belief that this compromise is an acceptable solution to the concerns of all patrons.

**4.33 ASSEMBLY AREAS
STAFF WAIVER ANALYSIS**

Name of Assembly: Cobb Theatres 14 @ Daytona 'LIVE' [X] New [] Alteration [] Addition

Auditorium Category	Auditorium numbers in the category	Wheelchair spaces per auditorium			Companion seating provided? Y/N	Number of wheelchair spaces provided in:		
		Provided	FL requires	ADA requires		Front Zone A	Middle Zone B	Back Zone C
A. Fixed Seats 51 to 100	N/A	—	4	4	—	—	—	—
B. Fixed Seats 101 – 200	Houses 3, 4, 11, 12	5	5	4	Yes	0	5	0
	Houses 2, 5, 10, 13	5	5	4		0	5	0
	Houses 6, 9	5	5	4		0	3	2
C. Fixed Seats 201 to 300	Houses 1, 14	6	6	4	Yes	0	4	2
D. Fixed Seats 301 to 400	Houses 7, 8	7	7	6	Yes	0	4	3
E. Fixed Seats 401 to 500	N/A	—	8	6	—	—	—	—
F. Fixed Seats 501 to 600	N/A	—	9	7	—	—	—	—
G. Fixed Seats 601 and up	N/A	—	—	—	—	—	—	—

Wheelchair spaces required: FL 51 to 100 -- 4 + 1 for every 100 fraction. ADAAG 51 to 300 -- 4; 301 to 500 -- 6 + 1 for every 100 or fraction. When the seating capacity exceeds 300, wheelchair spaces shall be provided in more than one location.

In theatres seating 150 or more, 50% of wheelchair spaces should be located in zone B (sweet spot) as per Charette 2-10-98.

ANY EXPLANATIONS:

Attachment 'B'

Outside letter from ELEVATORS, Etc.
Dated September 30, 1998.

Attachment 'B'

ELEVATORS, Etc.

ACCESSIBILITY EQUIPMENT SALES and SERVICE

1773 Blount Road, Suite 303
Pompano Beach, FL 33069
(954) 970-0767
Fax (954) 970-7227

September 30, 1998

Mr. Lawrence L. Corley
BAILEY-CORLEY & ASSOCIATES, Inc.
530 Beacon Parkway West, Suite 701
Birmingham, AL 35209

RE: Movie Theater - vertical accessibility

Dear Mr. Corley:

As discussed with members of your firm, there isn't any type of equipment on the market at this time that I am aware of that is designed to provide vertical access to every level of a movie theater such as the ones we've reviewed.

An incline platform lift complying with ADA and ANSI elevator codes could be utilized to provide access to up to seven levels per lift however. The cost of such a lift is estimated to be between \$40,000.00 and \$50,000.00. Therefore, in order to accommodate up to 14 levels, you can estimate a cost of \$80,000.00 to \$100,000.00.

As you know, the equipment has clearance requirements that need to be met in order for it to fit in a given stairway. However, this should not pose a significant problem.

I'd be happy to review any other plans if you wish and get the manufacturers more involved with this issue if you feel it appropriate. Thank you for asking me to review this matter.

Sincerely,

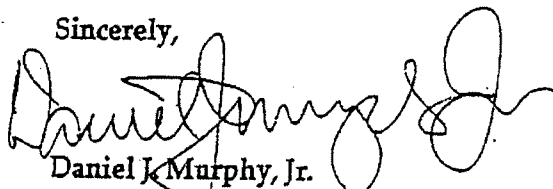

Daniel J. Murphy, Jr.
South Florida Sales Manager

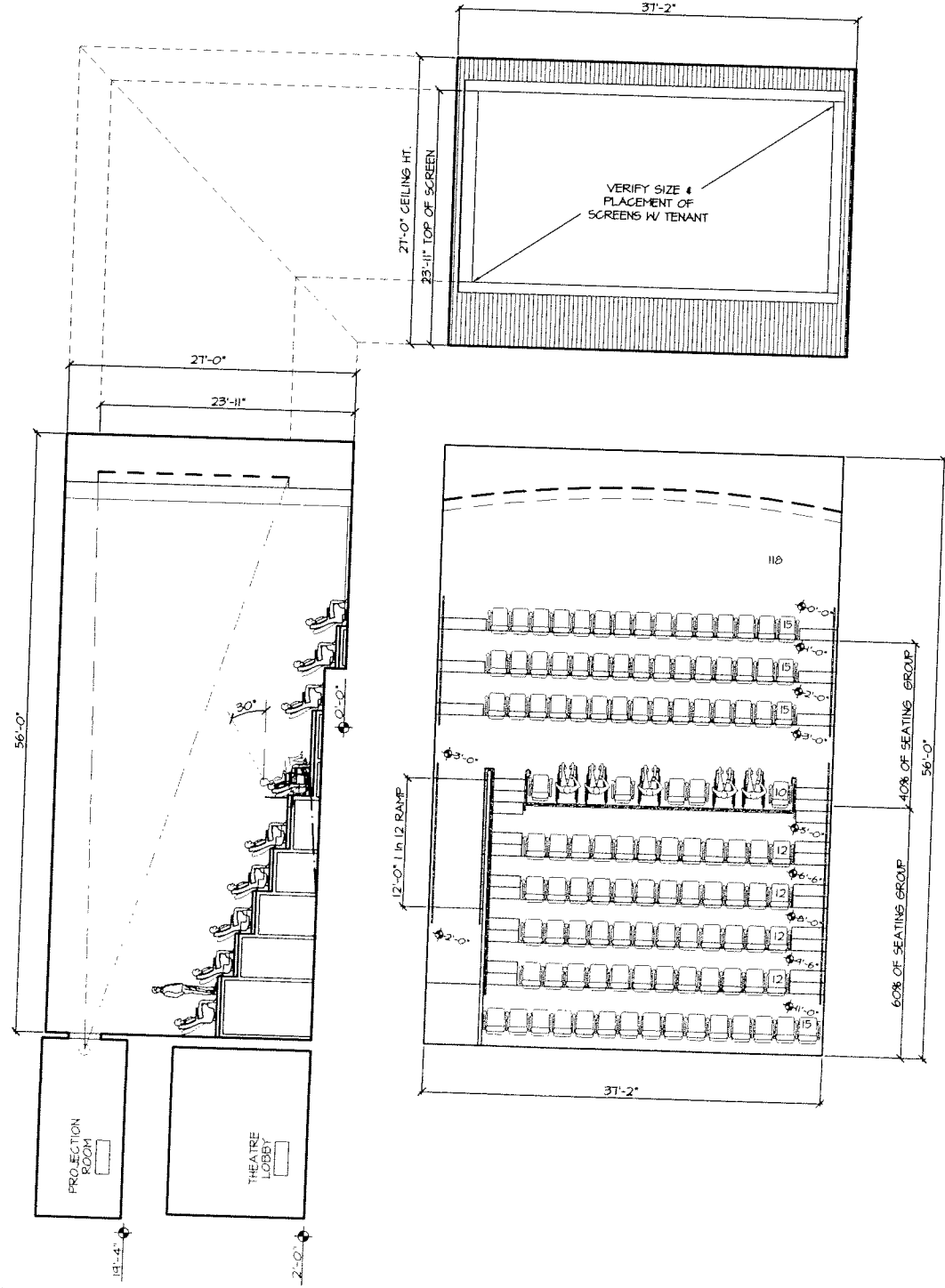

THEATRE HOUSE TYPE 'B2'
 SCALE : 1/8" = 1'-0"
 118 SEATS IN 4 THEATRE HOUSES 3, 4, 11, 12

PRINTED BY: KIMBERLY 10 JUL 2008 9:17:49 CASH DAYTONA/LIVE/APPRA/08/082_246.dwg
 © COPYRIGHT 2008. THIS ARCHITECTURE AND ALL DIMENSIONS, NOTES, AND SPECIFICATIONS ARE THE PROPERTY OF THE ARCHITECT. THIS SET OF DRAWINGS IS FOR THE ARCHITECT'S USE ONLY AND IS NOT TO BE REPRODUCED OR TRANSMITTED IN ANY FORM OR BY ANY MEANS, ELECTRONIC OR MECHANICAL, WITHOUT THE WRITTEN PERMISSION OF THE ARCHITECT.

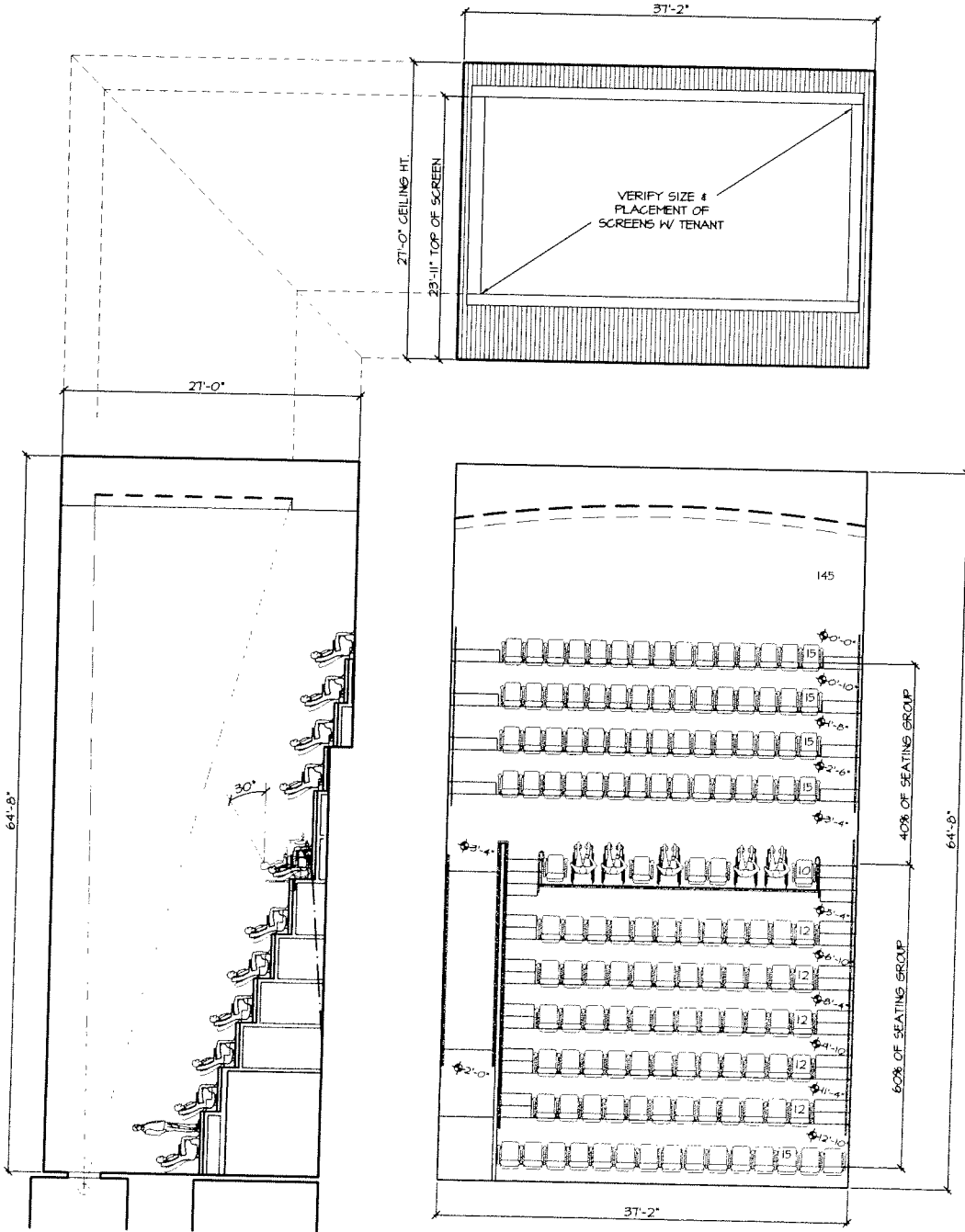

THEATRE HOUSE TYPE 'B6'

SCALE : 1/16" = 1'-0"

145 SEATS IN 4 THEATRE HOUSES 2, 5, 10, 13

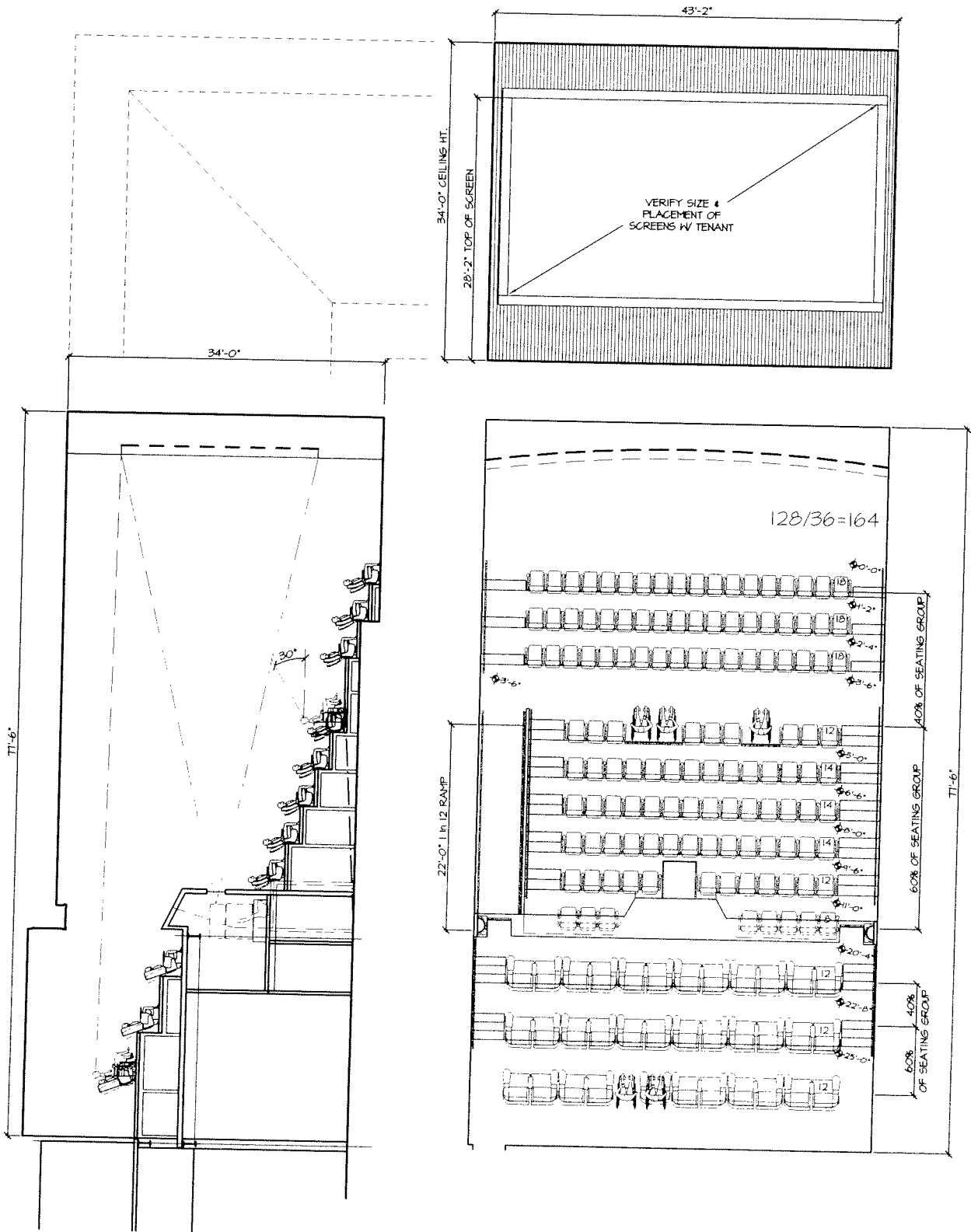

PREMIUM SEATS - 36
STANDARD SEATS - 128
TOTAL SEAT COUNT - 164

THEATRE HOUSE TYPE 'B7'

SCALE = 1/8" = 1'-0"

164 SEATS IN 2 THEATRE HOUSES 6 & 9

PLOTTED BY KEMPPEL 10 JUL 2008 8:17:49 Cobb Doyle\THEATRE\080717_Plot.dwg

C3

PREMIUM SEATS - 48
STANDARD SEATS - 170
TOTAL SEAT COUNT - 218

THEATRE HOUSE TYPE 'C3' 218 SEATS IN 2 THEATRE HOUSES 1, 14

SCALE: 1/16" = 1'-0"

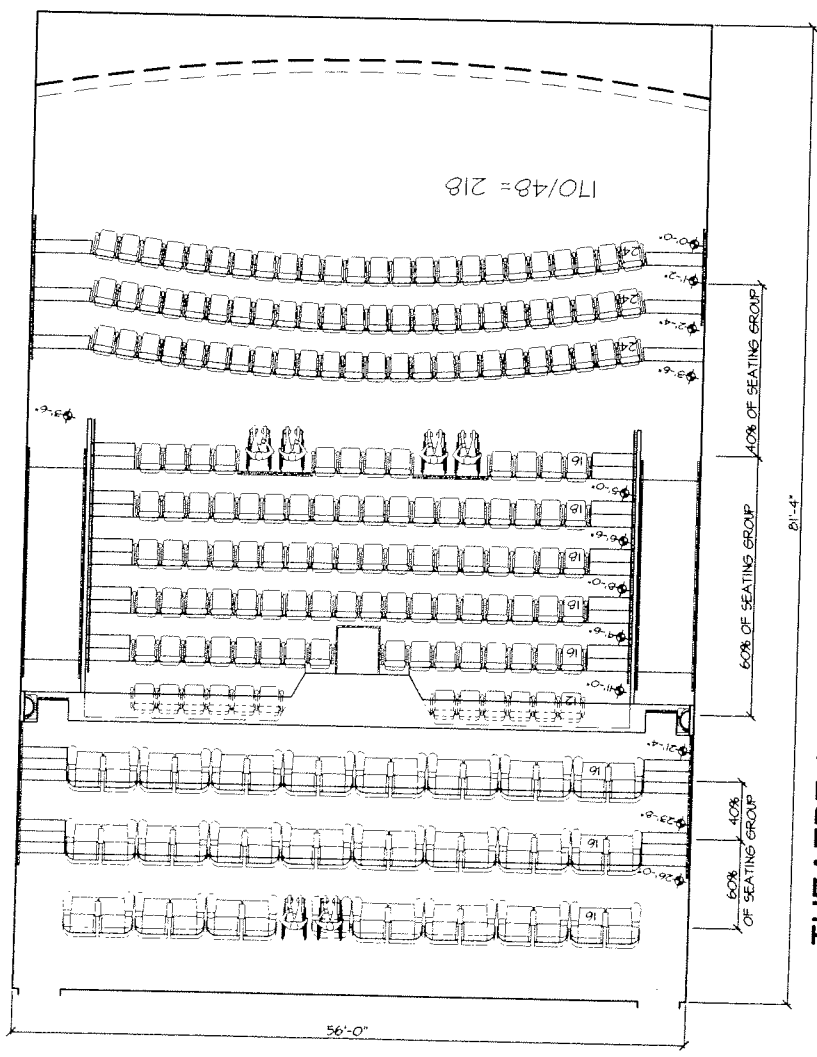
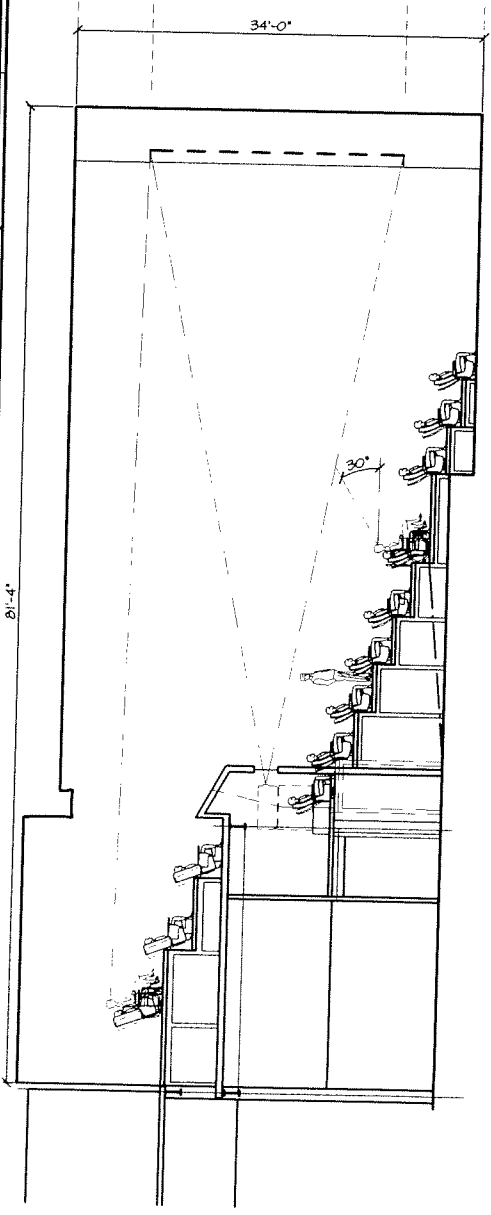
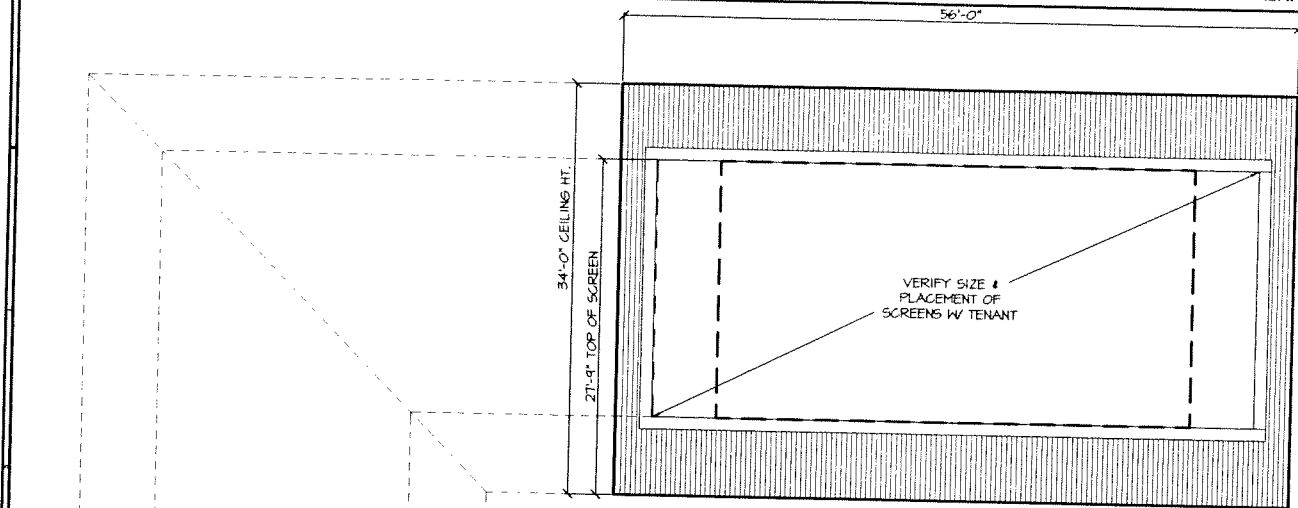

NOTED: If modified, 10/18/2008 0:1749 Cobb Daytona/VE APPLA/DOCHS, P.dwg
Copyright 2008, Corley Timothy Sweeney McCormac. All rights reserved. No part of this drawing may be reproduced or transmitted in any form or by any means, electronic, mechanical, photocopying, recording, or by any information storage and retrieval system, without the prior written permission of Corley Timothy Sweeney McCormac.

G1

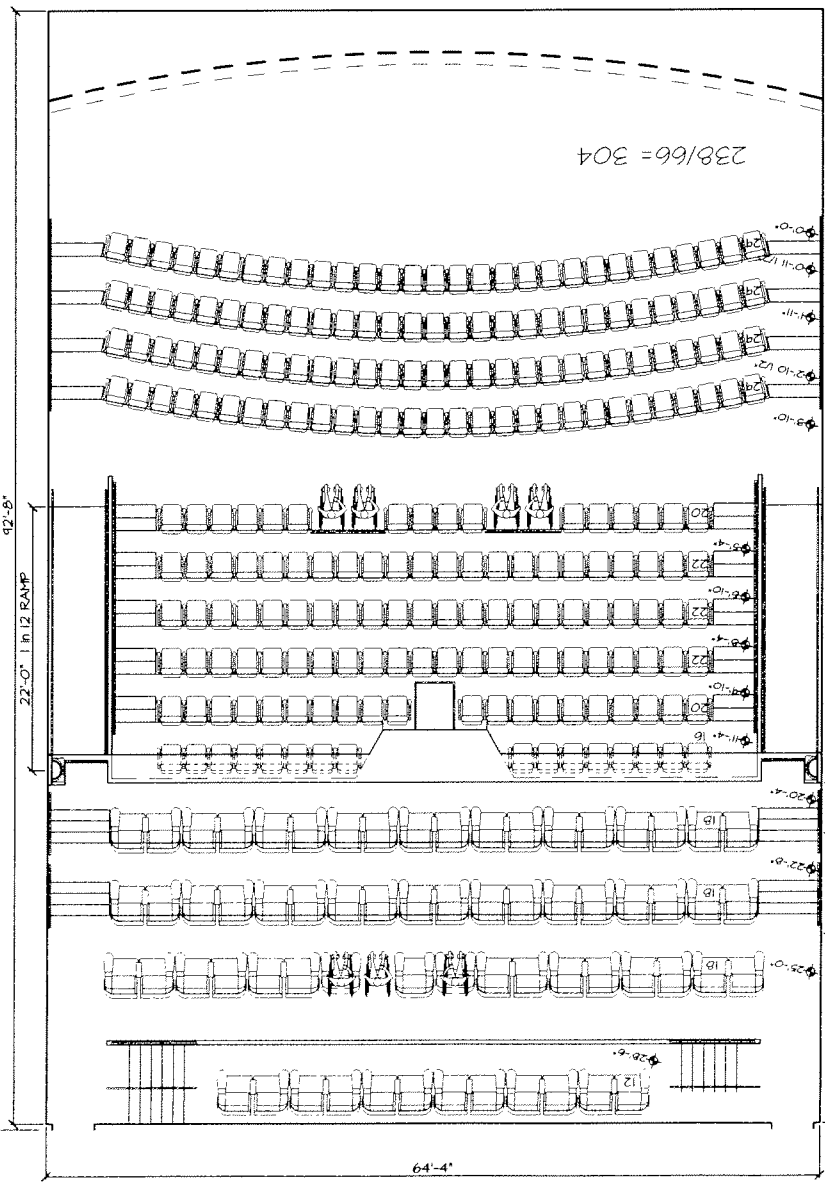
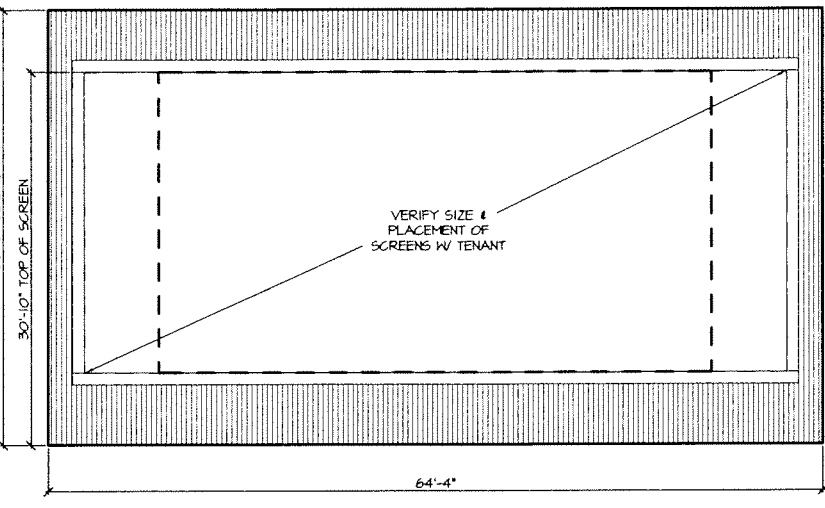
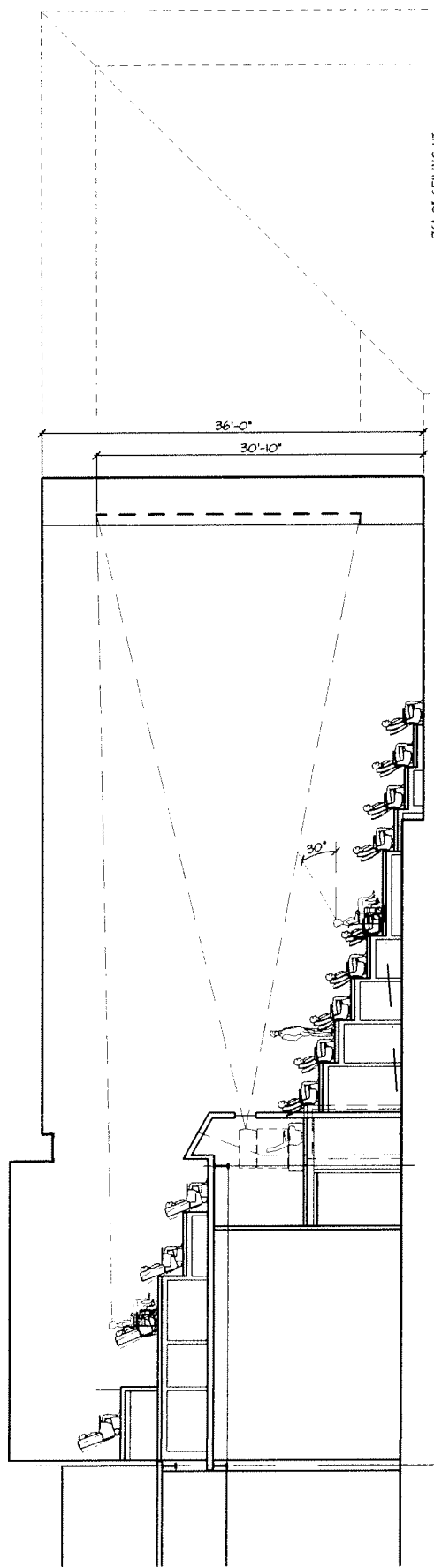

THEATRE HOUSE TYPE 'G1'
 SCALE = 1/16" = 1'-0"
304 SEATS IN 2 THEATRE HOUSES 7 & 8

60% OF SEATING GROUP
 40% OF SEATING GROUP
 60% OF SEATING GROUP
 40% OF SEATING GROUP
 66
 238
TOTAL SEAT COUNT - 304

PROJECTION ROOM LEVEL

PROPOSED SITE PLAN

1/2" = 1'-0"
 1/8" = 1'-0"
 Daytona, Florida

14 FLEX
 COBB THEATRE
 DAYTONA LIVE
 REVISION

A010

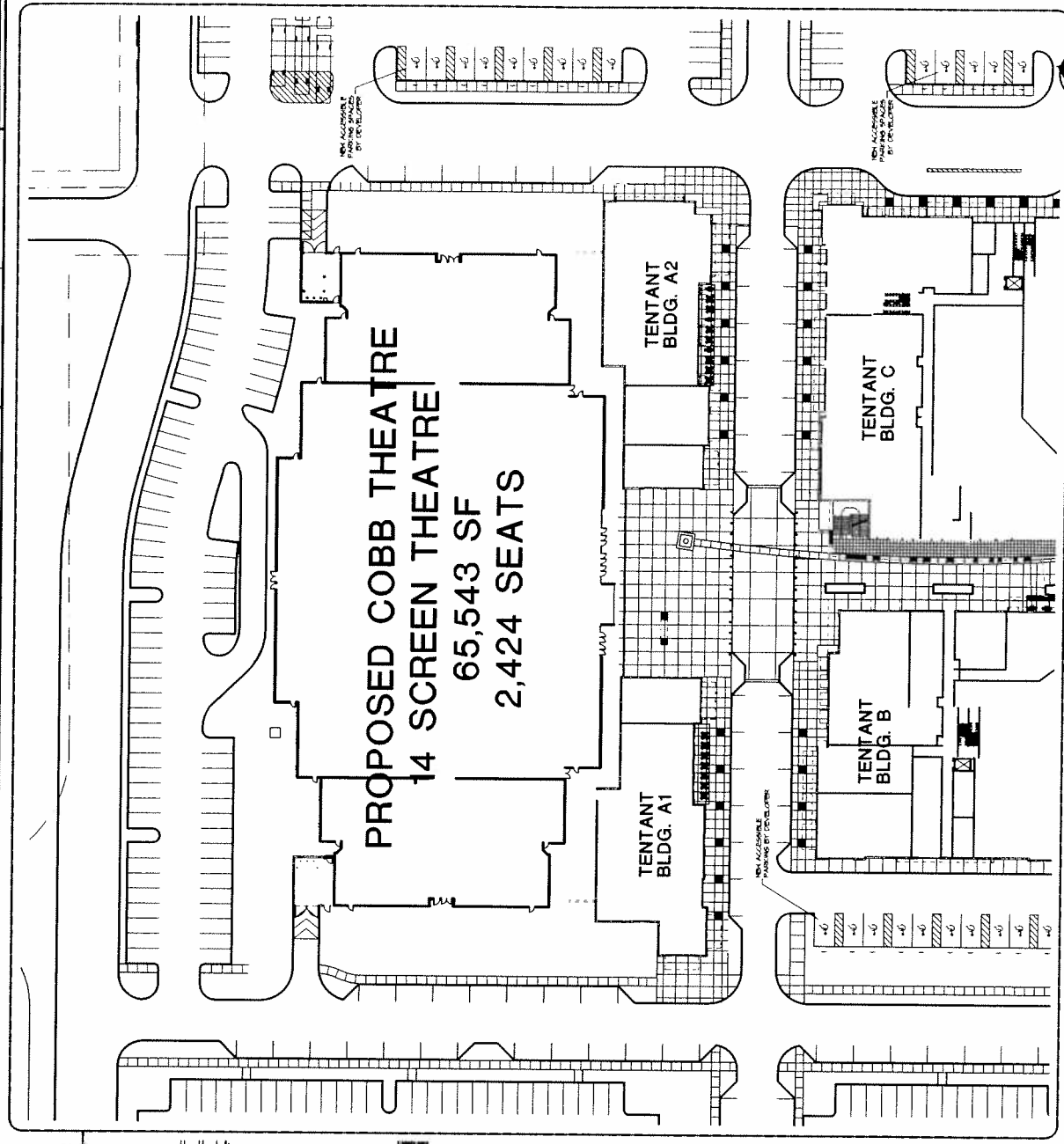

D1 PROPOSED SITE PLAN
SCALE: 1" = 30'-0"

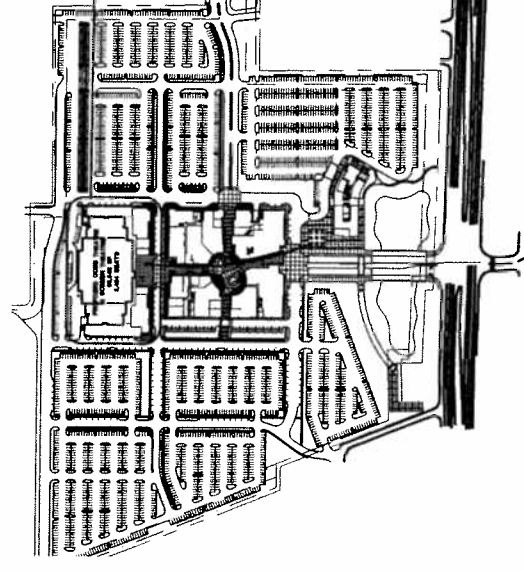

B1 OVERALL SITE PLAN
SCALE: 1" = 30'-0"

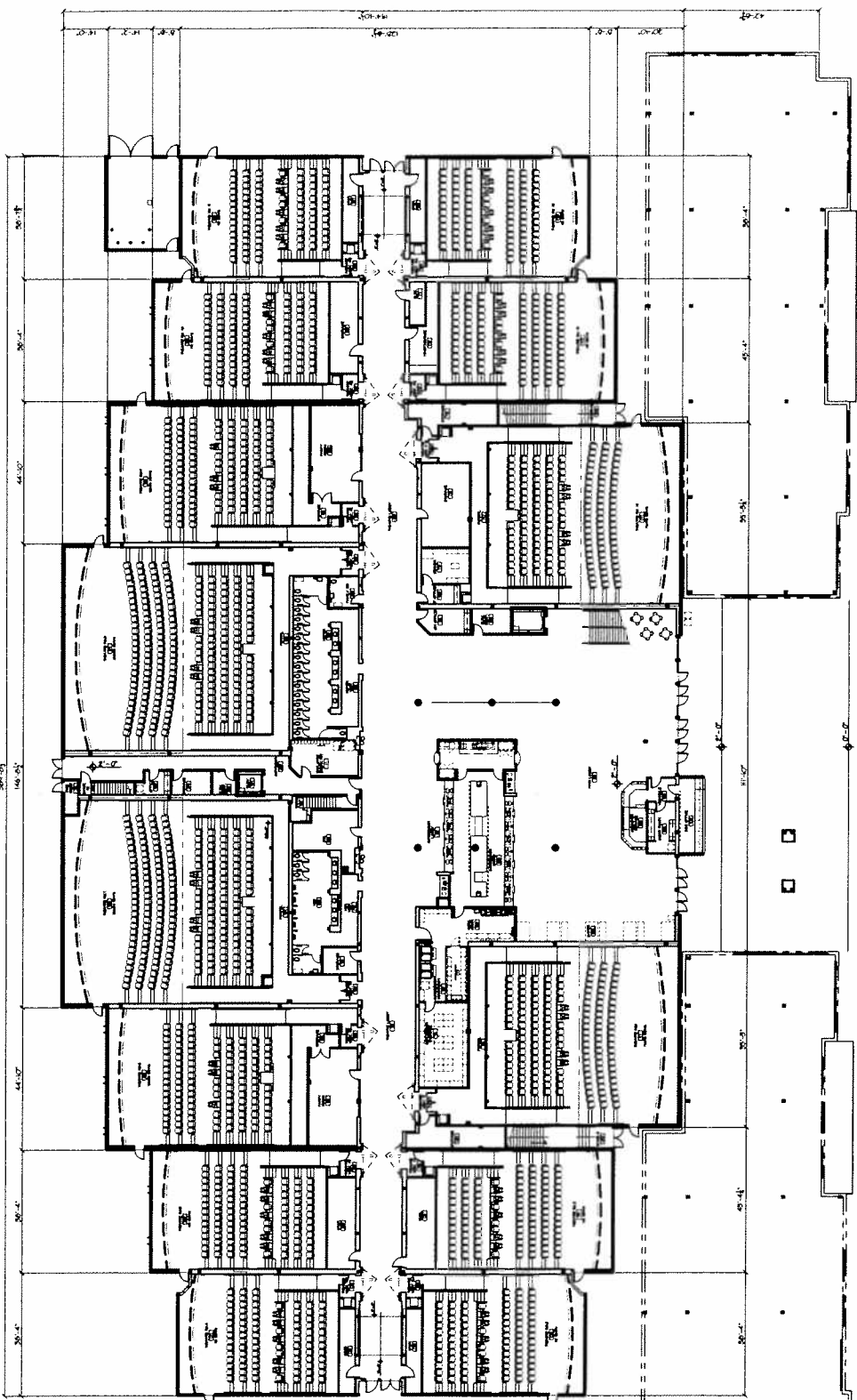

North
FIRST LEVEL FLOOR PLAN
 SCALE: 1/8" = 1'-0"

SEAT TOTALS

	STANDARD / METZANINE	PREMIUM
HOUSE G	2,304	46
HOUSE C3	2,218	46
HOUSE B1	2,164	36
HOUSE B6	4,145	0
HOUSE B1	8,105	0
TOTAL	21,244	300

CONCEPTUAL DATA 7-10-08

SCREENS	14
SEATS	2424 SEATS
FOOTPRINT SQ. FT.	65,543 SQ.FT.
EFFICIENCY RATIO	2104 SF/SEAT
FOOTPRINT AREA	65,543 SQ.FT.
SCREEN FLOOR	2424 SEATS
SCREEN AREA	10,318 SQ.FT.
PROJECTION AREA	1,932 SQ.FT.

SECOND LEVEL
FLOOR PLAN

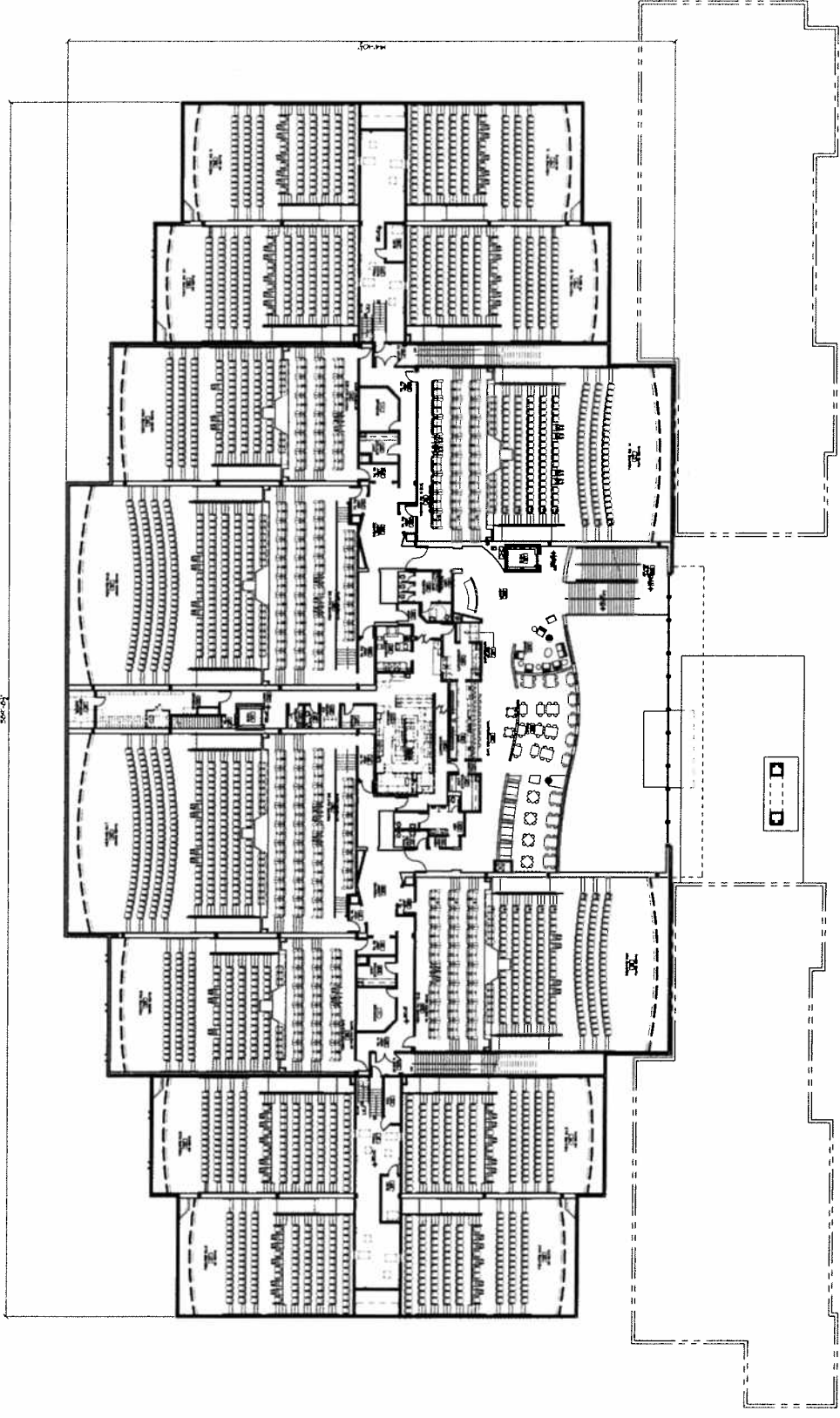

SECOND LEVEL FLOOR PLAN
SCALE: 1/8" = 1'-0"

PLOTTED BY: KENNEDY 10 JUN 2008 9:17:49 CORB DAYTONA LIVE! AREA: 174982.dwg
© COPYRIGHT 2008, ALL RIGHTS RESERVED. NO PART OF THIS DOCUMENT OR ANY PART THEREOF MAY BE REPRODUCED OR TRANSMITTED IN ANY FORM WITHOUT EXPRESS WRITTEN PERMISSION OF THE ARCHITECT.

THEATRE HOUSE PLANS

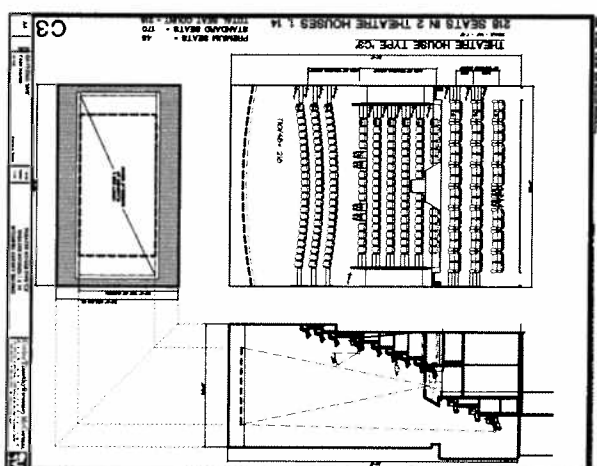
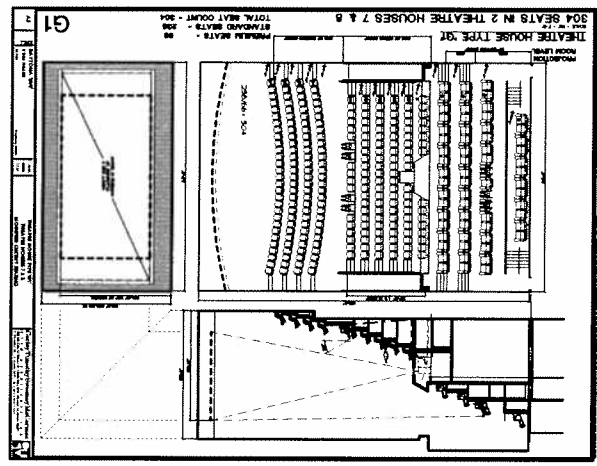
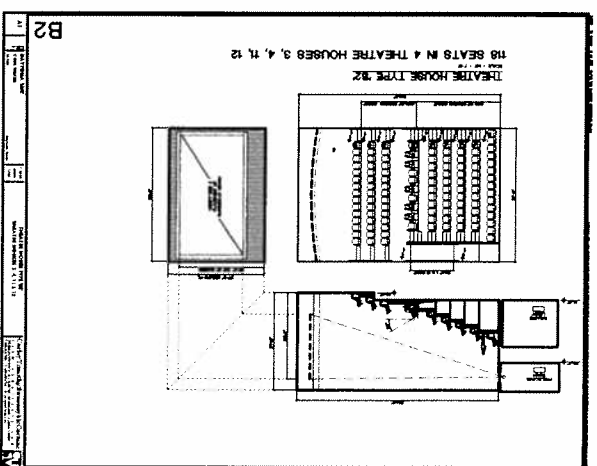
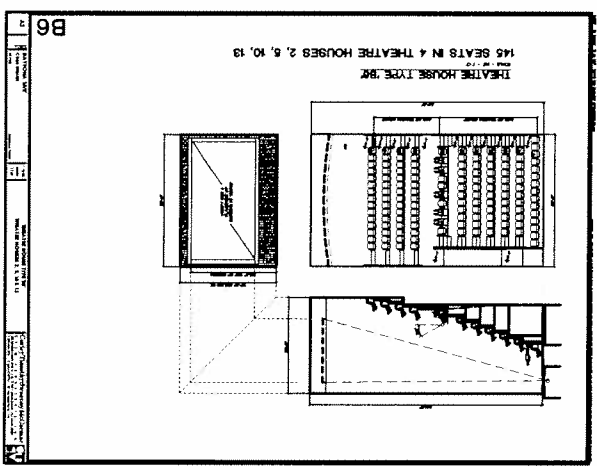
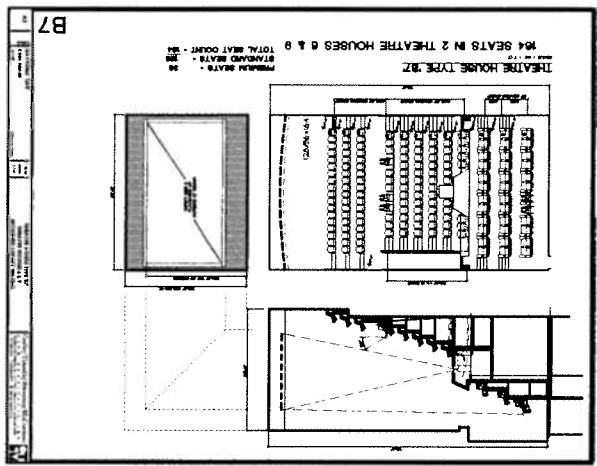

JANUARY, 2008 WAIVER APPLICATION

This application is available in alternate formats upon request.

**REQUEST FOR WAIVER FROM ACCESSIBILITY REQUIREMENTS
OF CHAPTER 553, PART V, FLORIDA STATUTES**

Your application will be reviewed by the Accessibility Advisory Council and its recommendations will be presented to the Florida Building Commission. You will have the opportunity to answer questions and/or make a short presentation, not to exceed 15 minutes, at each meeting. The Commission will consider all information presented and the Council's recommendation before voting on the waiver request.

1. Name and address of project for which the waiver is requested.

Name: Cobb Theatre 14 @ Daytona 'LIVE'

Address: West International Speedway Blvd

Daytona, Florida 32120

2. Name of Applicant. If other than the owner, please indicate relationship of applicant to owner and written authorization by owner in space provided:

Applicant's Name: Joseph L. Sweeney

Applicant's Address: 530 Beacon Parkway West Suite 900 Birmingham, AL 35209

Applicant's Telephone: (205) 443-3720 FAX: (205) 443-3790

Applicant's E-mail Address: jsweeney@ctsmarchitects.com

Relationship to Owner: Architect for Theatres

Owner's Name: Cobb Theatres LLC

Owner's Address: 2100 A South Bridge Parkway Suite 640; Birmingham, AL 35209

Owner's Telephone: (205) 802-7766 FAX: (205) 802-7771

Owner's E-mail Address: _____

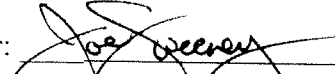
Signature of Owner:  as Agent and Architect for Cobb Theatres, LLC

Contact Person: Joe Sweeney or Lawrence L. Corley

Contact Person's Telephone: (205) 443-3720 E-mail Address: jsweeney@ctsmarchitects.com
lcorley@ctsmarchitects.com

This application is available in alternate formats upon request.
Form No. 2001-01

3. Please check one of the following:

New construction.

Addition to a building or facility.

Alteration to an existing building or facility.

Historical preservation (addition).

Historical preservation (alteration).

4. Type of facility. Please describe the building (square footage, number of floors). Define the use of the building (i.e., restaurant, office, retail, recreation, hotel/motel, etc.)

Multi-Screen Movie Theatre One Story 65,000 +/- square feet

Group "A" Assembly

5. Project Construction Cost (Provide cost for new construction, the addition or the alteration):

\$ 7 million

6. Project Status: Please check the phase of construction that best describes your project at the time of this application. Describe status.

Under Design Under Construction*

In Plan Review Completed*

* Briefly explain why the request has now been referred to the Commission.

N/A

7. **Requirements requested to be waived.** Please reference the applicable section of Florida law. Only Florida-specific accessibility requirements may be waived.

Issue

1: See Attachment 'A'

Issue

2: _____

Issue

3: _____

8. **Reason(s) for Waiver Request:** The Florida Building Commission may grant waivers of Florida-specific accessibility requirements upon a determination of unnecessary, unreasonable or extreme hardship. Please describe how this project meets the following hardship criteria. Explain all that would apply for consideration of granting the waiver.

The hardship is caused by a condition or set of conditions affecting the owner which does not affect owners in general.

Substantial financial costs will be incurred by the owner if the waiver is denied.
See Attachment "A"

The owner has made a **diligent investigation** into the costs of compliance with the code, but cannot find an efficient mode of compliance. Provide detailed cost estimates and, where appropriate, photographs. Cost estimates must include bids and quotes.

9. **Provide documented cost estimates for each portion of the waiver request and identify any additional supporting data, which may affect the cost estimates.** For example, for vertical accessibility, the lowest documented cost of an elevator, ramp, lift or other method of providing vertical accessibility should be provided, documented by quotations or bids from at least two vendors or contractors.

a. The following is the estimated cost impact for this theatre to comply with Section 553.509 of the Florida Statutes:

b. 14 lifts required (14 x \$40,000 each = \$560,000) See Attachment "B"

c. Also because 15% and 30% of seats (depending on house size) must be removed to accommodate the lifts. In addition, the seating platforms will be required to be wider to accommodate the wheelchairs at each tier of seating, further reducing the seat count by an estimated 15% to 30% per house

10. **Licensed Design Professional:** Where a licensed design professional has designed the project, his or her comments **MUST** be included and certified by signature and affixing of his or her professional seal. The comments must include the reason(s) why the waiver is necessary.

See Section 7

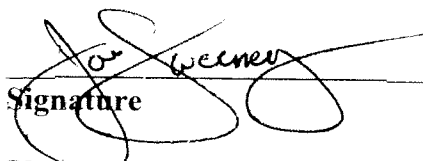
Signature

Joseph L. Sweeney
Printed Name

Phone number (205) 443-3720

(SEAL)

CERTIFICATION OF APPLICANT:

I hereby swear or affirm that the applicable documents in support of this Request for Waiver are attached for review by the Florida Building Commission and that all statements made in this application are to the best of my knowledge true and correct.

Dated this 14 day of December, 2007

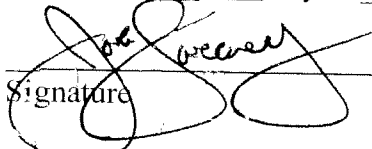
Signature

Joseph L. Sweeney
Printed Name

By signing this application, the applicant represents that the information in it is true, accurate and complete. If the applicant misrepresents or omits any material information, the Commission may revoke any order and will notify the building official of the permitting jurisdiction. Providing false information to the Commission is punishable as a misdemeanor under Section 775.083, Florida Statutes.

REVIEW AND RECOMMENDATION BY LOCAL BUILDING DEPARTMENT.

Please state why the issue is being referred to the Florida Building Commission as well as a recommendation for disposition. The Building Official or his or her designee should review the application and indicate that to the best of his or her knowledge, all information stipulated herein is true and accurate. Further, if this project is complete, explain why it is being referred to the Commission. The Building Official or his or her designee should sign a copy of the plans accompanying this application as certification that such plans are the same as those submitted for building department review. Please reference the applicable section of the Accessibility Code.

a. _____

b. _____

c. _____

Has there been any permitted construction activity on this building during the past three years? If so, what was the cost of construction?

Yes No Cost of Construction _____

Comments/Recommendation _____

Jurisdiction _____

Building Official or Designee _____
Signature

Printed Name _____

Certification Number _____

Telephone/FAX _____

Address: _____

Certification of Licensed Design Professional for Replicated Designs to be Placed on Consent Agenda

Note: This form is to be used only for cases in which design documents are duplicates of previously approved waivers and the project can be placed on a Consent Agenda pursuant to Rule 9B-7.003(3), Florida Administrative Code.

NOT APPLICABLE

I, _____, a licensed architect/engineer in the state of Florida, whose Florida license number is _____, hereby state as follows:

1. I am the architect/engineer of record for the project known as (name of project) _____, for which the Owner seeks a waiver of one or more accessibility requirements in an application to which this Certification is attached.

2. I hereby certify that to the best of my knowledge and belief to the Florida Building Commission that the design documents for the (insert project described in paragraph 1 above) _____ are the same as the design documents previously submitted to the Commission and referenced in paragraph 3 below, except that the two projects are built or to be built on different parcels of land at different locations.

3. The licensed design professional of record (identify the licensed design professional of record), _____, prepared the design documents for the project known as _____, for which the majority of the Accessibility Advisory Council recommended approval and the Commission granted a waiver of one or more accessibility requirements in Final Order No. _____.

Printed Name: _____ Affix certification seal below:

Address: _____

Telephone: _____

Fax: _____

E-Mail Address: _____

Certification of Applicant for Replicated Designs to be Placed on Consent Agenda

Note: This form is to be used only for cases in which design documents are duplicates of previously approved waivers and the project can be placed on a Consent Agenda pursuant to Rule 9B-7.003(3), Florida Administrative Code.

NOT APPLICABLE

I, _____, am applying for placement on the Consent Agenda pursuant to Rule 9B-7.003(3), Florida Administrative Code. I (check one of the following and complete blank):

I am the owner of this Project (name of project) _____,

and was the owner of the project known as _____,

I am the franchisee of this Project (name of project) _____,

am under the same franchiser (name of franchiser) _____

who was the franchiser of the project known as _____,

I am the licensee of this Project (name of project) _____,

am under the same licensor (name of licensor) _____,

who was the licensor of the project known as _____,

for which the majority of the Accessibility Advisory Council recommended approval, and the Florida Building Commission granted a waiver of one or more accessibility requirements in Final Order No. _____.

I hereby swear or affirm that the above information to the best of my knowledge is true and correct.

Dated this _____ day of _____, 20 _____

Signature

Printed Name

Providing false information to the Florida Building Commission is punishable as a misdemeanor under Section 775.083, Florida Statutes.

Attachment 'A'

The Florida State Statues Section 553.509 VERTICAL ACCESSIBILITY states that "Nothing in Sections 553.501 – 553.513 or the guidelines shall be construed to relieve the owner of any building, structure or facility governed by those sections for the duty to provide vertical accessibility to all levels above and below the habitable grade level, regardless of whether the guidelines require an elevator to be installed in such building, structure or facility." The stadium seating concept is one relatively new to the movie theater industry therefore it is commonly believed that this type of building construction was not anticipated during the drafting of legislation for vertical accessibility nor that it was meant to mean that every level or platform of stadium seating be made accessible. The design industry has relied on Section 4.33.3 Placement of Wheelchair Locations for direction during the design process. This section states:

"Wheelchair areas shall be an integral part of any fixed seating plan and shall be provided so as to provide people with physical disabilities a choice of admission prices and lines of sight comparable to those for members of the general public. They shall adjoin an accessible route that also serves as a means of egress in case of emergency. At least one companion fixed seat shall be provided next to each wheelchair seating area. When the seating capacity exceeds 300, wheelchair spaces shall be provided in more than one location. Readily removable seats may be installed in wheelchair spaces when the spaces are not required to accommodate wheelchair users. EXCEPTION: Accessible viewing positions may be clustered for bleachers, balconies and other areas having sight lines that require slopes of greater than 5 percent. Equivalent accessible viewing positions may be located on levels having accessible egress."

It is the design industries desire and duty to incorporate the findings and wishes of the Council and Board with sound and practical construction methods. However, it is impossible to provide vertical accessibility to each level of stadium seating due 1) to the high cost and 2) to the requirements of the ADA Section 4.33.3 which states "they (stadium seating) shall adjoin an accessible route that also serves as a means of egress in case of emergency." It is impractical to achieve this in a stadium seating movie theatre and accommodate the needs of all patrons. We have therefore established the goal of locating accessible seating to within 0% to 20% of the center of each house achieving a disbursed pattern and providing for companion seating as well as achieving comparable sight lines. Having complied with the remaining requirements of Section 4.33.3 it is our belief that this compromise is an acceptable solution to the concerns of all patrons.

**4.33 ASSEMBLY AREAS
STAFF WAIVER ANALYSIS**

Name of Assembly: Cobb Theatres 14 @ Daytona 'LIVE' [X] New [] Alteration [] Addition

Auditorium Category	Auditorium numbers in the category	Wheelchair spaces per auditorium			Companion seating provided? Y/N	Number of wheelchair spaces provided in:		
		Provided	FL requires	• ADA requires		Front Zone A	Middle Zone B	Back Zone C
A. Fixed Seats 51 to 100	N/A	---	4	4	---	---	---	---
B. Fixed Seats 101 - 200	Houses 3, 4, 11, 12	5	5	4	Yes	0	5	0
	Houses 2, 5, 10, 13	5	5	4		0	5	0
	Houses 6, 9	5	5	4		0	3	2
C. Fixed Seats 201 to 300	Houses 1, 14	6	6	4	Yes	0	4	2
D. Fixed Seats 301 to 400	Houses 7, 8	7	7	6	Yes	0	4	3
E. Fixed Seats 401 to 500	N/A	---	8	6	---	---	---	---
F. Fixed Seats 501 to 600	N/A	---	9	7	---	---	---	---
G. Fixed Seats 601 and up	N/A	---	---	---	---	---	---	---

Wheelchair spaces required: FL 51 to 100 -- 4 + 1 for every 100 fraction. ADAAG 51 to 300 -- 4; 301 to 500 -- 6 + 1 for every 100 or fraction. When the seating capacity exceeds 300, wheelchair spaces shall be provided in more than one location.

In theatres seating 150 or more, 50% of wheelchair spaces should be located in zone B (sweet spot) as per Charette 2-10-98.

ANY EXPLANATIONS:

Attachment 'B'

Outside letter from ELEVATORS, Etc.
Dated September 30, 1998.

Attachment 'B'

ELEVATORS, Etc.

ACCESSIBILITY EQUIPMENT SALES and SERVICE

1773 Blount Road, Suite 303
Pompano Beach, FL 33069
(954) 970-0767
Fax (954) 970-7227

September 30, 1998

Mr. Lawrence L. Corley
BAILEY-CORLEY & ASSOCIATES, Inc.
530 Beacon Parkway West, Suite 701
Birmingham, AL 35209

RE: Movie Theater - vertical accessibility

Dear Mr. Corley:

As discussed with members of your firm, there isn't any type of equipment on the market at this time that I am aware of that is designed to provide vertical access to every level of a movie theater such as the ones we've reviewed.

An incline platform lift complying with ADA and ANSI elevator codes could be utilized to provide access to up to seven levels per lift however. The cost of such a lift is estimated to be between \$40,000.00 and \$50,000.00. Therefore, in order to accommodate up to 14 levels, you can estimate a cost of \$80,000.00 to \$100,000.00.

As you know, the equipment has clearance requirements that need to be met in order for it to fit in a given stairway. However, this should not pose a significant problem.

I'd be happy to review any other plans if you wish and get the manufacturers more involved with this issue if you feel it appropriate. Thank you for asking me to review this matter.

Sincerely,

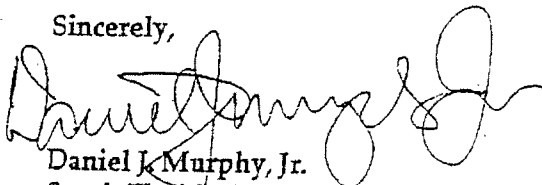

Daniel J. Murphy, Jr.
South Florida Sales Manager



Corley Timothy Sweeney McCormac

December 18, 2007

Ms. Mary Katherine Smith
Department of Community Affairs
Codes & Standards Section
2555 Shumard Oak Blvd.
Tallahassee, FL 32399-2100

Re: Cobb 14 Theatres @ Daytona 'LIVE'
Daytona, Florida
CTSM No. 1749

Dear Ms. Smith:

I have enclosed the cover form along with the required documents for our submission on the Cobb Theatre for Daytona 'LIVE', Daytona, Florida.

I have signed the application letter as Architect for the submission, and will be coming to the Hearing to represent our office.

Please let us know if you need any more information at this time. Thank you for your assistance with this submission.

Sincerely,

A handwritten signature in black ink that reads "Joe Sweeney". The signature is fluid and cursive, with the first and last letters of each word being capitalized and prominent.

Joe Sweeney
Principal, CTSM Architects, Inc.

CC: Lawrence Corley
Bobby Cobb

Attachments: Florida Accessibility Waiver Forms, Drawings 24" x 36", 11" x 17" and 8½" x 11",
w/ Transparencies and Disk

C T S M A R C H I T E C T S , I N C .

ARCHITECTURE INTERIOR DESIGN MASTER PLANNING CONSULTING

530 BEACON PARKWAY W. / SUITE 900 / BIRMINGHAM, ALABAMA 35209

T 205.443.3720 F 205.443.3790 W ctsmarchitects.com

J:\Jobs\1749 Cobb Daytona\Florida Handicap\Smith, Mary K.doc

© 2006, CTSM Architects, Inc.

B1 OVERALL SITE PLAN
Scale: 1" = 200'

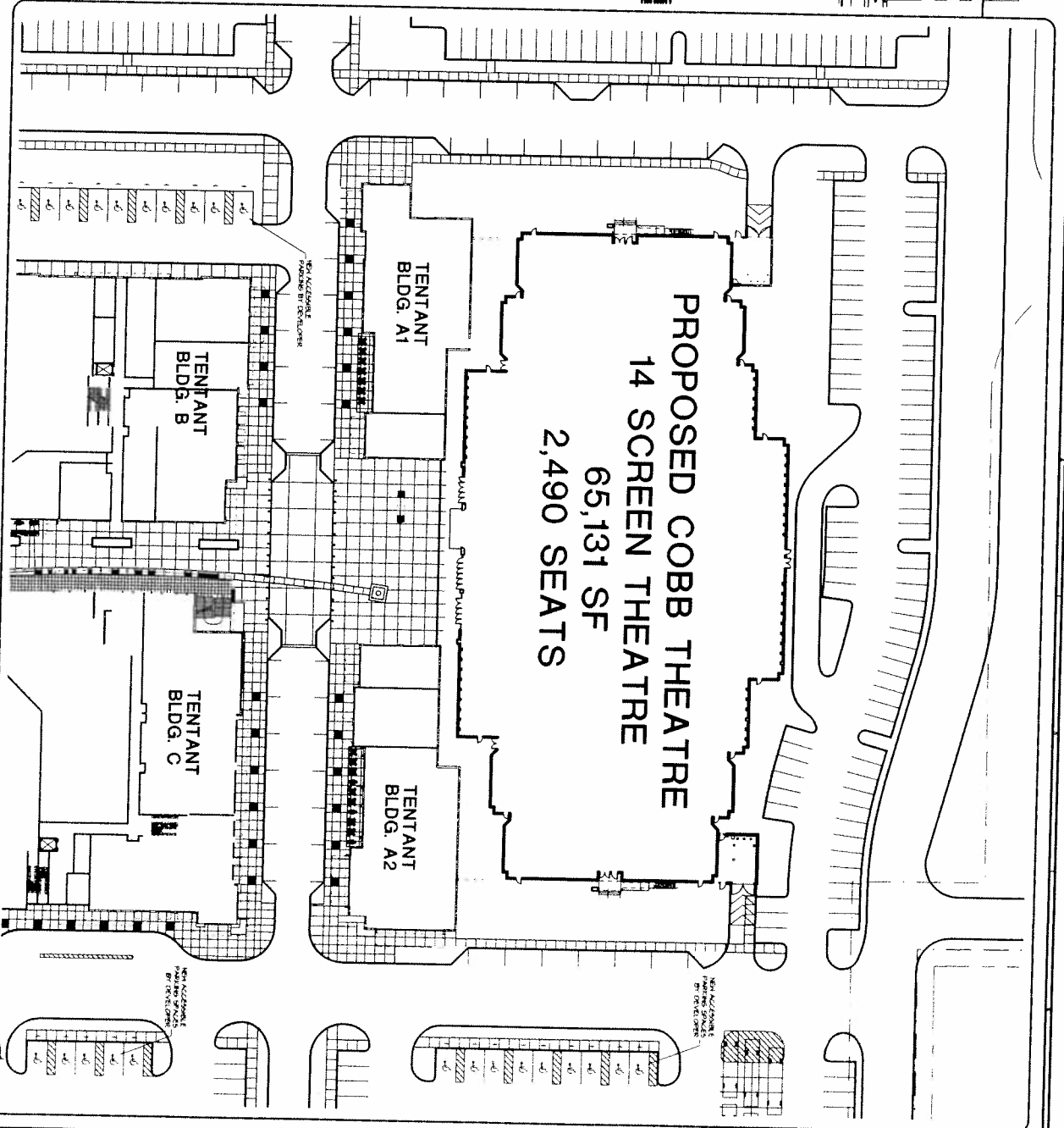
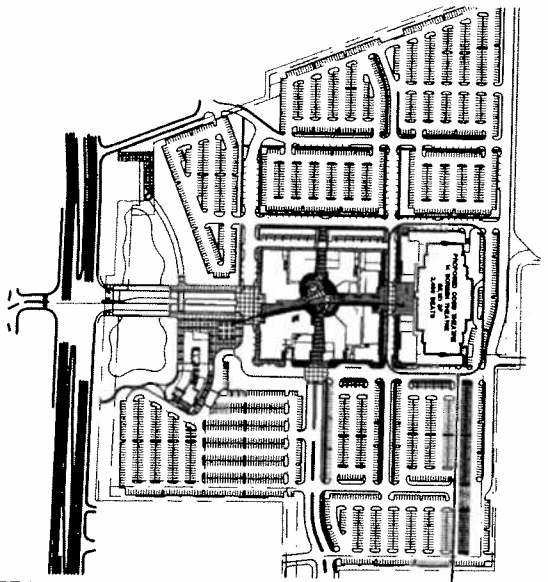

D1 PROPOSED SITE PLAN
Scale: 1" = 200'

A010

REV. 2/20
DAYTONA 'LIVE'
COBB THEATRE
14 PLEX

11.7.02
1749
Daytona, Florida

PROPOSED SITE PLAN

CorleyTimothySweeneyMcCormac
CTSM ARCHITECTS, INC.
530 BEACON PARKWAY W. / SUITE 900 / BIRMINGHAM, ALABAMA 35209
T. 205-443-3720 F. 205-443-3790 W. ctsmarchitects.com



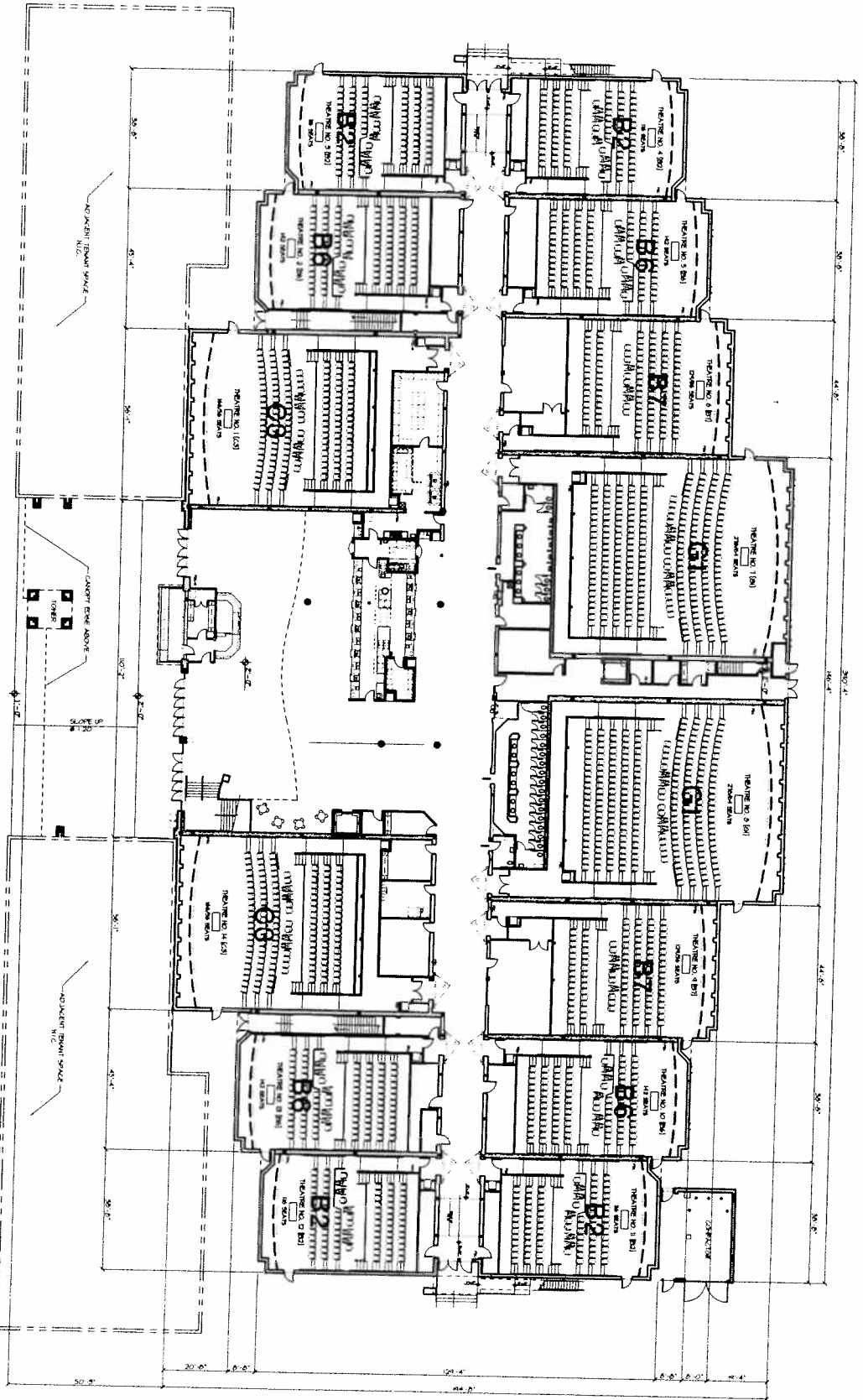

FOOTPRINT AREA = 65,911 SQ.FT.
 SECOND FLOOR
 DEVELOPMENT AREA = 5,816 SQ.FT.
 PROJECTION AREA = 2,860 SQ.FT.

MAIN LEVEL FLOOR PLAN

SCALE: 1/8" = 1'-0"
 CONCEPTUAL DATA 11-7-07

SCREENS 14
 SEATS 2,440 SEATS
 FINISHING SQ. FT. 55,931 SQ.FT.
 EFFICIENCY RATIO 20.937 SQ.FT.

SEAT TOTALS

NOVUE 6	NOVUE 7	NOVUE 8	NOVUE 9	NOVUE 10	NOVUE 11	NOVUE 12	NOVUE 13	NOVUE 14	NOVUE 15	NOVUE 16	NOVUE 17	NOVUE 18	NOVUE 19	NOVUE 20	TOTAL
2,842	2,822	2,842	2,842	2,842	2,842	2,842	2,842	2,842	2,842	2,842	2,842	2,842	2,842	2,842	2,842



NORTH

DAYTONA 'LIVE'
COBB THEATRE
 14 PLEX

11.7.07
 1749
 Daytona, Florida

MAIN LEVEL FLOOR PLAN

CorleyTimothySweeneyMcCormac
 CIVIL ARCHITECTS, INC.
 430 BEACON PARKWAY N.W. SUITE 701 / BIRMINGHAM, ALABAMA 35209
 T 205-443-3750 F 205-443-3750 W ctmsmc@tmsmc.com FL Lic # AA0003447



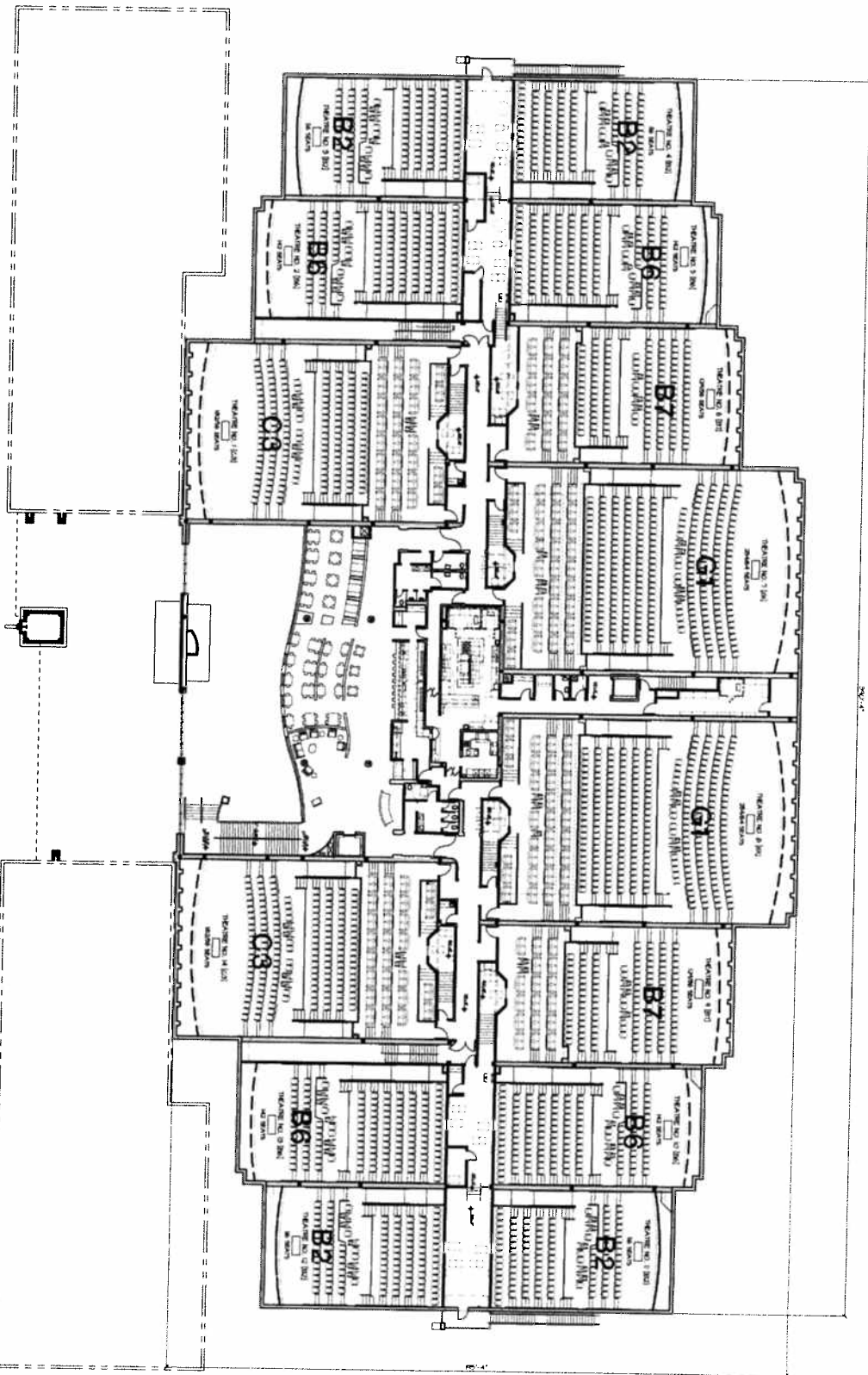

PROJECTION LEVEL FLOOR PLAN
SCALE: 1/8" = 1'-0"

A102

DAYTONA 'LIVE'
COBB THEATRE
14 FLEX

Daytona, Florida

11.7.02
1749

PROJECTION LEVEL
FLOOR PLAN

CorleyTimothySweeneyMcCormac
C T S M A R C H I T E C T S, I N C.
530 BEACON PARKWAY W. SUITE 701 / BIRMINGHAM, ALABAMA 35209
T 205-443-3720 F 205-443-3790 W ctmarchitects.com FL Reg. # 9703



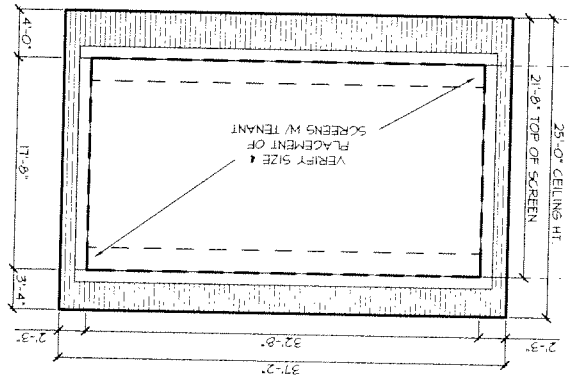
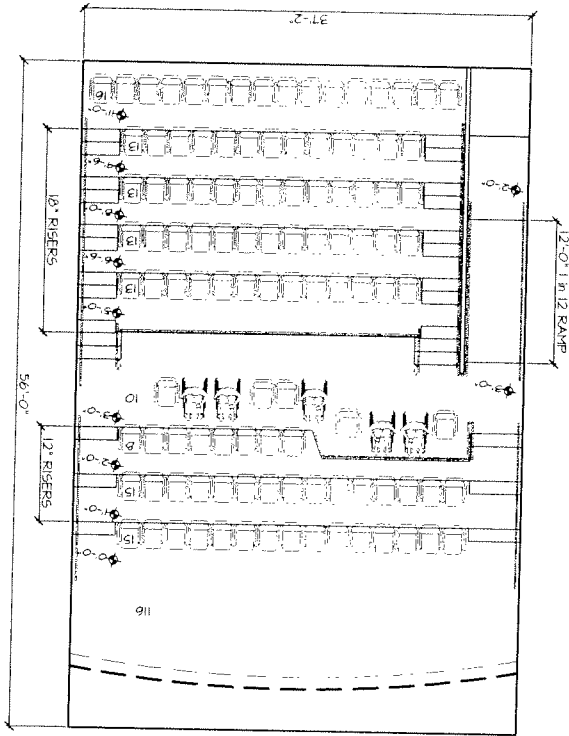
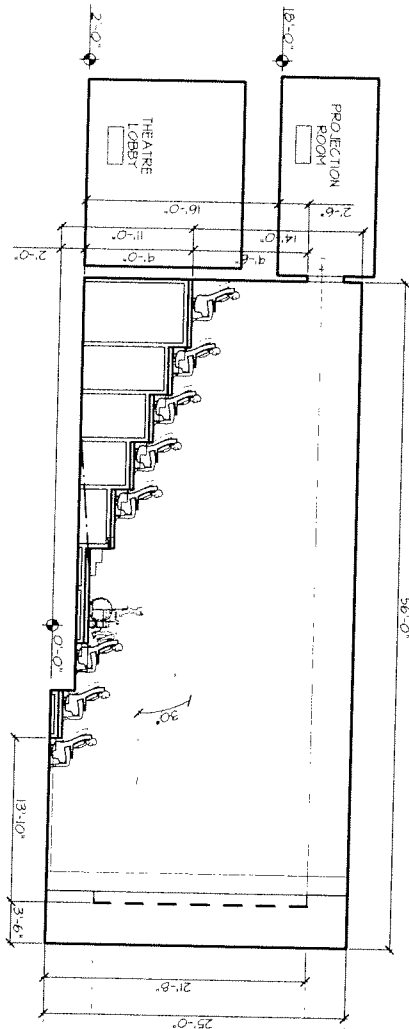

THEATRE HOUSE TYPE 'B2'
SCALE: 1/8" = 1'-0"
116 SEATS IN 4 THEATRE HOUSES 3, 4, 11, 12

B2

A1

DAYTONA 'LIVE'
COBB THEATRE
14 FLEX

Daytona, Florida

11-7-07
1749

THEATRE HOUSE TYPE 'B2'
THEATRE HOUSES 3, 4, 11 & 12

CorleyTimothySweeneyMcCormac
CTSMA ARCHITECTS, INC.
530 BEACON PARKWAY W / SUITE 900 / BIRMINGHAM, ALABAMA 35209
T 205 443 3720 F 205 443 3795 W ctsmaarchitects.com



THEATRE HOUSE TYPE 'B6'
 SCALE: 1/16" = 1'-0"
142 SEATS IN 4 THEATRE HOUSES 2, 5, 10, 13

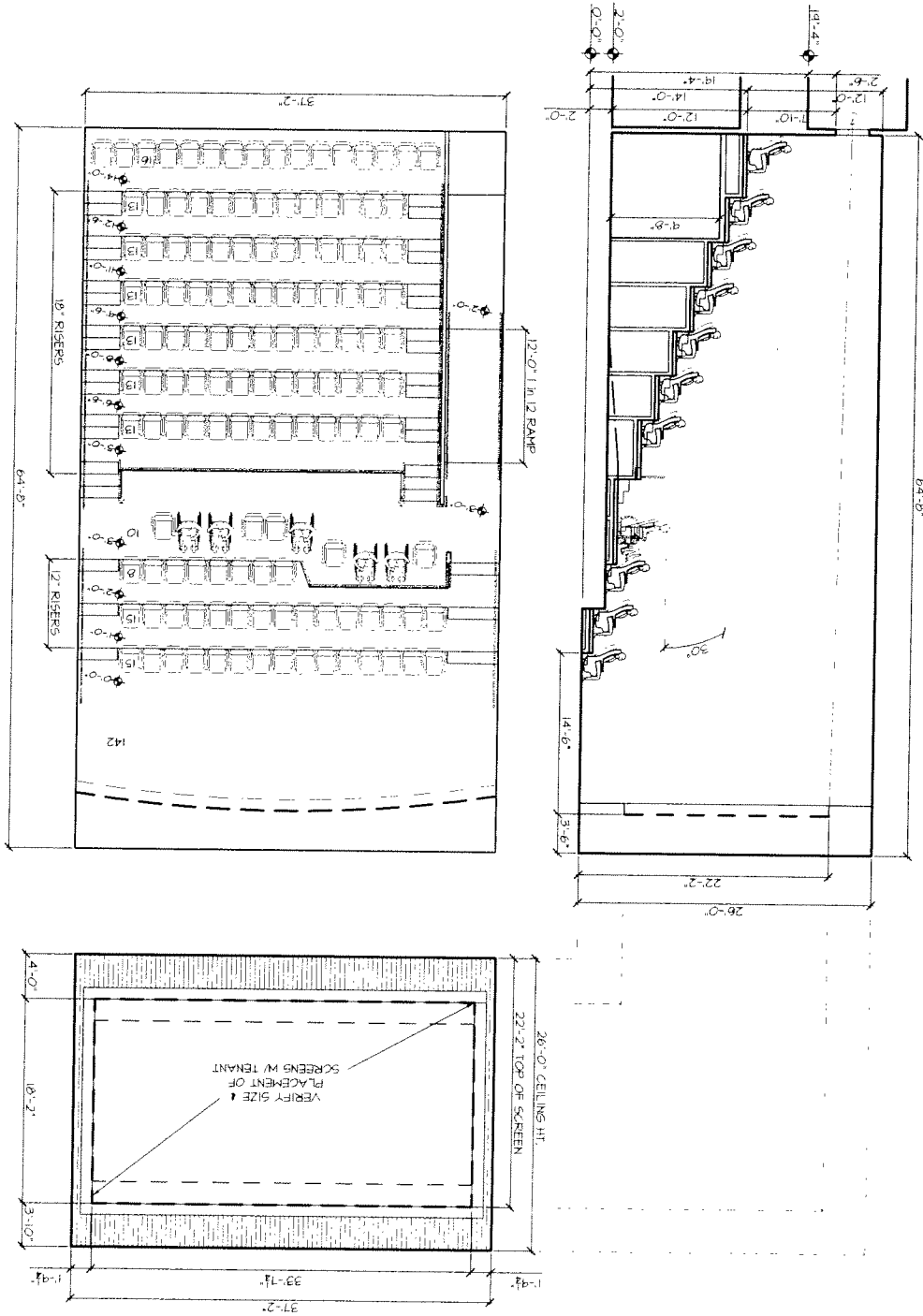

B6

A2

DAYTONA 'LIVE'
 COBB THEATRE
 14 FLEX

Daytona, Florida

11-7-07
 1749

THEATRE HOUSE TYPE 'B6'
 THEATRE HOUSES 2, 5, 10 & 13

Corley Timothy Sweeney McCormac
 C T S M A R C H I T E C T S I N C.
 530 BEACON PARKWAY N., SUITE 900 / BIRMINGHAM, ALABAMA 35209
 T 205 443 3720 F 205 443 3790 W ctsmarchitects.com



THEATRE HOUSE TYPE 'B7'

SCALE: 1/8" = 1'-0"

165 SEATS IN 2 THEATRE HOUSES 6 & 9

PREMIUM SEATS - 36
STANDARD SEATS - 129
TOTAL SEAT COUNT - 165

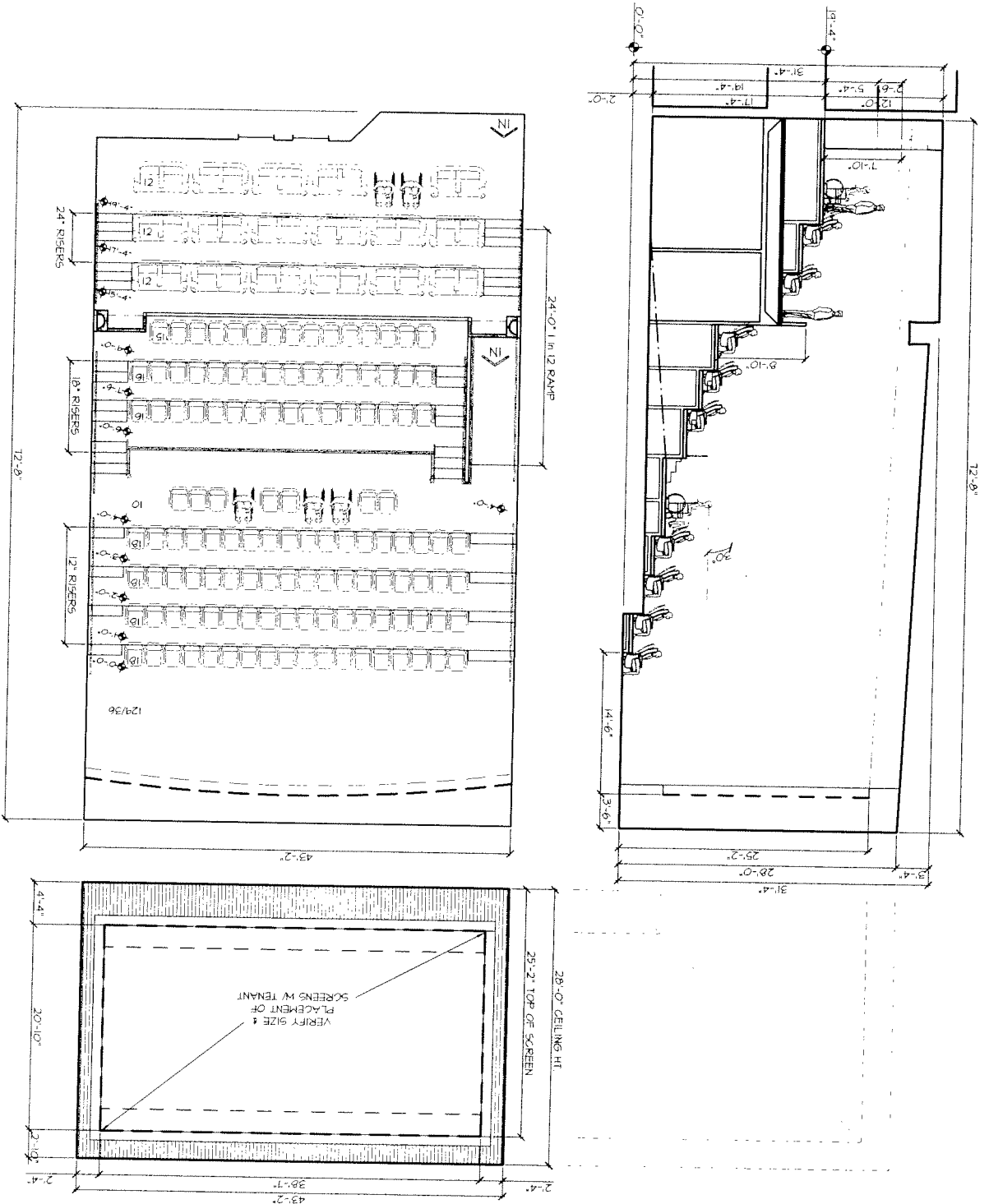

37



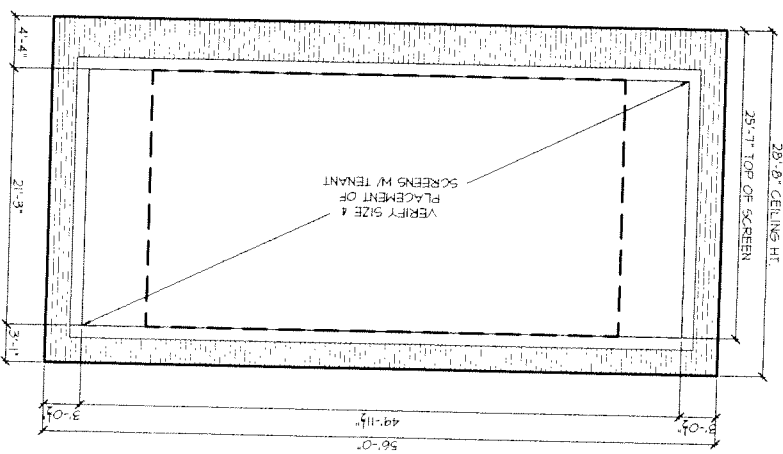
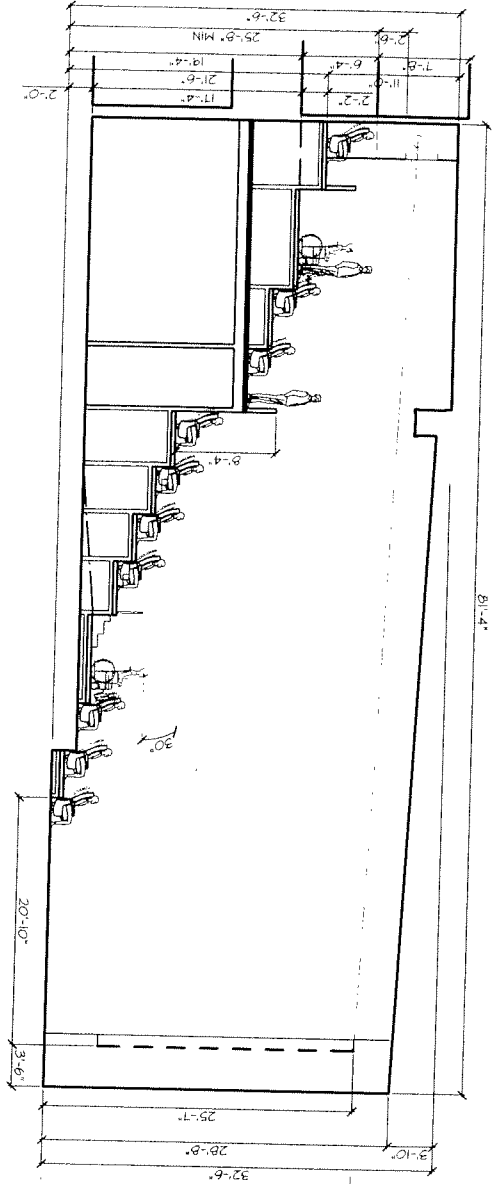
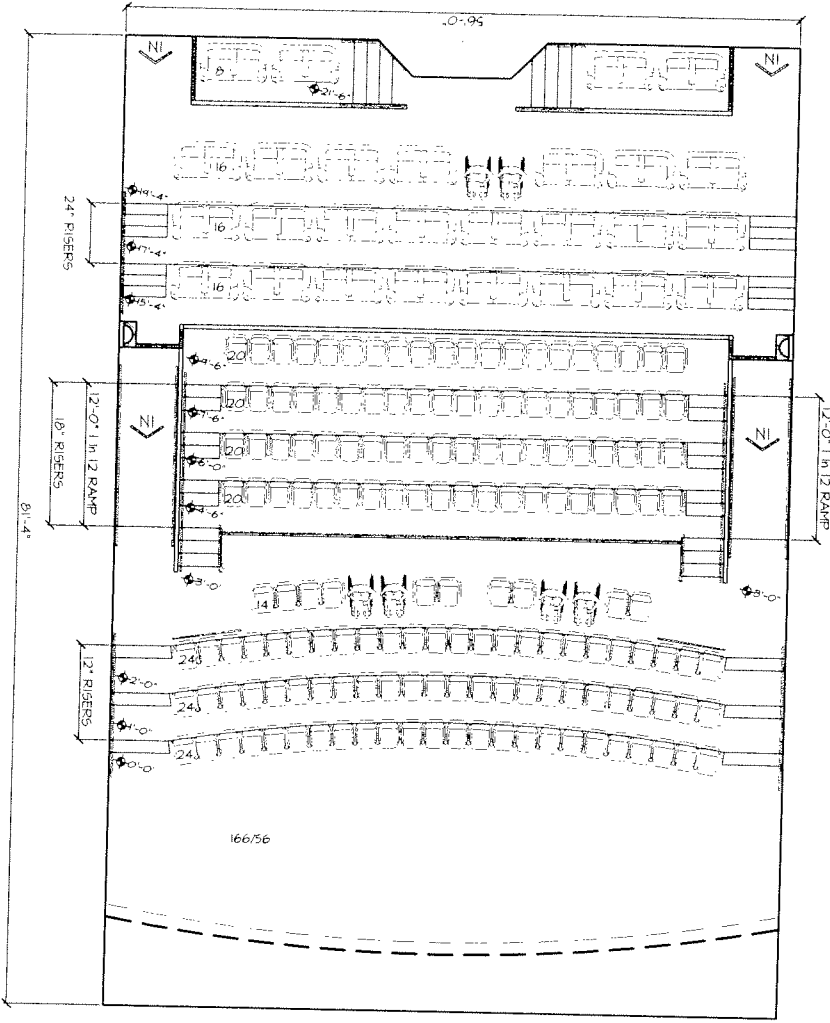

THEATRE HOUSE TYPE 'C3'
 SCALE: 1/8" = 1'-0"
222 SEATS IN 2 THEATRE HOUSES 1, 14

PREMIUM SEATS - 56
STANDARD SEATS - 166
TOTAL SEAT COUNT - 222

33

