

Sign Legend				
Id.	M.U.T.C.D. Number	Dimensions		Symbol
		Width	Height	
1	R1-1	30"	30"	STOP
2	R1-3P	18"	6"	ALL WAY
3	W11-2	24"	24"	PEDESTRIAN
4	W16-9P	24"	12"	AHEAD
5	W16-7P	24"	12"	RIGHT TURN
6	R2-1	24"	30"	20 MPH
7	R2-1	24"	30"	15 MPH
8	W11-11	30"	30"	TRUCK
9	R1-2	36"	36"	YIELD
10	W11-2	30"	30"	ROUNDABOUT
11	R6-4	30"	24"	RIGHT TURN
12	W16-7P	24"	18"	TRAFFIC CIRCLE
13	R1-6	12"	36"	STREET NAME

Pavement Marking Legend		
Symbol	Description	
14	←	PAINTED WHITE DIRECTIONAL ARROWS PER FDOT INDEX 711-002
15	—	24" STOP BAR (4' BEHIND CROSSWALK/CURB RAMPS) PER FDOT INDEX NO. 711-001
16	I	CROSSWALK PER FDOT INDEX NO. 711-001
17	—	6" SOLID WHITE STRIPE PER FDOT INDEX NO. 711-001
18	—	6" SOLID YELLOW STRIPE PER FDOT INDEX NO. 711-001
19	—	DOUBLE 6" SOLID YELLOW STRIPE AND 18" YELLOW SOLID LINE IN A 45° ANGLE PER FDOT INDEX NO. 711-001
20	6" WHITE ENTRANCE LINE (2'-4" SKIP) PER FDOT INDEX NO. 711-001

- NOTES:
1. ALL STRIPING AND SIGNAGE TO BE INSTALLED IN ACCORDANCE WITH MUTCD (LATEST EDITION) AND FDOT STANDARDS AND SPECIFICATIONS, UNLESS OTHERWISE SPECIFIED.
 2. NO PARKING ZONES ON STREETS TO BE ENFORCED THROUGH THE HOA DOCUMENTS.
 3. HANDICAP RAMPS MUST BE CONSTRUCTED AT THE ROUNDABOUT INTERSECTION(S) AND TO COMPLY WITH THE AMERICANS WITH DISABILITY ACT (ADA) AND WILL MEET FDOT DESIGN STANDARDS. DETECTABLE WARNING SURFACES WILL BE PROVIDED AT ALL PLACES WHERE VEHICULAR PATH MEETS PEDESTRIAN PATH.
 4. STREET NAME SIGNS SHALL BE PLACED AT ALL INTERSECTIONS PER ORANGE COUNTY STANDARDS AND SPECIFICATIONS.

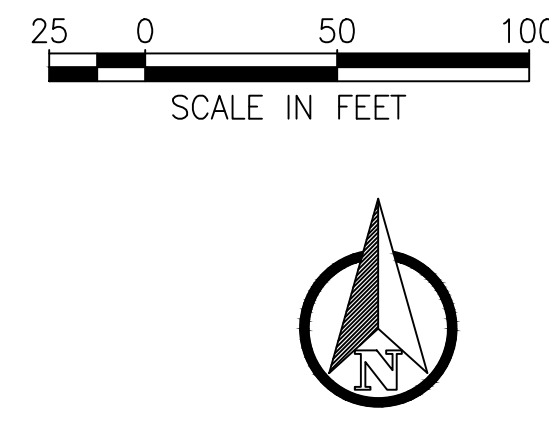
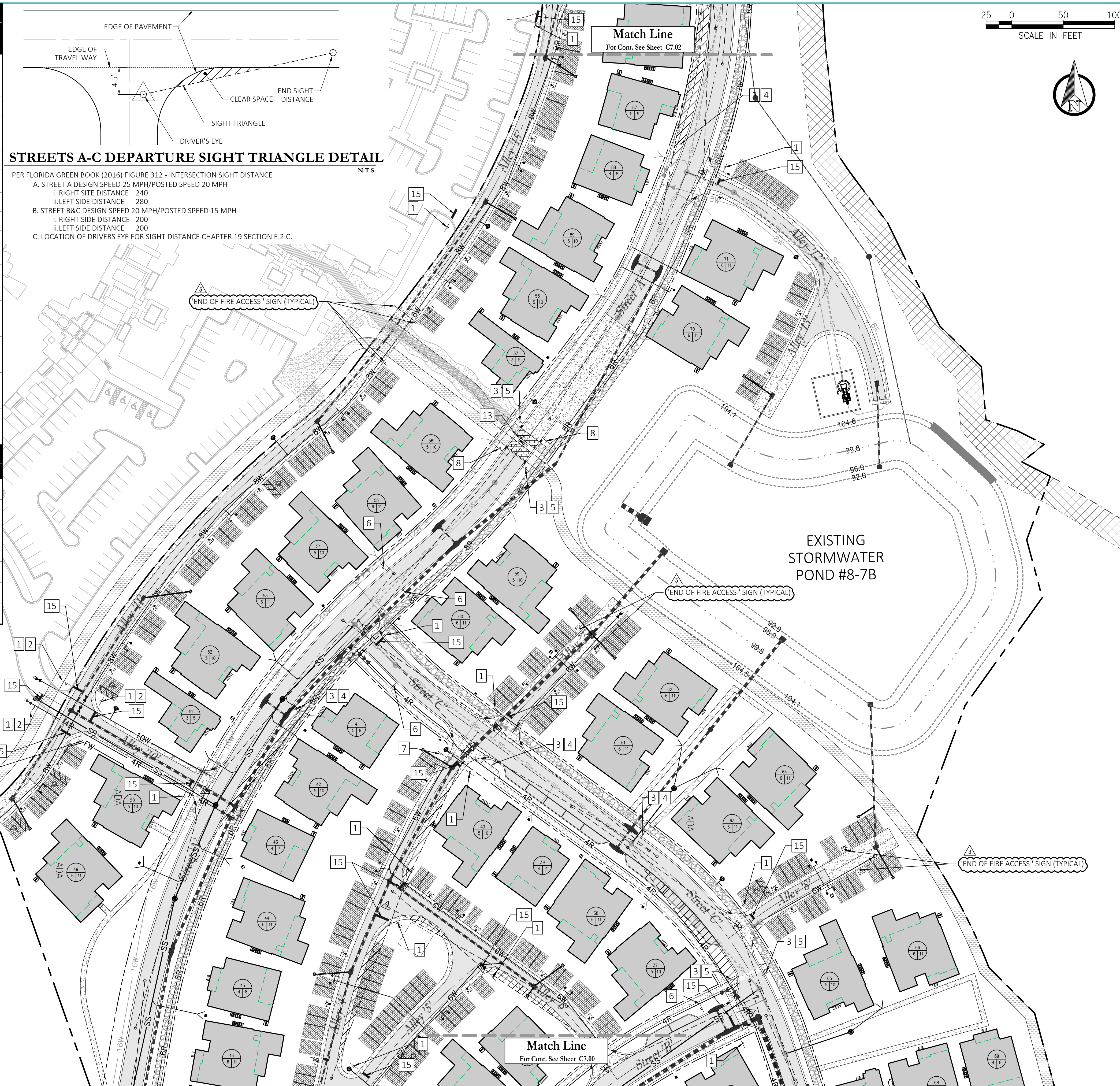

Owner

Project Name

CORE VILLAGE
GRAND CYPRESS RESORT

Consultants

DIX-HITE LANDSCAPE ARCHITECT
DIX.HITE + PARTNERS
150 WEST JESUP AVE.
LONGWOOD, FL 32750

LRK ARCHITECT
LRK
671 FRONT STREET, SUITE 220
CELEBRATION, FL 34747

POULOS & BENNETT CIVIL ENGINEER
POULOS & BENNETT
2602 E. LIVINGSTON ST.
ORLANDO, FL 32803

exp. LIGHTING CONSULTANT
EXP
2601 WESTHALL LANE
MAITLAND, FL 32751

dtj LANDSCAPE ARCHITECT
dtj DESIGN
817 W. PEACHTREE ST.
ATLANTA, GA 30308

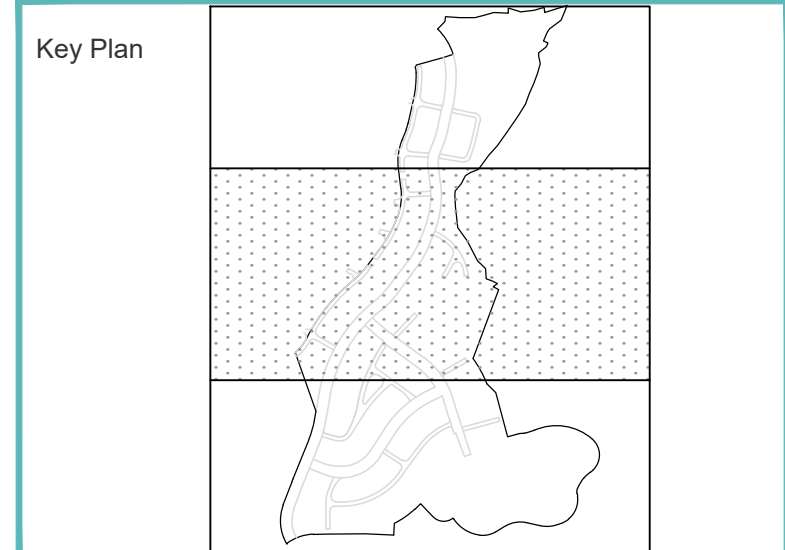

Rev	Date	Issued for
1	1/13/2021	Orange County
2	2/10/2021	Orange County
3	3/12/2021	Orange County

Date	09/02/2020
Designed By	JR / DM
Drawn By	JR / DM
Approved / Checked By	RAO/CMB
Project Number	18-027

Seal

CHRISTINA M. BAXTER
LICENSE No. 67547
STATE OF FLORIDA
PROFESSIONAL ENGINEER

DATE: March 11, 2021
ENG. BUS. NO. 35867

Project Phase

CONSTRUCTION PLANS

Sheet Title

SIGNAGE & STRIPING PLAN

Revision Number	Sheet Number
3	C7.01