



# **SUPERBLUE**

## VISIBILITIES / DISABILITIES

## ABOUT SUPERBLUE

At Superblue, we believe that art and creativity have the power to change how people understand the world we live in.

So we've teamed up with innovative artists who think the same. Artists who create experiential artworks that are as meaningful as they are breathtaking. Who push boundaries of what art can be, where it can be shown, and how it can be understood. Who invite audiences to participate in their extraordinary work to share in the experience of it together.

Superblue is an initiative designed to champion artists whose ideas are best expressed through large-scale immersive installations that are audacious, evocative, and impactful. A global network of Superblue experiential art centers, as well as other physical and digital platforms, are currently underway to support this vision.

Spearheaded by co-founders Marc Glimcher, President and CEO of Pace Gallery and Mollie Dent-Brocklehurst, previously President of Pace London, Superblue's Leadership team brings together expertise across art, audiences, production, entertainment and technology.

Welcome to Superblue. A new way to experience art, created by artists and completed by you.

[Click here to know more about our leadership team](#)

[Click here to know more about the story behind our name](#)



Image of DRIFT, Ego

## ORIGIN OF SUPERBLUE

Superblue is a ground-breaking new model, arising from several major shifts in the contemporary art landscape.

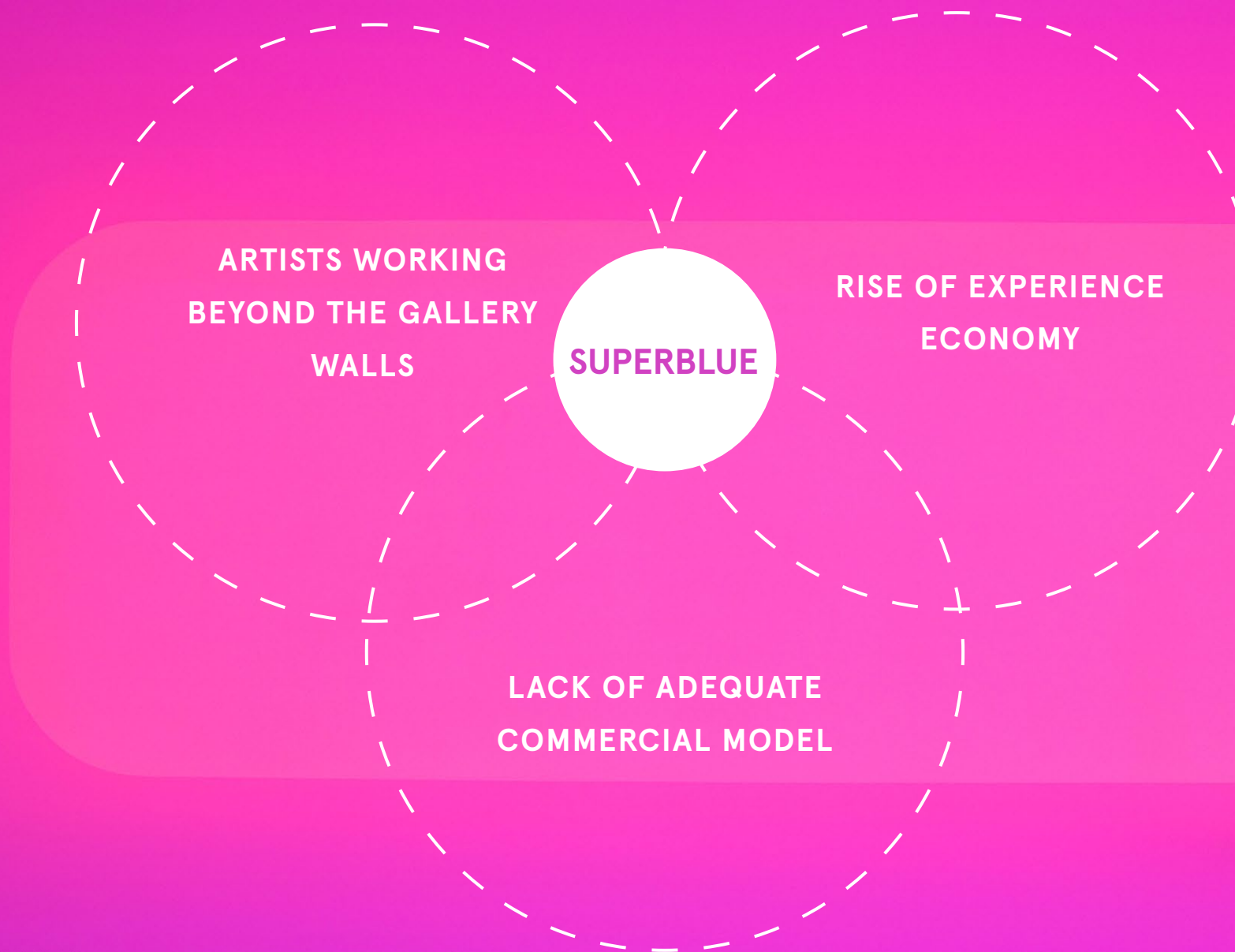

SUPERBLUE

Image of James Turrell, AKHU



## OUR ARTISTS

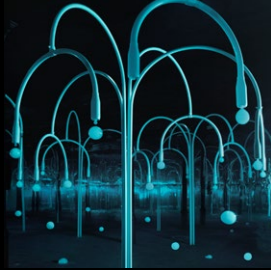

A.A. Murakami



Daniel Boyd



Nick Cave



Mary Corse



Es Devlin

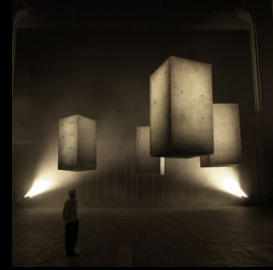

DRIFT

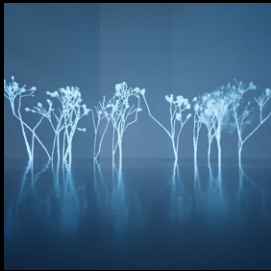

Simon Heijdens



Studio INI



Yinka Ilori



JR



Glenn Kaino

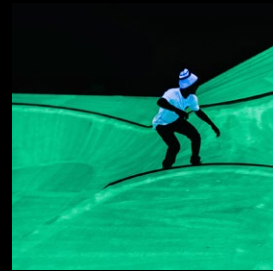

Koo Jeong A



Joanie Lemerrier



Rafael Lozano-Hemmer



Kohei Nawa



Carsten Nicolai



Risa Puno



Quayola



RANDOM  
INTERNATIONAL



Michal Rovner



Jacolby Satterwhite



Jakob Kudsk  
Steensen



teamLab



James Turrell



Leo Villareal

**SUPERBLUE MIAMI**



**SUPERBLUE MIAMI  
LOCATION**

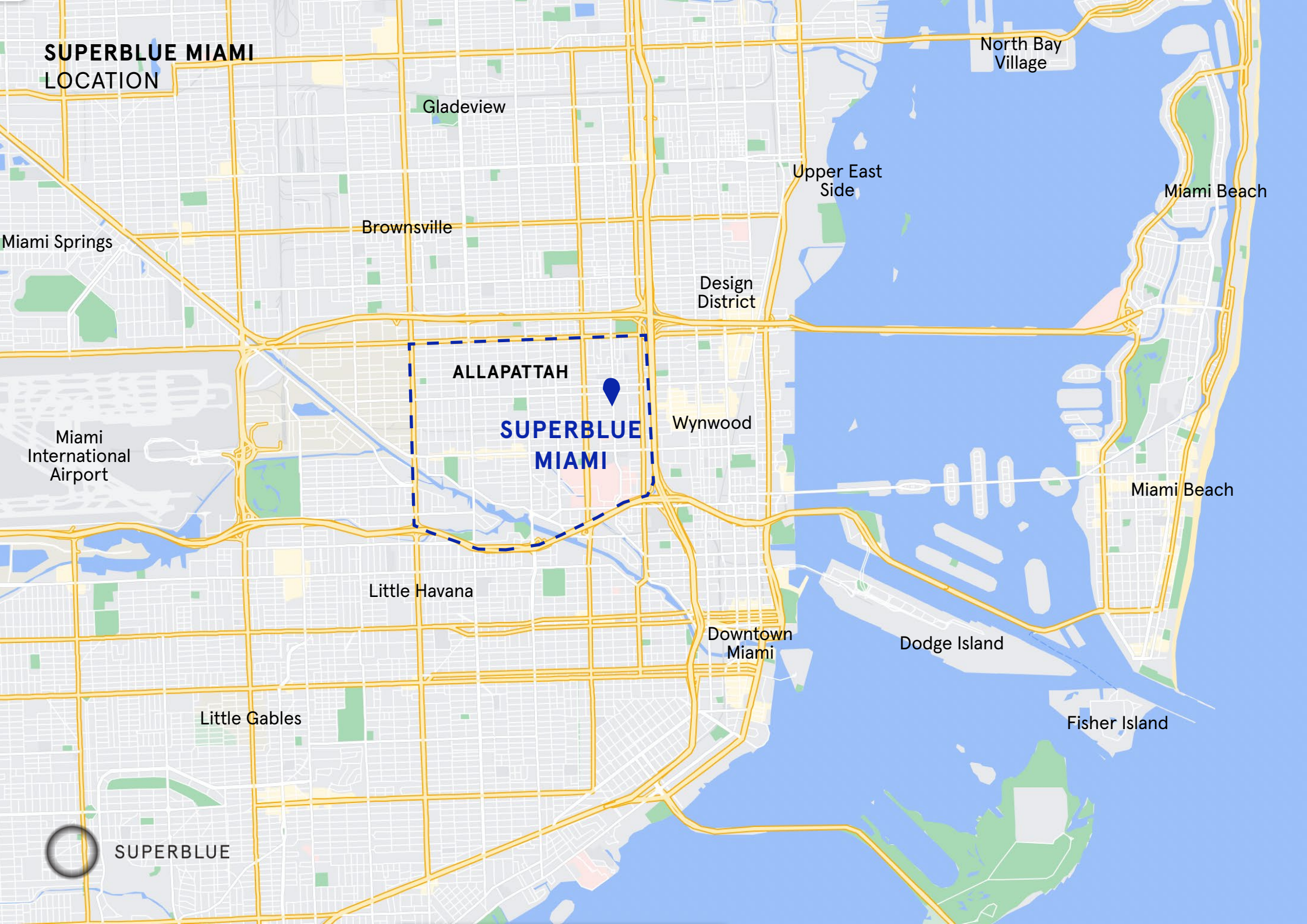

ALLAPATTAH

**SUPERBLUE  
MIAMI**

North Bay  
Village

Gladeview

Upper East  
Side

Miami Beach

Brownsville

Design  
District

Wynwood

Miami  
International  
Airport

Miami Beach

Little Havana

Downtown  
Miami

Dodge Island

Fisher Island

Little Gables



SUPERBLUE



# SUPERBLUE MIAMI

Over 50,000 sq ft in the Allapattah neighborhood.  
1101 NW 23rd St, Miami, FL 33127





## SUPERBLUE MIAMI

### EVERY WALL IS A DOOR



#### teamLab

teamLab (f. 2001, Tokyo, by Toshiyuki Inoko) is an interdisciplinary group of 500 whose collaborative practice navigates the merger of art, technology, design, and the natural world.



#### Rafael Lozano-Hemmer

Lozano-Hemmer develops participatory installations at the intersection of architecture, technology and performance art, with a particular interest in the history of scientific discovery.

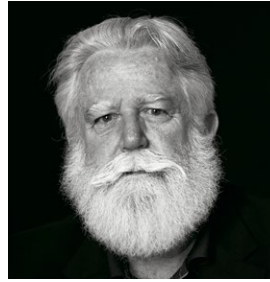

#### James Turrell

Turrell is a pioneer of the Light and Space movement of the 1960s. For over 50 years, Turrell has worked with light and space to create artwork that engages viewers with the limits of human perception.



#### Es Devlin

Devlin is known for creating large-scale performative sculptures and environments that fuse music, language, and light. She is a globally renowned artist and stage designer, based in London.



#### Yinka Ilori

Yinka Ilori is an artist based in London whose bold, colorful aesthetic draws on his British-Nigerian cultural heritage to demonstrate how design can positively impact architectural and social landscapes.



SUPERBLUE



**SUPERBLUE MIAMI**  
EVERY WALL IS A DOOR



**TEAMLAB**  
Between Life and  
Non-Life



**TEAMLAB**  
Massless Clouds  
Between Sculpture  
and Life



**RAFAEL  
LOZANO-  
HEMMER**  
Pulse Topology



**JAMES TURRELL**  
AKHU

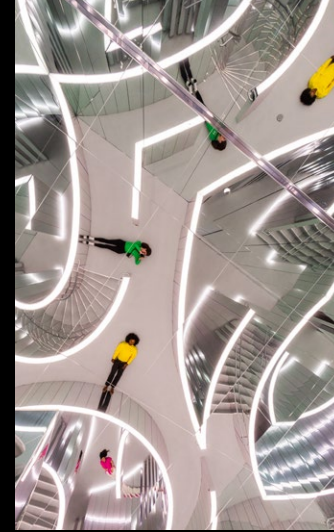

**ES DEVLIN**  
Forest of Us

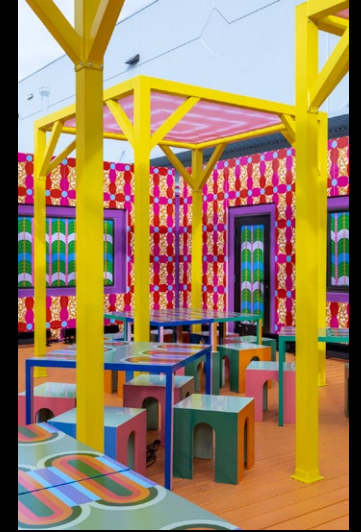

**YINKA ILORI**  
Blue Rider Cafe

# SENSORY GUIDE



# SENSORY GUIDE

## SENSORY KIT

We have a Sensory kit and guides available for those who may need it. This kit can be collected at the entrance where one of our team will explain the contents and use accordingly.

### SENSORY GUIDES:

- Know as you go
- Sensory guide key
- Social story

### SENSORY KIT INVENTORY:

- 2 Sensory toys
- Sunglasses
- Emotion cards
- Assistance cards
- Ear Plugs

*Please email [andrea@superblue.com](mailto:andrea@superblue.com) if you have any questions*



KNOW AS YOU GO

# SUPERBLUE MIAMI



PLEASE BE AWARE THAT WE HAVE MANY CHANGES IN LIGHT AND SOUND BETWEEN OUR EXPERIENCES, AND THIS MAY AFFECT PHOTSENSITIVE GUESTS.

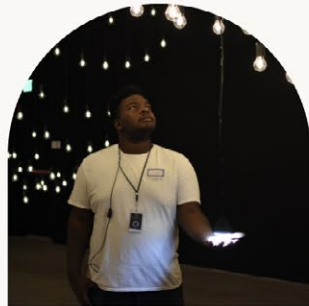

IF YOU HAVE ANY QUESTIONS OR CONCERNS BEFORE, DURING, OR AFTER YOUR VISIT, PLEASE COMMUNICATE WITH OUR GUIDES.



AT ANY POINT DURING YOUR EXPERIENCE, PLEASE FEEL FREE TO UTILIZE OUR [SAFE SPACE](#) FOR A QUIET AREA TO RELAX AND RECENTER.







## ACCESS AND WAYFINDING



### SENSORY MAP



We have identified some spaces within the Experimental Art Center that some should be aware of in their visit. These spaces—some of which are quieter and less crowded and others that are overly stimulating—are indicated in this Sensory Friendly Map.

 Disclaimer: Dramatic changes in light and imagery will occur. It may not be safe for some people with epilepsy and other conditions with sensitivity to light



-  Noisy Space
-  Please Touch
-  Do Not Touch

-  Bright Space
-  Dark Space
-  Quiet Space

-  Show Your Ticket
-  Safe Space

**SENSORY GUIDE**  
ADA, DISABILITY ACCESS

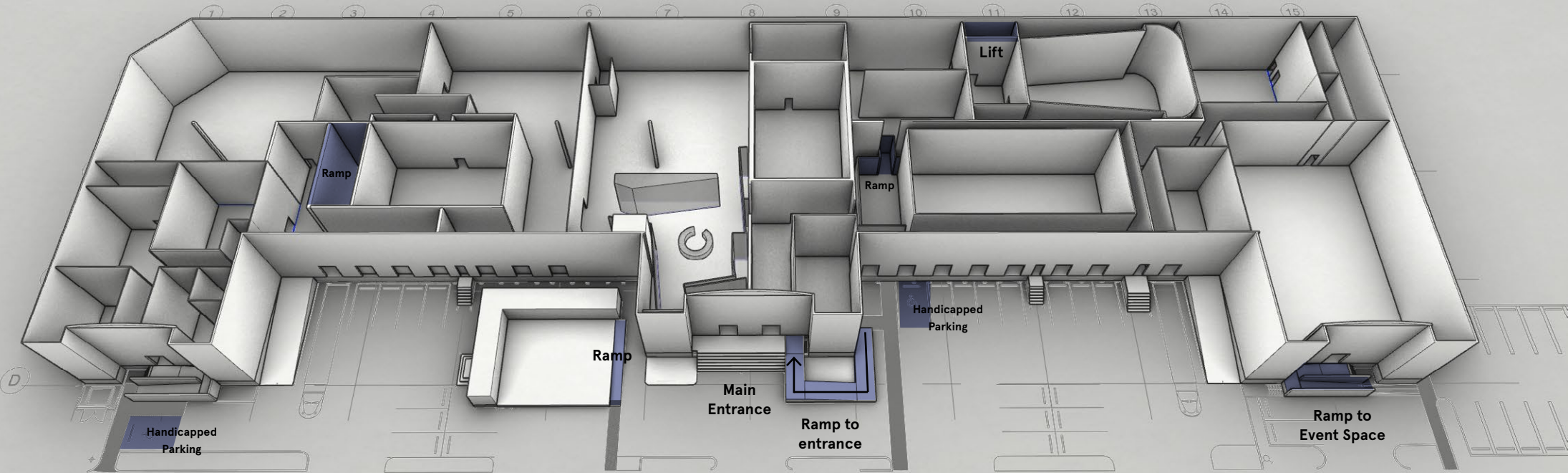



**SENSORY GUIDE**  
ADA, DISABILITY ACCESS

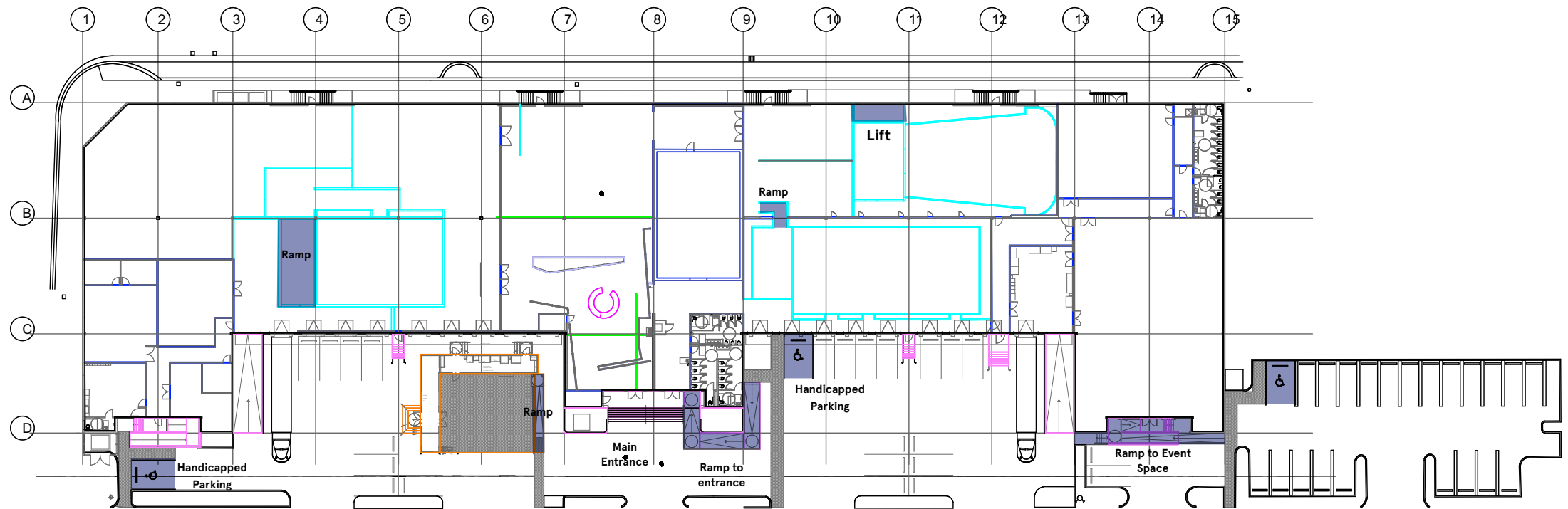

**SUPERBLUE MIAMI**  
**AUTISM DESIGNATION VISIT**





# SUPERBLUE MIAMI

## AUTISM DESIGNATION VISIT



# SUPERBLUE MIAMI

## AUTISM DESIGNATION VISIT

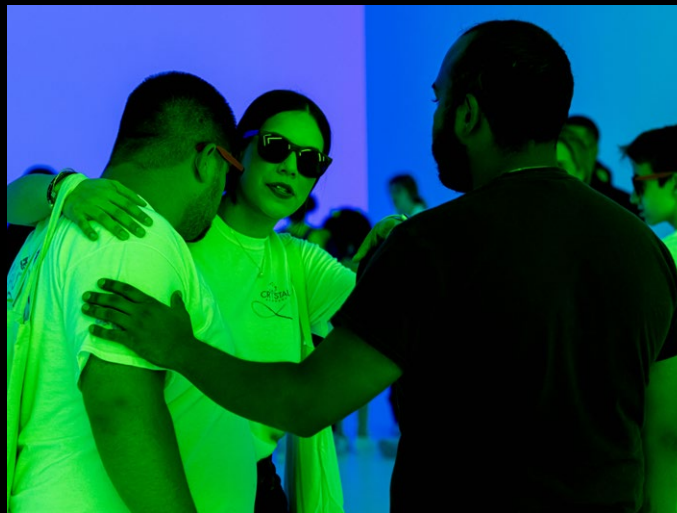
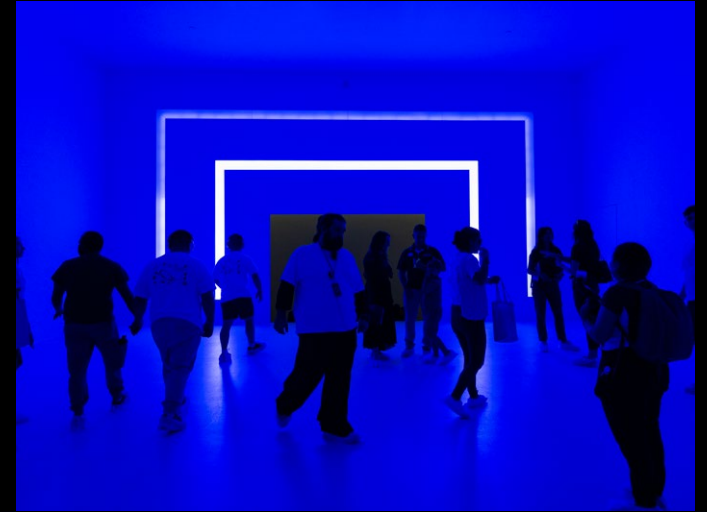



## SUPERBLUE MIAMI AUTISM DESIGNATION VISIT

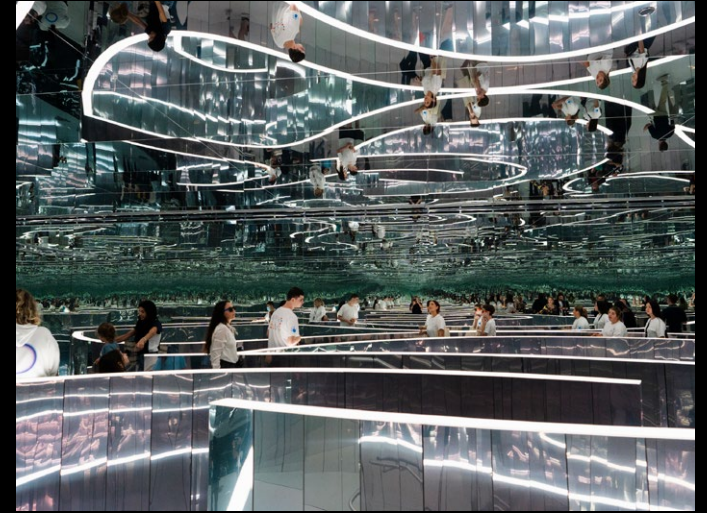



# SUPERBLUE MIAMI

## AUTISM DESIGNATION CEREMONY





