

**1 HERCULE ENC.**

- ① PIT SWITCH
- ② LANDING LIGHT SWITCH BY OTHER
- ④ PIT LIGHTING
- ⑤ LANDING LIGHT BY OTHER
- ⑩ PIT OUTLET GFCI
- ⑫ MAIN DISCONNECT
- ⑬ LIGHTING DISCONNECT
- ⑰ CALL STATION

**11 DISCONNECT (BY INSTALLER)**

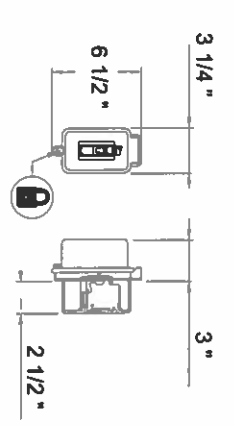

**NOTE**

1. HERCULES ENCLOSER. PLATFORM.
2. INSTALL 1 LIGHTING FIXTURE AND SWITCH AT EACH LANDING, AS NEAR AS POSSIBLE TO THE LANDING DOOR (OUTSIDE THE SHAFT). ② ⑤
3. BRING A 120VAC 20A/1Ø/1N/1GND (1 BLACK+1 WHITE/NEUTRAL)+1 GND) LEAD WIRES FOR THE MOTOR 24VDC WITH BATTERIES BACKUP, ROUTE FROM THE BREAKER PANEL TO THE MAIN DISCONNECT (BY ELECTRICIAN) ⑫ ⑬
4. PROVIDE ALSO ONE WIRE AT THE SAME PLACE, FROM THE BUILDING BREAKER PANNEL, ROUT ONE 120 VAC 15A (BY ELECTRICIAN) FOR PIT LIGHTING AND GFCI OUTLET (SUPPLIED BY ATLAS) ① ④ ⑩
5. TELEPHONE JACK PRIORITY FOR BILATERAL COMMUNICATIONS\_HARD WIRE (OPTION)
6. PREPARE A 3" PIT TO THE SAME INTERIOR DIMENSIONS AS THE ELEVATOR SHAFT. THE PIT SHOULD MINIMALLY BE MADE OF 25MPa REINFORCED CONCRETE WITH 5% TO 8% AIR ENTRAINMENT (6X6, #9 WIRE MESH) OR OTHER ALTERNATIVE CONSTRUCTION APPROVED BY BUILDING'S STRUCTURAL ENGINEER
7. ALL WORK AND MATERIALS MUST COMPLY TO LOCAL LAWS AND REGULATIONS.
8. CHECK WITH ARCHITECT IF AUTOMATIC DOOR OPENERS ARE REQUIRED ON LOCATION.
9. ONLY PORTIONS OF NFPA 70 SPECIFIED INTO A18.1 IS APPLICABLE TO THE ELEVATOR FURNITURE (SEE A18.1 TABLE 1.5-1). THE GENERAL CONTRACTOR AND ELECTRICIAN MUST FOLLOW NFPA70 REQUIREMENTS WHEN INSTALLING THE LIFT.



**AMERIGLIDE**  
 5110 Atlantic Ave,  
 Raleigh, NC 27616  
 Tel:1 (800) 790-1635

**Ameriglide**  
 Accessibility  
 Solutions

**William Wivell**  
 Hagerstown, MD

No DRAWING: **HERCULES-36X54** Rev **1**

Drafter: **C. Bonneau** Date: **09-04-2024** Status: **APPROVAL** 1/6

REF: 4531-YB-A-240819

[www.ameriglide.com](http://www.ameriglide.com)

AMERIGLIDE IS NOT RESPONSIBLE FOR THE STRUCTURAL DESIGN OF THE BUILDING AND ITS ABILITY TO SUPPORT THE ELEVATOR LOADS AND OR REACTIONS

ALL DRAWINGS ARE THE INTELLECTUAL PROPERTY OF AMERIGLIDE AND CANNOT BE COPIED OR MODIFIED WITHOUT PERMISSION

REV	X	CB	Approval	08-19-2024
BY			DESCRIPTION:	DATE:

Code: **B-355 A18.1**  
 A18.1 SECTION 2  
 GUARD PANEL: **42" HEIGHT**  
 SAFETY: **± 1/16"**

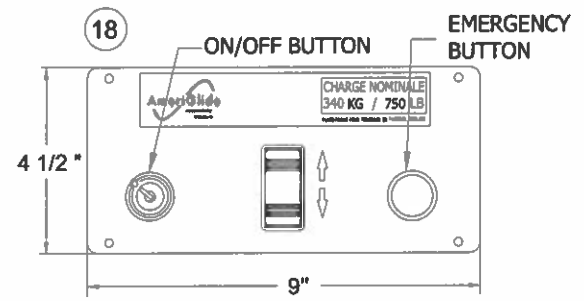

**3 CONTROL PANEL**

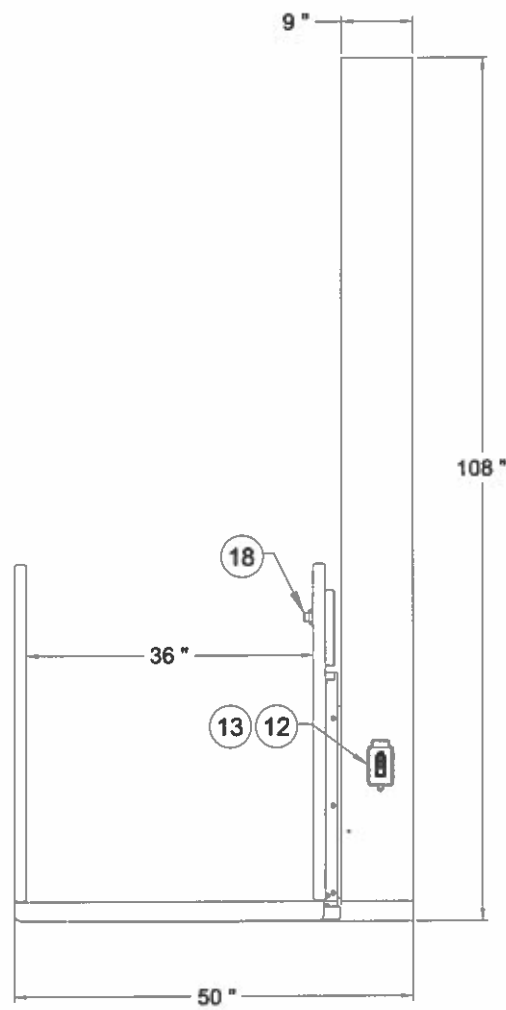
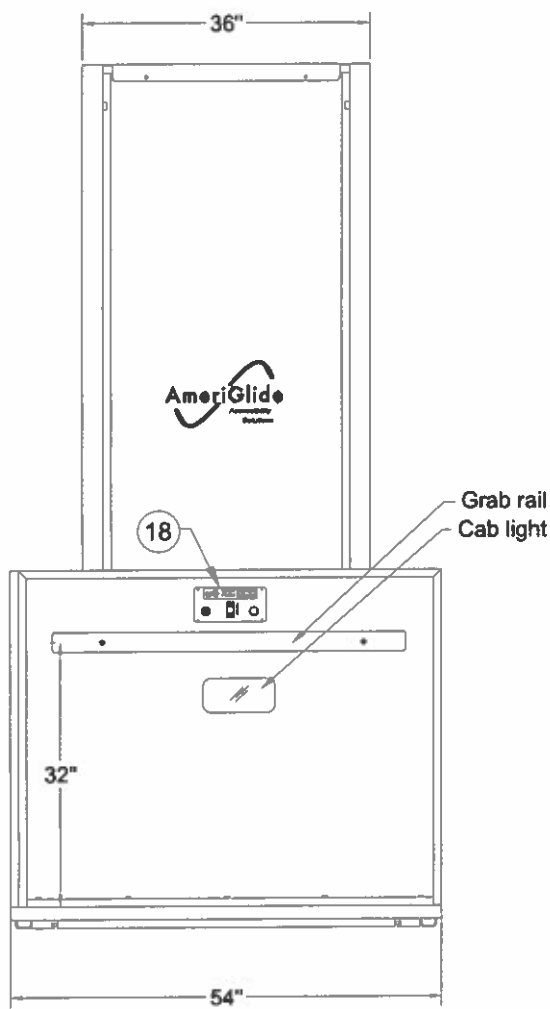

**2 PLATFORM ELEVATING WITHOUT ENCLOSURE**

**NOTE**  
 1. ALL WORK AND MATERIALS MUST COMPLY TO LOCAL LAWS AND REGULATIONS.  
 2. INSTALL IN ACCORDANCE WITH A117.1 2009  
 3. INSTALL IN ACCORDANCE NFPA70  
 4. THIS VERTICAL PLATFORM LIFT IS DESIGNED AND BUILT BY AMERIGLIDE IN ACCORDANCE WITH THE FOLLOWINGS CODES:  
 -A18.1 2014 (SEE A18.1 TABLE 1.5-1).  
 -A117.1 2009  
 -NFPA 70 2017

- 12 MAIN DISCONNECT
- 13 LIGHTING DISCONNECT
- 18 CONTROL PANEL / CAB

**AmeriGlide**  
 Accessibility Solutions  
 AMERIGLIDE  
 5110 Atlantic Ave,  
 Raleigh, NC 27616  
 Tel:1 (800) 790-1635

<a href="http://www.ameriglide.com">www.ameriglide.com</a>		REF: 4531-YB-A-240819	Code: B-355 A18.1 A18.1 SECTION 2	<b>William Wivell</b> Hagerstown, MD	
AMERIGLIDE IS NOT RESPONSIBLE FOR THE STRUCTURAL DESIGN OF THE BUILDING AND ITS ABILITY TO SUPPORT THE ELEVATOR LOADS AND OR REACTIONS		ALL DRAWINGS ARE THE INTELLECTUAL PROPERTY OF AMERIGLIDE AND CANNOT BE COPIED OR MODIFIED WITHOUT PERMISSION	GUARD PANEL: 42" HEIGHT	No DRAWING: HERCULES-36X54	Rev 1
X	CB	Approval	08-19-2024	SAFETY: ± 1/16"	Drafter: C. Bonneau Date: 09-04-2024 Status: APPROVAL 2/6
REV	BY	DESCRIPTION:	DATE:		

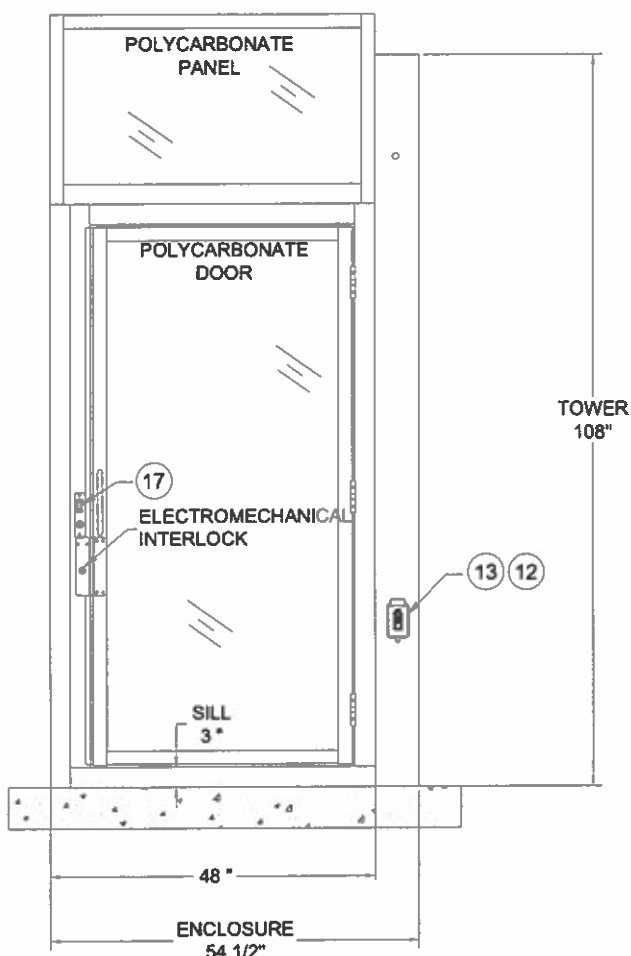

**4** DETAIL A  
LEVEL 1

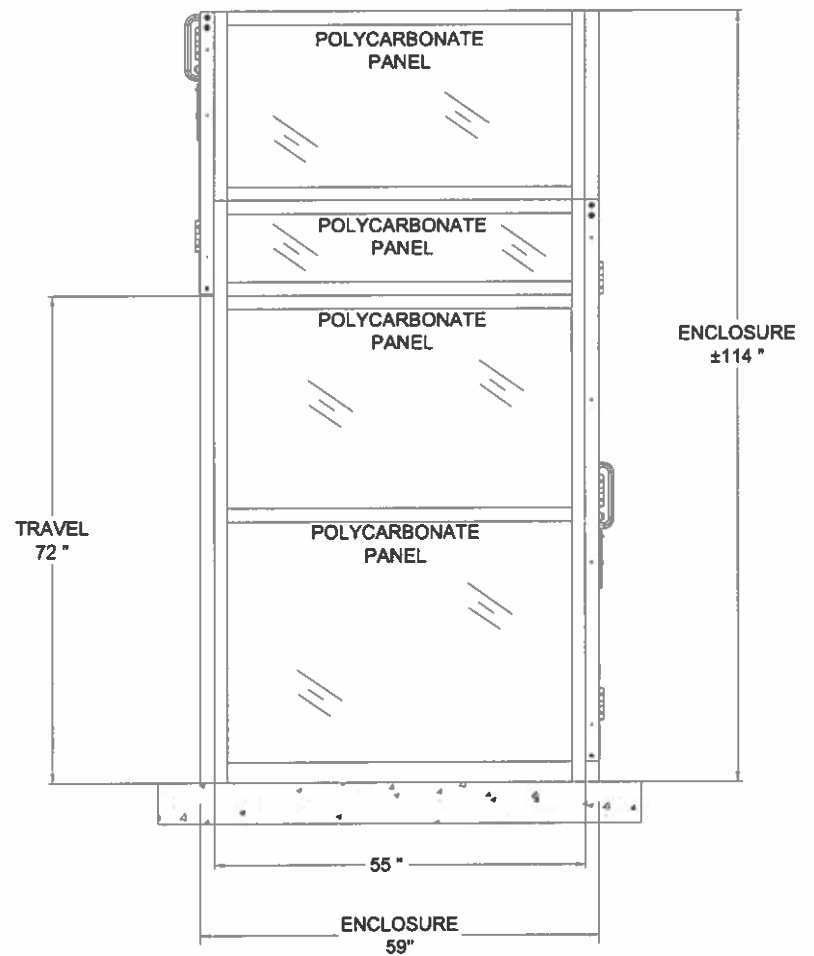

**5** DETAIL B

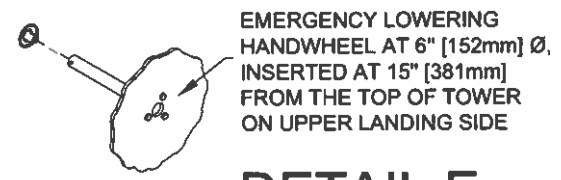

**8** DETAIL E

EMERGENCY LOWERING  
HANDWHEEL AT 6" [152mm] Ø,  
INSERTED AT 15" [381mm]  
FROM THE TOP OF TOWER  
ON UPPER LANDING SIDE

PROTECTION WALL. SMOOTH SURFACE  
WITHOUT RECESSES OR  
PROTRUSIONS.  
USE ALL AVAILABLE SPACE.  
(SEE DOCUMENT 08-01)  
(BY GENERAL CONTRACTOR)



**AmeriGlide**  
Accessibility  
Solutions

AMERIGLIDE  
5110 Atlantic Ave,  
Raleigh, NC 27616  
Tel: 1 (800) 790-1635

<a href="http://www.ameriglide.com">www.ameriglide.com</a>		REF: 4531-YB-A-240819		Code: B-355 A18.1 A18.1 SECTION 2		William Wivell Hagerstown, MD	
AMERIGLIDE IS NOT RESPONSIBLE FOR THE STRUCTURAL DESIGN OF THE BUILDING AND ITS ABILITY TO SUPPORT THE ELEVATOR LOADS AND OR REACTIONS		ALL DRAWINGS ARE THE INTELLECTUAL PROPERTY OF AMERIGLIDE AND CANNOT BE COPIED OR MODIFIED WITHOUT PERMISSION		GUARD PANEL: 42" HEIGHT		No DRAWING: <b>HERCULES-36X54</b>	
		X CB Approval		08-19-2024		SAFETY: ± 1/16"	
		REV BY DESCRIPTION:		DATE:		Drafter: C. Bonneau Date: 09-04-2024 Status: APPROVAL Rev 1	

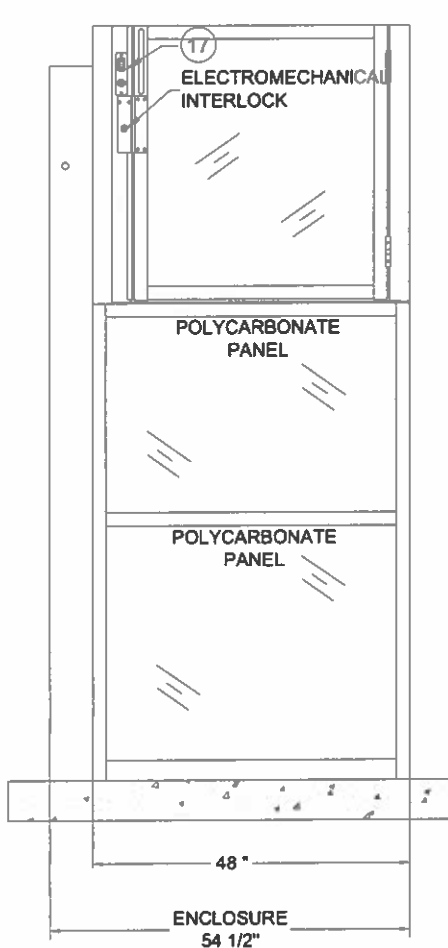

6 **DETAIL C**  
LEVEL 2

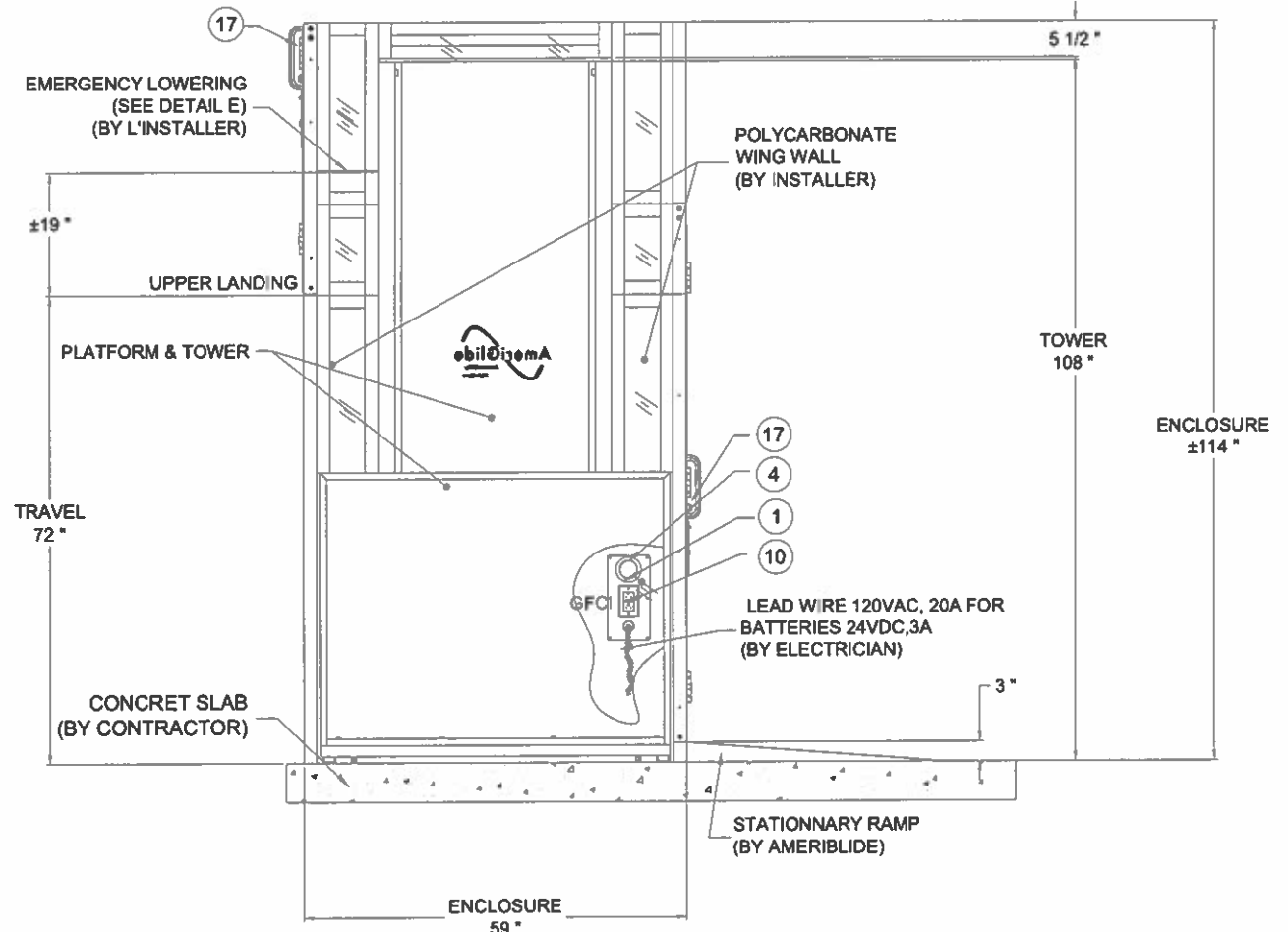

7 **DETAIL D**

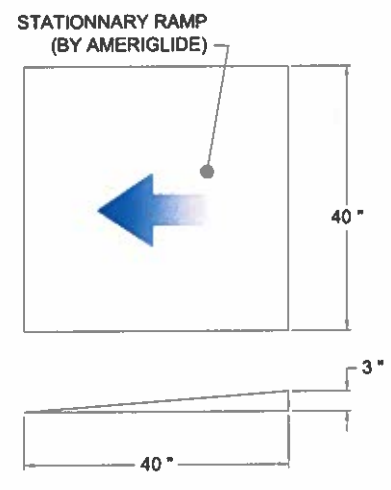

9 **STATIONNARY RAMP**



- 1 PIT SWITCH
- 4 PIT LIGHTING
- 10 PIT OUTLET GFCI
- 17 CALL STATION 2252 KEYED

**AmeriGlide**  
Accessibility Solutions

AMERIGLIDE  
5110 Atlantic Ave,  
Raleigh, NC 27616  
Tel:1 (800) 790-1635

<a href="http://www.ameriglide.com">www.ameriglide.com</a>		REF: 4531-YB-A-240819		Code: B-355 A18.1 A18.1 SECTION 2		William Wivell Hagerstown, MD									
AMERIGLIDE IS NOT RESPONSIBLE FOR THE STRUCTURAL DESIGN OF THE BUILDING AND ITS ABILITY TO SUPPORT THE ELEVATOR LOADS AND OR REACTIONS		ALL DRAWINGS ARE THE INTELLECTUAL PROPERTY OF AMERIGLIDE AND CANNOT BE COPIED OR MODIFIED WITHOUT PERMISSION		GUARD PANEL: 42" HEIGHT		No DRAWING: <b>HERCULES-36X54</b>									
		<table border="1"> <thead> <tr> <th>REV</th> <th>BY</th> <th>DESCRIPTION</th> <th>DATE</th> </tr> </thead> <tbody> <tr> <td>X</td> <td>CB</td> <td>Approval</td> <td>08-19-2024</td> </tr> </tbody> </table>		REV	BY	DESCRIPTION	DATE	X	CB	Approval	08-19-2024	SAFETY: ± 1/16"		Drafter: C. Bonneau Date: 09-04-2024 Status: APPROVAL Rev 1 4/6	
REV	BY	DESCRIPTION	DATE												
X	CB	Approval	08-19-2024												

VERTICAL LOADS	
TOWER	626 Lb
PLATFORM	280 Lb
ENCLOSURE	787 Lb
NOMINALE CHARGE	750 Lb
<b>TOTAL</b>	<b>2444 Lb</b>

**NOTE**

- FOLLOW A MINIMUM SAFETY FACTOR OF 5 ON ALL STRUCTURAL COMPONENTS
- THE INDICATED REACTIONS IS A COMBINATION OF THE NOMINAL PAYLOAD PLUS THE MASS OF ELEVATOR.
- THE SELF SUPPORTING LEGS CAN BE ELIMINATED IF A SUPPORTING WALL IS BUILT BEHIND THE TOWER OF THE LIFTING PLATFORM.
- ANCHORED THE PLATFORM WITH 108" HEIGHT TOWER OR MORE
- ANCHORED THE PLATFORM 1000Lb CAPACITY.
- THE ANCHORING STRUCTURE WILL BE APPROVED BY THE BUILDING'S STRUCTURAL ENGINEER.

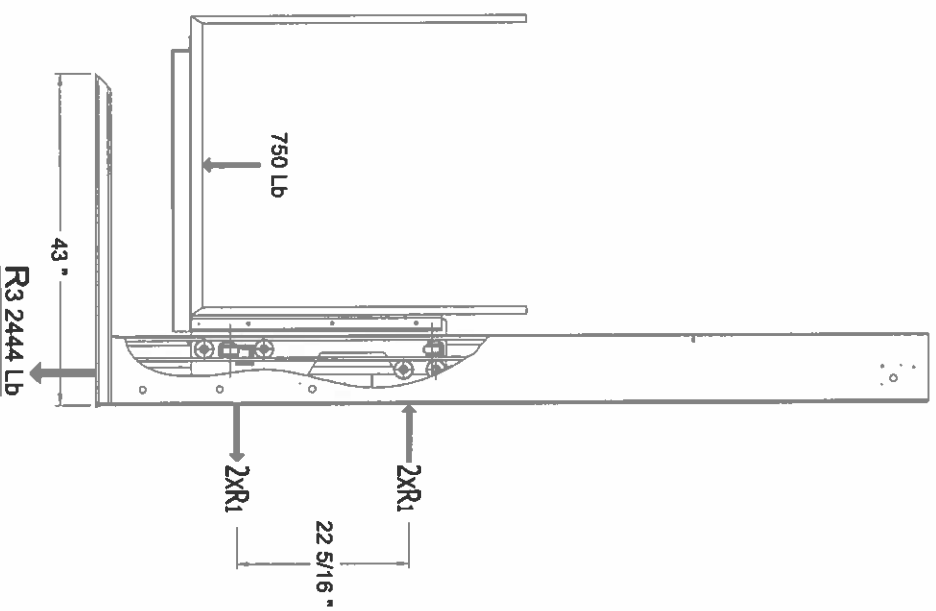
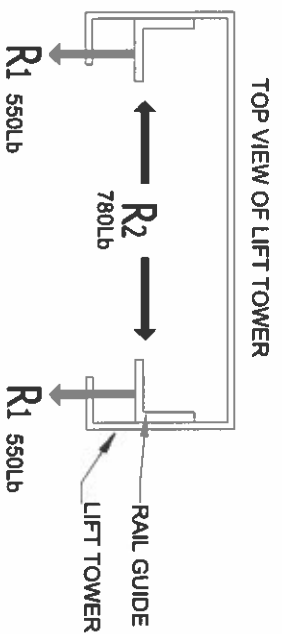
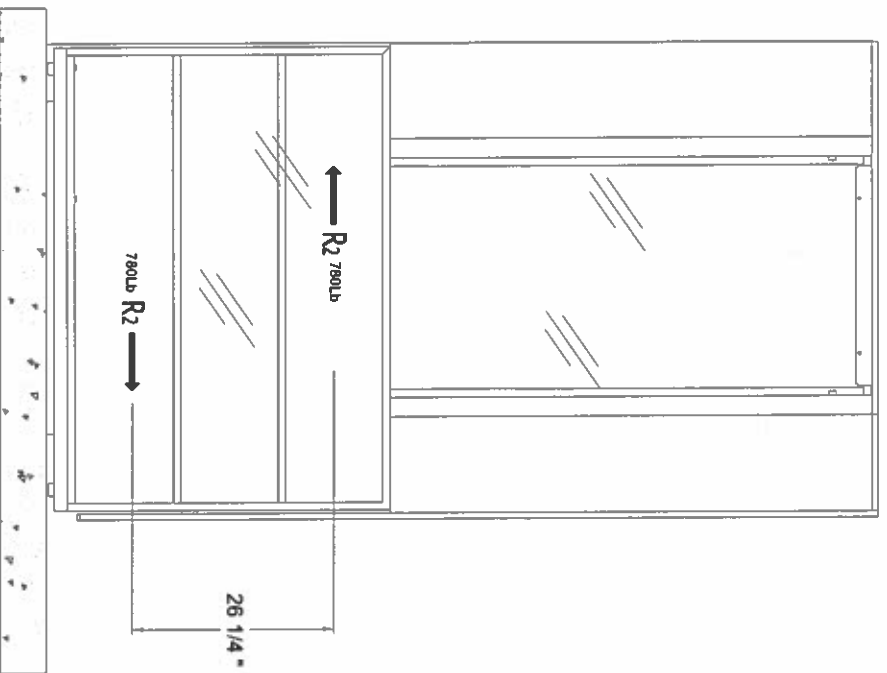

**LOAD ON FLOOR**

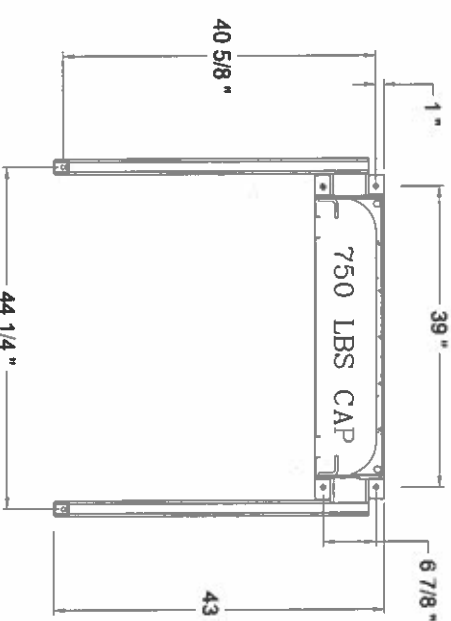

**SELF SUPPORTING**

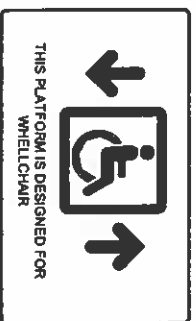

THIS PLATFORM IS DESIGNED FOR WHEELCHAIR

**10 RATED LOADS**

**AMERIGLIDE**  
 5110 Atlantic Ave,  
 Raleigh, NC 27616  
 Tel:1 (800) 790-1635

**AmeriGlide**  
 Accessibility  
 Solutions

[www.ameriglide.com](http://www.ameriglide.com)

REF: 4531-YB-A-240819

Code: B-355 A18.1  
 A18.1 SECTION 2

**William Wivell**  
 Hagerstown, MD

AMERIGLIDE IS NOT RESPONSIBLE FOR THE STRUCTURAL DESIGN OF THE BUILDING AND ITS ABILITY TO SUPPORT THE ELEVATOR LOADS AND OR REACTIONS

ALL DRAWINGS ARE THE INTELLECTUAL PROPERTY OF AMERIGLIDE AND CANNOT BE COPIED OR MODIFIED WITHOUT PERMISSION

REV	BY	DESCRIPTION:	DATE:
X	CB	Approval	08-19-2024

GUARD PANEL:  
 42" HEIGHT  
 SAFETY: ± 1/16"

No DRAWING:	Drafter:	Date:	Status:	Rev
<b>HERCULES-36X54</b>	C. Bonneau	09-04-2024	APPROVAL	1

## GENERAL SPECIFICATIONS

**MODEL:** HERCULE ENCLOSURE  
**CONFIGURATION:** 180 Right hand  
**PLATFORM SIZE:** 36"x 54"  
**APPLICATION:** Commercial  
**FINISH:** Painted steel beige Atlas (RAL 7047)  
**CAPACITY:** 750 Lb  
**CONTROL:** Constant pressure rocker switch with e-stop  
**POWER SOURCE:** 120V 60Hz, 20Amp circuit (Battery backup)  
**MOTOR:** 1 hp, 24VDC motor  
**DRIVE SYSTEM:** Acme screw  
**SPEED:** 0 at 8 pi/m  
**EXACT TRAVEL:** 72"  
**TOWER:** 108"  
**CONTROLLER:** NANO-R-Z2-24 (QAI/E10695)  
**SAFETY DEVICES:** -Limit switches at each stop  
 -Final limit switch at top  
 -Non-skid platform surface  
 -Obstruction sensing safety pan  
 -Acme safety nut with monitor  
 -Emergency manuel lowering  
 -Emergency audible alarm  
 -Electromechanical interlock  
 -Platform disconnect  
 -Cab operating device with manually ressetable alarm switch  
 -2252 Keyed  
 -Handrail & cab light  
**EQUIPMENTS:** -Full interieur polycarbonate Enclosure  
 -Right hinged polycarbonate door 38"  
 -Door frame mounted call station  
 -Right hinged polycarbonate gate 38"  
 -Gate frame mounted call-station  
 -(1) Door Closer  
 -(2) Call stations c/w monted post (wall mount) (surface mount)  
 -Wing walls with light & GFCI  
**SAFETY DESING STDS:** -ASME A18.1 section 2  
 -CSA B44.1 / ASME 17.5-elevator and escalator electrical equipment.  
 -ICC A117.1 accessible and usable buildings and facilities(section 410)  
 -Electrical number QAI: E10695



### NOTES:

- 1- Structural support by others. pad construction requirement may vary from state. dimensions given are atlas recommend clearances, reflecting running and access clearances. consult local authority to assure compliance with state and local codes.
- 2- Wall below top landing to be solid, smooth, plumb and square.
- 3- Any alterations to equipment without written authorization by atlas will void warranties.
- 4- Per ASME A18.1 the runway shall be guarded at the upper landing by door or gate at least 42" high of solid construction and provided with a combination mechanical lock and electric contact. the door shall be permitted to be opened only if the platform floor is withing 2"(50mm)of that landing.



<a href="http://www.ameriglide.com">www.ameriglide.com</a>		REF: 4531-YB-A-240819	Code: B-355 A18.1 A18.1 SECTION 2	<b>William Wivell</b> Hagerstown, MD							
AMERIGLIDE IS NOT RESPONSIBLE FOR THE STRUCTURAL DESIGN OF THE BUILDING AND ITS ABILITY TO SUPPORT THE ELEVATOR LOADS AND OR REACTIONS ALL DRAWINGS ARE THE INTELLECTUAL PROPERTY OF AMERIGLIDE AND CANNOT BE COPIED OR MODIFIED WITHOUT PERMISSION			GUARD PANEL: 42" HEIGHT	No DRAWING: <b>HERCULES-36X54</b>	Rev <b>1</b>						
		<table border="1" style="width: 100%; border-collapse: collapse;"> <tr> <td style="text-align: center;">X</td> <td style="text-align: center;">CB</td> <td style="text-align: center;">Approval</td> <td style="text-align: center;">08-19-2024</td> </tr> <tr> <td style="text-align: center;">REV</td> <td style="text-align: center;">BY</td> <td style="text-align: center;">DESCRIPTION:</td> <td style="text-align: center;">DATE:</td> </tr> </table>	X	CB	Approval	08-19-2024	REV	BY	DESCRIPTION:	DATE:	SAFETY: ± 1/16"
X	CB	Approval	08-19-2024								
REV	BY	DESCRIPTION:	DATE:								



## AmeriGlide Distributing 2019 Terms and Conditions

### Acceptance

The contract shall consist only of our offer and your acceptance of the Order Form and these terms, nothing else shall form part of the contract and be binding on either you or us. It is our responsibility to supply you with goods that meet your consumer rights. Nothing in this contract affects your statutory rights. By accepting you acknowledge and agree to have read, understood and agreed to be legally bound to the terms and conditions set out below. Unless otherwise stated, you agree to pay as follows: **100% payment upon signed acceptance.**

### Payment

- Payment to be made by check or ACH bank transfer only unless otherwise noted.
- If credit card payment is requested and accepted a 3% service charge will be added to the invoice.
- Overdue Invoice: A service charge of 18% annually shall apply to overdue accounts past thirty (30) days.
- If you do not pay within sixty (60) days from the billing date we may choose to do one of the following:
  - 1) suspend all work until the amount has been paid, or
  - 2) declare all sums for the unexpired term of this agreement due immediately and terminate this agreement. This will void warranty and technical support.

### Cancellation Charges

The following are charges that will be applicable during the production process of items purchased.

25% of purchase value	Completion of engineering drawings
50% of purchase value	Once equipment enters production
80% of purchase value	Once production is 50% complete
100% of purchase value	Once production is 100% complete

**Note:** that once production of purchased equipment has been completed, the product is non refundable. Products are custom built and cannot be returned once completed.

### Specific Terms and Conditions

#### 1. Responsibility of Purchaser

- a. Purchaser is responsible for checking the product for damages upon its arrival. Once delivery has been accepted, the purchaser accepts responsibility for the condition of the product.
- b. Purchaser is responsible for unloading delivery. Delivery to a job site requires the customer to have a forklift available, or it must be picked up at a local terminal. In some cases, not all customers can purchase forklift delivery.
- c. In the event that the customer requests a change in the delivery address after the product has been shipped from the manufacturer, a minimum fee of \$695 will be assessed to cover the associated administrative and logistical expenses incurred by the seller.
- d. Purchaser is responsible for all local and state guidelines. This includes and is not limited to permitting, inspection, installation and operation of AmeriGlide products.
- e. The purchaser shall be responsible for obtaining all the relevant pre-construction and post-construction permits to be availed by the purchaser as mandated by applicable laws and policy guidelines for work of this nature. The Purchaser shall maintain and, to the extent applicable renew such permits. AmeriGlide is responsible for providing the product.

**2. Terms and Conditions of Sale**

- a. In consideration of AmeriGlide Distributing 2019 performing the services herein specified, you expressly agree to indemnify, defend, save harmless, discharge, release and forever acquit AmeriGlide Distributing 2019, our officers, our employees from and against any and all claims, demands, suits, and proceedings brought against us or our employees of any nature whatsoever, including but not limited to loss, damage, injury or death that are alleged to have arisen from or alleged to be in connection with misuse, maintenance, operation or condition of the equipment covered by this agreement.
- b. Typical lead time for delivery can vary based on product.
- c. Production lead time begins upon receipt of signed approval drawings and execution of contract terms.
- d. A **maximum of 2** engineered drawing revisions are included in this contract price. Subsequent revisions are chargeable at \$245 per change request.
- e. Change orders must be communicated with a signed change order request document approved by both parties and may be subject to additional cost(s).
- f. **Storage fees:** Equipment may be stored for up to 10 business days after the requested equipment delivery date at no charge. Additional storage is available at \$50/day.
- g. Quotes are valid for 7 business days from the date of issue, quotes older than 7 business days may be subject to repricing.
- h. Installation must be completed within 1 year of contract acceptance or price increase may result.
- i. **Attorney Fees.** In the event that there is any controversy or claim arising out of or relating to this Agreement, or to the interpretation, breach or enforcement thereof, and any action or proceeding is commenced to enforce the provisions of this Agreement, the prevailing party shall be entitled to a reasonable attorney's fee, costs and expenses.
- j. Any overdue invoice past 60 days will void the warranty. Interest will be applied.
- k. We reserve the right to deny turn-over of equipment until the complete payment has been received.
- l. Warranty is valid for two (2) years on all parts from the date of shipping.
- m. Installation must be completed by a trained licensed professional. Failure to have a trained licensed professional may result in voiding all warranties.
- n. **Any third party installation** (Installation completed by anyone other than an AmeriGlide Distributing 2019 or their agent and paid separately from this contract) comes with a one hour of free technical service. Each call will be counted as a minimum 15 min call. All technical service calls after the included hour will be billed at \$200 per hour with a minimum call / charge of \$50.00 for 15 mins. This does not include the initial hold time and must be paid in advance on a valid credit card. All technical service call fee's are non refundable.
- o. **Any third party installation** (as indicated above) revokes any right to sue for component breakage, injury related to use, or damage related to other third parties in the form of prejudice or delays in the face of malfunctions of the product or improper installation by that third party.
- p. **Ownership Clause:** Until the product is fully paid, the product shall remain the property of AmeriGlide Distributing 2019 ("AmeriGlide"). In the event that the full payment is not received in accordance with the agreed terms, AmeriGlide reserves the right to retake possession of the product without further notice. The customer acknowledges and agrees that AmeriGlide has a security interest in the product until full payment is received.

**By signing this agreement, the customer agrees to drawings detailed in previous pages and acknowledges and agrees to the above mentioned terms.**

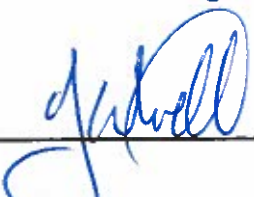
Purchaser Signature:  Date: 9/10/24  
Printed Name: WILLIAM WIVELL Title: BUSINESS MANAGER