

MODELS	24 GA EXT	27 GA EXT	27 GA EXT
CLOPAY	4400, 4401	4300, 4301, HDG, HDGF	4310, HDGL
HOLMES	---	66, 66G, 68, 68G	67, 67G
IDEAL	---	SP20, SF20	SE20
	SHORT PANEL / FLUSH		LONG PANEL

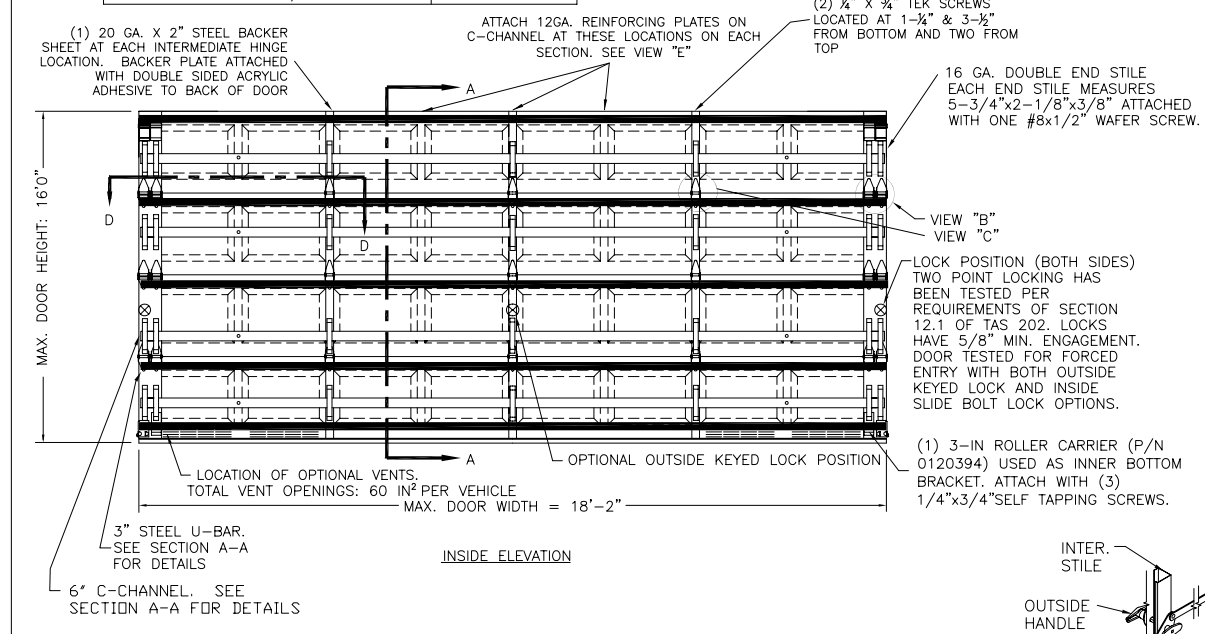

INSTALLER MODEL	RETAIL HDGL	DESCRIPTION
4300/SP200	HDGL 66, 66G	27 GA. EXT. SKIN; SHORT RAISED PANEL
4400	N/A	24 GA. EXT. SKIN; SHORT RAISED PANEL
4401	N/A	24 GA. EXT. SKIN; FLUSH PANEL
4301/SF200	HDGF, 69, 68G	27 GA. EXT. SKIN; FLUSH PANEL
4310/SE200	HDGL, 67, 67G	27 GA. EXT. SKIN; WIDE RAISED PANEL

TABLE 1

DOOR HEIGHT	NUMBER OF SECTIONS*
6'0" TO 7'0"	4
7'6" TO 8'9"	5
9'0" TO 10'6"	6
10'9" TO 12'3"	7
12'6" TO 14'0"	8
14'3" TO 15'9"	9
16'0"	10

* SECTION ARE EITHER 18" OR 21" HIGH

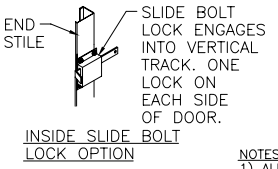
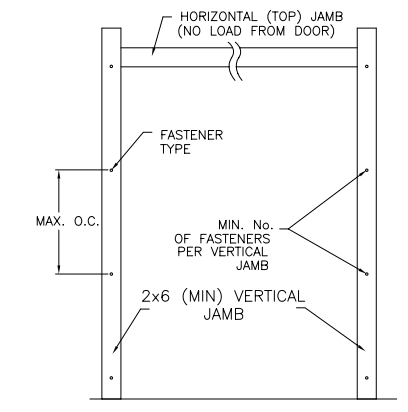

NOTES:
 1) ALL THE LOAD FROM THE DOOR IS TRANSFERRED TO THE TRACK AND THEN FROM THE TRACK TO THE 2x6 VERTICAL YELLOW PINE (GRADE #2 OR BETTER) JAMBS. NO LOAD FROM THE DOOR IS TRANSFERRED TO THE HORIZONTAL (TOP) JAMB.
 2) ALL JAMB FASTENERS MAY BE (BUT NOT REQUIRED) COUNTERSUNK TO PROVIDE A FLUSH MOUNTING SURFACE.

WOOD FRAME BUILDINGS

STUD WALLS OF DOOR OPENING SHALL BE FRAMED SOLID BY NOT LESS THAN (3) 2x6 PRESSURE TREATED SYP OR BETTER GRADE #2 OR BETTER WOOD STUDS OF A STRESS GRADE NOT LESS THAN 1200 PSI NOMINAL EXTREME FIBER STRESS IN BENDING (F_b). STUD WALLS TO BE CONTINUOUS FROM FOOTING TO TIE BEAMS.

C-90 BLOCK WALL, 2,000 OR 3,000 PSI MIN. CONCRETE

2x6 WOOD JAMB SHALL BE ANCHORED TO GROUT REINFORCED BLOCK WALL OR CONCRETE COLUMN. BLOCK WALL CELLS SHALL BE FILLED WITH CONCRETE AND REINFORCED WITH REINFORCING BARS EXTENDING INTO THE FOOTING AND INTO TIE BEAMS. ALL BARS SHALL BE CONTINUOUS FROM THE TIE BEAMS TO FOOTING PER BLOCK WALL OR CONCRETE COLUMN. BLOCK WALLS AND CONCRETE COLUMNS TO BE DESIGNED BY THE BUILDING ENGINEER OR ARCHITECT OF RECORD.

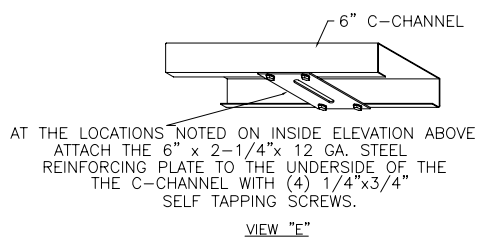
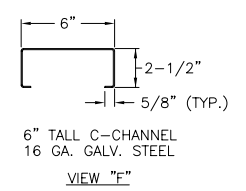
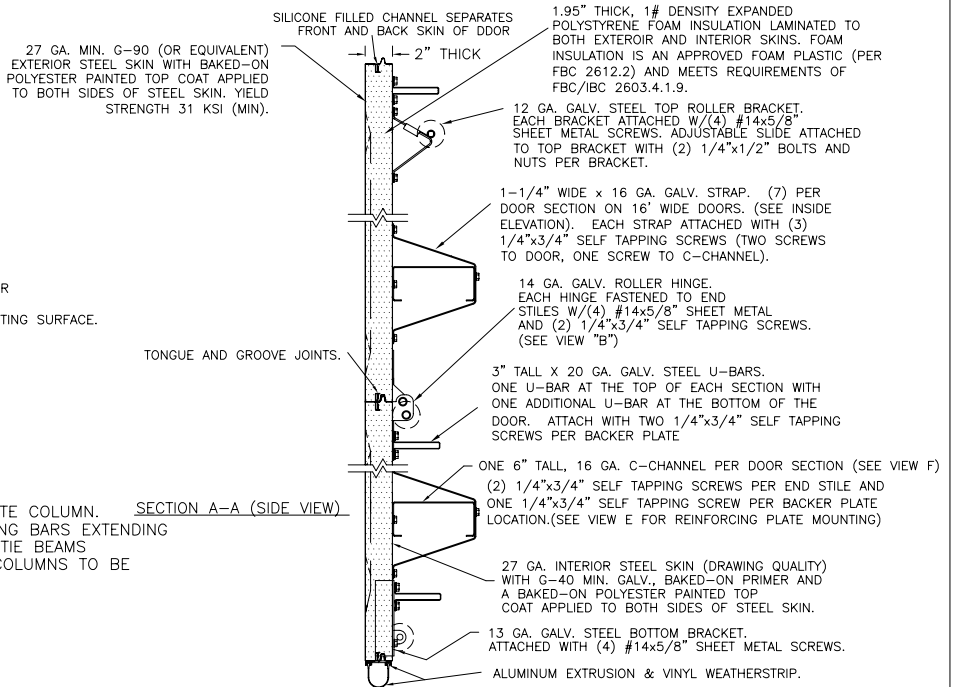

2x6 JAMB TO SUPPORTING STRUCTURE ATTACHMENT

BUILDING TYPE	FASTENER TYPE	MAXIMUM * ON CENTER DISTANCE BETWEEN FASTENERS	STEEL WASHERS REQUIRED?
GROUT-FILLED CMU BLOCK	1/4" x 3" (1-1/4" EMBED) SELF TAPPING CONCRETE ANCHOR (2-1/2" MIN. EDGE DISTANCE)	4"	1" O.D.
2,000 PSI MIN. CONCRETE	1/4" x 3" (1-1/2" EMBED) SELF TAPPING CONCRETE ANCHOR (2-1/2" MIN. EDGE DISTANCE)	8"	1" O.D.
3,000 PSI MIN. CONCRETE	1/4" x 3" (1-1/2" EMBED) SELF TAPPING CONCRETE ANCHOR (2-1/2" MIN. EDGE DISTANCE)	11"	1" O.D.
SYP WOOD FRAME	3/8" x 3" (1-1/2" EMBED) LAG SCREW (1-1/2" MIN. EDGE DISTANCE)	16"	1-1/8" O.D.
2,000 PSI MIN. CONCRETE	1/2" x 3" (1-1/2" EMBED) SLEEVE ANCHOR (3" MIN. EDGE DISTANCE)	9-1/2"	INCLUDED

* - FIRST ANCHOR/SCREW STARTING FROM BOTTOM AT NO MORE THAN HALF OF MAXIMUM ON CENTER DISTANCE. HIGHEST ANCHOR/SCREW INSTALLED AT LEAST AS HIGH AS THE DOOR OPENING HEIGHT
 #- ANCHORS CAN BE INSTALLED DIRECTLY THROUGH TAPERED TRACK ANGLE IN LIEU OF 5/6 x 1-5/8 LAG SCREWS

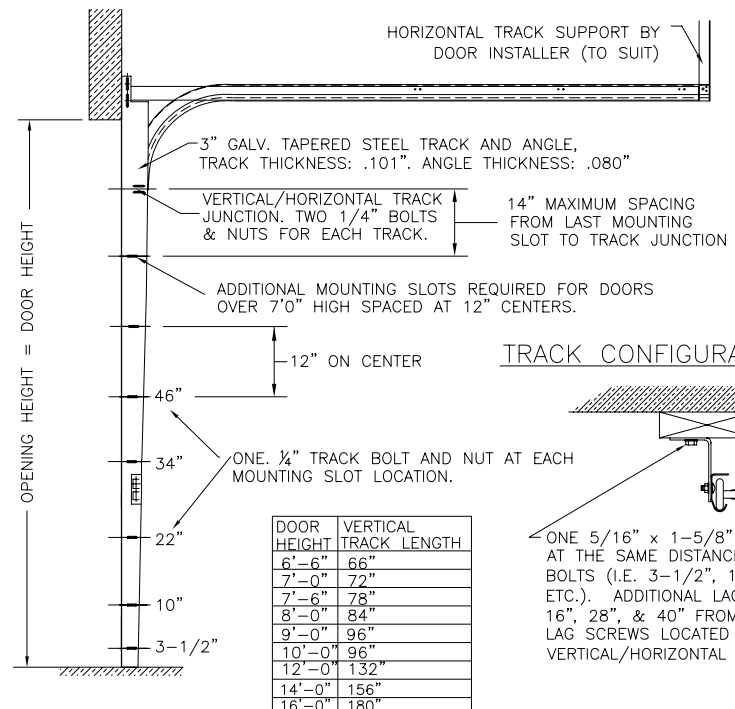

DOOR HEIGHT	VERTICAL TRACK LENGTH
6'-6"	66"
7'-0"	72"
7'-6"	78"
8'-0"	84"
9'-0"	96"
10'-0"	102"
12'-0"	132"
14'-0"	156"
16'-0"	180"

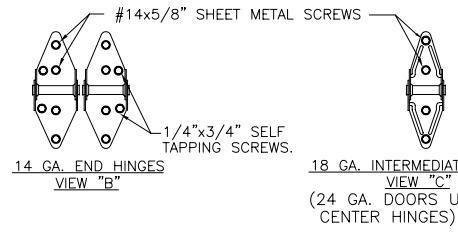
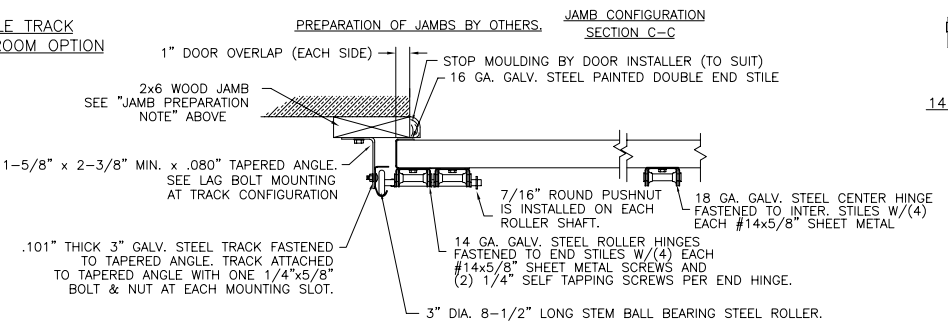
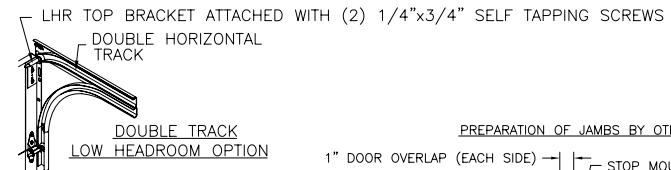

NOTE: SUPPORTING STRUCTURAL ELEMENTS SHALL BE DESIGNED BY A REGISTERED PROFESSIONAL ENGINEER FOR WIND LOADS SHOWN ON THIS DRAWING.

THIS DOOR MEETS THE REQUIREMENTS OF THE LARGE MISSILE IMPACT AND CYCLIC TESTING.

THIS DOOR MEETS OR EXCEEDS THE DESIGN LOADS FOR THE WIND SPEEDS LISTED BELOW ACCORDING TO THE FLORIDA BLDG. CODE OR IBC (ASCE7) FOR THE FOLLOWING CONDITIONS: 1) ENCLOSED BUILDING, 2) DOOR HAS 2' OF WIDTH IN BUILDING'S END ZONE, 3) IMPORTANCE FACTOR OF 1.0, 4) ANY ROOF SLOPE, AND 5) 50% SAFETY FACTOR.

WIND SPEED (MPH)	140	146	150	150
EXPOSURE LEVEL	B or C	C	B	C
MEAN ROOF HEIGHT	30'	28'	30'	20'

DESIGN ENGINEER
 MARK W. WESTERFIELD, P.E.
 FLORIDA P.E. #48495, NC P.E. #23832, TEXAS P.E. #91513

DESIGN LOADS: +46 PSF & -50.0 PSF
 TEST LOADS: +69 PSF & -75 PSF



TOLERANCES
 .00 = ±.03
 .000 = ±.015
 .0000 = ±.007
 Degrees = ±1/2"

CLOPAY BUILDING PRODUCTS
 8585 DUKE BLVD.
 MASON, OHIO 45040
 (513) 770-4800

PAGE: 1 OF 1	CLOPAY WINDLOAD RATING: W8	MAX. SIZE: 18'2"W x 16'0"H
DATE: 10/13/03	DESCRIPTION: M/N 4300/01/10, 4400/01, HDG/L/F, 66/7/8/G	
DRAWN BY: RJK	DRAWING NUMBER: B 103028	VER: IBC
MANUFACTURING PRODUCT CODE: MPC: DSIE-1F171		