

INSTALLATION NOTES:

- ADJUSTABLE STORM PANEL AND COMBO WINDOW KIT. PATENTED, U.S. PATENT NO. 5,504,018 , PATENT PENDING.
- THESE " INNOVATIVE NEW PRODUCT" EVALUATION DOCUMENTS REPRESENT A SHUTTER KIT AND GLASS WINDOW SYSTEM DESIGNED AND TESTED AS A LARGE MISSILE IMPACT PROTECTIVE SYSTEM IN ACCORDANCE WITH THE INTERNATIONAL BUILDING CODE, (I.B.C.) AND THE FLORIDA BUILDING CODE 2007. "CANNOT BE USED IN HIGH VELOCITY HURRICANE ZONES".
- THIS COMBO WINDOW SHUTTER KIT HAS PASSED TESTING FOR ASTM-E 330 "UNIFORM STATIC AIR PRESSURE DIFFERENCE", ASTM- E 1996-05 "IMPACTED BY WINDBORNE DEBRIS" AND ASTM 1886-05 "IMPACTED BY MISSILES AND CYCLIC PRESSURE
- GLASS THICKNESS BASED ON ASTM E 1300 - GLASS CALCULATIONS CHART, GLASS SPECIFICATIONS CAN VARY DEPENDING ON SIZE OF GLAZED LITE AND OR LOAD. TESTING HAS SHOWN THAT 1/4" ANNEALED GLASS DOES NOT BREAK ON IMPACT.
- UNIVERSAL "U" (0.090") KIT HEADER & (0.110") "F" TRACK KIT SILL.
- COMBO WINDOW HEADER & SILL FASTENERS SHALL BE :
  - 2X WOOD FRAME (FIN): #10 WOOD SCREWS OR BETTER WITH A MINIMUM 1 1/2" EMBEDMENT
  - CONCRETE (FLANGE): 1/4" TAPCON SCREWS OR BETTER WITH A MINIMUM 1 1/4" EMBEDMENT
- THE MINIMUM PANEL LENGTH IS 18" (POROSITY LIMITATIONS).
- ANCHORS SHALL BE INSTALLED IN ACCORDANCE WITH MANUFACTURERS' RECOMMENDATIONS.
- ALL ALUMINUM EXTRUSIONS ARE ALLOY 6063-T5 WITH TYPICAL WALL THICKNESS OF 0.100".
- USE HIGH QUALITY CAULK BEHIND KIT'S HEADER AND SILL, OSI. OR EQUIVLANT.
- THE RESPONSIBILITY FOR SELECTION OF THESE PRODUCTS TO MEET ANY APPLICABLE LOCAL LAWS, BUILDING CODES, ORDINANCES OR OTHER SAFETY REQUIREMENTS RESTS SOLELY WITH THE ARCHITECT, BUILDER, OWNER OR CONTRACTOR.
- THESE PRODUCT EVALUATION DOCUMENTS ARE VALID WHEN DATED & EMBOSSED SEALED AND OR A MASTER APPROVAL DOCUMENT IS ON FILE WITH A MUNICIPALITY OR OTHER GOVERNING AGENCY.
- THESE PRODUCT EVALUATION DOCUMENTS ARE SUITABLE TO BE APPLIED BY THE CONTRACTOR PROVIDED THE CONTRACTOR DOES NOT DEVIATE FROM THE CONDITIONS DETAILED HEREIN AND THE CONTRACTOR VERIFIES THE EXISTING STRUCTURE IS CAPABLE OF SUPPORTING THE SUPERIMPOSED LOADS.
- ALTERATIONS OR ADDITIONS TO THIS DOCUMENT ARE NOT PERMITTED.
- WHEN THE SITE CONDITIONS DEVIATE FROM THESE PRODUCT EVALUATION DOCUMENTS, SITE SPECIFIC DOCUMENTS SHALL BE PREPARED BY A DULY LICENSED AND REGISTERED ENGINEER OR ARCHITECT.
- A MINIMUM OF ONE LABEL PER OPENING OR A CERTIFICATE OF COMPLIANCE SHALL BE PROVIDED BY THE MANUFACTURER OR INSTALLER. WHERE LABELS ARE USED, THE LABEL SHALL READ AS REQUIRED BY THE QUALITY ASSURANCE AGENCY AND NAME OF MANUFACTURER.
- STORM PANELS SHALL BE MARKED PATENTED, U.S. PATENT NO, 5,540,018. AND PATENT PENDING.
- STORM PANELS SHALL BE 22/24 GUAGE STEEL CONFORMING TO ASTM A653 SQ GRADE 40, G60 GALVANIZED COATING AND BE LIMITED TO 103" SPAN ON THIS ENGINEERING.
- PERMANENT FASTENER COMPONENTS MUST BE PROTECTED AGAINST CONTAMINATION & CORROSION.
- WHERE SCREWS FASTEN TO NARROW FACE OF STUD FRAMING, FASTENER SHALL BE LOCATED IN CENTER OF NOMINAL 2" X 4" (MIN.) WOOD STUD (MIN. G=0.55). 3/4" EDGE DISTANCE IS OR GREATER DENSITY. FASTENERS MAY HAVE PHILLIPS, PAN HEAD OR HEX HEAD. CONTRACTOR MUST VERIFY THAT WOOD BUCK CONNECTION TO SUBSTRATE IS SUFFICIENT
- EXISTING STRUCTURE MAY BE CONCRETE, HOLLOW BLOCK OR WOOD FRAMING.
- CONCRETE COMPRESSIVE STRENGTH = 3,000 PSI AT 28 DAYS CURING TIME.
- MINIMUM EDGE DISTANCE (E.D.) OF ANCHORS SHALL BE 1 1/4" , IN HOLLOW BLOCK OR CONCRETE.
- DETERMINE THE POSITIVE AND NEGATIVE DESIGN LOADS TO USE WHEN REFERENCING THESE DOCUMENTS IN ACCORDANCE WITH THE GOVERNING CODE AND GOVERNING WIND VELOCITY. FOR WIND LOAD CALCULATIONS IN ACCORDANCE WITH ASCE 7-98
- NO INCREASE IN ALLOWABLE STRESS HAS BEEN USED IN THE DESIGN OF THIS PRODUCT.
- REFERENCED TEST REPORTS BY NCTL. ARE THE PROPERTY OF DWS.

# DIVERSIFIED WINDOW SOLUTIONS, INC.

## FIN & FLANGE HEADER & SILL KIT

PANEL INSTALLATION NOTES:

- INSERT 3/4" HEX HEAD 1/4" #20 BOLTS INTO THE BOTTOM TRACK, ONE BOLT FOR EACH HOLE IN THE BOTTOM OF THE PANELS.
- INSTALL PANELS FROM THE LEFT SIDE OF THE WINDOW OR SLIDING GLASS DOOR OPENING TOWARDS THE RIGHT SIDE OF THE OPENING. THE NARROW EDGE OF THE PANEL IS ON THE LEFT AND THE WIDER SIDE OF THE PANEL WITH THE ELONGATION HOLE TO THE RIGHT SIDE.
- INSERT THE FIRST PANEL INTO THE UPPER "U" HEADER AND PLACE THE PREPUNCHED HOLES IN THE BOTTOM OF THE PANEL OVER THE BOLTS EXTENDING FROM THE BOTTOM "F" TRACK.
- INSTALL THE MOLDED WING NUTS ON THE LEFT BOLT AND ON THE CENTER BOLT, DO NOT TIGHTEN THE WING NUTS AT THIS TIME.
- INSTALL THE NEXT PANEL OVERLAPPING THE FIRST PANEL WITH THE NARROW SIDE OF THE SECOND PANEL OVERLAPPING THE WIDER RIGHT SIDE OF THE FIRST PANEL.
- ON THE SECOND PANEL, INSTALL THE MOLDED WING NUTS ON THE LEFT BOLT AND ON THE CENTER BOLT, DO NOT TIGHTEN THE WING NUTS AT THIS TIME.
- CONTINUE INSTALLING PANELS USING THIS METHOD UNTIL THE OPENING IS COVERED.
- WITH THE WING NUTS LOOSE, THE PANELS MAY BE ADJUSTED TO THE RIGHT OR LEFT AS NEEDED. ONCE THIS IS DONE, TIGHTEN ALL WING NUTS TO PROPERLY SECURE THE PANELS TO THE LOWER "F" TRACK.
- DO NOT STAND BEHIND WINDOWS DURING A STORM.

THE PANEL OVERLAP, SLIDE BOLT TRACK AND ELONGATED HOLE ALLOW PANEL WIDTH ADJUSTMENT

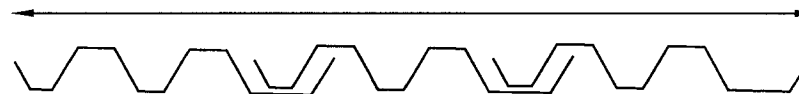

SIZE & CONFIGURATION	DESIGN PRESSURE	MISSILE IMPACT RATING
103" MAX. SPAN WIDTH	+60/-60 PSF	LARGE MISSILE IMPACT RATED

Diversified Window Solutions Inc. 2010 - LICENSOR OF WINDOW SYSTEMS AND HURRICANE SHUTTERS. "PATENTED, U.S. PATENT NO. 5,540,018" & PENDING

**Diversified Window Solutions, Inc.**  
 215 PINEDA STREET  
 UNIT 141  
 LONGWOOD, FL 32750  
 PH: 407-889-9440 FX:407-889-9193

**TITLE:** FIN & FLANGE HEADER & SILL KIT  
**GENERAL & INSTALLATION NOTES**  
**PREPARED BY:** GERTWORKS, LLC  
 127 W. FAIRBANKS AVE., STE. 438  
 WINTER PARK, FL 32789  
 PH: (407) 644-6957 FX: (407) 644-2366

REVISIONS	DESCRIPTION	BY	DATE
		NO.	

*[Handwritten Signature]*  
 11-15-10  
 KRISTINA S. DAUGHERTY, PE  
 FLORIDA P. E. NO. 68455  
 127 W FAIRBANKS AVE., STE 438  
 WINTER PARK, FL 32789  
 FBPE CERT. OF AUTHORIZATION NO. 28520

**DATE:** 11.05.10  
**DWN BY:** JLA  
**CHK BY:** HFN  
**SCALE:** NTS

**DWG #:** DWS001  
**SHEET:** 1 OF 7



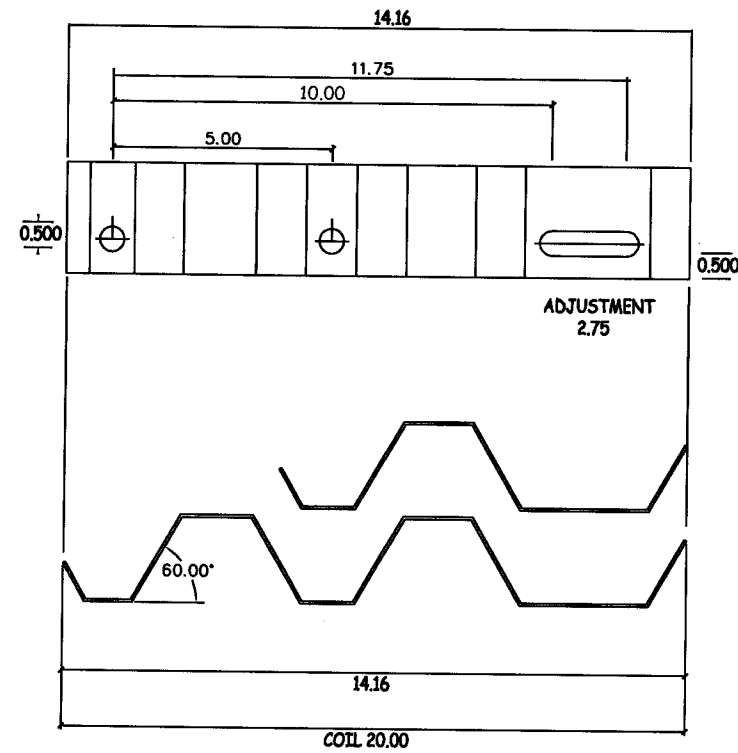
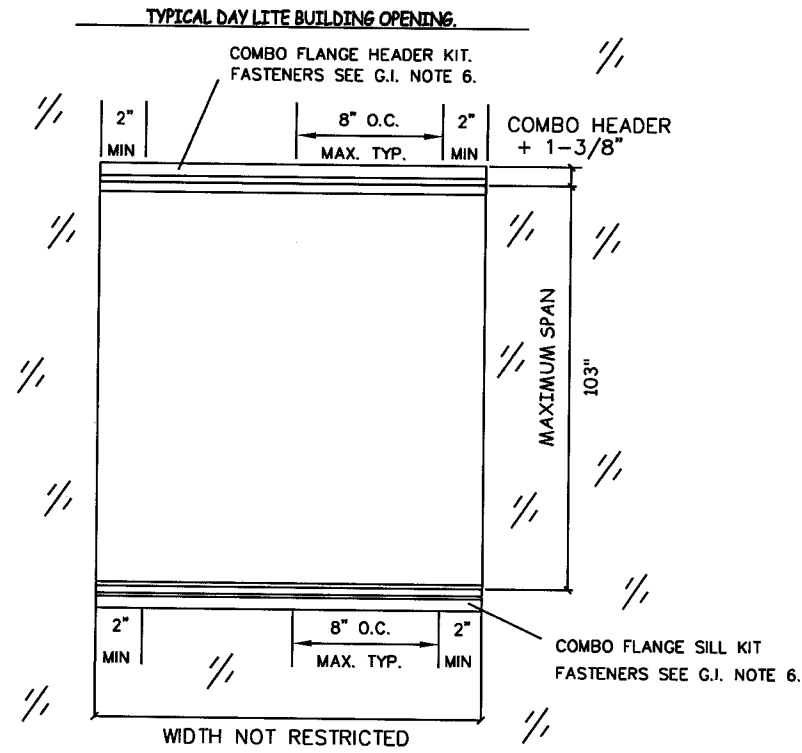

SHUTTER SOLUTIONS PATENTED AJUSTABLE STORM PANEL

Diversified Window Solutions Inc. 2010 - LICENSOR OF WINDOW SYSTEMS AND HURRICANE SHUTTERS. "PATENTED, U.S. PATENT NO. 5,540,018" & PENDING

**Diversified**  
Window Solutions, Inc.

215 PINEDA STREET  
UNIT 141  
LONGWOOD, FL 32750

PH: 407-889-9440 FX: 407-889-9193

**TITLE:** FIN & FLANGE  
HEADER & SILL KIT  
SHUTTER ELEVATION  
& DETAILS

**PREPARED BY:**  
CERTWORKS, LLC  
127 W. FAIRBANKS AVE., STE. 438  
WINTER PARK, FL 32789  
PH: (407) 644-6957 FX: (407) 644-2366

REVISIONS		
NO.	DESCRIPTION	BY DATE

*Kristina S. Daugherty*  
NO. 11-5-10  
STATE OF FLORIDA  
KRYSTINA S. DAUGHERTY, R.E.  
FLORIDA P.E. NO. 58456  
127 W FAIRBANKS AVE., STE 438  
WINTER PARK, FL 32789  
FBPE CERT. OF AUTHORIZATION NO. 28520

**DATE:** 11.05.10  
**DWN BY:** JLA  
**CHK BY:** HFN  
**SCALE:** NTS

**DWG #:**  
**DWS001**

**SHEET:** 3 OF 7

FLANGE WINDOW KIT AND WINDOW OR LITE  
COMBO FLANGE KIT HEADER AND SILL

- A. WINDOW HEIGHT + 3.0" = MASONRY HEIGHT
- B. A MASONRY OPENING WIDTH AND HEIGHT SHOULD BE 0.25" OR (1/4") WIDER AND HIGHER THAN THE WINDOW KIT SIZE. DO NOT MAKE THE OPENING SIZE GREATER THAN 0.50" (BLOCKING WILL THEN BE REQUIRED).
- C. MEASURE WINDOW OPENING FOR SIZE AND TO BE SURE WINDOW OPENING IS PLUMB, SQUARE, LEVEL AND TRUE.
- D. FOLLOW INSTRUCTIONS ON WINDOW FOR PROPER WINDOW INSTALLATION.
- E. CENTER OF BOLT TRACK TO HEADER + (0.50) = PANEL LENGTH

**CONCRETE/MASONRY**  
**EXISTING CONSTRUCTION**

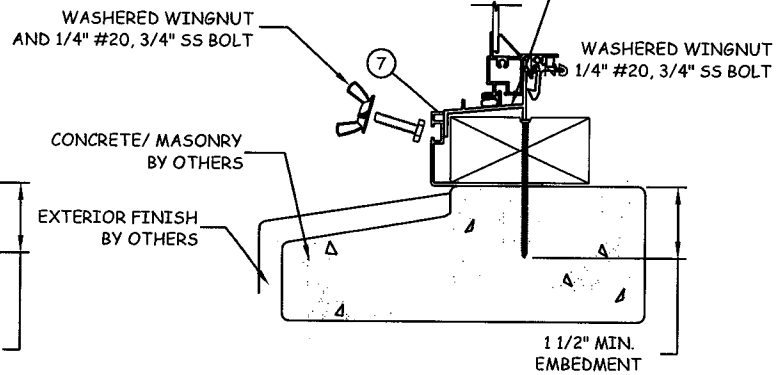
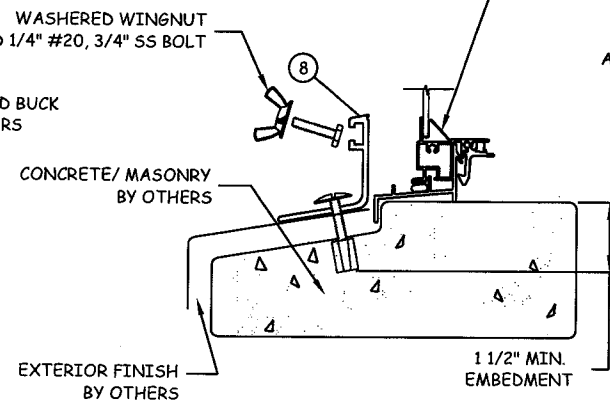
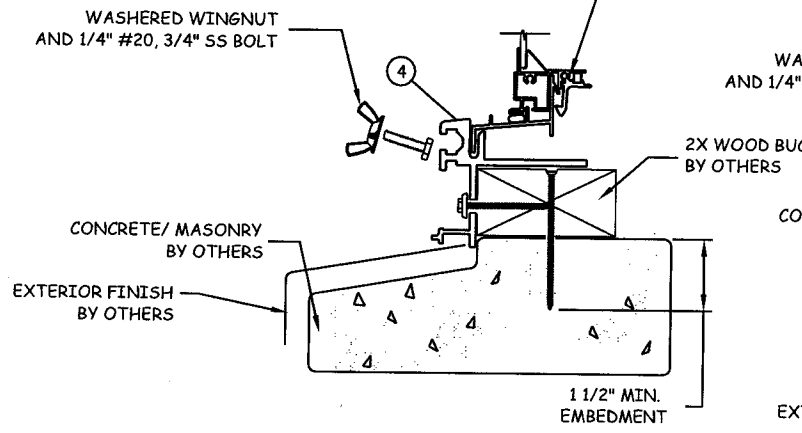
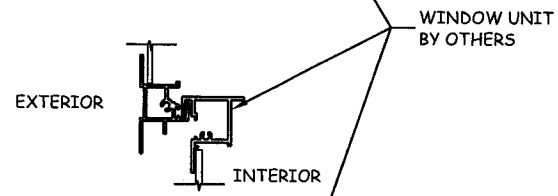
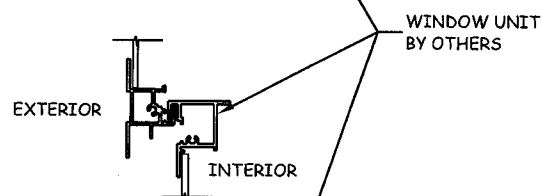
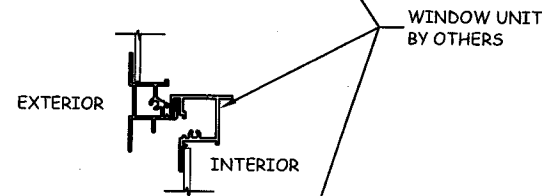
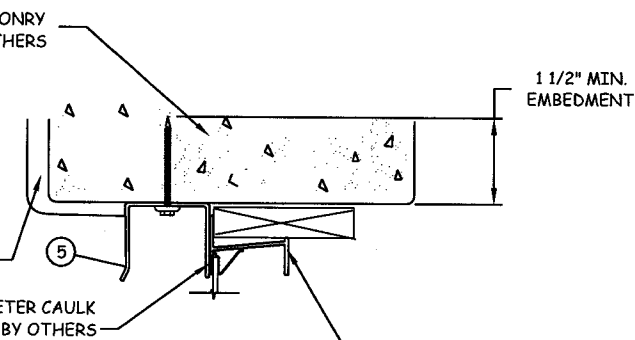
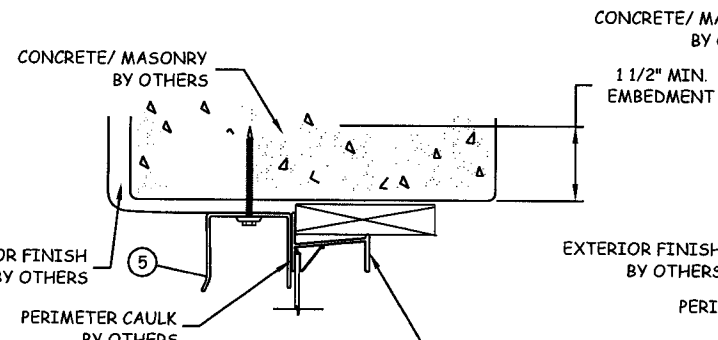
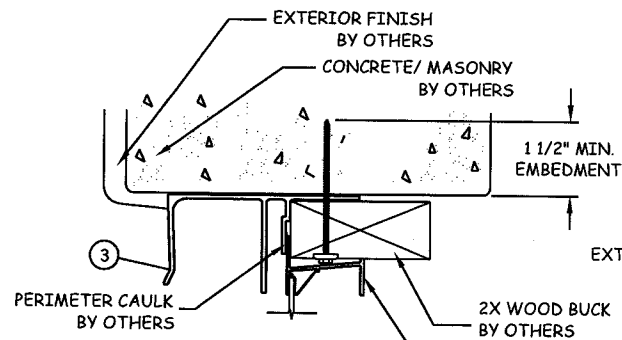
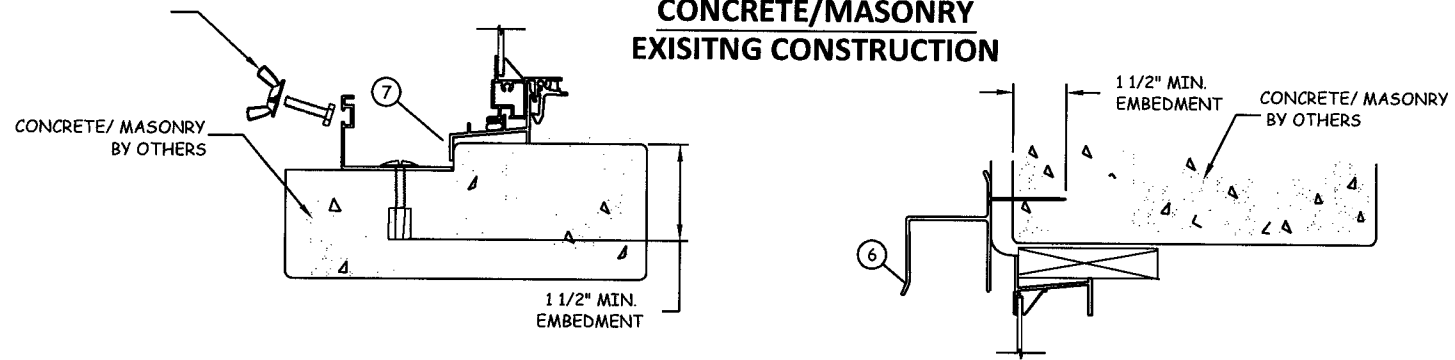

**CONCRETE/MASONRY WITH WOOD BUCK**  
**NEW CONSTRUCTION**

**CONCRETE/MASONRY**  
**EXISTING CONSTRUCTION**

**CONCRETE/MASONRY**  
**EXISTING CONSTRUCTION**

Diversified Window Solutions Inc. 2010 - LICENSOR OF WINDOW SYSTEMS AND HURRICANE SHUTTERS. "PATENTED, U.S. PATENT NO. 5,540,018" & PENDINGS



215 PINEDA STREET  
UNIT 141  
LONGWOOD, FL 32750

PH: 407-889-9440 FX:407-889-9193

TITLE: FIN & FLANGE  
HEADER & SILL KIT

FLANGE INSTALLATION

PREPARED BY:

CERTWORKS, LLC  
127 W. FAIRBANKS AVE., STE. 438  
WINTER PARK, FL 32789  
PH: (407) 644-6997 FX: (407) 644-2366

**REVISIONS**

NO.	DESCRIPTION	BY	DATE

*[Handwritten Signature]*  
11-5-10  
KRISTINA S. DAUGHERTY, P.E.  
FLORIDA P.E. NO. 68455  
127 W FAIRBANKS AVE., STE. 438  
WINTER PARK, FL 32789  
FBPE CERT. OF AUTHORIZATION NO. 28620

DATE: 11.05.10	DWN BY: JLA	CHK BY: HFN	SCALE: NTS
-------------------	----------------	----------------	---------------

DWG #:  
**DWS001**

SHEET: 4 OF 7



215 PINEDA STREET  
UNIT 141  
LONGWOOD, FL 32750

PH: 407-889-9440 FX: 407-889-9193

Diversified Window Solutions Inc. 2010 - LICENSOR OF WINDOW SYSTEMS AND HURRICANE SHUTTERS. "PATENTED, U.S. PATENT NO. 6,540,018" & PENDING

**TITLE:** FIN & FLANGE HEADER & SILL KIT  
**FIN INSTALLATION**

**PREPARED BY:**  
CERTWORKS, LLC  
127 W. FAIRBANKS AVE., STE. 438  
WINTER PARK, FL 32789  
PH: (407) 644-6957 FX: (407) 644-2366

REVISIONS	
NO.	DESCRIPTION

*[Handwritten Signature]*  
11-05-10  
KIRSTINA S. DALGHERTY, P.E.  
FLORIDA PROFESSIONAL ENGINEER  
127 W. FAIRBANKS AVE., STE. 438  
WINTER PARK, FL 32789  
FBPE CERT. OF AUTHORIZATION NO. 28520

DATE: 11.05.10  
DWN BY: JLA  
CHK BY: HFN  
SCALE: NTS

DWG #: **DWS001**  
SHEET: **5 OF 7**

FIN WINDOW KIT AND WINDOW OR LITE COMBO FLANGE KIT HEADER AND SILL

- A. WINDOW HEIGHT, FOLLOW WINDOW INSTALLATION INSTRUCTIONS.
- B. A WOOD FRAME OPENING WIDTH AND HEIGHT SHOULD BE 0.25" OR (1/4") WIDER AND HIGHER THAN THE WINDOW SIZE. DO NOT MAKE THE OPENING SIZE GREATER THAN 0.50" OR (1/2"), (BLOCKING WILL THEN BE REQUIRED).
- C. MEASURE WINDOW OPENING FOR SIZE AND TO BE SURE WINDOW OPENING IS PLUMB, SQUARE, LEVEL AND TRUE.
- D. FOLLOW INSTRUCTIONS ON WINDOW FOR PROPER WINDOW INSTALLATION.
- E. CENTER OF BOLT TRACK TO HEADER + (0.50) = PANEL LENGTH

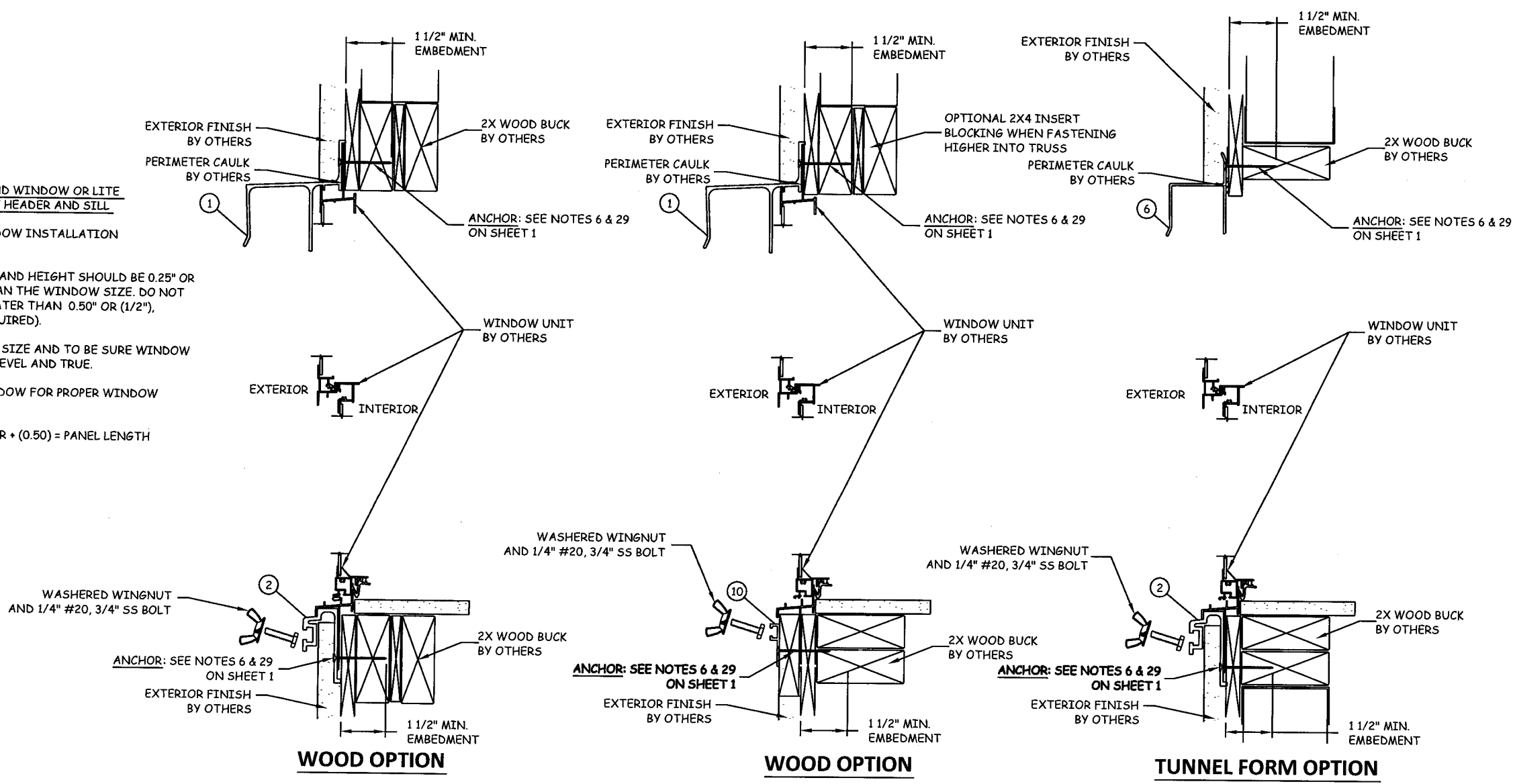

**WOOD OPTION**

**WOOD OPTION**

**TUNNEL FORM OPTION**

BILL OF MATERIALS			
ITEM NO.	DESCRIPTION	MATERIAL	MANUFACTURER
1	COMBO FIN KIT HEADER	6063-T5	DIVERSIFIED WINDOWS
2	COMBO FIN KIT SILL	6063-T5	DIVERSIFIED WINDOWS
3	COMBO FLANGE KIT HEADER	6063-T5	DIVERSIFIED WINDOWS
4	COMBO FLANGE KIT SILL	6063-T5	DIVERSIFIED WINDOWS
5	"U" HEADER	6063-T5	DIVERSIFIED WINDOWS
6	"H" HEADER	6063-T5	DIVERSIFIED WINDOWS
7	"F" TRACK OUTSIDE 90 DEGREE	6063-T5	DIVERSIFIED WINDOWS
8	"F" TRACK INSIDE 100 DEGREE	6063-T5	DIVERSIFIED WINDOWS
9	"F" TRACK INSIDE 90 DEGREE	6063-T5	DIVERSIFIED WINDOWS
10	"F" TRACK WALL MOUNT	6063-T5	DIVERSIFIED WINDOWS

1 COMBO FIN KIT HEADER ALUMINUM 6063-T5

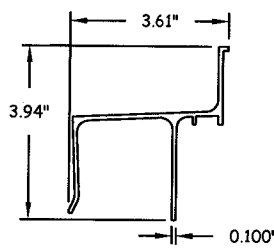

2 COMBO FIN KIT SILL ALUMINUM 6063-T5

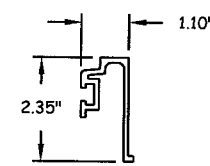

3 COMBO FLANGE KIT HEADER ALUMINUM 6063-T5

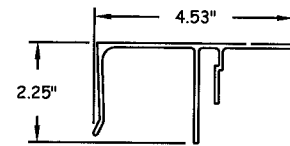

4 COMBO FLANGE KIT SILL ALUMINUM 6063-T5

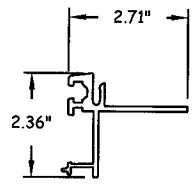

5 "U" HEADER ALUMINUM 6063-T5

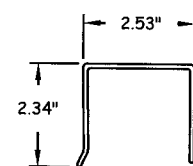

6 "H" HEADER ALUMINUM 6063-T5

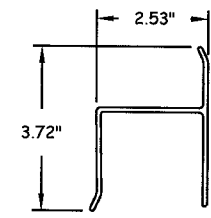

7 "F" TRACK OUTSIDE 90 DEGREE ALUMINUM 6063-T5

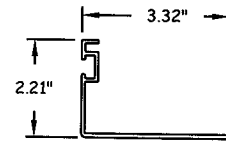

8 "F" TRACK INSIDE 100 DEGREE ALUMINUM 6063-T5

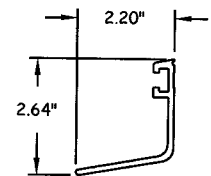

9 "F" TRACK INSIDE 90 DEGREE ALUMINUM 6063-T5

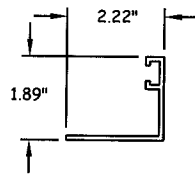

10 "F" TRACK WALL MOUNT ALUMINUM 6063-T5

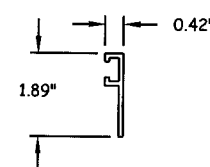

Diversified Window Solutions Inc. 2010 - LICENSOR OF WINDOW SYSTEMS AND HURRICANE SHUTTERS. "PATENTED, U.S. PATENT NO. 6,540,018" & PENDING

**Diversified**  
Window Solutions, Inc.  
215 PINEDA STREET  
UNIT 141  
LONGWOOD, FL 32750  
PH: 407-889-9440 FX: 407-889-9193

TITLE: FIN & FLANGE HEADER & SILL KIT  
COMPONENTS & BILL OF MATERIALS  
PREPARED BY: CERTWORKS, LLC  
127 W. FAIRBANKS AVE., STE. 438  
WINTER PARK, FL 32789  
PH: (407) 644-6957 FX: (407) 644-2366

REVISIONS	
DESCRIPTION	DATE

*[Signature]*  
11-5-10  
KRISTINA S. DAUGHERTY, P.E.  
FLORIDA P.E. NO. 689455  
127 W. FAIRBANKS AVE., STE. 438  
WINTER PARK, FL 32789  
FBPE CERT. OF AUTHORIZATION NO. 28520

DATE: 11.05.10  
DWN BY: JLA  
CHK BY: HFN  
SCALE: NTS

DWG #: DWS001  
SHEET: 6 OF 7

# FIN AND FLANGE INSTALLATION NOTES

## A. ROUGH OPENING MASONRY OR WOOD CONSTRUCTION.

- CHECK TO ENSURE THE OPENING IS PROPER SIZE.
- SILL PLATE MUST BE LEVEL.
- PROVIDE 1/4 TO 1/2 INCH OF CLEARANCE ON BOTH HEIGHT AND WIDTH.
- IN WOOD FRAME INSTALLATIONS COVER THE OUTSIDE FACE OF THE BUILDING OPENINGS WITH VAPOR BARRIER AND/OR OTHER MATERIAL AS PROVIDED BY OTHERS FOR THE BUILDER. INSTALL WINDOW, THE BOTTOM PEEL AND SEAL STRIP IS APPLIED OVER NAILING FIN THEN APPLY JAMB STRIPS. TOP STRIP IS APPLIED OVER NAILING FIN AFTER TWO SIDE STRIPS ARE APPLIED.
- FOLLOW SITE SPECIFIC DETAILS FROM SEALED JOB PLANS IF PROVIDED.

## B. CHECKING WINDOW UNIT.

- OPEN AND OPERATE SASH AND CHECK THAT THE UNIT OPERATES PROPERLY BEFORE INSTALLING.
- CLOSE AND LOCK SASH.

## C. INSTALLATION PROCEDURE.

- IN WOOD FRAME CONSTRUCTION, APPLY A CONTINUOUS BEAD OF SEALANT (BEDDING JOINT) AROUND THE FULL PERIMETER OF THE BACKSIDE OF THE MOUNTING FIN. APPLY THE SEALANT IN LINE WITH ANY PRE-PUNCHED HOLES ON THE MOUNTING FIN.
- IN MASONRY CONSTRUCTION, SEALANT MAY BE APPLIED AROUND THE ENTIRE BUCK AT THE POINT WHERE THE BACKSIDE (INTERIOR SURFACE) OF THE MOUNTING FLANGE WILL MAKE CONTACT WITH THE BUCK.
- CENTER UNIT IN OPENING.
- SELECT AND APPLY SHIMS.
- ADJUST THE SHIMS AND CHECK THE WINDOW FOR LEVEL, PLUM, AND TRUE. ENSURE THE WINDOW IS NOT BOWED IN OR OUT. DISTANCE BETWEEN JAMBS AT MEETING RAIL SHOULD MEASURE THE SAME AS HEAD AND SILL.
- FOR WOOD FRAME INSTALLATIONS FASTEN THE UPPER CORNER IN PLACE THROUGH THE NAIL FIN. DO NOT DRIVE THE FASTENER IN TO TEN POINT OF BENDING THE FIN.
- FOR CONCRETE/MASONRY WALL INSTALLATIONS FASTEN THE UPPER CORNER IN PLACE THROUGH THE BALANCE CHANNEL. DO NOT DRIVE THE FASTENER IN TO THE POINT OF BENDING THE NAILING FIN.
- ENSURE THE WINDOW IS SQUARE, OPERATES SMOOTHLY, AND OPERABLE SASHES ARE SITTING SQUARE IN THEIR OPENINGS.
- FASTEN THE CORNER DIAGONALLY OPPOSITE THE UPPER CORNER THAT WAS FASTENED FIRST.
- CONTINUE TO FASTEN SIDES, TOP, AND BOTTOM THROUGH THE MOUNTING FIN; RECHECKING THE UNIT TO ENSURE IT IS SET PLUMB, LEVEL, SQUARE, AND TRUE. FASTENER HEADS SHOULD NOT COMPRESS THE NAIL FIN WHEN PUT IN PLACE.
- IF APPLYING ADDITIONAL INSULATION BEHIND JAMBS AND UNDER SILL, BE CAREFUL NOT TO BOW FRAME IN.
- IN WOOD FRAME INSTALLATIONS, IF A TOP FLASHING STRIP IS USED, APPLY OVER HEADER NAILING FIN
- CHECK THE OPERATION OF THE WINDOW AND ADJUST AS NECESSARY.
- REFER TO ENGINEERING DRAWINGS FOR MORE SPECIFIC INSTALLATION DETAILS.

## D. PANEL MEASUREMENTS.

- MEASURE FROM THE INTERIOR TOP OF THE HEADER TO THE CENTER OF THE BOLT TRACK AND ADD 1/2" THIS WILL BE THE PANEL LENGTH.

DETAIL 12 - TYPICAL BLOCK WALL SECTION  
CROSS SECTION VIEW OF C.B.S. WALL

MINIMUM EMBEDMENT (M.E.) IS THE DISTANCE AN ANCHOR MUST PENETRATE THE BEARING STRUCTURE

EDGE DISTANCE (E.D.) IS THE DISTANCE FROM THE STRUCTURES EDGE TO THE ANCHOR.

ANCHORS SHALL BE INSTALLED IN ACCORDANCE WITH MANUFACTURES RECOMMENDATIONS

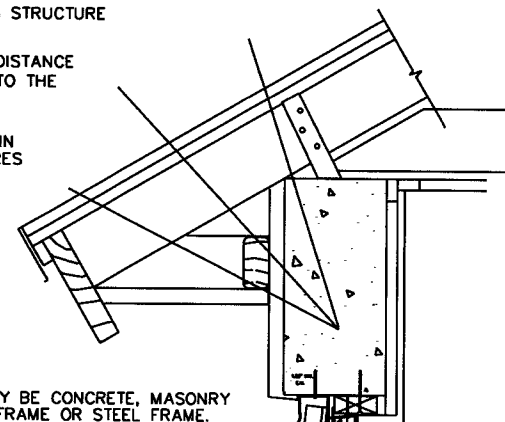

STRUCTURE MAY BE CONCRETE, MASONRY BLOCK, WOOD FRAME OR STEEL FRAME.

NO SEPRATION FROM GLASS REQUIRED.

SEE EGRESS DETAIL.

DETAIL 14 - HALF PANEL

THIS WALL SECTION DEPICTS A VARIETY OF CONSTRUCTION STYLES, C.B.S. WITH TIE BEAM, C.B.S. WITH LINTEL AND PRECASTS ABOVE OR BELOW WINDOWS AND DOORS, AND PRECAST WALL STRUCTURES, ECT.

### ANCHORING DETAIL.

WHEN ANCHORING INTO WOOD, THE WOOD SHALL BE A MINIMUM OF 2" X 4" AND EQUAL TO 2# SOUTHERN PINE OR CONSTRUCTION GRADE, STAMPED CONSTRUCTION GRADE AND BE PART OF THE FRAMING STRUCTURE OR SECURELY ATTACHED TO THE FRAMING STRUCTURE OR SUPPORTING JOISTS. 1/4" ANCHOR SCREW LENGTH REQUIRED FOR 1 1/2" EMBEDMENT

Diversified Window Solutions Inc. 2010 - LICENSOR OF WINDOW SYSTEMS AND HURRICANE SHUTTERS. "PATENTED, U.S. PATENT NO. 5,540,018" & PENDING



215 PINEDA STREET  
UNIT 141  
LONGWOOD, FL 32750

PH: 407-889-9440 FX:407-889-9193

TITLE: FIN & FLANGE HEADER & SILL KIT  
INSTALLATION NOTES  
PREPARED BY: CERTWORKS, LLC  
127 W. FAIRBANKS AVE., STE. 438  
WINTER PARK, FL 32789  
PH: (407) 644-6957 FX: (407) 644-2366

NO.	DESCRIPTION	BY	DATE

REVISIONS

NO. 11-5-10

DESCRIPTION: 11-5-10

DATE: 11-05-10

BY: JLA

CHK BY: HFN

SCALE: NTS

KRISTINA S. DAUGHERTY, PE  
FLORIDA P. E. NO. 88455  
127 W FAIRBANKS AVE., STE 438  
WINTER PARK, FL 32789  
FBPE CERT. OF AUTHORIZATION NO. 286620

DATE: 11.05.10  
DWN BY: JLA  
CHK BY: HFN  
SCALE: NTS

DWG #: DWS001

SHEET: 7 OF 7