

dormakaba USA, Inc.

BEST ACCESS SERIES 9K CYLINDRICAL LOCKSET HARDWARE - LMI (COMPONENT APPROVAL)



dormakaba USA Inc.
6161 E. 75TH STREET
INDIANAPOLIS, IN 46250
PH: (317) 806-3288

9K CYLINDRICAL LOCKSET			
MAX. DESIGN PRESSURE RATING-PSF			
CONFIGURATION	MAX. PANEL SIZE	LATCH THROW	MAX. DP
SINGLE	48" X 96"	9/16"	+/- 75 PSF
SINGLE	48" X 96"	3/4"	+/- 80 PSF
DOUBLE	36" X 84"	3/4"	+/- 50 PSF

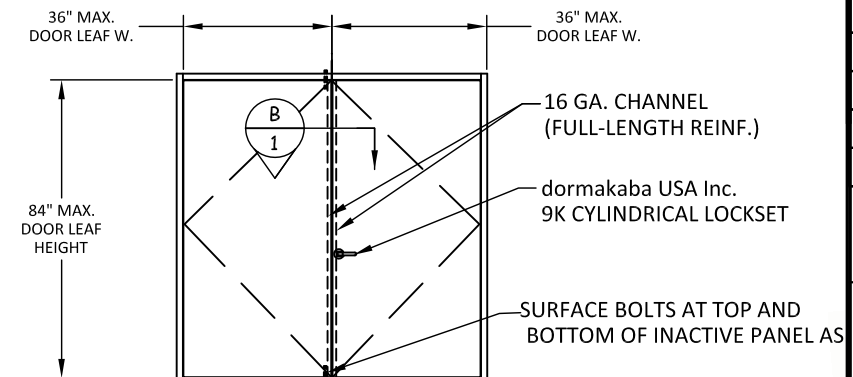
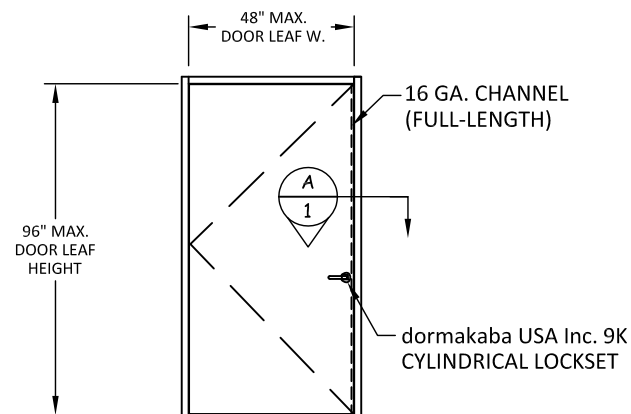
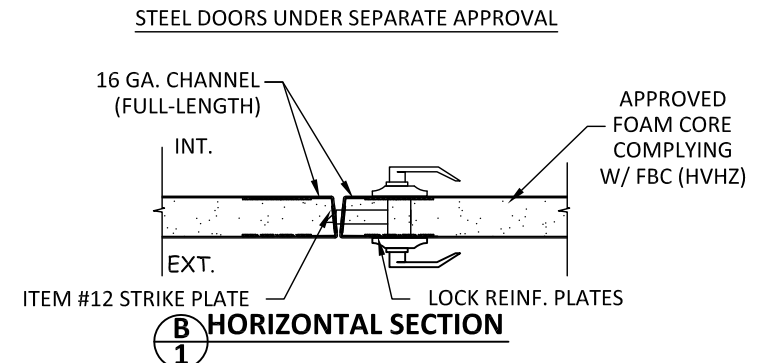
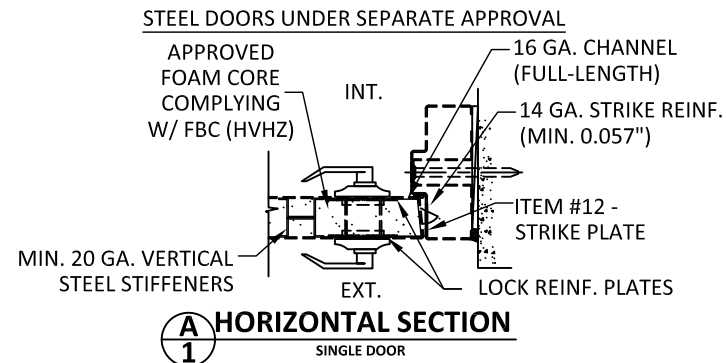

OUTSWING SINGLE STEEL DOOR DOORS UNDER SEPARATE APPROVAL

OUTSWING PAIR STEEL DOORS DOORS UNDER SEPARATE APPROVAL

TABLE OF CONTENTS		
SHEET	REVISION	SHEET DESCRIPTION
1	-	GENERAL NOTES, ELEVATION, AND SECTION VIEW
2	-	EXPLODED ISOMETRIC VIEW
3	-	ORTHOGRAPHIC VIEWS & BILL OF MATERIALS

GENERAL NOTES:

- THIS PRODUCT HAS BEEN DESIGNED AND MANUFACTURED TO COMPLY WITH THE 6TH EDITION FLORIDA BUILDING CODE (FBC) INCLUDING PROVISIONS SET FORTH FOR HIGH-VELOCITY HURRICANE ZONES (HVHZ) AND HAVE BEEN TESTED AND EVALUATED IN ACCORDANCE WITH TAS 201, 202, & 203.
- THE COMPONENT DESCRIBED HEREIN SHALL BE USED WITH DOOR PANEL FACE SHEETS TO BE MIN. 18 GA. (0.048" MIN.) STEEL, AND FRAME TO BE MIN. 16 GA. (0.057" MIN.) WITH MIN. $F_y = 35,400$ PSI STEEL. FORMED STEEL REINFORCEMENT PLATE (1.557" X 8.018") SHALL BE A MINIMUM OF 16 GA. (0.057" MIN.) COLD ROLLED STEEL HINGE REINFORCEMENTS SHALL BE A MINIMUM OF 9 GA. (0.132" MIN.).
 - MAX. SINGLE DOOR PANEL DIMENSIONS: 48" (W) X 96" (H) X 1-3/4" THICK
 - DEVICE SHALL BE INSTALLED INTO SINGLE COMMERCIAL CORE FILLED STEEL DOORS UNDER SEPARATE APPROVAL.
 - CORE OF DOORS SHALL BE APPROVED AS PART OF SEPARATE DOOR APPROVAL.
 - DOOR SHALL BE REINFORCED WITH 20 GA. VERTICAL STEEL STIFFENERS.
 - MAX. DOUBLE DOOR PANEL DIMENSIONS: 36" (W) X 84" (H) X 1-3/4" THICK
 - DEVICE SHALL BE INSTALLED INTO DOUBLE COMMERCIAL CORE FILLED STEEL DOORS UNDER SEPARATE APPROVAL.
 - FILLED CORE OF DOORS SHALL BE APPROVED AS PART OF SEPARATE DOOR APPROVAL.
 - INACTIVE PANELS SHALL BE SECURED WITH BOLTS AT TOP AND BOTTOM AS PART OF SEPARATE DOOR APPROVAL.
- LOCKING HARDWARE SHALL BE INSTALLED AS PER MANUFACTURER'S INSTALLATION INSTRUCTIONS.
- ALL FASTENERS AND ASSOCIATED HARDWARE MUST BE MADE OF CORROSION RESISTANT MATERIAL OR HAVE A CORROSION RESISTANT COATING.
- STRIKES, HINGES, AND ALL APPLICABLE REINFORCEMENTS MINIMUM AS REQUIRED ON DETAIL DRAWING IN THIS APPROVAL.
- STEEL COMPONENTS SHALL BE COATED OR COMPLY WITH CORROSION RESISTANCE PROTECTION IN CONFORMANCE WITH THE MATERIAL PROTECTION PROVISIONS OF CHAPTER 22 OF THE FBC.

LIMITATIONS OF USE:

- THIS CYLINDRICAL LOCKSET HARDWARE COMPONENT APPROVAL IS TO BE USED AS AN EQUIVALENT ALTERNATIVE OF TESTED LOCK COMPONENTS FOR SINGLE OR PAIR STEEL OUTSWING DOORS HAVING A SEPARATE CURRENT NOA. THE LOWER DESIGN PRESSURE OF DOOR OR THE LOCK COMPONENT APPROVAL HEREIN SHALL CONTROL.
- ELECTRICAL/ELECTRONIC FUNCTION AND INSTALLATION OTHER THAN SELF CONTAINED ELECTRONIC DEVICES ARE NOT PART OF THIS APPROVAL AND MUST BE REVIEWED BY AUTHORITY HAVING JURISDICTION(AHJ) IN THE AREA.
- DOOR LEAF SHALL BE NO WIDER THAN 48" OR HIGHER THAN 96" FOR SINGLE DOORS OR WIDER THAN 48" OR HIGHER THAN 84" FOR DOUBLE DOOR APPLICATIONS.
- COMPLIANCE WITH BUILDING EGRESS REQUIREMENTS TO BE REVIEWED BY BUILDING OFFICIAL.

TITLE: BEST ACCESS SERIES 9K CYLINDRICAL LOCK SET HARDWARE GENERAL NOTES, ELEVATION, AND SECTION VIEW

PREPARED BY: BUILDING DROPS, INC.
398 E. DANIA BEACH BLVD., STE. 338
DANIA BEACH, FL 33004
PH: (954)399-8478
FAX: (954)744-4738
WEB: www.buildingdrops.com

REMARKS	BY	DATE

THE INSTALLATION DETAILS DESCRIBED HEREIN ARE GENERIC AND MAY NOT REFLECT ACTUAL CONDITIONS FOR A SPECIFIC SITE. IF SITE CONDITIONS CAUSE INSTALLATION TO DEVIATE FROM THE REQUIREMENTS DETAILED HEREIN, A LICENSED ENGINEER OR ARCHITECT SHALL PREPARE SITE SPECIFIC DOCUMENTS FOR USE WITH THIS DOCUMENT.

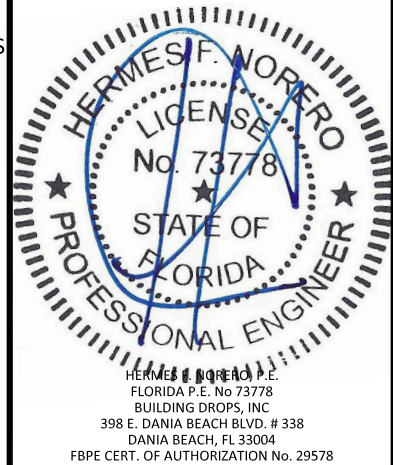

FL16202

DATE: 12.11.18

DWG. BY: SM CHK. BY: HFN

SCALE: NTS

DWG. #: DOR001

SHEET:

1 OF 3

2/15/2019 4:27 PM s:\projects\dormakaba\loc-18-134-1020096 and fl16202 (revision and name changed)\dwg\1116202\dor001_9k_cylindrical_lockset.dwg

TITLE: BEST ACCESS SERIES 9K
CYLINDRICAL LOCK SET HARDWARE

EXPLODED ISOMETRIC VIEW

PREPARED BY:  BUILDING DROPS, INC.
398 E. DANIA BEACH BLVD., STE. 338
DANIA BEACH, FL 33004
PH: (954) 399-8478
FAX: (954) 744-4738
WEB: www.buildingdrops.com

REMARKS	BY	DATE

THE INSTALLATION DETAILS DESCRIBED HEREIN ARE GENERIC AND MAY NOT REFLECT ACTUAL CONDITIONS FOR A SPECIFIC SITE. IF SITE CONDITIONS CAUSE INSTALLATION TO DEVIATE FROM THE REQUIREMENTS DETAILED HEREIN, A LICENSED ENGINEER OR ARCHITECT SHALL PREPARE SITE SPECIFIC DOCUMENTS FOR USE WITH THIS DOCUMENT.

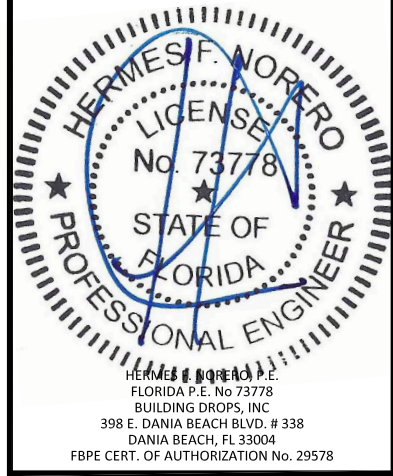

FL16202

DATE: 12.11.18

DWG. BY: SM CHK. BY: HFN

SCALE: NTS

DWG. #: DOR001

SHEET:

2

OF 3

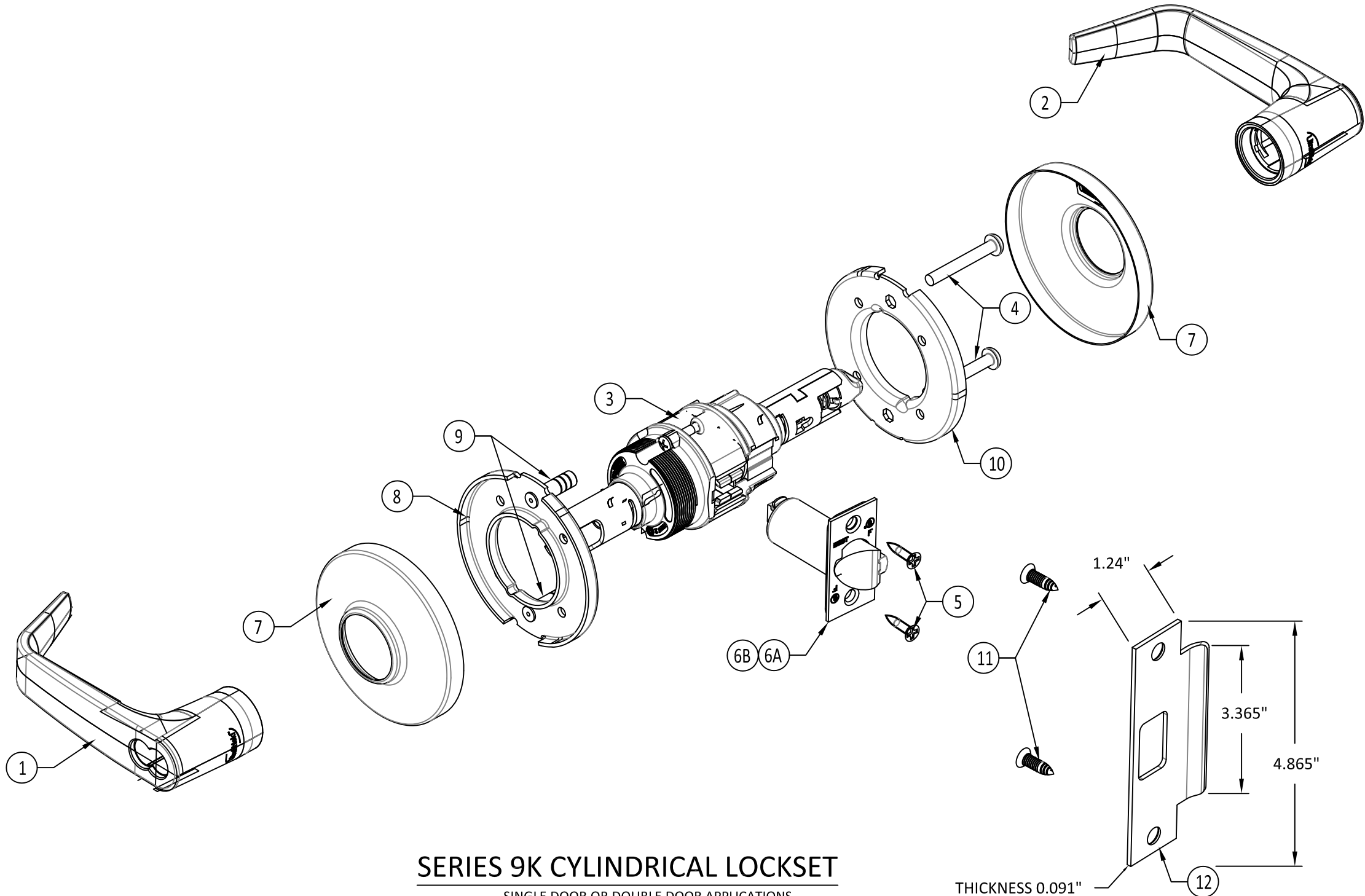

SERIES 9K CYLINDRICAL LOCKSET

SINGLE DOOR OR DOUBLE DOOR APPLICATIONS
SEE SHEET 1 FOR DESIGN PRESSURES AND FURTHER LIMITATIONS.

s:\projects\dormakaba\loc-18-1134-11200096 and fl16202 (revision and name change)\dwg\1116202\dor001_9k_cylindrical_lockset.dwg 2/15/2019 4:27 PM

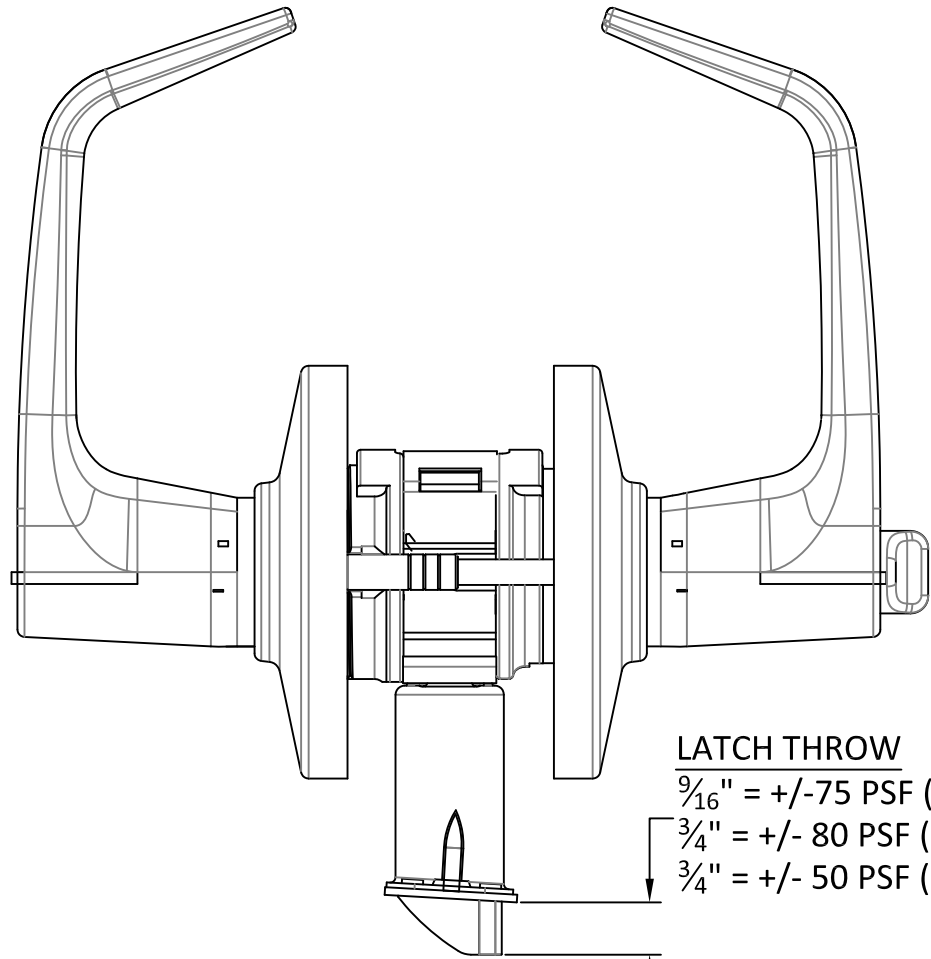

LATCH THROW
 $\frac{9}{16}$ " = +/- 75 PSF (SINGLE DOOR)
 $\frac{3}{4}$ " = +/- 80 PSF (SINGLE DOOR)
 $\frac{3}{4}$ " = +/- 50 PSF (DOUBLE DOOR)

SERIES 9K CYLINDRICAL LOCKSET

TOP ORTHO VIEW

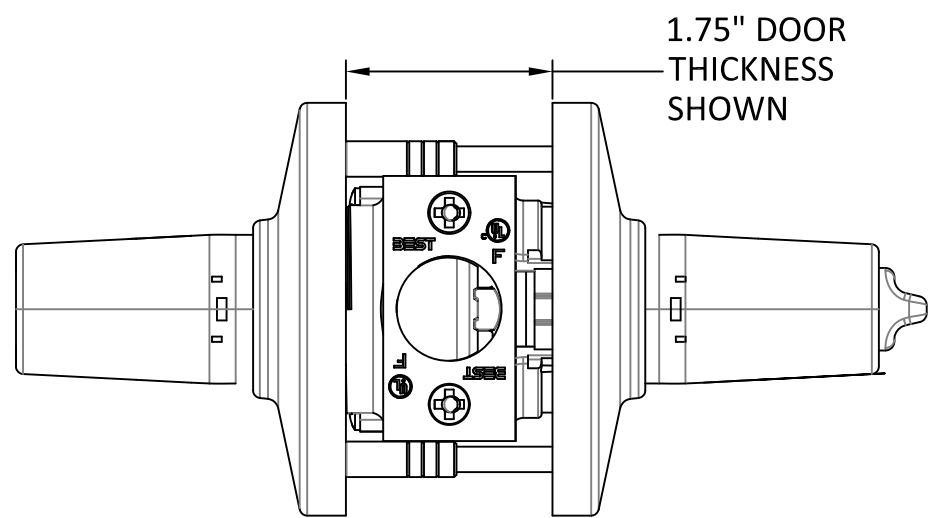

1.75" DOOR THICKNESS SHOWN

SERIES 9K CYLINDRICAL LOCKSET

SIDE ORTHO VIEW

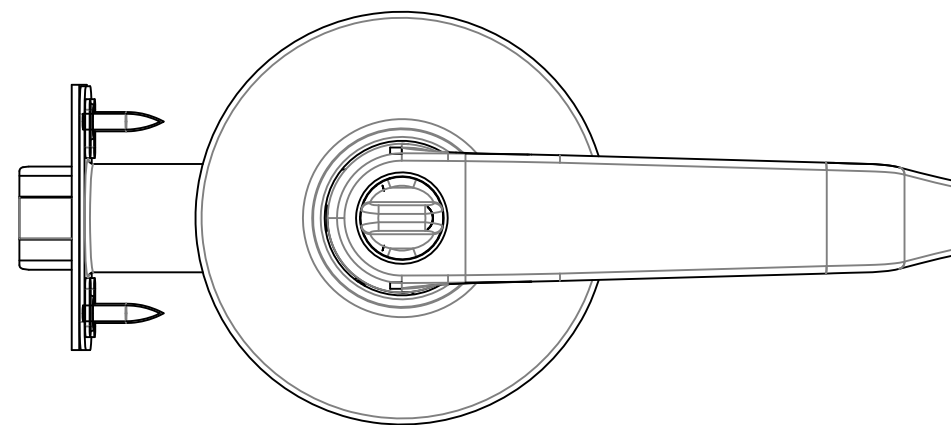

SERIES 9K CYLINDRICAL LOCKSET

FRONT ORTHO VIEW

MATERIAL & PARTS LIST					
ITEM	DRAWING	DESCRIPTION	APPROXIMATE SIZE	MATERIAL	REQ'D
1	D55168	#15 STYLE KEYED LEVER HANDLE FOR 9K	5.414 X 2.095 X 1.260	ZINC	1
2	D55170	#15 STYLE BUTTON LEVER HANDLE FOR 9K	5.414 X 2.095 X 1.260	ZINC	1
3	C54322	CHASSIS ASSEMBLY "AB" FUNCTION	Ø2.075 X 7.103	STEEL	1
4	A55557	CLAMP FOR 9K	#12-24 X 1.625	STEEL	2
5	A25359	COMBINATION SCREW # 8-32	#8-32 X .750	STEEL	2
6A	C54680	DEADLOCKING LATCH & FACEPLATE ASSEMBLY FOR 9K ($\frac{3}{4}$ " THROW)	2.248 X 1.123 X 2.626	STEEL	1
6B	C54680	DEADLOCKING LATCH & FACEPLATE ASSEMBLY FOR 9K ($\frac{9}{16}$ " THROW)	2.248 X 1.123 X 2.626	STEEL	1
7	B55007	LARGE ROSE	Ø3.499 X .788	BRASS	2
8	C55508	LARGE O/S LINER	Ø3.499 X .240	STEEL	1
9	B55507	THREADED ANTI-ROTATION STUD	Ø301 X 1.137	STEEL	2
10	C55555	LARGE THREADLESS I/S LINER	Ø3.499 X .240	STEEL	1
11	A18724	#12-24/#12-12 X 3/4" UNDERCUT PFHCS, GR. 5	#12-24 X .750	STEEL	2
12	B25641	4 7/8" STRIKE FOR 9K	4.865 X 1.240 X .091	BRASS	1



dormakaba USA Inc.
 6161 E. 75TH STREET
 INDIANAPOLIS, IN 46250
 PH: (317) 806-3288

TITLE: BEST ACCESS SERIES 9K CYLINDRICAL LOCK SET HARDWARE
 ORTHOGRAPHIC VIEW & BILL OF MATERIALS
 PREPARED BY: BUILDING DROPS, INC.
 398 E. DANIA BEACH BLVD., STE. 338
 DANIA BEACH, FL 33004
 PH: (954) 399-8478
 FAX: (954) 744-4738
 WEB: www.buildingdrops.com

REMARKS	BY	DATE

THE INSTALLATION DETAILS DESCRIBED HEREIN ARE GENERIC AND MAY NOT REFLECT ACTUAL CONDITIONS FOR A SPECIFIC SITE. IF SITE CONDITIONS CAUSE INSTALLATION TO DEVIATE FROM THE REQUIREMENTS DETAILED HEREIN, A LICENSED ENGINEER OR ARCHITECT SHALL PREPARE SITE SPECIFIC DOCUMENTS FOR USE WITH THIS DOCUMENT.

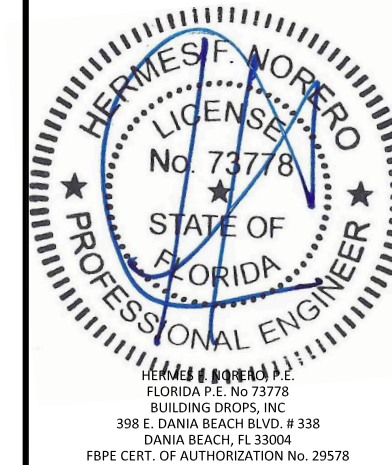

FL16202

DATE: 12.11.18
 DWG. BY: SM
 CHK. BY: HFN
 SCALE: NTS
 DWG. #: DOR001
 SHEET:

3

OF 3