

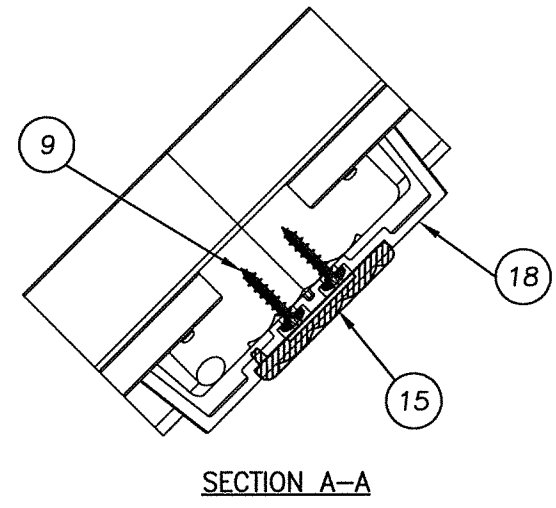

\\dc01\wbc\Clients\ODL, Inc. PERMANENTVA - Florida Product Approvals\FL-15260 Exterior Door Components - Lite Frame InsertsC - Drawings\FL 15260 (2020) R9\FL-15260.1-2.dwg

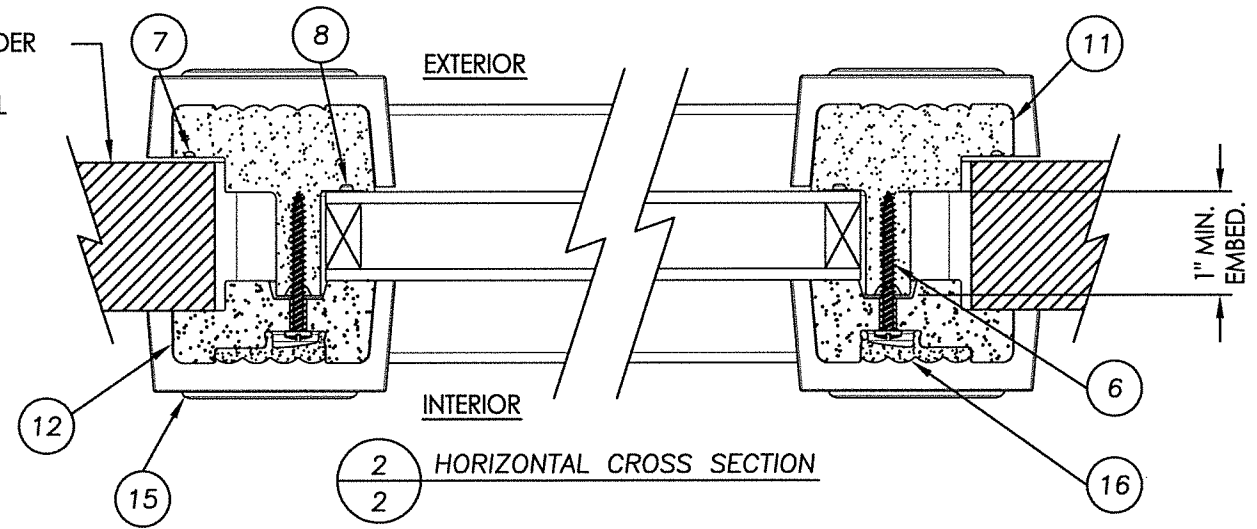
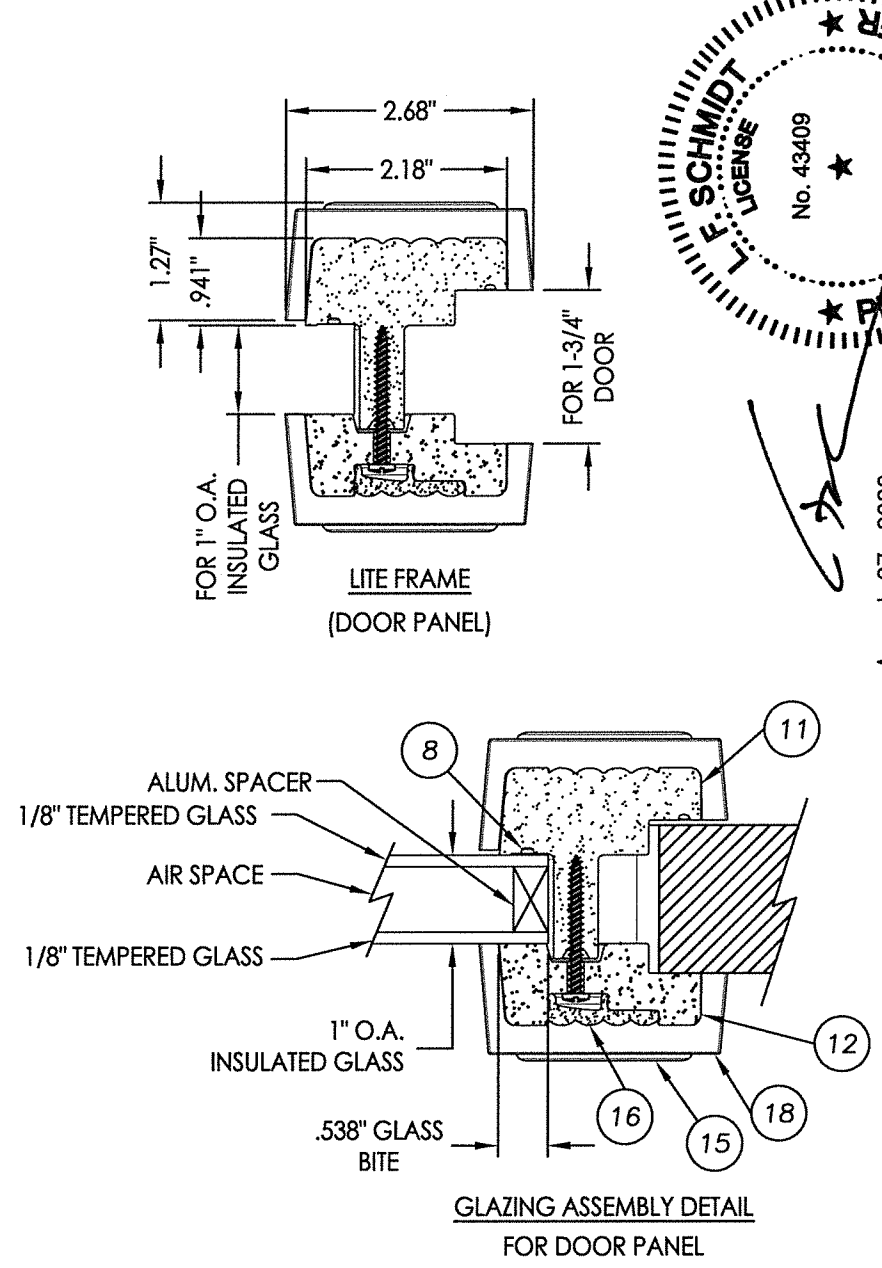
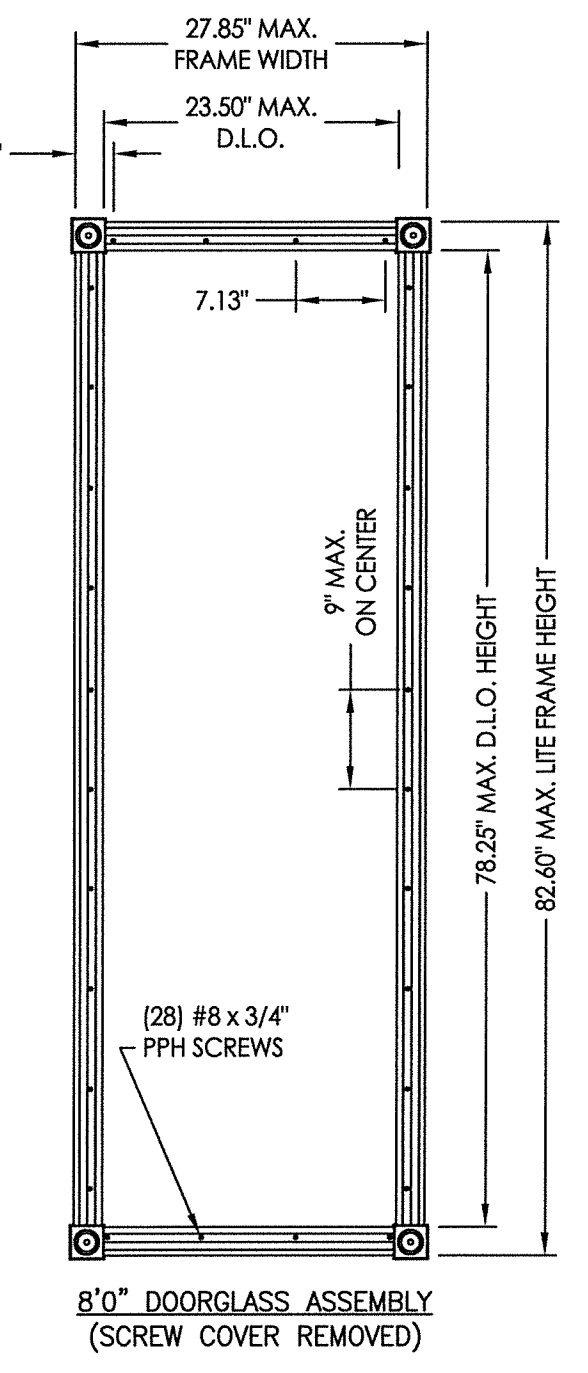
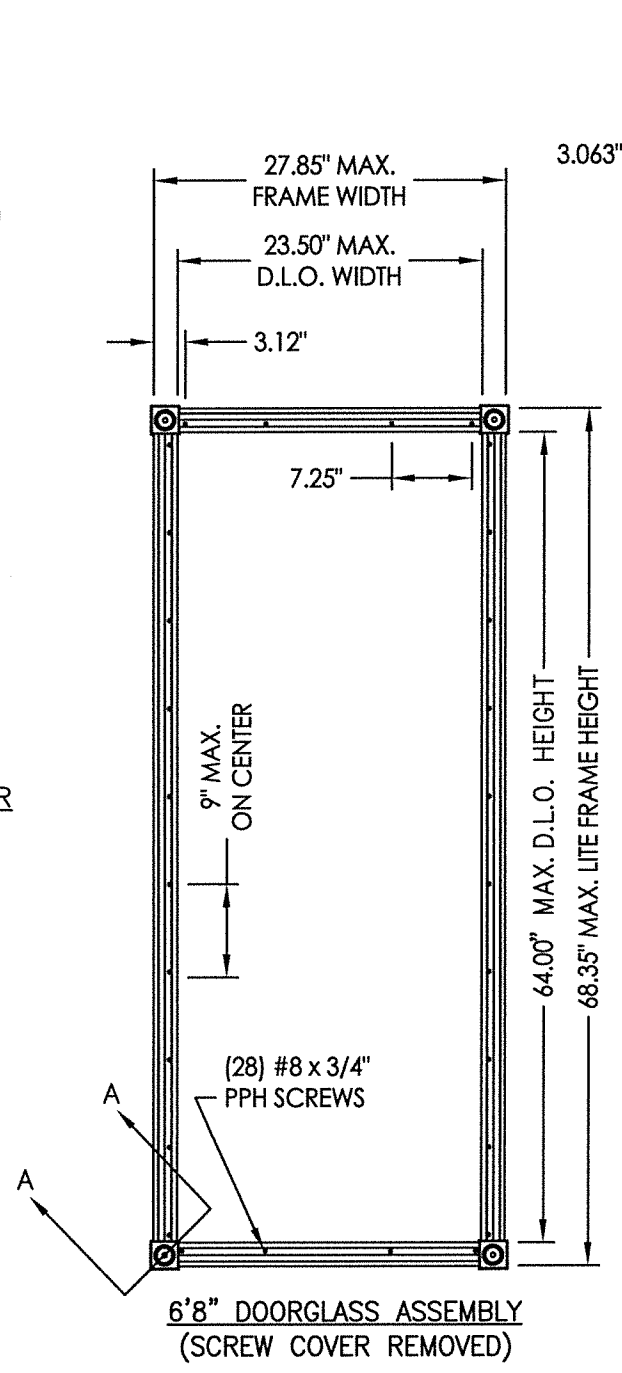
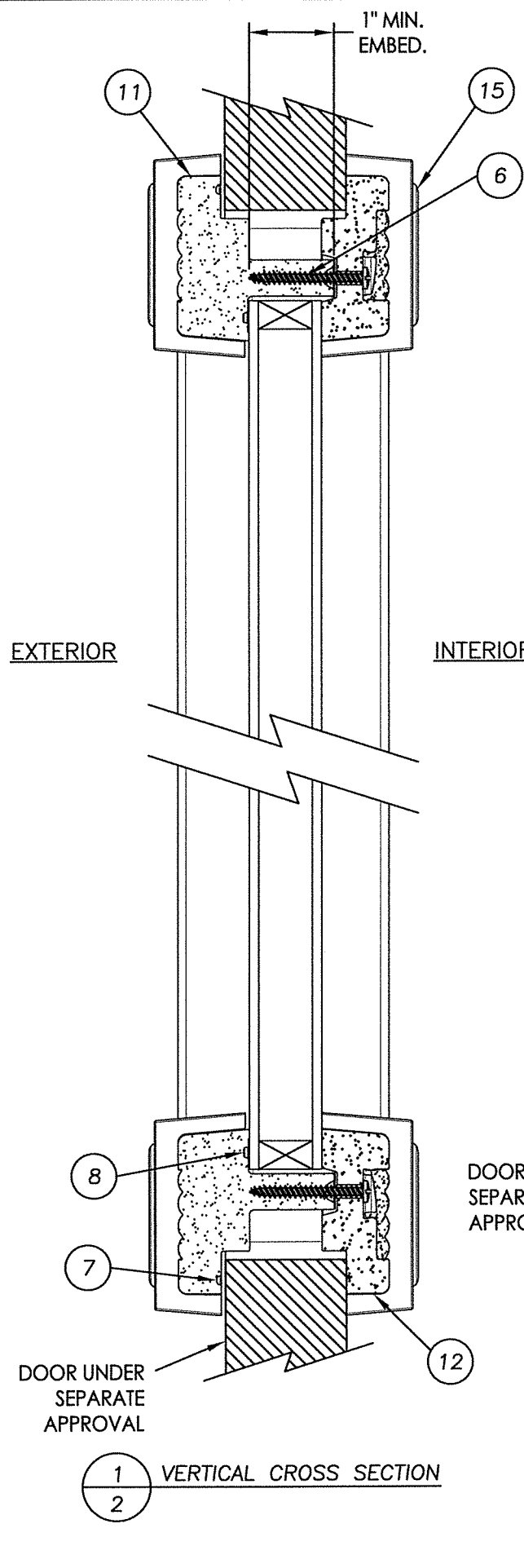

August 07, 2020  
 Documents Prepared By:  
 Lyndon F. Schmidt  
 P.E. No. 43409

**RW**  
 BUILDING CONSULTANTS, INC.  
 P.O. Box 230, Valrico, FL 33595  
 Phone No.: 813.659.9197  
 FBPE Registry No. 9813

PRODUCT:		ODL/WESTERN REFLECTIONS FLUTED ARCHITECTURAL SERIES DOORGLASS ASSEMBLY			
PART OR ASSEMBLY:		GLAZING DETAIL & CROSS SECTIONS (DOOR)			
NO.	DATE	BY	REVISIONS		
3	8/50/20	DAC	UPDATE TO 7TH ED. (2020)	FBC	
2	9/26/17	JK	UPDATE TO 6TH ED. (2017)	FBC	
1	3/28/15	JK	UPDATE TO 5TH ED. (2014)	FBC	
DATE					
DATE:	2/29/12				
SCALE:	N.T.S.				
DWG. BY:	JK				
CHK. BY:	LFS				
DRAWING NO.:	FL-15260.2				
SHEET	2 OF 4				

© 2012 R.W. BUILDING CONSULTANTS INC.

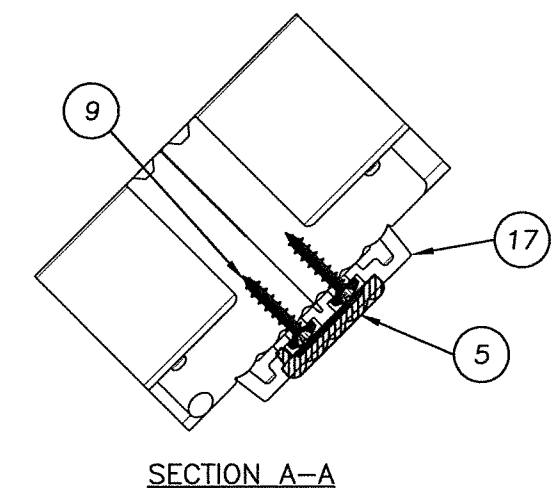
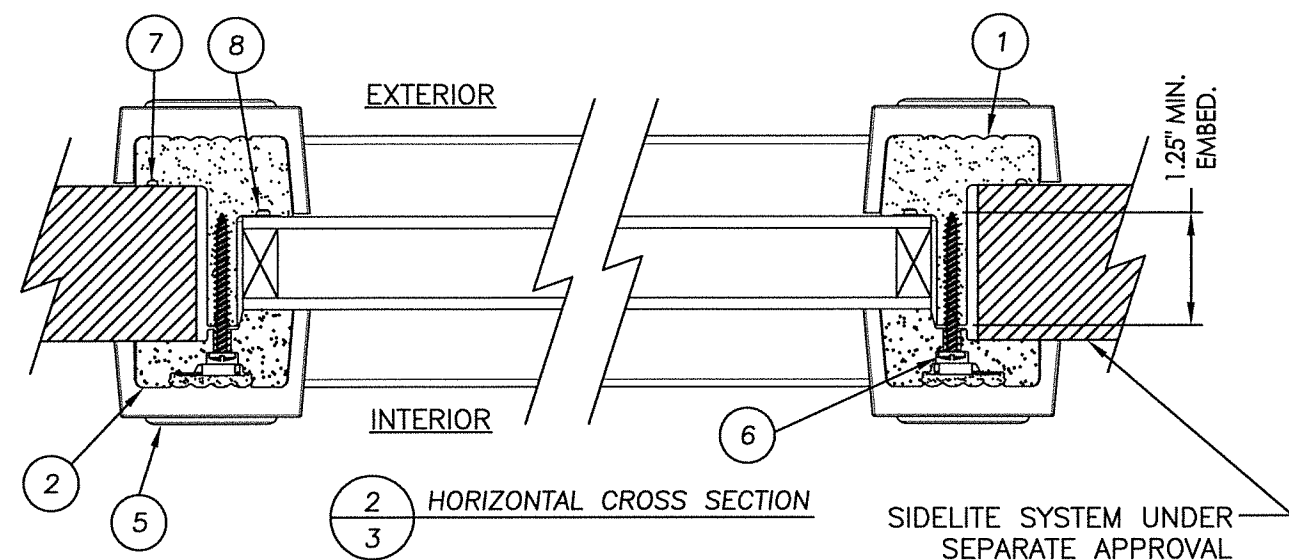
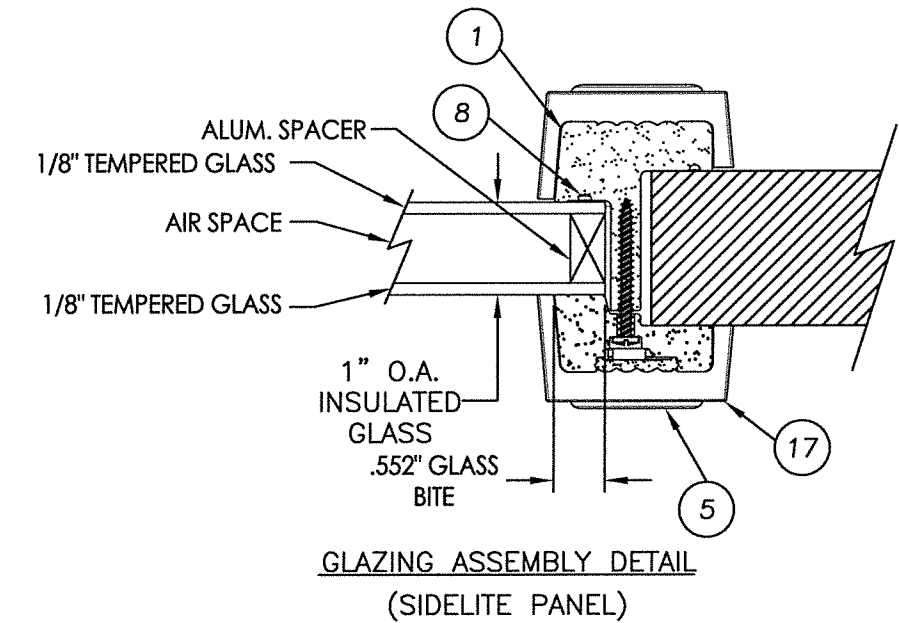
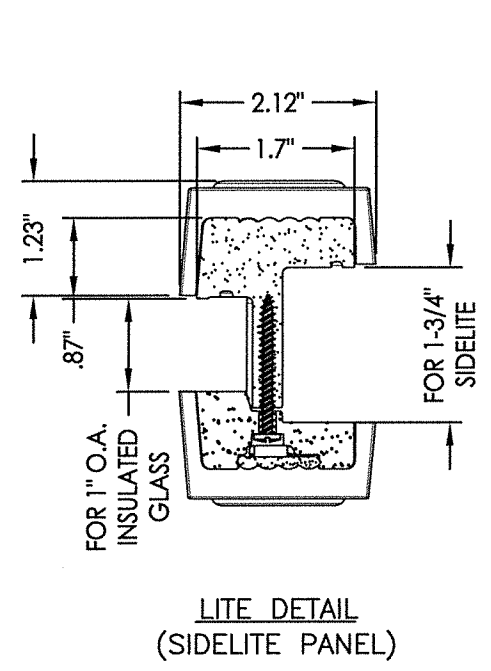
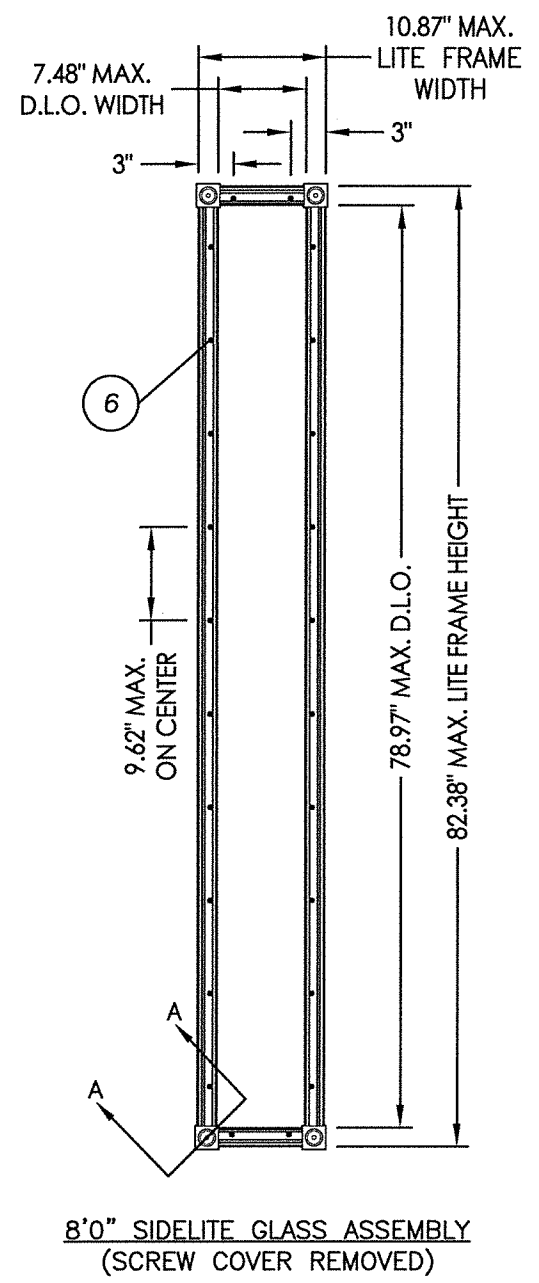
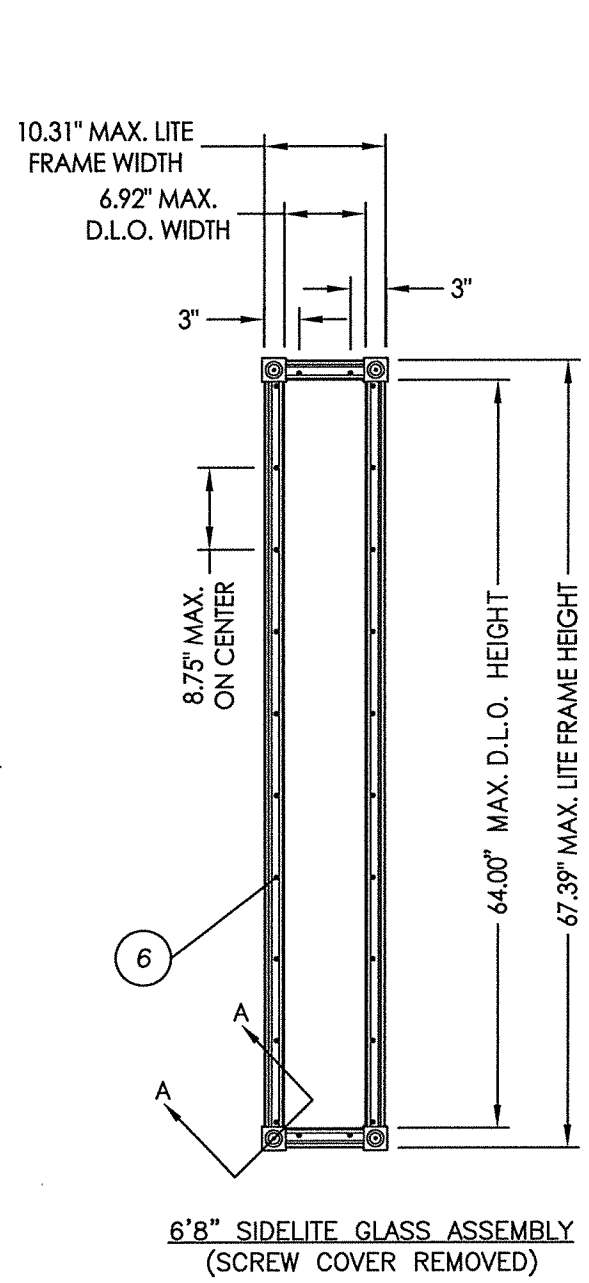
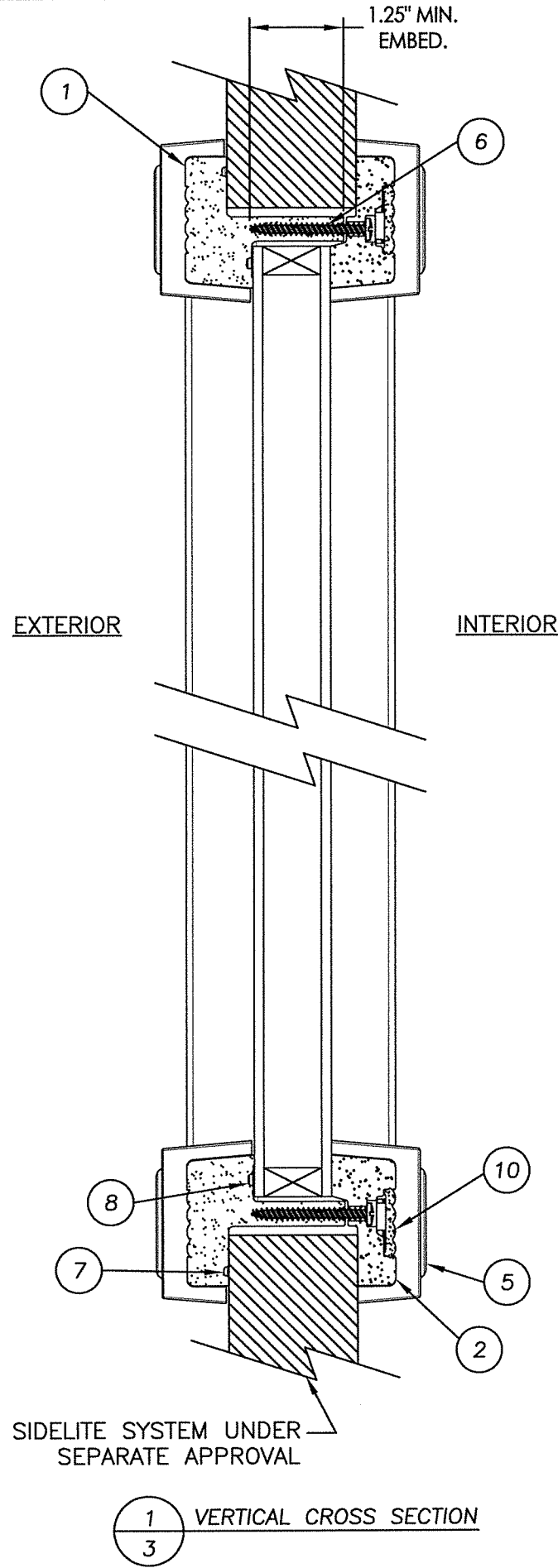

August 07, 2020

Documents Prepared By: Lyndon F. Schmidt P.E. No. 43409

STATE OF FLORIDA PROFESSIONAL ENGINEER

No. 43409

R.W. BUILDING CONSULTANTS, INC. P.O. Box 230, Valrico, FL 33595 Phone No.: 813.659.9197 FBPE Registry No. 9813

PRODUCT: ODL/WESTERN REFLECTIONS FLUTED ARCHITECTURAL SERIES DOORGLASS ASSEMBLY

PART OR ASSEMBLY: GLAZING DETAIL & CROSS SECTIONS (SIDELITE)

NO.	DATE	BY	REVISIONS
3	8/50/20	DAC	UPDATE TO 7TH ED. (2020) FBC
2	9/26/17	JK	UPDATE TO 6TH ED. (2017) FBC
1	3/28/15	JK	UPDATE TO 5TH ED. (2014) FBC

DATE: 2/29/12

SCALE: N.T.S.

DWG. BY: JK

CHK. BY: LFS

DRAWING NO.: FL-15260.2

SHEET 3 OF 4

\\dc01\wbc\clients\ODL, Inc. PERMANENTVA - Florida Product Approvals\FL-15260 Exterior Door Components - Lite Frame InsertsC - Lite Frame InsertsC - Drawings\FL 15260 (2020) R9\FL-15260.1-2.dwg

ITEM	DESCRIPTION	MATERIAL
1	EXTERIOR FRAME, FULL LIGHT, SIDELITE *	CELLULAR PVC
2	INTERIOR FRAME, FULL LIGHT, SIDELITE *	CELLULAR PVC
5	MEDALLION, SIDELITE	HP PLASTIC
6	PPH SCR, #8 X 1.5", 24 Pc./BAG	STEEL
7	SYNTHETIC RUBBER	RUBBER
8	BUTYL	BUTYL
9	PPH SCR, #8 X 3/4", 24 Pc./BAG	STEEL
10	SIDELITE SCREW COVER	CELLULAR PVC
11	EXTERIOR FRAME, FULL LIGHT, DOOR *	CELLULAR PVC
12	INTERIOR FRAME, FULL LIGHT, DOOR *	CELLULAR PVC
15	MEDALLION, DOOR	HP PLASTIC
16	DOOR SCREW COVER	CELLULAR PVC
17	CORNER CAP, SIDELITE	HP PLASTIC
18	CORNER CAP, DOOR	HP PLASTIC

\* CELLULAR PVC EXTRUSIONS SHALL BE BY ROYAL MOULDINGS PRODUCED UNDER A CURRENT PLASTICS MATERIAL APPROVAL.

**SPECIFICATION FOR DOOR AND SIDELITE PANELS:**

THE ODL/WESTERN REFLECTIONS CELLULAR PVC DOORGLASS ASSEMBLY COMPONENT IS APPROVED UNDER THIS STATEWIDE PRODUCT APPROVAL. THE SINGLE GLAZED DOOR SYSTEM AND SIDELITE SYSTEM SHOWN ARE UNDER SEPARATE CURRENT STATEWIDE PRODUCT APPROVALS. THE DOOR AND SIDELITE (MAX. PANEL SIZE OF 36" WIDE X 96" HIGH) MUST MEET THE FOLLOWING MINIMUM REQUIREMENTS TO BE QUALIFIED WITH THIS DOORGLASS COMPONENT:

**I. STEEL DOOR, SWINGING TYPE (1-3/4" MIN THICK PANEL):**

1. BOTTOM RAIL: 0.020" MIN. THICK STEEL OR BETTER.
2. STILE: 1.715" X 1.000" (WOOD STILE)
3. TOP RAIL: 1.715" X 1.000" (WOOD RAIL)
4. FOAM CORE: APPROVED 2-2.5#/FT<sup>3</sup> DENSITY URETHANE OR 2.0#/FT<sup>3</sup> DENSITY POLYSTYRENE, COMPLYING TO FBC.

**II. STEEL FIXED SIDELITE (1-3/4" MIN. THICK PANEL):**

1. TOP & BOTTOM RAIL: 1.715" X 1.000" (WOOD RAIL)
2. STILES: 1.715" X 1.000" (WOOD STILE)
3. FOAM CORE: APPROVED 2-2.5#/FT<sup>3</sup> DENSITY URETHANE OR 2.0#/FT<sup>3</sup> DENSITY POLYSTYRENE, COMPLYING TO FBC.

**III. FIBERGLASS DOOR. (WOOD EDGE). 1-3/4" MIN THK. PANEL.**

1. HINGE STILE: OSB 1.100" X 1.450"
2. LATCH STILE: OSB 3.780" X 1.450"
3. STILE CAP: HARDWOOD .372" X 1.450"
4. TOP RAIL: COMPOSITE 1.450" X .940"
5. BOTTOM RAIL: COMPOSITE 1.450" X .800"
6. FOAM CORE: APPROVED 2-2.5 #/FT<sup>3</sup> DENSITY URETHANE OR 2.0 #/FT<sup>3</sup> DENSITY POLYSTYRENE COMPLYING TO FBC.

**IV. FIBERGLASS FIXED SIDELITE. (WOOD EDGE). 1-3/4" MIN THK. PANEL.**

1. STILE: COMPOSITE 1.186" X 1.620"
2. TOP RAIL: COMPOSITE 1.620" X 1.125"
3. BOTTOM RAIL: COMPOSITE 1.620" X 1.066"
4. FOAM CORE: APPROVED 2-2.5 #/FT<sup>3</sup> DENSITY URETHANE OR 2.0 #/FT<sup>3</sup> DENSITY POLYSTYRENE COMPLYING TO FBC.

**V. DOOR & SIDELITE SKINS**

1. STEEL DOOR AND SIDELITE SKIN 0.020" THK.
2. FIBERGLASS DOOR SKIN 0.125" THK.
3. FIBERGLASS SIDELITE SKIN 0.083" THK.

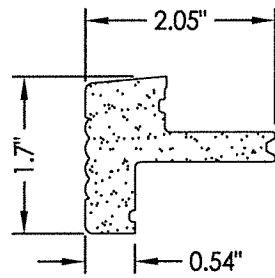

1 EXTERIOR LITEFRAME SIDELITE

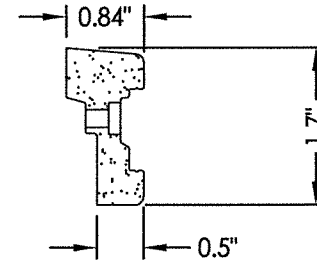

2 INTERIOR LITEFRAME SIDELITE

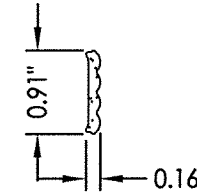

10 SCREW COVER SIDELITE

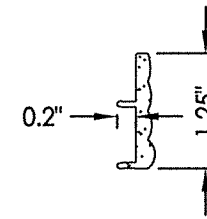

16 SCREW COVER DOOR

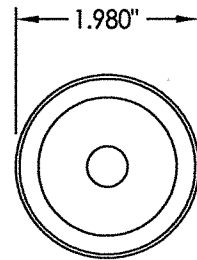

15 MEDALLION DOOR

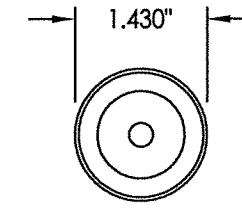

5 MEDALLION SIDELITE

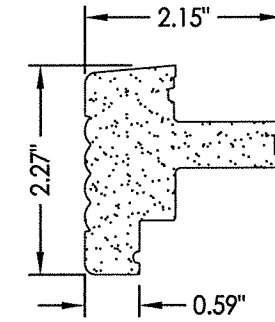

11 EXTERIOR LITEFRAME DOOR

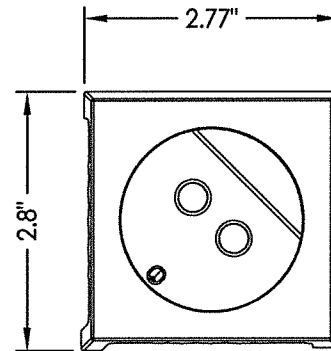

18 CORNER CAP DOOR

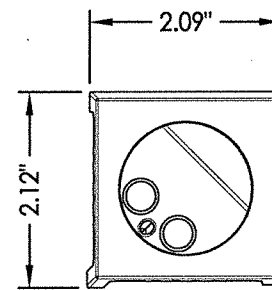

17 CORNER CAP SIDELITE

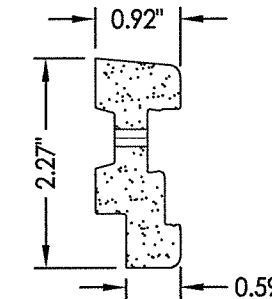

12 INTERIOR LITEFRAME DOOR

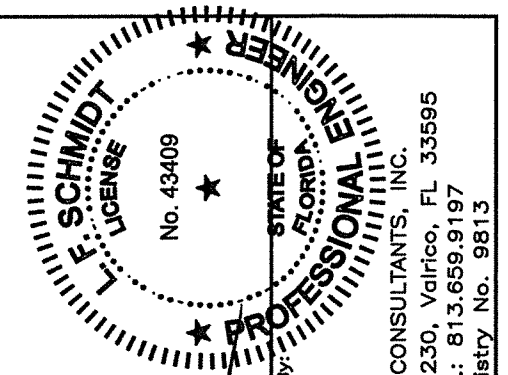

August 07, 2020

Documents Prepared By:  
Lyndon F. Schmidt  
P.E. No. 43409

**R.W. BUILDING CONSULTANTS, INC.**  
P.O. Box 230, Valrico, FL 33595  
Phone No.: 813.659.9197  
FBPE Registry No. 9813

PRODUCT:  
ODL/WESTERN REFLECTIONS  
FLUTED ARCHITECTURAL SERIES  
DOORGLASS ASSEMBLY  
PART OR ASSEMBLY:  
BILL OF MATERIALS  
& COMPONENTS

NO.	DATE	REVISIONS
3	8/50/20	UPDATE TO 7TH ED. (2020) FBC
2	9/26/17	UPDATE TO 6TH ED. (2017) FBC
1	3/28/15	UPDATE TO 5TH ED. (2014) FBC

DATE: 2/29/12  
SCALE: N.T.S.  
DWG. BY: JK  
CHK. BY: LFS  
DRAWING NO.: FL-15260.2  
SHEET 4 OF 4

© 2012 R.W. BUILDING CONSULTANTS INC.