

Richard A. Baumann
 F.P.E #36469
 T.P.E # 85227
 698 Timber Creek Road
 Dixon Illinois 61021

REV.	DESCRIPTION	ECO	DATE	ECO
A	RELEASE FOR PRODUCTION	6338.02	08/02/12	

SCALE: NONE
DRAWN BY: G. WEDEKIND
CHECKED BY: G. WEDEKIND
DATE: 08/02/12
ECO: 6338.02



TITLE: SPEC, WINDLOAD TC200		
NO. P-2413	SHEET 1 OF 4	REV A

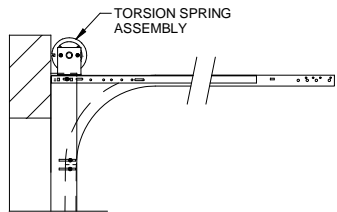

NORMAL HEADROOM TRACK
2" TRACK ANGLE MOUNT SHOWN
2" TRACK BRACKET MOUNT AVAILABLE
3" TRACK ANGLE MOUNT AVAILABLE

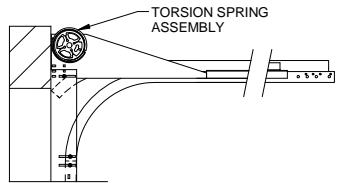

FRONT MOUNT LOW HEADROOM TRACK
2" TRACK ANGLE MOUNT SHOWN
2" TRACK BRACKET MOUNT AVAILABLE
3" TRACK ANGLE MOUNT AVAILABLE

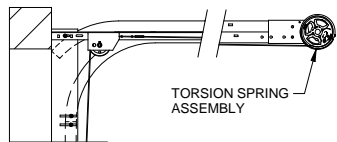

REAR MOUNT LOW HEADROOM TRACK
2" TRACK ANGLE MOUNT SHOWN
2" TRACK BRACKET MOUNT AVAILABLE
3" TRACK ANGLE MOUNT AVAILABLE

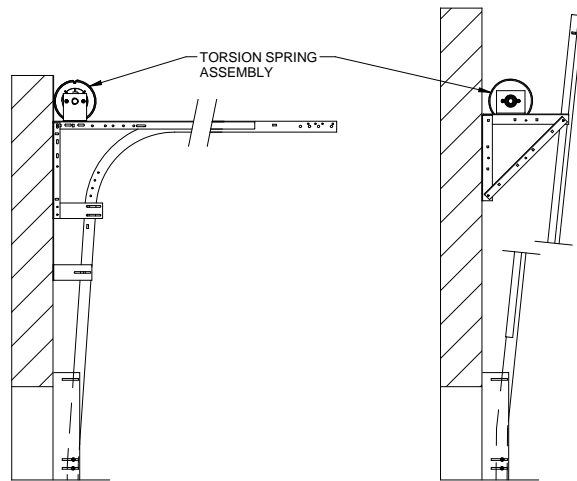

LIFT CLEARANCE TRACK
2" TRACK ANGLE MOUNT SHOWN
2" TRACK BRACKET MOUNT AVAILABLE
3" TRACK ANGLE MOUNT AVAILABLE

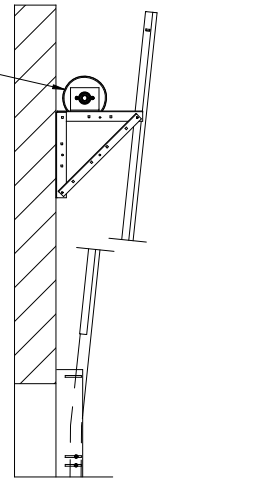

VERTICAL LIFT TRACK
2" TRACK ANGLE MOUNT SHOWN
2" TRACK BRACKET MOUNT AVAILABLE
3" TRACK ANGLE MOUNT AVAILABLE

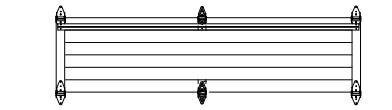

1 CENTER STILE
8'-2" WIDE

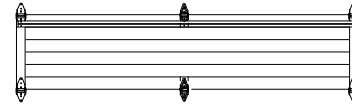

1 CENTER STILE
9'-2" WIDE

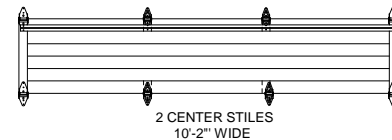

2 CENTER STILES
10'-2" WIDE

HINGE ROW LAYOUT
INTERIOR VIEW

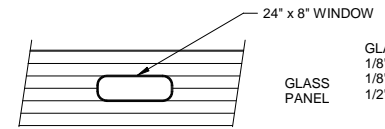

24" x 8" WINDOW
GLASS PANEL
GLASS OPTIONS:
1/8" DSB
1/8" ACRYLIC
1/2" INSULATED GLASS

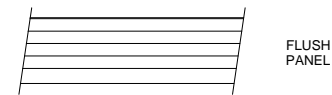

FLUSH PANEL
PANEL OPTIONS
EXTERIOR VIEW

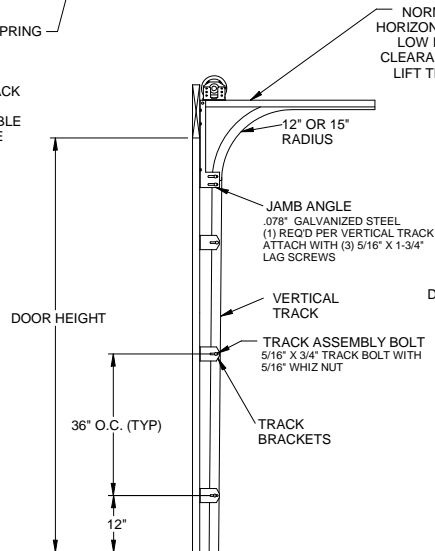
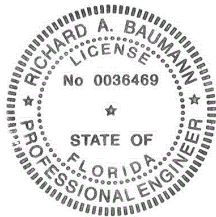

TYPICAL TRACK INSTALLATION
BRACKET MOUNT
WOOD JAMBS

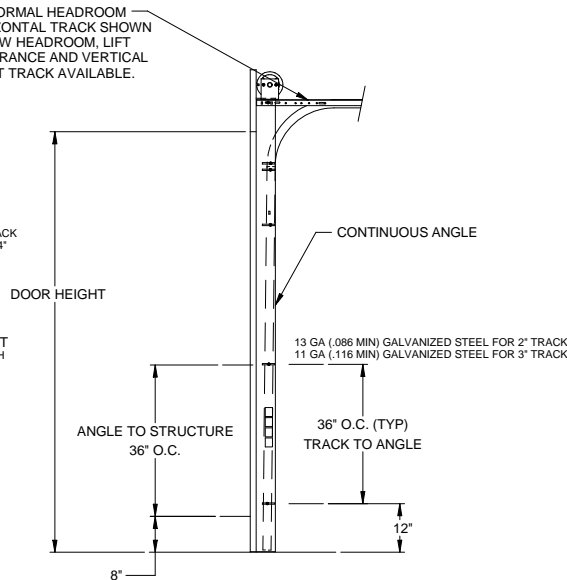

TYPICAL TRACK INSTALLATION
ANGLE MOUNT
WOOD, STEEL OR MASONRY
JAMBS

Richard A. Baumann
F.P.E #36469
T.P.E # 85227
698 Timber Creek Road
Dixon Illinois 61021

SCALE: NONE
DRAWN BY: G. WEDEKIND
CHECKED BY: G. WEDEKIND
DATE: 08/02/12
ECO: 6338.02



TITLE: SPEC. WINDLOAD
TC200

NO. P-2413

SHEET 2 OF 4
REV A

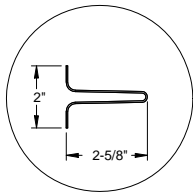

STEEL U-BAR DETAIL
18 GA. (.049" MIN) GALVANIZED
HIGH TENSILE STEEL 80 KSI MINIMUM YIELD

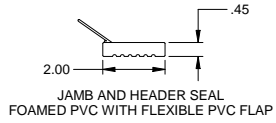

JAMB AND HEADER SEAL
FOAMED PVC WITH FLEXIBLE PVC FLAP

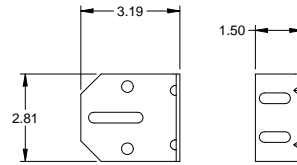

3" TRACK BRACKET
.116 GALV. STEEL

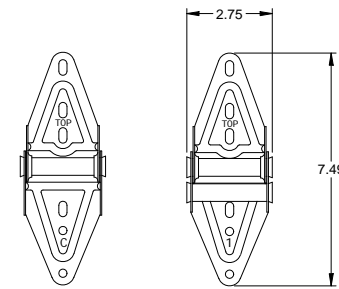

CENTER HINGE
.045 GALV. STEEL

EDGE HINGE
.086 GALV. STEEL

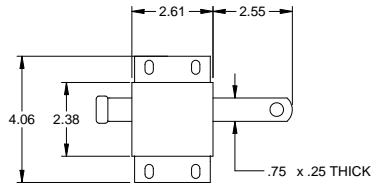

SLIDE LOCK
CASE .086 GALV. STEEL

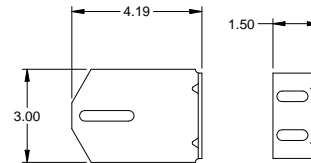

4" TRACK BRACKET
.116 GALV. STEEL

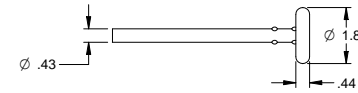

TRACK ROLLER

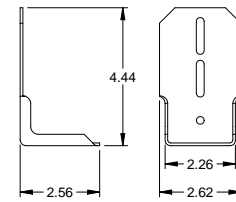

TOP FIXTURE
.086 GALV. STEEL

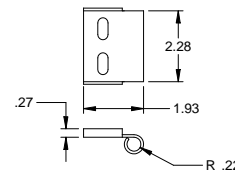

TOP ROLLER CARRIER
.086 GALV. STEEL
ATTACHED TO TOP FIXTURE WITH
(2) TRACK BOLTS AND WHIZ NUTS

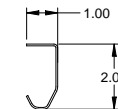

TRACK
.055 GALV. STEEL

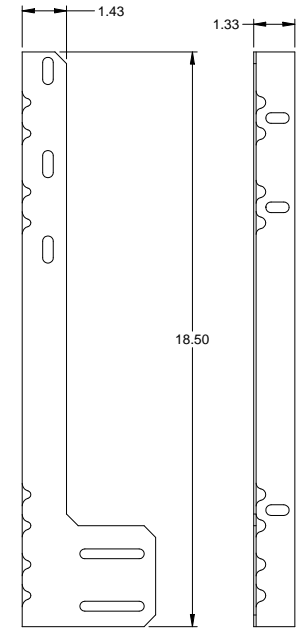

JAMB ANGLE
.078 GALV. STEEL

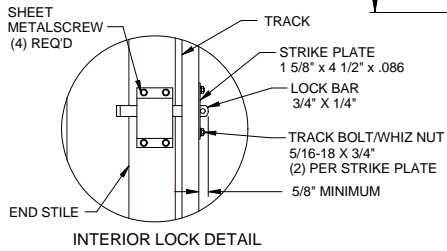

INTERIOR LOCK DETAIL

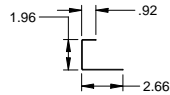

END STILE
.043 GALV. STEEL

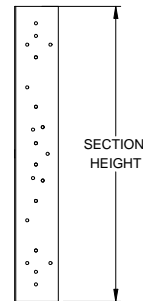

SECTION
HEIGHT

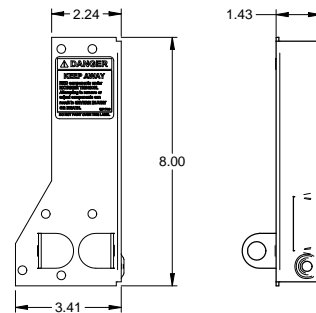

CORNER BRACKET
.086 GALV. STEEL

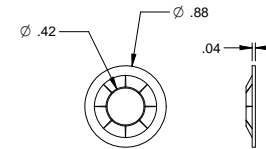

RETAINING NUT

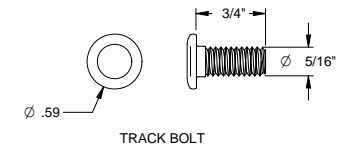

TRACK BOLT

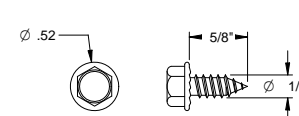

SHEET METAL SCREW

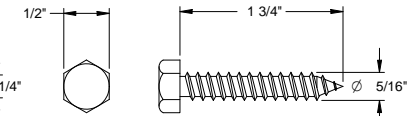

HEX HEAD LAG SCREW

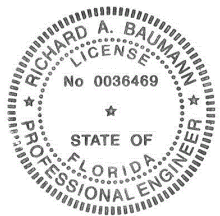

Richard A. Baumann
F.P.E #36469
T.P.E # 85227
698 Timber Creek Road
Dixon Illinois 61021

SCALE: NONE
DRAWN BY: G. WEDEKIND
CHECKED BY: G. WEDEKIND
DATE: 08/02/12
ECO: 6338.02



TITLE: SPEC. WINDLOAD
TC200

NO. P-2413

SHEET 3 OF 4
REV A

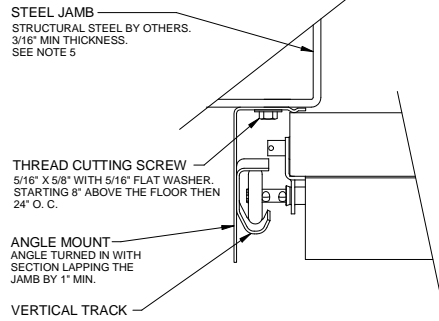

TRACK ASSEMBLY ATTACHMENT TO STEEL JAMB
2\"/>

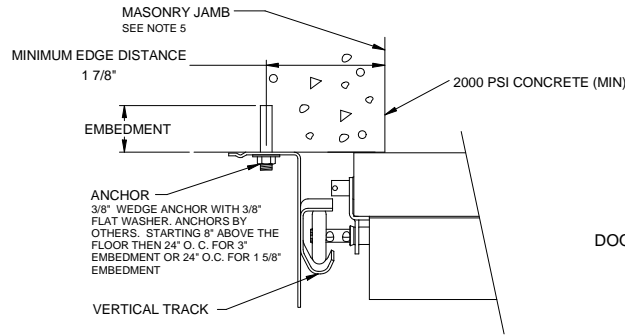

TRACK ASSEMBLY ATTACHMENT TO MASONRY JAMB
2\"/>

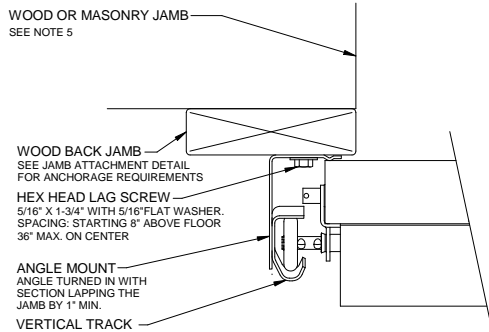
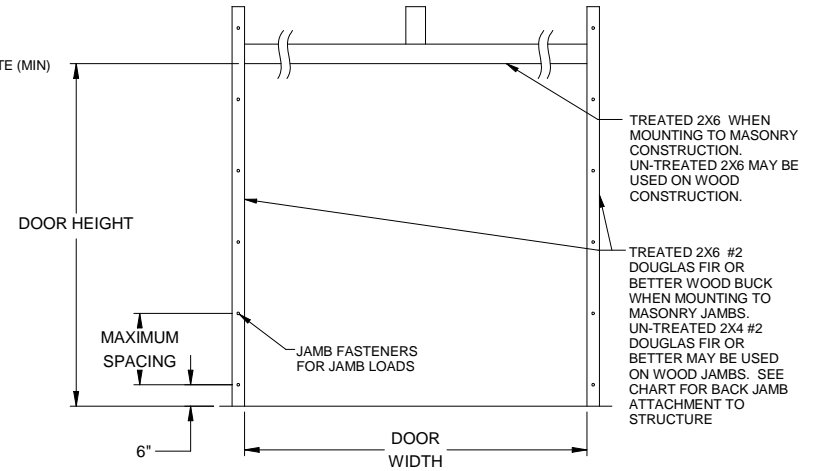

TRACK ASSEMBLY ATTACHMENT TO WOOD BACK JAMB
2\"/>

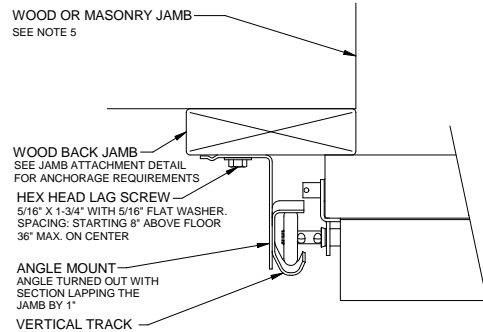

TRACK ASSEMBLY ATTACHMENT TO WOOD BACK JAMB
2\"/>

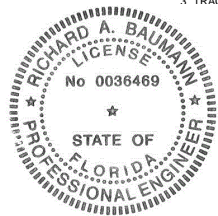

JAMB ATTACHMENT NOTES

1. 1/4" DIAMETER ANCHORS REQUIRE 5/8" MIN. O.D. STEEL WASHER.
2. 5/16" AND 3/8" DIAMETER FASTENERS REQUIRE 7/8" MIN O.D. STEEL WASHER.
3. MAXIMUM POSITIVE LOAD PER JAMB = (10'-2" X 30.0 PSF) / 2 = 153 LBS PER FOOT
4. MAXIMUM NEGATIVE LOAD PER JAMB = (10'-2" X 34.0 PSF) / 2 = 173 LBS PER FOOT.
5. DESIGN OF THE SUPPORTING STRUCTURE SHALL BE THE SOLE RESPONSIBILITY OF THE BUILDING DESIGNER AND SHALL BE DESIGNED FOR THE JAMB LOADS LISTED IN NOTES 3 AND 4.
6. ALTERNATE JAMB ATTACHMENTS MAY BE USED IF APPROVED BY A REGISTERED PROFESSIONAL ENGINEER.

JAMB ATTACHMENT

1/4" ITW BUILDEX TAPCON				
JAMB TYPE	EMBEDMENT	EDGE DISTANCE	ALLOWABLE TENSION LOAD	MAXIMUM ON CENTER SPACING
2000 PSI CONCRETE	1-3/4"	2-1/2"	505	24"
3000 PSI CONCRETE	1-3/4"	2-1/2"	550	24"
5/16" ITW BUILDEX TAPCON				
3000 PSI CONCRETE	1-3/4"	2 3/16"	563	24"
POWER ANCHOR - 3/8" WEDGE ANCHOR				
2000 PSI CONCRETE	1-5/8"	1-7/8"	360	24"
	3"	1-7/8"	768	24"
5/16" LAG SCREW				
SPRUCE, PINE, FIR (G = .42)	1-1/2"	1-3/4"	307	24"
DOUGLAS FIR (G = .46)	1-1/2"	1-3/4"	352	24"
SOUTHERN YELLOW PINE (G = .55)	1-1/2"	1-3/4"	460	24"
3/8" LAG SCREW				
SPRUCE, PINE, FIR (G = .42)	1-1/2"	1-3/4"	352	24"
DOUGLAS FIR (G = .46)	1-1/2"	1-3/4"	403	24"
SOUTHERN YELLOW PINE (G = .55)	1-1/2"	1-3/4"	528	24"
5/16 X 5/8 THREAD CUTTING SCREW				
STEEL A 36	3/16"	1/2"	1048	24"

Richard A. Baumann
F.P.E #36469
T.P.E # 85227
698 Timber Creek Road
Dixon Illinois 61021

SCALE: NONE	 1101 EAST RIVER ROAD DIXON, IL 61021	TITLE: SPEC, WINDLOAD TC200
DRAWN BY: G. WEDEKIND		NO. P-2413
CHECKED BY: G. WEDEKIND		
DATE: 08/02/12		REV A
ECO: 6338.02		