

Door Height	Top Section Height	Intermediate Section Height	Intermediate Section Height	Intermediate Section Height	Bottom Section Height
7'-0"	28"	28"	N/A	N/A	28"
8'-0"	28"	22 21/32"	22 21/32"	N/A	22 21/32"
9'-0"	28"	26 21/32"	26 21/32"	N/A	26 21/32"
10'-0"	28"	23"	23"	23"	23"

DOORS TESTED TO ANSI/DASMA 108 DESIGN LOAD = + 31.5 / - 35.1 PSF

SCALE: NONE		DRAWN BY: M. REUTZEL		TITLE: SPEC, WIND LOAD ARBORSHORE	
CHECKED BY: GW		DATE: 05/26/10		 <small>800 HILLCREST BLVD. ROAD DUNN, IL 60119</small>	
REV. A RELEASED FOR PRODUCTION		5824.01	05/26/10		
REV.	DESCRIPTION	ECN NO.	DATE	ECN NO.	REV

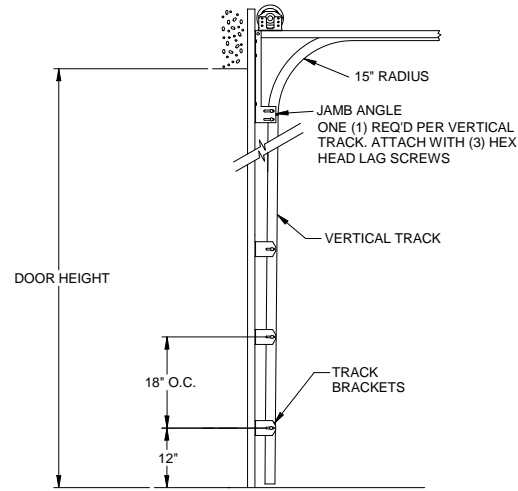
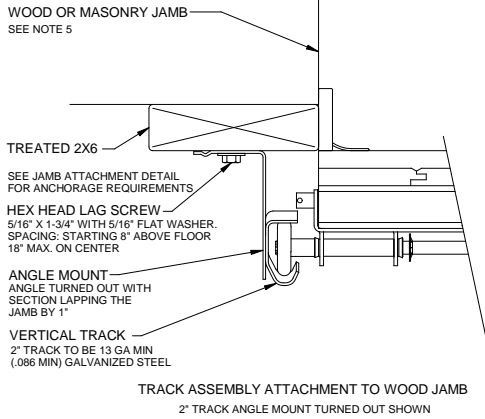

TYPICAL TRACK INSTALLATION
NORMAL HEADROOM TRACK SHOWN, LOW HEADROOM, LIFT CLEARANCE AND VERTICAL LIFT TRACK AVAILABLE

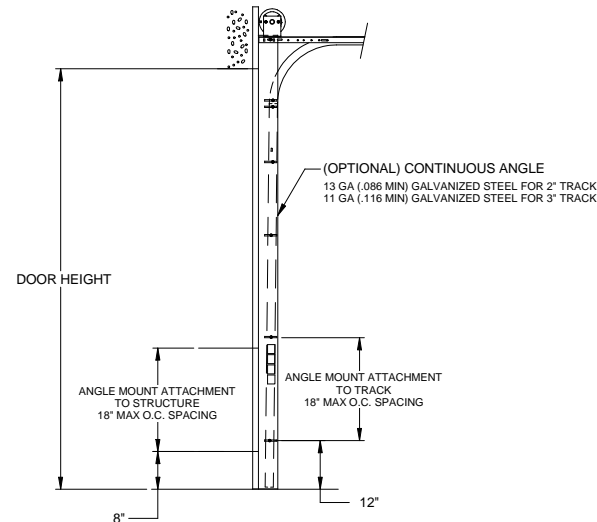

TYPICAL TRACK INSTALLATION ANGLE MOUNT
NORMAL HEADROOM TRACK SHOWN, LOW HEADROOM, LIFT CLEARANCE AND VERTICAL LIFT TRACK AVAILABLE

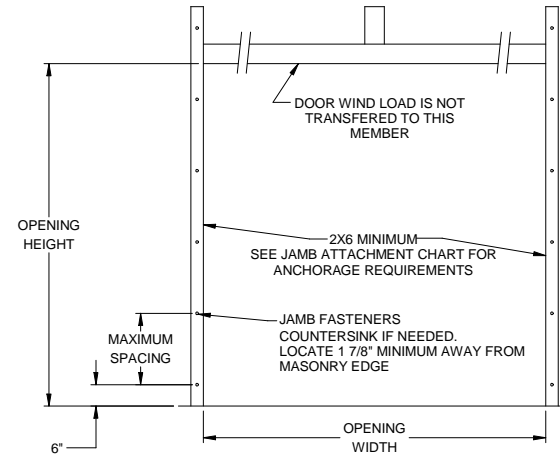

JAMB ATTACHMENT TO STRUCTURE

1/4" ITW BUILDEX TAPCON				
WALL CONSTRUCTION	EMBEDMENT	EDGE DISTANCE	ALLOWABLE TENSION LOAD	MAXIMUM ON CENTER SPACING
HOLLOW BLOCK	1-1/4"	1"	117	8-7/8"
2000 PSI CONCRETE	1-3/4"	2-1/2"	508	36"
3000 PSI CONCRETE	1-3/4"	1"	510	36"
5/16" ITW BUILDEX TAPCON				
3000 PSI CONCRETE	1-3/4"	2 3/16"	563	36"
POWER ANCHOR - 3/8" WEDGE ANCHOR				
2000 PSI CONCRETE	1-5/8"	1-7/8"	360	36"
	3"	1-7/8"	768	36"
5/16" LAG SCREW				
SPRUCE, PINE, FIR (G = .42)	1-1/2"	1-3/4"	307	23-1/4"
DOUGLAS FIR (G = .49)	1-1/2"	1-3/4"	387	29-3/8"
SOUTHERN YELLOW PINE (G = .55)	1-1/2"	1-3/4"	460	35"
3/8" LAG SCREW				
SPRUCE, PINE, FIR (G = .42)	1-1/2"	1-3/4"	352	26-3/4"
DOUGLAS FIR (G = .49)	1-1/2"	1-3/4"	444	33-3/4"
SOUTHERN YELLOW PINE (G = .55)	1-1/2"	1-3/4"	528	36"

JAMB ATTACHMENT NOTES

- 1/4" DIAMETER ANCHORS REQUIRE 5/8" MIN. O.D. STEEL WASHER.
- 5/16" AND 3/8" DIAMETER FASTENERS REQUIRE 7/8" MIN O.D. STEEL WASHER.
- MAXIMUM POSITIVE LOAD PER JAMB = (10'-0" X 31.5 PSF) / 2 = 157.5 LBS PER FOOT
- MAXIMUM NEGATIVE LOAD PER JAMB = (10'-0" X 35.1 PSF) / 2 = 175.5 LBS PER FOOT.
- DESIGN OF THE SUPPORTING STRUCTURE SHALL BE THE SOLE RESPONSIBILITY OF THE BUILDING DESIGNER AND SHALL BE DESIGNED FOR THE JAMB LOADS LISTED IN NOTES 3 AND 4.
- 3 FASTENERS MINIMUM PER JAMB

SCALE: NONE		DRAWN BY: M. REUTZEL		TITLE: SPEC, WIND LOAD ARBORSHORE	
CHECKED BY: GW		DATE: 05/26/10			
REV		DESCRIPTION			
ECON. NO.		DATE		REV A	
ECON. NO. 5624.01					

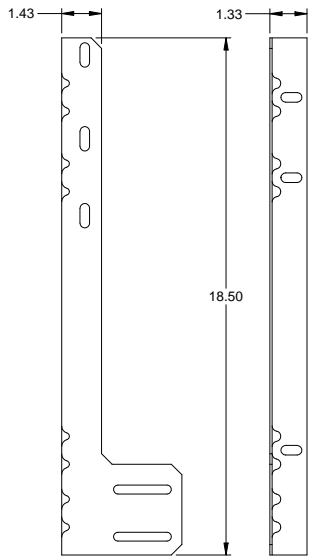

JAMB ANGLE
.078 GALV. STEEL

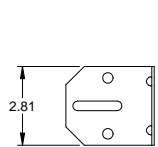

3" TRACK BRACKET
.116 GALV. STEEL

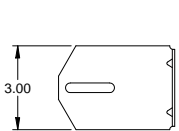

4" TRACK BRACKET
.116 GALV. STEEL

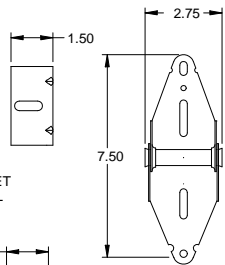

CENTER HINGE
.116 GALV. STEEL

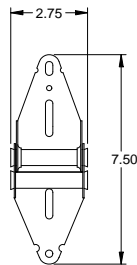

EDGE HINGE
.116 GALV. STEEL

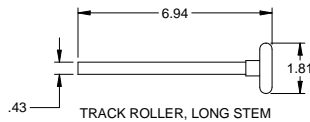

TRACK ROLLER, LONG STEM



TRACK
.086 GALV. STEEL

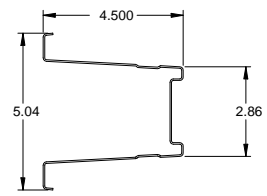

STEEL BOX STRUT DETAIL
20 GA. (.035" MIN) GALVANIZED
HIGH TENSILE STEEL 80 KSI MINIMUM YIELD

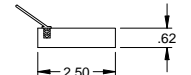

JAMB AND HEAD SEAL
WOOD WITH FLEXIBLE PVC FLAP

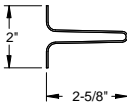

UBAR
20 GA. (.035" MIN) GALVANIZED
80 KSI MINIMUM TENSILE

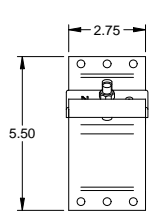

TOP FIXTURE

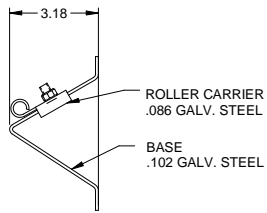

ROLLER CARRIER
.086 GALV. STEEL
BASE
.102 GALV. STEEL

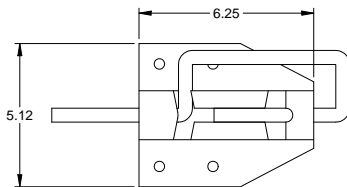

INTERIOR LOCK

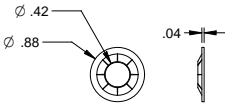

RETAINING NUT

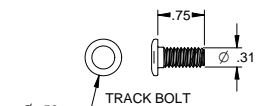

TRACK BOLT

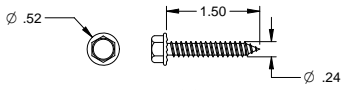

HEX HEAD LAG SCREW

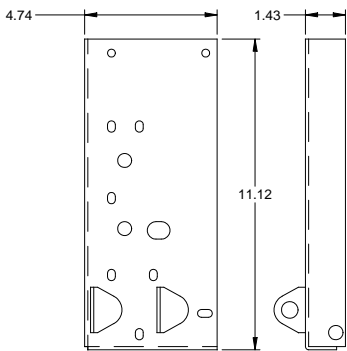

CORNER BRACKET
.116 GALV. STEEL

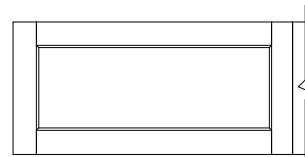

SINGLE PANE WINDOW DESIGN

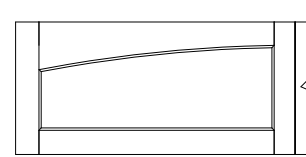

ARCHED SINGLE PANE WINDOW DESIGN

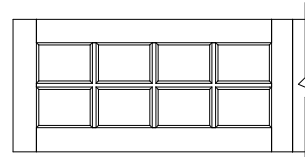

4-OVER-4 WINDOW WINDOW DESIGN (SWING-OUT ONLY)
ARBORSHORE: TRUE DIVIDED GLASS
STREAMWOOD: SIMULATED DIVIDED GLASS

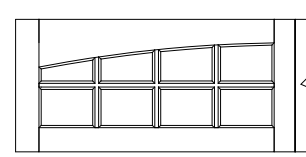

ARCHED 4-OVER-4 WINDOW WINDOW DESIGN (SWING-OUT ONLY)
ARBORSHORE: TRUE DIVIDED GLASS
STREAMWOOD: SIMULATED DIVIDED GLASS

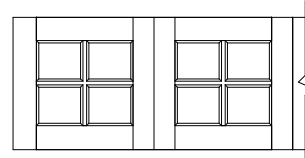

2-OVER-2 WINDOW WINDOW DESIGN (BI-FOLD ONLY)
ARBORSHORE: TRUE DIVIDED GLASS
STREAMWOOD: SIMULATED DIVIDED GLASS

GLAZING OPTIONS	
1/8" CLEAR TEMPERED	
1/2" CLEAR INSULATED TEMPERED	
1/2" INSULATED ANTIQUE SEEDED	

REV	DESCRIPTION	ECH. NO.	DATE	SCALE: NONE	DRAWN BY: M. REUTZEL	CHECKED BY: GW	DATE: 05/26/10	ECH. NO.: 5824.01	TITLE: SPEC. WIND LOAD ARBORSHORE



NO. P-2308	SHEET 3 OF 3	REV A
------------	--------------	-------