

SECTION SCHEDULE					
DOOR HEIGHT	#1 BOTTOM SECTION	#2 INTERMEDIATE SECTION	#3 INTERMEDIATE SECTION	#4 INTERMEDIATE SECTION	#5 TOP SECTION
6'-0"	24"	24"	24"	24"	24"
6'-6"	18"	18"	18"	24"	24"
7'-0"	18"	24"	18"	24"	24"
7'-6"	24"	18"	24"	24"	24"
8'-0"	24"	24"	24"	24"	24"
8'-6"	24"	18"	18"	18"	24"
9'-0"	24"	18"	18"	24"	24"
9'-6"	24"	24"	18"	24"	24"
10'-0"	24"	24"	24"	24"	24"

STEEL SECTION
 25 GAUGE HOT DIPPED GALVANIZED STEEL EXTERIOR SKIN ROLL-FORMED WITH WOOD GRAIN EMBOSSED TEXTURE FINISHED WITH A BAKED ON POLYESTER TOP COAT OVER AN EPOXY PRIMER

25 GAUGE HOT DIPPED GALVANIZED STEEL INTERIOR SKIN ROLL-FORMED WITH STUCCO EMBOSSED TEXTURE FINISHED WITH A BAKED ON POLYESTER TOP COAT OVER AN EPOXY PRIMER

DECORATIVE EXTERIOR TRIM BOARDS TRIM BOARDS ADDED TO EXTERIOR OF BASE DOOR TO CREATE CARRIAGE HOUSE LOOK. LOCATION AND QUANTITY OF BOARDS WILL VARY.

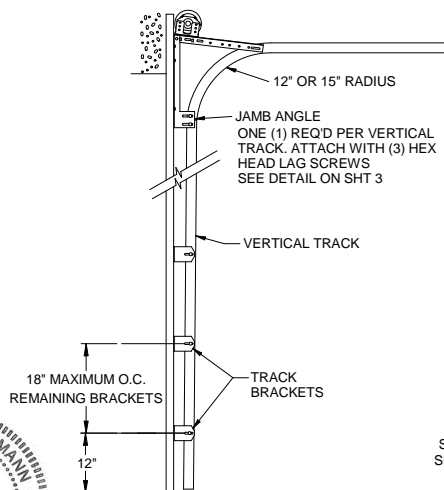
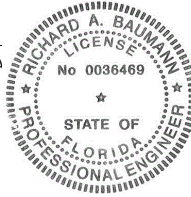
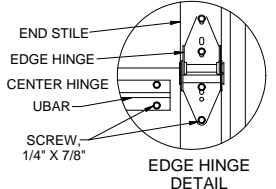
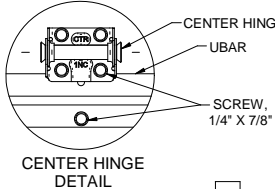
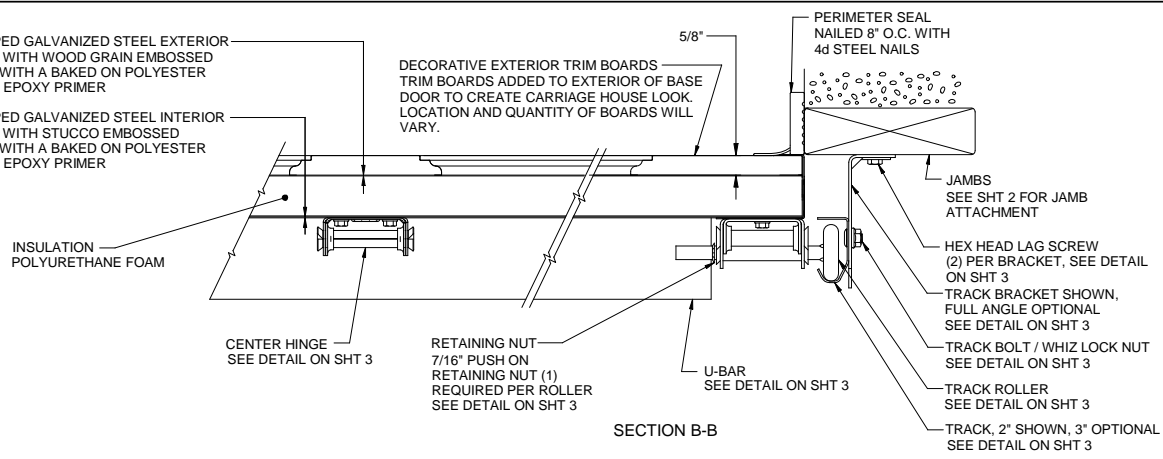

TOP FIXTURE SEE DETAIL ON SHT 3

WINDOWS, OPTIONAL SEE DETAILS ON SHT 2

STEEL REINFORCEMENT ONE (1) U-BAR PER SECTION, FASTENED USING (2) SHEET METAL SCREWS AT EACH STILE

LOCKS REQUIRED ON DOORS NOT ELECTRICALLY OPERATED SEE DETAILS ON SHT 3

ROLLER CARRIER SEE DETAIL ON SHT 3

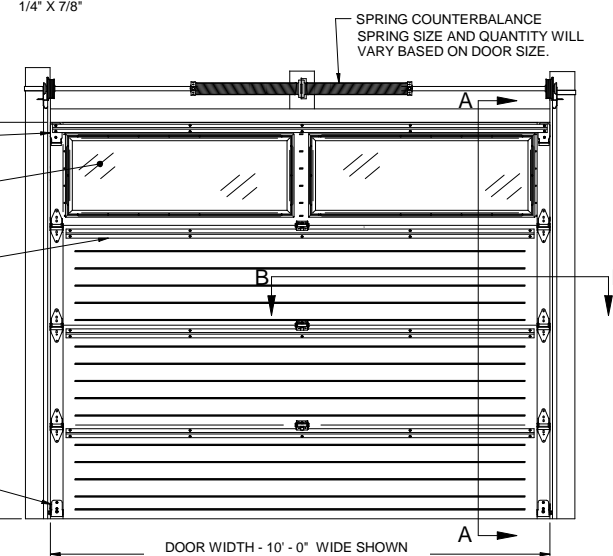

DOORS TESTED PER ANSI/DASMA 108 FOR STATIC AIR PRESSURE

DOOR WIDTH	PSF RATING WITH OR WITHOUT WINDOWS	
	DESIGN LOAD	
10'-0"	+31.0	-35.0

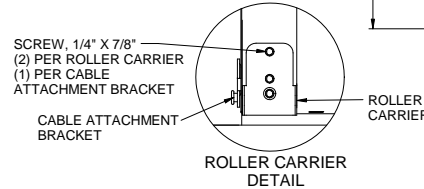

Richard A. Baumann
 F.P.E. #36469
 T.P.E. #85227
 698 Timber Creek Road
 Dixon Illinois 61021

REV.	DESCRIPTION	ECO	DATE	ECO
A	PRODUCTION RELEASE	6338.02	08/02/12	

SCALE: NONE
 DRAWN BY: G. WEDEKIND
 CHECKED BY: G. WEDEKIND
 DATE: 08/02/12
 ECO: 6338.02



TITLE: SPEC. WINDLOAD ROCKCREEKE 10'-0" MAX. DOOR WIDTH

NO. P-2306	SHEET 1 OF 3	REV A
------------	--------------	-------

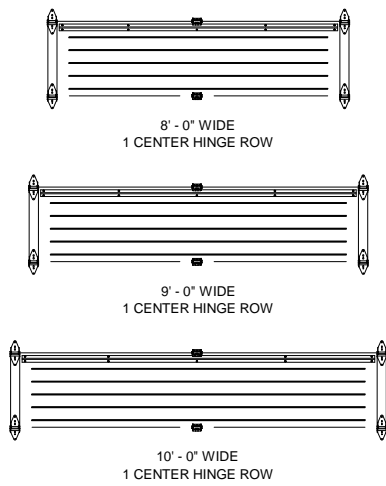

CENTER HINGE AND U-BAR ATTACHMENT LAYOUT
INTERIOR VIEW
INTERMEDIATE SECTION SHOWN

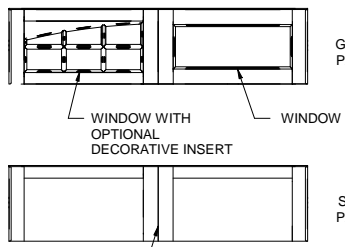

GLASS OPTIONS:
1/8" DSB
1/2" INSULATED GLASS

TRIM BOARDS
ARRANGEMENT OF
BOARDS WILL VARY

PANEL OPTIONS
EXTERIOR VIEW

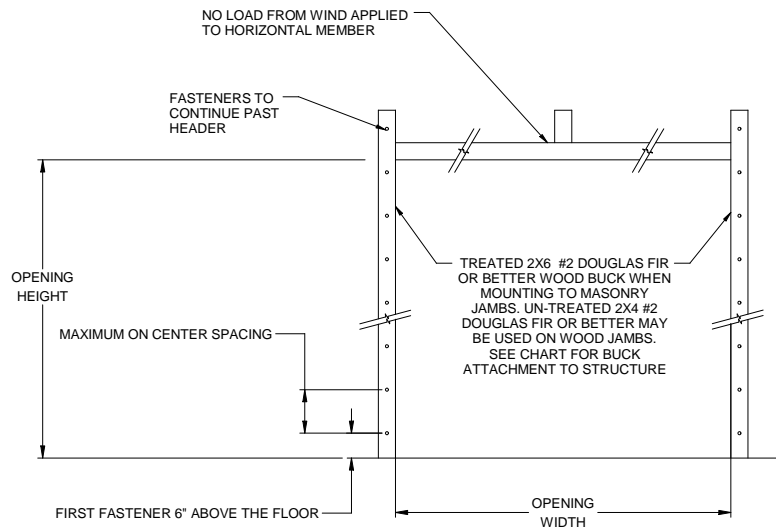

JAMB ATTACHMENT NOTES

1. 1/4" DIAMETER ANCHORS REQUIRE 1" MIN. O.D. STEEL WASHER AND 2-1/2" MIN. EDGE DISTANCE.
2. 5/16" AND 3/8" DIAMETER FASTENERS REQUIRE 7/8" MIN O.D. STEEL WASHER AND 3" MIN. EDGE DISTANCE.
3. MAXIMUM POSITIVE LOAD PER JAMB = (10' X 31.0 PSF) / 2 = 155 LBS PER FOOT.
4. MAXIMUM NEGATIVE LOAD PER JAMB = (10' X 35.0 PSF) / 2 = 175 LBS PER FOOT.
5. DESIGN OF THE SUPPORTING STRUCTURE SHALL BE THE SOLE RESPONSIBILITY OF THE BUILDING DESIGNER AND SHALL BE DESIGNED FOR THE JAMB LOADS LISTED IN NOTES 3 AND 4.
6. ALTERNATE JAMB ATTACHMENTS MAY BE USED IF APPROVED BY A REGISTERED PROFESSIONAL ENGINEER.

JAMB MATERIAL	FASTENER TYPE	MINIMUM EMBEDMENT	MINIMUM EDGE DISTANCE	ALLOWABLE TENSION LOAD	MAXIMUM ON CENTER SPACING
GROUT FILLED BLOCK	5/16" DIA X 3 1/4" LONG ITW TAPCON	1 3/4"	4"	487	24"
3192 PSI CONCRETE	1/4" DIA X 3 1/4" LONG ITW TAPCON	1 3/4"	1"	510	24"
2899 PSI CONCRETE	5/16" DIA X 3 3/4" LONG ITW TAPCON	2 1/4"	1 9/16"	713	24"
2000 PSI CONCRETE	3/8" DIA X 3 1/2" POWER STUD ANCHOR	1 5/8"	1 7/8"	360	24"
4000 PSI CONCRETE	3/8" DIA X 3 1/2" POWER STUD ANCHOR	1 5/8"	1 7/8"	570	24"
WOOD DOUGLAS FIR (G=46)	5/16" DIA. X 3 1/2"	1 1/2"	1"	352	24"
WOOD SYP (G=55)	5/16" DIA. X 3 1/2"	1 1/2"	1"	460	24"

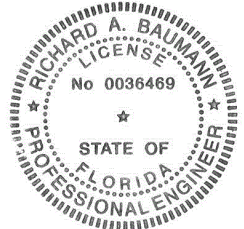

Richard A. Baumann
F.P.E. #36469
T.P.E. #85227
698 Timber Creek Road
Dixon Illinois 61021

SCALE: NONE	 1101 EAST RIVER ROAD DIXON, IL 61021	TITLE: SPEC. WINDLOAD ROCKCREEKE 10'-0" MAX. DOOR WIDTH	
DRAWN BY: G. WEDEKIND		NO. P-2306	SHEET
CHECKED BY: G. WEDEKIND			2 OF 3
DATE: 08/02/12		REV	A
ECO: 6338.02			

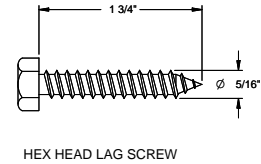
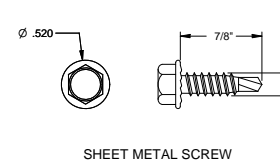
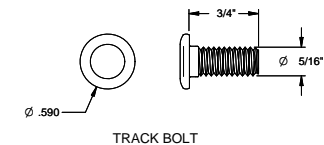
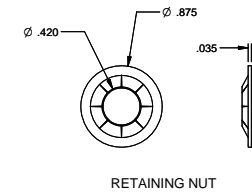
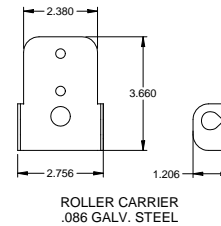
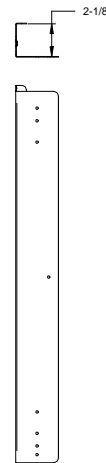
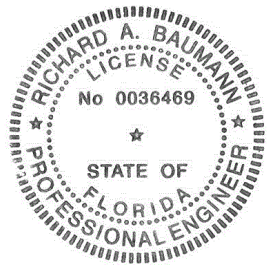
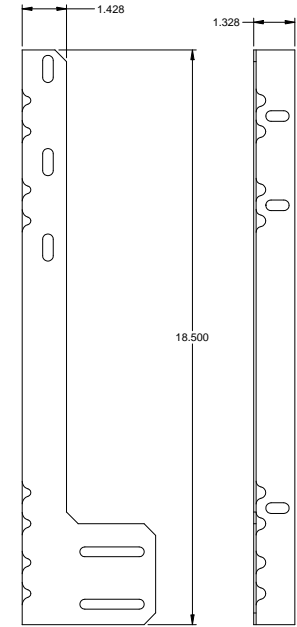
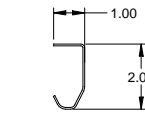
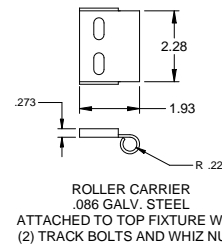
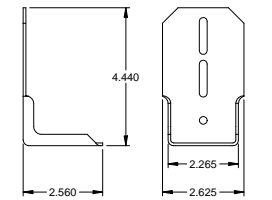
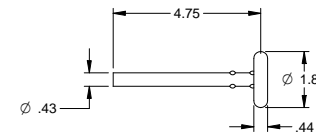
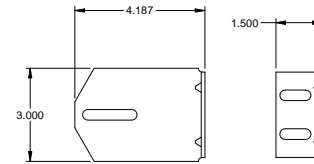
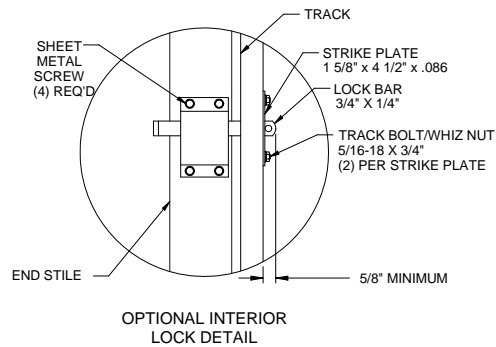
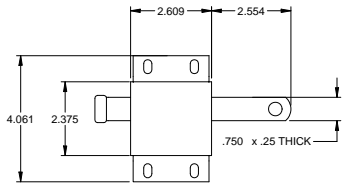
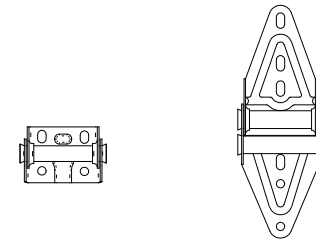
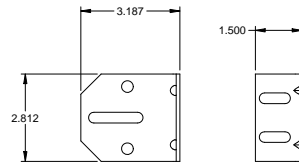
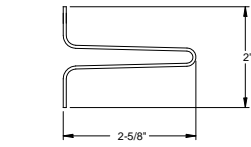
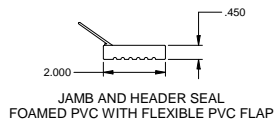

Richard A. Baumann
F.P.E. #36469
T.P.E. #85227
698 Timber Creek Road
Dixon Illinois 61021

SCALE: NONE
DRAWN BY: G. WEDEKIND
CHECKED BY: G. WEDEKIND
DATE: 08/02/12
ECO: 6338.02



TITLE: SPEC. WINDLOAD
ROCKCREEK
10'-0" MAX. DOOR WIDTH

NO. P-2306
SHEET 3 OF 3
REV A