



MODEL 2280HI-A HURRICANE IMPACT LIGHT KIT PVC DOORGLASS ASSEMBLY COMPONENT APPROVAL

"IMPACT"

GENERAL NOTES

1. This product has been evaluated and is in compliance with the 2007 Florida Building Code structural requirements including the High Velocity Hurricane Zone (HVHZ).
2. This product shall only be used as a substitute doorglass assembly in conjunction with glazed steel or fiberglass side hinged swing doors or fixed sidelites possessing a comparable current Florida Statewide product approval. The lite opening size shall not exceed the opening size approved in the glazed steel or fiberglass side hinged swing doors or fixed sidelites approval. See sheet 2 for door and sidelite panel construction specifications.
3. The design pressure (DP) rating shall be the lesser of the DP rating shown on sheet 1 of this approval or the DP rating shown in the glazed steel or fiberglass side hinged swing doors or fixed sidelites approval being used.
4. When used in areas outside of the "HVHZ" requiring wind borne debris protection this product complies with Section 1609.1.2 of the 2007 FBC and does not require an impact resistant covering.
5. When used in the "HVHZ" this product complies with section 1626 of the Florida Building Code and does not require an impact resistant covering.
6. This product meets the water infiltration requirements for "HVHZ".

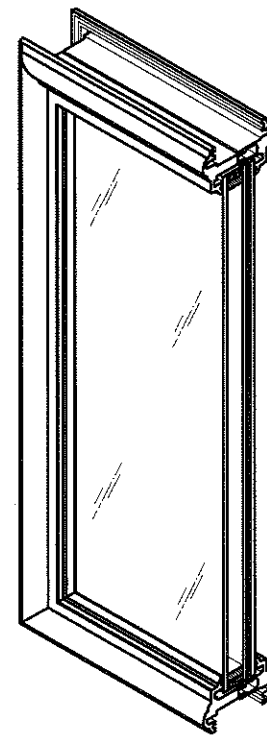

LIGHT DETAIL

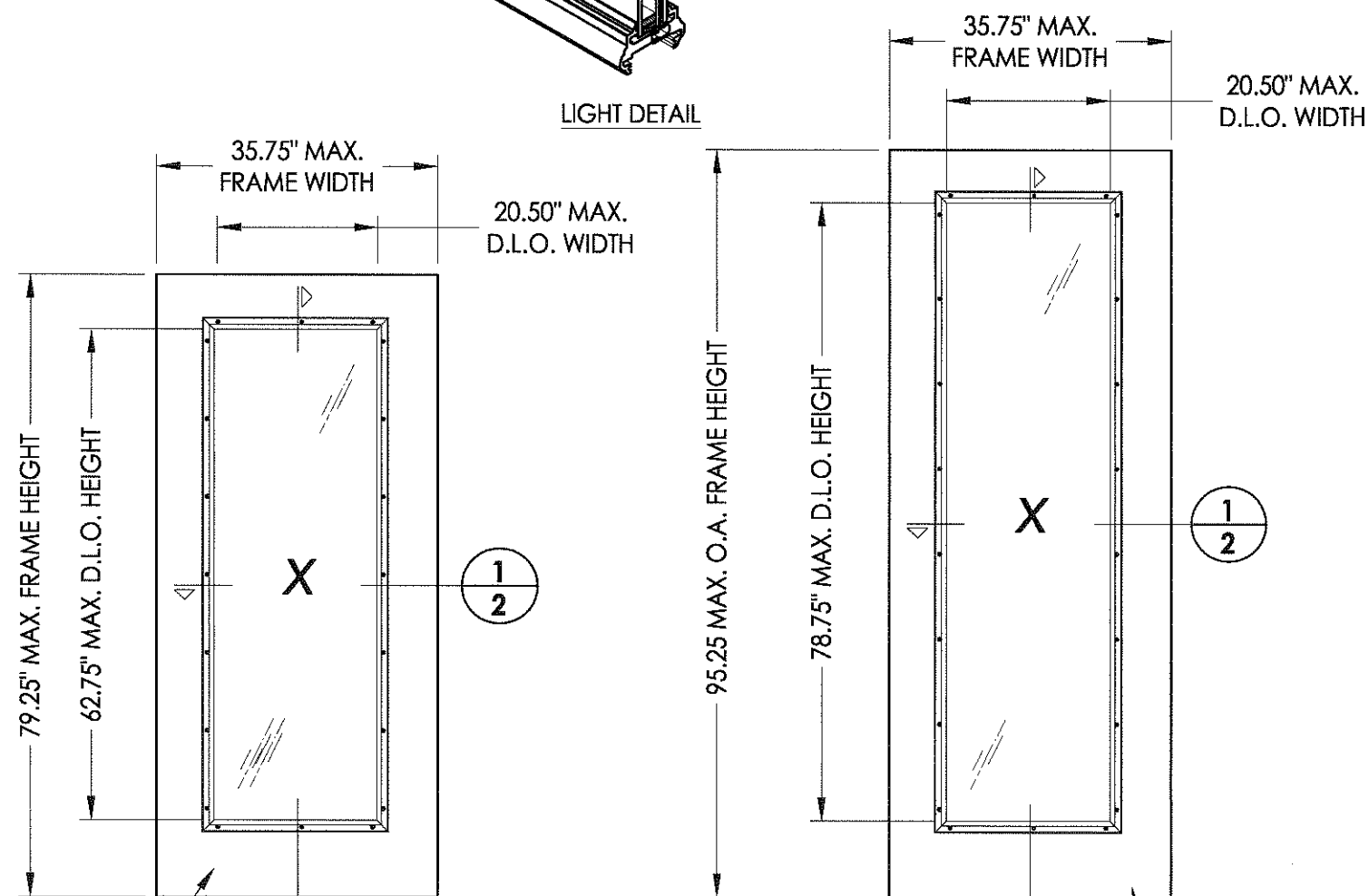

SWING DOOR OR
SIDELITE SYSTEM
UNDER SEPARATE
APPROVAL

SWING DOOR OR
SIDELITE SYSTEM
UNDER SEPARATE
APPROVAL

DESIGN PRESSURE (PSF)	
POSITIVE	NEGATIVE
+60.0	-60.0

TABLE OF CONTENTS	
SHEET #	DESCRIPTION
1	Typical elevations, design pressures, & general notes
2	Cross sections, glazing detail, & bill of materials

Documents Prepared By:
RW BUILDING CONSULTANTS, INC.
 P.O. Box 230 Valrico FL 33595
 Phone No.: 813.659.9197
 Florida Board of Professional Engineers
 Certificate Of Authorization No. 9813
RF 10-29-08
 Lyndon F. Schmidt, P.E. No. 43409

PRODUCT: RSL IMPACT LITE INSERT

PART OR ASSEMBLY: TYPICAL ELEVATION, DESIGN PRESSURES & GENERAL NOTES

NO.	DATE	BY	REVISIONS

DATE: 10/20/08
 SCALE: N.T.S.
 DWG. BY: DWS
 CHK. BY: LFS
 DRAWING NO.: FL-11515.1
 SHEET 1 OF 2

R:\A - Projects\Project Folders\proj 1401-1500\PF 1432\D. RWBC Drawings\FL-11515\FL-11515.dwg, Model

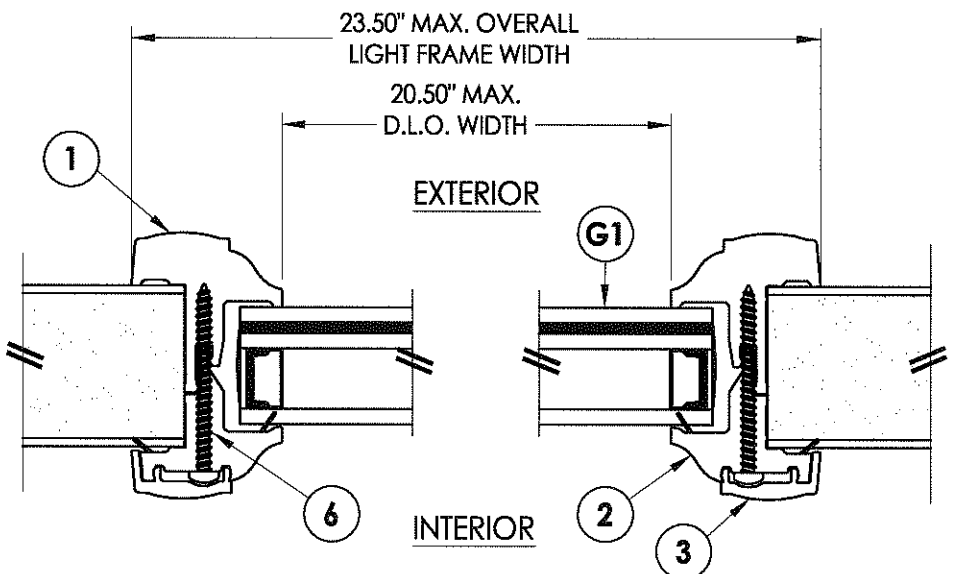
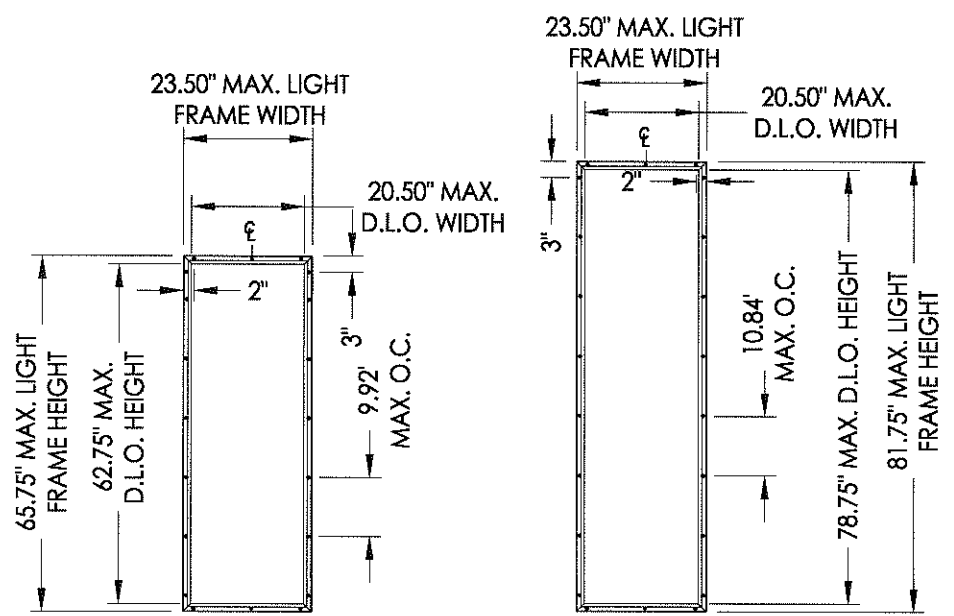

1 2 HORIZONTAL CROSS SECTION

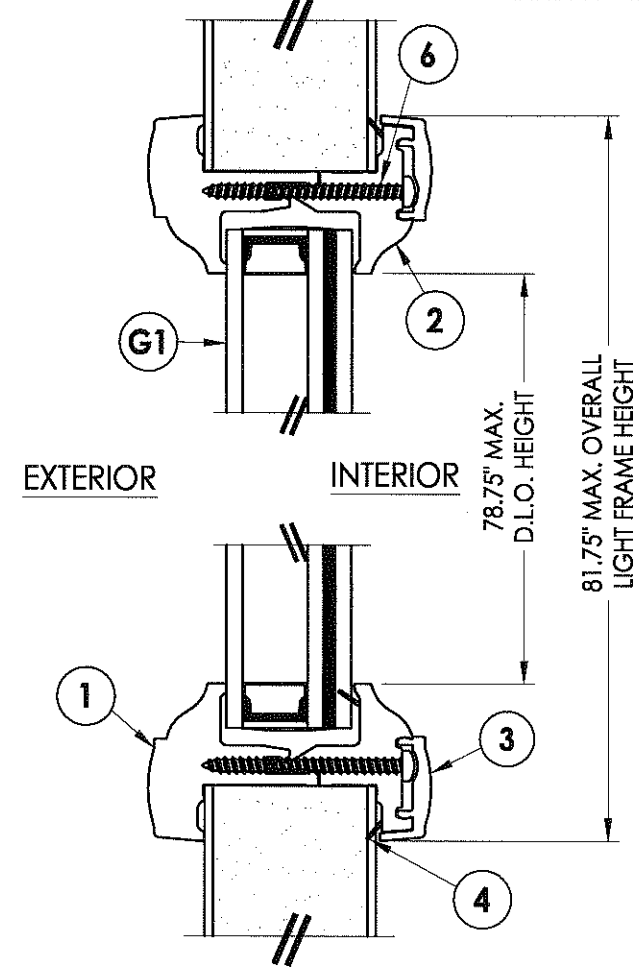

2 2 VERTICAL CROSS SECTION

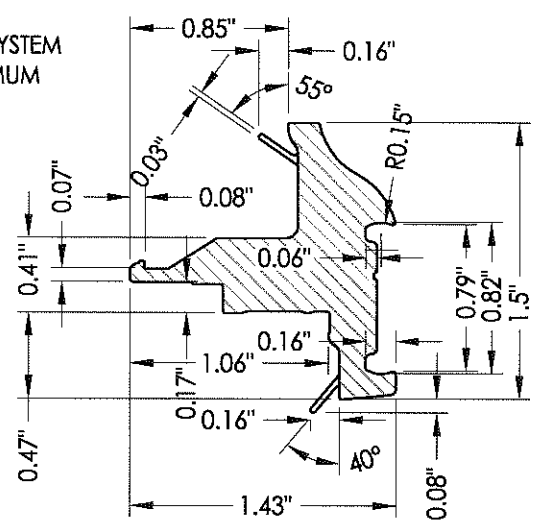

2 INTERIOR DOOR LITE FRAME (060407-4)

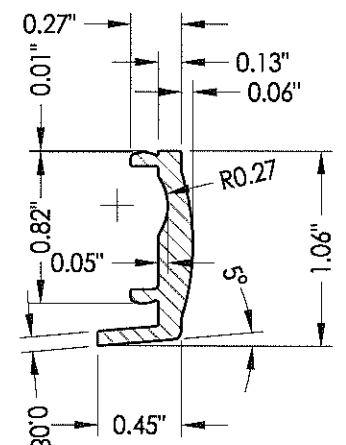

3 SCREW COVER (060407-6)

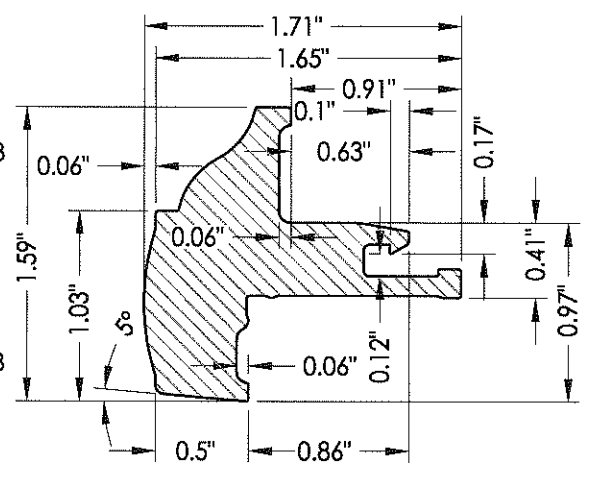

1 EXTERIOR DOOR LITE FRAME (060407-5)

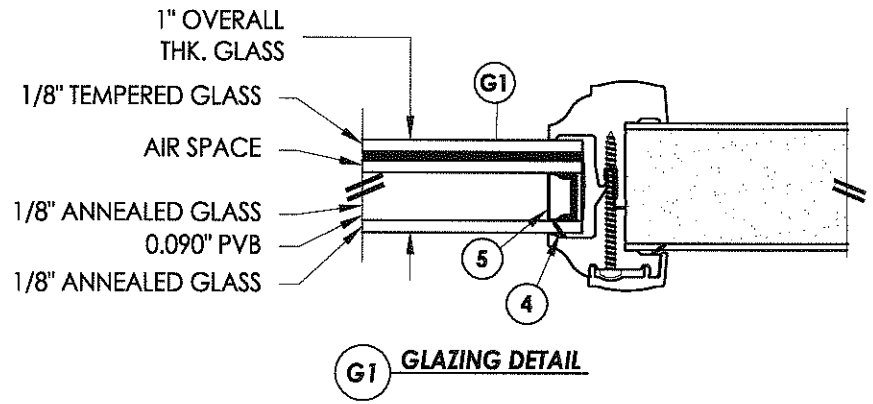

G1 GLAZING DETAIL

SPECIFICATION FOR DOOR AND SIDELITE PANELS:

THE RSL, INC. PVC DOORGLASS ASSEMBLY COMPONENT IS APPROVED UNDER THIS STATEWIDE PRODUCT APPROVAL. THE SINGLE GLAZED DOOR SYSTEM OR SIDELITE SYSTEM SHOWN ARE UNDER SEPARATE CURRENT STATEWIDE PRODUCT APPROVALS (MAXIMUM PANEL SIZE OF 35.75" WIDE & 95.75" HIGH). THE DOOR AND SIDELITE MUST MEET THE FOLLOWING MINIMUM REQUIREMENTS TO BE QUALIFIED WITH THIS DOORGLASS COMPONENT:

I. STEEL DOOR, SWINGING TYPE (1-3/4" MIN THICK PANEL):

1. BOTTOM RAIL: 0.020" MIN. THICK STEEL OR BETTER.
2. STILE: 1.715" X 1.000" (WOOD STILE)
3. TOP RAIL: 1.715" X 1.000" (WOOD RAIL)
4. FOAM CORE: APPROVED 2-2.5/FT^3 DENSITY URETHANE OR 2.0#/FT^3 DENSITY POLYSTYRENE, COMPLYING TO FBC.

II. STEEL FIXED SIDELITE (1-3/4" MIN. THICK PANEL):

1. TOP & BOTTOM RAIL: 1.715" X 1.000" (WOOD RAIL)
2. STILES: 1.715" X 1.000" (WOOD STILE)
3. FOAM CORE: APPROVED 2-2.5/FT^3 DENSITY URETHANE OR 2.0#/FT^3 DENSITY POLYSTYRENE, COMPLYING TO FBC.

III. FIBERGLASS DOOR. (WOOD EDGE). 1-3/4" MIN THK. PANEL.

1. HINGE STILE: OSB 1.100" X 1.450"
2. LATCH STILE: OSB 3.780" X 1.450"
3. STILE CAP: HARDWOOD .372" X 1.450"
4. TOP RAIL: COMPOSITE 1.450" X .940"
5. BOTTOM RAIL: COMPOSITE 1.450" X .800"
6. FOAM CORE: APPROVED 2-2.5 #/FT^3 DENSITY URETHANE OR 2.0 #/FT^3 DENSITY POLYSTYRENE COMPLYING TO FBC.

IV. FIBERGLASS FIXED SIDELITE. (WOOD EDGE). 1-3/4" MIN THK. PANEL.

1. STILE: COMPOSITE 1.186" X 1.620"
2. TOP RAIL: COMPOSITE 1.620" X 1.125"
3. BOTTOM RAIL: COMPOSITE 1.620" X 1.066"
4. FOAM CORE: APPROVED 2-2.5 #/FT^3 DENSITY URETHANE OR 2.0 #/FT^3 DENSITY POLYSTYRENE COMPLYING TO FBC.

V. DOOR & SIDELITE SKINS

1. STEEL DOOR AND SIDELITE SKIN 0.020" THK.
2. FIBERGLASS DOOR SKIN 0.125" THK.
3. FIBERGLASS SIDELITE SKIN 0.083" THK.

BILL OF MATERIALS		
ITEM		MATERIAL
1	EXTERIOR DOOR LIGHT FRAME (BY ROYAL MOULDINGS)	PVC
2	INTERIOR DOOR LIGHT FRAME (BY ROYAL MOULDINGS)	PVC
3	SCREW COVER (BY ROYAL MOULDINGS)	PVC
4	NON STURCTURAL SEALANT	SILICONE
5	1/2" NON-GROOVE SWIGGLE W/ DELCHEM#80 POLYSULFIDE 1/8" BACKFILL	-
6	#10 1-3/4" PFH SCREW	STEEL

Documents Prepared By: **RW** BUILDING CONSULTANTS, INC.
P.O. Box 230 Vairico FL 33595
Phone No.: 813.659.9197
Florida Board of Professional Engineers
Certificate of Authorization No. 9813
10-29-08
Lyndon F. Schmidt, P.E. No. 43409

PRODUCT: RSL INSERT
IMPACT LITE
PART OR ASSEMBLY: CROSS SECTIONS, GLAZING DETAIL, & B.O.M.

NO.	DATE	BY	REVISIONS

DATE: 10/20/08
SCALE: N.T.S.
DWG. BY: DWS
CHK. BY: LFS
DRAWING NO.: FL-11515.1
SHEET 2 OF 2

© 2008 R.W. BUILDING CONSULTANTS INC.