

REVISIONS	BY	DATE
△ PERMIT SETS ISSUED	DWD	03.03.20
△ BLDG. DEPT. REVISIONS	DWD	06.10.20

REDGRAVE & ROSENTHAL
OFFICE BUILDING
RENOVATION & ADDITION
 14881 HAGEN RANCH ROAD
 DELRAY BEACH, FL

RANDALL STOFFT
ARCHITECTS
 distinctive, inspirational, architecture.

Job No. 1904026
 FL-001105 FIRM-AA003379
ALL DESIGN, DESIGN ARRANGEMENTS, & PLANS INDICATED OR REPRESENTED BY THIS DRAWING ARE OWNED BY THE ARCHITECT. THE ARCHITECT'S NAME SHALL BE PROMINENTLY DISPLAYED ON THE DRAWING. THE ARCHITECT'S DESIGN, ARRANGEMENTS, OR PLANS SHALL BE USED BY OR INCORPORATED TO ANY PERSON, FIRM, OR CORPORATION FOR ANY PURPOSE WHATSOEVER WITHOUT THE WRITTEN PERMISSION OF RANDALL L. STOFFT ARCHITECTS, P.A. WRITTEN PERMISSIONS ON THESE DRAWINGS SHALL HAVE PRECEDENCE OVER SCALE DIMENSIONS. CONTRACTORS SHALL VERIFY & BE RESPONSIBLE FOR ALL DIMENSIONS & CONDITIONS ON THE JOB. A THIS OFFICE MUST BE NOTIFIED OF ANY CHANGES TO THE DRAWINGS. SHOP DETAILS OF APPLICABLE SCALE MUST BE SUBMITTED TO THIS OFFICE FOR APPROVAL BEFORE PROCEEDING WITH FABRICATION ON ITEMS SO NOTED. © 2020. ALL RIGHTS RESERVED. RANDALL STOFFT ARCHITECTS P.A.

A201b

PERMIT SET 03-03-20

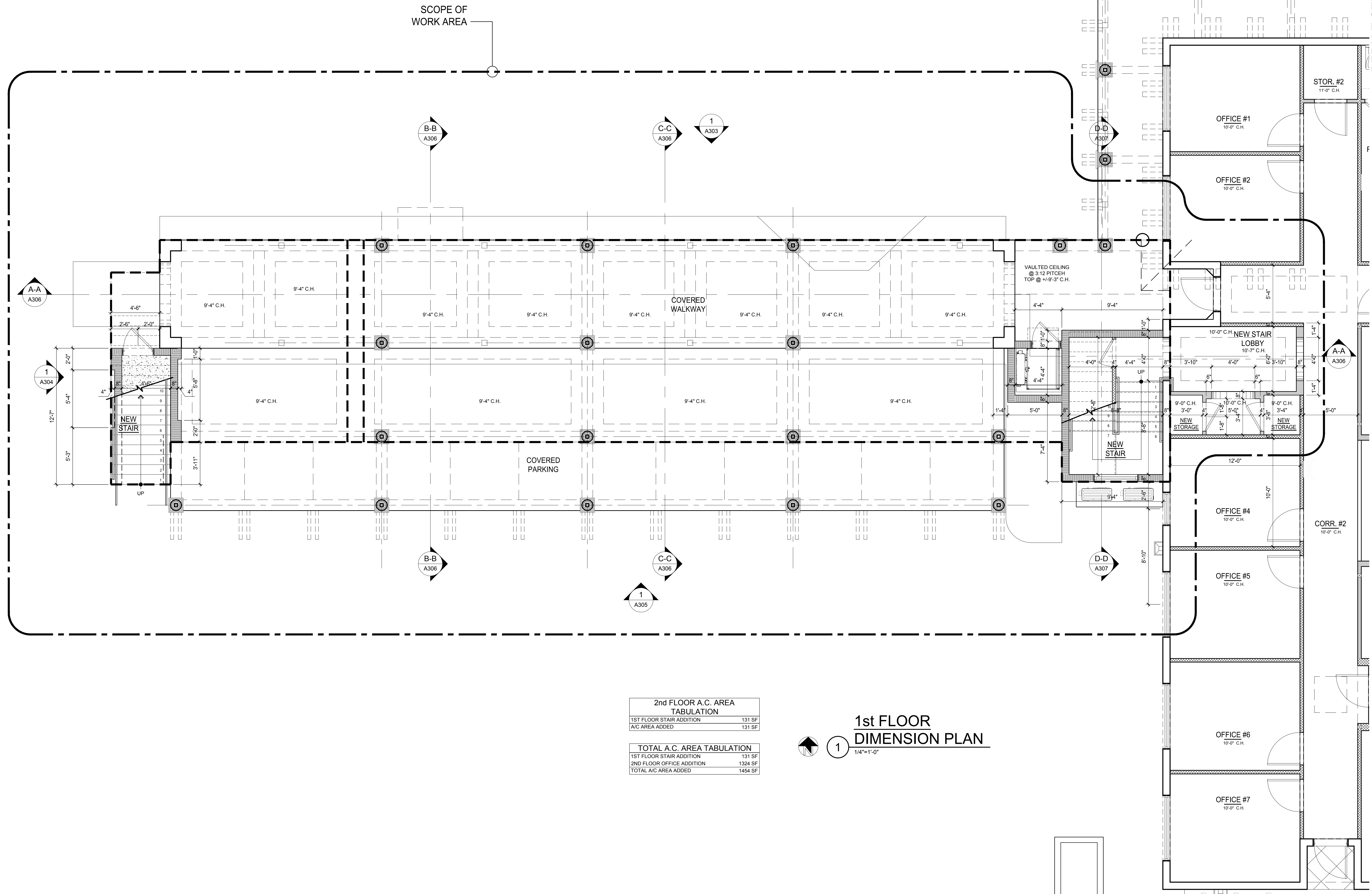

2nd FLOOR A.C. AREA TABULATION	
1ST FLOOR STAIR ADDITION	131 SF
A/C AREA ADDED	131 SF

TOTAL A.C. AREA TABULATION	
1ST FLOOR STAIR ADDITION	131 SF
2ND FLOOR OFFICE ADDITION	1324 SF
TOTAL A/C AREA ADDED	1454 SF

1st FLOOR DIMENSION PLAN
 1/4"=1'-0"

F:\COVID19\1904026-REDGRAVE & ROSENTHAL-ADDITION\Sheet Files\Redgrave_A201.dwg, 7/17/2020 6:07:50 PM
 42 N SWINTON AVE, DELRAY BEACH, FL 33444 (561) 245-0799 • NAPLES, FL (239) 262-1677 • WWW.STOFFT.COM