

1
A 4.1
ELEVATOR LANDING @ FIRST-FLOOR
SCALE: 1/2" = 1'-0"

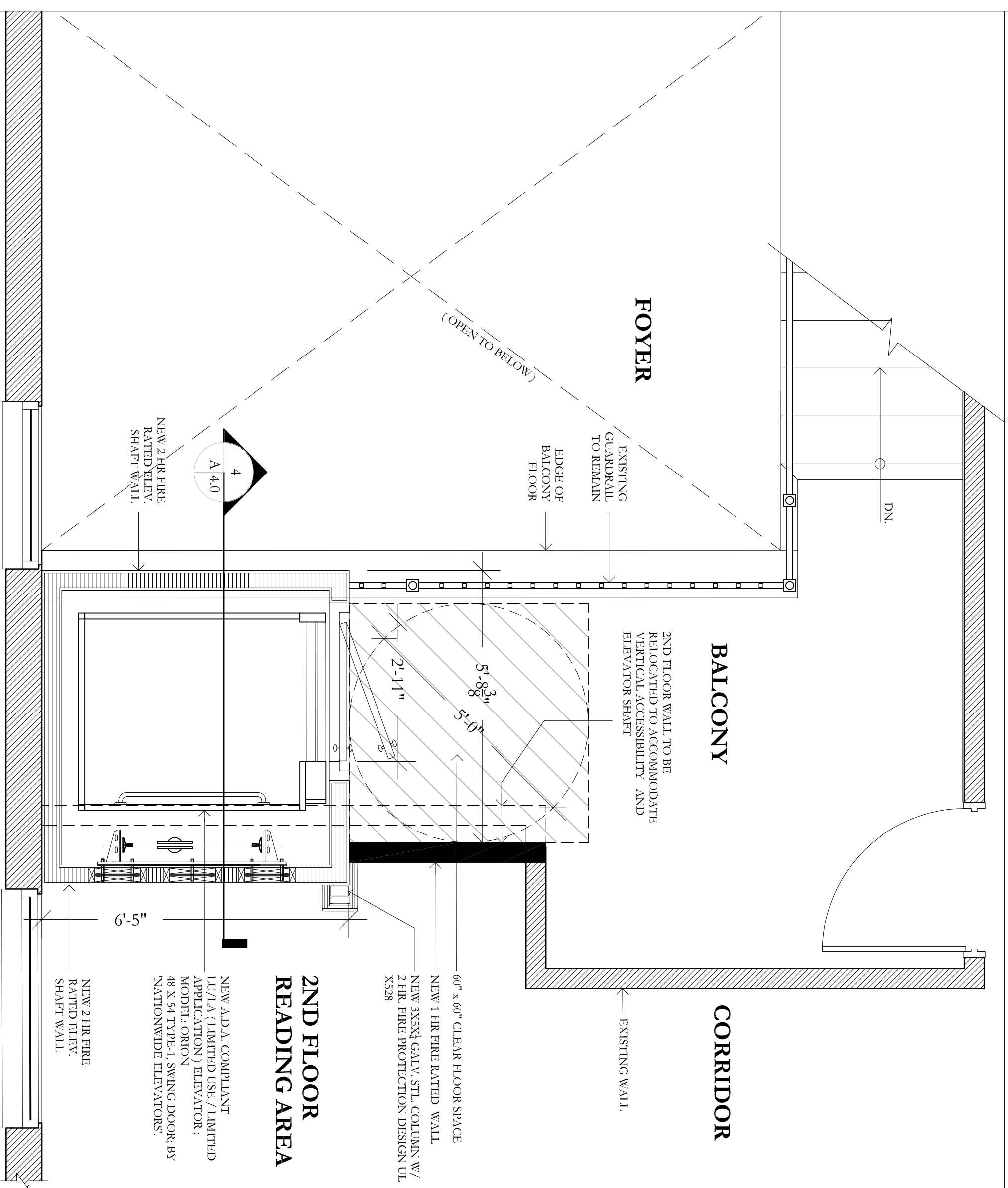

2
A 4.1
ELEVATOR LANDING @ SECOND-FLOOR
SCALE: 1/2" = 1'-0"

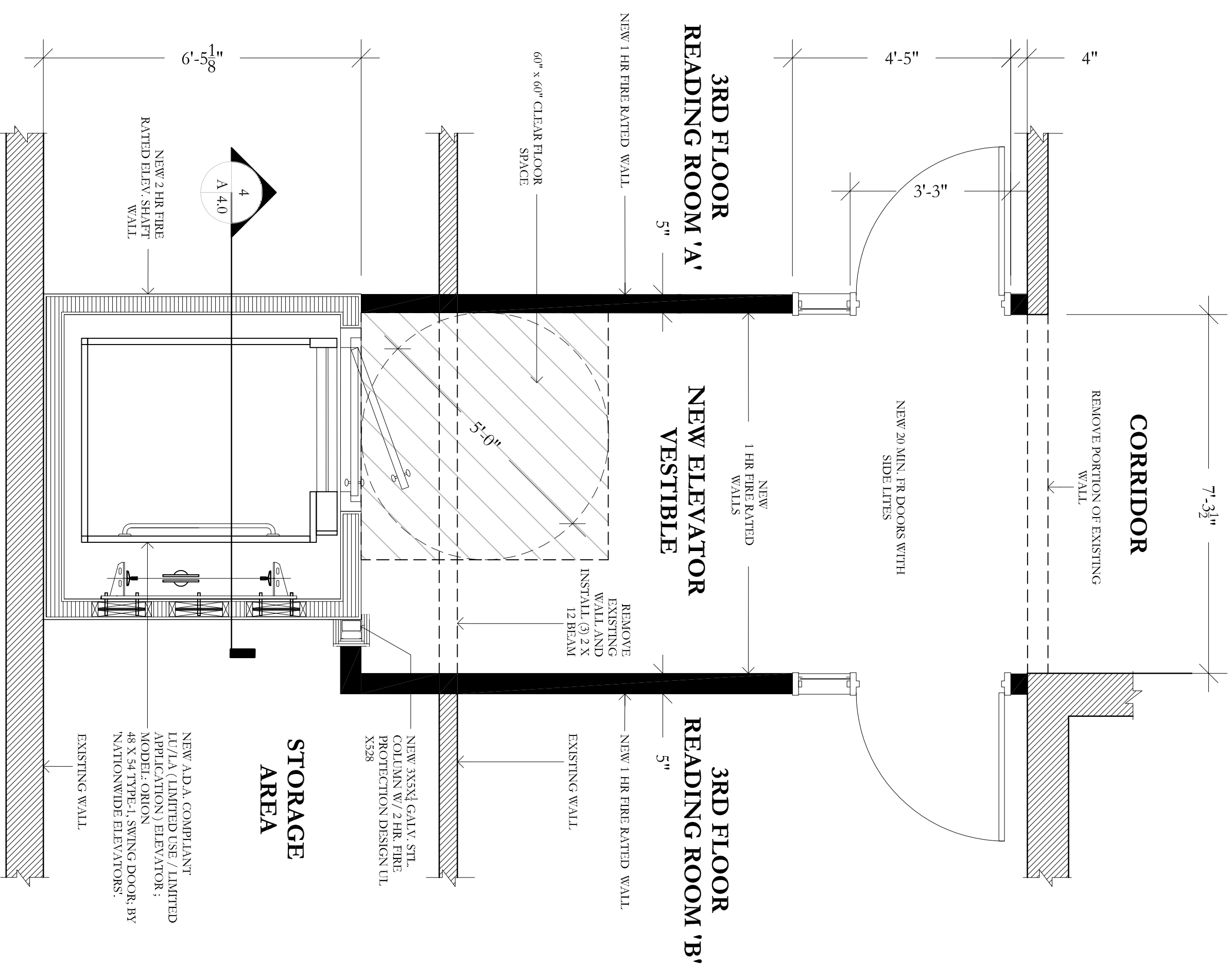

3
A 4.1
ELEVATOR LANDING @ THIRD-FLOOR
SCALE: 1/2" = 1'-0"

