

E. COLLEGE AVENUE

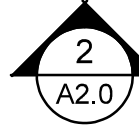
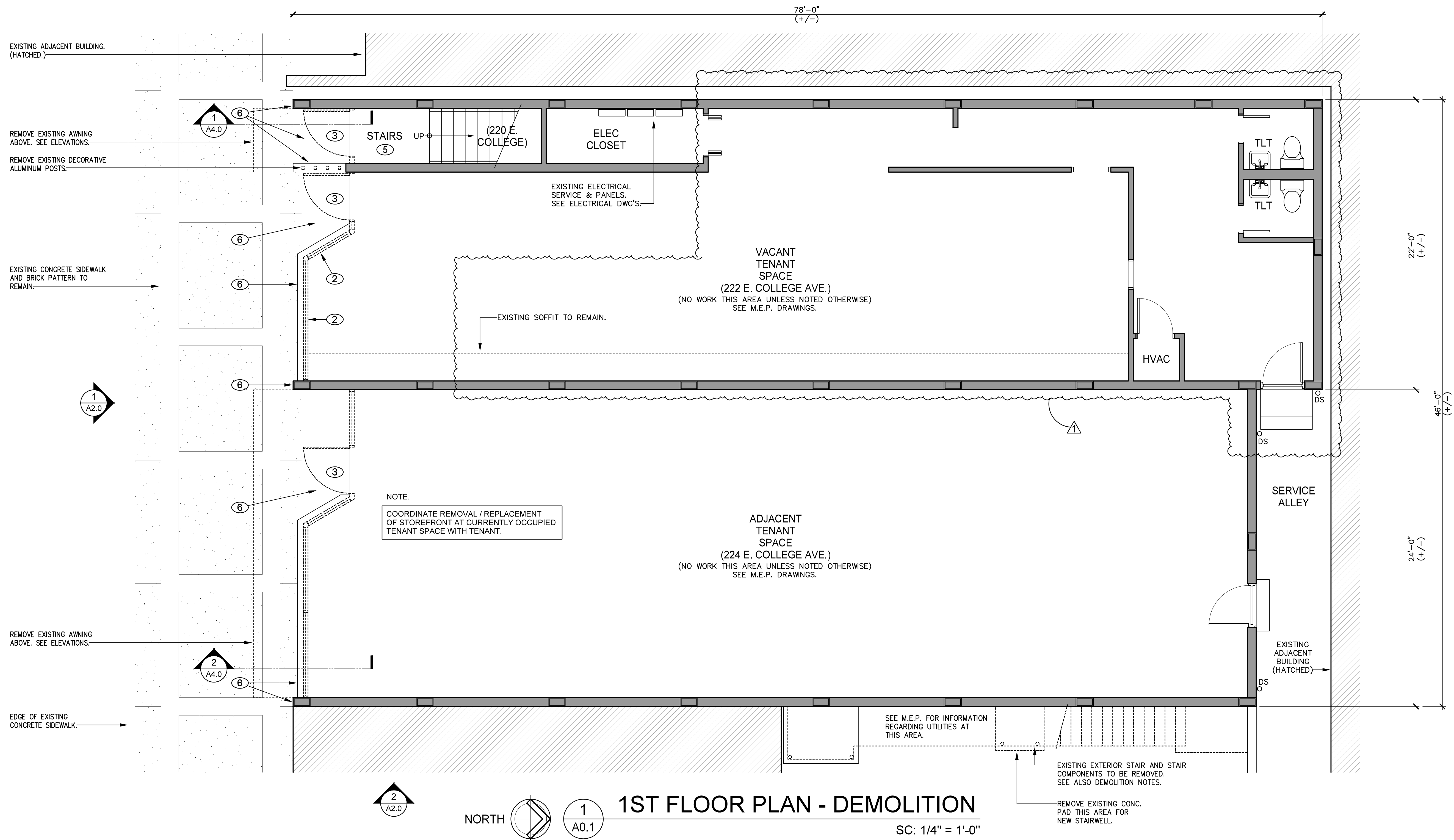

1 A0.1

1ST FLOOR PLAN - DEMOLITION

SC: 1/4" = 1'-0"

EXISTING ADJACENT BUILDING. (HATCHED.)

REMOVE EXISTING AWNING ABOVE. SEE ELEVATIONS.

REMOVE EXISTING DECORATIVE ALUMINUM POSTS.

EXISTING CONCRETE SIDEWALK AND BRICK PATTERN TO REMAIN.

REMOVE EXISTING AWNING ABOVE. SEE ELEVATIONS.

EDGE OF EXISTING CONCRETE SIDEWALK.

NOTE:
COORDINATE REMOVAL / REPLACEMENT OF STOREFRONT AT CURRENTLY OCCUPIED TENANT SPACE WITH TENANT.

VACANT TENANT SPACE
(222 E. COLLEGE AVE.)
(NO WORK THIS AREA UNLESS NOTED OTHERWISE) SEE M.E.P. DRAWINGS.

ADJACENT TENANT SPACE
(224 E. COLLEGE AVE.)
(NO WORK THIS AREA UNLESS NOTED OTHERWISE) SEE M.E.P. DRAWINGS.

SEE M.E.P. FOR INFORMATION REGARDING UTILITIES AT THIS AREA.

EXISTING EXTERIOR STAIR AND STAIR COMPONENTS TO BE REMOVED. SEE ALSO DEMOLITION NOTES.

REMOVE EXISTING CONC. PAD THIS AREA FOR NEW STAIRWELL.

NOTES

NOTES - DEMOLITION
(THIS SHEET ONLY)

- NOTE 1. ALL DIMENSIONS TO EXISTING WALLS ARE TO FACE OF EXISTING C.M.U.
- NOTE 2. CONTRACTOR SHALL VERIFY LOCATION OF ALL EXISTING UTILITIES AT AREA OF PROPOSED ADDITION / RENOVATION.
- NOTE 3. ALL ITEMS DASHED ON PLANS ARE EXISTING CONDITIONS TO BE REMOVED. ALL OTHER ITEMS SHOWN ARE EXISTING CONDITIONS TO REMAIN INSTALLED AND OPERATIONAL. PROTECT ALL EXISTING CONDITIONS TO REMAIN DURING DEMOLITION AND NEW CONSTRUCTION.

WALL LEGEND

WALL LEGEND - DEMOLITION
(THIS SHEET ONLY)

- EXISTING PARTITION, DOOR, FINISH, FIXTURE, UTILITY, ETC., TO BE REMOVED. SEE KEYNOTES, DEMOLITION NOTES, AND M.E.P. DRAWINGS.
- EXISTING PARTITION, DOOR, FINISH, FIXTURE, UTILITY, ETC., TO REMAIN. SEE PROPOSED PLANS, KEYNOTES, DEMOLITION NOTES, AND M.E.P. DRAWINGS.
- EXISTING ADJACENT BUILDING TO REMAIN. NO WORK AT THIS AREA. SEE DEMOLITION NOTES, PROPOSED PLANS, AND M.E.P. DRAWINGS.

KEY NOTES

KEYNOTES - DEMOLITION
(THIS SHEET ONLY)

- 1 REMOVE PORTION OF EXISTING NON-LOAD BEARING WALL, FINISHES, AND UTILITIES TO EXTENTS SHOWN. SEE PROPOSED FLOOR PLAN AND DEMOLITION NOTES. CONTRACTOR TO SHORE AND BRACE ANY CONNECTED STRUCTURE TO REMAIN.
- 2 REMOVE EXISTING WINDOW WALL. SEE PROPOSED FLOOR PLAN. CONTRACTOR TO SHORE AND BRACE ANY CONNECTED STRUCTURE TO REMAIN.
- 3 REMOVE EXISTING DOOR, FRAME, AND HARDWARE. SEE PROPOSED PLAN AND DEMOLITION NOTES.
- 4 REMOVE EXISTING FINISHED CEILING AND CEILING UTILITIES THROUGHOUT EXISTING TENANT SPACE. SEE MEP DRAWINGS.
- 5 REMOVE EXISTING FINISHED FLOORING, BASE, G.W.B., AND FURRING THROUGHOUT EXISTING TENANT SPACE.
- 6 REMOVE ALL CERAMIC TILE FROM EXISTING SURFACES. SEE PROPOSED FLOOR PLAN.
- 7 REMOVE EXISTING PLUMBING FIXTURES AND FINISHES. SEE MEP DRAWINGS.

EXISTING CONDITIONS AS SHOWN ARE BASED ON FIELD MEASUREMENTS AND MAY VARY FROM ACTUAL FIELD CONDITIONS. ACTUAL FIELD CONDITIONS SHALL GOVERN.

PRIOR TO BIDDING, ALL SUB-CONTRACTORS ARE RESPONSIBLE FOR FIELD VERIFYING EXISTING CONDITIONS TO DETERMINE THE SCOPE OF WORK NECESSARY TO ACHIEVE THE PROPOSED CONDITIONS AS SHOWN ON THE PLANS.

CONTRACTOR(S) SHALL VERIFY ALL EXISTING CONDITIONS PRIOR TO COMMENCEMENT OF WORK. ANY DISCREPANCIES SHALL BE BROUGHT TO THE ATTENTION OF THE ARCHITECT.

RENOVATION & REMODEL for COLLEGE STATION
220 E. COLLEGE AVE. TALLAHASSEE, FL.

1ST FLOOR PLAN - DEMOLITION



DATE	DEC. 11, 2014
DRAWN BY	B.K.
REVISED	
	FEB. 13, 2015
JOB NO.	14-174
DATE	
SHEET NUMBER	A0.1

ISSUED FOR PERMITTING

COPYRIGHT © 2014 CONN & ASSOCIATES, INC. ALL RIGHTS RESERVED. ANY REPRODUCTION OF THESE DRAWINGS IN ANY FORM OR BY ANY MEANS, ELECTRONIC OR MECHANICAL, INCLUDING PHOTOCOPYING, RECORDING, OR OTHERWISE, WITHOUT THE PRIOR WRITTEN PERMISSION OF CONN & ASSOCIATES, INC.