



SYNALOVSKI ROMANIK SAYE  
Architects - Planning - Interior Design

1800 Eller Drive, Suite 500  
Fort Lauderdale, FL 33316  
T 954.961.6806  
F 954.961.6807  
www.synalovskid.com

Manuel Synalovski, AIA  
AR 0011628  
SEAL

LICENSE NO. AA26001863

WINDMILL PARK

700 LYONS ROAD  
COCONUT CREEK, FL 33063

CLIENT: CITY OF COCONUT CREEK

REV	DATE	DESCRIPTION
1	12/14/15	DRC REVIEW SET
2		ISSUE DATE: 12/14/15

DESIGN DELIVERABLE: DRC REVIEW SET  
ISSUE DATE: 12/14/15

PROJECT NUMBER: 1252-140622  
DRAWN BY: KW  
CHECKED BY: MR  
Copyright (c) by SYNALOVSKI ROMANIK SAYE  
All Rights Reserved.

SHEET TITLE:  
**EXISTING PAVILION  
2nd FLOOR PLAN  
OPTION 3**

SHEET NUMBER:  
**A1-1.1**

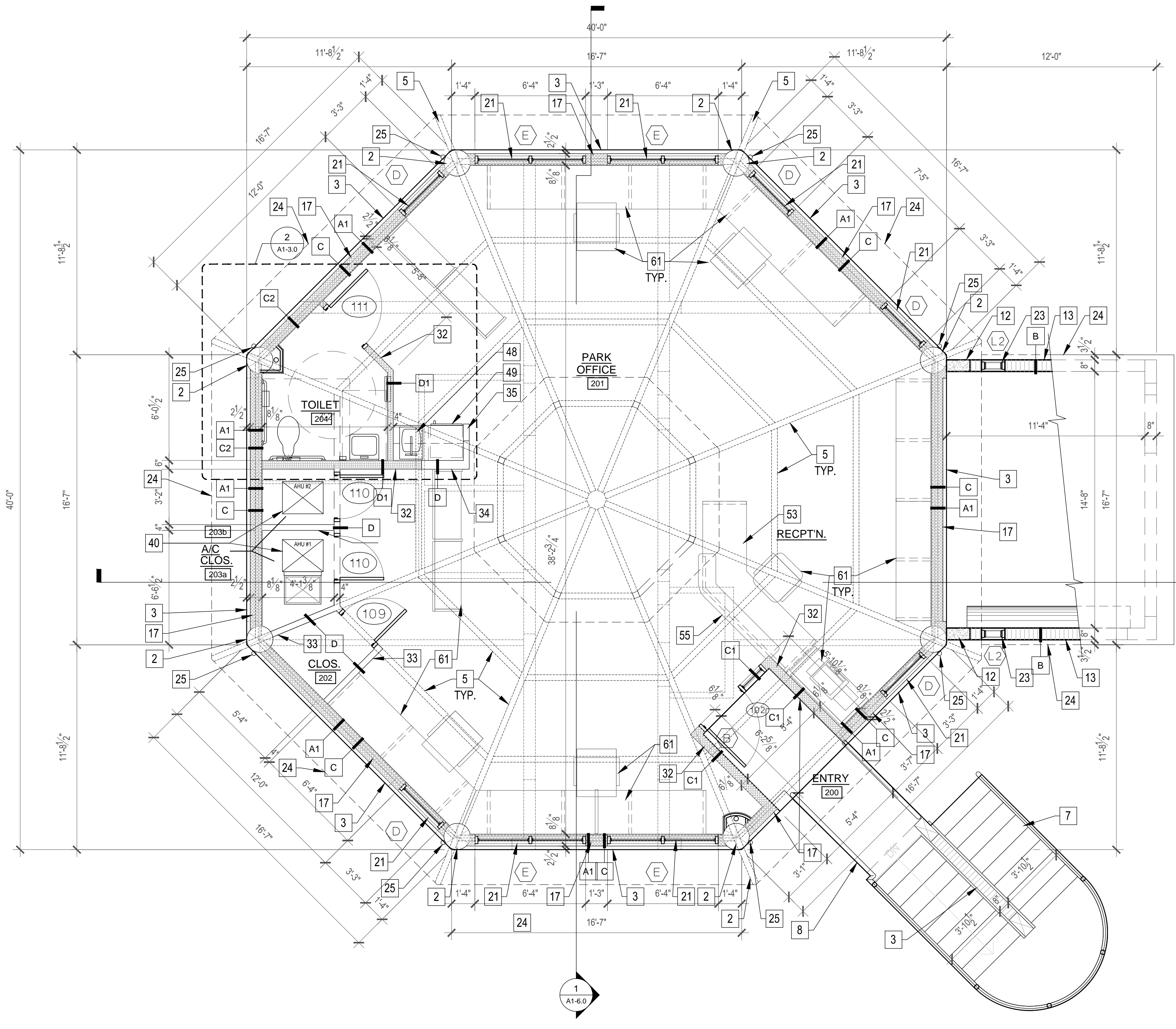

- 1 EXIST. CONC. BEAM OR TIE BEAM TO REMAIN (SEE STRUCT. DWG'S.)
- 2 EXIST. CONC. COLUMN TO REMAIN (SEE STRUCT. DWG'S.)
- 3 EXIST. STUCCO FINISHED CONC. OR 8" MASONRY TO REMAIN.
- 4 EXIST. PAINTED, EXPOSED 8" x 8" STACKED MASONRY WALL TO REMAIN.
- 5 EXIST. HEAVY TIMBER WD. STRUCTURE TO REMAIN.
- 6 EXIST. EXPOSED WD. LOUVERS TO REMAIN.
- 7 EXIST. PAINTED MTL. STAIR, HANDRAIL & SAFEGUARDS TO REMAIN. (TYP.)
- 8 EXIST. 42" MTL. SAFEGUARD TO REMAIN.
- 9 EXIST. DOOR OR WINDOW UNIT TO REMAIN (SEE DOOR & WINDOW SCHEDULES)
- 10 EXIST. PAINTED MTL. SECURITY SCREEN INFILL TO REMAIN. (TYP.)
- 11 EXIST. PAINTED MTL. SECURITY GATE TO REMAIN. (TYP.)
- 12 NEW STUCCO FINISHED CONC. OR 8" MASONRY TO BE ADDED. (SEE STRUCT. DWG'S.)
- 13 NEW PAINTED, EXPOSED 8" x 8" STACKED MASONRY WALL TO BE ADDED & MATCH EXIST. (SEE STRUCT. DWG'S.)
- 14 REINF. CONCRETE BEAM OR TIE BEAM. (SEE STRUCT. DWG'S.)
- 15 MIN. 1/2" 2-COAT CEMENT STUCCO FINISH OVER CONC. OR 8" MASONRY
- 16 MASONRY KNEE WALL W/ SOLID BRICK CAP @ +28" A.F.F. (U.O.N.) MATCH EXIST.
- 17 MIN. 3/4" PAINTED STUCCO FINISHED EXTERIOR WALL OVER PLYWD. SHEATHING ON GALV. MTL. FRAMING AT 16" O.C. (TYP. - SEE STRUCT. DWG'S.)
- 18 PAINTED, FLUSH MTL. DOOR UNIT (SEE DOOR SCHEDULE)
- 19 ALUMINUM DOOR UNIT W/ IMPACT RESISTANT GLAZING (SEE DOOR SCHEDULE)
- 20 ALUMINUM WINDOW & DOOR UNIT W/ IMPACT RESISTANT GLAZING (SEE DOOR & WINDOW SCHEDULES)
- 21 ALUMINUM WINDOW W/ IMPACT RESISTANT GLAZING (SEE WINDOW SCHEDULE)
- 22 IMPACT RATED, PAINTED, MOTORIZED STL., COILING ROLL-UP OVERHEAD DOOR (SEE DOOR SCHEDULE)
- 23 CLR. ANOD. FIXED ALUM. IMPACT RESISTANT VENT. LOUVER (REFER TO WINDOW SCHEDULE)
- 24 LINE OF WALL OR ROOF EDGE ABOVE
- 25 PAINTED, GALV. RAINWATER DOWNSPOUTS (SEE PLMB'G. DWG'S.)
- 26 ALUMINUM WINDOW W/ TEMPERED GLAZING TO MATCH EXTERIOR UNITS (SEE TO WINDOW SCHED.)
- 27 EXIST. SPACE TO REMAIN. PATCH TO MATCH ALL DAMAGED EXIST. FINISHES.
- 28 EXIST. SPACE TO BE RENOVATED. (SEE WALL LEGEND & FINISH SCHED.)
- 29 (NOT USED)

- 30 NEW CMU INFILL OF EXIST. OPENING. (SEE WALL LEGEND & FINISH SCHED.)
- 31 MTL. FRAMED, GYPBD. FINISHED WALL PARTITION TO MIN. 4" ABOVE CLG. (SEE WALL LEGEND). USE M.R. DRYWALL IN ALL DAMP AREAS (TYP.) USE CEMENTITIOUS SUBSTRATE BEHIND TILE WALL FINISHES. (SEE FINISH SCHED.)
- 32 MTL. FRAMED, GYPBD. FINISHED WALL PARTITION TO EXIST. WD. DECKING ABOVE. (SEE WALL LEGEND & FINISH SCHED.)
- 33 MTL. FRAMED, GYPBD. FINISHED WALL PARTITION TO +7'-8" A.F.F. (SEE WALL LEGEND & FINISH SCHED.)
- 34 MTL. FRAMED, GYPBD. FINISHED WALL PARTITION TO +8'-8" A.F.F. (SEE WALL LEGEND & FINISH SCHED.)
- 35 MTL. FRAMED, GYPBD. FINISHED KNEE WALL PARTITION W/ DRYWALL SILL @ +30" A.F.F. (U.O.N.)
- 36 MTL. FURRED, GYPBD. FINISH OVER CONC. OR CMU WALL. (SEE WALL LEGEND & FINISH SCHED.)
- 37 LINE OF SOFFIT EDGE OR DROPPED HEADER ABOVE
- 38 ELECTRIC METER & MAIN DISC. (SEE ELEC. DWG'S.)
- 39 ELECTRIC PANEL (SEE ELEC. DWG'S.)
- 40 AIR CONDITIONING AIR HANDLER UNIT
- 41 AIR CONDITIONING CONDENSING UNIT
- 42 WALL MTD. ELEC. INST-HOT WATER HEATER
- 43 HI-LOW DRINKING FOUNTAIN (SEE PLMB'G. DWG'S.)
- 44 12" x 12" CLG. ACCESS PANEL
- 45 LAVATORY
- 46 WATER CLOSET
- 47 PRECAST, FLOOR MTD. MIN. 8" DEEP MOP SINK
- 48 6" DEEP BAR SINK
- 49 22" WIDE UNDERCOUNTER REFRIGERATOR
- 50 14" W WD. SHELF (SEE ENLARGED PLAN)
- 51 3 SHELVES, EQUALLY SPACED
- 52 24" DEEP WOOD BASE CABINET UNIT W/ MICA FINISHED COUNTERTOP @ +36" A.F.F.
- 53 24" DEEP WOOD BASE CABINET UNIT W/ MICA FINISHED COUNTERTOP @ +30" A.F.F.
- 54 24" DEEP WOOD BASE CABINET UNIT W/ MICA FINISHED COUNTERTOP @ +28" A.F.F.
- 55 12" DEEP MICA FINISHED COUNTERTOP @ +42" A.F.F.
- 56 12" DEEP x 30" TALL WOOD UPPER CABINETS W/ 2 ADJUSTABLE SHELVES. TOP @ +84" A.F.F. (U.O.N.)
- 57 12" DEEP x 24" TALL WOOD UPPER CABINETS W/ 1 ADJUSTABLE SHELF. TOP @ +84" A.F.F. (U.O.N.)
- 58 BUILT-IN WOOD SHELF UNIT (86" TALL x 166" WIDE) W/ (5) 8" DEEP ADJ. SHELVES (4 EQ. SPACES).
- 59 BUILT-IN WOOD SHELF UNIT (86" TALL x 102" WIDE) W/ (5) 8" DEEP ADJ. SHELVES (2 EQ. SPACES).
- 60 BUILT-IN WOOD SHELF UNIT (86" TALL x 42" WIDE) W/ (5) 8" DEEP ADJ. SHELVES.
- 61 ALL FURNITURE SHOWN, IS BY OWNER. SIZE, TYPE, FINISH, LOCATION, ETC. TO BE DETERMINED BY OWNER.
- 62 (NOT USED)

**1 SECOND FLOOR PLAN**  
1/4" = 1'-0"

**2 PLAN NOTE LEGEND**  
NO SCALE

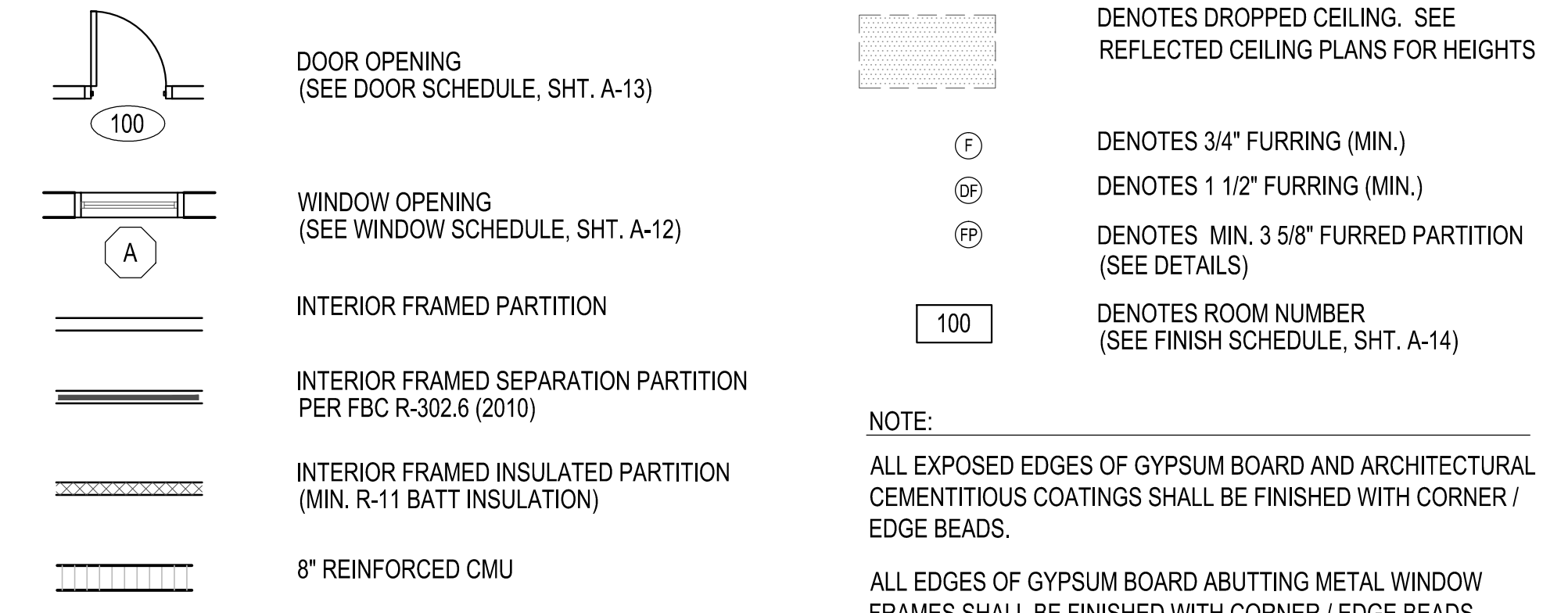

- |  |   |   |   |   |
|--|---|---|---|---|
| <p><b>A</b> EXIST. PAINTED or STUCCO COVERED EXTERIOR CONC. &amp; CMU WALL W/ 5/8" PAINTED GYPBD. INTERIOR FINISH OVER R-4.1 FOIL-FACED INSULATION ON GALV. MTL. FURRING @ 24" O.C. (USE M.R. GYPBD. IN ANY MOISTURE PRONE AREAS - TYP.)</p> <p><b>A1</b> EXIST. EXTERIOR WALL SAME AS "A". W/ 5/8" INTERIOR FINISH ALSO THE SAME, AND W/ R-4.1 FOIL-FACED INSULATION, BUT OVER 1 1/2" GALV. MTL. FURRING @ 24" O.C. (TYP.)</p> <p><b>A2</b> EXIST. EXTERIOR WALL SAME AS "A". W/ THIN-SET CERAMIC TILE INTERIOR FINISH ON 1/2" CEMENTITIOUS BACKER BOARD OVER R-4.1 FOIL-FACED INSULATION ON GALV. MTL. FURRING @ 16" O.C. (TYP. IN ALL WET AREAS.)</p> | <p><b>B</b> NEW, PAINTED or STUCCO COVERED EXTERIOR CONC. &amp; CMU WALL W/ 2-COAT, 1/2" PAINTED, SMOOTH STUCCO INTERIOR FINISH (TYP.) APPLY LIQUID BONDING AGENT OVER ALL EXPOSED CONCRETE SURFACES PRIOR TO STUCCO FINISH APPLICATION (TYP.)</p> <p><b>B1</b> EXIST. EXTERIOR WALL SAME AS "A". FORMER EXTERIOR FACE TO BE REFINISHED W/ 2-COAT, 1/2" PAINTED, SMOOTH STUCCO INTERIOR FINISH (TYP.)</p> <p><b>B2</b> FORMER EXTERIOR WALL SIMILAR TO "A" (NO INSUL. REQ'D). BOTH INTERIOR FACES TO BE REFINISHED W/ 5/8" GYPBD. FINISH ON GALV. MTL. FURRING @ 16" O.C. (USE M.R. GYPBD. IN MOISTURE PRONE AREAS, OR CEMENTITIOUS BACKER BOARD UNDER TILED FINISHES - TYP.)</p> | <p><b>C</b> NEW, PAINTED 7/8" 3-COAT SMOOTH STUCCO EXTERIOR FINISH OVER PAPER BACKED, SELF-FURRING GALV. MTL. LATH ON TYVEK MOISTURE BARRIER OVER 19/32" A.P.A. EXPOSURE 1 RATED, CD GRADE PLYWD. SHEATHING SECURED TO 8" GALV. MTL. STUDS @ 16" O.C. (REFER TO STRUCT. DWG'S.) W/ 5/8" PAINTED GYPBD. INTERIOR FINISH OVER R-19 F.G. BATT INSULATION IN STUD WALL CAVITY. (USE M.R. GYPBD. IN ANY MOISTURE PRONE AREAS - TYP.)</p> <p><b>C1</b> EXIST. EXTERIOR WALL SAME AS "C". W/ 5/8" INTERIOR FINISH ALSO THE SAME, BUT OVER 6" GALV. MTL. STUD FRAMING @ 16" O.C. (SEE STRUCT. DWG'S. - TYP.)</p> <p><b>C2</b> EXIST. EXTERIOR WALL SAME AS "C". W/ THIN-SET CERAMIC TILE INTERIOR FINISH ON 1/2" CEMENTITIOUS BACKER BOARD OVER R-4.1 FOIL-FACED INSULATION ON GALV. MTL. FURRING @ 16" O.C. (TYP. IN ALL WET AREAS.)</p> | <p><b>D</b> NEW INTERIOR FRAMED PARTITION OF 3 5/8" or 6" GALV. MTL. STUDS @ 16" O.C., W/ 5/8" PAINTED GYPBD. INTERIOR FINISH EACH SIDE (SEE STRUCT. DWG'S. - TYP.)</p> <p><b>D1</b> NEW INTERIOR PARTITION SAME AS "D". W/ PAINTED GYPBD. FINISH ONE SIDE, &amp; THIN-SET CERAMIC TILE INTERIOR FINISH ON 1/2" CEMENTITIOUS BACKER BOARD OTHER SIDE. (TYP. IN ALL WET AREAS.) SEE FINISH SCHED.</p> <p><b>D2</b> NEW INTERIOR PARTITION SAME AS "D". W/ THIN-SET CERAMIC TILE INTERIOR FINISH ON 1/2" CEMENTITIOUS BACKER BOARD ON BOTH SIDES. (TYP. IN ALL WET AREAS.) SEE STRUCT. DWG'S. FOR STUD GAUGE IF PLMB'G. FIXTURES ARE HUNG ON WALL.</p> <p><b>D3</b> NEW INTERIOR CMU INFILL TO MATCH EXIST. EXTERIOR WALL W/ INTERIOR FINISH ON EACH SIDE SAME AS "B2". (SEE STRUCT. DWG'S. - TYP.)</p> | <p><b>E</b> EXIST. PAINTED or STUCCO COVERED EXTERIOR CONC. &amp; CMU WALL TO REMAIN. CLEAN, PATCH AND REPAIR EXIST. FINISHES AS REQ'D. PRIOR TO REPAINTING (TYP.)</p> <p><b>E1</b> EXIST. INTERIOR PARTITION TO REMAIN. CLEAN, PATCH AND REPAIR EXIST. FINISHES AS REQ'D. PRIOR TO REPAINTING (TYP.)</p> <p><b>E2</b> EXIST. INTERIOR PARTITION FRAMING TO REMAIN. CLEAN, PATCH AND REPAIR EXIST. INTERIOR FINISH ON ONE SIDE TO REMAIN AS REQ'D. &amp; REFINISH OTHER SIDE WITH 5/8" PAINTED GYPBD. OR 1/2" CEMENTITIOUS BACKER BOARD FOR TILE FINISH - SEE FINISH SCHED. (TYP.)</p> <p><b>E2</b> EXIST. INTERIOR PARTITION FRAMING TO REMAIN. CLEAN, PATCH AND REPAIR EXIST. INTERIOR FINISH TO BE REFINISHED BOTH SIDES WITH 5/8" PAINTED GYPBD. OR 1/2" CEMENTITIOUS BACKER BOARD FOR TILE FINISH - SEE FINISH SCHED. (TYP.)</p> |
|--|---|---|---|---|

**3 SYMBOL LEGEND**  
NO SCALE

**4 WALL TYPE LEGEND**  
NO SCALE