

Perez & Partners, Inc. architecture

ARCHITECT
Jorge I. Perez, AIA
AR 95576
Perez & Partners, Inc.
AA 26002942
7720 SW 89 Ct
Miami, FL 33173
786.543.9053
jorge@perezandpartners.com

CLIENT/PROJECT NAME

INTERIOR RENOVATIONS TO
THE PRESTIGE HOTEL
(East Building)
1526 OCEAN DRIVE
VERO BEACH, FLORIDA 32963

CONSULTANTS

STRUCTURAL ENGINEER:
Adolfo J. Gonzalez, PE
2050 Coral Way #502
Miami, FL 33145
305.415.8782
adolfo.gonzalezpe@gmail.com

MEP ENGINEER:
Treasure Coast
Engineering, Inc.
4925 13th Lane
Vero Beach, FL 32966
772.567.1007
www.tce.eng.pro

ISSUE/REVISIONS

No.	DATE	DESCRIPTION
9-14-15		PERMIT SUBMITTAL
10/13/15		PERMIT COMMENTS

PROJECT No. 15-03

DRAWN BY:

CHECKED BY:

SEAL

SHEET No.

A2.02

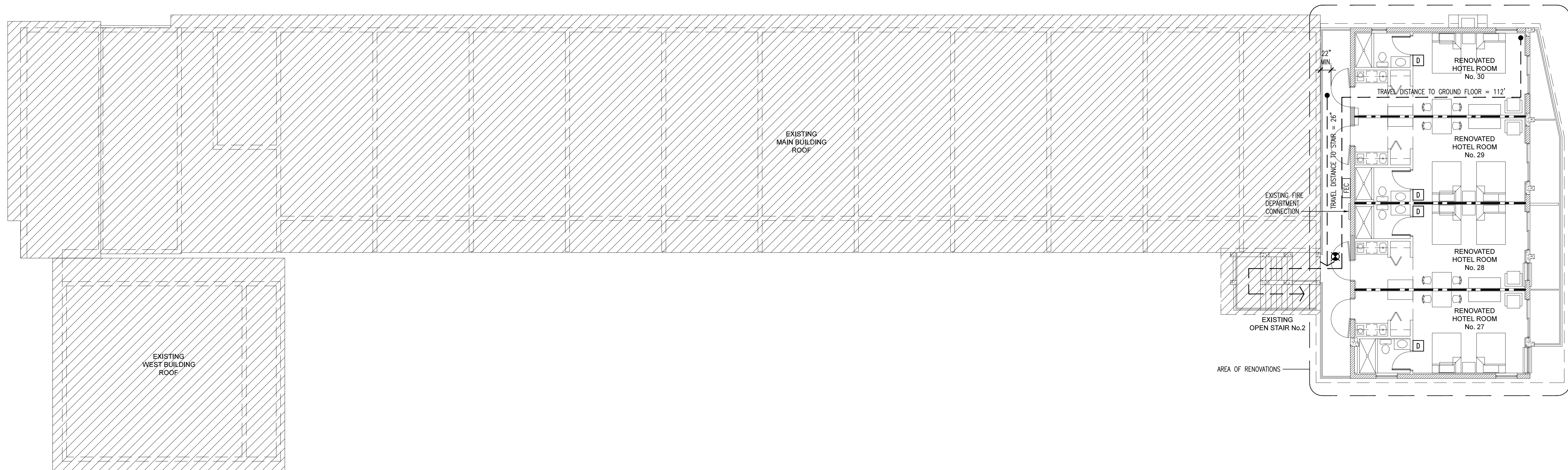

1 THIRD FLOOR LIFE SAFETY PLAN

SCALE: 1/8" = 1'-0"

LIFE SAFETY DATA

APPLICABLE CODES

FLORIDA BUILDING CODE (FBC) – 2014 EDITION
FLORIDA FIRE PREVENTION CODE (FFPC) – 5TH EDITION

OCCUPANCY CLASSIFICATION

FBC: RESIDENTIAL GROUP R-1, TRANSIENT. (FBC 602.3, TABLES 503 AND 601)
FFPC: RESIDENTIAL – HOTEL. (FFPC 6.1.8.1.3)

CONSTRUCTION TYPE

FBC: TYPE III-B. (FBC 602.3, TABLES 503 AND 601)
FFPC: TYPE II(11). (FFPC, NFPA 220, 4.3.1)

MEANS OF FIRE PROTECTION

PORTABLE FIRE EXTINGUISHERS (EXISTING)
NO FIRE SPRINKLERS SYSTEM IN EXISTING COMPLEX (NON-SPRINKLERED)

BUILDING HEIGHT AND AREAS

(FBC, TABLE 503)

DESCRIPTION	MAXIMUM ALLOWED	PROVIDED
BUILDING HEIGHT	55 FEET	25'-6" (EXISTING)
NUMBER OF STORIES	4	3 (EXISTING)
BUILDING AREA PER STORY	16,000 SQFT	10,408 SQFT (EXISTING)

FIRE CLASSIFICATION OF INTERIOR FINISHES

INTERIOR FINISH CLASSIFICATION LIMITATIONS (NON-SPRINKLERED BUILDING)
FBC: TABLE 803.9
FFPC: CHAPTER 20.8

OCCUPANCY	EXITS	EXITS ACCESS CORRIDOR	OTHER SPACES
R-1(FBC)	A I or II	A or B	A, B, or C
HOTEL (FFPC)	A I or II	A or B	A, B, or C

NOTES:
1. Class A interior wall and ceiling finish – flame spread 0-25, (new) smoke developed 0-450
2. Class B interior wall and ceiling finish – flame spread 26-75, (new) smoke developed 0-450
3. Class C interior wall and ceiling finish – flame spread 76-200, (new) smoke developed 0-450
4. Class I interior floor finish – critical radiant flux, not less than 0.45 W/m2
5. Class II interior floor finish – critical radiant flux, not less than 0.22 W/m2 but less than 0.45 W/m2

MEANS OF EGRESS CRITERIA

FFPC

1. MAXIMUM TRAVEL DISTANCE

OCCUPANCY: MAXIMUM ALLOWED:
EXISTING HOTELS (FFPC, NFPA 101, 29.2) 75 FT. WITHIN A GUEST ROOM TO A CORRIDOR DOOR (FFPC, NFPA 101, 29.2.6.1)
100 FT. FROM CORRIDOR DOOR OF GUEST ROOM TO THE NEAREST EXIT (FFPC, NFPA 101, 29.2.6.3.1)
200 FT. FROM CORRIDOR DOOR OF GUEST ROOM TO THE NEAREST EXIT FOR EXTERIOR WAYS OF EXIT ACCESS (FFPC, NFPA 101, 29.2.6.3.2)

2. COMMON PATH OF EGRESS TRAVEL

OCCUPANCY: MAXIMUM ALLOWED:
EXISTING HOTELS (FFPC, NFPA 101, 29.2) 35 FT. FROM CORRIDOR DOOR OF GUEST ROOM TO THE NEAREST EXIT (FFPC, NFPA 101, 29.2.5.3)

3. DEAD ENDS:

OCCUPANCY: MAXIMUM ALLOWED:
EXISTING HOTELS (FFPC, NFPA 101, 29.2) 50 FT. (FFPC, NFPA 101, 29.2.5.5)

4. CORRIDORS:

OCCUPANCY: MIN. ALLOWED:
HOTELS 36 IN. (FFPC, 14.8.3.4.1)

FBC

1. MAXIMUM TRAVEL DISTANCE

OCCUPANCY: MAXIMUM ALLOWED:
RESIDENTIAL R-1 200 FT. (FBC, TABLE 1016.2)

2. COMMON PATH OF EGRESS TRAVEL

OCCUPANCY: MAXIMUM ALLOWED:
RESIDENTIAL R-1 75 FT. (FBC, TABLE 1014.3)

3. DEAD ENDS:

OCCUPANCY: MAXIMUM ALLOWED:
RESIDENTIAL R-1 20 FT. (FBC, 1018.4)

4. CORRIDORS:

OCCUPANCY: MINIMUM WIDTH ALLOWED:
RESIDENTIAL R-1 44 IN. (FBC, 1018.2)

FIRE-RESISTANCE RATING REQUIREMENTS (HOURS)

BUILDING ELEMENT	CONST. TYPE: III-B (FBC, TABLE 601)	CONST. TYPE: II(111) (FFPC, NFPA 220 TABLE 4.1.1)
- PRIMARY STRUCTURAL FRAME	0	1
- BEARING WALLS		
EXTERIOR	2	1
INTERIOR	0	1
- NONBEARING WALLS AND PARTITIONS		
EXTERIOR (FIRE SEPARATION DISTANCE=X)	0 (X>30') 1 (20'<X<30')	0
INTERIOR	0	0
- FLOOR CONSTRUCTION AND SECONDARY MEMBERS	0	1
- ROOF CONSTRUCTION AND SECONDARY MEMBERS	0	1

FIRE SEPARATION

WALLS SEPARATING DWELLING OR SLEEPING UNITS (FBC 420.2, 708.1)----- 1HR
HORIZONTAL ASSEMBLIES SEPARATING DWELLING OR SLEEPING UNITS (FBC 420.3, 711.3)----- 1HR

FIRST FLOOR OCCUPANT LOAD CALCULATION CHART (FFPC TABLE 14.8.1.1 / FBC, TABLE 1004.1.2). *STRINGENT FACTOR APPLIED

SPACE / ROOM	FUNCTION OF SPACE	FLOOR AREA (SQ. FT.)	OCCUPANT LOAD FACTOR (SQUARE FEET PER PERSON)	OCCUPANT LOAD (PERSONS)
MAIN LOBBY	ASSEMBLY: LESS CONCENTRATED USE WITHOUT WITHOUT FIXED SEATING	310	15 NET	21
LOBBY OFFICE, RECEPTION, LAUNDRY, POOL RESTROOM	BUSINESS	636	100 GROSS	7
HOTEL ROOMS (1-10) (MAIN BUILDING)	RESIDENTIAL: HOTEL AND DORMITORIES	4312	200 GROSS	22
SUPPLY CLOSET, ELECTRICAL, UTILITY	STORAGE	225	300 GROSS	1
TOTAL				51

SECOND FLOOR OCCUPANT LOAD CALCULATION CHART (FFPC TABLE 14.8.1.1 / FBC, TABLE 1004.1.2). *STRINGENT FACTOR APPLIED

SPACE / ROOM	FUNCTION OF SPACE	FLOOR AREA (SQ. FT.)	OCCUPANT LOAD FACTOR (SQUARE FEET PER PERSON)	OCCUPANT LOAD (PERSONS)
HOTEL ROOMS(23-26) (EAST BUILDING)	RESIDENTIAL: HOTEL AND DORMITORIES	1422	200 GROSS	8
HOTEL ROOMS(11-20) (MAIN BUILDING)	RESIDENTIAL: HOTEL AND DORMITORIES	4312	200 GROSS	22
HOTEL ROOMS(21-22) (WEST BUILDING)	RESIDENTIAL: HOTEL AND DORMITORIES	666	200 GROSS	4
OFFICE, LAUNDRY, STORAGE AREA	BUSINESS	554	100 GROSS	6
MULTI-PURPOSE ROOM	ASSEMBLY: LESS CONCENTRATED USE WITHOUT WITHOUT FIXED SEATING	315	15 NET	21
TOTAL				61

THIRD FLOOR OCCUPANT LOAD CALCULATION CHART (FFPC TABLE 14.8.1.1 / FBC, TABLE 1004.1.2). *STRINGENT FACTOR APPLIED

SPACE / ROOM	FUNCTION OF SPACE	FLOOR AREA (SQ. FT.)	OCCUPANT LOAD FACTOR (SQUARE FEET PER PERSON)	OCCUPANT LOAD (PERSONS)
HOTEL ROOMS(27-30) (EAST BUILDING)	RESIDENTIAL: HOTEL AND DORMITORIES	1422	200 GROSS	8
TOTAL				8

LIFE SAFETY LEGEND

	1 HOUR FIRE RATING
	2-HOUR FIRE RATING
	3-HOUR FIRE RATING
	4-HOUR FIRE RATING
	SMOKE BARRIER (1-HOUR RATED)
	SMOKE PARTITION (NON-RATED)
	TRAVEL DISTANCE
	SMOKE DETECTOR, CEILING MOUNTED
	SMOKE DETECTOR, WALL MOUNTED
	EXIT SIGN, CEILING MOUNTED
	FIRE EXTINGUISHER CABINET