

LIFE SAFETY PLAN
SECOND FLOOR
SCALE : 1/4" = 1'-0"

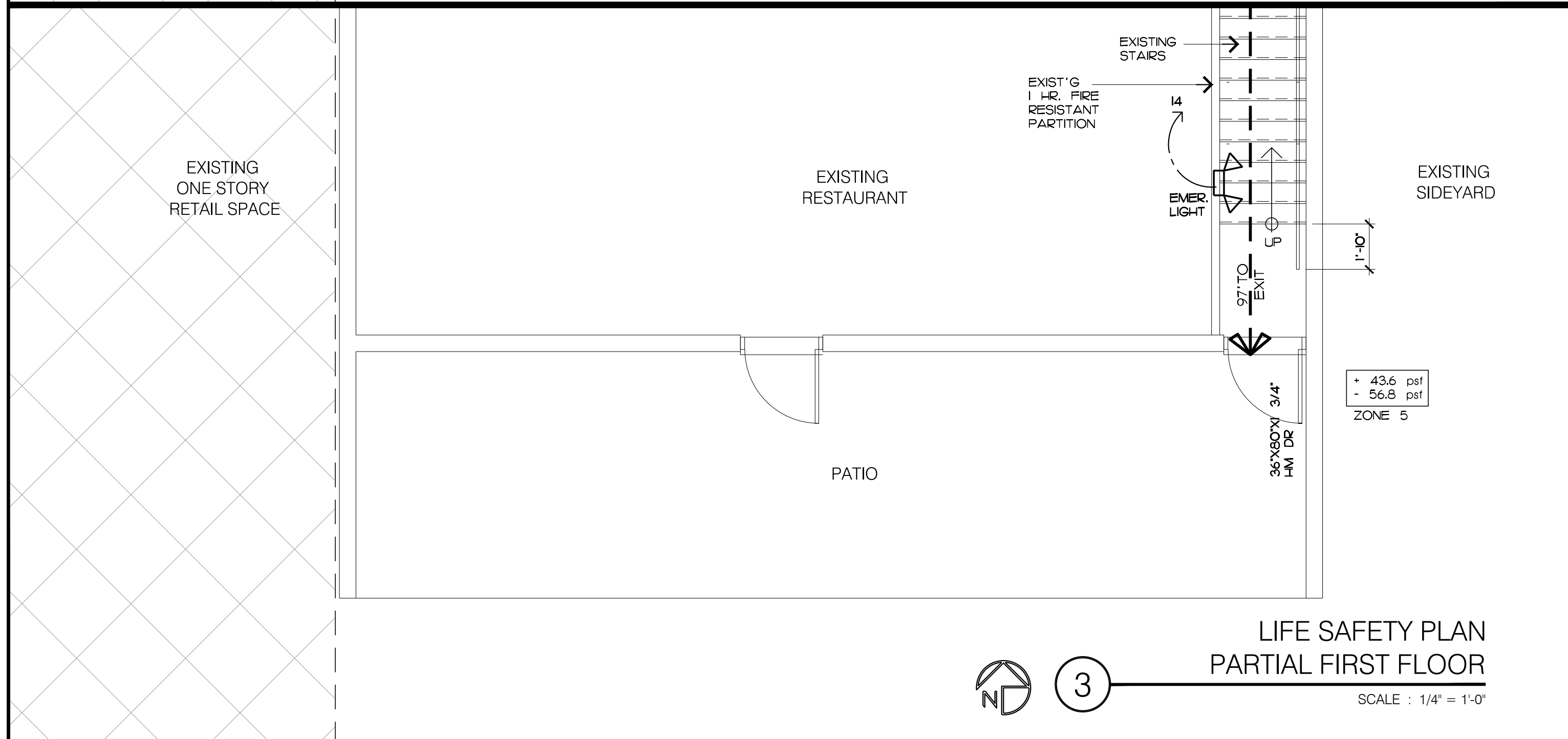

LIFE SAFETY PLAN
PARTIAL FIRST FLOOR
SCALE : 1/4" = 1'-0"

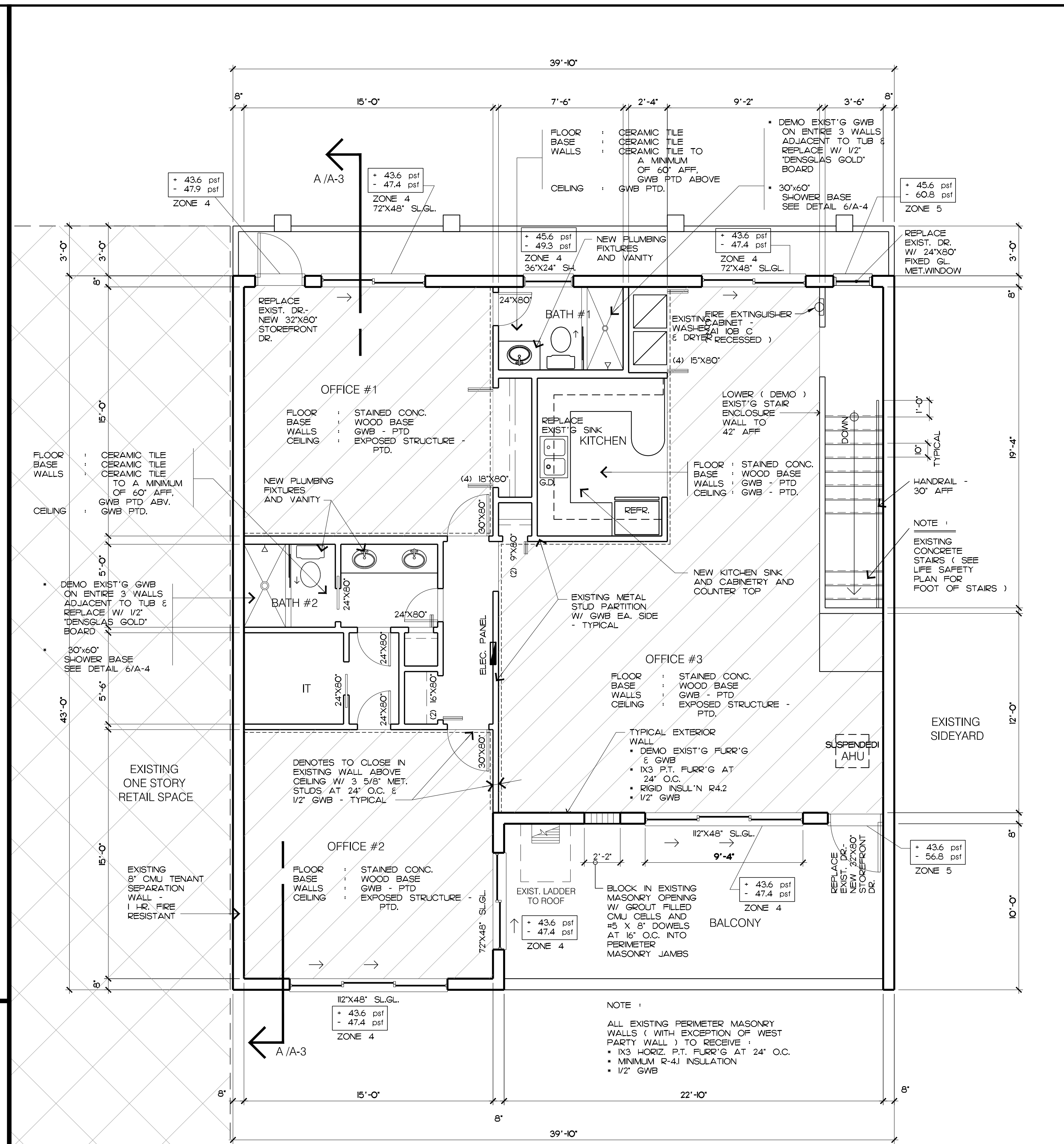

GENERAL NOTES :

- DIMENSIONS TO BE VERIFIED. NOTIFY ARCHITECT OF ANY PLAN DISCREPANCIES.
- ALL INTERIOR METAL STUD PARTITIONS ARE SHOWN AS 4" NOMINAL, UNO.
- ALL WOOD IN CONTACT WITH CONCRETE OR CONC. BLOCK SHALL BE P.T.
- ALL CONCEALED AND EXPOSED INSULATION SHALL HAVE A FLAME SPREAD INDEX OF NOT MORE THAN 25 AND A SMOKE INDEX OF NOT MORE THAN 450.
- ALL SECOND FLOOR EXTERIOR GLAZING TO BE REPLACED WITH STOREFRONT IMPACT TYPE GLASS TO WITHSTAND MISSEL IMPACT AS REQUIRED BY THE 2015 FLORIDA BUILDING CODE, UNO.
- ALL EXISTING INTERIOR DOORS ARE TO BE REPLACED TO MATCH EXISTING R.O. W/ WOOD FINISH.
- ALL DOORS ARE TO BE REPLACED
- ALL CONSTRUCTION IS EXISTING, UNO.

NOTE :
 * ALL CONSTRUCTION IS EXISTING UNO.
 EXISTING GWB CEILING DEMOLISHED UNDER PREVIOUSLY SUBMITTED DEMO PLAN.
 EXISTING STRUCTURE TO BE EXPOSED AND PAINTED, COLOR AS SELECTED BY OWNER.

1,320 sq.ft. / 100 sq.ft. per occupant =
14 total occupants

1,320 sq.ft. gross area

SECOND FLOOR PLAN
SCALE : 1/4" = 1'-0"

NO.	REVISIONS	DATE	BY

jerry clawson / architect
 218 EAST COMMERCIAL BLVD., STE. 218
 LAUDERDALE BY THE SEA, FLORIDA 33308
 954 974-3230 jclawson99@gmail.com
 LICENSE NO. : AR-0012262

FLOOR PLAN
 256 COMMERCIAL BLVD.
 LAUDERDALE BY THE SEA, FLORIDA 33308

DRAWN	jtc
CHECKED	
JOB NO.	
DATE	07/17/15
SHEET NO.	A-2
OF ... SHEETS	