

1313 15th ST.



KEY PLAN
SCALE: N.T.S.



PLANNING NOTES:
THE LANDSCAPE AND IRRIGATION PLANS SHALL BE SUBMITTED FOR REVIEW AND A SEPARATE PERMIT IS TO BE ISSUED AND INSTALLED PRIOR TO THE ISSUANCE OF A TCO, CO, TTC OR CC. PLEASE SEE THE AREA OF SITE DEMOLITION AND PROPOSED FUTURE LANDSCAPE/HARDSCAPE DESIGN TO COMPLY WITH SECTION 142-1105.

- GENERAL NOTES:**
- ALL EQUIPMENT SHALL BE INSTALLED ABOVE FLOOD PLAIN ELEVATION PLUS 1' AT 9'-0" BUILDING SHALL BE MAINTAINED AND OPERATED AS A HOTEL. ALL GUESTS MUST REGISTER AT THE CHECK-IN/REGISTRATION GUESTS/OCCUPANTS PROHIBITED WITHOUT REGISTRATION.
 - ANY WORK OR USE OF EQUIPMENT OR IMPROVEMENTS FROM/TO THE RIGHT OF WAY INCLUDING LANDSCAPING AND IRRIGATION REQUIRE A SEPARATE PERMIT AND APPROVAL FROM CITY OF MIAMI BEACH AND PUBLIC WORKS.
 - FIRE SPRINKLER AND FIRE LINE SERVICES CONNECTION SHALL BE UNDER SEPARATE PERMIT AND SHOP DRAWINGS FOR APPROVAL.

- CONSTRUCTION NOTES:**
- NEW LOCATION OF CONDENSOR IN WEST SET BACK UNITS TO BE RELOCATED.
 - PROPOSED FIRE BACK FLOW PREVENTOR UNDER SEPARATE PROJECT.
 - PROPOSED POST INDICATOR P.I.V. AT EXTERIOR FRONT VISIBLE TO FIRE DEPT. NO LANDSCAPE OR FENCING COVERING IT.
 - FIRE DEPARTMENT CONNECTION TO BE POLISHED CHROME. PROVIDE MIAMI BEACH APPROVED SIGNAGE.
 - FIRE DEPARTMENT CONNECTION TO BE POLISHED CHROME. PROVIDE MIAMI BEACH APPROVED SIGNAGE.
 - BICYCLE BACK TO ACCOMMODATE HOTEL GUESTS (8) AND EMPLOYEES (2) PER BUILDING = TOTAL OF 10
 - MECHANICAL/PLUMBING PENETRATIONS AT ROOF
 - MAINTAIN EXISTING ROOF ACCESS OPENING

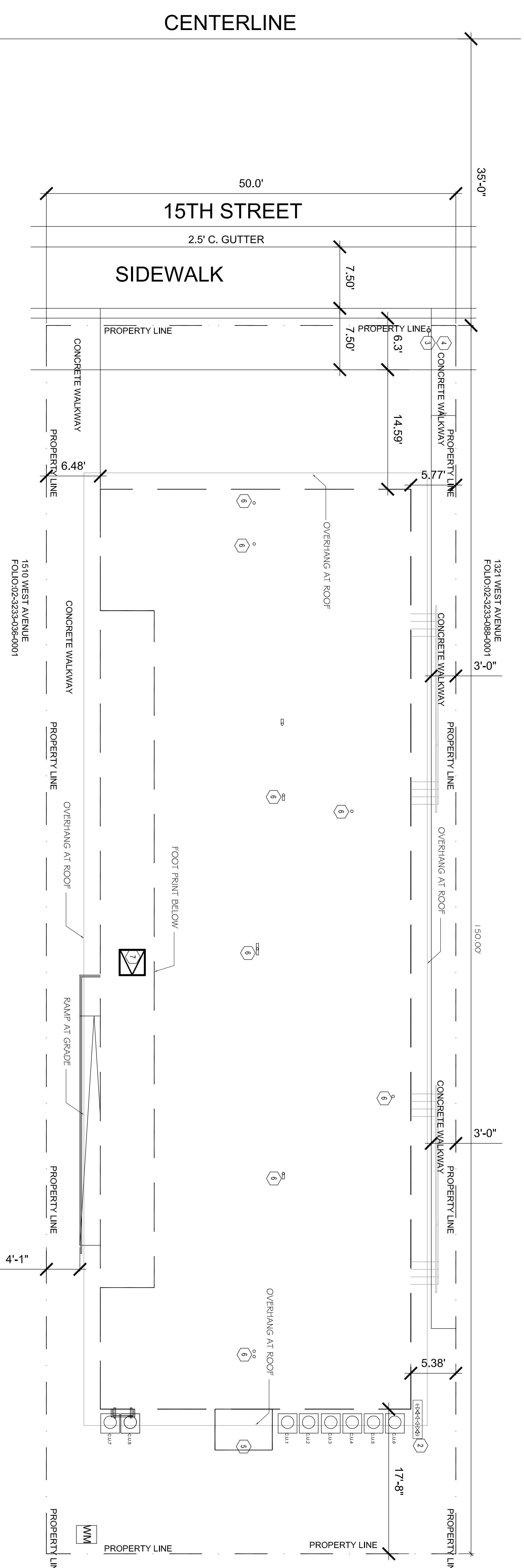

1 SITE PLAN
SCALE: 1/8" = 1'-0"

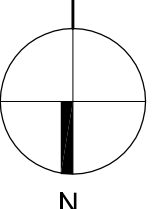

CLIENT:

1313 15th Street

Change of Use

1313 15th Street
Miami Beach, FL 33139
Folio: 02-3233-01-6-0140

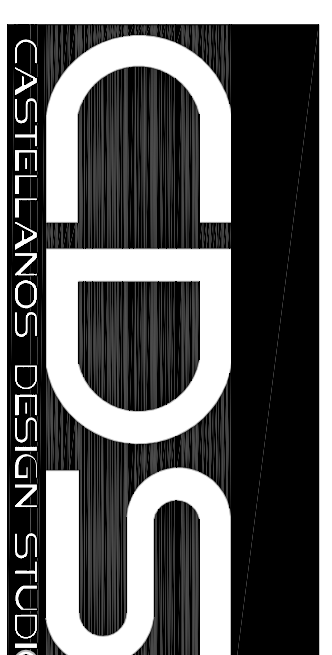

7300 BISCAYNE BLVD, SUITE 200
MIAMI, FL 33138
Tel: 786.218.5335
License #AA 20002467
WWW.CASTELLANOSDESIGN.COM

No.	DATE	ISSUED / REVISED
1	22 AUG/16	CONSTRUCTION DOCUMENTS
2	24 OCT/19	PERMIT REV. & DESIGN CHANGE
3		
4		

ALL DRAWINGS AND WRITTEN MATERIAL CONTAINED HEREIN IS THE SOLE PROPERTY OF CASTELLANOS DESIGN STUDIO. NO PART OF THIS DRAWING OR WRITTEN MATERIAL SHALL BE REPRODUCED OR TRANSMITTED IN ANY FORM OR BY ANY MEANS, ELECTRONIC OR MECHANICAL, INCLUDING PHOTOCOPYING, RECORDING, OR BY ANY INFORMATION STORAGE AND RETRIEVAL SYSTEM, WITHOUT THE WRITTEN PERMISSION OF CASTELLANOS DESIGN STUDIO. THE CONTRACTOR SHALL BE RESPONSIBLE FOR OBTAINING ALL NECESSARY PERMITS AND APPROVALS FROM THE CITY OF MIAMI BEACH AND THE STATE OF FLORIDA. THE CONTRACTOR SHALL BE RESPONSIBLE FOR OBTAINING ALL NECESSARY PERMITS AND APPROVALS FROM THE CITY OF MIAMI BEACH AND THE STATE OF FLORIDA. THE CONTRACTOR SHALL BE RESPONSIBLE FOR OBTAINING ALL NECESSARY PERMITS AND APPROVALS FROM THE CITY OF MIAMI BEACH AND THE STATE OF FLORIDA.

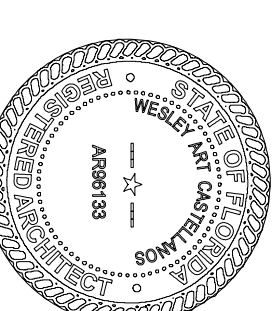

WESLEY ART CASTELLANOS
FLORIDA ARCHITECT LICENSE AR 98183
PROJECT NO: 2016-17

ARCHITECTURAL SITE PLAN

CHECKED BY: WGC
DRAWN BY: WGC
SCALE:
SHEET NO: AS-1
© 2019 BY CDS