

Page 1
 Original
 Update

HISTORICAL STRUCTURE FORM
FLORIDA SITE FILE

Site #8 MR2521
Recorder # 2-18
Field Date 2/17/97
Form Date 8/15/97

SITE NAME (addr. if none) First National/Commercial Bank Mult. List. #8
SURVEY Downtown Ocala Historic Properties Survey [Survey # 3066]
NATIONAL REGISTER CATEGORY building structure district site object

LOCATION & IDENTIFICATION

ADDRESS (Include N,S,E,W; st., ave., etc.) 36 S Magnolia Avenue
CROSS STREETS nearest/between SW corner Broadway St & S Magnolia Ave
NEAREST CITY/TOWN Ocala IN CURRENT CITY LIMITS? yes no
COUNTY Marion TAX PARCEL # 2853-046-001
SUBDIVISION NAME Ocala BLOCK 46 LOT # 1
OWNERSHIP private-profit priv-nonprofit priv-indiv priv-unspecified city county state federal unknown
NAME OF PUBLIC TRACT (e.g., park) _____
ROUTE TO _____

MAPPING

USGS 7.5' MAP NAME Ocala West, Fla., 1991
TOWNSHIP 15S, RANGE 22E, SECT. 18, 1/4 SE, 1/4-1/4 NE IRREG. SECT.? yes no
[UTM: ZONE 16 17 EASTING 389450 NORTHING 3228930]
PLAT OR OTHER MAP (map's name, location) Old Survey of Ocala, PB E/PG 1; Map 179, B4

DESCRIPTION

STYLE Commercial Vernacular EXTERIOR PLAN rectangular NO. STORIES 3
STRUCTURAL SYSTEMS masonry
FOUNDATION: Types slab Materials concrete
EXTERIOR FABRICS stucco, brick
ROOF: Types flat Materials built up
Secondary structures (dormers, etc.) _____
CHIMNEY: No. 1 Materials brick Locations N wall, int.
WINDOWS (types, materials, and placements) 2/2 SHS, metal, independent & paired; 1/1 DHS w/ transom, wood, independent, & paired; fixed glass, wood frame, independent & ribbon
MAIN ENTRANCE (stylistic details) _____
PORCHES: #open #closed #incised 1 Locations NE
Porch roof types integral
EXTERIOR ORNAMENT ornamented cornice, accentuated surrounds and banding, chamfered entrance corner
INTERIOR PLAN unknown CONDITION: excellent good fair deteriorated ruinous
SURROUNDINGS (N=None, S=Some, M=Most, A=All or nearly all) Acommercial residential institutional rural
ANCILLARY FEATURES (No., type of outbuildings; major landscape features) Available data indicate a 2-story Commercial Vernacular building, constructed c. 1912 adjacent on the W was an independent building housing a commercial store through 1930.
ARCHAEOLOGICAL REMAINS AT SITE Archaeological form completed? yes no (no-explain; yes-attach)
Artifacts or other remains None observed.

NARRATIVE (description of int., landscape, architecture, etc.; limit to 3 lines; attach full statement on separate sheet)
The ornamentation of this very tall, narrow building has been highlighted with various paint colors. Ground floor windows have been enclosed w/ foam shutters. 3rd flr shutter enclosures are wood. It is currently vacant.

HISTORY

CONSTRUCTION DATE 1885 CIRCA yes no
 ARCHITECT: (last name first) unknown
 BUILDER: (last name first) E. W. Agnew & Co.
 MOVES yes no Dates _____ Orig. addr. _____
 ALTERATIONS yes no Dates c. 1990 Nature replacement windows, stucco
 ADDITIONS yes no Dates _____ Nature _____
 ORIGINAL USES (give dates) comm. bank, lodge, offices (Knights of Pythias Hall 93)
 INTERMEDIATE USES (give dates) commercial bank, store (1930)
 PRESENT USES (give dates) commerical unoccupied
 OWNERSHIP HISTORY (especially original owner) Fancy's Sweet Treats, Inc. (7/95); E. W. Agnew & Co. (orig.)

SURVEYOR'S EVALUATION OF SITE

Potentially elig. for local designation? yes no insuff. info. Local Designation Category _____
 Individually elig. for Nat. designation? yes no insuff. info. _____
 Potential contributor to NR district? yes no insuff. info. _____

HISTORICAL ASSOCIATIONS (ethnic heritage, etc.) Community Planning and Development; Commerce

EXPLANATION OF EVALUATION (required; limit to three lines; attach full statement on separate sheet)
This building, of some historic interest, is currently vacant, in fair condition, & awaiting rehabilitation. In its current state, it does not appear individually NR eligible, but would contribute to a historic district.

CROSS-REFERENCES

BIBLIOGRAPHIC REFERENCES (author, date, title, publication information; if unpublished, give FSF Manuscript Number, or location where available) Marion County Property Appraiser's records; Marion County Clerk of Circuit Courts; Polk, R. L., Ocala City Directories 1908-1940; Sanborn Fire Insurance Maps 1884-1930; Brick City Directory, 1893

PHOTOGRAPHS (REQUIRED) B&W print(s) at least 3 x 5, at least one main facade. Label the back of the print with the FSF site number (site name if not available), direction and date of photograph: use pencil. Attach to back of the second to last page with a plastic or coated clip.
 Location of negatives/neg. nos. Historical & Architectural Research Services; Roll 2/18-20; 4/8

RECORDER

NAME (last, first)/ADDR/PHONE/AFFILIATION Hartig, Mikki & Delahaye, Daniel/3708 Flores Ave., Sarasota, FL 34239/941-955-6028/Historical & Architectural Research Services

FOR DETAILED INSTRUCTIONS: Guide to the 1992 Historic Structure Form of the Florida Site File.

DHR USE ONLY		OFFICIAL EVALUATIONS				DHR USE ONLY	
NR DATE	KEEPER-NR ELIGIBILITY*:	y	n	pe	ii	Date	___/___/___
___/___/___	SHPO-NR ELIGIBILITY*:	y	n	pe	ii	Date	___/___/___
DELIST DATE	LOCAL DESIGNATION*:					Date	___/___/___
___/___/___	Local office						

* y=Yes; n=No; pe=Potentially Eligible; ii=Insufficient Information

- REQUIRED: (1) USGS MAP WITH STRUCTURE PINPOINTED
 (2) LARGE SCALE STREET OR PLAT MAP
 (3) PHOTO OF MAIN FACADE, PREFER B&W, AT LEAST 3X5

PHOTOGRAPH

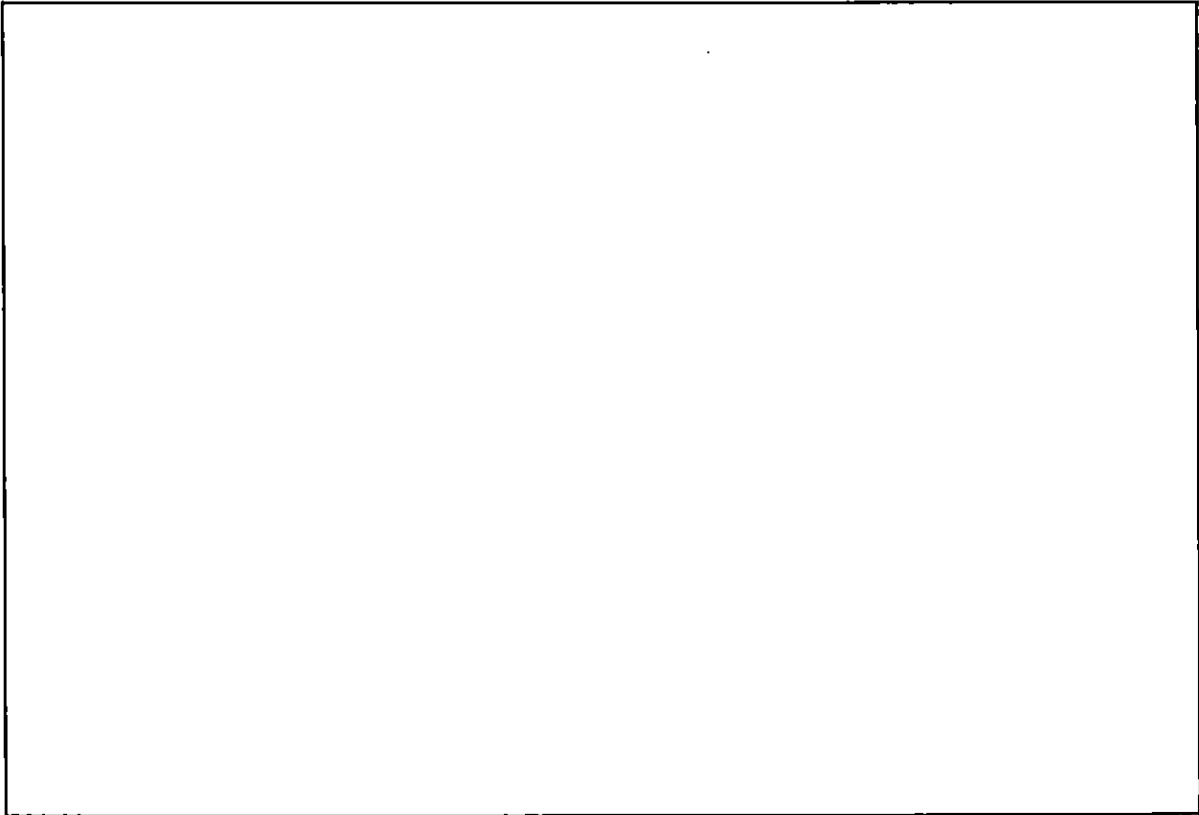

STREET OR PLAT MAP

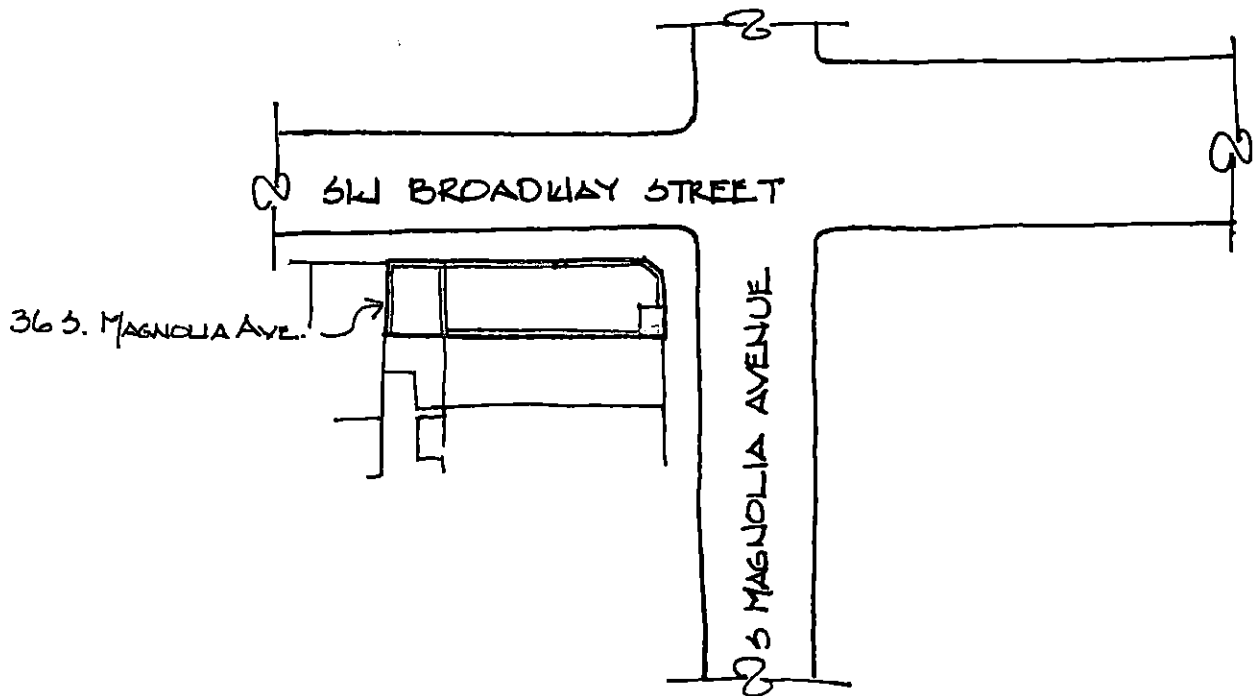

NOT TO SCALE

USGS MAP

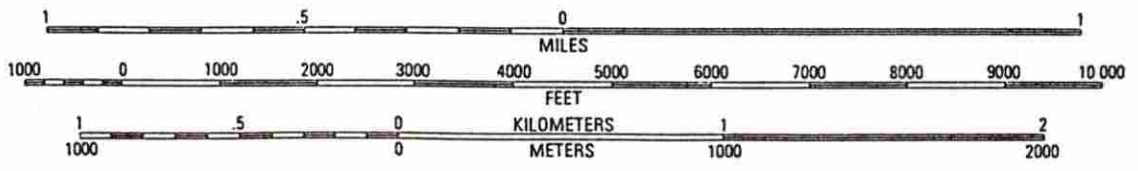
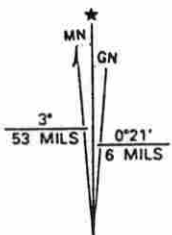
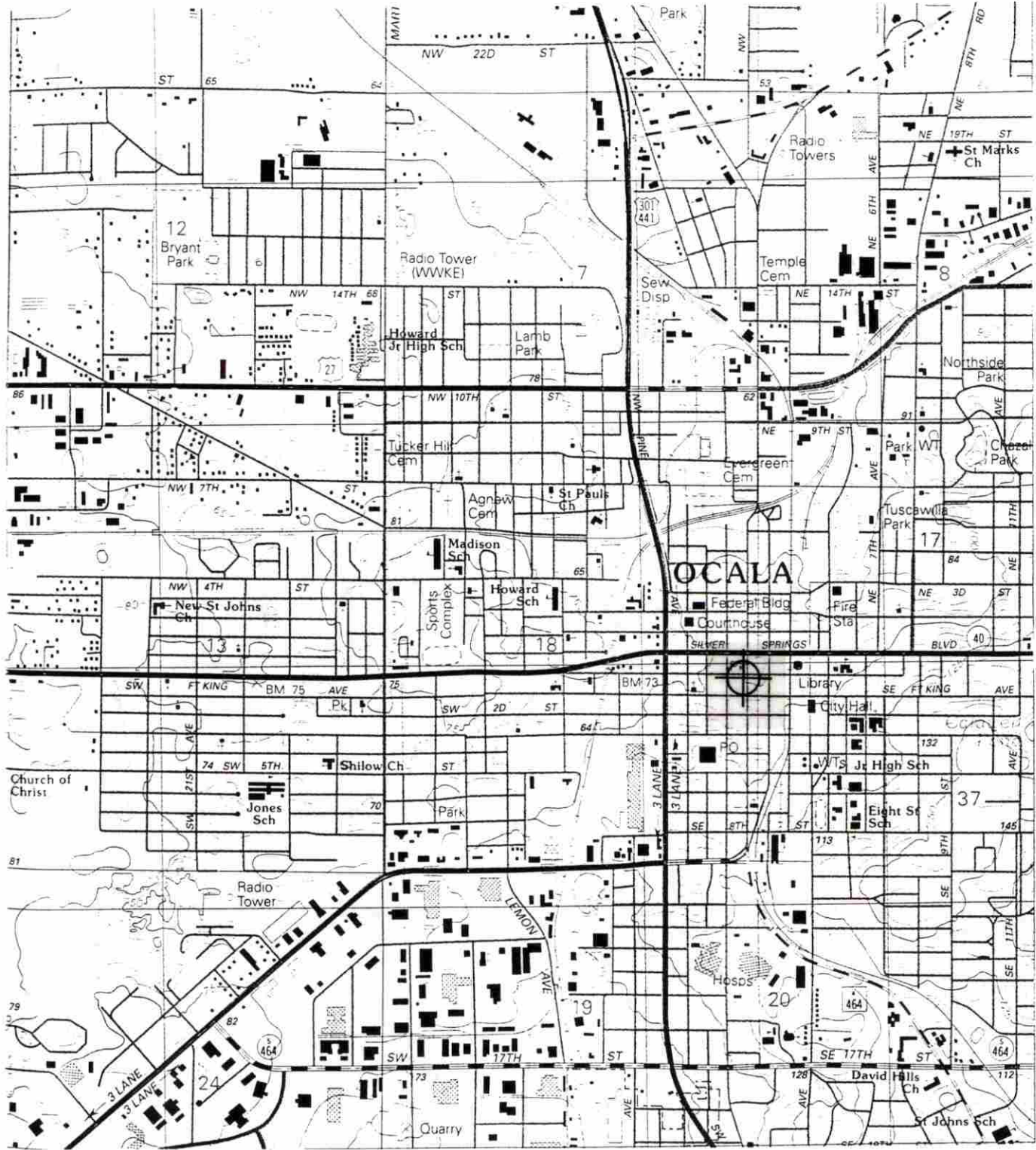

UTM GRID AND 1988 MAGNETIC NORTH DECLINATION AT CENTER OF SHEET



SW Broadway St

SPEED
LIMIT
25

HILLIARD'S

MP 2521
36 S. MANWOLLA
NE ELEV
FEB '97 2/19

008508* N N N N 1-112(022)
<###> 025