

This application is available in alternate formats upon request.

**REQUEST FOR WAIVER FROM ACCESSIBILITY REQUIREMENTS
OF CHAPTER 553, PART V, FLORIDA STATUTES**

Your application will be reviewed by the Accessibility Advisory Council and its recommendations will be presented to the Florida Building Commission. You will have the opportunity to answer questions and/or make a short presentation, not to exceed 15 minutes, at each meeting. The Commission will consider all information presented and the Council's recommendation before voting on the waiver request.

1. Name and address of project for which the waiver is requested.

Name: University of South Florida Soccer Park

Address: 4202 E. Fowler Ave. Tampa Fl, 33620

2. Name of Applicant. If other than the owner, please indicate relationship of applicant to owner and written authorization by owner in space provided:

Applicant's Name: W. Howard Bruning A.I.A. / R.R. Simmons Construction Corporation

Applicant's Address: 13112 Telecom Drive, Tampa, Fl 33637

Applicant's Telephone: 813-632-5590 FAX: 813-632-1200

Applicant's E-mail Address: howardbruning@rrsimmons.com

Relationship to Owner: Architect

Owner's Name: University of South Florida, Facilities Planning and Construction

Owner's Address: 4202 East Fowler Ave, FPC 110 Tampa, FL 33620-7550

Owner's Telephone: 813-974-0864 FAX 813-974-3542

Owner's E-mail Address: (Ray Gonzalez) rgonzale@admin.usf.edu

Signature of Owner:  _____

Contact Person: Ken Boeser – R.R. Simmons Construction Corporation (Design/Builder)

Contact Person's Telephone: 813-632-5519 **E-mail Address:** kenboeser@rrsimmons.com

This application is available in alternate formats upon request.

Form No. 2001-01

3. Please check one of the following:

New construction.



Addition to a building or facility.

Alteration to an existing building or facility.

Historical preservation (addition).

Historical preservation (alteration).

4. **Type of facility.** Please describe the building (square footage, number of floors). Define the use of the building (i.e., restaurant, office, retail, recreation, hotel/motel, etc.)

University Athletic Association Soccer Park for intercollegiate competitive practice and play, with spectator seating and associated pressbox, restrooms, concessions, and admissions ticket outbuildings. Spectator seating is designed for 500 fixed chair seats in tiers, 500 seats in bleacher style benches, and 1,000 general admission and student passes to provide admission to lawn seating areas on grassed berms at each end of the playing field behind the goals.

5. **Project Construction Cost (Provide cost for new construction, the addition or the alteration):**

New Construction –

Total cost including design, construction, and administrative costs: \$3.5 Million

6. **Project Status:** Please check the phase of construction that best describes your project at the time of this application. Describe status.

Under Design Under Construction*

In Plan Review Completed*

* Briefly explain why the request has now been referred to the Commission.
The facility

This design has been reviewed and a companion cost of construction presented to the University for acceptance. The project is proposed to be constructed simultaneously with the larger multi-venue project now under construction. Coordination of the major excavation part of the Soccer Park concept with the sitework for other adjacent facilities is important. Because the facility is being constructed completely within an on grade seating bowl, obtaining acceptance of a waiver and/or any conditions thereto is important for preparation of the final design and costs for the facility. Per FBC 11-4.1.3 Vertical accessibility shall be provided to all levels above and below the occupiable grade level. As shown, the project design documents do not show compliance with this criteria.

7. **Requirements requested to be waived.** Please reference the applicable section of Florida law. Only Florida-specific accessibility requirements may be waived.



Issue

1: On behalf of the Owner, the Applicant seeks a waiver of the vertical accessibility requirements of Section 553.509 of the Florida Americans with Disabilities Implementation Act, Florida Statutes. More specifically, The Owner seeks a waiver of the requirement to provide accessibility to each tier of seats in a stadium to be used for intercollegiate soccer events as would otherwise be required by the specifics of FBC 11-4.1.3 Accessible buildings: new construction, paragraph 2.

Issue

2: _____

Issue

3: _____

8. Reason(s) for Waiver Request: The Florida Building Commission may grant waivers of Florida-specific accessibility requirements upon a determination of unnecessary, unreasonable or extreme hardship. Please describe how this project meets the following hardship criteria. Explain all that would apply for consideration of granting the waiver.

The hardship is caused by a condition or set of conditions affecting the owner which does not affect owners in general.

By use of the design concept in this application, the Owner would be making an accommodation to accessible needs by improving on conventional seating used for similar venues by constructing seating on grade in the hillside. This accommodation provides for accessible seating at both the top and bottom levels, reasonably as an improvement over similar venues. Otherwise, the configuration of riser seating with accessibility to every tier causes extreme hardship over other building types.

Substantial financial costs will be incurred by the owner if the waiver is denied.

The means of compliance using conventional design elements compliant with FBC Chapter 13 using multiple ramps, elevator(s), and other transition elements would cause significant alteration to the overall spectator experience if accessibility to every tier level were provided. The addition of ramps to service each tier would create conflicts with lines of sight to the field of play due to layout and configuration requirements of those elements. The size and cost of the tiered seating would increase by up to 50% for the physical area needed for the requisite ramp structures. The project is being constructed with donated funds and no other sources of finance to extend the budget are available. Should the project costs increase substantially, the other features of the project essential to facility minimums proposed by the NCAA and the member athletic conference could not be met.



[X] The owner has made a **diligent investigation** into the costs of compliance with the code, but cannot find an efficient mode of compliance. Provide detailed cost estimates and, where appropriate, photographs. Cost estimates must include bids and quotes.

On behalf of the Owner, to provide equivalent compliance to FS 553.509, the Architect proposes accessible seating configurations consistent with the U.S. Department of Justice Disability Rights Section Publication: Accessible Stadiums.

9. **Provide documented cost estimates for each portion of the waiver request and identify any additional supporting data which may affect the cost estimates.** For example, for vertical accessibility, the lowest documented cost of an elevator, ramp, lift or other method of providing vertical accessibility should be provided, documented by quotations or bids from at least two vendors or contractors.

a. _____

b. _____

c. _____

10. **Licensed Design Professional:** Where a licensed design professional has designed the project, his or her comments **MUST** be included and certified by signature and affixing of his or her professional seal. The comments must include the reason(s) why the waiver is necessary.

It is the opinion of the Applicant that equivalent accommodation is being provided for in the design by dispersing the accessible seating throughout the venue and to historically preferred seating locations suggested by the USF Athletic Department - Directly behind the goals, at the top of the open lawn student seating behind the goals, adjacent to the pressbox, immediately behind the officials bench and team benches, and at the uppermost level behind each team. For this type of venue, the Owner reports that the preferred seating may be considered to be both the highest tier (for best view) and lowest level for close contact with the players on the field. Of note, because of the upper level promenade, significantly more accessible seating could be added with little or no physical accommodation for overflow events or events such as Special Olympics.



Signature

Phone number 813-632-5590

(SEAL)

W. Howard Bruning, A.I.A.

Printed Name

AR 0012909



CERTIFICATION OF APPLICANT:

I hereby swear or affirm that the applicable documents in support of this Request for Waiver are attached for review by the Florida Building Commission and that all statements made in this application are to the best of my knowledge true and correct.

Dated this 8th day of July, 2010

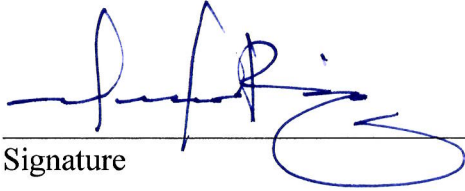

Signature

W. Howard Bruning A.I.A.
Vice President
R.R. Simmons Construction Corporation

Printed Name

By signing this application, the applicant represents that the information in it is true, accurate and complete. If the applicant misrepresents or omits any material information, the Commission may revoke any order and will notify the building official of the permitting jurisdiction. Providing false information to the Commission is punishable as a misdemeanor under Section 775.083, Florida Statutes.

REVIEW AND RECOMMENDATION BY LOCAL BUILDING DEPARTMENT.

Please state why the issue is being referred to the Florida Building Commission as well as a recommendation for disposition. The Building Official or his or her designee should review the application and indicate that to the best of his or her knowledge, all information stipulated herein is true and accurate. Further, if this project is complete, explain why it is being referred to the Commission. The Building Official or his or her designee should sign a copy of the plans accompanying this application as certification that such plans are the same as those submitted for building department review. Please reference the applicable section of the Accessibility Code.

a. This issue is being referred to the Florida Building Commission for waiver consideration of the Vertical accessibility to all levels of seating (FBC Sec 11-4.1.3) for tiered type seating in the spectator areas within the Soccer Park facility.

b. _____

c. _____

Has there been any permitted construction activity on this building during the past three years? If so, what was the cost of construction?

Yes No Cost of Construction _____

Comments/Recommendation _____

Jurisdiction University of South Florida

Building Official or Designee

Signature

Roy Clark, BCA

Printed Name

BU1281

Certification Number

813-974-0893

Telephone/FAX

Address: University of South Florida, 4202 E. Fowler Ave. FPC110 Tampa, FL 33620.

43

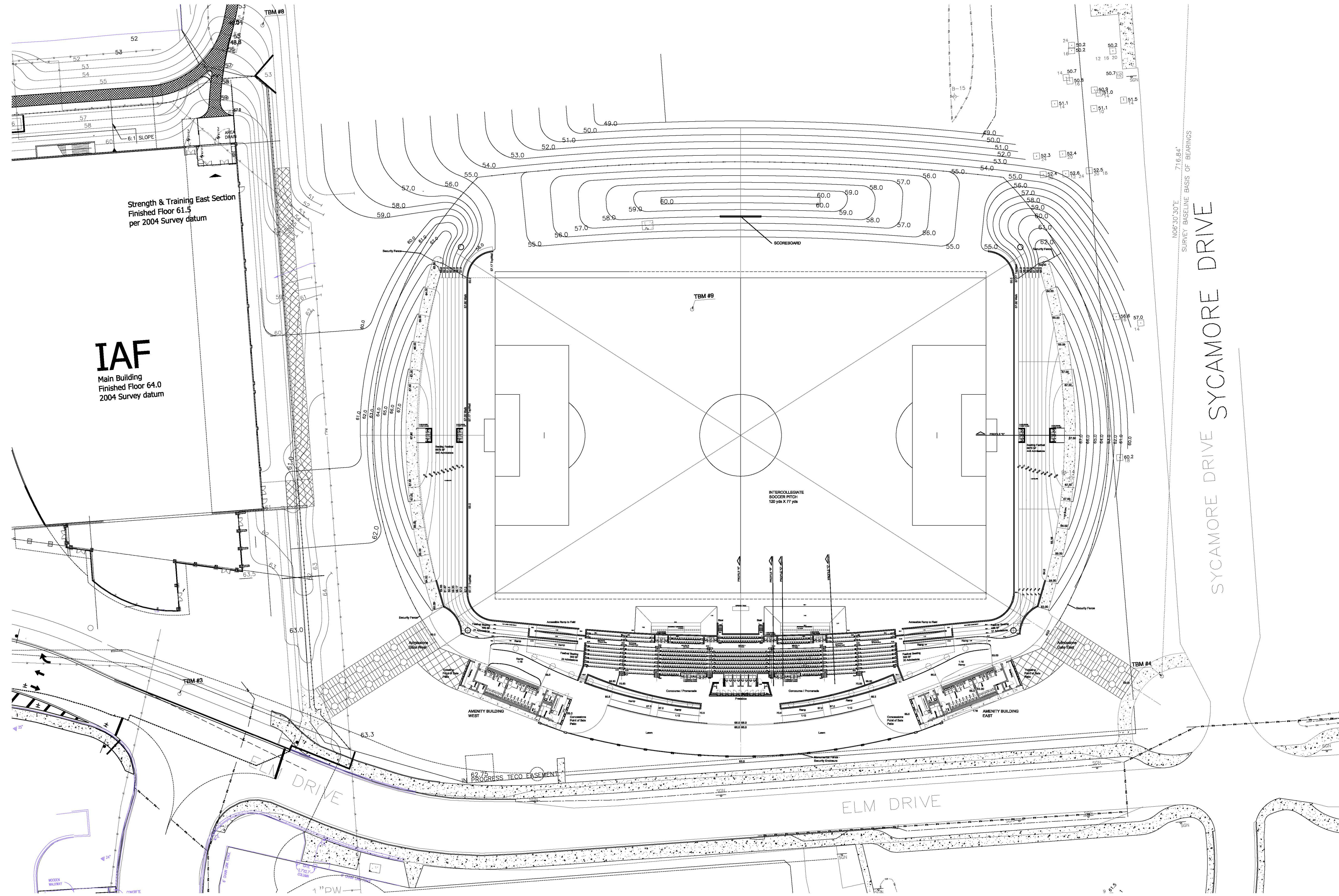

Revisions

No.	Description	Date

University of South Florida Soccer Park
4202 East Fowler Avenue FPC 110
Tampa, FL 33620

University of South Florida Facilities
Planning & Construction
4202 East Fowler Avenue FPC 110
Tampa, FL 33620

ISSUED: 07/09/10
REVIEW:
DRAWN:
PROJECT No. 10-903

© COPYRIGHT 2010
R R Simmons Construction Corporation
This drawing is the property of the
architect and may not be used or
reproduced without permission.
FL REG AA2600502

SHEET TITLE

Site Context
Soccer Park

SHEET NUMBER

A0.0

Revisions		
No.	Description	Date

University of South Florida Soccer Park
 4202 East Fowler Avenue FPC 110
 Tampa, FL 33620

University of South Florida Facilities
 Planning & Construction
 4202 East Fowler Avenue FPC 110
 Tampa, FL 33620

ISSUED: 07/09/10

REVIEW:

DRAWN:

PROJECT No. 10-903

© COPYRIGHT 2010
 R R Simmons Construction Corporation
 This drawing is the property of the
 architect and may not be used or
 reproduced without permission.
 FL REG AA2600502

SHEET TITLE

Site Plan
 Soccer Park

SHEET NUMBER

A0.1

ACCESSIBILITY WAIVER

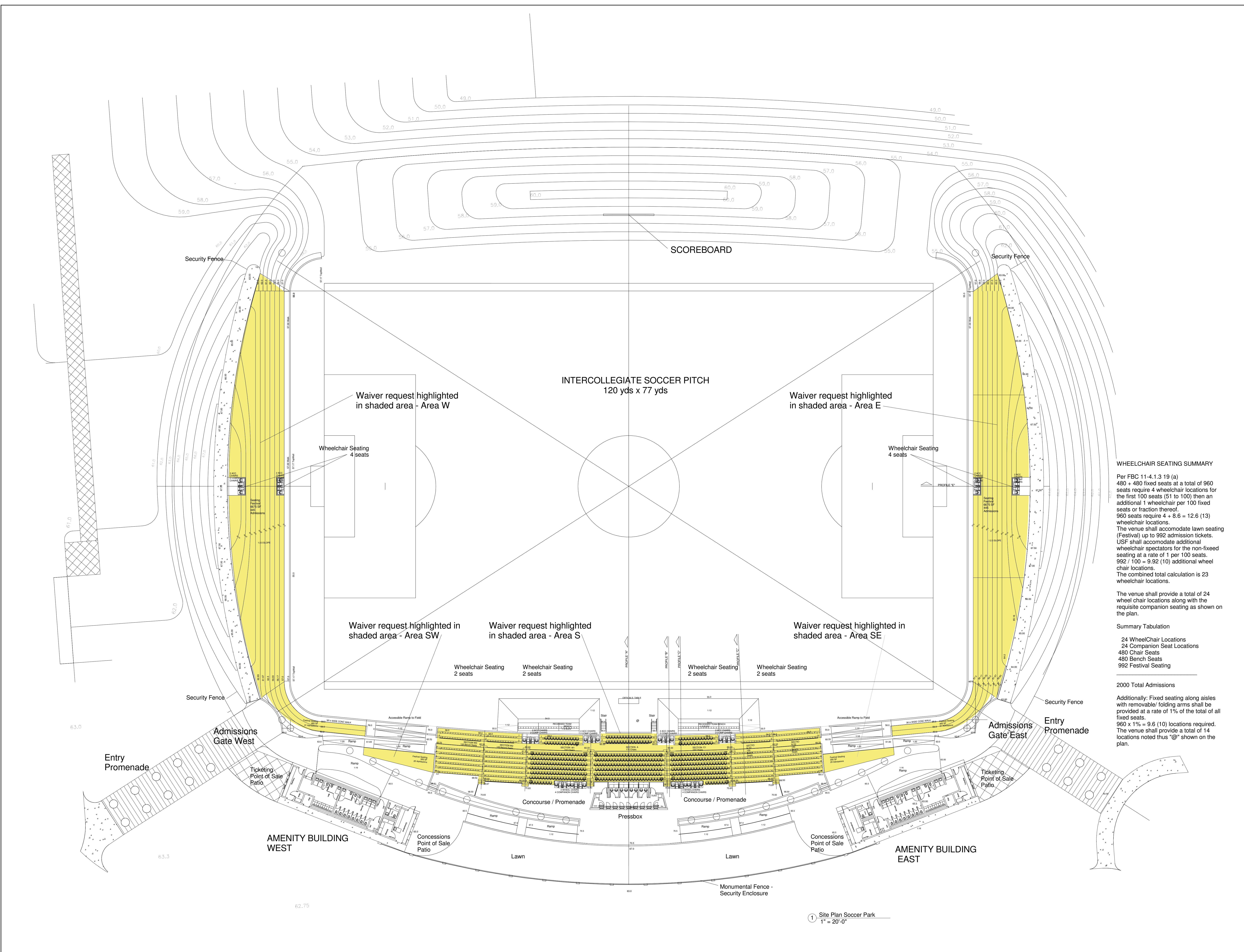

WHEELCHAIR SEATING SUMMARY

Per FBC 11-4.1.3 19 (a)
 480 + 480 fixed seats at a total of 960
 seats require 4 wheelchair locations for
 the first 100 seats (51 to 100) then an
 additional 1 wheelchair per 100 fixed
 seats or fraction thereof.
 960 seats require 4 + 8.6 = 12.6 (13)
 wheelchair locations.
 The venue shall accommodate lawn seating
 (Festival) up to 992 admission tickets.
 USF shall accommodate additional
 wheelchair spectators for the non-fixed
 seating at a rate of 1 per 100 seats.
 992 / 100 = 9.92 (10) additional wheel
 chair locations.
 The combined total calculation is 23
 wheelchair locations.

The venue shall provide a total of 24
 wheel chair locations along with the
 requisite companion seating as shown on
 the plan.

Summary Tabulation

24 WheelChair Locations
24 Companion Seat Locations
480 Chair Seats
480 Bench Seats
992 Festival Seating

2000 Total Admissions

Additionally: Fixed seating along aisles
 with removable/ folding arms shall be
 provided at a rate of 1% of the total of all
 fixed seats.
 960 x 1% = 9.6 (10) locations required.
 The venue shall provide a total of 14
 locations noted thus "@" shown on the
 plan.

① Site Plan Soccer Park
 1" = 20'-0"

Revisions

No.	Description	Date

University of South Florida Soccer Park
 4202 East Fowler Avenue FPC 110
 Tampa, FL 33620
 University of South Florida Facilities
 Planning & Construction
 4202 East Fowler Avenue FPC 110
 Tampa, FL 33620

ISSUED: 07/08/10

REVIEW:

DRAWN:

PROJECT No. 10-903

© COPYRIGHT 2010
 R R Simmons Construction Corporation
 This drawing is the property of the
 architect and may not be used or
 reproduced without permission.
 FL REG AA2600502

SHEET TITLE

Seating Plan
 Soccer Park

SHEET NUMBER

A0.2

ACCESSIBILITY WAIVER

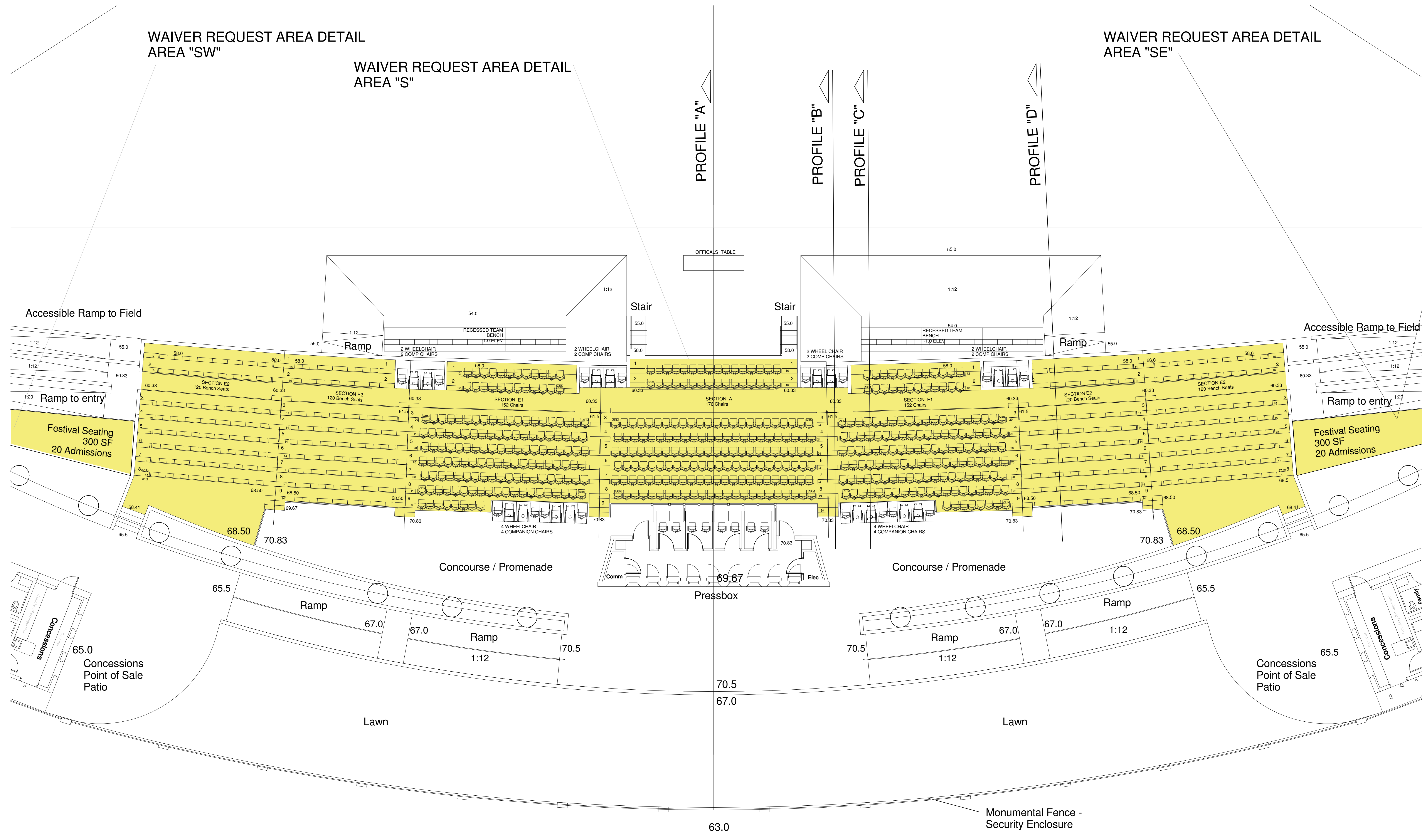

Revisions

No.	Description	Date

University of South Florida Soccer Park
 4202 East Fowler Avenue FPC 110
 Tampa, FL 33620
 University of South Florida Facilities
 Planning & Construction
 4202 East Fowler Avenue FPC 110
 Tampa, FL 33620

ISSUED: 07/09/10

REVIEW:

DRAWN:

PROJECT No. 10-903

© COPYRIGHT 2010
 R R Simmons Construction Corporation
 This drawing is the property of the
 architect and may not be used or
 reproduced without permission.
 FL REG AA26500502

SHEET TITLE

Sight Line
 Studies
 Soccer Park

SHEET NUMBER

A0.3

ACCESSIBILITY WAIVER

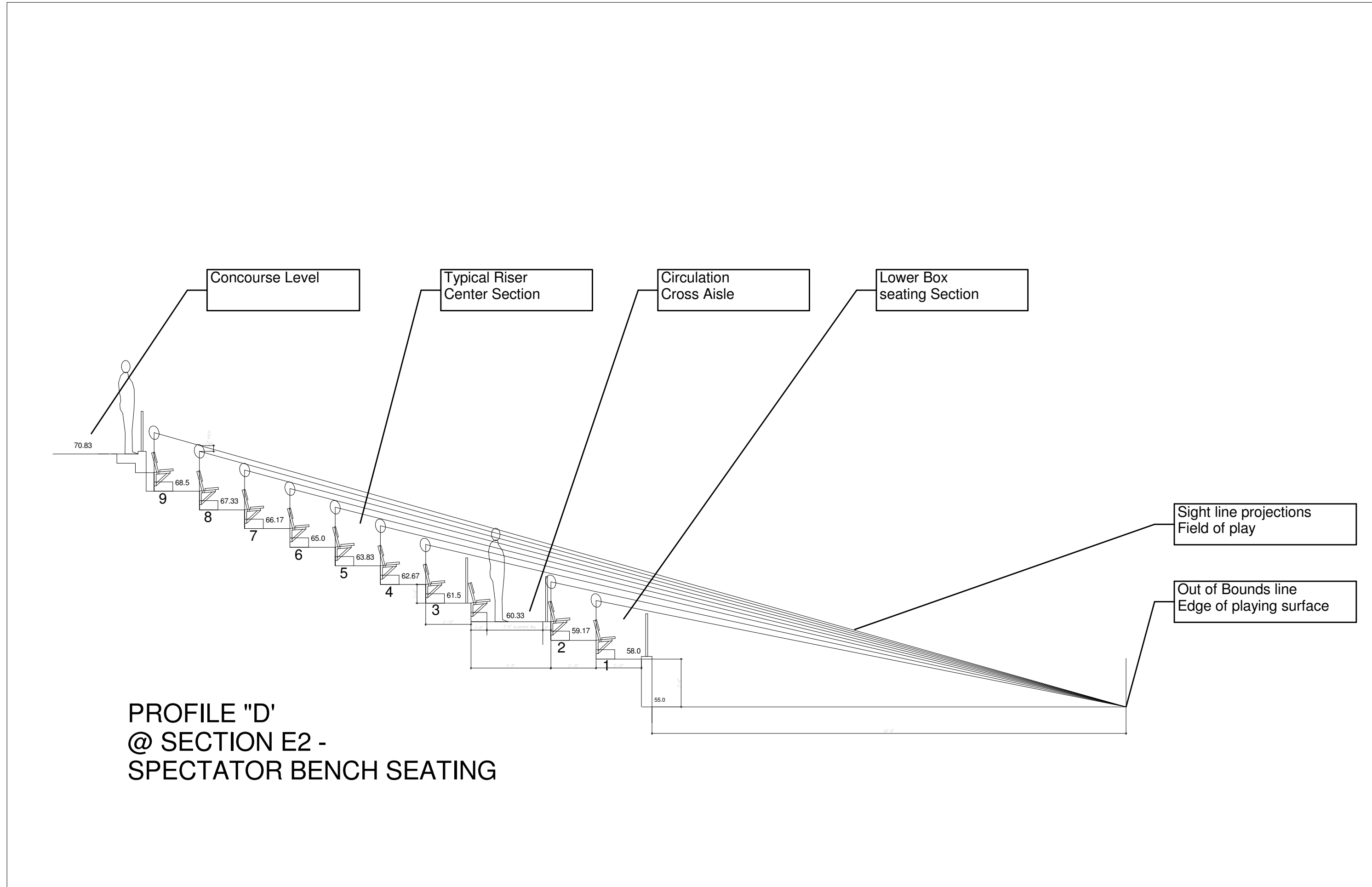
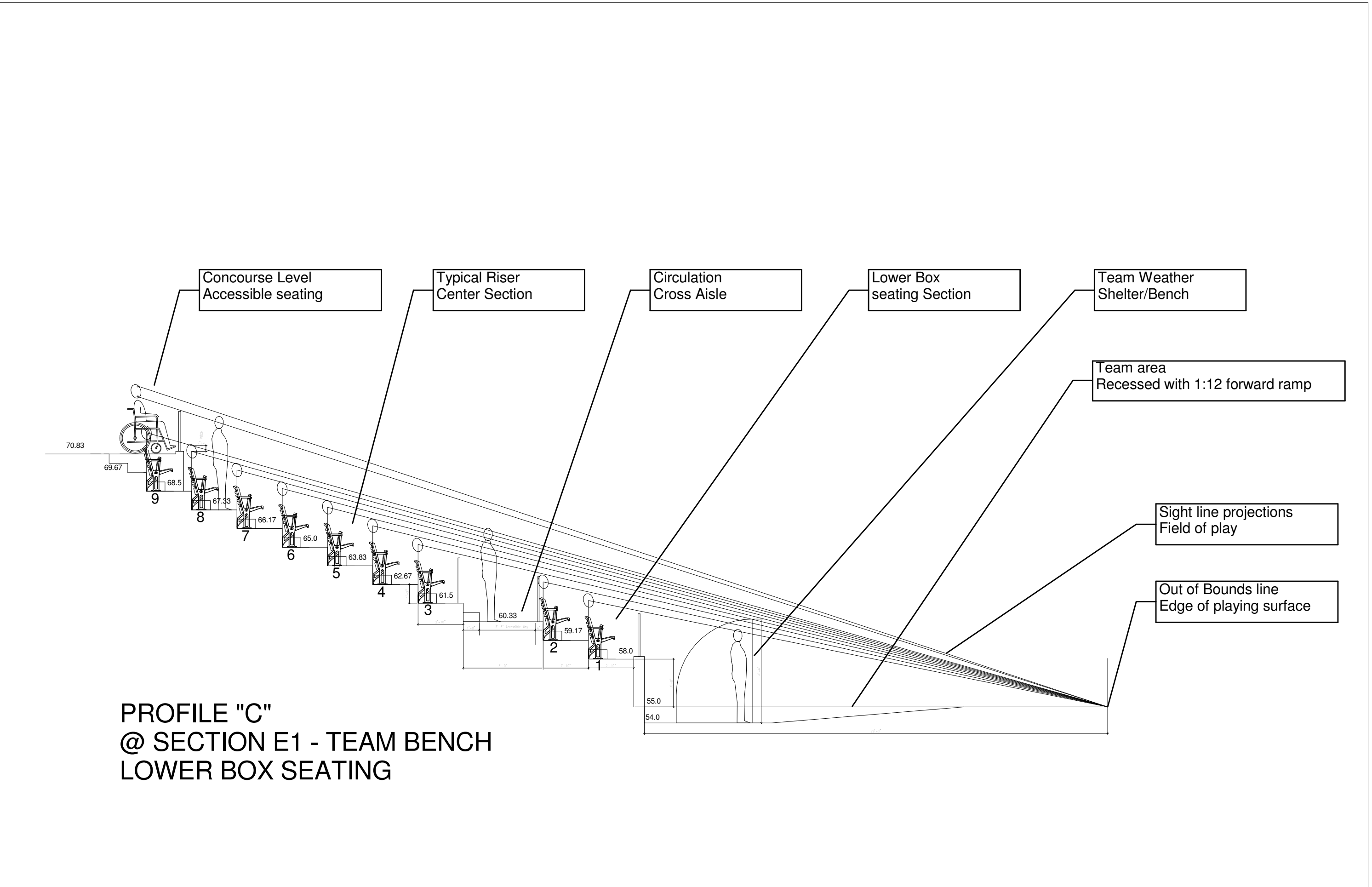
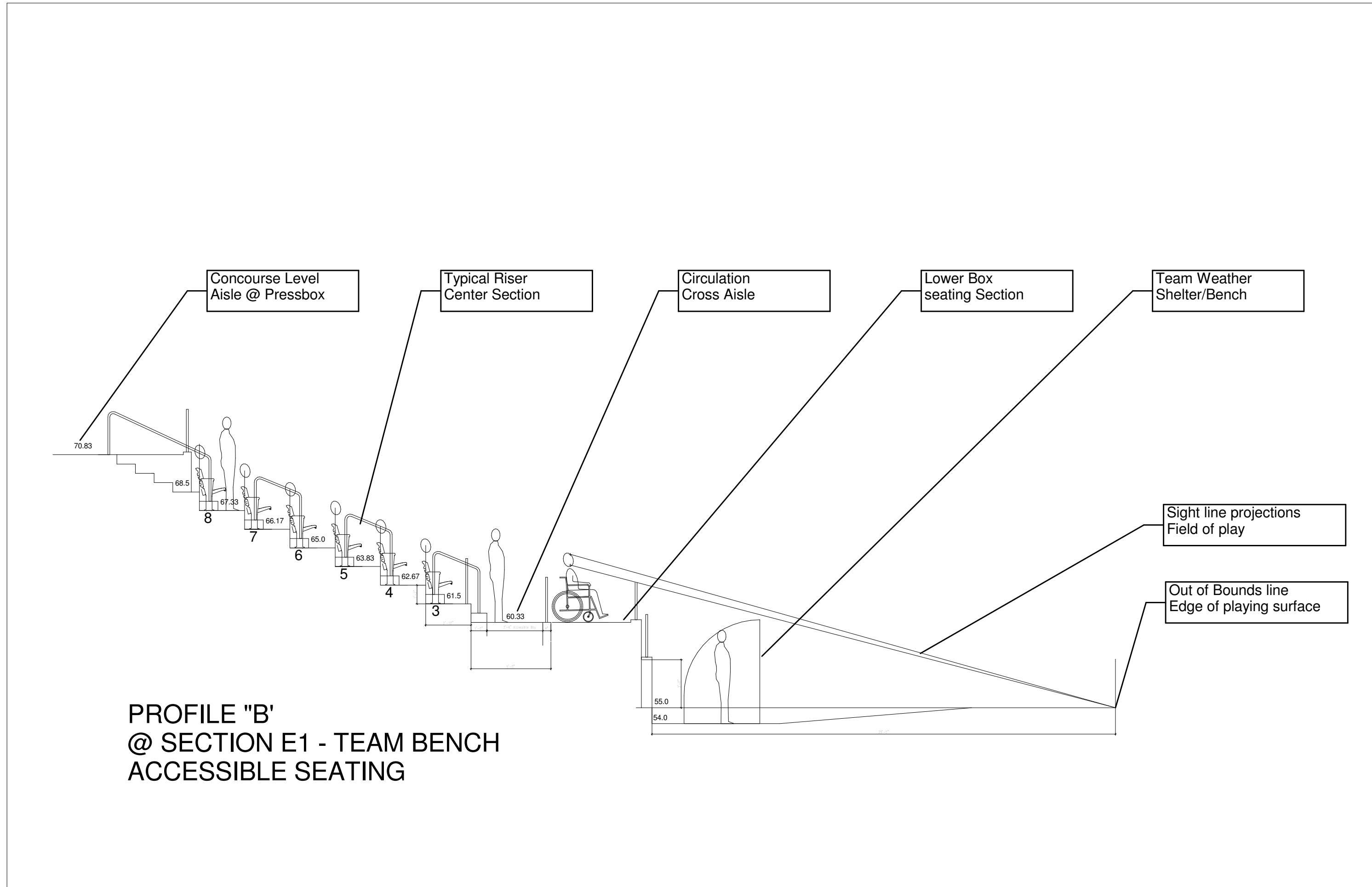
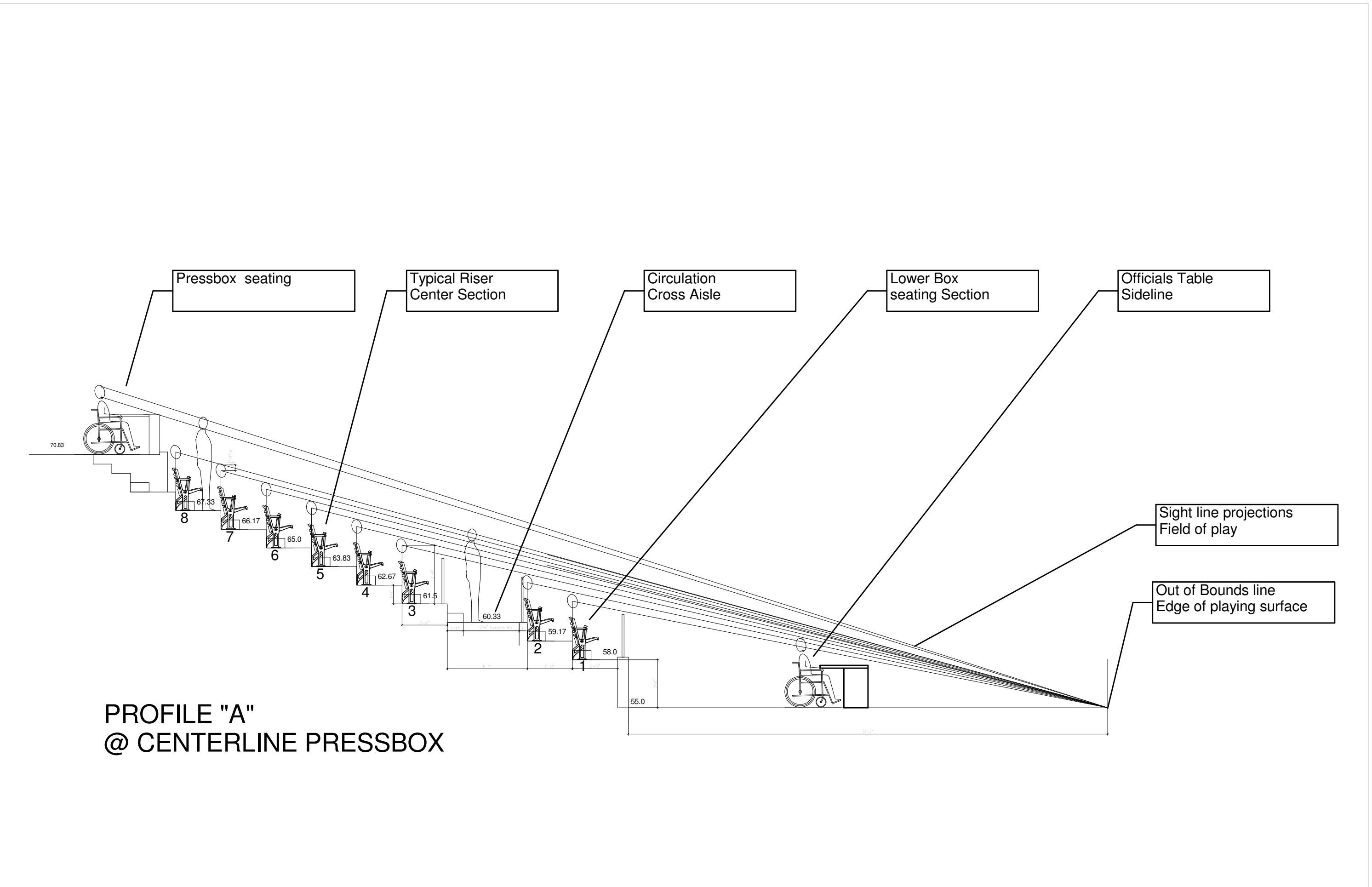

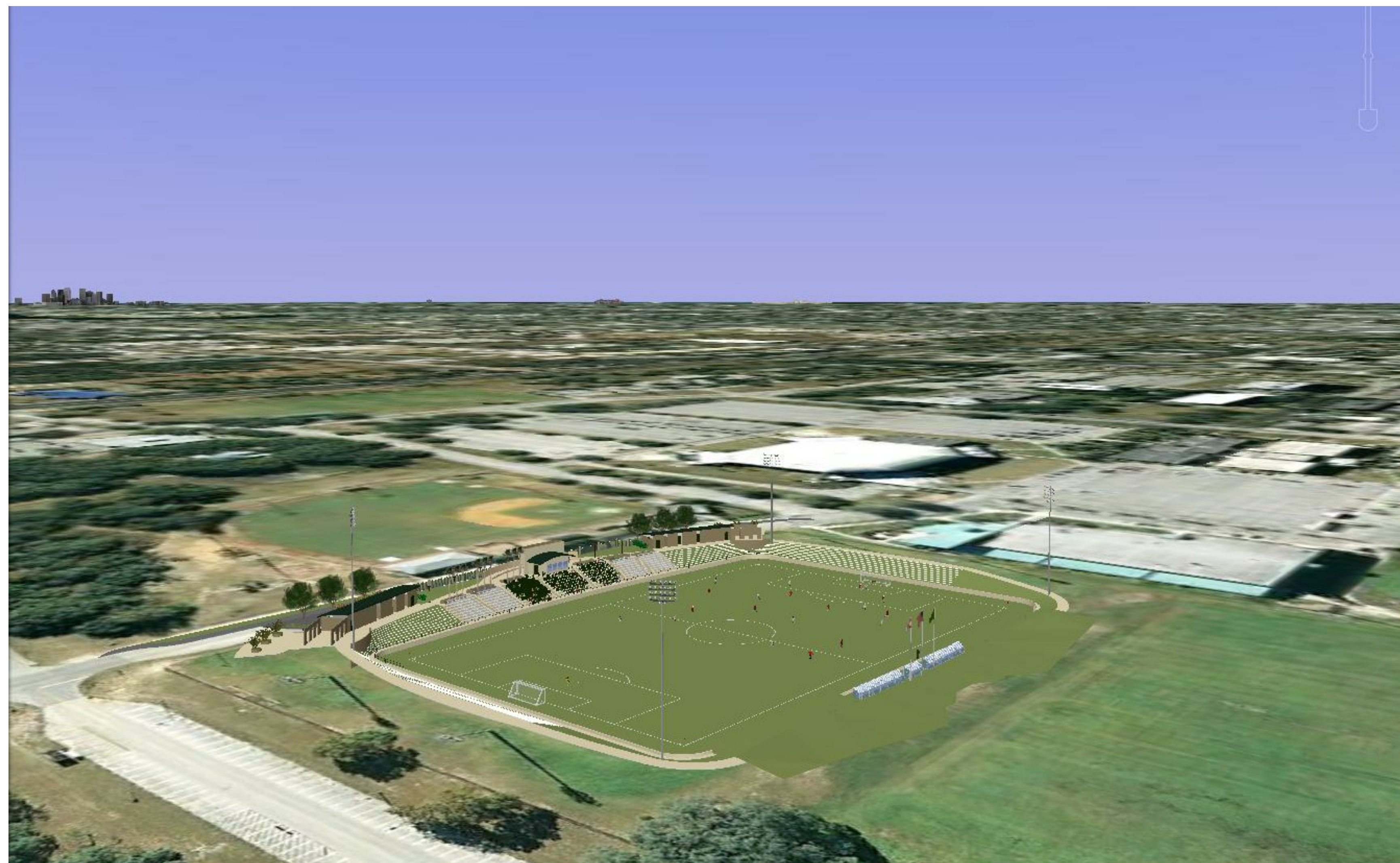
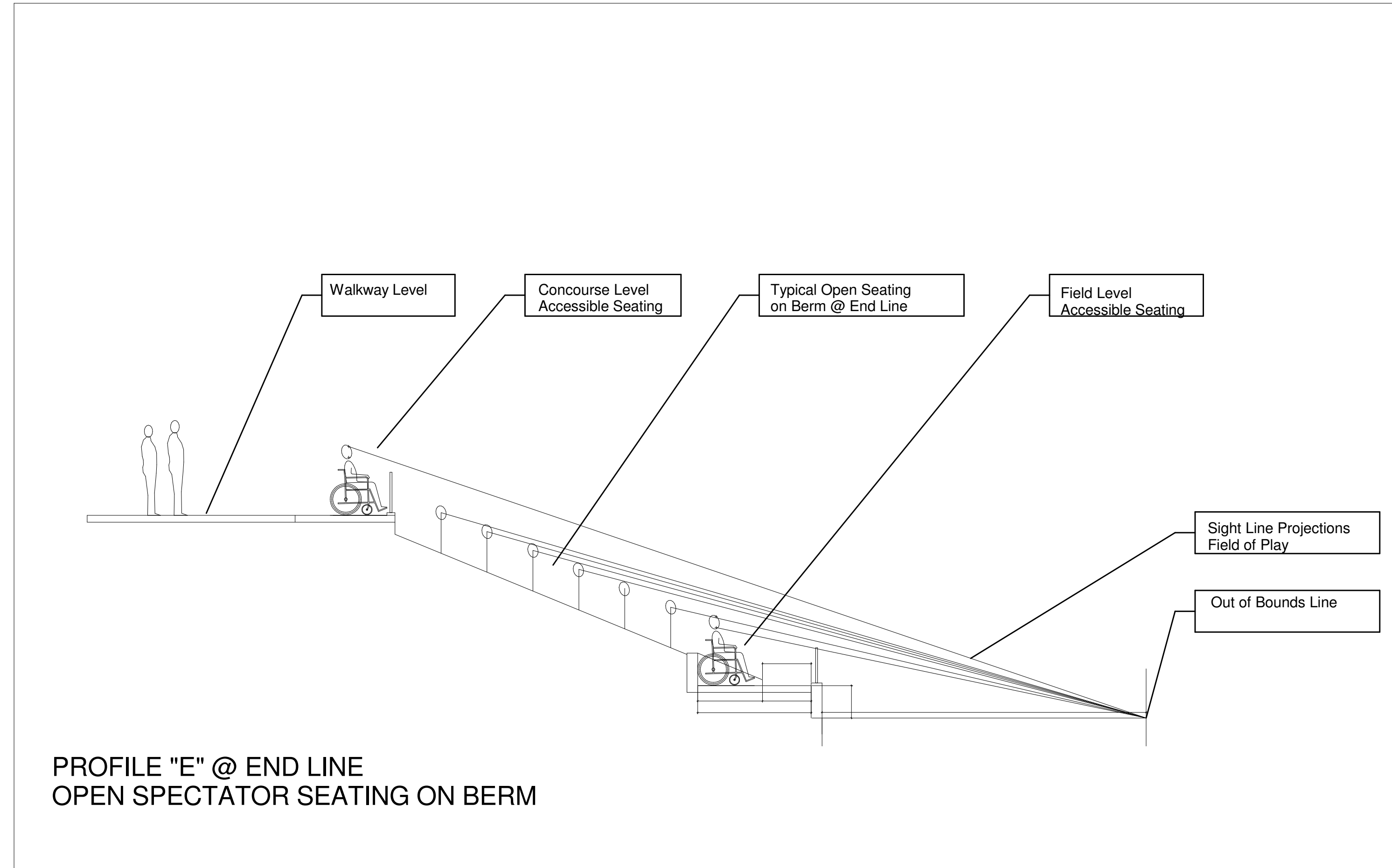

Revisions

No.	Description	Date

University of South Florida Soccer Park
4202 East Fowler Avenue FPC 110
Tampa, FL 33620
University of South Florida Facilities
Planning & Construction
4202 East Fowler Avenue FPC 110
Tampa, FL 33620

ISSUED: 07/09/10

REVIEW:

DRAWN:

PROJECT No. 10-903

© COPYRIGHT 2010
R R Simmons Construction Corporation
This drawing is the property of the
architect and may not be used or
reproduced without permission.
FL REG AA2600502

SHEET TITLE

Sight Line
Studies

SHEET NUMBER

A0.4