

MUVICO THEATERS – COCOWALK

Issue: Vertical accessibility to all rows of seats in a stadium type movie theater.

Analysis: The applicant is requesting a waiver from providing vertical accessibility to all rows of seats in an existing 16 theater complex that is being reduced to 8 screens. The theaters range from 48 to 151 seats and all required wheelchair locations with companion seating have been provided. No wheelchair seating is on the end of a row in any theater. The project will cost \$4,000,000 and according to the applicant it is technically infeasible to make every row in each theater accessible, nor is it cost effective.

Project Progress:

The project is under design.

Items to be Waived:

Vertical accessibility to all rows of seats, as required by Section 553.509, Florida Statutes.

553.509 Vertical accessibility. Nothing in Sections 553.501-553.513 or the guidelines shall be construed to relieve the owner of any building, structure or facility governed by those sections from the duty to provide vertical accessibility to all levels above and below the occupiable grade level regardless of whether the guidelines require an elevator to be installed in such building, structure or facility, except for:

- (1) Elevator pits, elevator penthouses, mechanical rooms, piping or equipment catwalks and automobile lubrication and maintenance pits and platforms;
- (2) Unoccupiable spaces, such as rooms, enclosed spaces and storage spaces that are not designed for human occupancy, for public accommodations or for work areas; and
- (3) Occupiable spaces and rooms that are not open to the public and that house no more than five persons, including, but not limited to equipment control rooms and projection booths.

Waiver Criteria: There is no specific guidance for a waiver of this requirement in the code. The Commission's current rule, authorized in Section 553.512, Florida Statutes, provides criteria for granting waivers and allows consideration of unnecessary or extreme hardship to the applicant if the specific requirements were imposed.

**REQUEST FOR WAIVER FROM ACCESSIBILITY REQUIREMENTS
OF CHAPTER 553, PART V, FLORIDA STATUTES**

Your application will be reviewed by the Accessibility Advisory Council and its recommendations will be presented to the Florida Building Commission. You will have the opportunity to answer questions and/or make a short presentation, not to exceed 15 minutes, at each meeting. The Commission will consider all information presented and the Council's recommendation before voting on the waiver request.

1. Name and address of project for which the waiver is requested.

Name: Muvico Theaters – Cocowalk – Coconut Grove, Florida

Address: 3015 Grand Avenue, Coconut Grove, Florida 33133

2. Name of Applicant. If other than the owner, please indicate relationship of applicant to owner and written authorization by owner in space provided:

Applicant's Name: Larry M. Schneider, AIA

Applicant's Address: 9319 NW 48 Doral Terrace, Miami, Florida 33178

Applicant's Telephone: 786-336-1984 **FAX:** 786-336-1985

Applicant's E-mail Address: Larry@LMSArch.net

Relationship to Owner: Accessibility Consultant

Owner's Name: Muvico Entertainment, LLC.- George Figler, Director of Design and Construction

Owner's Address: 3101 North Federal Highway - 6th Floor, Ft. Lauderdale, Florida

Owner's Telephone: 954-5646550 **FAX** 954-5646553

Owner's E-mail Address: george.figler@muyico.com

Signature of Owner: _____

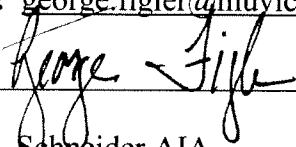

Contact Person: Larry M. Schneider AIA

Contact Person's Telephone: 786-3361984 **E-mail Address:** Larry@LMSArch.net

3. **Please check one of the following:**

New construction.

Addition to a building or facility.

Alteration to an existing building or facility.

Historical preservation (addition).

Historical preservation (alteration).

4. **Type of facility.** Please describe the building (square footage, number of floors). Define the use of the building (i.e., restaurant, office, retail, recreation, hotel/motel, etc.)

The project is a eight screen cinema with stadium style seating with theater seating ranges from 50, 63, 64, 72, 76, 79, 127, 132 and 154 seats. This is an existing facility in which there are 16 theaters of which six of them are going to be removed and ten existing theaters are to be altered per the drawings submitted.

5. **Project Construction Cost (Provide cost for new construction, the addition or the alteration):** \$ Estimated Project Budget is \$5,000,000

6. **Project Status:** Please check the phase of construction that best describes your project at the time of this application. Describe status.

Under Design Under Construction*

In Plan Review Completed*

* Briefly explain why the request has now been referred to the Commission.

NA

7. **Requirements requested to be waived.** Please reference the applicable section of Florida law. Only Florida-specific accessibility requirements may be waived.

Issue: Compliance with Section 553.509 Florida State Statutes

1:553.509 Vertical accessibility.--Nothing in sections 553.501-553.513 or the guidelines shall be **construed to relieve the owner** of any building, structure, or facility governed by those sections **from the duty to provide vertical accessibility to all levels** above and below the occupiable grade level, regardless of whether the guidelines require an elevator to be installed in such building, structure, or facility,

8. **Reason(s) for Waiver Request:** The Florida Building Commission may grant waivers of Florida-specific accessibility requirements upon a determination of unnecessary, unreasonable or extreme hardship. Please describe how this project meets the following hardship criteria.

Explain all that would apply for consideration of granting the waiver.

The hardship is caused by a condition or set of conditions affecting the owner which does not affect owners in general.

The issue of the requirement for vertical accessibility to all levels, as mandated by the Florida State Statutes, section 553.509 VERTICAL ACCESSIBILITY. This section states that - **Nothing in sections 553.501 - 553.513 or the guidelines shall be construed to relieve the owner of any building, structure, or facility governed by those sections from the duty to provide vertical accessibility to all levels above and below the habitable grade level, regardless of whether the guidelines require an elevator to be installed in such building, structure, or facility.** However, we do not believe that this type of construction (stadium style seating in a movie theater) was contemplated by the legislation in the drafting and implementation of the law for vertical accessibility and that the statute itself would impose a hardship on the applicant that is unique to the situation and more specifically its use nor that they meant that **every level** of stadium style seating shall be made accessible. The concept of stadium type seating is the current standard that the movie theater industry is using for all new theater designs. The industry, around the country, have been using section 4.33.3 Placement of Wheelchair Locations for proceeding with their designs. This section states that - **Wheelchair areas shall be an integral part of any fixed seating plan and shall be provided so as to provide people with physical disabilities a choice of admission prices and lines of sight comparable to those for members of the general public. They shall adjoin an accessible route that also serves as a means of egress in case of emergency. At least one companion fixed seat shall be provided next to each wheelchair seating area. When the seating capacity exceeds 300, wheelchair spaces shall be provided in more than one location. Readily removable seats may be installed in wheelchair spaces when the spaces are not required to accommodate wheelchair users. EXCEPTION: Accessible viewing positions may be clustered for bleachers, balconies, and other areas having sight lines that require slopes of greater than 5 percent. Equivalent accessible viewing positions may be located on levels having accessible egress.** Muvico has listened to (The Theater Design Charette) and has adjusted their designs to work towards accomplishing the requests/desires of the Council and the Commission. The concern of the industry is to strike a balance between the desires of the Council and the Commission and the construction process. It is financial impracticable to provide vertical accessibility to **EACH** level of stadium style seating in a movie theater. This is due to the costs that would be required by the accessible design requirements of the FACBC and the ADA (e.g.: **They [the seating] shall adjoin an accessible route that also serves as a means of egress in case of emergency**). You can not do this for each level and build stadium style seating that would provide a cost effective and usable solution to meet all of the Florida specific requirements relating to this issue. With this in mind Muvico has worked towards providing the accessible seating in the first row of the start of the stadium seating (at the crossover aisle); with this row providing a viewing angle of 15 to 30 degrees depending on the size of the movie house. We have obtained the goal of accessible seating in an area with an acceptable viewing angle by locating the accessible seating along the crossover aisle which is on a raised position. The accessible seating is disbursed on either side with the applicable companion seating available. This project will comply with all of the other requirements of section 4.33 as it relates to this type of seating. We believe that this viable solution will meet the concerns and needs of all parties.

[X] Substantial financial costs will be incurred by the owner if the waiver is denied.

The issue of providing vertical accessibility to all levels of stadium style seating in a movie theater is not technically feasible, is an extreme hardship and is unreasonable.

[X] The owner has made a **diligent investigation** into the costs of compliance with the code, but cannot find an efficient mode of compliance. Provide detailed cost estimates and, where appropriate, photographs. Cost estimates must include bids and quotes.

9. **Provide documented cost estimates for each portion of the waiver request and identify any additional supporting data which may affect the cost estimates.** For example, for vertical accessibility, the lowest documented cost of an elevator, ramp, lift or other method of providing vertical accessibility should be provided, documented by quotations or bids from at least two vendors or contractors.

a. _____

b. _____

10. **Licensed Design Professional:** Where a licensed design professional has designed the project, his or her comments **MUST** be included and certified by signature and affixing of his or her professional seal. The comments must include the reason(s) why the waiver is necessary.

Under Florida State Statutes a waiver can be granted for one of the following reasons - a determination of unnecessary, unreasonable, or extreme hardship. We believe that we would qualify under an unreasonable, an extreme hardship and technically infeasible. We concur with the reasoning as so stated under item 8.

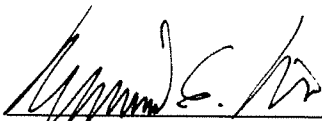

Signature

NEIL E. DIXON

Printed Name

Phone number: 954.523.3500
(SEAL)

NOT VALID UNLESS IT BEARS
AN ORIGINAL SIGNATURE AND
A RAISED EMBOSSED
ARCHITECT SEAL

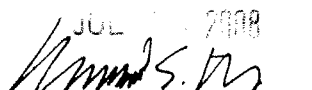
JUL 11 2008

NEIL EDWIN DIXON
FLORIDA ARCHITECT
No. AR 0013519

CERTIFICATION OF APPLICANT:

I hereby swear or affirm that the applicable documents in support of this Request for Waiver are attached for review by the Florida Building Commission and that all statements made in this application are to the best of my knowledge true and correct.

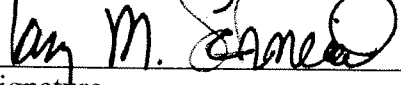
Dated this 18th day of July, 2008



Signature

Larry M. Schneider AIA
Printed Name

By signing this application, the applicant represents that the information in it is true, accurate and complete. If the applicant misrepresents or omits any material information, the Commission may revoke any order and will notify the building official of the permitting jurisdiction. Providing false information to the Commission is punishable as a misdemeanor under Section 775.083, Florida Statutes.

REVIEW AND RECOMMENDATION BY LOCAL BUILDING DEPARTMENT.

Please state why the issue is being referred to the Florida Building Commission as well as a recommendation for disposition. The Building Official or his or her designee should review the application and indicate that to the best of his or her knowledge, all information stipulated herein is true and accurate. Further, if this project is complete, explain why it is being referred to the Commission. The Building Official or his or her designee should sign a copy of the plans accompanying this application as certification that such plans are the same as those submitted for building department review. Please reference the applicable section of the Accessibility Code.

a. 553.509 Vertical accessibility.--Nothing in sections 553.501-553.513 or the guidelines shall be construed to relieve the owner of any building, structure, or facility governed by those sections from the duty to provide vertical accessibility to all levels above and below the occupiable grade level, regardless of whether the guidelines require an elevator to be installed in such building, structure, or facility. Section 11-4.1.6(1)(k)(iii) of the FACBC.

b. _____

c. _____

Has there been any permitted construction activity on this building during the past three years? If so, what was the cost of construction?

Yes No Cost of Construction _____

Comments/Recommendation:

Jurisdiction Coconut Grove, Florida

Building Official or Designee

Signature

Printed Name

Certification Number

Telephone/FAX

Address: _____



3:\data\Projects\315Grand\315Grand.dwg 11/11/2009 10:57:58 AM 2009

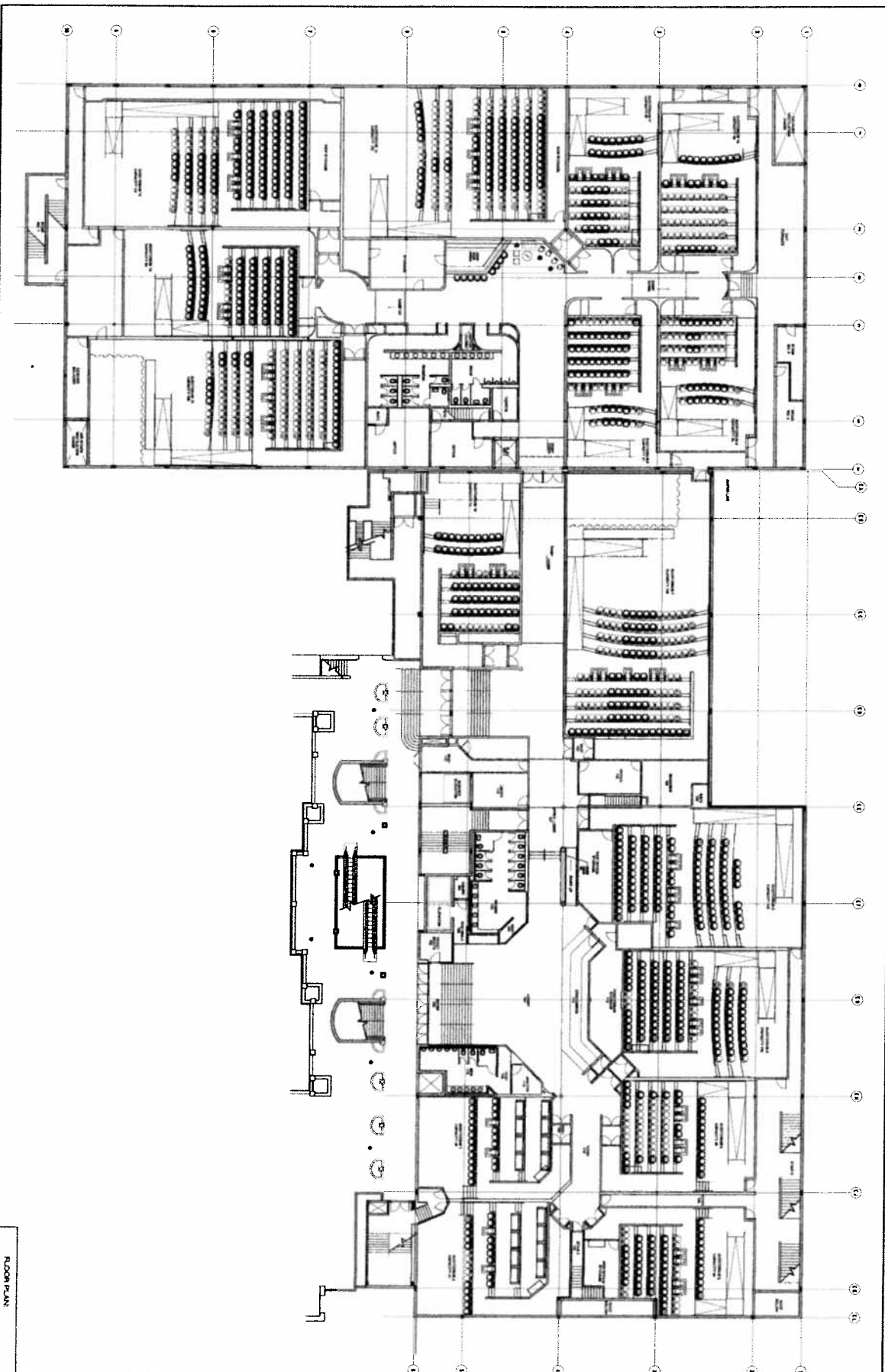

FLOOR PLAN
Scale 1/8" = 1'-0"

THEATER ELEVATIONS

NO.	DESCRIPTION	DATE	BY	CHECKED

MUVICO THEATERS
 THEATERS • SEATING • STAGE
3015 Grand Avenue
 Coconut Grove, Florida 33133

OWNER
 MUVICO THEATERS
 3015 Grand Avenue
 Coconut Grove, Florida 33133
 (305) 444-1111
 www.muvico.com

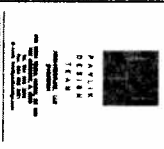

- ◆ FINISHED CEILING
ELEV. 64'-8"
- ◆ EXIST MEZZ FLR
ELEV. 60'-6"
- ◆ NEW/EXIST FLR
ELEV. 49'-6"
- ◆ SLAB
ELEV. 47'-0"

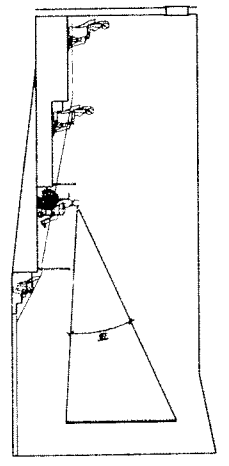

ELEVATION:
THEATER 1
SCALE 1/8"=1'-0"

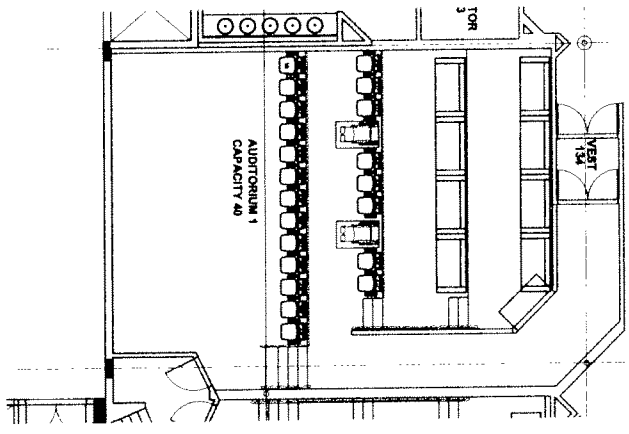

FLOOR PLAN:
THEATER 1
SCALE 1/8"=1'-0"

**PAULIK
DESIGN
TEAM**
ARCHITECTS, PC
1000 N. W. 10th Street, Suite 200
Fort Lauderdale, FL 33304
Tel: 954.575.1100
Fax: 954.575.1101
www.paulikdesign.com



ENGINEER
THE ARCHITECTS FOR ARCHITECTS
2017 West Cypress Drive
Fort Lauderdale, FL 33304
Tel: 954.575.1100
Fax: 954.575.1101
www.the-architects.com
Certified: Robert Brown, P.E., ASCE
EIT 100000000

NO.	DESCRIPTION	DATE
1	ISSUED FOR PERMIT	10/15/17
2	ISSUED FOR CONSTRUCTION	10/15/17
3	ISSUED FOR AS-BUILT	10/15/17

**MUVICO
THEATERS**
THE WORLD'S PREMIER MOVIE EXPERIENCE
3015 Grand Avenue
Coconut Grove, Florida 33133

THEATER
ELEVATIONS

NO.	DESCRIPTION	DATE
1	ISSUED FOR PERMIT	10/15/17
2	ISSUED FOR CONSTRUCTION	10/15/17
3	ISSUED FOR AS-BUILT	10/15/17

- ◆ FINISHED CEILING
ELEV. 94'-8"
- ◆ EXIST MEZZ FLR
ELEV. 99'-8"
- ◆ NEW/EXIST FLR
ELEV. 49'-8"
- ◆ SLAB
ELEV. 47'-0"

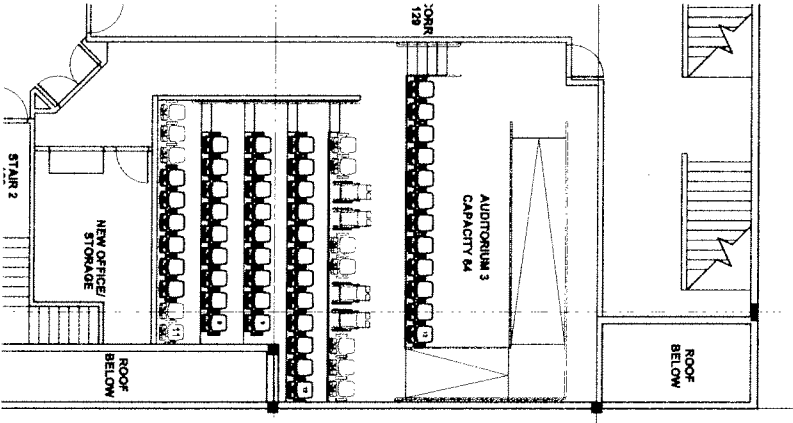
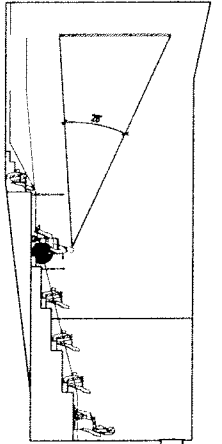

ELEVATION: THEATER 3
SCALE: 1/4" = 1'-0"

FLOOR PLAN: THEATER 3
SCALE: 1/4" = 1'-0"

PAYLIK DESIGN TEAM
ARCHITECTS, INC.
1000 N. W. 10th Ave., Suite 100
Fort Lauderdale, FL 33304
Tel: 954.575.1111
Fax: 954.575.1112
www.paylikdesign.com

TD ENGINEERING
ENGINEER
DESIGNING FOR MOVIES
1000 N. W. 10th Ave., Suite 100
Fort Lauderdale, FL 33304
Tel: 954.575.1111
Fax: 954.575.1112
www.td-engineering.com

MUVICO THEATERS
THE WORLD'S PREMIER MOVIE EXPERIENCE
3015 Grand Avenue
Coconut Grove, Florida 33133

THEATER ELEVATIONS

NO.	DESCRIPTION	DATE	BY	CHKD.

- ◆ FINISHED CEILING
ELEV. 84'-6"
- ◆ EXIST MEZZ FLR
ELEV. 89'-6"
- ◆ NEW/EXIST FLR
ELEV. 89'-6"
- ◆ SLAB
ELEV. 47'-0"

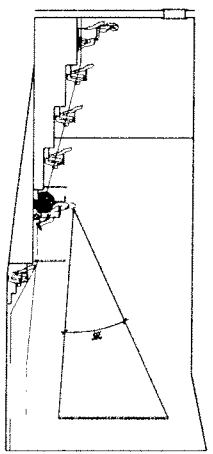

ELEVATION:
THEATER 4
SCALE 1/8"=1'-0"

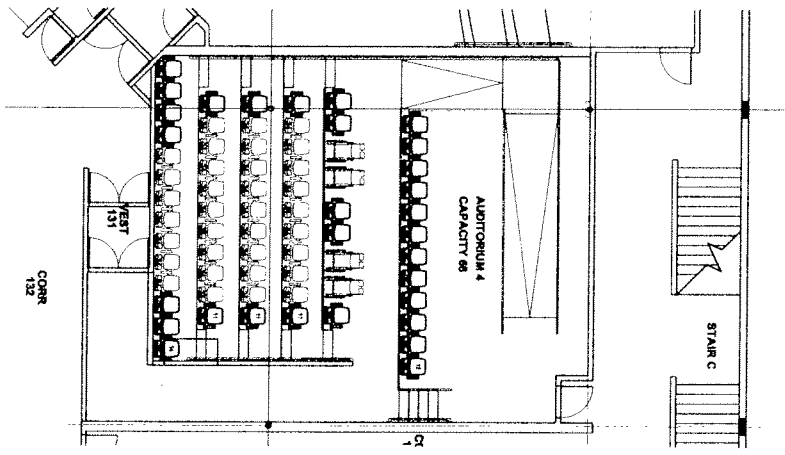

FLOOR PLAN:
THEATER 4
SCALE 1/8"=1'-0"



PAULIK
DESIGN
FEAR
ARCHITECTS, LLC
1001 N. W. 10th St.
Fort Lauderdale, FL 33304
Tel: 954.333.1111
Fax: 954.333.1112
www.paulikdesign.com



ENGINEER
TIC ENGINEERS FOR ARCHITECTS
20357 New Lagoon Drive
Miami, Florida 33150
Tel: (305) 296-8800
Fax: (305) 296-8801
CONTACT: Marka Shuman
634500075 TIC/0807048

NO.	DATE	DESCRIPTION

MUVICO THEATERS
THE WORLD'S PREMIER MOVIE EXPERIENCE
3015 Grand Avenue
Coconut Grove, Florida 33133

THEATER
ELEVATIONS

NO.	DATE	DESCRIPTION

- ◆ FINISHED CEILING
ELEV. 84'-5"
- ◆ EXIST. MEZZ. FLR.
ELEV. 80'-0"
- ◆ NEW/EXIST. FLR.
ELEV. 49'-5"
- ◆ SLAB
ELEV. 47'-0"

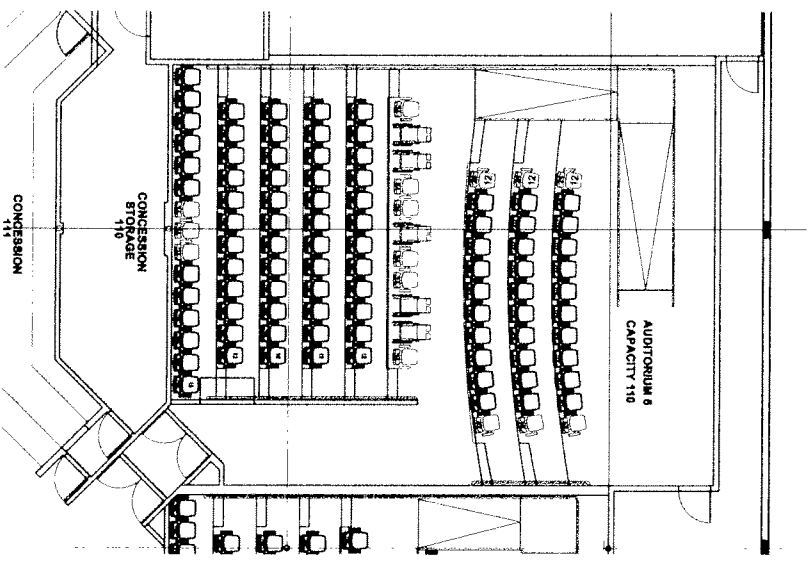
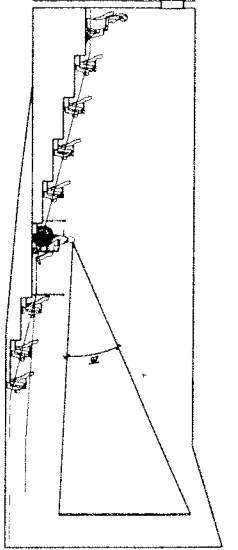

FLOOR PLAN
THEATER 5
ROOM 110-119

PAYLIK DESIGN TEAM
 ARCHITECTS, LLC
 1000 BAYVIEW BLVD., SUITE 100
 MIAMI, FL 33134
 TEL: 305.371.1111
 FAX: 305.371.1112
 WWW.PAYLIKDESIGN.COM

ENGINEER
 EXP. ENGINEER FOR ARCHITECTS
 3015 GRAND AVENUE, SUITE 402
 COCONUT GROVE, FL 33133
 TEL: 305.371.1111
 FAX: 305.371.1112
 WWW.MUVICO.COM
 EIC: MUVICO 11

MUVICO THEATERS
 THE WORLD'S PREMIER MOVIE EXPERIENCE
 3015 Grand Avenue
 Coconut Grove, Florida 33133

THEATER ELEVATIONS

DATE: 07/07/08	BY: [Signature]
DATE: 07/07/08	BY: [Signature]
DATE: 07/07/08	BY: [Signature]
DATE: 07/07/08	BY: [Signature]
DATE: 07/07/08	BY: [Signature]

- ◆ FINISHED CEILING
ELEV. 84'-6"
- ◆ EXIST MEZZ FLR
ELEV. 98'-9"
- ◆ NEW/EXIST FLR
ELEV. 90'-11"
- ◆ SLAB
ELEV. 47'-0"

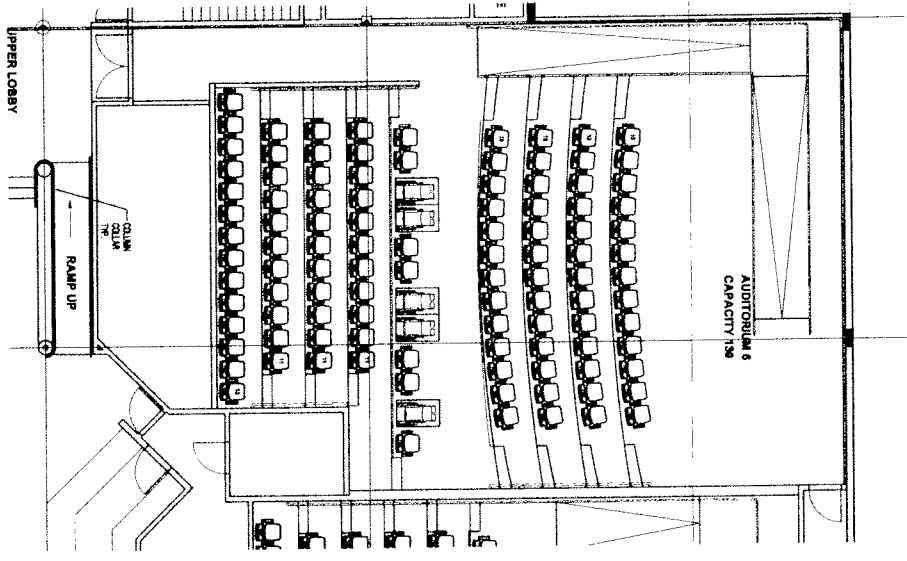
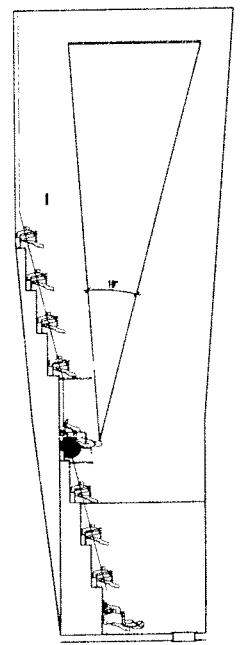

FLOOR PLAN:
THEATER 6
SCALE 1/8" = 1'-0"



**PAVLIK
DESIGN
TEAM**
ARCHITECTS, LLC
1101 W. UNIVERSITY AVENUE, SUITE 200
ANN ARBOR, MI 48106
TEL: 734.763.3737
WWW.PAVLIKDESIGN.COM



ENGINEERING
TLC ENGINEERING FOR ARCHITECTS
3075 East Tropic Drive
Ann Arbor, MI 48106
TEL: 734.763.3737
WWW.TLCENGINEERING.COM
CONSULTING MEMBER SINCE
89 00000017

NO.	DATE	DESCRIPTION

MUVICO
THEATERS
THE WORLD'S PREMIER SEATING EXPERIENCE
3015 Grand Avenue
Coconut Grove, Florida 33133

**THEATER
ELEVATIONS**

NO.	DATE	DESCRIPTION

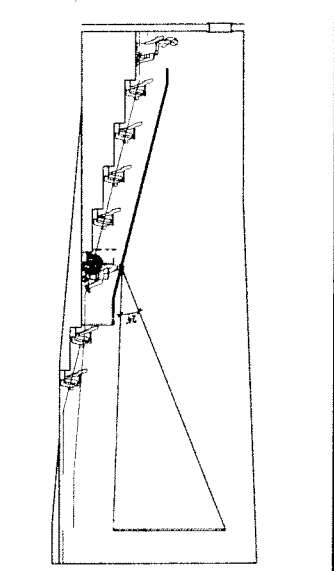

ELEVATION:
 THEATER 11
 SCALE 1/4" = 1'-0"

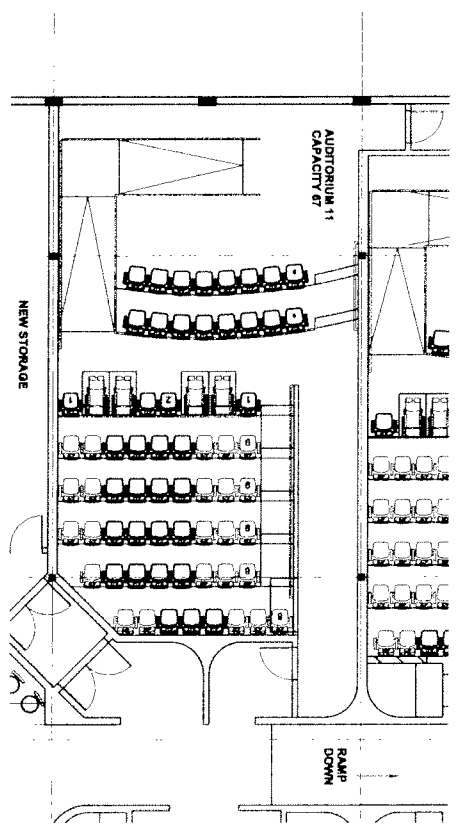

FLOOR PLAN:
 THEATER 11
 SCALE 1/4" = 1'-0"

**PAVLIK
 DESIGN
 TEAM**
 ARCHITECTS, LLC
 1000 N. W. 10th Ave., Suite 1000
 Ft. Lauderdale, FL 33304
 TEL: 954.525.1100
 FAX: 954.525.1101
 WWW.PAVLIKDESIGN.COM

ENGINEERS FOR ARCHITECTS
 CONSULTANTS
T.C. MOULTON
 2625 N.W. 11th Street
 Suite 100
 Ft. Lauderdale, FL 33304
 Tel: (954) 525-1100
 Fax: (954) 525-1101
 E-mail: tcm@tcmoulton.com
 EIT 10000115 T.C. MOULTON

**MUVICO
 THEATERS**
 THE WORLD'S PREMIER MOVIE EXPERIENCE
3015 Grand Avenue
 Coconut Grove, Florida 33133

THEATER
 ELEVATIONS

NO. 10000115	THEATER 11	11/21/2008
NO. 10000115	THEATER 11	11/21/2008
NO. 10000115	THEATER 11	11/21/2008
NO. 10000115	THEATER 11	11/21/2008

- ◆ FINISHED CEILING
ELEV. 86'-6"
- ◆ EXIST MEZZ FLR
ELEV. 69'-4"
- ◆ NEW/EXIST FLR
ELEV. 60'-5"
- ◆ FINISHED FLOOR
ELEV. 47'-0"

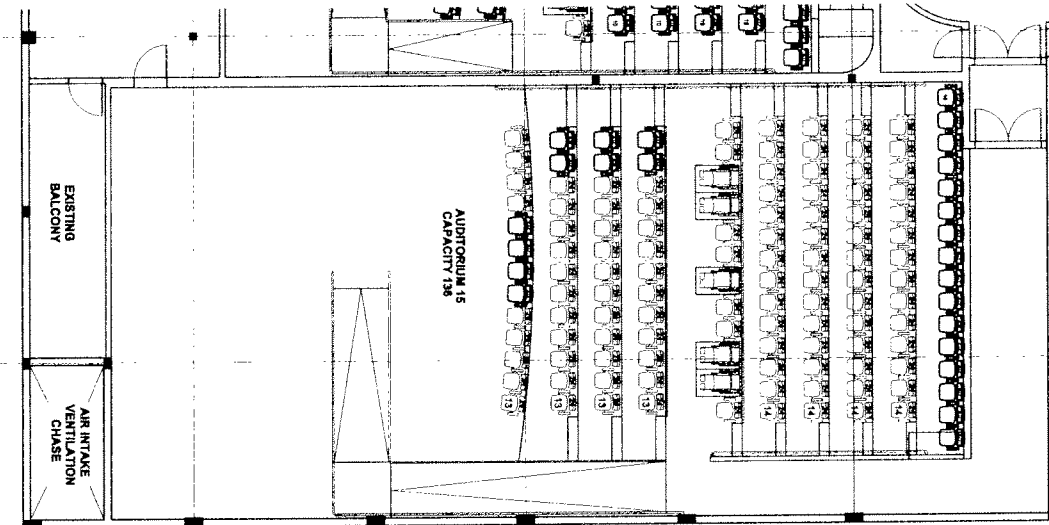
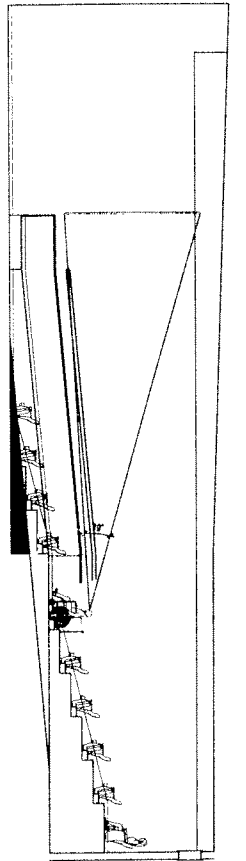

FLOOR PLAN:
THEATER 15
SCALE: 1/8" = 1'-0"

ELEVATION:
THEATER 15
SCALE: 1/8" = 1'-0"

MUVICO
THEATERS
THE WORLD'S PREMIER MUSIC EXPERIENCE

3015 Grand Avenue
Coconut Grove, Florida 33133

THEATER
ELEVATIONS



PAVLIK
DESIGN
TEAM
ARCHITECTS, LLC
1000 N. W. 10th St., Suite 100
Fort Lauderdale, FL 33304
Tel: 954.561.1111
Fax: 954.561.1112
www.pavlikdesign.com

ENGINEER
CONTRACT NO. 15-1

THEATRE MANAGEMENT GROUP ARCHITECTS
1001 N. W. 10th St., Suite 100
Fort Lauderdale, FL 33304
Tel: 954.561.1111
Fax: 954.561.1112
www.tmgarchitects.com

NO.	DATE	DESCRIPTION
1	10/15/15	ISSUED FOR PERMIT
2	11/10/15	REVISIONS
3	12/15/15	REVISIONS
4	01/15/16	REVISIONS
5	02/15/16	REVISIONS
6	03/15/16	REVISIONS
7	04/15/16	REVISIONS
8	05/15/16	REVISIONS
9	06/15/16	REVISIONS
10	07/15/16	REVISIONS
11	08/15/16	REVISIONS
12	09/15/16	REVISIONS
13	10/15/16	REVISIONS
14	11/15/16	REVISIONS
15	12/15/16	REVISIONS
16	01/15/17	REVISIONS
17	02/15/17	REVISIONS
18	03/15/17	REVISIONS
19	04/15/17	REVISIONS
20	05/15/17	REVISIONS
21	06/15/17	REVISIONS
22	07/15/17	REVISIONS
23	08/15/17	REVISIONS
24	09/15/17	REVISIONS
25	10/15/17	REVISIONS
26	11/15/17	REVISIONS
27	12/15/17	REVISIONS
28	01/15/18	REVISIONS
29	02/15/18	REVISIONS
30	03/15/18	REVISIONS
31	04/15/18	REVISIONS
32	05/15/18	REVISIONS
33	06/15/18	REVISIONS
34	07/15/18	REVISIONS
35	08/15/18	REVISIONS
36	09/15/18	REVISIONS
37	10/15/18	REVISIONS
38	11/15/18	REVISIONS
39	12/15/18	REVISIONS
40	01/15/19	REVISIONS
41	02/15/19	REVISIONS
42	03/15/19	REVISIONS
43	04/15/19	REVISIONS
44	05/15/19	REVISIONS
45	06/15/19	REVISIONS
46	07/15/19	REVISIONS
47	08/15/19	REVISIONS
48	09/15/19	REVISIONS
49	10/15/19	REVISIONS
50	11/15/19	REVISIONS
51	12/15/19	REVISIONS
52	01/15/20	REVISIONS
53	02/15/20	REVISIONS
54	03/15/20	REVISIONS
55	04/15/20	REVISIONS
56	05/15/20	REVISIONS
57	06/15/20	REVISIONS
58	07/15/20	REVISIONS
59	08/15/20	REVISIONS
60	09/15/20	REVISIONS
61	10/15/20	REVISIONS
62	11/15/20	REVISIONS
63	12/15/20	REVISIONS
64	01/15/21	REVISIONS
65	02/15/21	REVISIONS
66	03/15/21	REVISIONS
67	04/15/21	REVISIONS
68	05/15/21	REVISIONS
69	06/15/21	REVISIONS
70	07/15/21	REVISIONS
71	08/15/21	REVISIONS
72	09/15/21	REVISIONS
73	10/15/21	REVISIONS
74	11/15/21	REVISIONS
75	12/15/21	REVISIONS
76	01/15/22	REVISIONS
77	02/15/22	REVISIONS
78	03/15/22	REVISIONS
79	04/15/22	REVISIONS
80	05/15/22	REVISIONS
81	06/15/22	REVISIONS
82	07/15/22	REVISIONS
83	08/15/22	REVISIONS
84	09/15/22	REVISIONS
85	10/15/22	REVISIONS
86	11/15/22	REVISIONS
87	12/15/22	REVISIONS
88	01/15/23	REVISIONS
89	02/15/23	REVISIONS
90	03/15/23	REVISIONS
91	04/15/23	REVISIONS
92	05/15/23	REVISIONS
93	06/15/23	REVISIONS
94	07/15/23	REVISIONS
95	08/15/23	REVISIONS
96	09/15/23	REVISIONS
97	10/15/23	REVISIONS
98	11/15/23	REVISIONS
99	12/15/23	REVISIONS
100	01/15/24	REVISIONS

Studio Architecture/Coconut Grove/3015 Grand Ave. 3/1/2008 - 3:15pm

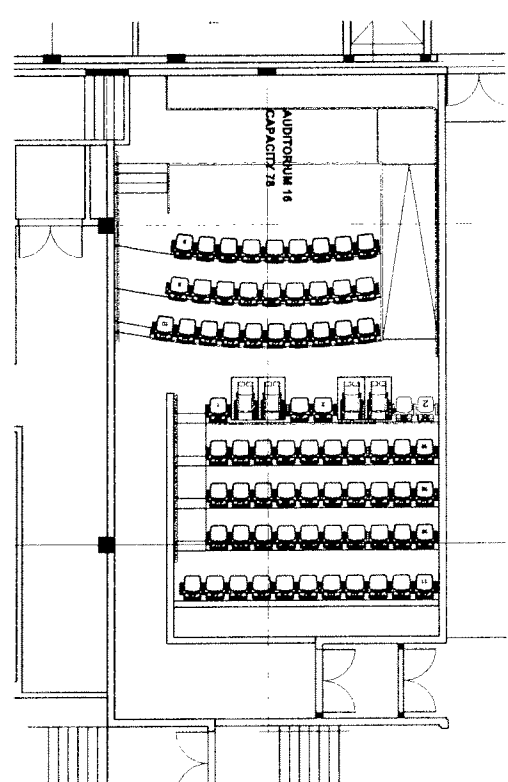

FLOOR PLAN:
THEATER 16
SCALE: 1/8" = 1'-0"

- ◆ FINISHED CEILING
ELEV. 84'-6"
- ◆ EXIST MEZZ FLR
ELEV. 89'-6"
- ◆ NEW/EXIST FLR
ELEV. 85'-11"
- ◆ EXIST FLR - 1"
ELEV. 48'-8"
- ◆ SLAB
ELEV. 47'-0"

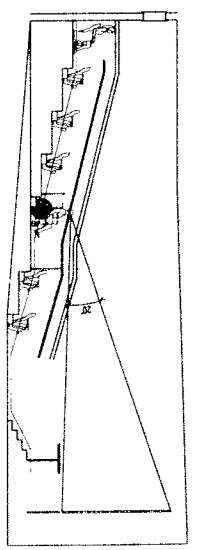

ELEVATION:
THEATER 16
SCALE: 1/8" = 1'-0"

PAVLIK
 DESIGN
 TEAM
 ARCHITECTURE, LLC
 1000 W. PALM BEACH BLVD.
 SUITE 200
 WEST PALM BEACH, FL 33411
 TEL: 561-833-8800
 FAX: 561-833-8801
 WWW.PAVLIKDESIGN.COM

ENGINEER
ENGINEERING
 T/C ENGINEERING FOR ARCHITECTS
 1000 W. PALM BEACH BLVD.
 SUITE 200
 WEST PALM BEACH, FL 33411
 TEL: 561-833-8800
 FAX: 561-833-8801
 WWW.TCENGINEERING.COM

MUVICO
THEATERS
 THE WORLD'S LEADING THEATER EXPERIENCE
 3015 Grand Avenue
 Coconut Grove, Florida 33133

THEATER
ELEVATIONS

NO.	DATE	DESCRIPTION
1	3/1/08	ISSUED FOR PERMIT
2	3/1/08	ISSUED FOR CONSTRUCTION
3	3/1/08	ISSUED FOR RECORD