

“UUU” HIGH SCHOOL FOR HILLSBOROUGH COUNTY

Issue: Vertical accessibility to press boxes.

Analysis: The applicant is requesting a waiver from providing vertical accessibility to three press boxes at the football stadium, baseball and softball fields. According to the applicant, each press box will have 240 or fewer square feet and not occupied by more than five persons. A quote of \$336,773 was submitted as the cost of constructing three elevators. The playing fields and press boxes are being constructed in conjunction with building a new \$49,000,000 high school.

Project Progress:

The project is under design/construction.

Items to be Waived:

Vertical accessibility to three press boxes, as required by Section 553.509, Florida Statutes.

553.509 Vertical accessibility. Nothing in Sections 553.501-553.513 or the guidelines shall be construed to relieve the owner of any building, structure or facility governed by those sections from the duty to provide vertical accessibility to all levels above and below the occupiable grade level regardless of whether the guidelines require an elevator to be installed in such building, structure or facility, except for:

- (1) Elevator pits, elevator penthouses, mechanical rooms, piping or equipment catwalks and automobile lubrication and maintenance pits and platforms;
- (2) Unoccupiable spaces, such as rooms, enclosed spaces and storage spaces that are not designed for human occupancy, for public accommodations or for work areas; and
- (3) Occupiable spaces and rooms that are not open to the public and that house no more than five persons, including, but not limited to equipment control rooms and projection booths.

Waiver Criteria: There is no specific guidance for a waiver of this requirement in the code. The Commission's current rule, authorized in Section 553.512, Florida Statutes, provides criteria for granting waivers and allows consideration of unnecessary or extreme hardship to the applicant if the specific requirements were imposed.

**REQUEST FOR WAIVER FROM ACCESSIBILITY REQUIREMENTS
CHAPTER 553, PART V, FLORIDA STATUTES**

Your application will be reviewed by the Accessibility Advisory Council and its recommendations will be presented to the Commission. You will have the opportunity to answer questions and/or make a short presentation, not to exceed 15 minutes, at each meeting. The Commission will consider all information presented and the Council's recommendation before voting on the waiver request.

1. Name and address of project for which the waiver is requested.

Name: "UUU" high School for Hillsborough Co. School Board
Address: Intersection of Gallagher St. & Newsome Rd. Plant City, Florida

Telephone 813-272-4112 **FAX** 813-272-4933

2. Name of Applicant. If other than the owner, please indicate relationship of applicant to owner and written authorization by owner in space provided:

Applicant's Name: Alexander Long, Long & Associates Architects/Engineers, Inc.

Applicant's Address: 4525 S. Manhattan Avnue, Tampa, FL 33611

Applicant's Telephone: 813-839-0506 **FAX:** 813-839-4616

Relationship to Owner: Design Professional

Owner's Name: School District of Hillsborough County

Owner's Address: 901 E. Kennedy Blvd. Tampa, FL 33602

Owner's Telephone: 813-272-4112 **FAX** 813-272-4933

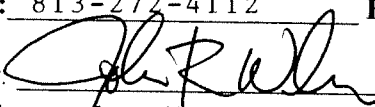
Signature of Owner: 

Contact Person: Alexander M. Long, AIA, 813-839-0506

3. Please check one of the following:

- New construction.
- Addition to a building or facility.
- Alteration to an existing building or facility.
- Historical preservation (addition).
- Historical preservation (alteration).

4. Type of facility. Please describe the building. Define the occupant or proposed occupant and how it serves the public. If the building is existing and undergoing a change of use, please specify the previous usage.

High School Press Box at Stadium, limited to 5 persons or less
and limited to 240 SF, type IIB construction. High School Press
Boxes located on each at the baseball field and softball field,
limited 5 or less and limited to 235 SF, type IIB construction

Previous Use None

5. Project Construction Cost High School Total \$49,000,000

6. Project Status: Please check the phase of construction that best describes your project at the time of this application. Describe status. 90% Construction Document Phase

Construction to start January, 2008

Site plans are in for review

- Under Design
- Under Construction
- In Plan Review
- Completed

Briefly explain why the request has now been referred to the Commission.

Local Building Code Manager for the District is requiring an elevator to each press box. See attached communication & code references

7. Requirements requested to be waived. Please reference the applicable section of the Florida law. For example, Section 553.509 FG, governs the requirements for vertical accessibility.

Issue

1: "Vertical accessibility, Section 553.509 Florida Statutes - See attached communication

Issue

2: _____

Issue 3: _____

8. Reason(s) for Waiver Request: Please describe how this project meets the following criteria. Explain all that would apply for consideration of granting the waiver.

The hardship exists primarily as a result of the statute.

Providing vertical accessibility to the Press Boxes is not required per FBC 2004 w/2006 Supplement 11-4.1.2 which excludes also, identified per ADAAG 4.4.1.5 (b). See attached

Unique circumstances and not general conditions, cause the hardship.

The hardship is based on an actual or proposed situation as presented by the design documents. Provide a detailed cost estimate and, where appropriate, photographs. Cost estimates must include bids and quotes.

Substantial financial loss and/or investment, if any, will result if the waiver request is denied.

The cost of an elevator to each press box would add more than

\$100,000 per location for 240 SF limited access/use space.

A good faith effort has been made to comply with the statute as evidenced by submittal of documented proof of all feasible technical alternatives.

9. **Provide documented cost estimates for each portion of the waiver request.** For example, for vertical accessibility, the lowest documented cost of an elevator, ramp, lift or other method of providing vertical accessibility should be given, documented by quotations or bids from at least two vendors.

- a. See attached cost documentation by the Construction Manager. In addition to the construction costs, there
- b. are annual maintenance & testing costs required by the
- c. elevator code to keep the units certified & operational

10. **Licensed Design Professional:** Where a design professional has designed the project, his or her comments **MUST** be included and certified by signature and affixing of his or her professional seal.

We believe the Press Boxes are exempt or should be granted a
waiver in accordance w/FBC 2004 11-4.1.2 and ADAA6 4.4.1.5 (b)

Signature Printed Name ALEXANDER LONG

Phone number 813-839-0506

(SEAL)

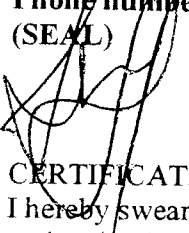

CERTIFICATION OF APPLICANT:

I hereby swear or affirm that the applicable documents in support of this Request for Waiver are attached for review by the Florida Building Commission and that all statements made in this application are to the best of my knowledge true and correct.

Dated this 3 day of DECEMBER, 19 2007

Signature

Alexander M. Long, AIA
Printed Name

By signing this application, the applicant represents that the information in it is true, accurate and complete. If the applicant misrepresents or omits any material information, the Commission may revoke any order and will notify the building official of the permitting jurisdiction. Providing false information to the Commission is punishable as a misdemeanor under §775.083, Florida Statutes.

REVIEW AND RECOMMENDATION BY LOCAL BUILDING DEPARTMENT.

Please state why the issue is being referred to the Commission as well as a recommendation for disposition. The Building Official or his designee should review the application and indicate that to the best of his or her knowledge, all information stipulated herein is true and accurate. Further, if this project is complete, explain why it is being referred to the Commission. The Building Official or his or her designee should sign a copy of the plans accompanying this application as certification that such plans are the same as those submitted for building department review. Please reference the applicable section of the Accessibility Code. For example, Section 4.22 governs the requirements for toilet rooms.

- a. Vertical Accessability, Section 553.509 Florida Statutes
- b. FBC 2004 11-4.1.2
- c. ADAA6 4.4.1.5 (b)

Has there been any permitted construction activity on this building during the past three years? If so, what was the cost of construction?

Yes No Cost of Construction _____

Comments/Recommendation _____

Jurisdiction _____

Building Official or Designee :

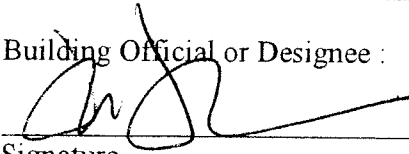

Signature

JAMES R. Johannessen, Building Code MANAGER
Printed Name

Certification Number

Telephone (813) 272-4117 FAX (813) 272-4933

Address: 901 E. Kennedy Blvd.

Tampa, FL 33602

Please see below from John Williams and may I offer the following for your consideration:

I was not providing vertical accessibility to the projection booths or press boxes based on the following FBC codes as supplemented by 2005 & 2006 amendments:

FBC 2004 423.8.1

① FBC 2004 w/ 2006 supplement 11-4.1.2 (blue page) which excludes: elevator pits, penthouses, mechanical rooms, piping or equipment catwalks, and occupiable spaces and rooms that are not open to the public and that house no more than 5 persons including, but not limited to, **equipment control rooms and projection booths, but must comply with ADAAG.**

ADAAG 4.4.1.5.(b) [http://www.access-board.gov/adaag/html/adaag.htm#A4.1.2\(2\)\(b\)](http://www.access-board.gov/adaag/html/adaag.htm#A4.1.2(2)(b)) [Marker]

(b) Accessibility is not required to or in:

(i) raised areas used primarily for purposes of security or life or fire safety, including, but not limited to, observation or lookout galleries, prison guard towers, fire towers, or fixed life guard stands;

② (ii) non-occupiable spaces accessed only by ladders, catwalks, crawl spaces, very narrow passageways, tunnels, or freight (non-passenger) elevators, and frequented only by service personnel for maintenance, repair, or occasional monitoring of equipment; such spaces may include, but are not limited to, elevator pits, elevator penthouses, piping or equipment catwalks, water or sewage treatment pump rooms and stations, electric substations and transformer vaults, and highway and tunnel utility facilities;

(iii) single occupant structures accessed only by a passageway that is below grade or that is elevated above standard curb height, including, but not limited to, toll booths accessed from underground tunnels;

(iv) **raised structures used solely for refereeing, judging, or scoring a sport;**

(v) water slides;

(vi) animal containment areas that are not for public use; or

(vii) raised boxing or wrestling rings.

Therefore, based on the above information, please offer comment on the AHJ requirement.

Thank you,

Lex

October 15, 2007



Alex Long
Long and Associates Architects / Engineers, Inc.
4525 S. Manhattan Ave.
Tampa, FL 33611-2305

5100 West Kennedy Boulevard
Suite 250
Tampa, Florida 33609-1817
813 282 3900
Fax 813 288 0188
beckgroup.com

Re: Conceptual Budget – Grand Stand Elevators

Dear Alex:

In response to your request we have generated a conceptual budget to furnish and install a single-lift elevator at each of the following grandstand press boxes:

- Football – Home team side
- Baseball
- Softball

The budget for the work is estimated to be \$336,773 for all three freestanding elevator assemblies. We have included budget quotes from Thyssen Krupp and Kone Elevator as well as from Advanced Masonry Systems.

Please let us know if we can be of additional assistance.

Sincerely

A handwritten signature in black ink, appearing to read "Ryan Toth".

HCBeck, Ltd.
Ryan Toth
Project Manager

Better Buildings, Better Built!



ADVANCED MASONRY SYSTEMS

5403 Ashton Court

Sarasota, Florida 34233

Phone: (941) 926-3155 Fax: (941) 926-4804

PRICE QUOTE

| | |
|--------------------------------|---|
| Date: October 8, 2007 | Project: High School UUU |
| To: Beck | Attn: Ryan Toth, Project Manager |
| Fax No.: (813) 288-0188 | Phone No.: (813) 282-3900 |

We hereby submit this Price Quote for additional work as follows:

| | | | |
|--|-----------------------|---------------------|---|
| Description of Work: Labor, materials and equipment to install one (1) elevator shaft (concrete, masonry and rebar). Presumes and includes 10x10x10 mechanical room at grade, 10'x10' shaft, elevator lid, 8"x16" tie beams, standard CMU. | | | |
| Status of Work: | Completed: | In Progress: | Pending Authorization X |
| Cost of Work: | | | |
| | Material: | 12,851.24 | See Attached |
| | Labor: | 15,040.00 | See Attached |
| | Equipment: | 5,000.00 | Excavator; Lift; Scaffold; Mixer; Misc. |
| | Subcontractor: | 1,500.00 | Concrete Pumping |
| | Overhead: | 3,439.12 | 10.0% |
| | Profit: | 1,719.56 | 5.0% |
| | Bond: | 791.00 | 2% |
| | Total: | <u>\$ 40,340.92</u> | EACH ELEVATOR |

Kindly issue a authorization for the above-described work at your earliest convenience. Please note that if this work is on hold pending issuance of authorization, work will not proceed without your written authorization to do so. Should you have any questions or need any additional information, please do not hesitate to contact the undersigned.

Submitted this 8th day of October, 2007.



Ronald D. Karp
Advanced Masonry Systems

cc: RFC File

Labor Rates (including burden):

AMS Worksheet

| Description | Hourly Rate | Overtime Premium | Overtime Rate |
|-------------|-------------|------------------|---------------|
| Foreman | \$ 52.50 | \$ 26.25 | \$ 78.75 |
| Journeyman | \$ 28.00 | \$ 14.00 | \$ 42.00 |
| Carpenter | \$ 28.00 | \$ 14.00 | \$ 42.00 |
| Operator | \$ 24.00 | \$ 12.00 | \$ 36.00 |
| Laborer | \$ 21.00 | \$ 10.50 | \$ 31.50 |

Labor:

| Description | Reg. Hrs. | Cost | Overtime Hrs. | Cost | Total |
|-------------|-----------|-------------|---------------|------|-------------|
| Foreman | 80 | \$ 4,200.00 | | \$ - | \$ 4,200.00 |
| Journeyman | 160 | \$ 4,480.00 | | \$ - | \$ 4,480.00 |
| Carpenter | 60 | \$ 1,680.00 | | \$ - | \$ 1,680.00 |
| Operator | 20 | \$ 480.00 | | \$ - | \$ 480.00 |
| Laborer | 200 | \$ 4,200.00 | | \$ - | \$ 4,200.00 |
| Total Labor | 520 | \$15,040.00 | - | \$ - | \$15,040.00 |

Materials:

| Description | Unit Cost | Quantity | Subtotal | Tax | Total |
|----------------------|------------|----------|------------|-----------|-------------|
| Concrete | \$ 125.00 | 20 | \$2,500.00 | \$ 175.00 | \$ 2,675.00 |
| Rebar | \$ 900.00 | 3.5 | \$3,150.00 | \$ 220.50 | \$ 3,370.50 |
| FormingMats. | \$1,000.00 | 1 | \$1,000.00 | \$ 70.00 | \$ 1,070.00 |
| Mesh/Visqueen /Misc. | \$ 600.00 | 1 | \$ 600.00 | \$ 42.00 | \$ 642.00 |
| CMU - 8" | \$ 1.30 | 1700 | \$2,210.00 | \$ 154.70 | \$ 2,364.70 |
| Lintels | \$ 28.50 | 3 | \$ 85.50 | \$ 5.99 | \$ 91.49 |
| Masonry Accessories | \$ 750.00 | 1 | \$ 750.00 | \$ 52.50 | \$ 802.50 |
| Mortar | \$ 5.00 | 125 | \$ 625.00 | \$ 43.75 | \$ 668.75 |
| Grout | \$ 110.00 | 9 | \$ 990.00 | \$ 69.30 | \$ 1,059.30 |
| Misc. | \$ 100.00 | 1 | \$ 100.00 | \$ 7.00 | \$ 107.00 |
| | | | \$ - | \$ - | \$ - |
| | | | \$ - | \$ - | \$ - |
| Total | | | | | \$12,851.24 |

Tampa Branch Office
New Equipment Business



Elevators Escalators

October 03, 2007

Mr. Ryan Toth
HC BECK, Ltd.

KONE Inc.
5903-C Hampton Oaks Pkwy
Tampa, FL 33610
Tel 813-635-0330
Fax 813-635-9440
www.kone.com
steve.jarvis@kone.com

Re: Budget Hydro pricing for UUU High School

Dear Ryan,

Per your request, the budget cost for a 2-landing, 2000 lb. elevator with an approximate rise of 16'-0" would be \$55,000.00 for a complete, installed, package.

This price is based upon providing a holeless hydraulic elevator with standard finishes, features, and amenities.

Please do not hesitate to contact me should you have any further questions.

Sincerely,

Steve Jarvis
Sales Manager
KONE, Inc.

ThyssenKrupp Elevator



Construction Sales Department

October 8, 2007

Ryan Toth
Beck

Re: UUU High School Budget

Dear Ryan:

ThyssenKrupp Elevator is pleased to provide you with the following budget of One Hundred Twenty Thousand Dollars (\$120,000.00) to furnish and install three (3) ThyssenKrupp Pre-engineered holeless Oilraulic elevator(s) at the above referenced project per the following clarifications:

CLARIFICATIONS

1. Budget based on providing standard equipment.

Please let me know if any further information is required. Thank you.

Sincerely,

A handwritten signature in black ink that reads "Dan Cook".

Dan Cook
New Construction Sales Representative

3 TOTAL

ThyssenKrupp Elevator Corporation
5100 West Grace Street
Tampa, FL 33607
Telephone: (813) 287-1744, (800) 693-8680
Fax: (813) 288-1954
E-mail: dan.cook@thyssenkruppelevator.com
Internet: www.thyssenkruppelevator.com

NOTE:
 DASHED CIRCLES INDICATE WAIVER
 BUILDING LOCATIONS

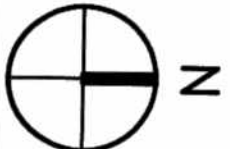
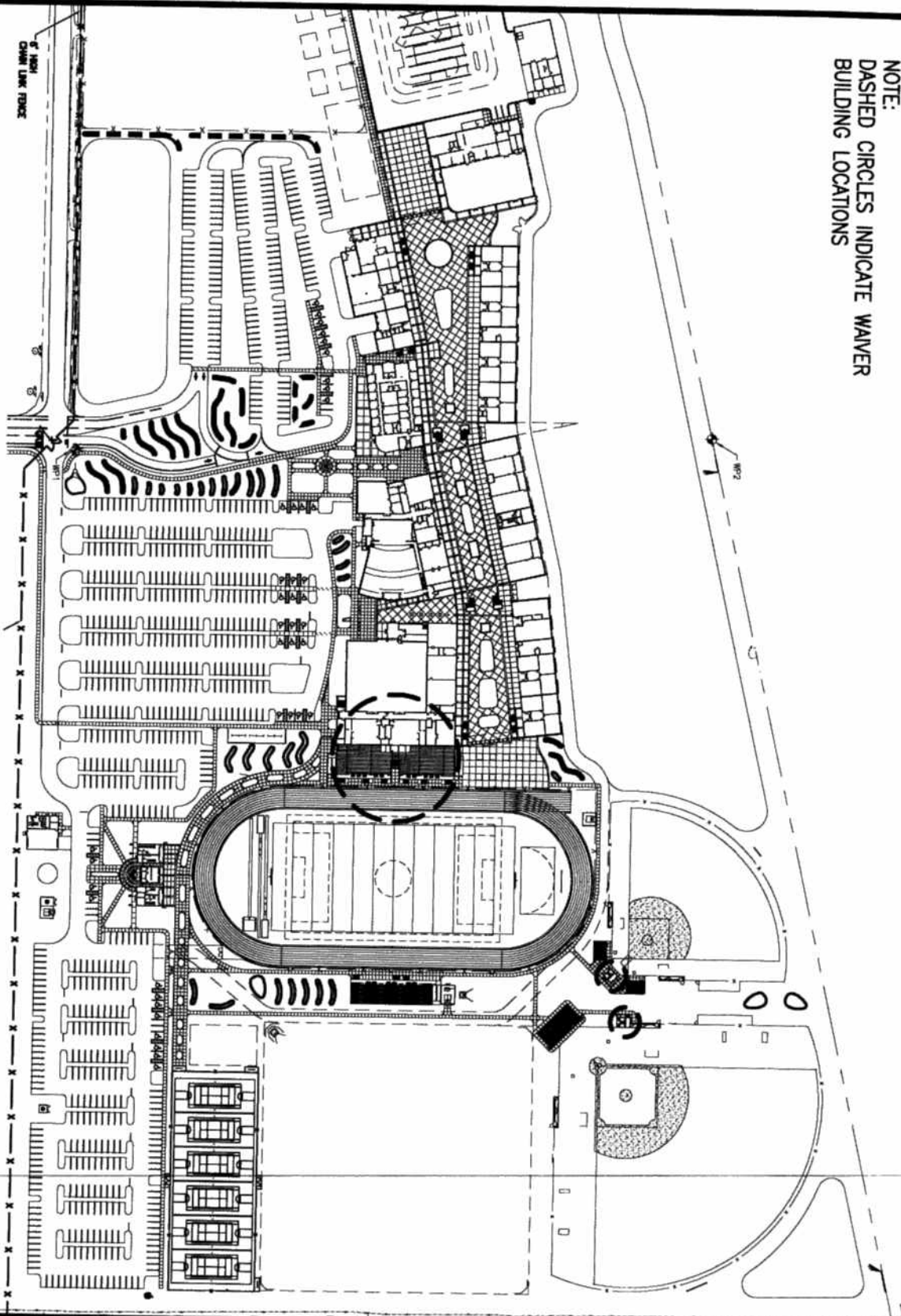

N

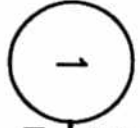

OVERALL
 SITE STAGING PLAN
 NTS

HIGH SCHOOL "UUU"

LONG & ASSOCIATES
 ARCHITECTS/ENGINEERS, INC.

MANHATTAN CENTER
 4525 S. MANHATTAN AVE.
 TAMPA, FLORIDA 33611
 PHONE: (813) 839-0506
 FAX: (813) 839-4616
 AAC001624 EB 1828

| | |
|--------------------|------------------------------|
| JOB NO.: 200668 | ISSUED NO.: ADA WAIVER |
| DRAWN: KGF | SK-A1 |
| CHECKED: AML | |
| DATE: 11-29-07 | REFER TO DWG: REF A00.0.3 |

NOTE:
 DASHED CIRCLES INDICATE WAIVER
 BUILDING LOCATIONS

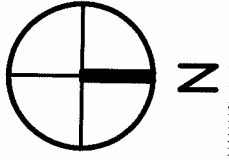
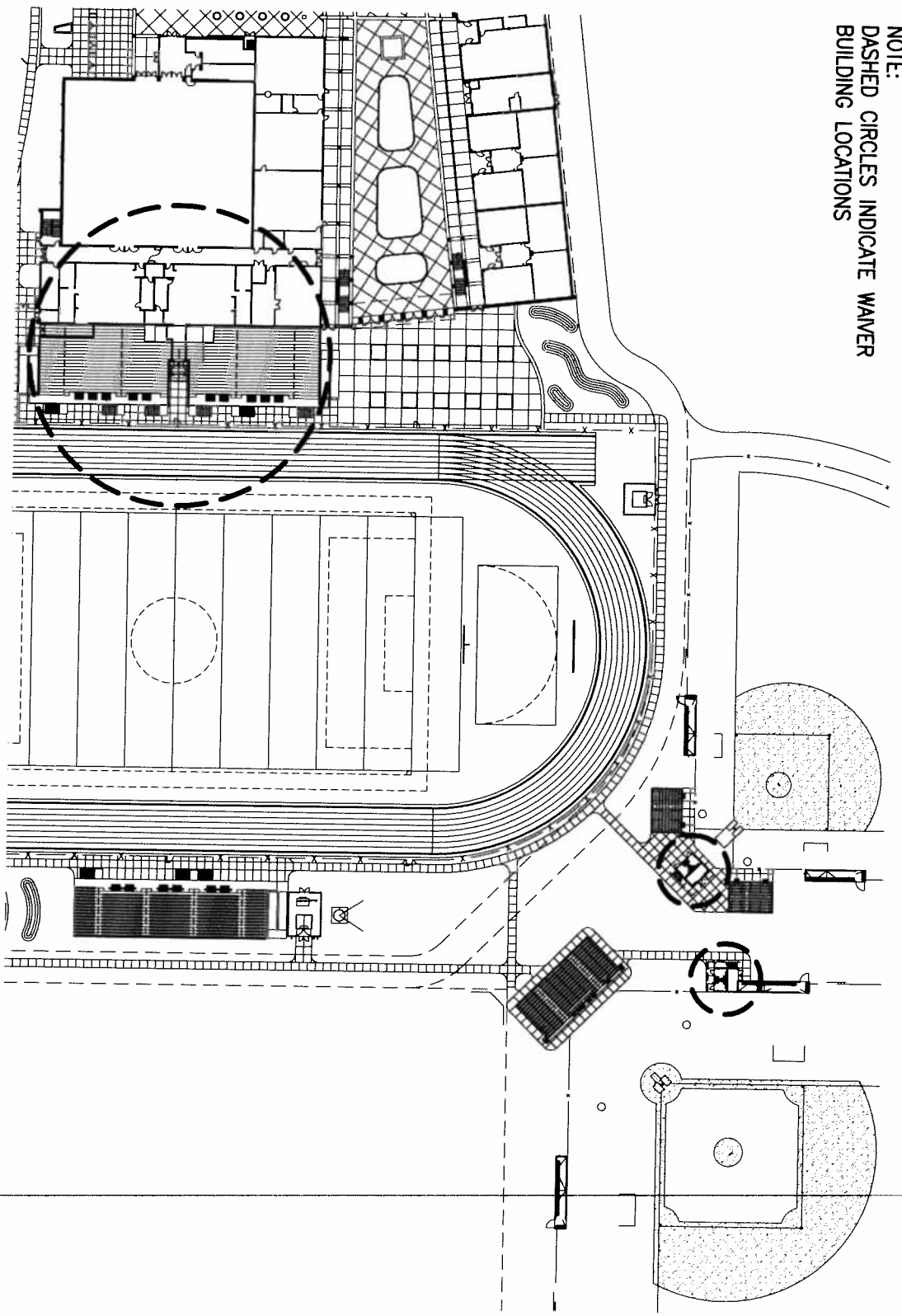

1

PARTIAL
 SITE STAGING PLAN

SCALE: 1" = 100'

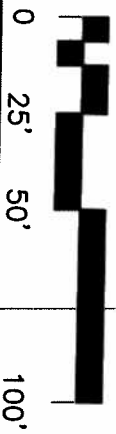

HIGH SCHOOL "UUU"

JOB NO.:
 200668

ISSUED NO.:
 ADA WAIVER

DRAWN:
 KGF

CHECKED:
 AML

SK-A2

DATE:
 11-29-07

REFER TO DWG:
 REF A00.0.3

LONG & ASSOCIATES
 ARCHITECTS/ENGINEERS, INC.

MANHATTAN CENTER
 4525 S. MANHATTAN AVE.
 TAMPA, FLORIDA 33611
 PHONE: (813) 839-0506
 FAX: (813) 839-4616
 AAC001624 EB 1828

HOME TEAM
FOOTBALL GRANDSTAND

PLAN

1

SCALE: 1/16" = 1'-0"

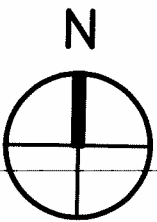
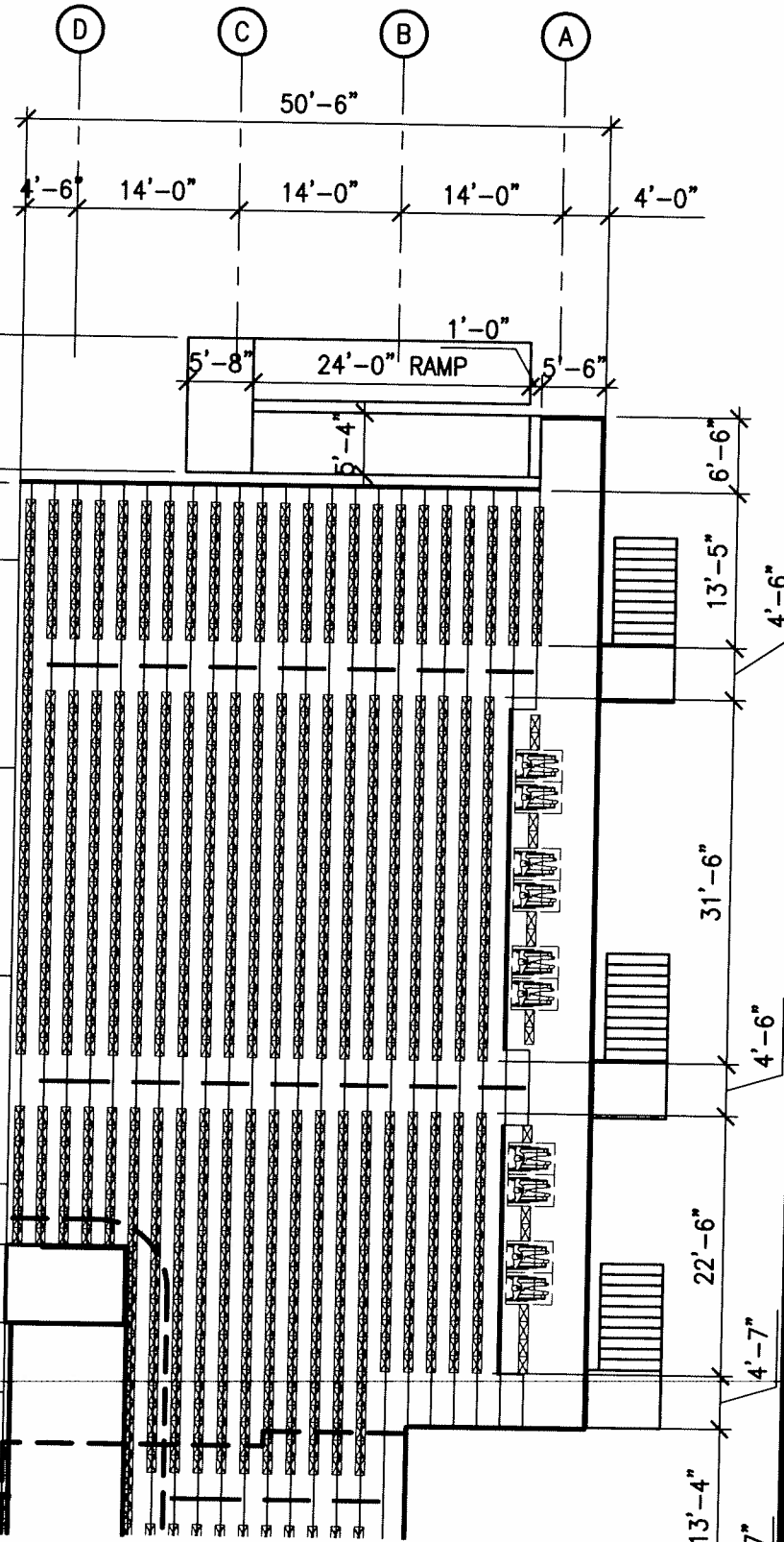

5
A00.2.2

LL LENGTH OF STAND

MATCHLINE

HIGH SCHOOL "UUU"

LONG & ASSOCIATES
ARCHITECTS/ENGINEERS, INC.

MANHATTAN CENTER
4525 S. MANHATTAN AVE.
TAMPA, FLORIDA 33611
PHONE: (813) 839-0506
FAX: (813) 839-4616
AAC001624 EB 1828

JOB NO.:
200668

DRAWN:
KGF

CHECKED:
AML

DATE:
11-29-07

ISSUED NO.:
ADA WAIVER

SK-A3

REFER TO DWG:
REF A00.2.2

175'-4" OVERALL LEN

MATCHLINE

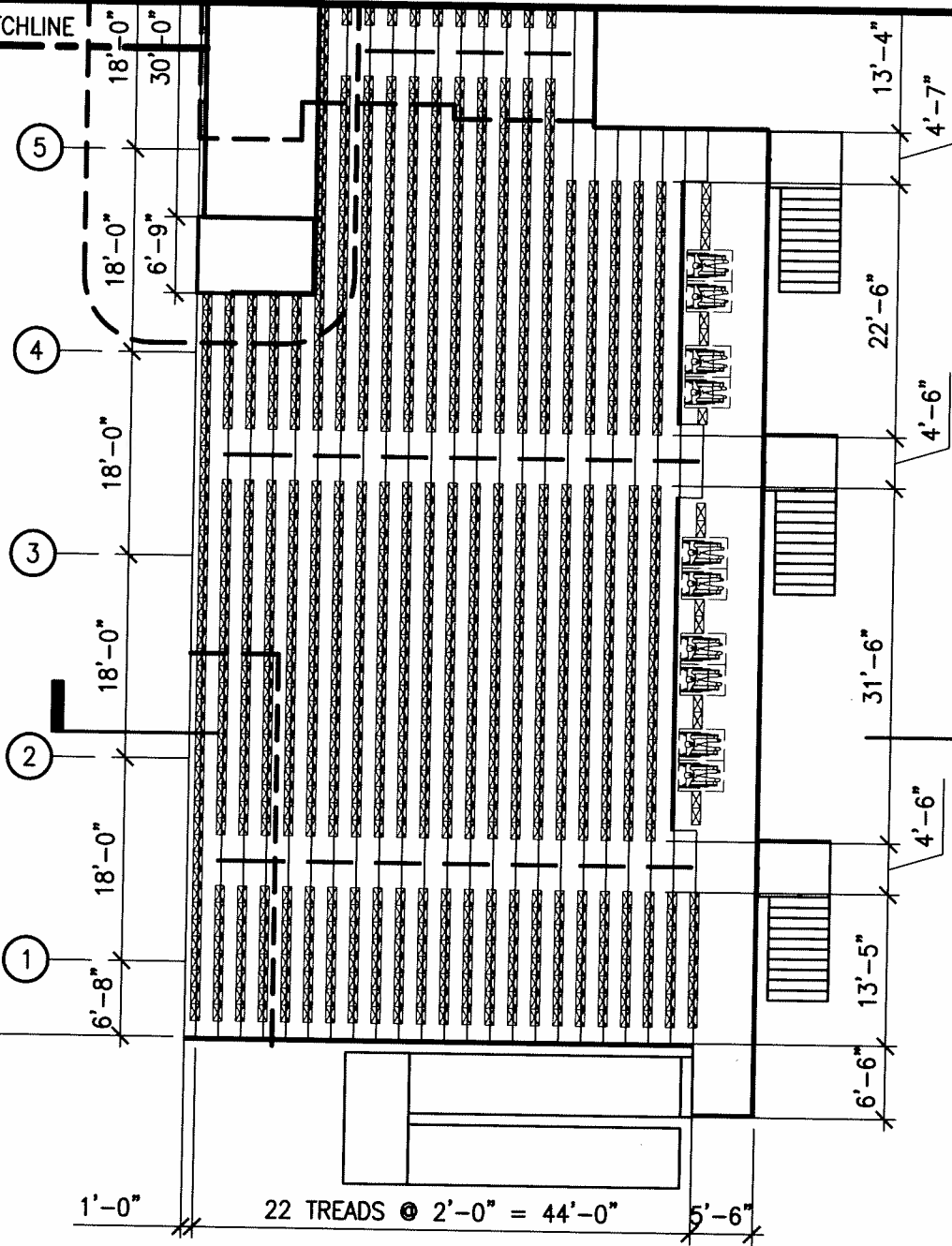

1'-0" 22 TREADS @ 2'-0" = 44'-0" 5'-6"

HOME TEAM FOOTBALL GRANDSTAND

PLAN

SCALE: 1/16" = 1'-0"

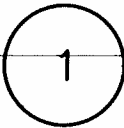
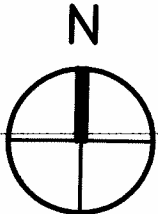
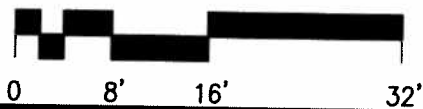

| SEATING CAPACITY | |
|--------------------|--------|
| NET BENCH SEATING | = 1955 |
| COMPANION SEATS | = 20 |
| WHEEL CHAIR SPACES | = 20 |
| TOTAL SEATING | = 1995 |

| | | | |
|-----------------|---|------------------------------|---------------------------|
| | HIGH SCHOOL "UUU" | JOB NO.: 200668 | ISSUED NO.: ADA WAIVER |
| | MANHATTAN CENTER 4525 S. MANHATTAN AVE. TAMPA, FLORIDA 33611 PHONE: (813) 839-0506 FAX: (813) 839-4616 AAC001624 EB 1828 | DRAWN: KGF | <h1>SK-A4</h1> |
| CHECKED: AML | DATE: 11-29-07 | REFER TO DWG: REF A00.2.2 | |

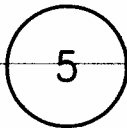
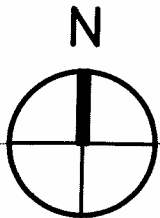
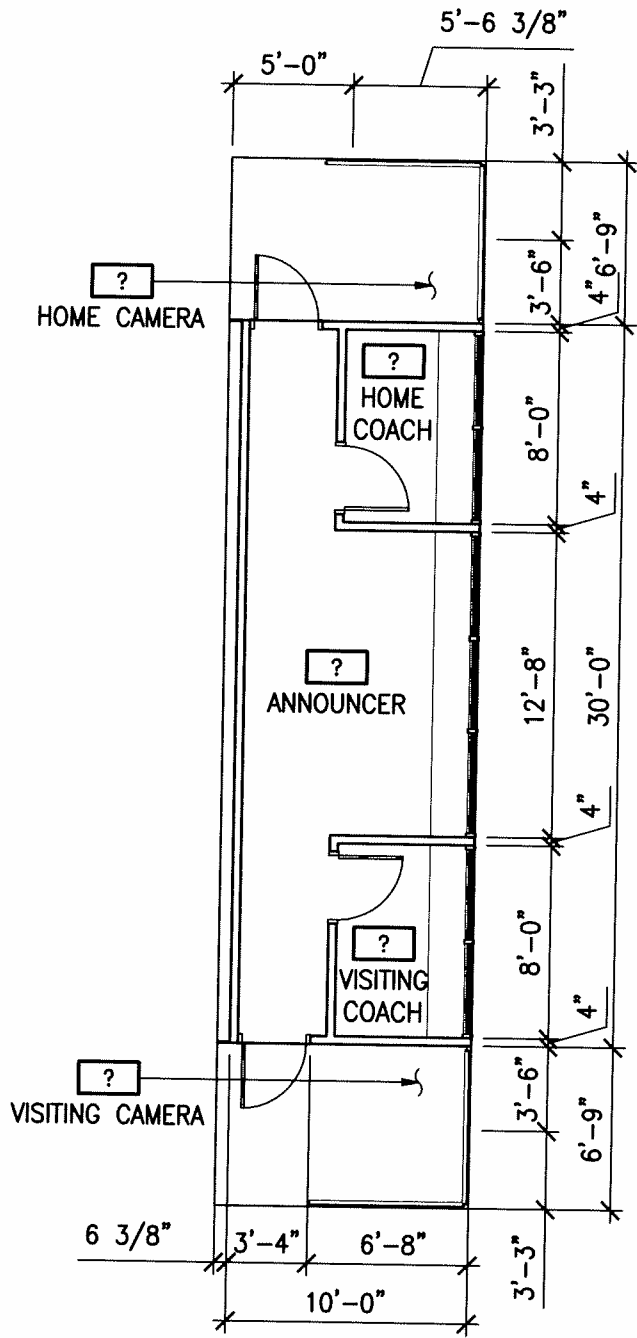

PRESSBOX
FLOOR PLAN

SCALE: 1/8" = 1'-0"



HIGH SCHOOL "UUU"

JOB NO.:
200668

ISSUED NO.:
ADA WAIVER

DRAWN:
KGF

CHECKED:
AML

SK-A5

DATE:
11-29-07

REFER TO DWG:
REF A00.2.2

LONG & ASSOCIATES
ARCHITECTS/ENGINEERS, INC.

MANHATTAN CENTER
4525 S. MANHATTAN AVE.
TAMPA, FLORIDA 33611
PHONE: (813) 839-0506
FAX: (813) 839-4616
AAC001624 EB 1828

DO NOT ATTACH BLEACHERS TO BUILDING, THERE IS TO BE A 1" SPACE BETWEEN THE FACE OF THE BUILDING AND THE BACK EDGE OF THE BLEACHERS.

BLEACHER MANUF TO PROVIDE FOUNDATION & FRAMING DESIGN AROUND LOWER CORRIDOR AND COORDINATE AS REQ'D

FOUNDATION DESIGN & FRAMING BY BLEACHER MANUF.

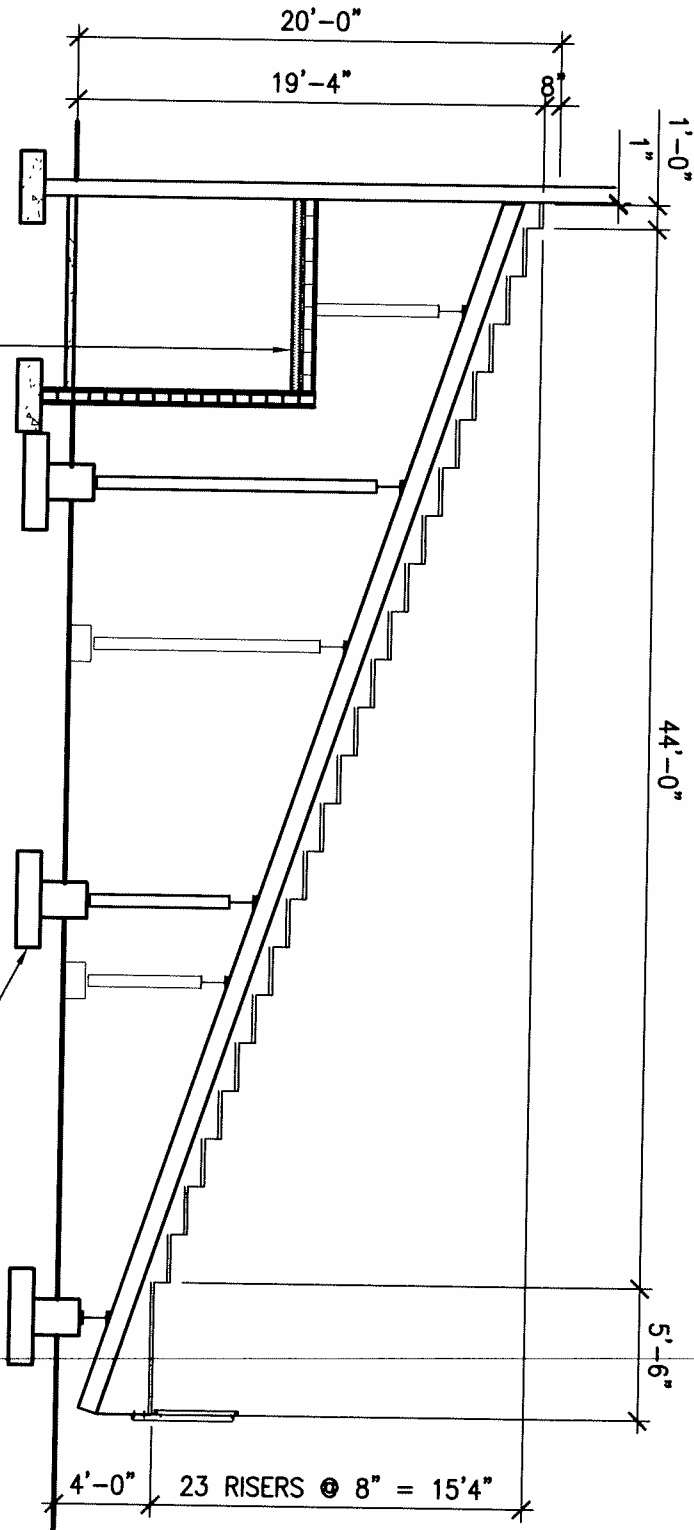

FOOTBALL HOME BLEACHERS

SECTION

2

SCALE: 1/8" = 1'-0"

HIGH SCHOOL "UUU"

JOB NO.: 200668

ISSUED NO.: ADA WAIVER

DRAWN: KGF

CHECKED: AML

SK-A6

DATE: 11-29-07

REFER TO DWG: REF A00.2.2

LONG & ASSOCIATES
ARCHITECTS / ENGINEERS, INC.

MANHATTAN CENTER
4525 S. MANHATTAN AVE.
TAMPA, FLORIDA 33611
PHONE: (813) 839-0506
FAX: (813) 839-4616
AAC001624 EB 1828

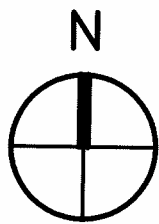
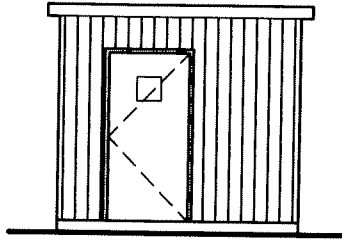

PRESSBOX
SOUTH
ELEVATION

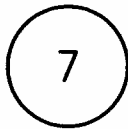

SCALE: 1/8" = 1'-0"

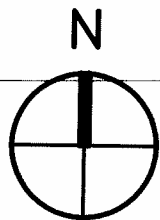
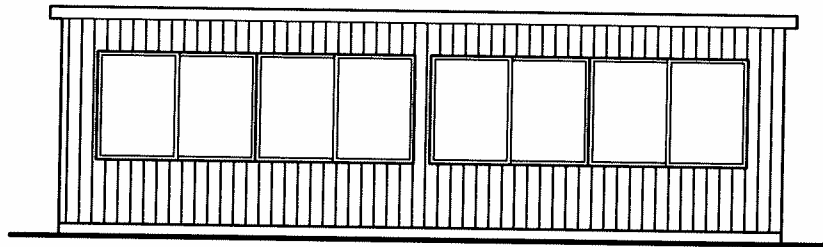

PRESSBOX
EAST
ELEVATION

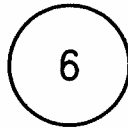

SCALE: 1/8" = 1'-0"

HIGH SCHOOL "UUU"

JOB NO.:
200668

ISSUED NO.:
ADA WAIVER

DRAWN:
KGF

CHECKED:
AML

SK-A7

DATE:
11-29-07

REFER TO DWG:
REF A00.2.2

LONG & ASSOCIATES
ARCHITECTS/ENGINEERS, INC.

MANHATTAN CENTER
4525 S. MANHATTAN AVE.
TAMPA, FLORIDA 33611
PHONE: (813) 839-0506
FAX: (813) 839-4616
AAC001624 EB 1828

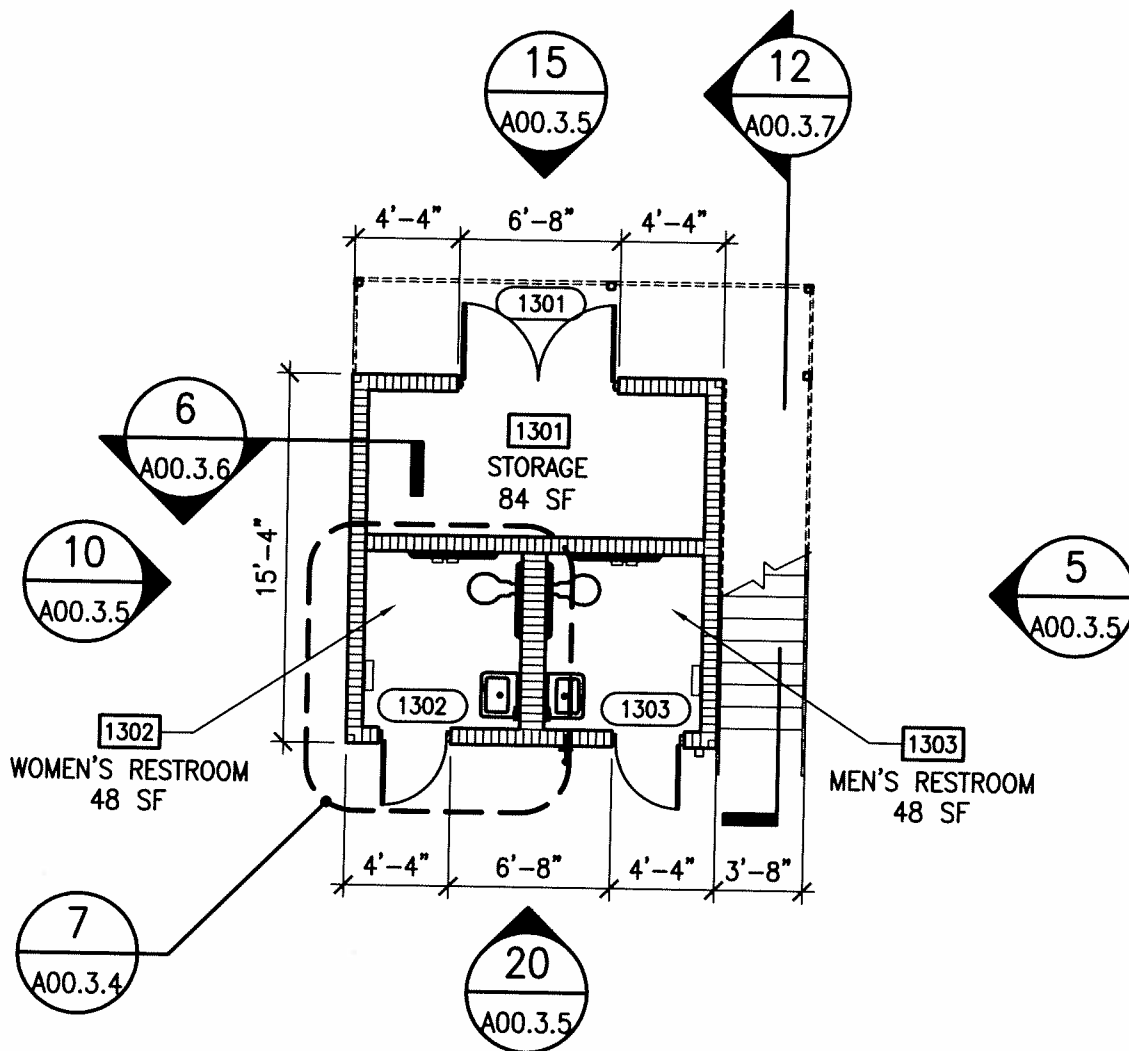

BLDG 12
1ST FLOOR

PLAN

SCALE: 1/8" = 1'-0"



HIGH SCHOOL "UUU"

JOB NO.:
200668

ISSUED NO.:
ADA WAIVER

DRAWN:
KGF

CHECKED:
AML

SK-A8

DATE:
11-29-07

REFER TO DWG:
REF A00.3.4

LONG & ASSOCIATES
ARCHITECTS/ENGINEERS, INC.

MANHATTAN CENTER
4525 S. MANHATTAN AVE.
TAMPA, FLORIDA 33611
PHONE: (813) 839-0506
FAX: (813) 839-4616
AAC001624 EB 1828

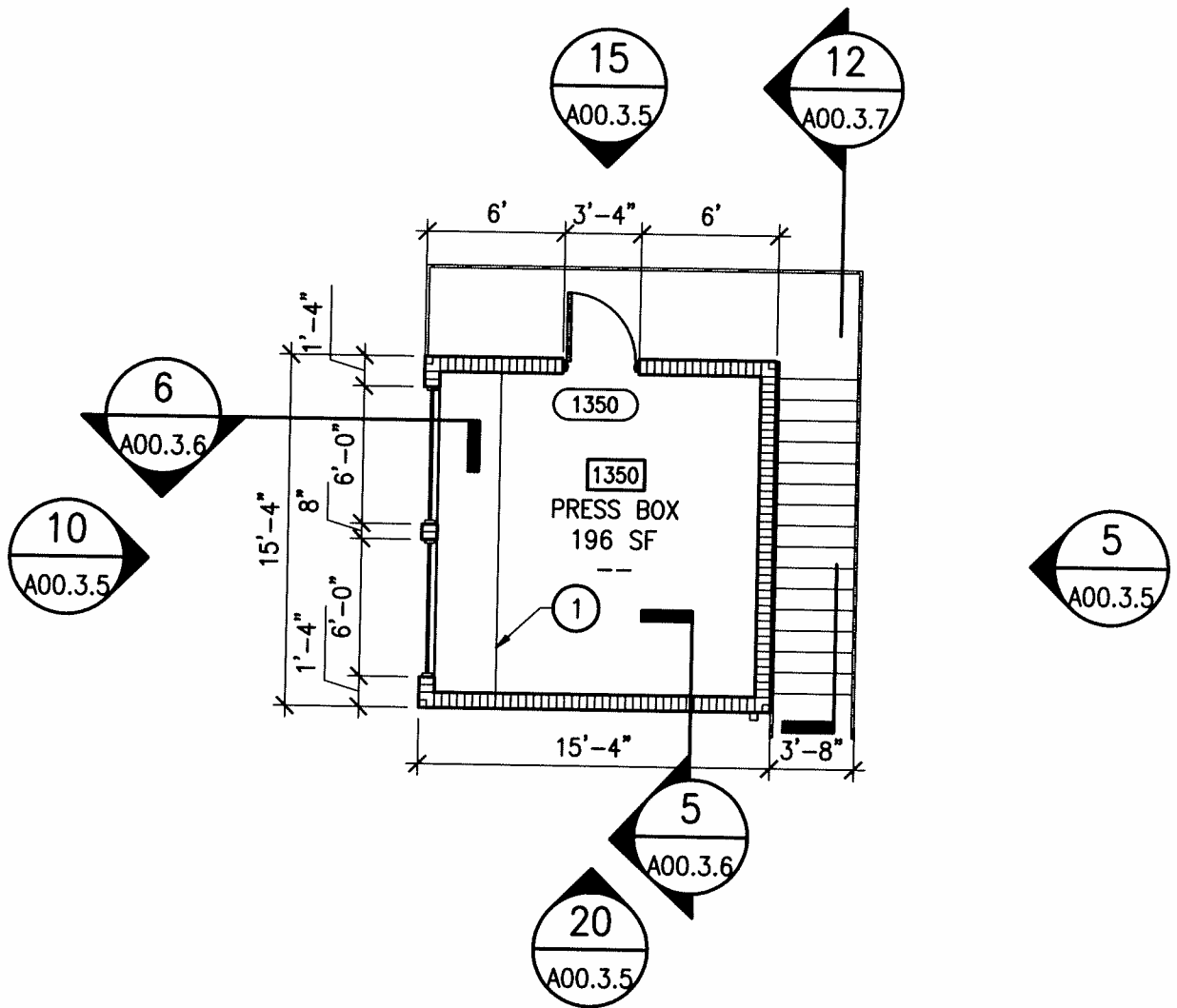

N

BLDG 12
2ND FLOOR
PLAN

2

SCALE: 1/8" = 1'-0"

| | | |
|-------------------|---|---------------------------|
| HIGH SCHOOL "UUU" | JOB NO.: 200668 | ISSUED NO.: ADA WAIVER |
| | DRAWN: KGF | SK-A9 |
| | CHECKED: AML | |
| | MANHATTAN CENTER 4525 S. MANHATTAN AVE. TAMPA, FLORIDA 33611 PHONE: (813) 839-0506 FAX: (813) 839-4616 AAC001624 EB 1828 | DATE: 11-29-07 |

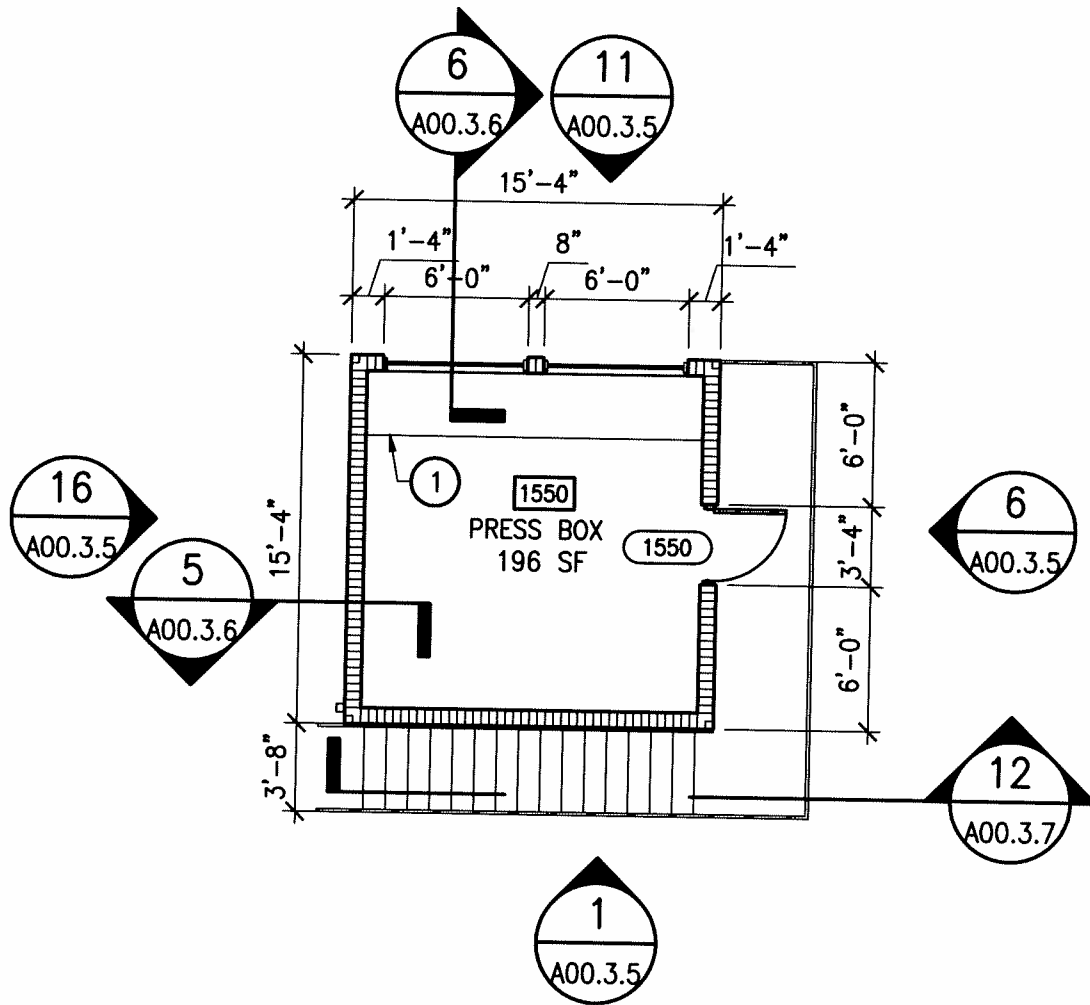

BLDG 14
2ND FLOOR

PLAN

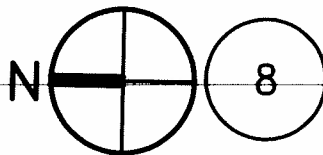

SCALE: 1/8" = 1'-0"



HIGH SCHOOL "UUU"

JOB NO.:
200668

ISSUED NO.:
ADA WAIVER

DRAWN:
KGF

CHECKED:
AML

SK-A10

DATE:
11-29-07

REFER TO DWG:
REF A00.3.4

LONG & ASSOCIATES
ARCHITECTS/ENGINEERS, INC.

MANHATTAN CENTER
4525 S. MANHATTAN AVE.
TAMPA, FLORIDA 33611
PHONE: (813) 839-0506
FAX: (813) 839-4616
AAC001624 EB 1828

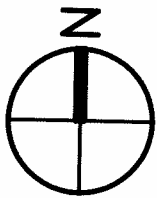

4

SCALE: 1/8" = 1'-0"



PLAN

BLDG 14
1ST FLOOR

THIRD BASE BASEBALL DUGOUT
240 SF
240 PGM

STORAGE
84 SF

MEN'S RESTROOM
48 SF

WOMEN'S RESTROOM
48 SF

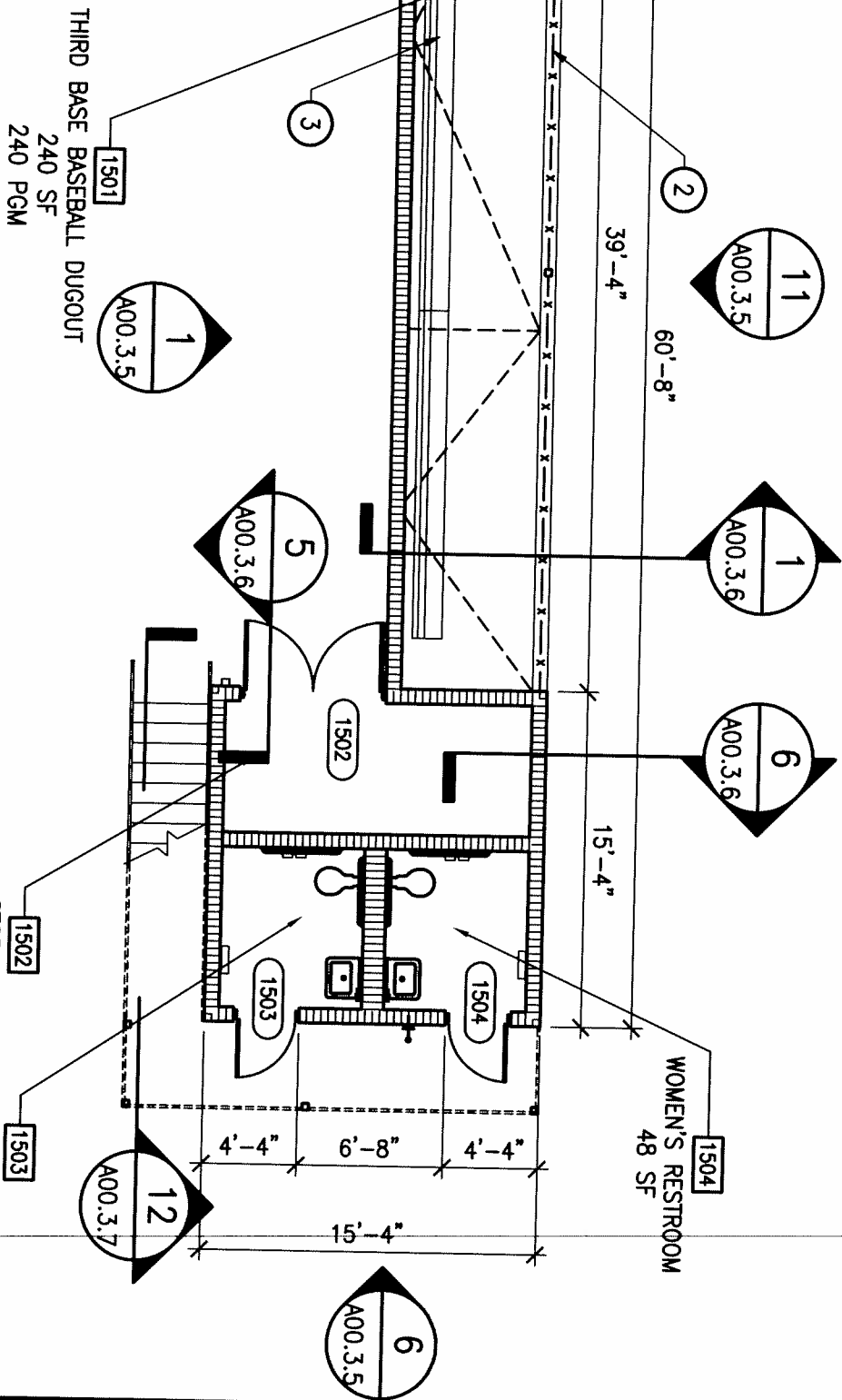

HIGH SCHOOL "UUU"

JOB NO.:
200668

ISSUED NO.:
ADA WAIVER

DRAWN:
KGF

CHECKED:
KGF

SK-A11

DATE:
11-29-07

REFER TO DWG:
REF A00.3.4

LONG & ASSOCIATES
ARCHITECTS/ENGINEERS, INC.

MANHATTAN CENTER
4525 S. MANHATTAN AVE.
TAMPA, FLORIDA 33611
PHONE: (813) 839-0506
FAX: (813) 839-4616
AAC001624 EB 1828

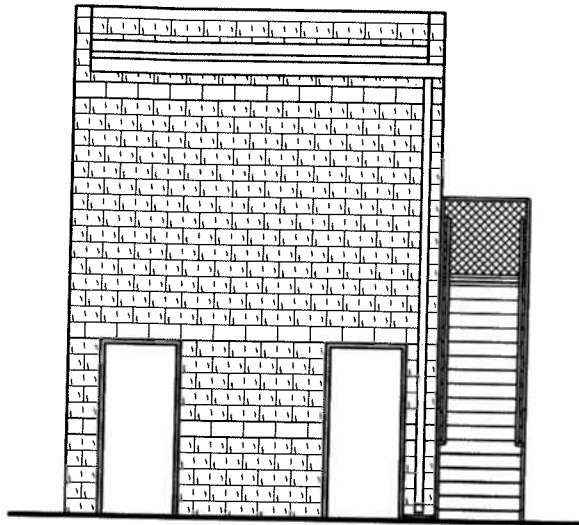

BLDG 12
SOUTHWEST
ELEVATION

20

SCALE: 1/8" = 1'-0"

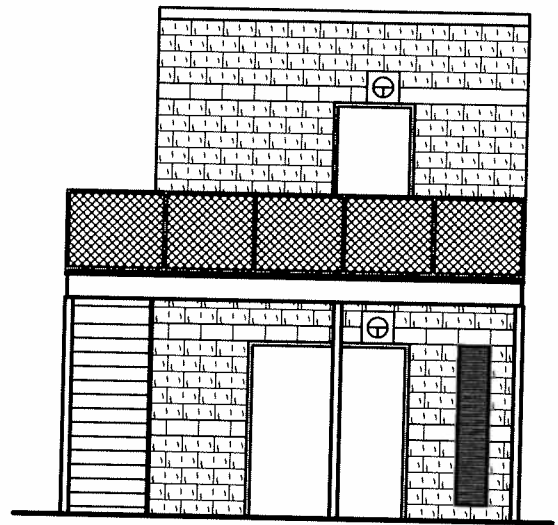

BLDG 12
NORTHEAST
ELEVATION

15

SCALE: 1/8" = 1'-0"

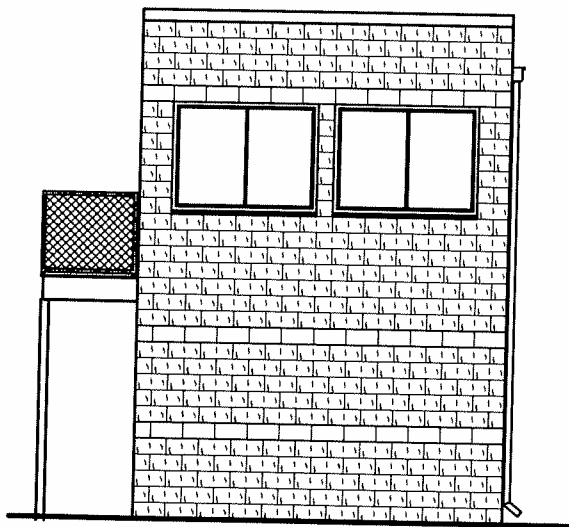

BLDG 12
NORTHWEST
ELEVATION

10

SCALE: 1/8" = 1'-0"

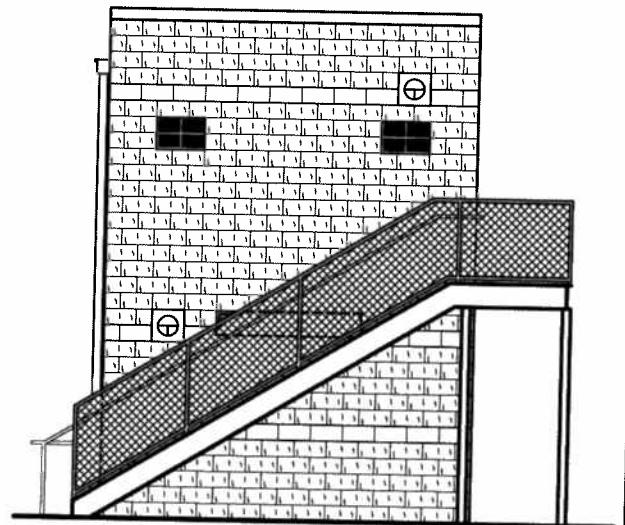

BLDG 12
SOUTHEAST
ELEVATION

5

SCALE: 1/8" = 1'-0"

HIGH SCHOOL "UUU"

LONG & ASSOCIATES
ARCHITECTS/ENGINEERS, INC.

MANHATTAN CENTER
4525 S. MANHATTAN AVE.
TAMPA, FLORIDA 33611
PHONE: (813) 839-0506
FAX: (813) 839-4616
AAC001624 EB 1828

JOB NO.:
200668

DRAWN:
KGF

CHECKED:
AML

DATE:
11-29-07

ISSUED NO.:
ADA WAIVER

SK-A12

REFER TO DWG:
REF A00.3.5

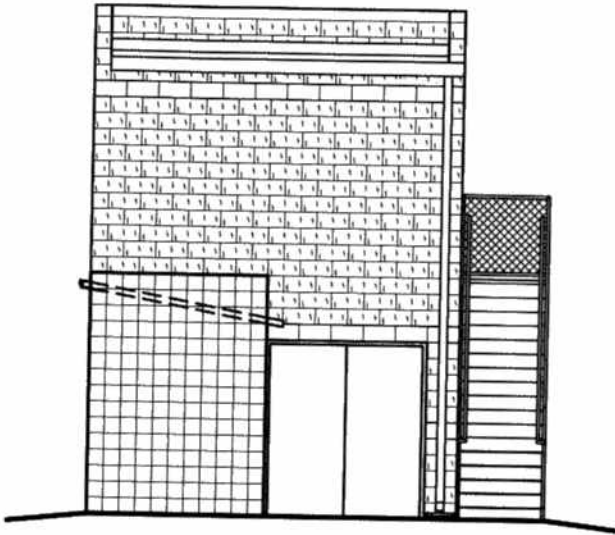

BLDG 14
NORTH
ELEVATION

16

SCALE: 1/8" = 1'-0"

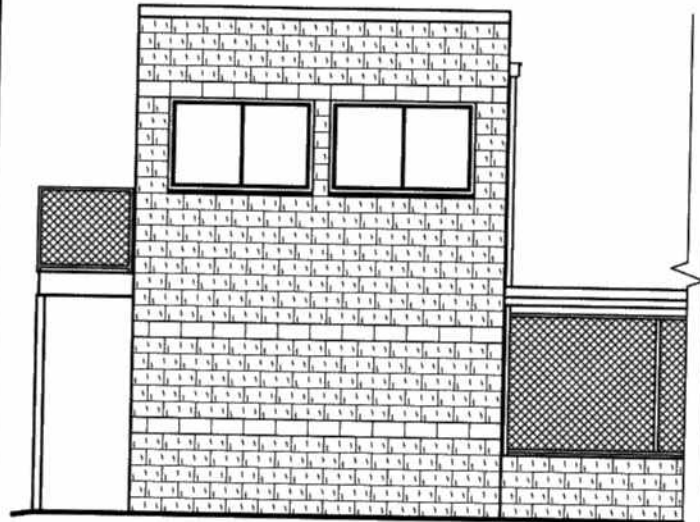

BLDG 14
EAST
ELEVATION

11

SCALE: 1/8" = 1'-0"

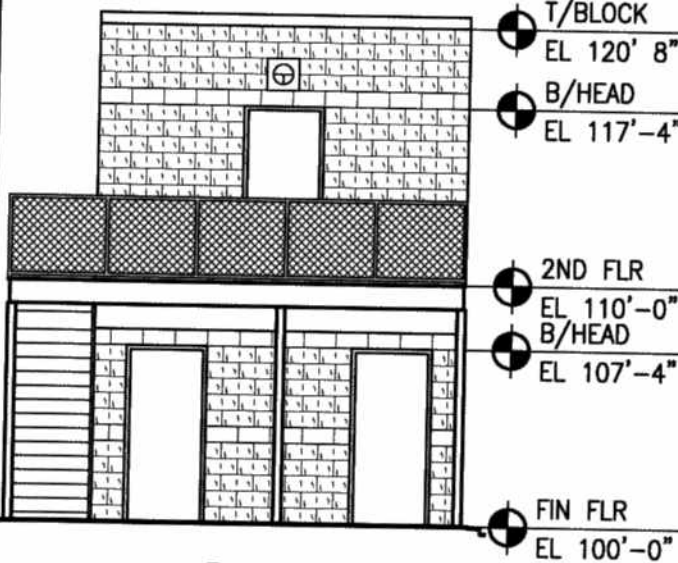

BLDG 14
SOUTH
ELEVATION

6

SCALE: 1/8" = 1'-0"

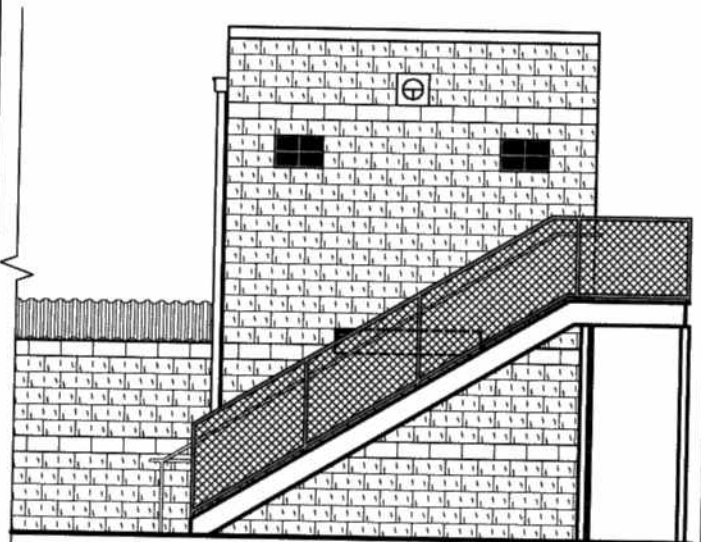

BLDG 14
WEST
ELEVATION

1

SCALE: 1/8" = 1'-0"

HIGH SCHOOL "UUU"

LONG & ASSOCIATES
ARCHITECTS/ENGINEERS, INC.

MANHATTAN CENTER
4525 S. MANHATTAN AVE.
TAMPA, FLORIDA 33611
PHONE: (813) 839-0506
FAX: (813) 839-4616
AAC001624 EB 1828

JOB NO.:
200668

DRAWN:
KGF

CHECKED:
AML

DATE:
11-29-07

ISSUED NO.:
ADA WAIVER

SK-A13

REFER TO DWG:
REF A00.3.5

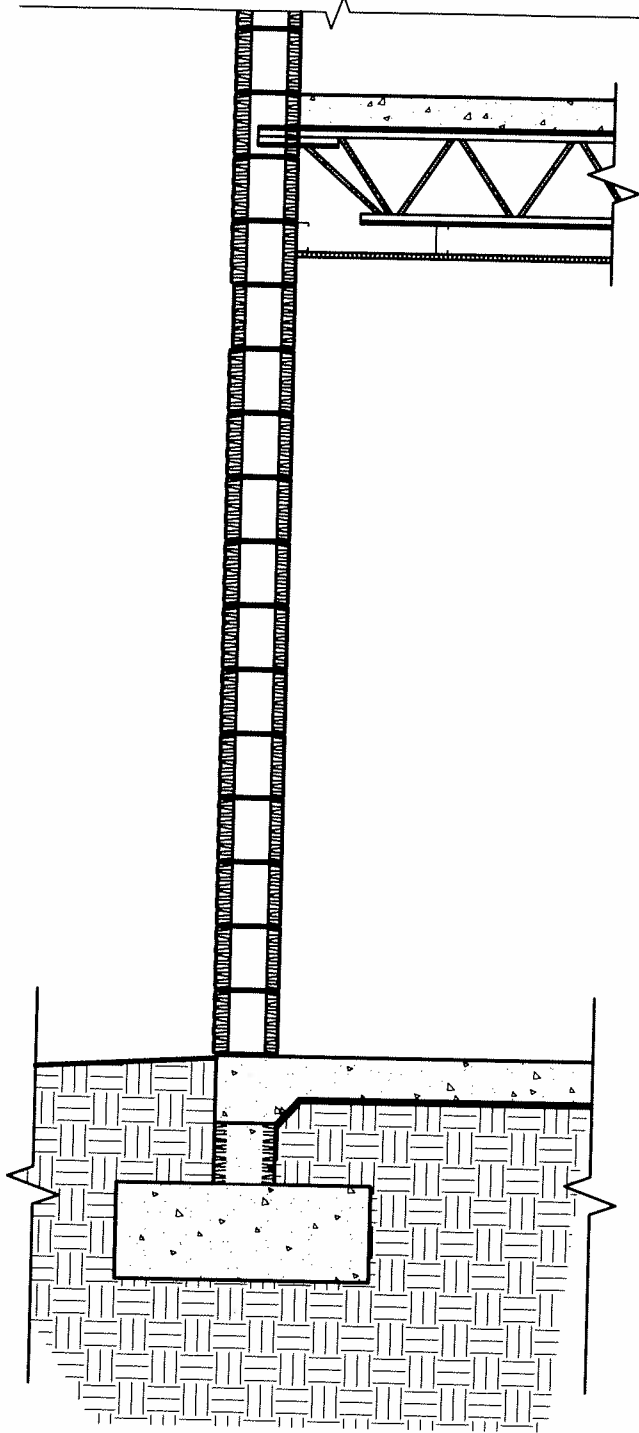

BLDG 12 & 14

SECTION

6

SCALE: 1/2" = 1'-0"

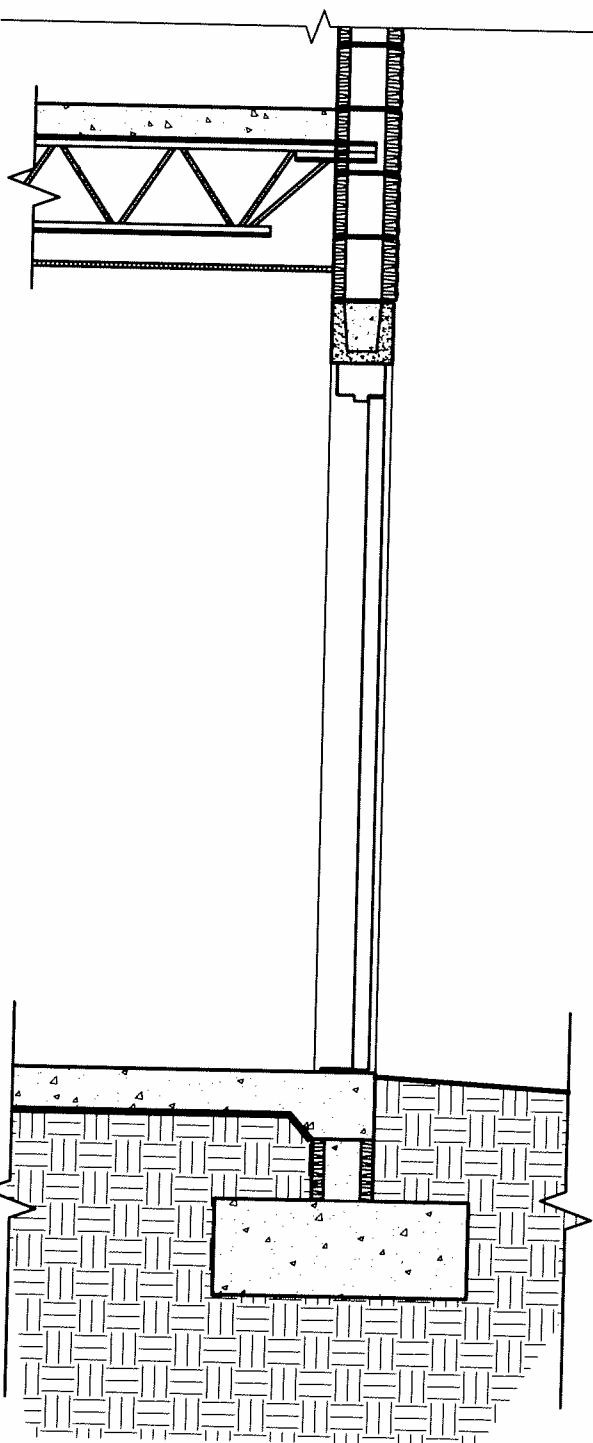

BLDG 12 & 14

SECTION

5

SCALE: 1/2" = 1'-0"

HIGH SCHOOL "UUU"

LONG & ASSOCIATES
ARCHITECTS/ENGINEERS, INC.

MANHATTAN CENTER
4525 S. MANHATTAN AVE.
TAMPA, FLORIDA 33611
PHONE: (813) 839-0506
FAX: (813) 839-4616
AAC001624 EB 1828

JOB NO.:
200668

DRAWN:
KGF

CHECKED:
AML

DATE:
11-29-07

ISSUED NO.:
ADA WAIVER

SK-A14

REFER TO DWG:
REF A00.3.6

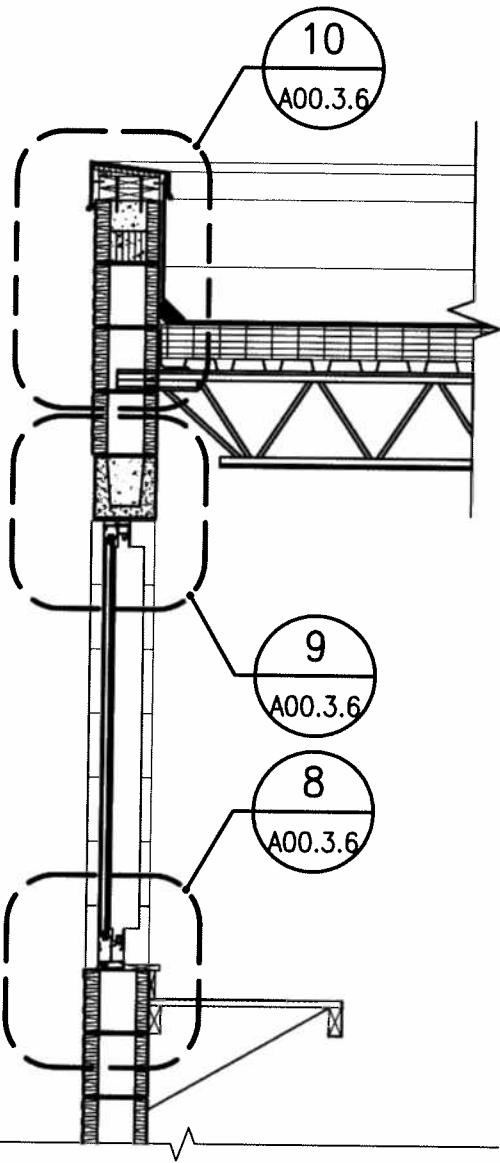

BLDG 12 & 14
SECTION

6

SCALE: 1/2" = 1'-0"

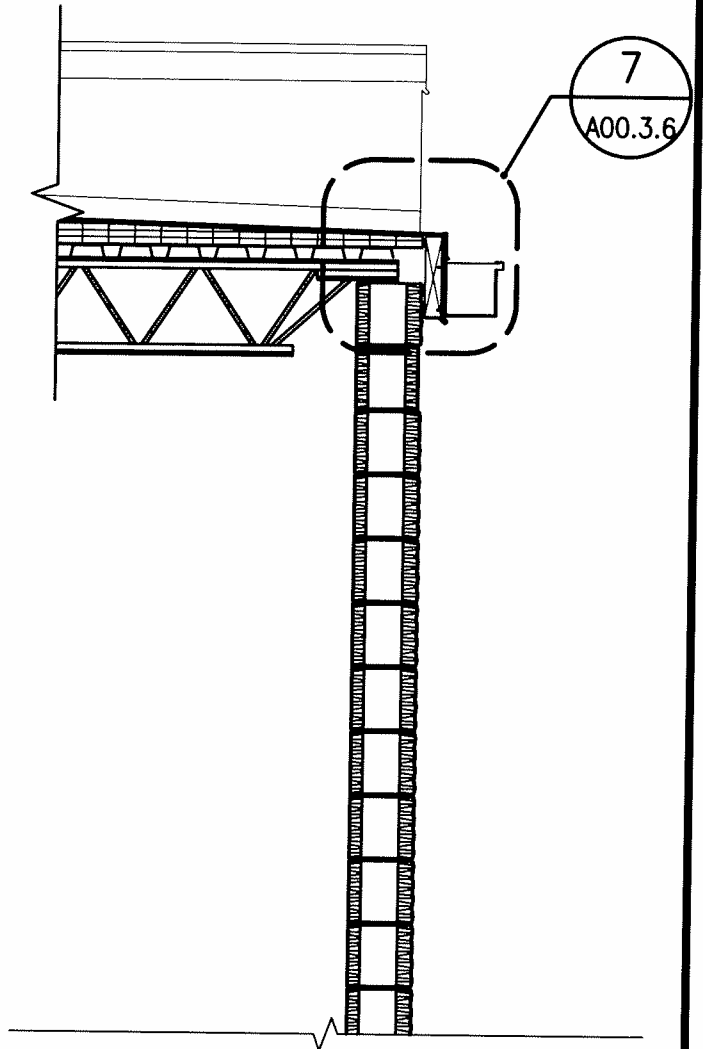

BLDG 12 & 14
SECTION

5

SCALE: 1/2" = 1'-0"

HIGH SCHOOL "UUU"

JOB NO.:
200668

ISSUED NO.:
ADA WAIVER

DRAWN:
KGF

CHECKED:
AML

DATE:
11-29-07

SK-A15

REFER TO DWG:
REF A00.3.6

LONG & ASSOCIATES
ARCHITECTS/ENGINEERS, INC.

MANHATTAN CENTER
4525 S. MANHATTAN AVE.
TAMPA, FLORIDA 33611
PHONE: (813) 839-0506
FAX: (813) 839-4616
AAC001624 EB 1828